

FOR KCC USE:

FORM C-1 7/91

FORM MUST BE TYPED

FORM MUST BE SIGNED

ALL BLANKS MUST BE FILLED

EFFECTIVE DATE: 11-28-92

State of Kansas

NOTICE OF INTENTION TO DRILL

Must be approved by the K.C.C. five (5) days prior to commencing well

DISTRICT # 1
SEAT Yes No

Expected Spud Date 11-27-92
month day year

Spot NE NW Sec 12 Twp 31S S, Rg 19 East
C. NE NW Sec 12 Twp 31S S, Rg 19 West

OPERATOR: License # 5123
Name: Pickrell Drilling Co. Inc.
Address: 110 N. Market, Suite 205
City/State/Zip: Wichita, Kansas 67202
Contact Person: Larry J. Richardson
Phone: 262-8427

660 feet from South (North) Line of Section
1980 feet from East (West) Line of Section
IS SECTION X REGULAR IRREGULAR?

(NOTE: Locate well on the Section Plat on Reverse Side)

County: Comanche
Lease Name: Hadley "A" Well #: 1
Field Name: Caraway Ext.

CONTRACTOR: License #: 5123
Name: Pickrell Drilling Co.

Is this a Prorated/Spaced Field? yes X no
Target Formation(s): Marmaton, Mississippian
Nearest lease or unit boundary: 660'

Well Drilled For: Well Class: Type Equipment:
X Oil ... Enh Rec ... Infield X Mud Rotary
X Gas ... Storage X Pool Ext. ... Air Rotary
... DWMO ... Disposal ... Wildcat ... Cable
... Seismic; ... # of Holes ... Other

Ground Surface Elevation: 2168 feet MSL
Water well within one-quarter mile: yes X no
Public water supply well within one mile: yes X no

If DWMO: old well information as follows:
Operator:
Well Name:
Comp. Date: Old Total Depth

Depth to bottom of fresh water: 128 17.5
Depth to bottom of usable water: 240
Surface Pipe by Alternate: X 1 2
Length of Surface Pipe Planned to be set: 260+

Directional, Deviated or Horizontal wellbore? yes X no
If yes, true vertical depth:
Bottom Hole Location:

Length of Conductor pipe required: 0
Projected Total Depth: 5200
Formation at Total Depth: Mississippian
Water Source for Drilling Operations:
well farm pond X other

DWR Permit #:
Will Cores Be Taken? yes X no
If yes, proposed zone:

AFFIDAVIT

*Last Circulation Zone between
500' to 600'. *

The undersigned hereby affirms that the drilling, completion and eventual plugging of this well will comply with K.S.A. 55-101, et. seq.
It is agreed that the following minimum requirements will be met:

- 1. Notify the appropriate district office prior to spudding of well;
- 2. A copy of the approved notice of intent to drill shall be posted on each drilling rig;
- 3. The minimum amount of surface pipe as specified below shall be set by circulating cement to the top; in all cases surface pipe shall be set through all unconsolidated materials plus a minimum of 20 feet into the underlying formation;
- 4. If the well is dry hole, an agreement between the operator and the district office on plug length and placement is necessary prior to plugging;
- 5. The appropriate district office will be notified before well is either plugged or production casing is cemented in;
- 6. IF AN ALTERNATE II COMPLETION, PRODUCTION PIPE SHALL BE CEMENTED FROM BELOW ANY USABLE WATER TO SURFACE WITHIN 120 DAYS OF SPUD DATE. IN ALL CASES, NOTIFY DISTRICT OFFICE PRIOR TO ANY CEMENTING.

I hereby certify that the statements made herein are true and to the best of my knowledge and belief.
Date: 11-17-92 Signature of Operator or Agent: Larry J. Richardson Title: Geologist

FOR KCC USE:
API # 15- 033-20866-00-00
Conductor pipe required None feet
Minimum surface pipe required 200' feet per Alt. 1 X
Approved by: CB 11-23-92
This authorization expires: 5-23-93
(This authorization void if drilling not started within 6 months of effective date.)
Spud date: Agent:

REMEMBER TO:

- File Drill Pit Application (form CDP-1) with Intent to Drill;
- File Completion Form ACO-1 within 120 days of spud date;
- File acreage attribution plat according to field proration orders;
- Notify appropriate district office 48 hours prior to workover or re-entry;
- Submit plugging report (CP-4) after plugging is completed;
- Obtain written approval before disposing or injecting salt water.

Mail to: Conservation Division, 200 Colorado Derby Building, 202 W. First St., Wichita, Kansas 67202-1286.

RECEIVED
KANSAS CORPORATION COMMISSION

NOV 17 1992
11-17-1992
CONSERVATION DIVISION
WICHITA, KS

12
31
19

IN ALL CASES PLOT THE INTENDED WELL ON THE PLAT BELOW

PLAT OF ACREAGE ATTRIBUTABLE TO A WELL IN A PRORATED OR SPACED FIELD

If the intended well is in a prorated or spaced field, please fully complete this side of the form. If the intended well is in a prorated or spaced field complete the plat below showing that the well will be properly located in relationship to other wells producing from the common source of supply. Please show all the wells within 1 mile of the boundaries of the proposed acreage attribution unit for gas wells and within 1/2 mile of the boundaries of the proposed acreage attribution unit for oil wells.

API NO. 15- _____
 OPERATOR Pickrell Drilling Co. Inc. LOCATION OF WELL: COUNTY Comanche
 LEASE Hadley "A" 660 feet from ~~south~~/north line of section
 WELL NUMBER 1 1980 feet from ~~east~~/west line of section
 FIELD Caraway Extension SECTION 12 TWP 31S RG 19W

NUMBER OF ACRES ATTRIBUTABLE TO WELL _____ IS SECTION X REGULAR or _____ IRREGULAR
 QTR/QTR/QTR OF ACREAGE _____ - _____ - _____ IF SECTION IS IRREGULAR, LOCATE WELL FROM NEAREST CORNER BOUNDARY.

Section corner used: _____ NE _____ NW _____ SE _____ SW
PLAT

(Show location of the well and shade attributable acreage for prorated or spaced wells.)
 (Show footage to the nearest lease or unit boundary line.)

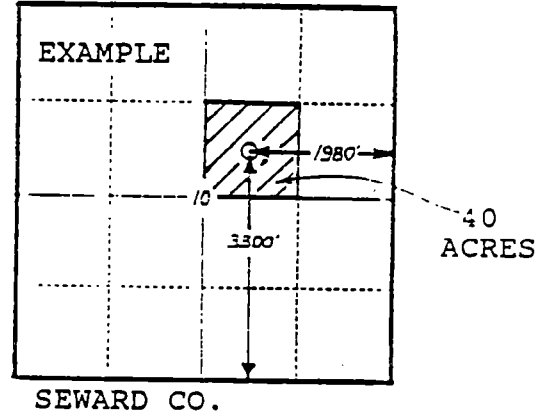
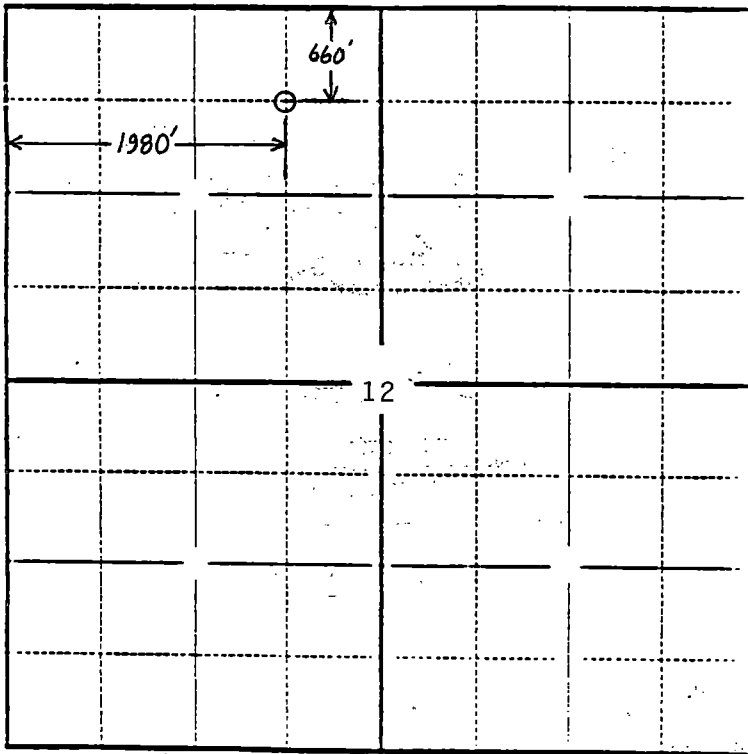

In plotting the proposed location of the well, you must show:

- 1) The manner in which you are using the depicted plat by identifying section lines, i.e. 1 section, 1 section with 8 surrounding sections, 4 sections, etc.;
- 2) the distance of the proposed drilling location from the section's south/north and east/west lines; and
- 3) the distance to the nearest lease or unit boundary line.

FOR KCC USE:

FORM C-1 7/91

EFFECTIVE DATE: 11-28-92

FORM MUST BE TYPED

DISTRICT # 1

State of Kansas

033-20,866-00-00

FORM MUST BE SIGNED

SSA? Yes No

NOTICE OF INTENTION TO DRILL

ALL BLANKS MUST BE FILLED

Must be approved by the K.C.C. five (5) days prior to commencing well

Expected Spud Date 11-27-92 month day year

Spot C-NE-NW Sec. 12. Twp 31S. S. Rg 19 East West

OPERATOR: License # 5123 Pickrell Drilling Co. Inc. Name: 110 N. Market, Suite 205 Address: Wichita, Kansas 67202 City/State/Zip: Larry J. Richardson Contact Person: 262-8427 Phone:

660 feet from South line of Section 1980 feet from East line of Section IS SECTION X REGULAR IRREGULAR?

CONTRACTOR: License # 5123 Pickrell Drilling Co. Name:

(NOTE: Locate well on the Section Plat on Reverse Side) County: Comanche Lease Name: Hadley Well #: 1 Field Name: Caraway Ext.

Well Drilled For: Well Class: Type Equipment: X Oil Enh Rec Infield X Mud Rotary X Gas Storage X Pool Ext. Air Rotary ... GWD Disposal Wildcat Cable ... Seismic; # of Holes Other

Is this a Prorated/Spaced Field? yes no Target Formation(s): Marmaton, Mississippian Nearest lease or unit boundary: 660 Ground Surface Elevation: 2168

If GWD: old well information as follows: Operator: Well Name: Comp. Date: Old Total Depth

Water well within one-quarter mile: yes no Public water supply well within one mile: yes no Depth to bottom of fresh water: 17.5 Depth to bottom of usable water: 240

Directional, Deviated or Horizontal wellbore? yes no If yes, true vertical depth: Bottom Hole Location:

Surface Pipe by Alternate: X 1 2 Length of Surface Pipe Planned to be set: 260+ Length of Conductor pipe required: 0 Projected Total Depth: 5200 Formation at Total Depth: Mississippian

Exp. 5/23/93

Water Source for Drilling Operations: well farm pond X other

The undersigned hereby affirms that the drilling, completion and eventual plugging of this well will comply with K.S.A. 55-101, et. seq.

DNR Permit #: Will Cores Be Taken?: If yes, proposed zone:

* * * Last Circulation Zone between 500' to 600'. * * * 200' Alt. I Req

AFFIDAVIT

Pusher Doyle Folkerts SPUD DATE 12-3-92 INIT. DG LENGTH SURFACE PLANNED 600'

RESERVE PIT STATUS- REMOVE FLUID LINED after salt sect. bbls. when done bbls.

RATHOLED AHEAD? Y N SIZE HOLE SURFACE PIPE 5 1/2" @ 685 CONDUCTOR ANHYDRITE T- B- 1050 ELEVATION

TD 5200 FORMATION MISS

RAN PIPE @ DV TOOL ALT II DONE SX Y N

Arbuckle Plug @ Ft. W/ SX

Hug./Council @ Ft. W/ SX

Anhydrite Base @ 1100 Ft. W/ 50 SX

1/2 Base Anyh. @ Ft. W/ SX

1/2, 1/2 Plug @ Ft. W/ SX

Bottom Surface @ 720 Ft. W/ 50 SX

40' Plug @ 40 Ft. W/ 10 SX

RAT HOLE CIRC/W 15 SX MOUSE HOLE W/ SX

WATER WELL SX (Irr. Well Pond Hauling)

TECHNICIAN CM DATE 12-11-92

TYPE OF CEMENT 60/40 60% gel

STARTING TIME 12:00 (AM/PM) DATE 12-14-92

COMPLETION TIME 00:00 (AM/PM) DATE 12-14-92

CEMENT COMPANY Allied

12-22-1992

RECEIVED DIVISION OF COMMISSION ON COMMISSION