

FOR KCC USE:

FORM C-1 7/91

FORM MUST BE TYPED

FORM MUST BE SIGNED

ALL BLANKS MUST BE FILLED

EFFECTIVE DATE: 8-29-2000

State of Kansas

DISTRICT # 1

NOTICE OF INTENTION TO DRILL

SGA?  Yes...  No

Must be approved by the K.C.C. five (5) days prior to commencing well.

Spot \_\_\_\_\_ East

Expected Spud Date ... September ..... 25 ..... 2000 .....  
month day year

.NE...  .NE...  .SE.. Sec .5... Twp .32S. S, Rg .19W. xx West

OPERATOR: License # ... 31514 .....

.....2310'..... feet from South / ----- line of Section

..... 330'..... feet from East / ---- line of Section

IS SECTION  REGULAR \_\_\_\_\_ IRREGULAR?

Name: .Thoroughbred Associates, LLC.....

(NOTE: Locate well on the Section Plat on Reverse Side)

Address: .8100 E. 22nd St. No. Bldg. 600 Suite F.....

County: .....Comanche.....

City/State/Zip: ..Wichita, Kansas 67226.....

Lease Name: ..Bird Ranch.....Well #: ...1.....

Contact Person: ..Robert C. Patton.....

Field Name: .....unnamed.....

Phone: .....(316) 685-1512.....

Is this a Prorated/Spaced Field? .... yes  .X.. no

CONTRACTOR: License #: ... 5123 .....

Target Formation(s): ..LKC, Marmaton, St. Louis.....

Name: .....Pickrell Drilling Co., Inc.....

Nearest Lease or unit boundary: .....330'.....

Well Drilled For: Well Class: Type Equipment:

Ground Surface Elevation: ..... 2124' ..... feet MSL

Water well within one-quarter mile: .... yes  .XX. no

Public water supply well within one mile: .... yes  .XX. no

.X. Oil ... Enh Rec ... Infield .X. Mud Rotary

Depth to bottom of fresh water: .. 180 .....

.X. Gas ... Storage ... Pool Ext. ... Air Rotary

Depth to bottom of usable water: .. 220 .....

... OWWO ... Disposal .X. Wildcat ... Cable

Surface Pipe by Alternate: ..XX.  1  2

... Seismic; ... # of Holes ... Other

Length of Surface Pipe Planned to be set: ...425'.....

... Other .....

Length of Conductor pipe required: .....90'.....

If OWWO: old well information as follows:

Projected Total Depth: .....6000'.....

Operator: .....

Formation at Total Depth: .....Arbuckle.....

Well Name: .....

Water Source for Drilling Operations:

Comp. Date: ..... Old Total Depth .....

..... well ..... farm pond ..X. other

Directional, Deviated or Horizontal wellbore? .... yes  .XX. no

Will Cores Be Taken?: .... yes  .X.. no

If yes, true vertical depth:.....

If yes, proposed zone:.....

Bottom Hole Location.....

AFFIDAVIT

The undersigned hereby affirms that the drilling, completion and eventual plugging of this well will comply with K.S.A. 55-101, et. seq.

It is agreed that the following minimum requirements will be met:

1. Notify the appropriate district office prior to spudding of well;
2. A copy of the approved notice of intent to drill shall be posted on each drilling rig;
3. The minimum amount of surface pipe as specified below shall be set by circulating cement to the top; in all cases surface pipe shall be set through all unconsolidated materials plus a minimum of 20 feet into the underlying formation;
4. If the well is dry hole, an agreement between the operator and the district office on plug length and placement is necessary prior to plugging;
5. The appropriate district office will be notified before well is either plugged or production casing is cemented in;
6. IF AN ALTERNATE II COMPLETION, PRODUCTION PIPE SHALL BE CEMENTED FROM BELOW ANY USABLE WATER TO SURFACE WITHIN 120 DAYS OF SPUD DATE. IN ALL CASES, NOTIFY DISTRICT OFFICE PRIOR TO ANY CEMENTING.

I hereby certify that the statements made herein are true and to the best of my knowledge and belief.

Date: ..Aug. 11, 2000.....Signature of Operator or Agent: Kenneth Knopf..... Title:.....Partner.....

FOR KCC USE:

API # 15- 033-211340000

Conductor pipe required NONE feet

Minimum surface pipe required 240 feet per Alt. (1)

Approved by: JK 8-24-2000

This authorization expires: 2-24-2001

(This authorization void if drilling not started within 6 months of effective date.)

Spud date: \_\_\_\_\_ Agent: \_\_\_\_\_

REMEMBER TO:

- File Drill Pit Application (form CDP-1) with Intent to Drill;
- File Completion Form ACO-1 within 120 days of spud date;
- File acreage attribution plat according to field prorations orders;
- Notify appropriate district office 48 hours prior to workover or re-entry;
- Submit plugging report (CP-4) after plugging is completed;
- Obtain written approval before disposing or injecting salt water.

Mail to: KCC - Conservation Division, 130 S. Market - Room 2078, Wichita, Kansas 67202.

RECEIVED  
STATE CORPORATION COMMISSION

AUG 14 2000

8-14-00

CONSERVATION DIVISION  
Wichita, Kansas

5  
32  
191

**IN ALL CASES PLOT THE INTENDED WELL ON THE PLAT BELOW**

**PLAT OF ACREAGE ATTRIBUTABLE TO A WELL IN A PRORATED OR SPACED FIELD**

If the intended well is in a prorated or spaced field, please fully complete this side of the form. If the intended well is in a prorated or spaced field complete the plat below showing that the well will be properly located in relationship to other wells producing from the common source of supply. Please show all the wells within 1 mile of the boundaries of the proposed acreage attribution unit for gas wells and within 1/2 mile of the boundaries of the proposed acreage attribution unit for oil wells.

API NO. 15- \_\_\_\_\_  
 OPERATOR \_\_\_\_\_  
 LEASE \_\_\_\_\_  
 WELL NUMBER \_\_\_\_\_  
 FIELD \_\_\_\_\_

LOCATION OF WELL: COUNTY \_\_\_\_\_  
 \_\_\_\_\_ feet from south/north line of section  
 \_\_\_\_\_ feet from east/west line of section  
 SECTION \_\_\_\_\_ TWP \_\_\_\_\_ RG \_\_\_\_\_

NUMBER OF ACRES ATTRIBUTABLE TO WELL \_\_\_\_\_  
 QTR/QTR/QTR OF ACREAGE \_\_\_\_\_

IS SECTION \_\_\_\_\_ REGULAR or \_\_\_\_\_ IRREGULAR  
**IF SECTION IS IRREGULAR, LOCATE WELL FROM NEAREST CORNER BOUNDARY.**  
 Section corner used: \_\_\_\_\_ NE \_\_\_\_\_ NW \_\_\_\_\_ SE \_\_\_\_\_ SW

**PLAT**

(Show location of the well and shade attributable acreage for prorated or spaced wells.)  
 (Show footage to the nearest lease or unit boundary line.)

R19W

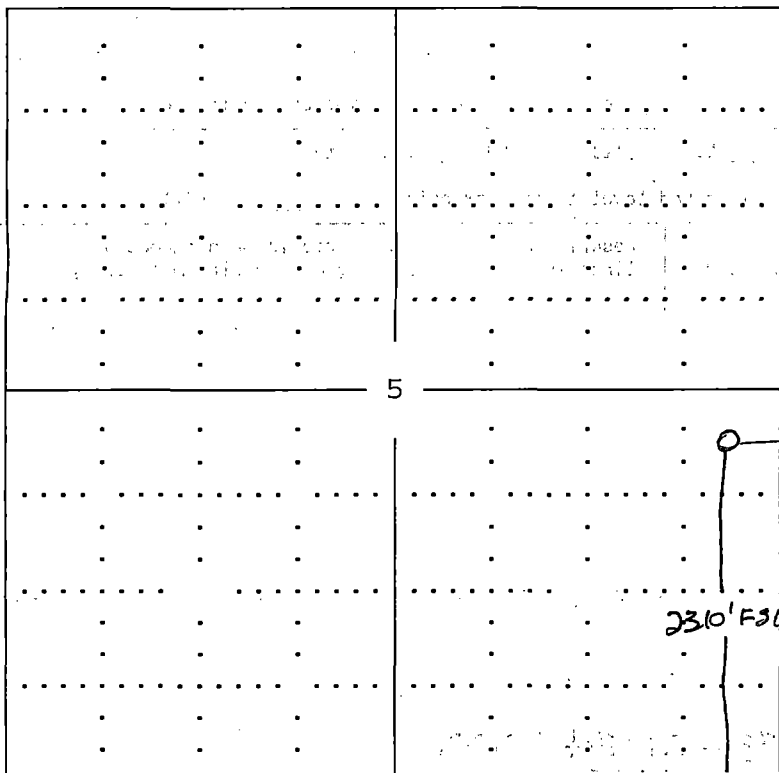

T  
3  
2  
S

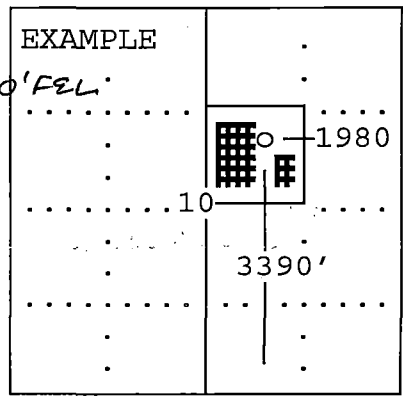

SEWARD CO.

Comanche County

**In plotting the proposed location of the well, you must show:**

- 1) The manner in which you are using the depicted plat by identifying section lines, i.e. 1 section, 1 section with 8 surrounding sections, 4 sections, etc.;
- 2) the distance of the proposed drilling location from the section's south/north and east/west; and
- 3) the distance to the nearest lease or unit boundary line.