

For KCC Use:
 Effective Date: 4-10-2001
 District # _____
 SGA? Yes No

KANSAS CORPORATION COMMISSION
 OIL & GAS CONSERVATION DIVISION

RECEIVED OWWO
 KANSAS CORPORATION COMMISSION
 Form C-1
 September 1999
 Form must be Typed
 Form must be Signed
 All blanks must be Filled

NOTICE OF INTENT TO DRILL

Must be approved by KCC five (5) days prior to commencing well

APR 03 2001

Expected Spud Date April 7, 2001
 month day year

Spot 90w of CONSERVATION DIVISION
 WICHITA, KS
 App. C NE SE Sec. 13 Twp. 32 S. R. 19
 East
 West
1980 feet from S / N (circle one) Line of Section
750 feet from E / W (circle one) Line of Section
 Is SECTION Regular Irregular?

OPERATOR: License# 4058
 Name: AMERICAN WARRIOR, INC.
 Address: P. O. Box 399
 City/State/Zip: Garden City, Kansas 67846-0399
 Contact Person: Cecil O'Brate
 Phone: 620/275-9231

CONTRACTOR: License# 5929
 Name: DUKE DRILLING CO., INC.

(Note: Locate well on the Section Plat on reverse side)

County: Comanche
 Lease Name: LENERTZ Well #: 1

Field Name: _____
 Is this a Prorated / Spaced Field? Yes No

Target Information(s): Mississippi, Viola
 Nearest Lease or unit boundary: 750'

Ground Surface Elevation: est 2020 feet MSL

Water well within one-quarter mile: Yes No

Public water supply well within one mile: Yes No

Depth to bottom of fresh water: 120'

Depth to bottom of usable water: 180' 240'

Surface Pipe by Alternate: 1 2

Length of Surface Pipe ~~Required to be set~~: 734'

Length of Conductor Pipe required: 20" @ 82'

Projected Total Depth: 6100'

Producing Formation Target: Viola

Water Source for Drilling Operations:

Well _____ Farm Pond _____ Other

DWR Permit #: _____

(Note: Apply for Permit with DWR)

Will Cores be taken? Yes No

If Yes, proposed zone: _____

Well Drilled For:	Well Class:	Type Equipment:
<input checked="" type="checkbox"/> Oil	<input checked="" type="checkbox"/> Enh Rec	<input checked="" type="checkbox"/> Infield
<input checked="" type="checkbox"/> Gas	<input type="checkbox"/> Storage	<input type="checkbox"/> Pool Ext.
<input checked="" type="checkbox"/> OWWO	<input type="checkbox"/> Disposal	<input type="checkbox"/> Wildcat
<input type="checkbox"/> Seismic; # of Holes _____	<input type="checkbox"/> Other _____	<input checked="" type="checkbox"/> Mud Rotary
<input type="checkbox"/> Other _____		<input type="checkbox"/> Air Rotary
		<input type="checkbox"/> Cable

If OWWO: old well information as follows:

Operator: BONNEVILLE FUELS CORP.

Well Name: Lenertz #1

Original Completion Date: 8/15/96 Original Total Depth: 6100'

Directional, Deviated or Horizontal wellbore? Yes No

If Yes, true vertical depth: _____

Bottom Hole Location: _____

KCC DKT #: _____

AFFIDAVIT

The undersigned hereby affirms that the drilling, completion and eventual plugging of this well will comply with K.S.A. 55-101, et. seq.

It is agreed that the following minimum requirements will be met:

1. Notify the appropriate district office *prior* to spudding of well;
2. A copy of the approved notice of intent to drill *shall be* posted on each drilling rig;
3. The minimum amount of surface pipe as specified below *shall be set* by circulating cement to the top; in all cases surface pipe *shall be set* through all unconsolidated materials plus a minimum of 20 feet into the underlying formation.
4. If the well is dry hole, an agreement between the operator and the district office on plug length and placement is necessary *prior to plugging*;
5. The appropriate district office will be notified before well is either plugged or production casing is cemented in;
6. If an ALTERNATE II COMPLETION, production pipe shall be cemented from below any usable water to surface within *120 days* of spud date. *In all cases, NOTIFY district office* prior to any cementing.

I hereby certify that the statements made herein are true and to the best of my knowledge and belief.

Date: 4/3/01 Signature of Operator or Agent: Sally R. Byers Title: Agent

For KCC Use ONLY

API # 15 - 033-20911-00-01

Conductor pipe required NONE feet

Minimum surface pipe required 734 feet per Alt. (1)

Approved by: JK 4-5-2001

This authorization expires: 10-5-2001
 (This authorization void if drilling not started within 6 months of effective date.)

Spud date: _____ Agent: _____

Remember to:

- File Drill Pit Application (form CDP-1) with Intent to Drill;
- File Completion Form ACO-1 within 120 days of spud date;
- File acreage attribution plat according to field proration orders;
- Notify appropriate district office 48 hours prior to workover or re-entry;
- Submit plugging report (CP-4) after plugging is completed;
- Obtain written approval before disposing or injecting salt water.

13
32
19W

IN ALL CASES PLOT THE INTENDED WELL ON THE PLAT BELOW

Plat of acreage attributable to a well in a prorated or spaced field

If the intended well is in a prorated or spaced field, please fully complete this side of the form. If the intended well is in a prorated or spaced field complete the plat below showing that the well will be properly located in relationship to other wells producing from the common source of supply. Please show all the wells and within 1 mile of the boundaries of the proposed acreage attribution unit for gas wells and within 1/2 mile of the boundaries of the proposed acreage attribution unit for oil wells.

API No. 15 - _____
Operator: _____
Lease: _____
Well Number: _____
Field: _____
Number of Acres attributable to well: _____
QTR / QTR / QTR of acreage: _____ - _____ - _____

Location of Well: County: _____
_____ feet from S / N (circle one) Line of Section
_____ feet from E / W (circle one) Line of Section
Sec: _____ Twp. _____ S. R. _____ East West
Is Section _____ Regular or _____ Irregular
If Section is Irregular, locate well from nearest corner boundary.
Section corner used: _____ NE _____ NW _____ SE _____ SW

PLAT

*(Show location of the well and shade attributable acreage for prorated or spaced wells.)
(Show footage to the nearest lease or unit boundary line.)*

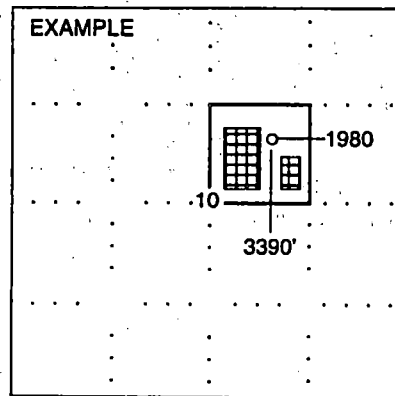
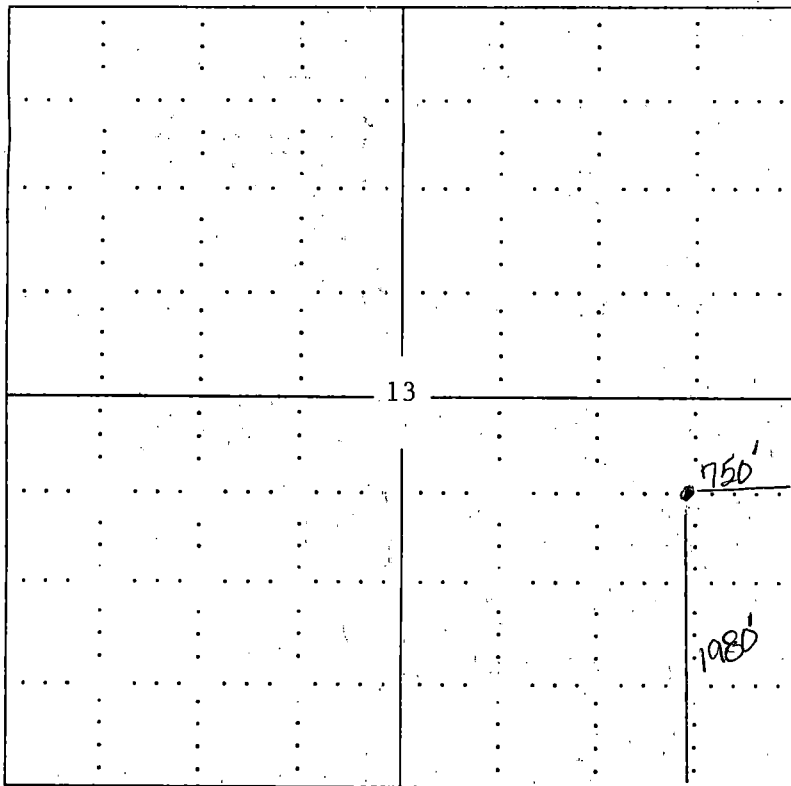

NOTE: In all cases locate the spot of the proposed drilling location.

COMANCHE COUNTY

In plotting the proposed location of the well, you must show:

1. The manner in which you are using the depicted plat by identifying section lines, i.e. 1 section, 1 section with 8 surrounding sections, 4 sections, etc.
2. The distance of the proposed drilling location from the section's south / north and east / west.
3. The distance to the nearest lease or unit boundary line.
4. If proposed location is located within a prorated or spaced field a certificate of acreage attribution plat must be attached: (CO-7 for oil wells; CG-8 for gas wells).