

EFFECTIVE DATE: 4-7-97

State of Kansas

DISTRICT # 1

NOTICE OF INTENTION TO DRILL

2. X Yes... No

Must be approved by the K.C.C. five (5) days prior to commencing well.

Expected Spud Date 4/4/97 month day year

Spot C NW Sec 34 Twp 32 S, Rg 19 East West

OPERATOR: License # 3882 SAMUEL GARY, JR. & ASSOCIATES 1670 BROADWAY, SUITE 3300 DENVER, COLORADO 80202 TOM FERTAL

1320 feet from South / North line of Section 1320 feet from East / West line of Section IS SECTION X REGULAR IRREGULAR

CONTRACTOR: License # 5105 CLARK CORPORATION

(NOTE: Locate well on the Section Plat on Reverse Side) County: COMANCHE Lease Name: GILLET Well #: 1-34 Field Name: COLTER WEST

Well Drilled For: Well Class: Type Equipment: Oil Enh Rec Infield Mud Rotary Gas Storage Pool Ext Air Rotary CWWD Disposal Wildcat Cable Seismic # of Holes Other TUTHILL & BARBEE 1-34 GILLET 1-24-81 Old Total Depth 5230

Is this a Prorated/Spaced Field? yes X no Target Formation(s): SWOPE Nearest lease or unit boundary: 1320 Ground Surface Elevation: 1933 feet MSL Water well within one-quarter mile: yes X no Public water supply well within one mile: yes X no Depth to bottom of fresh water: 105 Depth to bottom of usable water: 180 Surface Pipe by Alternate: X 1 Length of Surface Pipe Planned to be set: 797 Length of Conductor pipe required: NA Projected Total Depth: 5230 Formation at Total Depth: ARBUCKLE Water Source for Drilling Operations: well farm pond X other

Directional, Deviated or Horizontal wellbore? yes X no If yes, true vertical depth: on Hole Location.

Will Cores Be Taken? yes X no If yes, proposed zone:

AFFIDAVIT

RECEIVED KANSAS CORPORATION COMMISSION

The undersigned hereby affirms that the drilling, completion and eventual plugging of this well will comply with K.S.A. 55-101, et. seq. It is agreed that the following minimum requirements will be met:

APR 07 1997 4-1-97

- 1. Notify the appropriate district office prior to spudding of well; 2. A copy of the approved notice of intent to drill shall be posted on each drilling rig; 3. The minimum amount of surface pipe as specified below shall be set by circulating cement to the top; in all cases surface pipe shall be set through all unconsolidated materials plus a minimum of 20 feet into the underlying formation; 4. If the well is dry hole, an agreement between the operator and the district office on plug length and placement is necessary prior to plugging; 5. The appropriate district office will be notified before well is either plugged or production casing is cemented in; 6. IF AN ALTERNATE II COMPLETION, PRODUCTION PIPE SHALL BE CEMENTED FROM BELOW ANY USABLE WATER TO SURFACE WITHIN 120 DAYS OF SPUD DATE. IN ALL CASES, NOTIFY DISTRICT OFFICE PRIOR TO ANY CEMENTING.

CONSERVATION DIVISION WICHITA, KS

I hereby certify that the statements made herein are true and to the best of my knowledge and belief.

Date: Mar. 31, 1997 Signature of Operator or Agent: Thomas Fertal Title: Geologist

FOR KCC USE: API # 15- 033-204310001 Conductor pipe required NONE feet Minimum surface pipe required 797 feet per Alt. 1 X Approved by: SK 4-2-97 This authorization expires: 10-2-97 (This authorization void if drilling not started within 6 months of effective date.) Spud date: Agent:

D'sA Wypislock hole SEE-0002

34 32 19W

- REMEMBER TO: - File Drill Pit Application (form CDP-1) with Intent to Drill; - File Completion Form ACO-1 within 120 days of spud date; - File acreage attribution plat according to field proration orders; - Notify appropriate district office 48 hours prior to workover or re-entry; - Submit plugging report (CP-4) after plugging is completed; - Obtain written approval before disposing or injecting salt water.

**IN ALL CASES PLOT THE INTENDED WELL ON THE PLAT BELOW**

**PLAT OF ACREAGE ATTRIBUTABLE TO A WELL IN A PRORATED OR SPACED FIELD**

the intended well is in a prorated or spaced field, please fully complete this side of the form. If the intended well is in a prorated or spaced field complete the plat below showing that the well will be properly located in relationship to other wells producing from the common source of supply. Please show all the wells within 1 mile of the boundaries of the proposed acreage attribution unit for gas wells and within 1/2 mile of the boundaries of the proposed acreage attribution unit for oil wells.

API NO. 15- \_\_\_\_\_  
 OPERATOR Samuel Gary Jr. & Associates LOCATION OF WELL: COUNTY COMANCHE  
 LEASE GILLET 1320 feet from south/north line of section  
 WELL NUMBER 1 1320 feet from east/west line of section  
 FIELD COLTER WEST SECTION 34 TWP 32S RG 19W

NUMBER OF ACRES ATTRIBUTABLE TO WELL \_\_\_\_\_ IS SECTION X REGULAR or \_\_\_\_\_ IRREGULAR  
 QTR/QTR/QTR OF ACREAGE \_\_\_\_\_ IF SECTION IS IRREGULAR, LOCATE WELL FROM NEAREST  
CORNER BOUNDARY.

Section corner used: \_\_\_\_\_ NE \_\_\_\_\_ NW \_\_\_\_\_ SE \_\_\_\_\_ SW

**PLAT**

(Show location of the well and shade attributable acreage for prorated or spaced wells.)  
 (Show footage to the nearest lease or unit boundary line.)

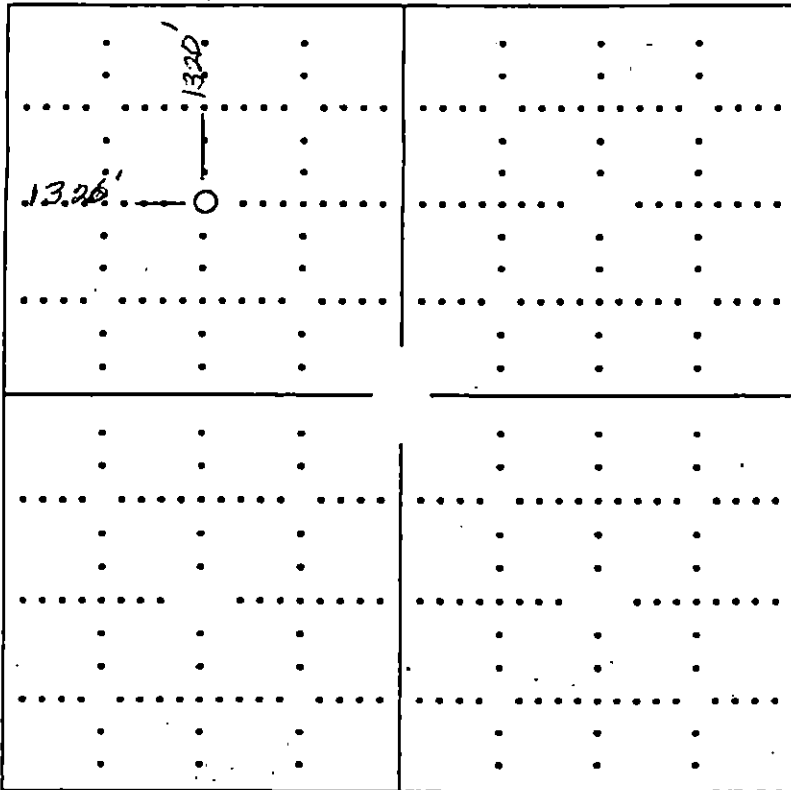

**RECEIVED**  
 KANSAS CORPORATION COMMISSION

APR 01 1997

CONSERVATION DIVISION  
 WICHITA, KS

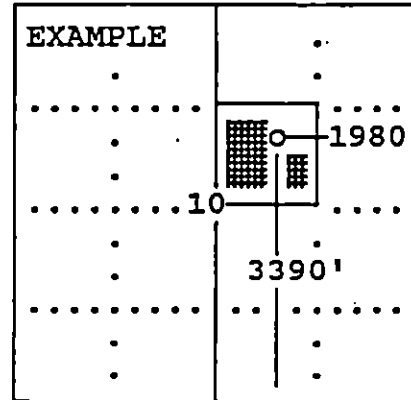

SEWARD CO.

**In plotting the proposed location of the well, you must show:**

- 1) The manner in which you are using the depicted plat by identifying section lines, i.e. 1 section, 1 section with 8 surrounding sections, 4 sections, etc.;
- 2) the distance of the proposed drilling location from the section's south/north and east/west; and
- 3) the distance to the nearest lease or unit boundary line.