

FOR KCC USE:

FORM C-1 7/91

FORM MUST BE TYPED

EFFECTIVE DATE: 10-14-97
DISTRICT # 1
SCA7 X Yes... No

State of Kansas
NOTICE OF INTENTION TO DRILL

FORM MUST BE SIGNED
ALL BLANKS MUST BE FILLED

Must be approved by the K.C.C. five (5) days prior to commencing well.

Expected Spud Date October 10, 1997
month day year

Spot 30'S & 100'W of
SW NE SW Sec 33 Twp 32S S, Rg 18W East West

OPERATOR: License # 3869
Name: IMPERIAL OIL PROPERTIES, INC.
Address: 212 North Market - Suite 513
City/State/Zip: Wichita, Kansas 67202-2013
Contact Person: Bob Williams
Phone: 316/265-6977

1620 feet from South / North line of Section
4440 1550 feet from East / West line of Section
IS SECTION S REGULAR IRREGULAR

CONTRACTOR: License # 59290
Name: DUKE DRILLING CO., INC.

(NOTE: Locate well on the Section Plat on Reverse Side)
County: Comanche
Lease Name: BREMER "A" Well #: 33-1
Field Name: Wildcat
Is this a Prorated/Spaced Field? yes X no
Target Formation(s): Miss. Viola
Nearest lease or unit boundary: 1550'
Ground Surface Elevation: 2088' feet MSL
Water well within one-quarter mile: X yes no
Public water supply well within one mile: yes X no
Depth to bottom of fresh water: 140'
Depth to bottom of usable water: 260' 240'
Surface Pipe by Alternate: X 1 2
Length of Surface Pipe Planned to be set: 575'
Length of Conductor pipe required: 60' (NONE)
Projected Total Depth: 6250'
Formation at Total Depth: Arbuckle
Water Source for Drilling Operations:
X well no farm pond no other

Well Drilled For: Well Class: Type Equipment:
Oil Enh Rec Infield X Mud Rotary
X Gas Storage Pool Ext. Air Rotary
OWWO Disposal X Wildcat Cable
Seismic; # of Holes Other
If OWWO: old well information as follows:
Operator:
Well Name:
Comp. Date: Old Total Depth

Directional, Deviated or Horizontal wellbore? yes X no
If yes, true vertical depth:
Bottom Hole Location:

Will Cores Be Taken? no
If yes, proposed zone:

APPLY FOR FROM DWR

AFFIDAVIT

The undersigned hereby affirms that the drilling, completion and eventual plugging of this well will comply with K.S.A. 55-101, et. seq.
It is agreed that the following minimum requirements will be met:

1. Notify the appropriate district office prior to spudding of well;
2. A copy of the approved notice of intent to drill shall be posted on each drilling rig;
3. The minimum amount of surface pipe as specified below shall be set by circulating cement to the top; in all cases surface pipe shall be set through all unconsolidated materials plus a minimum of 20 feet into the underlying formation;
4. If the well is dry hole, an agreement between the operator and the district office on plug length and placement is necessary prior to plugging;
5. The appropriate district office will be notified before well is either plugged or production casing is cemented in;
6. IF AN ALTERNATE II COMPLETION, PRODUCTION PIPE SHALL BE CEMENTED FROM BELOW ANY USABLE WATER TO SURFACE WITHIN 120 DAYS OF SPUD DATE. IN ALL CASES, NOTIFY DISTRICT OFFICE PRIOR TO ANY CEMENTING.

I hereby certify that the statements made herein are true and to the best of my knowledge and belief.

Date: October 2, 1997 Signature of Operator or Agent: [Signature] Title: Agent

FOR KCC USE:
API # 15- 033-209440000
Conductor pipe requires NONE feet
Minimum surface pipe required 260 feet per Alt. (1)X
Approved by: JK 10-9-97
This authorization expires: 4-9-98
(This authorization void if drilling not started within 6 months of effective date.)
Spud date: Agent:

RECEIVED
KANSAS CORP COMM
1997 OCT - 3 P 12:41
33 32 18W

10-03-1997

- REMEMBER TO:
- File Drill Pit Application (form CDP-1) with Intent to Drill;
 - File Completion Form ACD-1 within 120 days of spud date;
 - File acreage attribution plat according to field proration orders;
 - Notify appropriate district office 48 hours prior to workover or re-entry;
 - Submit plugging report (CP-4) after plugging is completed;
 - Obtain written approval before disposing or injecting salt water.

Mail to: KCC - Conservation Division, 130 S. Market - Room 2073, Wichita, Kansas 67202.

IN ALL CASES PLOT THE INTENDED WELL ON THE PLAT BELOW

PLAT OF ACREAGE ATTRIBUTABLE TO A WELL IN A PRORATED OR SPACED FIELD

If the intended well is in a prorated or spaced field, please fully complete this side of the form. If the intended well is in a prorated or spaced field complete the plat below showing that the well will be properly located in relationship to other wells producing from the common source of supply. Please show all the wells within 1 mile of the boundaries of the proposed acreage attribution unit for gas wells and within 1/2 mile of the boundaries of the proposed acreage attribution unit for oil wells.

API NO. 15- _____
 OPERATOR _____ LOCATION OF WELL: COUNTY _____
 LEASE _____ feet from south/north line of section
 WELL NUMBER _____ feet from east/west line of section
 FIELD _____ SECTION _____ TWP _____ RG _____

NUMBER OF ACRES ATTRIBUTABLE TO WELL _____ IS SECTION _____ REGULAR or _____ IRREGULAR
 STR/OTR/OTR OF ACREAGE _____ IF SECTION IS IRREGULAR, LOCATE WELL FROM NEAREST
 CORNER BOUNDARY.

Section corner used: _____ NE _____ NW _____ SE _____ SW

PLAT

(Show location of the well and shade attributable acreage for prorated or spaced wells.)
 (Show footage to the nearest lease or unit boundary line.)

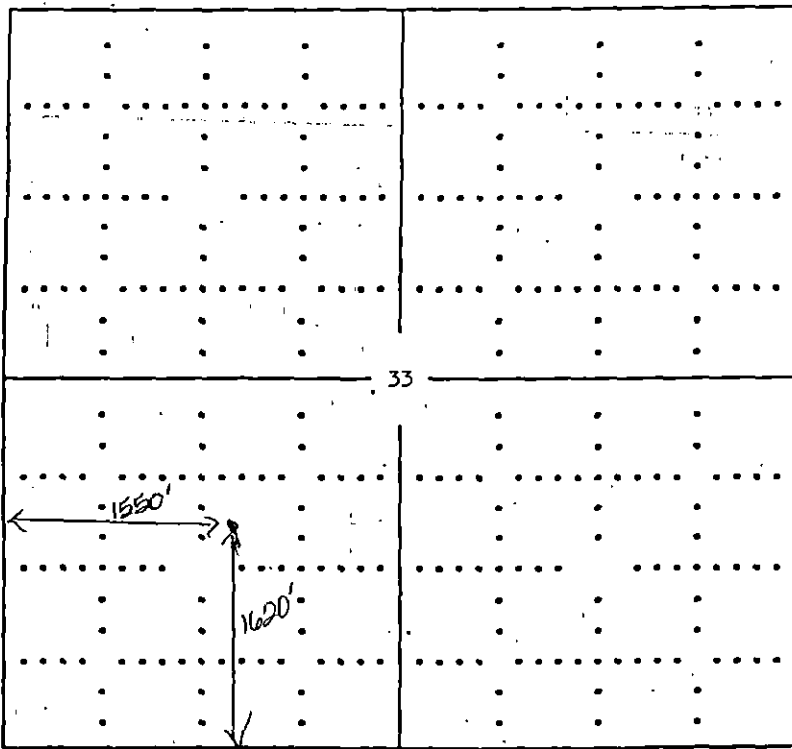

COMANCHE COUNTY

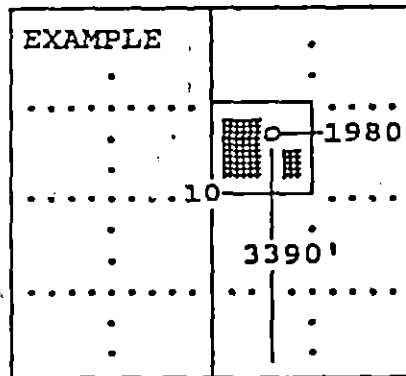

SEWARD CO.

In plotting the proposed location of the well, you must show:

- 1) The manner in which you are using the depicted plat by identifying section lines, i.e. 1 section, 1 section with 8 surrounding sections, 4 sections, etc.;
- 2) the distance of the proposed drilling location from the section's south/north and east/west; and
- 3) the distance to the nearest lease or unit boundary line.