

EFFECTIVE DATE: 5-21-97

State of Kansas

DISTRICT # 1

NOTICE OF INTENTION TO DRILL

SGA? Yes No

Must be approved by the K.C.C. five (5) days prior to commencing well.

Spot ~~150' S of~~ 85' N & 80' E of NE NE East

Expected Spud Date .. 05 .. 15 .. 97 ..
month day year

~~NE 1/4 NE 1/4 NE 1/4~~ Sec ..29. Twp ..32. S, Rg ..18.. West

OPERATOR: License #4243.....
Name: .CROSS BAR PETROLEUM, INC.
Address:151 N. MAIN, SUITE 630.....
City/State/Zip: ...WICHITA, KS 67202-1407.....
Contact Person: ...ALBERT BRENSING

575 feet from XXXXX / (North) line of Section
330 feet from (East) / xxxxx line of Section
IS SECTION REGULAR IRREGULAR?

(NOTE: Locate well on the Section Plat on Reverse Side)

CONTRACTOR: License #: ... 5929

County: COMANCHE

Name: DUKE DRILLING COMPANY, INC.....

Lease Name: BUNNELL Well #:1-29.....

Well Drilled For: Well Class: Type Equipment:

Field Name: .. NESCATUNGA.....

- Oil ... Enh Rec ... Infield Mud Rotary
- Gas ... Storage Pool Ext. ... Air Rotary
- OWWO ... Disposal ... Wildcat ... Cable
- Seismic; ... # of Holes ... Other
- Other

Is this a Prorated/Spaced Field? yes no

If OWWO: old well information as follows:

Target Formation(s):VIOLA

Operator:
Well Name:
Comp. Date: Old Total Depth

Nearest lease or unit boundary:330'.....

Ground Surface Elevation: ...EST. 2120 feet MSL

Water well within one-quarter mile: ... yes no

Public water supply well within one mile: yes no

Depth to bottom of fresh water:320' 220'.....

Depth to bottom of usable water:320'.....

* Surface Pipe by Alternate: 1 2

Length of Surface Pipe Planned to be set: 525'.....

Length of Conductor pipe required:N/A.....

Projected Total Depth:5900'.....

Formation at Total Depth:VIOLA.....

Water Source for Drilling Operations:

..... well farm pond other

Directional, Deviated or Horizontal wellbore? yes no

Will Cores Be Taken?: yes no

If yes, true vertical depth:.....

If yes, proposed zone:

Bottom Hole Location.....

* ALT 1 ONLY

AFFIDAVIT

The undersigned hereby affirms that the drilling, completion and eventual plugging of this well will comply with K.S.A. 55-101, et. seq.

It is agreed that the following minimum requirements will be met:

1. Notify the appropriate district office prior to spudding of well;
2. A copy of the approved notice of intent to drill shall be posted on each drilling rig;
3. The minimum amount of surface pipe as specified below shall be set by circulating cement to the top; in all cases surface pipe shall be set through all unconsolidated materials plus a minimum of 20 feet into the underlying formation;
4. If the well is dry hole, an agreement between the operator and the district office on plug length and placement is necessary prior to plugging;
5. The appropriate district office will be notified before well is either plugged or production casing is cemented in;
6. IF AN ALTERNATE II COMPLETION, PRODUCTION PIPE SHALL BE CEMENTED FROM BELOW ANY USABLE WATER TO SURFACE WITHIN 120 DAYS OF SPUD DATE. IN ALL CASES, NOTIFY DISTRICT OFFICE PRIOR TO ANY CEMENTING.

I hereby certify that the statements made herein are true and to the best of my knowledge and belief.

Date:05-07-97 Signature of Operator or Agent: *Albert Brensing* Title..PRESIDENT.....

FOR KCC USE:
 API # 15- 033-709340000
 Conductor pipe required NONE feet
 Minimum surface pipe required 340 feet per Alt. 1
 Approved by: JK 5-16-97
 This authorization expires: 11-16-97
 (This authorization void if drilling not started within 6 months of effective date.)
 Spud date: _____ Agent: _____

05-08-1997
RECEIVED
KANSAS CONSERVATION DIVISION
MAY - 8 1997
37
32
1832

REMEMBER TO:

- File Drill Pit Application (form CDP-1) with Intent to Drill;
- File Completion Form ACO-1 within 120 days of spud date;
- File acreage attribution plat according to field proration orders;
- Notify appropriate district office 48 hours prior to workover or re-entry;
- Submit plugging report (CP-4) after plugging is completed;
- Obtain written approval before disposing or injecting salt water.

Mail to: KCC - Conservation Division, 130 S. Market - Room 2078, Wichita, Kansas 67202.

IN ALL CASES PLOT THE INTENDED WELL ON THE PLAT BELOW

PLAT OF ACREAGE ATTRIBUTABLE TO A WELL IN A PRORATED OR SPACED FIELD

If the intended well is in a prorated or spaced field, please fully complete this side of the form. If the intended well is in a prorated or spaced field complete the plat below showing that the well will be properly located in relationship to other wells producing from the common source of supply. Please show all the wells within 1 mile of the boundaries of the proposed acreage attribution unit for gas wells and within 1/2 mile of the boundaries of the proposed acreage attribution unit for oil wells.

API NO. 15- _____
 OPERATOR: CROSS BAR PETROLEUM, INC.
 LOCATION OF WELL: COUNTY COMANCHE
 LEASE BUNNELL _____ 330 feet from XXXXX/north line of section
 WELL NUMBER #1-29 _____ 330 feet from east/xxxx line of section
 FIELD NESCATUNGA _____ SECTION 29 TWP 32S RG 18W

NUMBER OF ACRES ATTRIBUTABLE TO WELL 160 IS SECTION X REGULAR or _____ IRREGULAR
 QTR/QTR/QTR OF ACREAGE _____ **IF SECTION IS IRREGULAR, LOCATE WELL FROM NEAREST CORNER BOUNDARY.**
 Section corner used: x NE _____ NW _____ SE _____ SW

PLAT

(Show location of the well and shade attributable acreage for prorated or spaced wells.)
 (Show footage to the nearest lease or unit boundary line.)

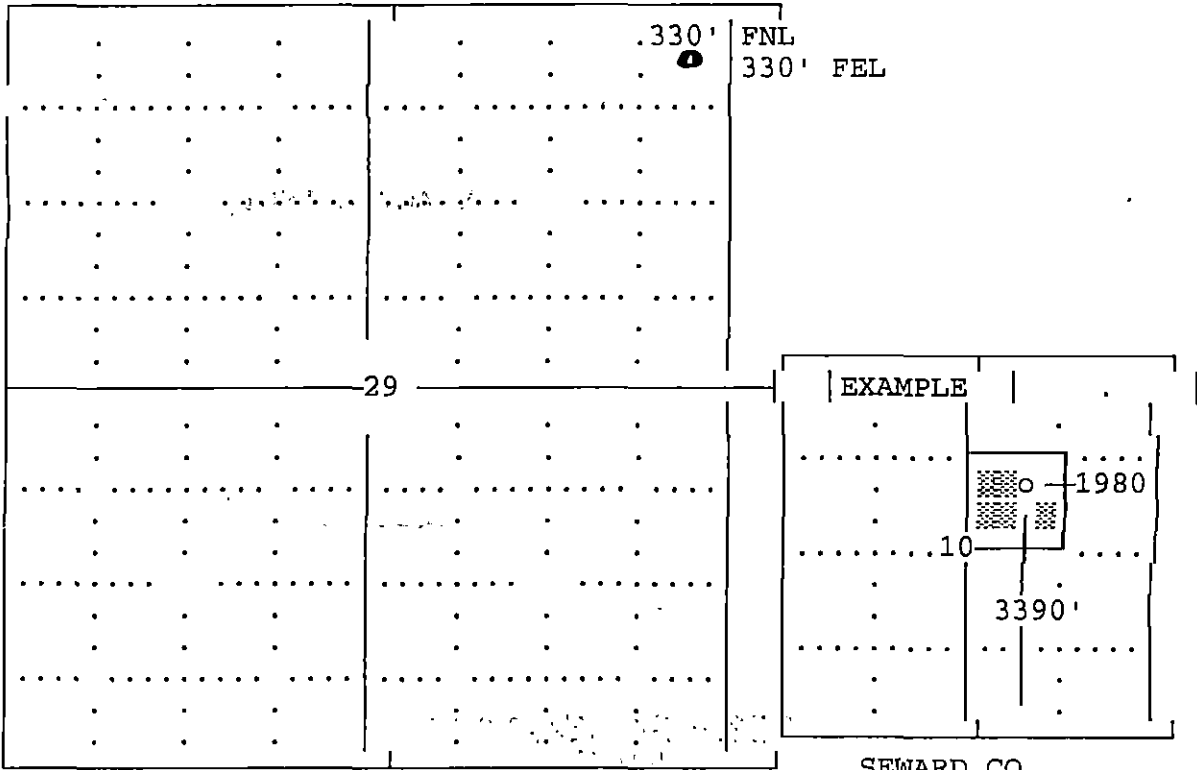

T32S-R18W, COMANCHE CO., KS

In plotting the proposed location of the well, you must show:

- 1) The manner in which you are using the depicted plat by identifying section lines, i.e. 1 section, 1 section with 8 surrounding sections, 4 sections, etc.;
- 2) the distance of the proposed drilling location from the section's south/north and east/west; and
- 3) the distance to the nearest lease or unit boundary line.

FOR KCC USE:

CORRECTED

FORM C-1 7/91

EFFECTIVE DATE: 5-21-97

State of Kansas

FORM MUST BE TYPED

DISTRICT # 1

NOTICE OF INTENTION TO DRILL

FORM MUST BE SIGNED

SGA? X Yes No

Must be approved by the K.C.C. five (5) days prior to commencing well.

ALL BLANKS MUST BE FILLED

Spot

Expected Spud Date .. 04 .. 18 .. 97 .. month day year

85' N & 80' E of NE NE Sec .29. Twp ..32. S, Rg .18. East X West

OPERATOR: License # 4243

Name: CROSS BAR PETROLEUM, INC.

Address: 151 N. MAIN, SUITE 630

City/State/Zip: WICHITA, KS 67202-1407

Contact Person: ALBERT BRENSING

Phone: 316-265-2279

575 feet from XXXX North line of Section 580 feet from East XXXX line of Section IS SECTION X REGULAR IRREGULAR?

(NOTE: Locate well on the Section Plat on Reverse Side)

County: COMANCHE

Lease Name: BUNNELL Well #: 1-29

Field Name: NESCATUNGA

Is this a Prorated/Spaced Field? yes X no

Target Formation(s): VIOLA

Nearest lease or unit boundary: 330' 575'

Ground Surface Elevation: 2132 feet MSL

Water well within one-quarter mile: yes X no

Public water supply well within one mile: yes X no

Depth to bottom of fresh water: 220'

Depth to bottom of usable water: 320'

* Surface Pipe by Alternate: X 1 2

Length of Surface Pipe Planned to be set: 525'

Length of Conductor pipe required: N/A

Projected Total Depth: 5900'

Formation at Total Depth: VIOLA

Water Source for Drilling Operations:

well farm pond X other

Well Drilled For: Well Class: Type Equipment:

X Oil Enh Rec Infield X Mud Rotary

X Gas Storage X Pool Ext. Air Rotary

OWWO Disposal Wildcat Cable

Seismic; # of Holes Other

Other

If OWWO: old well information as follows:

Operator:

Well Name:

Comp. Date: Old Total Depth

Directional, Deviated or Horizontal wellbore? yes X no

If yes, true vertical depth:

Bottom Hole Location:

Will Cores Be Taken?: yes X no

If yes, proposed zone:

* Alt 1 only. * WAS: 480' FNL 330' FEL

KS: 575' FNL 580' FEL

AFFIDAVIT

The undersigned hereby affirms that the drilling, completion and eventual plugging of this well will comply with K.S.A. 55-101, et. seq.

It is agreed that the following minimum requirements will be met:

* SPOT WAS: 150'S OF NE NE NE

SPOT IS: 85' N & 80' E OF NE NE

- 1. Notify the appropriate district office prior to spudding of well;
2. A copy of the approved notice of intent to drill shall be posted on each drilling rig;
3. The minimum amount of surface pipe as specified below shall be set by circulating cement to the top; in all cases surface pipe shall be set through all unconsolidated materials plus a minimum of 20 feet into the underlying formation;
4. If the well is dry hole, an agreement between the operator and the district office on plug length and placement is necessary prior to plugging;
5. The appropriate district office will be notified before well is either plugged or production casing is cemented in;
6. IF AN ALTERNATE II COMPLETION, PRODUCTION PIPE SHALL BE CEMENTED FROM BELOW ANY USABLE WATER TO SURFACE WITHIN 120 DAYS OF SPUD DATE. IN ALL CASES, NOTIFY DISTRICT OFFICE PRIOR TO ANY CEMENTING.

I hereby certify that the statements made herein are true and to the best of my knowledge and belief.

Date: 05-19-97 Signature of Operator or Agent: Julie Thompson Title: LAND & PRODUCTION ADMIN.

FOR KCC USE:
API # 15-033-209340000
Conductor pipe required None feet
Minimum surface pipe required 340 feet per Alt. 1 X
Approved by: JK 5-16-97 / COR S-22-97
This authorization expires: 11-16-97
(This authorization void if drilling not started within 6 months of effective date.)
Spud date: Agent:

REMEMBER TO:

- File Drill Pit Application (form CDP-1) with Intent to Drill;
- File Completion Form ACO-1 within 120 days of spud date;
- File acreage attribution plat according to field proration orders;
- Notify appropriate district office 48 hours prior to workover or re-entry;
- Submit plugging report (CP-4) after plugging is completed;
- Obtain written approval before disposing or injecting salt water.

Mail to: KCC - Conservation Division, 130 S. Market - Room 2078, Wichita, Kansas 67202.

Handwritten notes and stamps on the right side of the page, including '29 32 18W' and a circular stamp.

IN ALL CASES PLOT THE INTENDED WELL ON THE PLAT BELOW

PLAT OF ACREAGE ATTRIBUTABLE TO A WELL IN A PRORATED OR SPACED FIELD

If the intended well is in a prorated or spaced field, please fully complete this side of the form. If the intended well is in a prorated or spaced field complete the plat below showing that the well will be properly located in relationship to other wells producing from the common source of supply. Please show all the wells within 1 mile of the boundaries of the proposed acreage attribution unit for gas wells and within 1/2 mile of the boundaries of the proposed acreage attribution unit for oil wells.

API NO. 15- _____
OPERATOR: CROSS BAR PETROLEUM, INC./DUNNE EQUITIES, INC.
LOCATION OF WELL: COUNTY _____ COMANCHE _____
LEASE _____ BUNNELL _____ 575 feet from XXXXX/north line of section
WELL NUMBER #1-29 _____ 580 feet from east/xxxx line of section
FIELD _____ WILDCAT _____ SECTION 29 TWP 32S RG 18W

NUMBER OF ACRES ATTRIBUTABLE TO WELL 160 IS SECTION X REGULAR or IRREGULAR
QTR/QTR/QTR OF ACREAGE - - - IF SECTION IS IRREGULAR, LOCATE WELL FROM NEAREST CORNER BOUNDARY.

Section corner used: NE NW SE SW

PLAT

(Show location of the well and shade attributable acreage for prorated or spaced wells.)
(Show footage to the nearest lease or unit boundary line.)

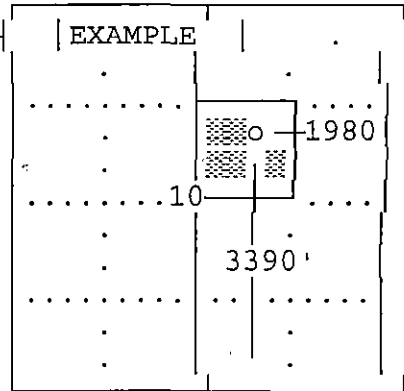
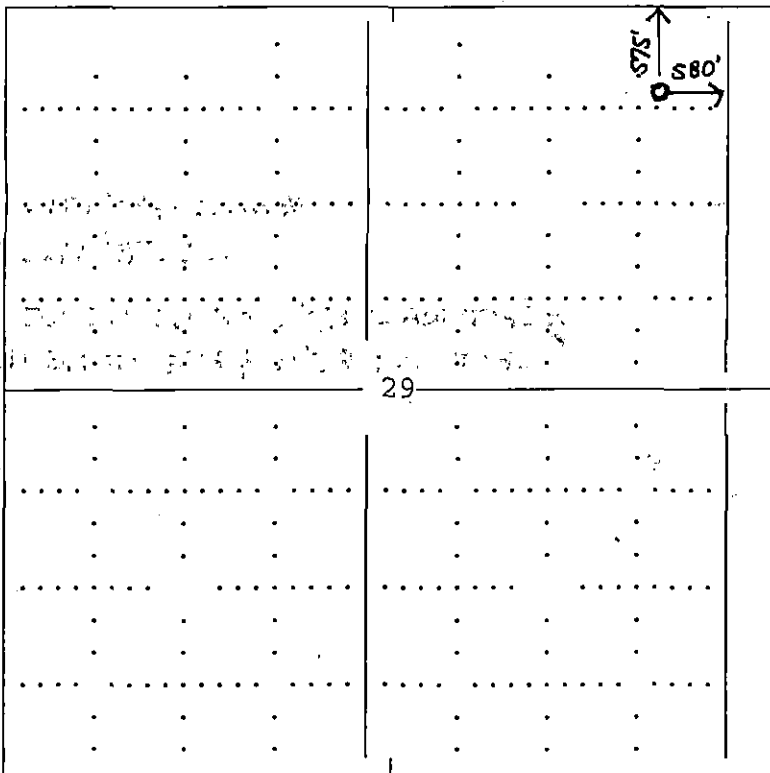

SEWARD CO.

T32S-R18W, COMANCHE CO., KS

In plotting the proposed location of the well, you must show:

- 1) The manner in which you are using the depicted plat by identifying section lines, i.e. 1 section, 1 section with 8 surrounding sections, 4 sections, etc.;
- 2) the distance of the proposed drilling location from the section's south/north and east/west; and
- 3) the distance to the nearest lease or unit boundary line.