

FOR KCC USE:

FORM C-1 7/91

EFFECTIVE DATE: 10-17-98

FORM MUST BE TYPED

DISTRICT # 1

State of Kansas

FORM MUST BE SIGNED

35A7 X Yes No

NOTICE OF INTENTION TO DRILL

ALL BLANKS MUST BE FILLED

Must be approved by the K.C.C. five (5) days prior to commencing well

Expected Spud Date October 12, 1998 Spec 200'S. of C-SW - NW. Sec. 29. Twp. 32S. Rg. 19W. East West

OPERATOR: License # 4058 Name: AMERICAN WARRIOR, INC. Address: P.O. Box 399 City/State/Zip: Garden City, Kansas 67824-0399 Contact Person: Cecil O. Brate Phone: 316/275-9231

CONTRACTOR: License # 5929 Name: DUKE DRILLING CO., INC.

Well Drilled For: Well Class: Type Equipment: X Oil ... Enh Rec X Infield X Mud Rotary X Gas ... Storage ... Pool Ext. ... Air Rotary ... OAWO ... Disposal ... Wildcat ... Cable ... Seismic: ... # of Holes ... Other

If OAWO: old well information as follows: Operator: Well Name: Comp. Date: Old Total Depth

Directional, Deviated or Horizontal wellbore? yes X no If yes, true vertical depth: Bottom Hole Location:

2180 feet from Section North line of Section 660 feet from Section West line of Section IS SECTION X REGULAR IRREGULAR (NOTE: Locate well on the Section Plat on Reverse Side) County: Comanche Lease Name: KERSTETTER Well #: 1-29 Field Name: Is this a Propped/Spaced Field? yes X no Target Formation(s): Arbuckle Nearest lease or unit boundary: 660' Ground Surface Elevation: 1925' est. feet MSL Water well within one-quarter mile: yes X no Public water supply well within one mile: yes X no Depth to bottom of fresh water: 100' Depth to bottom of usable water: 180' Surface Pipe by Alternate: X 1 2 Length of Surface Pipe Planned to be set: 600' Length of Conductor pipe required: N/A Projected Total Depth: 6400' Formation at Total Depth: Arbuckle Water Source for Drilling Operations: well X farm pond other DWR Permit #: Will Cores Be Taken? yes X no If yes, proposed zone:

AFFIDAVIT

The undersigned hereby affirms that the drilling, completion and eventual plugging of this well will comply with K.S.A. 55-101, et. seq. It is agreed that the following minimum requirements will be met:

- 1. Notify the appropriate district office prior to spudding of well;
2. A copy of the approved notice of intent to drill shall be posted on each drilling rig;
3. The minimum amount of surface pipe as specified below shall be set by circulating cement to the top; in all cases surface pipe shall be set through all unconsolidated materials plus a minimum of 20 feet into the underlying formation;
4. If the well is dry hole, an agreement between the operator and the district office on plug length and placement is necessary prior to plugging;
5. The appropriate district office will be notified before well is either plugged or production casing is cemented in;
6. IF AN ALTERNATE II COMPLETION, PRODUCTION PIPE SHALL BE CEMENTED FROM BELOW ANY USABLE WATER TO SURFACE WITHIN 120 DAYS OF SPUD DATE. IN ALL CASES, NOTIFY DISTRICT OFFICE PRIOR TO ANY CEMENTING.

I hereby certify that the statements made herein are true and to the best of my knowledge and belief. Date: 10/9/98 Signature of Operator or Agent: Kelly S. Byers Title: Agent

FOR KCC USE: API # 15- 033-209760000 Conductor pipe required NONE feet Minimum surface pipe required 200 feet per Alt. (1) X Approved by: JK 10-12-98 This authorization expires: 4-12-99 (This authorization void if drilling not started within 6 months of effective date.) Spud date: Agent:

RECEIVED KANSAS CORPORATION COMMISSION OCT 09 1998 10-9-98 CONSERVATION DIVISION WICHITA, KS

REMEMBER TO:

- File Drill Pit Application (form CDP-1) with Intent to Drill;
- File Completion Form ACO-1 within 120 days of spud date;
- File acreage attribution plat according to field proration orders;
- Notify appropriate district office 48 hours prior to workover or re-entry;
- Submit plugging report (CP-4) after plugging is completed;
- Obtain written approval before disposing or injecting salt water.

Mail to: Conservation Division, 200 Colorado Derby Building, 202 W. First St., Wichita, Kansas 67202-1284.

19W

IN ALL CASES PLOT THE INTENDED WELL ON THE PLAT BELOW

**PLAT OF ACREAGE ATTRIBUTABLE TO A WELL IN A PRORATED OR SPACED FIELD**

If the intended well is in a prorated or spaced field, please fully complete this side of the form. If the intended well is in a prorated or spaced field complete the plat below showing that the well will be properly located in relationship to other wells producing from the common source of supply. Please show all the wells within 1 mile of the boundaries of the proposed acreage attribution unit for gas wells and within 1/2 mile of the boundaries of the proposed acreage attribution unit for oil wells.

API NO. 15- \_\_\_\_\_  
 OPERATOR \_\_\_\_\_  
 LEASE \_\_\_\_\_  
 WELL NUMBER \_\_\_\_\_  
 FIELD \_\_\_\_\_

LOCATION OF WELL: COUNTY \_\_\_\_\_  
 \_\_\_\_\_ feet from south/north line of section  
 \_\_\_\_\_ feet from east/west line of section  
 SECTION \_\_\_\_\_ TWP \_\_\_\_\_ RG \_\_\_\_\_

NUMBER OF ACRES ATTRIBUTABLE TO WELL \_\_\_\_\_  
 QTR/QTR/QTR OF ACREAGE \_\_\_\_\_

IS SECTION \_\_\_\_\_ REGULAR or \_\_\_\_\_ IRREGULAR  
IF SECTION IS IRREGULAR, LOCATE WELL FROM NEAREST CORNER BOUNDARY.

Section corner used: \_\_\_\_\_ NE \_\_\_\_\_ NW \_\_\_\_\_ SE \_\_\_\_\_ SW  
PLAT

(Show location of the well and shade attributable acreage for prorated or spaced wells.)  
 (Show footage to the nearest lease or unit boundary line.)

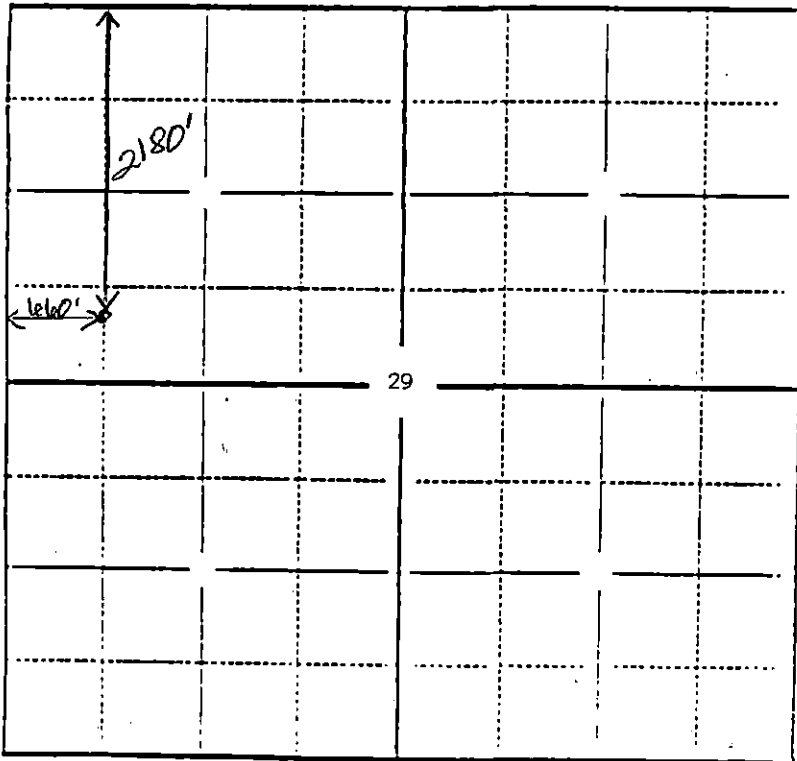

COMANCHE COUNTY

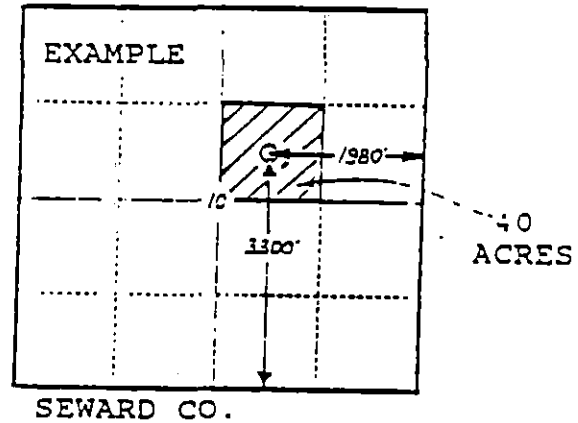

In plotting the proposed location of the well, you must show:

- 1) The manner in which you are using the depicted plat by identifying section lines, i.e. 1 section, 1 section with 8 surrounding sections, 4 sections, etc.;
- 2) the distance of the proposed drilling location from the section's south/north and east/west lines; and
- 3) the distance to the nearest lease or unit boundary line.