

For KCC Use:
 Effective Date: 7-27-2002
 District #: 1
 SGA? Yes No

KANSAS CORPORATION COMMISSION
 OIL & GAS CONSERVATION DIVISION
NOTICE OF INTENT TO DRILL

Must be approved by KCC five (5) days prior to commencing well

RECEIVED
 07-19-2002
 JUL 19 2002
 KCC WICHITA

Form C-1
 September, 1999
 Form must be Typed
 Form must be Signed
 All blanks must be filled

Expected Spud Date: 7 / 28 / 2002
month day year

Spot NE NE SW East West
 Sec 22 Twp 32S Rng 18W

OPERATOR: License# 5050
 Name: Hummon Corporation
 Address: 950 N. Tyler
 City/State/Zip: Wichita, Kansas 67212
 Contact Person: Wendy Wilson
 Phone: 316-773-2300

2310' fsl _____ feet from S (circle one) Line of Section
 2310' fwl _____ feet from W (circle one) Line of Section
 Is SECTION XX Regular Irregular?

CONTRACTOR: License# 5929
 Name: Duke Drilling Rig #4

County: Comanche
 Lease Name: Beeley Well # _____
 Field Name: Nescatunga

Is this a Prorated / Spaced Field? Yes No

Target Formation(s): Viola
 Nearest Lease or unit boundary: ~~2910'~~ 330'

Ground Surface Elevation: 2047' feet MSL

Water well within one-quarter mile: Yes No
 Public water supply well within one mile: Yes No

Depth to bottom of fresh water: 120'
 Depth to bottom of usable water: 180'

Surface Pipe by Alternate: X 1 2
 Length of Surface Pipe Planned to be set: 830'

Length of Conductor Pipe required: NONE
 Projected Total Depth: 5700'
 Formation at Total Depth: Viola

Water Source for Drilling Operations:

Well XX Farm Pond Other _____

DWR Permit #: _____

(Note: Apply for Permit with DWR)

Will Cores be taken? Yes No
 If Yes, proposed zone: _____

Well Drilled For: Well Class: Type Equipment:
 Oil Enh Rec Infield Mud Rotary
 Gas Storage Pool Ext Air Rotary
 OWWO Disposal Wildcat Cable
 Seismic; # of Holes Other
 Other

If OWWO: old well information as follows:

Operator: _____
 Well Name: _____
 Original Completion Date: _____ Original Total Depth: _____

Directional, Deviated or Horizontal wellbore? Yes No

If Yes, true vertical depth: _____

Bottom Hole Location: _____

KCC DKT #: _____

AFFIDAVIT

The undersigned hereby affirms that the drilling, completion and eventual plugging of this well will comply with K.S.A. 55-101, et. seq.

It is agreed that the following minimum requirements will be met:

1. Notify the appropriate district office **prior** to spudding of well;
2. A copy of the approved notice of intent to drill **shall be** posted on each drilling rig;
3. The minimum amount of surface pipe as specified below shall be set by circulating cement to the top; in all cases surface pipe **shall be set** through all unconsolidated materials plus a minimum of 20 feet into the underlying formation.
4. If the well is dry hole, an agreement between the operator and the district office on plug length and placement is necessary **prior to plugging**;
5. The appropriate district office will be notified before well is either plugged or production casing is cemented in;
6. If an ALTERNATE II COMPLETION, production pipe shall be cemented from below any usable water to surface within **120 days** of spud date. **In all cases, NOTIFY district office** prior to any cementing.

I hereby certify that the statements made herein are true and to the best of my knowledge and belief.

Date: 7/18/02 Signature of Operator or Agent Wendy Wilson Title: Prod. Manager Agent

For KCC Use ONLY

API # 15 - Conductor 15.033-21325-00.00
 Conductor pipe required NONE feet
 Minimum surface pipe required 200 feet per Alt. 1
 Approved by: RJP 7-22-2002
 This authorization expires: 1-22-2003
 (This authorization void if drilling not started within 6 months of effective date.)
 Spud date: Agent: _____

Remember to:

- File Drill Pit Application (form CDP-1) with Intent to Drill;
- File Completion Form ACO-1 within 120 days of spud date;
- File acreage attribution plat according to field proration orders;
- Notify appropriate district office 48 hours prior to workover or re-entry;
- Submit plugging report (CP-4) after plugging is completed;
- Obtain written approval before disposing or injecting salt water.

22
32
183

IN ALL CASES PLOT THE INTENDED WELL ON THE PLAT BELOW

Plat of acreage attributable to a well in a prorated or spaced field

RECEIVED
JUL 19 2000
KCC WICHITA

If the intended well is a prorated or spaced field, please fully complete this side of the form. If the intended well is in a prorated or spaced field complete the plat below showing that the well will be properly located in relationship to other wells producing from the common source of supply. Please show all the wells and within 1 mile of the boundaries of the proposed acreage attribution unit for gas wells and within 1/2 mile of the boundaries of the proposed acreage attribution unit for oil wells.

API No. 15- _____
 Operator Hummon Corporation
 Lease Beeley
 Well Number: 0
 Field: Nescatunga
 Number of Acres attributable to well: _____
 QTR / QTR / QTR of acreage: ApC - NE - SW

Location of Well: County: Comanche
 2310' fsl _____ feet from S / N (circle one) Line of Section
 2310' fwl _____ feet from E / W (circle one) Line of Section
 Sec. 22 Twp. 32S 18W East West
 Is Section Regular or Irregular
 If Section is Irregular, locate well from nearest corner boundary.
 Section corner used: _____ NE _____ NW _____ SE _____ SW

PLAT

(Show location of the well and shade attributable acreage for prorated or spaced wells.)
 (Show footage to the nearest lease or unit boundary line.)

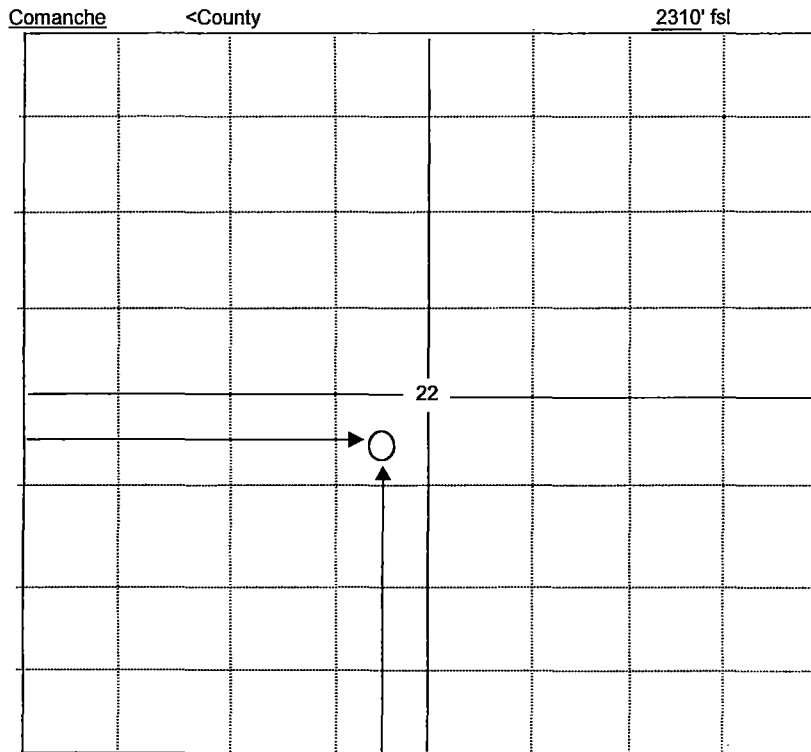

NOTE: In all cases locate the spot of the proposed drilling locaton.

2310' fwl

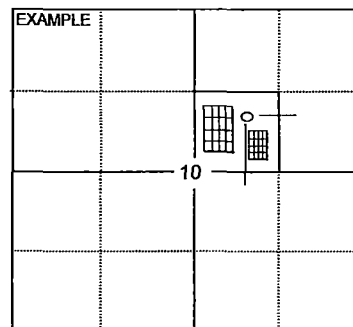

SEWARD CO.

In plotting the proposed location of the well, you must show:

1. The manner in which you are using the depicted plat by identifying section lines, i.e. 1 section, 1 section with 8 surrounding sections, 4 sections, etc.
2. The distance of the proposed drilling location from the section's south / north and east / west.
3. The distance to the nearest lease or unit boundary line.
4. If proposed location is located within a prorated or spaced field a certificate of acreage attribution plat must be attached: (C0-7 for oil wells; CG-8 for gas wells).