

STATE OF KANSAS
STATE CORPORATION COMMISSION

All Information Completely
Make Required Affidavit
Mail or Deliver Report to:
Conservation Division
State Corporation Commission
800 Bitting Building
Wichita, Kansas

WELL PLUGGING RECORD

NORTH

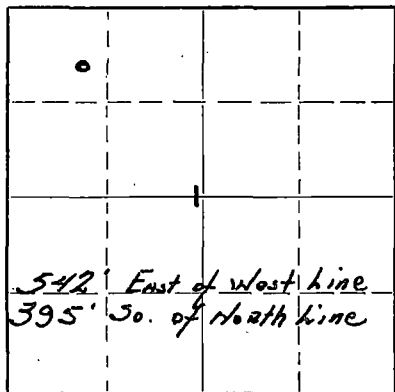

Locate well correctly on above
Section Plat

COMANCHE

County. Sec. 1

Twp. 32

Rge. 20

(X)

(W)

Location as "NE/CNW/SW" or footage from lines

NW/NW/NW 542' E & 395' S NW/c

Lease Owner J. M. HUBER CORPORATION

Lease Name ELLIS

Well No. 1

Office Address 302 PETROLEUM BLDG., WICHITA, KANSAS

Character of Well (completed as Oil, Gas or Dry Hole) DRY HOLE

Date well completed DEC. 31, 19 52

Application for plugging filed DEC. 31, 19 52

Application for plugging approved DEC. 31, 19 52

Plugging commenced 3:00 A.M., JANUARY 1, 19 53

Plugging completed 7:00 A.M., JANUARY 1, 19 53

Reason for abandonment of well or producing formation DRY HOLE

If a producing well is abandoned, date of last production 19

Was permission obtained from the Conservation Division or its agents before plugging was commenced? YES

Name of Conservation Agent who supervised plugging of this well M. A. RIVES, PRATT, KANSAS

Producing formation Depth to top Bottom Total Depth of Well 5240 Feet

Show depth and thickness of all water, oil and gas formations.

OIL, GAS OR WATER RECORDS

CASING RECORD

FORMATION	CONTENT	FROM	TO	SIZE	PUT IN	PULLED OUT
				18"	132' GM	-
				8-5/8"	1375' GM	-

Describe in detail the manner in which the well was plugged, indicating where the mud fluid was placed and the method or methods used in introducing it into the hole. If cement or other plugs were used, state the character of same and depth placed, from feet to feet for each plug set.

HEAVY MUD FROM 5230' (GM) TO 400', WOOD PLUG @ 400' WITH 20 SACKS CEMENT.
HEAVY MUD TO 35'. WOOD PLUG @ 35' WITH 10 SACKS CEMENT TO CELLAR. COMPLETED AT 7:00 A.M., JANUARY 1, 1953.

RECEIVED
STATE CORPORATION COMMISSION
FEB 27 1953
WICHITA, KANSAS

(If additional description is necessary, use BACK of this sheet)

Name of Plugging Contractor THE R. W. RINE DRILLING COMPANY
Address 320 CENTRAL BUILDING, WICHITA, KANSAS

STATE OF Kans, COUNTY OF Sedgewick, ss.
J. M. Barrett, Jr (employee of owner) or (owner or operator) of the above-described well, being first duly sworn on oath, says: That I have knowledge of the facts, statements, and matters herein contained and the log of the above-described well as filed and that the same are true and correct. So help me God.

(Signature) J. M. Barrett, Jr
302 Petroleum Bldg
Wichita, Kansas (Address)

SUBSCRIBED AND SWORN TO before me this 26 day of February, 19 53

Dorothy J. Beves
Notary Public.

My commission expires January 26, 1957



PLUGGING
FILE SEC 1 T 32 R 2024
BOOK PAGE 64 LINE 2

ELLIS WELL No. 1

NW-NW-NW
SEC. 1-325-20W
COMANCHE COUNTY, KANSAS

CONTRACTOR: THE R. W. RINE DRILLING COMPANY
STARTED: 11-29-52 FINISHED: 1-2-53

LOG

SAND - GRAVEL	0	65)	
RED BED - RED ROCK	65	220)	1ST HOLE CAVED IN, SKIPPED RIG
RED BED	220	300)	
SURFACE SAND	0	145	142' of 18" c50, 1/175 SX
CEMENT	130	145	
SHELLS - RED BED	145	610	EC @ 500' - 2°
CEMENT	1350	1400	
LIME - SHALE	1400	1982	EC @ 1500'
LIME	1982	2005	EC @ 2000' - 1/2°
LIME - SHALE	2005	2180	
LIME - SHALE BREAKS	2180	2325	
SHALE - LIME	2325	2425	
CHALKY LIME - SHALE	2425	2484	
LIME	2484	2525	EC @ 2500' - 3/4°
LIME - SHALE	2525	2685	
LIME	2685	2925	
LIME - SHALE	2925	3454	EC @ 3000' - NG
LIME	3454	4065	EC @ 3758' - 1/2°
LIME - SAND	4065	4115	EC @ 4000' - 1/2°
LIME	4115	4800	EC @ 4300' - 3/4°
LIME - SHALE	4800	4875	
LIME	4875	5100	
CHERTY LIME	5100	5142	
CORE #1 (DIAMOND CORE)	5142	5165	
LIME	5165	5240	T.O. - RB D & A PLUGGED - BOTTOM PLUG @ 400' 1/20 SX, TOP PLUG @ 35' 1/10 SX

I, R. M. GREEN, DO HEREBY CERTIFY THAT THE ABOVE IS A TRUE AND ACCURATE LOG OF THE ELLIS WELL No. 1, LOCATED NW NW NW SECTION 1-325-20W, COMANCHE COUNTY, KANSAS

R. M. Green

ASSISTANT SECRETARY

RECEIVED

STATE OF KANSAS

NOTARY PUBLIC

SUBSCRIBED TO AND SWORN BEFORE ME THIS 7th DAY OF JANUARY, 1953

Leonard Pederson
NOTARY PUBLIC

My COMMISSION EXPIRES APRIL 20, 1955.

PLUGGING
FILE SEC 1-325-20W
BOOK PAGE 67 LINE 2