

WELL PLUGGING RECORD

Give All Information Completely
Take Required Affidavit
Mail or Deliver Report to:
Conservation Division
State Corporation Commission
211 No. Broadway
Wichita, Kansas

Hodgeman County. Sec. 33 Twp. 21 Rge. 25W (E) (W)

Location as "NE/CNW/SW" or footage from lines C NE SW

Lease Owner Chief Drilling & Lee Banks

Lease Name Knoefler Well No. 1

Office Address 905 Century Plaza, Wichita, Kansas 67202

Character of Well (completed as Oil, Gas or Dry Hole) Dry Hole

Date well completed 9/26/72 19__

Application for plugging filed 9/25/72 19__

Application for plugging approved 9/25/72 19__

Plugging commenced 9/26/72 19__

Plugging completed 9/26/72 19__

Reason for abandonment of well or producing formation Dry Hole

If a producing well is abandoned, date of last production 19__

Was permission obtained from the Conservation Division or its agents before plugging was commenced? Yes

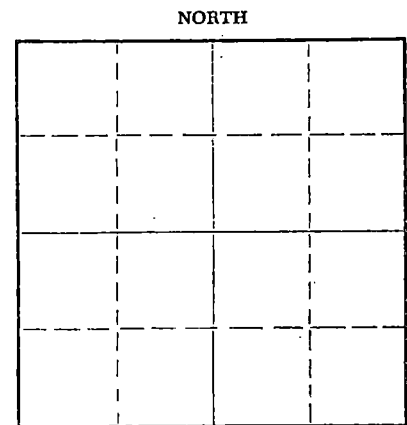

Locate well correctly on above Section Plat

Name of Conservation Agent who supervised plugging of this well Leo Massey

Producing formation _____ Depth to top _____ Bottom _____ Total Depth of Well 4600 Feet

Show depth and thickness of all water, oil and gas formations.

OIL, GAS OR WATER RECORDS

CASING RECORD

FORMATION	CONTENT	FROM	TO	SIZE	PUT IN	PULLED OUT
		0	482'	8 5/8"		

Describe in detail the manner in which the well was plugged, indicating where the mud fluid was placed and the method or methods used in introducing it into the hole. If cement or other plugs were used, state the character of same and depth placed, from _____ feet to _____ feet for each plug set.

Plugged through drill pipe at 660' w/50 sacks cement
Plugged through drill pipe at 450' w/25 sacks cement
Plugged through drill pipe at 40' w/10 sacks cement

RECEIVED
STATE CORPORATION COMMISSION
SEP 28 1972
CONSERVATION DIVISION
Wichita, Kansas

(If additional description is necessary, use BACK of this sheet)
Name of Plugging Contractor Chief Drilling Co., Inc.
Address Suite 905 Century Plaza, Wichita, Kansas 67202

STATE OF KANSAS, COUNTY OF SEDGWICK, ss.
Jim Robinson (employee of owner) or (owner or operator) of the above-described

well, being first duly sworn on oath, says: That I have knowledge of the facts, statements, and matters herein contained and the log of the above-described well as filed and that the same are true and correct. So help me God.

(Signature) Jim Robinson
905 Century Plaza, Wichita, Kansas
(Address)

SUBSCRIBED AND SWORN to before me this 27th day of September, 1972

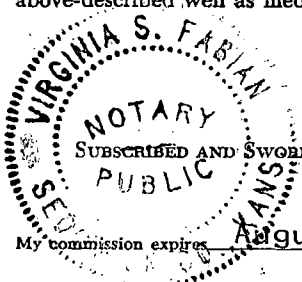

Virginia S. Fabian
Notary Public.

KANSAS DRILLERS LOG

API No. 15 _____ County _____ Number _____

Operator
Chief Drilling Co., Inc. and Lee Banks

Address
Suite 905 Century Plaza, Wichita, Kansas 67202

Well No. 1 Lease Name Knoefler

Footage Location
feet from (N) (S) line _____ feet from (E) (W) line _____

Principal Contractor Chief Drilling Geologist Tom Wesselowski

Spud Date 9/15/72 Total Depth 4600' P.B.T.D. _____

Date Completed 9/26/72 Oil Purchaser _____

S. 33 T. 21 R. 25^E_W
Loc. C NE SW
County Hodgeman

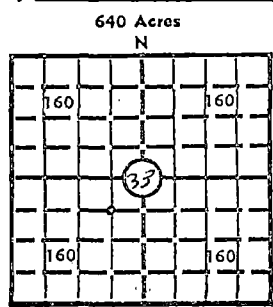

Elev.: Gr. 2437
DF 2439 KB 2442

CASING RECORD

Report of all strings set— surface, intermediate, production, etc.

Purpose of string	Size hole drilled	Size casing set (in O.D.)	Weight lbs/ft.	Setting depth	Type cement	Sacks	Type and percent additives
	12 1/4	8 5/8"	28 lbs.	482'	common quick set	300	

LINER RECORD

PERFORATION RECORD

Top, ft.	Bottom, ft.	Sacks cement	Shots per ft.	Size & type	Depth interval

TUBING RECORD

Size	Setting depth	Packer set at

ACID, FRACTURE, SHOT, CEMENT SQUEEZE RECORD

Amount and kind of material used	Depth interval treated

RECEIVED
STATE CORPORATION COMMISSION
SEP 28 1972
CONSERVATION DIVISION
Wichita, Kansas

INITIAL PRODUCTION

Date of first production	Producing method (flowing, pumping, gas lift, etc.)
RATE OF PRODUCTION PER 24 HOURS	Oil _____ Gas _____ Water _____ Gas-oil ratio _____
Disposition of gas (vented, used on lease or sold)	Producing interval (s) _____

INSTRUCTIONS: As provided in KCC Rule 82-2-125, within 90 days after completion of a well, one completed copy of this Drillers Log shall be transmitted to the State Geological Survey of Kansas, 4150 Monroe Street, Wichita, Kansas 67209. Copies of this form are available from the Conservation Division, State Corporation Commission, 3830 So. Meridian (P.O. Box 17027), Wichita, Kansas 66217. Phone AC 316-522-2206. If confidential custody is desired, please note Rule 82-2-125. Drillers Logs will be on open file in the Oil and Gas Division, State Geological Survey of Kansas, Lawrence, Kansas 66044.

Operator **Chief Drilling Co., Inc.** DESIGNATE TYPE OF COMP.: OIL, GAS, DRY HOLE, SWDW, ETC.:

Well No. **1** Lease Name **Knoefler** Dry Hole

S.33 T.21 R.25W^E

WELL LOG

Show all important zones of porosity and contents thereof; cored intervals, and all drill-stem tests, including depth interval tested, cushion used, time tool open, flowing and shut-in pressures, and recoveries.

SHOW GEOLOGICAL MARKERS, LOGS RUN, OR OTHER DESCRIPTIVE INFORMATION.

FORMATION DESCRIPTION, CONTENTS, ETC.	TOP	BOTTOM	NAME	DEPTH
DST #1 4525 - 4547' Open 15-30-30-30 Weak blow for 5" Rec. 25" rotary mud IBHP: 1220#-30" FBHP: 1005#-30" FP: 27-45#			Anhydrite Base Anhy. Heebner Toronto Lansing Base K.C. Ft. Scott Mississippi	1658 1690 3836 3857 3887 4294 4428 4517

USE ADDITIONAL SHEETS, IF NECESSARY, TO COMPLETE WELL RECORD.

Date Received	<i>Jim Robinson</i>
	Signature
	Vice President
	Title
	September 27, 1972
	Date