

STATE OF KANSAS
STATE CORPORATION COMMISSION

WELL PLUGGING RECORD

Give All Information Completely
Make Required Affidavit
Mail or Deliver Report to:
Conservation Division
State Corporation Commission
212 No. Market
Wichita, Kansas

Comanche County, Sec. 31 Twp. 32S Rge. 20(W)

Location as "NE/CNW/SW" or footage from lines C NE SW

Lease Owner Edmiston Oil Company

Lease Name Coate - Ewy "B" Well No. 1

Office Address 801 First National Bank Bldg., Wichita, Kansas 67202

Character of Well (completed as Oil, Gas or Dry Hole) dry hole

Date well completed August 27, 19 72

Application for plugging filed August 29, 19 72

Application for plugging approved 19

Plugging commenced August 26, 19 72

Plugging completed August 27, 19 72

Reason for abandonment of well or producing formation dry hole

If a producing well is abandoned, date of last production 19

Was permission obtained from the Conservation Division or its agents before plugging was commenced? yes

Name of Conservation Agent who supervised plugging of this well G. Russel Biberstein, Attica, Kansas

Producing formation Depth to top Bottom Total Depth of Well 5300 Feet

Show depth and thickness of all water, oil and gas formations.

OIL, GAS OR WATER RECORDS

CASING RECORD

FORMATION	CONTENT	FROM	TO	SIZE	PUT IN	PULLED OUT
Surface pipe		-0-	576'	8-5/8"	8/15/72	none

Describe in detail the manner in which the well was plugged, indicating where the mud fluid was placed and the method or methods used in introducing it into the hole. If cement or other plugs were used, state the character of same and depth placed, from feet to feet for each plug set.

Set bottom plug @ 350' w/40 sx cement;
Set top plug @ 40' w/20 sx cement;
2 sx cement in rathole.

RECEIVED
STATE CORPORATION COMMISSION
AUG 30 1972
8-30-72
CONSERVATION DIVISION
Wichita, Kansas

(If additional description is necessary, use BACK of this sheet)

Name of Plugging Contractor E. K. Edmiston Drilling Company, Inc.

Address 801 First National Bank Bldg., Wichita, Kansas 67202

STATE OF Kansas, COUNTY OF Sedgwick ss.
E. K. Edmiston (employee of owner) or (owner or operator) of the above-described well, being first duly sworn on oath, says: That I have knowledge of the facts, statements, and matters herein contained and the log of the above-described well as filed and that the same are true and correct. So help me God.

(Signature) [Signature]

801 First National Bank Bldg., Wichita, Kan.
(Address)

Subscribed and sworn to before me this 29th day of August, 19 72

My commission expires November 9, 1973

[Signature]
Marilyn E. Fox
Notary Public.

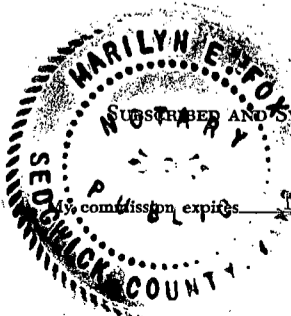

RECEIVED
STATE CORPORATION COMMISSION

AUG 30 1972

CONSERVATION DIVISION
Wichita, Kansas

KANSAS CORPORATION COMMISSION

WELL RECORD

(Mail to Kansas Geological Survey, #150 Monroe Street, Wichita, Kansas 67209)

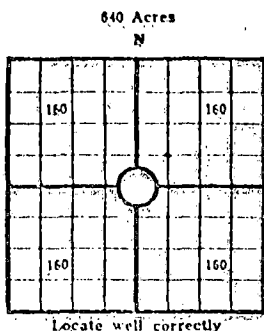

Lease Name: Coate - Ewy "B" Well No. 1
 Well Located: C NE SW
SEC 31 TWP 32S RGE 20W
 Operator: Edmiston Oil Company
 Address: 801 First National Bank Bldg., Wichita, Kansas 67202
 Elevation: Ground 1941 D.F. 1943 K.B. 1946
 Type Well: (Oil, gas, dry hole) dry hole

Drilling Commenced: August 15, 1972 Drilling Completed: August 26, 1972
 Well Completed: August 27, 1972 Total Depth 5300
 Initial Production: _____

Casing Record

Size: 8 - 5/8 Set at 576' Size: _____ Set at _____
 Size: _____ Set at _____ Size: _____ Set at _____

Liner Record

Size: _____ Set from _____ To _____

Cementing

Casing Size	Sacks	Type Cement and Additives
<u>8-5/8"</u>	<u>350</u>	<u>200 sx 50-50 Pozmix; 150 sx Sunset</u>
_____	_____	_____
_____	_____	_____

Perforations

Formation	Perforated Interval and Number Shots
_____	_____
_____	_____
_____	_____

Electric Log Run (Show type log and depths covered)

Electra Gamma Ray Neutron - 576' - 5303 T.D.

(Fill in formation and related information on reverse side)

FORMATION, TESTING AND COMPLETION RECORD

Show Drill Stem Tests,
Well Stimulation and
Production Tests

Formation	Top	Bottom	
Red Bed	0	157	
Red Bed & Shale	157	576	
Shale	576	2284	
Lime & Shale	2284	3587	
Lime	3587	3800	
Shale & Lime	3800	4520	No tests
Lime	4520	5300	R. T. D.

MISSISSIPPI
CONSERVATION DIVISION
NO 30 1915
MISSISSIPPI CONSERVATION COMMISSION
RECEIVED