

FOR KCC USE:

15-033-20915-0000

FORM C-1

FORM MUST BE T

FORM MUST BE SII

ALL BLANKS MUST BE FIL

EFFECTIVE DATE: 8-25-96

State of Kansas

DISTRICT # 1

NOTICE OF INTENTION TO DRILL

SEAT: Yes No

Must be approved by the K.C.C. five (5) days prior to commencing well

Expected Spud Date ... September 15, 1996 ... month day year

Spot 113 S ΔF NE NE NE Sec .4. Twp 33. S. Rg .19. X

OPERATOR: License # 6528 Name: R. J. Patrick, Operating Company Address: P. O. Box 1157 City/State/Zip: Liberal, KS 67905-1157 Contact Person: Mr. R. J. Patrick Phone: 316-624-8483

* 443 feet from South/North line of Sect 330 feet from East/West line of Sect 13 SECTION X REGULAR IRREGULAR

CONTRACTOR: License #: ADVISE ON ACO-1 Name:

(NOTE: Locate well on the Section Plat on Reverse S1 County: Comanche Lease Name: Herd Well #: 1 Field Name: Wildcat

Well Drilled For: Well Class: Type Equipment: X Oil Enh Rec Infield X Mud Rotary Gas Storage Pool Ext Air Rotary OWD Disposal Wildcat Cable Seismic: # of Holes Other If OWD: old well information as follows: Operator: Well Name: Comp. Date: Old Total Depth

Is this a Prerated/Spaced Field? yes X no Target Formation(s): Arbuckle Nearest lease or unit boundary: 330 Ground Surface Elevation: 1925' feet Water well within one-quarter mile: yes X Public water supply well within one mile: yes X Depth to bottom of fresh water: 100 Depth to bottom of usable water: 180 Surface Pipe by Alternate: X 1 2 Length of Surface Pipe Planned to be set: 650 Length of Conductor pipe required: 6500 Projected Total Depth: Arbuckle Formation at Total Depth: Water Source for Drilling Operations: well X farm pond oth

Directional, Deviated or Horizontal wellbores? yes X no If yes, true vertical depth: Bottom Hole Location:

OUR Permit #: Will Cores Be Taken? yes X no If yes, proposed zone:

AFFIDAVIT

* WAS: 330' FNL IS: 443' FNL

The undersigned hereby affirms that the drilling, completion and eventual plugging of this well will comply with K.S.A. 5 101, et. seq. It is agreed that the following minimum requirements will be met:

- 1. Notify the appropriate district office prior to spudding of well; 2. A copy of the approved notice of intent to drill shall be posted on each drilling rig; 3. The minimum amount of surface pipe as specified below shall be set by circulating cement to the top; in all cases surface pipe shall be set through all unconsolidated materials plus a minimum of 20 feet into the underlying formation; 4. If the well is dry hole, an agreement between the operator and the district office on plug length and placement necessary prior to plugging; 5. The appropriate district office will be notified before well is either plugged or production casing is cemented in; 6. IF AN ALTERNATE II COMPLETION, PRODUCTION PIPE SHALL BE CEMENTED FROM BELOW ANY USABLE WATER TO SURFACE WITHIN 120 DAY OF SPUD DATE. IN ALL CASES, NOTIFY DISTRICT OFFICE PRIOR TO ANY CEMENTING.

I hereby certify that the statements made herein are true and to the best of my knowledge and belief. Date: 8/7/96 Signature of Operator or Agent: Title: Engineer

RECEIVED KANSAS CORP COM 1996 OCT 25 P 1:3 10-25-96

FOR KCC USE: API # 15- 033-209150000 Conductor pipe required NONE feet Minimum surface pipe required 200 feet per Alt. 1 X Approved by: JK 11-7-96 / ORIL 8-20-96 This authorization expires: 2-20-97 (This authorization void if drilling not started within 6 months of effective date.) Spud date: Agent:

REMEMBER TO:

- File Drill Pit Application (form CDP-1) with Intent to Drill; - File Completion Form ACO-1 within 120 days of spud date; - File acreage attribution plat according to field proration orders; - Notify appropriate district office 48 hours prior to workover or re-entry; - Submit plugging report (CP-4) after plugging is completed; - Obtain written approval before disposing or injecting salt water.

Mail to: Conservation Division, 200 Colorado Derby Building, 202 W. First St., Wichita, Kansas 67202-1286.

4 33 PW

IN ALL CASES PLOT THE INTENDED WELL ON THE PLAT BELOW
PLAT OF ACREAGE ATTRIBUTABLE TO A WELL IN A PRORATED OR SPACED FIELD

If the intended well is in a prorated or spaced field, please fully complete this side of the form. If the intended well is in a prorated or spaced field complete the plat below showing that the well will be properly located in relationship to other wells producing from the common source of supply. Please show all the wells within 1 mile of the boundaries of the proposed acreage attribution unit for gas wells and within 1/2 mile of the boundaries of the proposed acreage attribution unit for oil wells.

API NO. 15- _____
OPERATOR R. J. Patrick Operating Company
LEASE Herd
WELL NUMBER 1
FIELD Wildcat

LOCATION OF WELL: COUNTY Comanche
* 443 feet from ~~south~~/north line of section
330 feet from east/~~west~~ line of section
SECTION 4 TWP 33 S RG 19 W

NUMBER OF ACRES ATTRIBUTABLE TO WELL 160
QTR/QTR/QTR OF ACREAGE NE NE NE

IS SECTION x REGULAR or IRREGULAR
IF SECTION IS IRREGULAR, LOCATE WELL FROM NEAREST CORNER BOUNDARY.

Section corner used: x NE NW SE SW

PLAT

(Show location of the well and shade attributable acreage for prorated or spaced wells.)
(Show footage to the nearest lease or unit boundary line.)

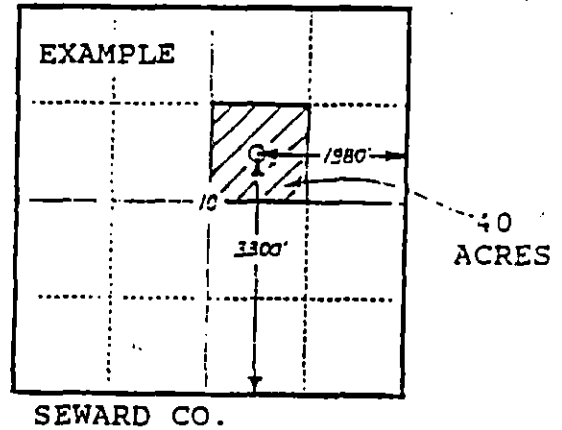
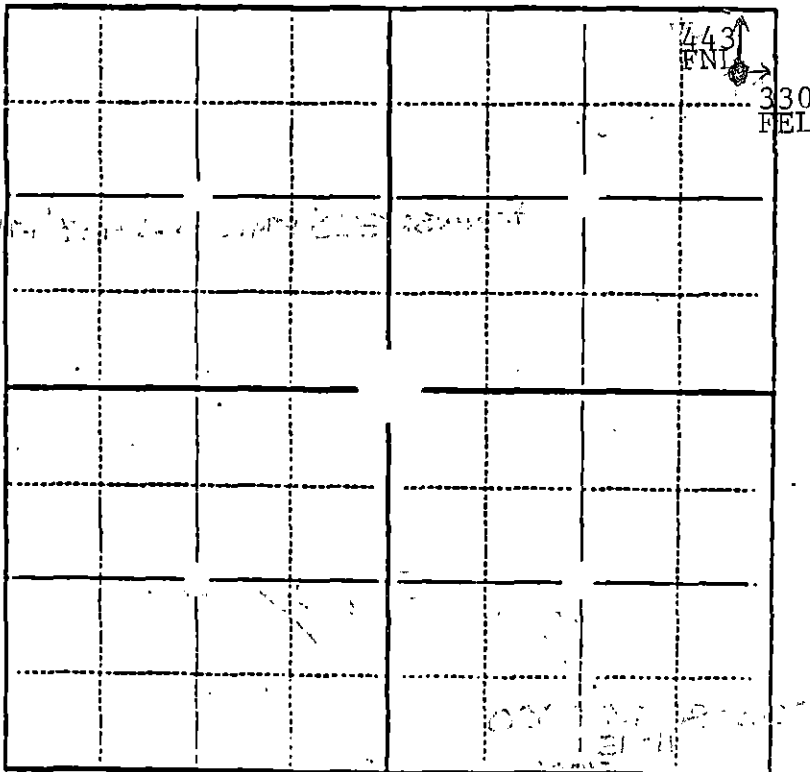

In plotting the proposed location of the well, you must show:

- 1) The manner in which you are using the depicted plat by identifying section lines, i.e. 1 section, 1 section with 8 surrounding sections, 4 sections, etc.;
- 2) the distance of the proposed drilling location from the section's south/north and east/west lines; and
- 3) the distance to the nearest lease or unit boundary line.