

FOR KCC USE:

FORM C-1 7/91

FORM MUST BE TYPED

EFFECTIVE DATE: 4-15-96

FORM MUST BE SIGNED

DISTRICT # 1
SEAT? Yes No

State of Kansas
NOTICE OF INTENTION TO DRILL

ALL BLANKS MUST BE FILLED

Must be approved by the K.C.C. five (5) days prior to commencing well

Expected Spud Date April 9 1996
month day year

Spot 230's OF East
NW - NE - NW Sec .3. Twp 33. S. Rg 19. X West

OPERATOR: License # 3882
Name: Samuel Gary, Jr. & Associates
Address: 1670 Broadway, Suite 3300
City/State/Zip: Denver, CO 80203
Contact Person: Tom Fertal
Phone: 303-831-4673

560 feet from South / North line of Section
1650 feet from East / West line of Section
IS SECTION REGULAR IRREGULAR?

CONTRACTOR: License #: 5059
Name: Eagle Drilling, Inc

(NOTE: Locate well on the Section Plat on Reverse Side)
County: Comanche
Lease Name: Webster Well #: 3-3
Field Name: Wildcat

Well Drilled For: Well Class: Type Equipment:
 Oil ... Enh Rec ... Infield ... Mud Rotary
... Gas ... Storage ... Pool Ext. ... Air Rotary
... OWWO ... Disposal Wildcat ... Cable
... Seismic; ... # of Holes ... Other
If OWWO: old well information as follows:
Operator: N/A
Well Name: N/A
Comp. Date: Old Total Depth

Is this a Prorated/Spaced Field? ... yes no
Target Formation(s): Viola, Arbuckle, Mass, Lmsnc
Nearest lease or unit boundary: 560 FNL
Ground Surface Elevation: 1935 (EST) feet MSL
Water well within one-quarter mile: ... yes no
Public water supply well within one mile: ... yes no
Depth to bottom of fresh water: 80
Depth to bottom of usable water: 180
Surface Pipe by Alternate: 1 2
Length of Surface Pipe Planned to be set: 650
Length of Conductor pipe required: 60
Projected Total Depth: 6200'
Formation at Total Depth: Arbuckle
Water Source for Drilling Operations:
... well farm pond ... other

Directional, Deviated or Horizontal wellbore? ... yes no
If yes, true vertical depth: N/A
Bottom Hole Location: N/A

DWR Permit #: ...
Will Cores Be Taken?: ... yes no
If yes, proposed zone: ...

AFFIDAVIT

* Based on Topo Map, well in center of N 1/2 section 3

The undersigned hereby affirms that the drilling, completion and eventual plugging of this well will comply with K.S.A. 55-101, et. seq.

It is agreed that the following minimum requirements will be met:

1. Notify the appropriate district office prior to spudding of well;
2. A copy of the approved notice of intent to drill shall be posted on each drilling rig;
3. The minimum amount of surface pipe as specified below shall be set by circulating cement to the top. In all cases surface pipe shall be set through all unconsolidated materials plus a minimum of 20 feet into the underlying formation;
4. If the well is dry hole, an agreement between the operator and the district office on plug length and placement is necessary prior to plugging;
5. The appropriate district office will be notified before well is either plugged or production casing is cemented in;
6. IF AN ALTERNATE II COMPLETION, PRODUCTION PIPE SHALL BE CEMENTED FROM BELOW ANY USABLE WATER TO SURFACE WITHIN 120 DAYS OF SPUD DATE. IN ALL CASES, NOTIFY DISTRICT OFFICE PRIOR TO ANY CEMENTING.

I hereby certify that the statements made herein are true and to the best of my knowledge and belief.

Date: 3/26/96 Signature of Operator or Agent: [Signature] Title: President

FOR KCC USE:
 API # 15- 033-20910 0000
 Conductor pipe required NONE feet
 Minimum surface pipe required 200' feet per Alt. ① X
 Approved by: JK 4-10-96
 This authorization expires: 10-10-96
 (This authorization void if drilling not started within 6 months of effective date.)
 Spud date: Agent:

REMEMBER TO:

- File Drill Pit Application (form GDP-1) with Intent to Drill;
- File Completion Form ACO-1 within 120 days of spud date;
- File acreage attribution plat according to field proration orders;
- Notify appropriate district office 48 hours prior to workover or re-entry;
- Submit plugging report (CP-4) after plugging is completed;
- Obtain written approval before disposing or injecting salt water.

Mail to: Conservation Division, 200 Colorado Berby Building, 202 W. First St., Wichita, Kansas 67202-1286.

W
33
19W

IN ALL CASES LOCATE THE INTENDED WELL ON THE PLAT BELOW
PLAT OF ACREAGE ATTRIBUTABLE TO A WELL IN A PRORATED OR SPACED FIELD

If the intended well is in a prorated or spaced field, please fully complete this side of the form. If the intended well is in a prorated or spaced field complete the plat below showing that the well will be properly located in relationship to other wells producing from the common source of supply. Please show all the wells within 1 mile of the boundaries of the proposed acreage attribution unit for gas wells and within 1/2 mile of the boundaries of the proposed acreage attribution unit for oil wells.

API NO. 15- _____
 OPERATOR Samuel Gary Jr. & Associates LOCATION OF WELL: COUNTY Comanche
 LEASE Webster 560 feet from south/north line of section
 WELL NUMBER 3-3 1650 feet from east/west line of section
 FIELD Wildcat SECTION 3 TWP 33S RG 19W

NUMBER OF ACRES ATTRIBUTABLE TO WELL _____ IS SECTION _____ REGULAR or _____ IRREGULAR
 QTR/QTR/QTR OF ACREAGE _____ IF SECTION IS IRREGULAR, LOCATE WELL FROM NEAREST
 CORNER BOUNDARY.

Section corner used: _____ NE _____ NW _____ SE _____ SW
 PLAT

(Show location of the well and shade attributable acreage for prorated or spaced wells.)
 (Show footage to the nearest lease or unit boundary line.)

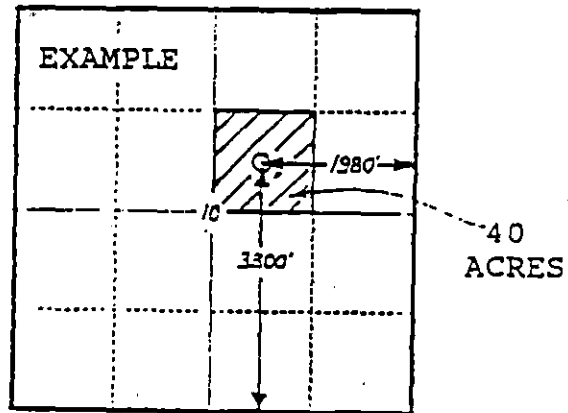
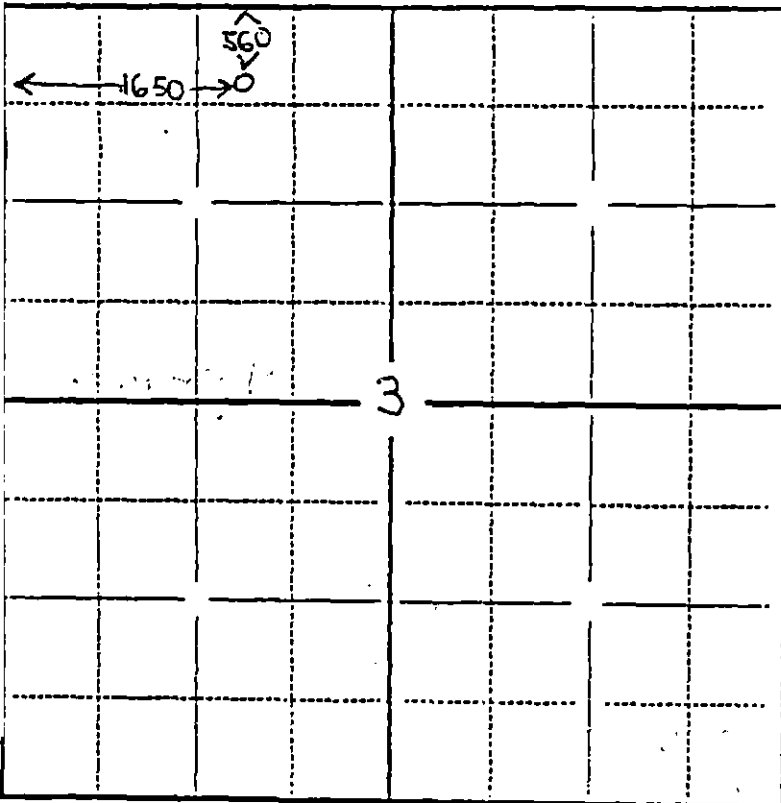

SEWARD CO.

RECEIVED
 KANSAS CORPORATION COMMISSION

APR 02 1996

CONSERVATION DIVISION
 WICHITA, KS

In plotting the proposed location of the well, you must show:

- 1) The manner in which you are using the depicted plat by identifying section lines, i.e. 1 section, 1 section with 8 surrounding sections, 4 sections, etc.;
- 2) the distance of the proposed drilling location from the section's south/north and east/west lines; and
- 3) the distance to the nearest lease or unit boundary line.