

EFFECTIVE DATE: 5-5-97

State of Kansas

FORM MUST BE TYPED

DISTRICT # 1

NOTICE OF INTENTION TO DRILL

FORM MUST BE SIGNED

ALL BLANKS MUST BE FILLED

2. X Yes... No

Must be approved by the K.C.C. five (5) days prior to commencing well.

Expected Spud Date 4 month 20 day 97 year

Spot 25 E of NW - SE - NW. Sec 3... Twp 33.. S, Rg 19 X West

OPERATOR: License # 3882 Name: Samuel Gary, Jr. & Associates Address: 1670 Broadway, Suite 3300 City/State/Zip: Denver, CO 80202 Contact Person: Tom Fertal Phone: 303-831-4673

1650 feet from South (North) line of Section 1675 feet from East (West) line of Section IS SECTION X REGULAR IRREGULAR?

(NOTE: Locate well on the Section Plat on Reverse Side) County: Comanche Lease Name: Williams Well #: 3-6-X Field Name: Colter West Is this a Prorated/Spaced Field? yes X no Target Formation(s): Arbuckle Nearest lease or unit boundary: 330 Ground Surface Elevation: 1936 feet MSL Water well within one-quarter mile: yes X no Public water supply well within one mile: yes X no Depth to bottom of fresh water: 80 Depth to bottom of usable water: 180 Surface Pipe by Alternate: X 1 / 2 Length of Surface Pipe Planned to be set: 650 Length of Conductor pipe required: 60 Projected Total Depth: 6300 Formation at Total Depth: Arbuckle Water Source for Drilling Operations: well farm pond X other

CONTRACTOR: License #: 5929 Name: Duke Drilling

Well Drilled For: Well Class: Type Equipment: X Oil Enh Rec Infield X Mud Rotary Gas Storage X Pool Ext Air Rotary OWO Disposal Wildcat Cable Seismic: # of Holes Other If OWO: old well information as follows: Operator: NA Well Name: Comp. Date: Old Total Depth

Directional, Deviated or Horizontal wellbore? yes X no If yes, true vertical depth: NA on Hole Location

Will Cores Be Taken? yes X no If yes, proposed zone:

AFFIDAVIT

RECEIVED KANSAS CORPORATION COMMISSION

The undersigned hereby affirms that the drilling, completion and eventual plugging of this well will comply with K.S.A. 55-101, et. seq. It is agreed that the following minimum requirements will be met:

- 1. Notify the appropriate district office prior to spudding of well; 2. A copy of the approved notice of intent to drill shall be posted on each drilling rig; 3. The minimum amount of surface pipe as specified below shall be set by circulating cement to the top; in all cases surface pipe shall be set through all unconsolidated materials plus a minimum of 20 feet into the underlying formation; 4. If the well is dry hole, an agreement between the operator and the district office on plug length and placement is necessary prior to plugging; 5. The appropriate district office will be notified before well is either plugged or production casing is cemented in; 6. IF AN ALTERNATE II COMPLETION, PRODUCTION PIPE SHALL BE CEMENTED FROM BELOW ANY USABLE WATER TO SURFACE WITHIN 120 DAYS OF SPUD DATE. IN ALL CASES, NOTIFY DISTRICT OFFICE PRIOR TO ANY CEMENTING.

APR 30 1997 4-30-97

I hereby certify that the statements made herein are true and to the best of my knowledge and belief.

Date: April 29 Signature of Operator or Agent: Thomas H. Fertal Title: Sr. Geologist

FOR KCC USE: API # 15- 033-209320000 Conductor pipe required NONE feet Minimum surface pipe required 200 feet per Alt. (1) X Approved by: JK 4-30-97 This authorization expires: 10-30-97 (This authorization void if drilling not started within 6 months of effective date.) Spud date: Agent:

- REMEMBER TO: - File Drill Pit Application (form CDP-1) with Intent to Drill; - File Completion Form ACO-1 within 120 days of spud date; - File acreage attribution plat according to field proration orders; - Notify appropriate district office 48 hours prior to workover or re-entry; - Submit plugging report (CP-4) after plugging is completed; - Obtain written approval before disposing or injecting salt water.

3 33 19W

IN ALL CASES PLOT THE INTENDED WELL ON THE PLAT BELOW

PLAT OF ACREAGE ATTRIBUTABLE TO A WELL IN A PRORATED OR SPACED FIELD

the intended well is in a prorated or spaced field, please fully complete this side of the form. If the intended well is in a prorated or spaced field complete the plat below showing that the well will be properly located in relationship to other wells producing from the common source of supply. Please show all the wells within 1 mile of the boundaries of the proposed acreage attribution unit for gas wells and within 1/2 mile of the boundaries of the proposed acreage attribution unit for oil wells.

API NO. 15- _____
 OPERATOR _____
 LEASE _____
 WELL NUMBER _____
 FIELD _____

LOCATION OF WELL: COUNTY _____
 _____ feet from south/north line of section
 _____ feet from east/west line of section
 SECTION _____ TWP _____ RG _____

NUMBER OF ACRES ATTRIBUTABLE TO WELL _____
 QTR/QTR/QTR OF ACREAGE _____

IS SECTION _____ REGULAR or _____ IRREGULAR
IF SECTION IS IRREGULAR, LOCATE WELL FROM NEAREST CORNER BOUNDARY.

Section corner used: _____ NE _____ NW _____ SE _____ SW

PLAT

(Show location of the well and shade attributable acreage for prorated or spaced wells.)
 (Show footage to the nearest lease or unit boundary line.)

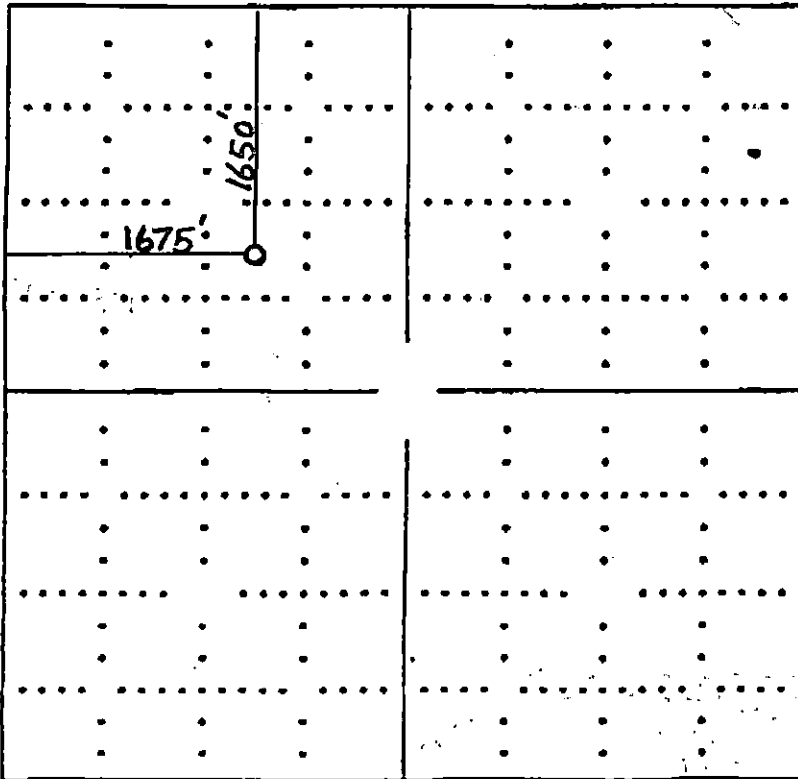

RECEIVED
 KANSAS CORPORATION COMMISSION

APR 30 1997

CONSERVATION DIVISION
 WICHITA, KS

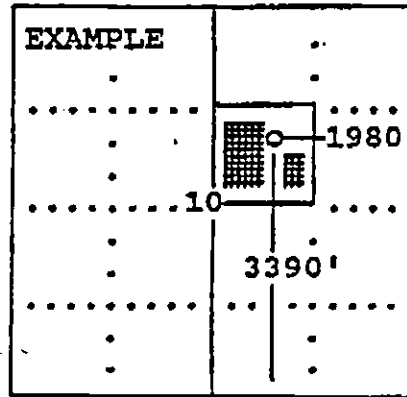

SEWARD CO.

In plotting the proposed location of the well, you must show:

- 1) The manner in which you are using the depicted plat by identifying section lines, i.e. 1 section, 1 section with 8 surrounding sections, 4 sections, etc.;
- 2) the distance of the proposed drilling location from the section's south/north and east/west; and
- 3) the distance to the nearest lease or unit boundary line.