

EFFECTIVE DATE: 5-20-96

State of Kansas

FORM MUST BE SIGNED

DISTRICT # 1

NOTICE OF INTENTION TO DRILL

ALL BLANKS MUST BE FILLED

SGA? Yes No

Must be approved by the K.C.C. five (5) days prior to commencing well.

Expected Spud Date June 15 1996
month day year

Spot APPROX East
SW - NE - SW Sec 13 Twp 33 S, Rg 18 West

OPERATOR: License # 31852
Name: Bonneville Fuels Corporation
Address: 1660 Lincoln St., Suite 1800
City/State/Zip: Denver, Colorado 80264
Contact Person: Robert A. Schwering, P.E.
Phone: (Day) 303-863-1555 (Night) 303-278-8020

1900 feet from South line of Section
1900 feet from West line of Section
IS SECTION REGULAR IRREGULAR?

(NOTE: Locate well on the Section Plat on Reverse Side)

CONTRACTOR: License #: _____
Name: Undesignated at this time: W.O. Bids.
Will advise on ACO-1.

County: Gomanche
Lease Name: Dale Acres Well #: 1
Field Name: Wildcat

Well Drilled For: Well Class: Type Equipment:

- Oil Enh Rec Infield Mud Rotary
- Gas Storage Pool Ext. Air Rotary
- OWWO Disposal Wildcat Cable
- Seismic; # of Holes Other
- Other

Is this a Prorated/Spaced Field? yes no

Target Formation(s): Arbuckle/Simpson/Viola/Spergen

Nearest lease or unit boundary: 584 Lease Boundary

Ground Surface Elevation: 1903.3 feet MSL

Water well within one-quarter mile: yes no

Public water supply well within one mile: yes no

Depth to bottom of fresh water: Approx. 120'

Depth to bottom of usable water: Approx. 200'

Surface Pipe by Alternate: 1 2

Length of Surface Pipe Planned to be set: 700'-900'

Length of Conductor pipe required: None

Projected Total Depth: 6,100'

Formation at Total Depth: Arbuckle Fm.

Water Source for Drilling Operations:

well farm pond other

APPLY FOR FROM DWR

If OWWO: old well information as follows:

Operator: _____

Well Name: _____

Comp. Date: _____ Old Total Depth _____

Directional, Deviated or Horizontal wellbore? yes no

If yes, true vertical depth: 6,100'

Bottom Hole Location: Approx. 1900' ESL & 1900' FWL

Will Cores Be Taken? yes no

If yes, proposed zone: _____

AFFIDAVIT

RECEIVED

KANSAS CORPORATION COMMISSION

The undersigned hereby affirms that the drilling, completion and eventual plugging of this well will comply with K.S.A. 55-101, et. seq.

It is agreed that the following minimum requirements will be met:

1. Notify the appropriate district office prior to spudding of well;
2. A copy of the approved notice of intent to drill shall be posted on each drilling rig;
3. The minimum amount of surface pipe as specified below shall be set by circulating cement to the top of the surface pipe shall be set through all unconsolidated materials plus a minimum of 20 feet into the underlying formation;
4. If the well is dry hole, an agreement between the operator and the district office on plug length and placement is necessary prior to plugging;
5. The appropriate district office will be notified before well is either plugged or production casing is cemented in;
6. IF AN ALTERNATE II COMPLETION, PRODUCTION PIPE SHALL BE CEMENTED FROM BELOW ANY USABLE WATER TO SURFACE WITHIN 120 DAYS OF SPUD DATE. IN ALL CASES, NOTIFY DISTRICT OFFICE PRIOR TO ANY CEMENTING.

MAY 09 1996

5-9-96

I hereby certify that the statements made herein are true and to the best of my knowledge and belief.

Date: 5/8/96 Signature of Operator or Agent: Robert A. Schwering, P.E. Title: Operations Manager

FOR KCC USE:
 API # 15- 033-209120000
 Conductor pipe required NONE feet
 Minimum surface pipe required 200' feet per Alt.
 Approved by: JK 5-15-96
 This authorization expires: 11-15-96
 (This authorization void if drilling not started within 6 months of effective date.)
 Spud date: _____ Agent: _____

REMEMBER TO:

- File Drill Pit Application (form CDP-1) with Intent to Drill;
- File Completion Form ACO-1 within 120 days of spud date;
- File acreage attribution plat according to field proration orders;
- Notify appropriate district office 48 hours prior to workover or re-entry;
- Submit plugging report (CP-4) after plugging is completed;
- Obtain written approval before disposing or injecting salt water.

13
33
102

IN ALL CASES PLOT THE INTENDED WELL ON THE PLAT BELOW

PLAT OF ACREAGE ATTRIBUTABLE TO A WELL IN A PRORATED OR SPACED FIELD

If the intended well is in a prorated or spaced field, please fully complete this side of the form. If the intended well is in a prorated or spaced field complete the plat below showing that the well will be properly located in relationship to other wells producing from the common source of supply. Please show all the wells within 1 mile of the boundaries of the proposed acreage attribution unit for gas wells and within 1/2 mile of the boundaries of the proposed acreage attribution unit for oil wells.

API NO. 15- _____
 OPERATOR Bonneville Fuels Corporation
 LEASE Dale Acres
 WELL NUMBER #1
 FIELD Wildcat

LOCATION OF WELL: COUNTY Comanche
 _____ feet from south/~~west~~ line of section
 _____ feet from ~~east~~/west line of section
 SECTION 13 TWP 33S. RG 18W.

NUMBER OF ACRES ATTRIBUTABLE TO WELL _____
 QTR/QTR/QTR OF ACREAGE _____

IS SECTION _____ REGULAR or x IRREGULAR
IF SECTION IS IRREGULAR, LOCATE WELL FROM NEAREST CORNER BOUNDARY.

Section corner used: _____ NE _____ NW _____ SE x SW

PLAT

(Show location of the well and shade attributable acreage for prorated or spaced wells.)

(Show footage to the nearest lease or unit boundary line.)

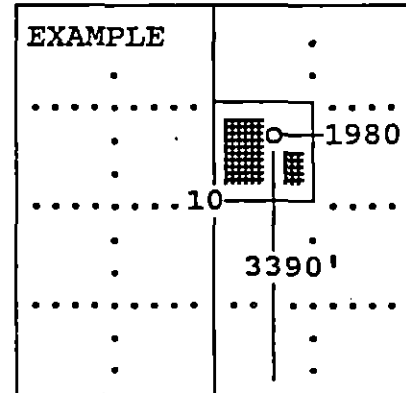
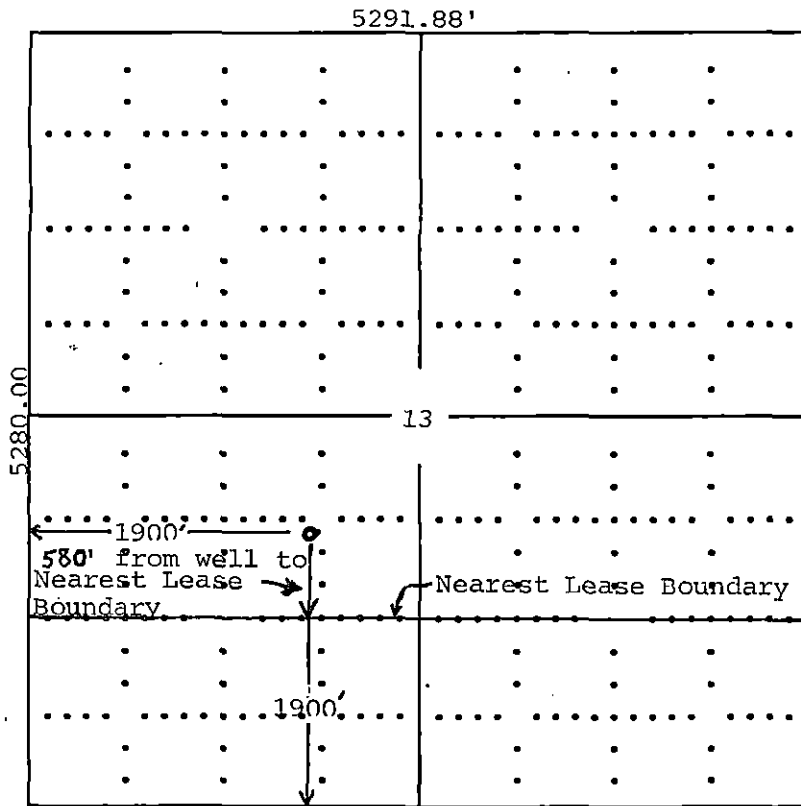

SEWARD CO.

Comanche Co. 5293.20' Survey Plat & Location Topo. & Site Plan Attached.

In plotting the proposed location of the well, you must show:

- 1) The manner in which you are using the depicted plat by identifying section lines, i.e. 1 section, 1 section with 8 surrounding sections, 4 sections, etc.;
- 2) the distance of the proposed drilling location from the section's south/north and east/west; and
- 3) the distance to the nearest lease or unit boundary line.