

RECEIVED
6-19-02
JUN 19 2002

Form C-1
September 1999
Form must be Typed
Form must be Signed
All blanks must be Filled

For KCC Use:
Effective Date: 6.30.02
District # 1
SGA? Yes No

KANSAS CORPORATION COMMISSION
OIL & GAS CONSERVATION DIVISION

NOTICE OF INTENT TO DRILL

Must be approved by KCC five (5) days prior to commencing well CONSERVATION DIVISION
WICHITA, KS

Expected Spud Date June 28 2002
month day year

OPERATOR: License# 31514
Name: Thoroughbred Associates LLC
Address: 8100 E. 22nd St. N. Bldg. 600 Ste. F
City/State/Zip: Wichita, KS 67226
Contact Person: Robert C. Patton
Phone: (316) 685-1512

CONTRACTOR: License# 5929
Name: Duke Drilling Company

Well Drilled For: Oil Enh Rec Infield Mud Rotary
 Gas Storage Pool Ext. Air Rotary
 OWWO Disposal Wildcat Cable
 Seismic; # of Holes Other

If OWWO: old well information as follows:
Operator: _____
Well Name: _____
Original Completion Date: _____ Original Total Depth: _____

Directional, Deviated or Horizontal wellbore? Yes No

If Yes, true vertical depth: _____

Bottom Hole Location: _____

KCC DKT #: _____

Spot East
SE - SE - NE Sec. 1 Twp. 32 S. R. 19 West
2337' feet from N (circle one) Line of Section
330' feet from E (circle one) Line of Section
Is SECTION Regular Irregular?

(Note: Locate well on the Section Plat on reverse side)

County: Comanche

Lease Name: Brosius/Unruh Well #: 1

Field Name: unnamed

Is this a Prorated / Spaced Field? Yes No

Target Formation(s): LKC, Marm, Miss, Viola

Nearest Lease or unit boundary: 330' from south & East Pin.

Ground Surface Elevation: 2116 feet MSL

Water well within one-quarter mile: Yes No

Public water supply well within one mile: 150 Yes No

Depth to bottom of fresh water: _____

Depth to bottom of usable water: 200

Surface Pipe by Alternate: X 1 2

Length of Surface Pipe Planned to be set: 425'

Length of Conductor Pipe required: NONE

Projected Total Depth: 5900'

Formation at Total Depth: Viola

Water Source for Drilling Operations:
Well _____ Farm Pond _____ Other X

DWR Permit #: _____

(Note: Apply for Permit with DWR)

Will Cores be taken? Yes No

If Yes, proposed zone: _____

AFFIDAVIT

The undersigned hereby affirms that the drilling, completion and eventual plugging of this well will comply with K.S.A. 55-101, et. seq.
It is agreed that the following minimum requirements will be met:

1. Notify the appropriate district office **prior** to spudding of well;
2. A copy of the approved notice of intent to drill **shall be** posted on each drilling rig;
3. The minimum amount of surface pipe as specified below **shall be set** by circulating cement to the top; in all cases surface pipe **shall be set** through all unconsolidated materials plus a minimum of 20 feet into the underlying formation.
4. If the well is dry hole, an agreement between the operator and the district office on plug length and placement is necessary **prior to plugging**;
5. The appropriate district office will be notified before well is either plugged or production casing is cemented in;
6. If an ALTERNATE II COMPLETION, production pipe shall be cemented from below any usable water to surface within **120 days** of spud date. **In all cases, NOTIFY district office** prior to any cementing.

I hereby certify that the statements made herein are true and to the best of my knowledge and belief.

Date: 6/19/02 Signature of Operator or Agent: Kanitkov Title: Patton

For KCC Use ONLY
API # 15 - 033-21322-0000
Conductor pipe required NONE feet
Minimum surface pipe required 220 feet per Alt. 1
Approved by: RJP 6-2502
This authorization expires: 12-25-02
(This authorization void if drilling not started within 5 months of effective date.)
Spud date: _____ Agent: _____

Remember to:

- File Drill Pit Application (form CDP-1) with Intent to Drill;
- File Completion Form ACO-1 within 120 days of spud date;
- File acreage attribution plat according to field proration orders;
- Notify appropriate district office 48 hours prior to workover or re-entry;
- Submit plugging report (CP-4) after plugging is completed;
- Obtain written approval before disposing or injecting salt water.

1
32
194

IN ALL CASES PLOT THE INTENDED WELL ON THE PLAT BELOW

Plat of acreage attributable to a well in a prorated or spaced field

If the intended well is in a prorated or spaced field, please fully complete this side of the form. If the intended well is in a prorated or spaced field complete the plat below showing that the well will be properly located in relationship to other wells producing from the common source of supply. Please show all the wells and within 1 mile of the boundaries of the proposed acreage attribution unit for gas wells and within 1/2 mile of the boundaries of the proposed acreage attribution unit for oil wells.

API No. 15 - _____
Operator: _____
Lease: _____
Well Number: _____
Field: _____

Number of Acres attributable to well: _____
QTR / QTR / QTR of acreage: SE - SE - NE

Location of Well: County: Comanche
2337 2310 feet from S (N circle one) Line of Section
330' feet from E / W (circle one) Line of Section
Sec. 1 Twp. 32 S. R. 19 East West

Is Section Regular or _____ Irregular

If Section is Irregular, locate well from nearest corner boundary.
Section corner used: ___ NE ___ NW ___ SE ___ SW

PLAT

(Show location of the well and shade attributable acreage for prorated or spaced wells.)

(Show footage to the nearest lease or unit boundary line.)

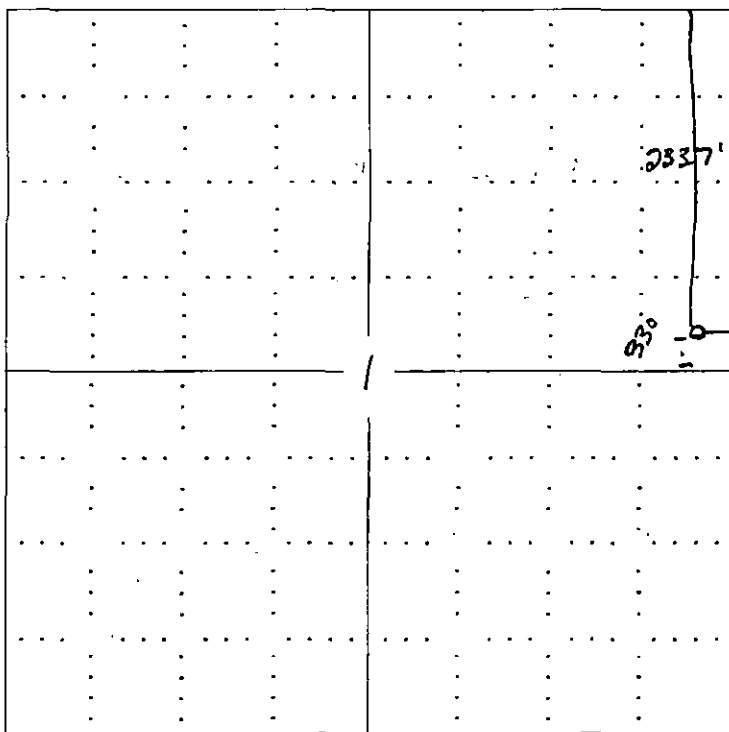

RECEIVED
KANSAS CORPORATION COMMISSION

JUN 19 2002

CONSERVATION DIVISION
WICHITA, KS

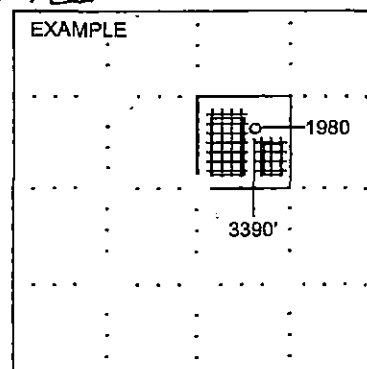

NOTE: In all cases locate the spot of the proposed drilling location.

Comanche Co.

In plotting the proposed location of the well, you must show:

- 1. The manner in which you are using the depicted plat by identifying section lines, i.e. 1 section, 1 section with 8 surrounding sections, 4 sections, etc.
- 2. The distance of the proposed drilling location from the section's south / north and east / west.
- 3. The distance to the nearest lease or unit boundary line.
- 4. If proposed location is located within a prorated or spaced field a certificate of acreage attribution plat must be attached: (CO-7 for oil wells; CG-8 for gas wells).

15-033-21322-0000

THOROUGHbred ASSOCIATES
8100 E. 22nd Street No.
Building 600, Suite F
Wichita, KS 67226
(316) 685-1512

Brosius/Unruh 1

FAX TRANSMISSION

DATE: June 24, 2002

TO: Bob Petersen

Kansas Corporation Commission

FROM: Karri

NUMBER OF PAGES (INCLUDING COVER): -5-

COMMENTS: Bob, attached hereto is a copy of the Declaration of Unitization of
Oil and Gas Leases which will be filed if production is found on the Brosius/Unruh
#1, SE SE NE, Sec. 1-T32S-R19W, Comanche County, KS. Also attached is a copy
Of the staking plat, showing a irregular section. We are actually 330' N from the
center section line and 330' EEL. If you need anything else, please call.

Thanks!

IF YOU HAVE ANY PROBLEMS RECEIVING THIS FAX, CALL 316-685-1512.

15-033-21322-0000

DECLARATION OF UNITIZATION OF OIL AND GAS LEASES

WHEREAS, THOROUGHbred ASSOCIATES, LLC, is the record owner of the Oil and Gas Leases as described in Exhibit "A" attached hereto and by reference made a part hereof, covering lands in Comanche County, Kansas.

WHEREAS, each of said Oil and Gas Leases as described under Exhibit "A" grant the right, power and privilege to the Lessee or his assigns, to pool or combine the acreage covered by each lease so as to form a gas production unit to cover, limit, and restrict only the acreage covered by each lease and not exceeding 320 acres, such rights to be exercised in writing and recorded in the conveyance records of the County in which the pooled area and/or unitized area is located, identifying and describing the pooled acreage and declaring the purpose to unitize the same.

WHEREAS, on the 28th day of June, 2002, THOROUGHbred ASSOCIATES, LLC, commenced the drilling of a test well at approximately the Southeast Quarter of the Southeast Quarter of the Northeast Quarter (SE SE NE) of Section One (1), Township Thirty-Two (32) South, Range Nineteen (19) West, Comanche County, Kansas; and

WHEREAS, said test well was completed as a gas well in paying quantities on or about 2002, and is presently shut-in awaiting pipeline connection.

NOW, THEREFORE, in consideration of the premises and of the original considerations granted and given in connection with the execution and delivery of said Oil and Gas Leases, THOROUGHbred ASSOCIATES, LLC, does hereby pool, consolidate, and unitize, as to the gas rights, the Oil and Gas Leases described in Exhibit "A" as covering the following lands, to-wit:

The Northeast Quarter (SE/4) of Section One (1), Township Thirty-Two (32) South, Range Nineteen (19) West, Comanche County, Kansas, containing 160 acres, more or less, hereinafter Unit Acreage.

THOROUGHbred ASSOCIATES, LLC, does hereby declare and give public notice by the execution and filing of this instrument of its purpose to unitize and pool the said Oil and Gas Leases as to the gas rights therein and thereunder so as to form the unit acreage described last above, and does declare the necessity and advisability of said pooling and unitization in order to properly develop and operate said lease premises so as to promote the conservation of gas in and under and that may be produced from said premises. Production found on the pooled or unit acreage shall be treated as if production is had from each and all of the several leases and royalty provided for under said leases shall be apportioned among the mineral, royalty and overriding royalty owners within the said unit in the proportion that the interest in the minerals under the lands within the unitized area of such owner bears to the full mineral interest under all of the lands in the unitized area.

IN WITNESS WHEREOF, the undersigned has set its hand and seal this 24th day of June, 2002.

THOROUGHbred ASSOCIATES, LLC.

Robert C. Patton, Managing Partner

15-033-21322-0000

Declaration of Unitization
of Oil and Gas Lease
Brosius/Unruh Unit
Page Two

STATE OF KANSAS)
)ss.
COUNTY OF SEDGWICK)

The foregoing instrument was acknowledged before me this 24th day of June, 2002 by Robert C. Patton, Managing Partner of Thoroughbred Associates, LLC.

Notary Public Karri Wolken

My Commission Expires: _____

15-033-21322-0000

EXHIBIT "A"

To that certain Declaration of Unitization of Oil and Gas Leases dated June 24, 2002, covering the NE/4 of Sec. 1; in Township 32 South, Range 19 West, Comanche County, Kansas, hereinafter referred to as Brosius/Unruh Unit.

LESSOR: Ronald G. Brosius and Peggy A. Brosius,
husband and wife
LESSEE: Mull Drilling Co., Inc.
DATE: January 16, 2002
RECORDING DATA: Book 98, Page 469
DESCRIPTION: A 5-acre tract in the NE/4, Section 1;
Township 32 South, Range 19 West, Comanche
County, Kansas

LESSOR: Randy J. Unruh and Shala L. Unruh,
husband and wife
LESSEE:
DATE: August 15, 1999
RECORDING DATA: Book 90, Page 733
DESCRIPTION: NE/4, except a 5-acre tract, Sec. 1;
Township 32 South, Range 19 West, Comanche
County, Kansas

15-033-21322-0000



ROBINSON SERVICES

P.O. Box 2324
Garden City, Kansas 67846
Office/Fax: (620) 276-6159
Cell: (620) 272-1499

060602-Z
PLAT NO.

4448
INVOICE NO.

Thoroughbred Associates

OPERATOR

Comanche County, KS.
COUNTY

32s 19w
Twp. Rng.

LEASE NAME

Main = 2337' PNL, -- 330' FEL
LOCATION SPOT

GR. ELEVATION: Main 2116.3 Alt #1 = 2116.0
Alt #2 = 2114.3



SCALE: 1" = 100'
DATE: 6/6/02
SUPPORTED BY: Burt West
DRAWN BY: Burt West
AUTHORIZED BY: Rob. P. / Roger Unruh / Ron Brosius.

From the North side of Coldwater, KS. (at the intersections of Hwy 183 & Hwy 160 East), Now go .6 mile North on Hwy 183 - Now go 377' West on gravel road into Unruh Sand & Gravel - Now go 300' South into Alt. #1 Loc. -- (Main loc. is 47.5' East & the Alt. #2 is 100' West of Alt. #1 loc. stake)

- * 1 staked Main loc. with a 7" x 1" wood stake with orange paint
- * 1 staked Alt. #1 & Alt. #2 with a 4" x 1" wood stake and also a 5' rebar, but these 2 locations are painted with "blue" paint.
- * All locations are in grass.

