

EFFECTIVE DATE: 2-8-2000

OWWO

FORM MUST BE TYPED

DISTRICT # 1
SEAT: X Yes, No

State of Kansas
NOTICE OF INTENTION TO DRILL

ALL BLANKS MUST BE FILLED

Must be approved by the K.C.C. five (5) days prior to commencing well

Expected Spud Date 2 13 2000
month day year

Spot 180' W & 70' N of
NE NW SE Sec 1 Twp 33 S. Rg 18W East West

OPERATOR: License # 5058 (CORSAIR ENERGY)
Name: Corsair Energy, LC/Lotus Operating, LLC
Address: 209 E. William Ste 220
City/State/Zip: Wichita KS 67202
Contact Person: Jim Collins
Phone: 316.267.7779

2380' FSL... feet from South / North line of Section
1830' FEL... feet from East / West line of Section
IS SECTION X REGULAR IRREGULAR

CONTRACTOR: License #: 5142
Name: Sterling Drilling, Inc.

(NOTE: Locate well on the Section Plat on Reverse Side)
County: Comanche
Lease Name: Crossbar Judith Well #: #1-1 OWWO
Field Name: WC (WILDCAT)
Is this a Prorated/Spaced Field? yes X no
Target Formation(s): Viola
Nearest lease or unit boundary: 510' East
Ground Surface Elevation: 1923 feet MSL
Water well within one-quarter mile: yes X no
Public water supply well within one mile: yes X no
Depth to bottom of fresh water: NA 80
Depth to bottom of usable water: NA 180
Surface Pipe by Alternate: X 1 2
Length of Surface Pipe Planned to be set: 658' 8 5/8"
Length of Conductor pipe required: NA
Projected Total Depth: 5686
Formation at Total Depth: Viola
Water Source for Drilling Operations:
... well ... farm pond X other

Well Drilled For: Well Class: Type Equipment:
... Oil ... Enh Rec ... Infield X Mud Rotary
X Gas ... Storage ... Pool Ext. ... Air Rotary
X OWWO ... Disposal X Wildcat ... Cable
... Seismic; ... # of Holes ... Other
... Other

If OWWO: old well information as follows:
Operator: Helmerich & Payne, Inc.
Well Name: Crossbar Judith #1-1
Comp. Date: 6/30/97 Old Total Depth: 5686

Directional, Deviated or Horizontal wellbore? yes X no
If yes, true vertical depth:
Bottom Hole Location:

DWR Permit #: ...
Will Cores Be Taken?: yes X no
If yes, proposed zone:

AFFIDAVIT

The undersigned hereby affirms that the drilling, completion and eventual plugging of this well will comply with K.S.A. 55-101, et. seq.

It is agreed that the following minimum requirements will be met:

- 1. Notify the appropriate district office prior to spudding of well;
- 2. A copy of the approved notice of intent to drill shall be posted on each drilling rig;
- 3. The minimum amount of surface pipe as specified below shall be set by circulating cement to the top; in all cases surface pipe shall be set through all unconsolidated materials plus a minimum of 20 feet into the underlying formation;
- 4. If the well is dry hole, an agreement between the operator and the district office on plug length and placement is necessary prior to plugging;
- 5. The appropriate district office will be notified before well is either plugged or production casing is cemented in;
- 6. IF AN ALTERNATE II COMPLETION, PRODUCTION PIPE SHALL BE CEMENTED FROM BELOW ANY USABLE WATER TO SURFACE WITHIN 120 DAYS OF SPUD DATE. IN ALL CASES, NOTIFY DISTRICT OFFICE PRIOR TO ANY CEMENTING.

I hereby certify that the statements made herein are true (and to the best of my knowledge and belief).

Date: ...1/28/2000... Signature of Operator or Agent: Jim Collins Title: Managing Member

FOR KCC USE:
API # 15- 033-20736-0001
Conductor pipe required NONE feet
Minimum surface pipe required 658 feet per Alt. (1) X
Approved by: JK 2-3-2000
This authorization expires: 8-3-2000
(This authorization void if drilling not started within 6 months of effective date.)
Spud date: Agent:

RECEIVED
KANSAS CORPORATION COMMISSION

JAN 28 2000
1-28-00
CONSERVATION DIVISION
WICHITA, KS

REMEMBER TO:

- File Drill Pit Application (form CDP-1) with Intent to Drill;
- File Completion Form ACO-1 within 120 days of spud date;
- File acreage attribution plat according to field proration orders;
- Notify appropriate district office 48 hours prior to workover or re-entry;
- Submit plugging report (CP-4) after plugging is completed;
- Obtain written approval before disposing or injecting salt water.

Mail to: Conservation Division, 200 Colorado Derby Building, 202 W. First St., Wichita, Kansas 67202-1286.

33
180

IN ALL CASES PLOT THE INTENDED WELL ON THE PLAT BELOW

PLAT OF ACREAGE ATTRIBUTABLE TO A WELL IN A PRORATED OR SPACED FIELD

If the intended well is in a prorated or spaced field, please fully complete this side of the form. If the intended well is in a prorated or spaced field complete the plat below showing that the well will be properly located in relationship to other wells producing from the common source of supply. Please show all the wells within 1 mile of the boundaries of the proposed acreage attribution unit for gas wells and within 1/2 mile of the boundaries of the proposed acreage attribution unit for oil wells.

API NO. 15- _____
 OPERATOR Corsair Energy, LC/Lotus Operating, LOCATION OF WELL: COUNTY Comanche
 LEASE Crossbar Judith OWWO 2380' FSL feet from south/north line of section
 WELL NUMBER #1-1 1830' FEL feet from east/west line of section
 FIELD WC SECTION 1 TWP 33S RG 18W

NUMBER OF ACRES ATTRIBUTABLE TO WELL 160 IS SECTION X REGULAR or IRREGULAR
 QTR/QTR/QTR OF ACREAGE NE - NW - SE IF SECTION IS IRREGULAR, LOCATE WELL FROM NEAREST
 CORNER BOUNDARY.

Section corner used: NE NW X SE SW
 PLAT

(Show location of the well and shade attributable acreage for prorated or spaced wells.)
 (Show footage to the nearest lease or unit boundary line.)

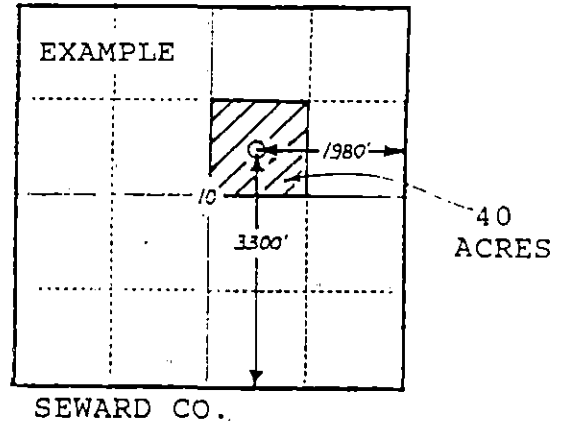
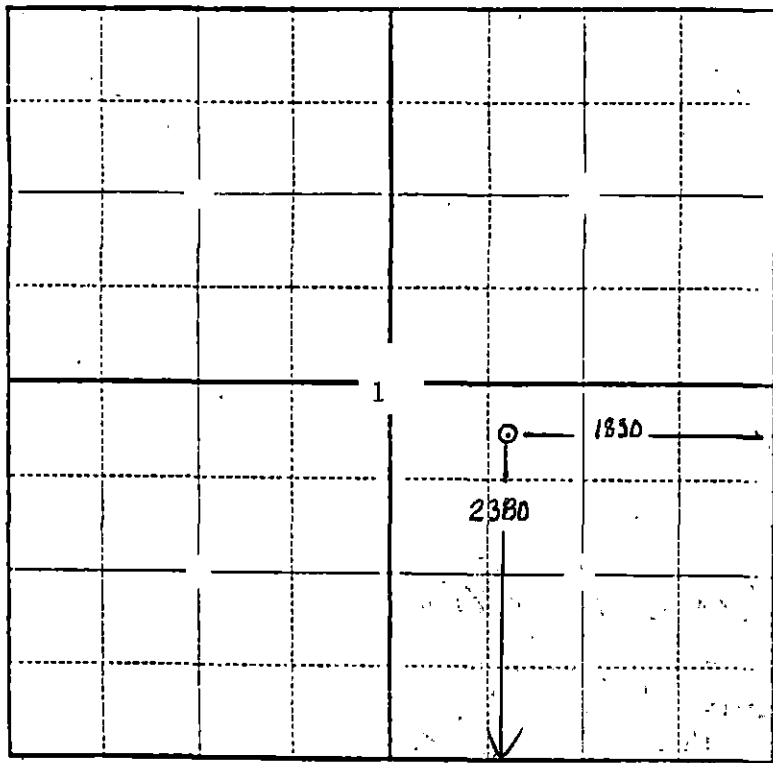

In plotting the proposed location of the well, you must show:

- 1) The manner in which you are using the depicted plat by identifying section lines, i.e. 1 section, 1 section with 8 surrounding sections, 4 sections, etc.;
- 2) the distance of the proposed drilling location from the section's south/north and east/west lines; and
- 3) the distance to the nearest lease or unit boundary line.