

RECEIVED
12-4-02
DEC 04 2002

For KCC Use: 12-9-02
Effective Date: 12-9-02
District #: 1
SGA? Yes No

KANSAS CORPORATION COMMISSION
OIL & GAS CONSERVATION DIVISION

NOTICE OF INTENT TO DRILL **KCC WICHITA**

Must be approved by KCC five (5) days prior to commencing well

Form C-1
September 1999
Form must be Typed
Form must be Signed
All blanks must be Filled

Expected Spud Date December 10 2002
month day year

OPERATOR: License# 32334
Name: Chesapeake Operating, Inc.
Address: P. O. Box 18496
City/State/Zip: Oklahoma City, OK 73154-0496
Contact Person: Jim Gowens, Barbara Bale
Phone: (405) 848-8000

CONTRACTOR: License# Will advise on ACO-1
Name: Will be licensed with KCC

Well Drilled For: Oil Enh Rec Gas OWWO Seismic; # of Holes Other
Well Class: Infield Pool Ext. Wildcat Other
Type Equipment: Mud Rotary Air Rotary Cable

If OWWO: old well information as follows:
Operator: _____
Well Name: _____
Original Completion Date: _____ Original Total Depth: _____
Directional, Deviated or Horizontal wellbore? Yes No
If Yes, true vertical depth: _____
Bottom Hole Location: _____
KCC DKT #: _____

Spot East West
SE - NW - NW Sec. 27 Twp. 32 S. R. 19
990 feet from S / N (circle one) Line of Section
990 feet from S / W (circle one) Line of Section
Is SECTION Regular Irregular?

(Note: Locate well on the Section Plat on reverse side)
County: Comanche
Lease Name: Pierce Well #: 5-27
Field Name: Bird East
Is this a Prorated / Spaced Field? Yes No
Target Information(s): Mississippian/Viola
Nearest Lease or unit boundary: 990'
Ground Surface Elevation: 1967' feet MSL
Water well within one-quarter mile: Yes No
Public water supply well within one mile: Yes No
Depth to bottom of fresh water: 150'
Depth to bottom of usable water: 180'
Surface Pipe by Alternate: 1 2
Length of Surface Pipe Planned to be set: 700'
Length of Conductor Pipe required: NA / NONE
Projected Total Depth: 5950'
Producing Formation Target: Mississippian/Viola
Water Source for Drilling Operations:
Well _____ Farm Pond _____ Other
DWR Permit #: _____
(Note: Apply for Permit with DWR)
Will Cores be taken? Yes No
If Yes, proposed zone: _____

AFFIDAVIT

The undersigned hereby affirms that the drilling, completion and eventual plugging of this well will comply with K.S.A. 55-101, et. seq.
It is agreed that the following minimum requirements will be met:
1. Notify the appropriate district office **prior** to spudding of well;
2. A copy of the approved notice of intent to drill **shall be** posted on each drilling rig;
3. The minimum amount of surface pipe as specified below **shall be set** by circulating cement to the top; in all cases surface pipe **shall be set** through all unconsolidated materials plus a minimum of 20 feet into the underlying formation.
4. If the well is dry hole, an agreement between the operator and the district office on plug length and placement is necessary **prior to plugging**;
5. The appropriate district office will be notified before well is either plugged or production casing is cemented in;
6. If an ALTERNATE II COMPLETION, production pipe shall be cemented from below any usable water to surface within **120 days** of spud date. **In all cases, NOTIFY district office** prior to any cementing.

I hereby certify that the statements made herein are true and to the best of my knowledge and belief.
Date: 11/27/02 Signature of Operator or Agent: Barbara J. Bale Title: Regulatory Analyst
Barbara J. Bale

For KCC Use ONLY
API # 15 - 033-21340-00-00
Conductor pipe required NONE feet
Minimum surface pipe required 200 feet per Alt. 1
Approved by: RJP 12-4-02
This authorization expires: 6-4-02
(This authorization void if drilling not started within 6 months of effective date.)
Spud date: _____ Agent: _____

Remember to:
- File Drill Pit Application (form CDP-1) with Intent to Drill;
- File Completion Form ACO-1 within 120 days of spud date;
- File acreage attribution plat according to field proration orders;
- Notify appropriate district office 48 hours prior to workover or re-entry;
- Submit plugging report (CP-4) after plugging is completed;
- Obtain written approval before disposing or injecting salt water.

27
32
19w

IN ALL CASES PLOT THE INTENDED WELL ON THE PLAT BELOW

Plat of acreage attributable to a well in a prorated or spaced field

If the intended well is in a prorated or spaced field, please fully complete this side of the form. If the intended well is in a prorated or spaced field complete the plat below showing that the well will be properly located in relationship to other wells producing from the common source of supply. Please show all the wells and within 1 mile of the boundaries of the proposed acreage attribution unit for gas wells and within 1/2 mile of the boundaries of the proposed acreage attribution unit for oil wells.

API No. 15 - _____
 Operator: Chesapeake Operating, Inc.
 Lease: Pierce
 Well Number: 5-27
 Field: Bird East

Location of Well: County: Comanche
 _____ 990 _____ feet from S N (circle one) Line of Section
 _____ 990 _____ feet from E W (circle one) Line of Section
 Sec. 27 Twp. 32 S. R. 19 East West

Number of Acres attributable to well: _____ 640
 QTR / QTR / QTR of acreage: _____ - _____ - All

Is Section X Regular or _____ Irregular

If Section is Irregular, locate well from nearest corner boundary.
 Section corner used: NE NW SE SW

PLAT

*(Show location of the well and shade attributable acreage for prorated or spaced wells.)
 (Show footage to the nearest lease or unit boundary line.)*

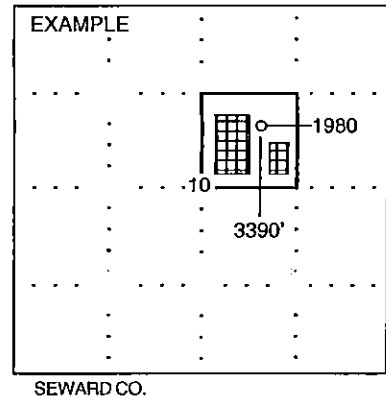
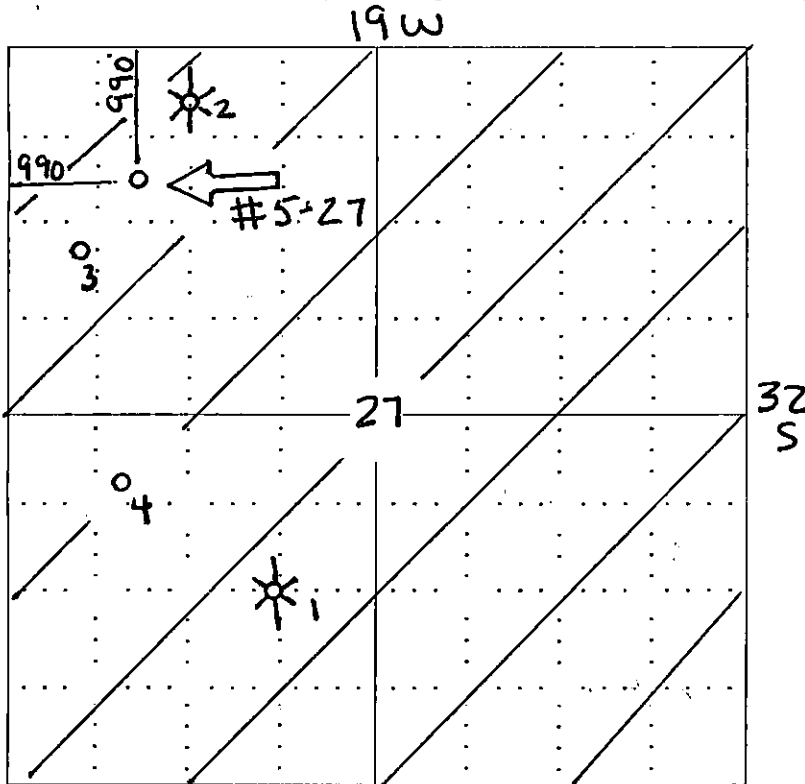

NOTE: In all cases locate the spot of the proposed drilling location.
COMANCHE Co.

In plotting the proposed location of the well, you must show:

1. The manner in which you are using the depicted plat by identifying section lines, i.e. 1 section, 1 section with 8 surrounding sections, 4 sections, etc.
2. The distance of the proposed drilling location from the section's south / north and east / west.
3. The distance to the nearest lease or unit boundary line.
4. If proposed location is located within a prorated or spaced field a certificate of acreage attribution plat must be attached: (CO-7 for oil wells; CG-8 for gas wells).