

STATE OF KANSAS
STATE CORPORATION COMMISSION

Form CP-4

Give All Information Completely
Make Required Affidavit
Mail or Deliver Report to:
Conservation Division
State Corporation Commission
212 No. Market
Wichita, Kansas

WELL PLUGGING RECORD

COMANCHE County, Sec. 27 Twp. 32s Rge. 17 (E) (W)

Location as "NE/CNW/SW" or footage from lines C NE NE

Lease Owner PETROLEUM, INC.

Lease Name GREGG UNIT Well No. B-1

Office Address R.R. #2, GREAT BEND, KANSAS

Character of Well (completed as Oil, Gas or Dry Hole) DRY HOLE

Date well completed JULY 1 19 68

Application for plugging filed JULY 1 19 68

Application for plugging approved JULY 1 19 68

Plugging commenced JULY 1 19 68

Plugging completed JULY 1 19 68

Reason for abandonment of well or producing formation NO PRODUCIBLE ZONE

If a producing well is abandoned, date of last production NONE 19

Was permission obtained from the Conservation Division or its agents before plugging was commenced? YES

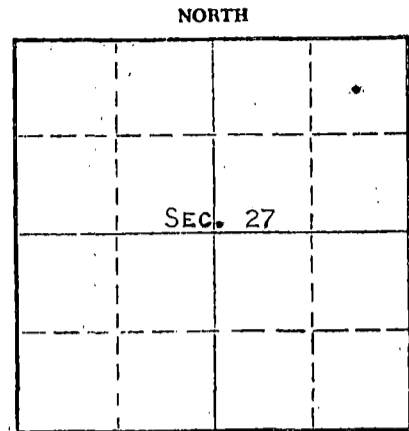

Locate well correctly on above Section Plat

Name of Conservation Agent who supervised plugging of this well R. J. WARREN

Producing formation _____ Depth to top _____ Bottom _____ Total Depth of Well 5800 Feet

Show depth and thickness of all water, oil and gas formations.

OIL, GAS OR WATER RECORDS

CASING RECORD

FORMATION	CONTENT	FROM	TO	SIZE	PUT IN	PULLED OUT
				8-5/8"	491'	NONE

Describe in detail the manner in which the well was plugged, indicating where the mud fluid was placed and the method or methods used in introducing it into the hole. If cement or other plugs were used, state the character of same and depth placed, from _____ feet to _____ feet for each plug set.

MUD TO 300', WOODEN PLUG, 1/2 SACK HULLS, 25 SACKS CEMENT, MUD TO 40', WOODEN PLUG, 1/2 SACK HULLS, 10 SACKS CEMENT ON TOP OF PLUG TO BASE OF WELL CELLAR.

RECEIVED
STATE CORPORATION COMMISSION
JUL 8 - 68
1968
CONSERVATION DIVISION
Wichita, Kansas

(If additional description is necessary, use BACK of this sheet)

Name of Plugging Contractor GARVEY DRILLING COMPANY

Address R.R. #2, GREAT BEND, KANSAS

STATE OF KANSAS, COUNTY OF BARTON, ss.

MONTE CHADD (employee of owner) or (owner) of the above-described well, being first duly sworn on oath, says: That I have knowledge of the facts, statements, and matters herein contained and the log of the above-described well as filed and that the same are true and correct. So help me God. MONTE CHADD, DIST. PROD. SUPT.

(Signature) *Monte Chadd*

R.R. #2, GREAT BEND, KANSAS (Address)

SUBSCRIBED AND SWORN to before me this 2 day of JULY, 19 68

My commission expires MAY 28, 1969

Richard H. Dumbler
Notary Public.

WELL LOG

COMPANY Petroleum, Inc.

SEC. 27 T. 32S. R. 17W

FARM Gregg Unit

NO. B-1

LOG. NE NE

TOTAL DEPTH 5800'

COUNTY Comanche

COMM. 6-6-68

COMP. 7-1-68

CONTRACTOR Garvey Drilling Company

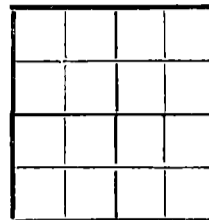

CASING 8 5/8" @ 491' w/400 SX

ELEVATION 2061' KB

PRODUCTION D & A

FIGURES INDICATE BOTTOM OF FORMATIONS

- 130' Sand
- 305' Red Bed
- 355' Anhydrite
- 1069' Red Bed
- 1162' Anhydrite
- 1574' Shale
- 2027' Shale and Shells
- 2270' Shale and Lime
- 2515' Lime and Shale
- 2920' Lime
- 3180' Lime and Shale
- 3375' Lime
- 3485' Shale and Lime
- 3715' Lime and Shale
- 3820' Lime
- 4450' Lime and Shale
- 4645' Lime
- 4715' Lime and Chalky Lime
- 5004' Lime
- 5027' Lime and Shale
- 5093' Lime
- 5177' Lime and Shale
- 5220' Lime
- 5494' Lime and Shale
- 5522' Lime
- 5568' Lime and Shale
- 5632' Lime
- 5686' Cherty Lime
- 5716' Lime and Chert
- 5763' Chert and Sand
- 5769' Sandy Dolomite
- 5800' Sand
- 5800' RTD

RECEIVED
 STATE CORPORATION COMMISSION
 JUL 8 - 68
 1968
 CONSERVATION DIVISION
 Wichita, Kansas

State of Kansas

County of Barton

ss

I, Sam N. Stephens of Garvey Drilling Company

upon oath state the above and foregoing is a true and correct copy of the log of the Gregg Unit B-1 well.

Subscribed and sworn to before me this 5th day of July 1968

My Commission Expires: May 28, 1969

NOTARY PUBLIC