

STATE OF KANSAS  
 STATE CORPORATION COMMISSION  
 CONSERVATION DIVISION  
 P. O. BOX 17027  
 WICHITA, KANSAS 67217

FORM CP-4

WELL PLUGGING RECORD

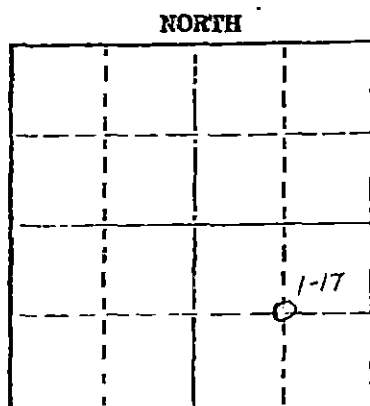

Locate well correctly on above Section Plat

Comanche County. Sec. 17 Twp. 33s Rge. 20 (E) W (W)  
 Location as "NE/CNWESW" or footage from lines. 1320' FS & EL's of Section  
 Lease Owner Northern Natural Gas Co.  
 Lease Name Shrauner Well No. 1-17  
 Office Address P.O. Box 35288 Tulsa, Oklahoma 74135  
 Character of Well (completed as Oil, Gas or Dry Hole) Dry Hole  
 Date well completed January 15 1978  
 Application for plugging filed January 16 1978  
 Application for plugging approved 1978  
 Plugging commenced January 16 1978  
 Plugging completed January 16 1978  
 Reason for abandonment of well or producing formation Dry Hole

If a producing well is abandoned, date of last production 1978  
 Was permission obtained from the Conservation Division or its agents before plugging was commenced? Yes

Name of Conservation Agent who supervised plugging of this well Bill Owens Box 369 Pratt, Kansas  
 Producing formation \_\_\_\_\_ Depth to top \_\_\_\_\_ Bottom \_\_\_\_\_ Total Depth of Well 7640 Feet  
 Show depth and thickness of all water, oil and gas formations.

OIL, GAS OR WATER RECORDS

CASING RECORD

FORMATION	CONTENT	FROM	TO	SIZE	PUT IN	PULLED OUT
				20"	60'	None
				8 3/8"	650'	None

Describe in detail the manner in which the well was plugged, indicating where the mud fluid was placed and the method or methods used in introducing it into the hole. If cement or other plugs were used, state the character of same and depth placed, from \_\_\_\_\_ feet to \_\_\_\_\_ feet for each plug set.

Heavy mud from T.D. to 600'  
 40 sacks from 600' to 400'  
 14 sacks from 40' to surface  
 3 sacks in rat hole  
 3 sacks in mouse hole  
 Heavy mud placed between plugs

(If additional descriptions is necessary, use BACK of this sheet)

Name of Plugging Contractor Rine Drilling Co.  
 Address Woodward, Oklahoma 73801

STATE OF \_\_\_\_\_ COUNTY OF \_\_\_\_\_, KS.

(employee of owner) or (owner or operator) of the above-described well, being first duly sworn on oath, says: That I have knowledge of the facts, statements, and matters herein contained and the log of the above-described well as filed and that the same are true and correct. So help me God.

(Signature) Robert W. Ward

Subscribed and sworn to before me this 23 day of January 1978

My commission expires February 12, 1978  
 Notary Public: Norma F. Martin

RECEIVED  
 STATE CORPORATION COMMISSION  
 JAN 26 1978  
 CONSERVATION DIVISION  
 Wichita, Kansas



Operator  
Northern Natural Gas Company

DESIGNATE TYPE OF COMP.: OIL, GAS,  
DRY HOLE, SWDW, ETC.:

Well No. 1-17 Lease Name Shrauner

Dry Hole

S 17 T 33 R 20 E  
W

**WELL LOG**

Show all important zones of porosity and contents thereof; cored intervals, and all drill-stem tests, including depth interval tested, cushion used, time tool open, flowing and shut-in pressures, and recoveries.

SHOW GEOLOGICAL MARKERS, LOGS RUN,  
OR OTHER DESCRIPTIVE INFORMATION.

FORMATION DESCRIPTION, CONTENTS, ETC.	TOP	BOTTOM	NAME	DEPTH
Ran Schlumberger DIL & FDC/CNL			Herington- Krider	2349
			Winfield	2420
			Base Heebner Shale	4189
			Lansing-K.C.	4400
			Base Lansing- Kansas City	4741
			Marathon	4875
			Cherokee	5061
			Morrow (Nt. (No Morrow)	5159
			Mississippian	5170
			Cowley Facies	5871
			Viola	6302
			1st Simpson	6518
			2nd Simpson	6626
			Arbuckle	6637
		Reagan	7588	

USE ADDITIONAL SHEETS, IF NECESSARY, TO COMPLETE WELL RECORD.

Date Received

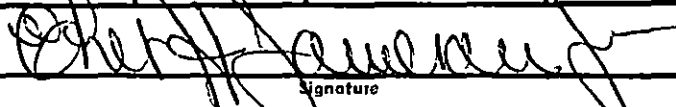
  
Signature  
Director, Production & Engineering  
Title  
January 23, 1978  
Date