

STATE OF KANSAS
STATE CORPORATION COMMISSION
200 Colorado Derby Building
Wichita, Kansas 67202

WELL PLUGGING RECORD
K.A.R.-82-3-117

API NUMBER 15-833-2011-0000

LEASE NAME Merrill

WELL NUMBER #1

660 Ft. from N Section Line

1650 Ft. from W Section Line

SEC. 4 TWP. 34S RGE. 16W (E) or (W)

COUNTY Comanche Cty., KS

Date Well Completed 1-31-72

Plugging Commenced _____

Plugging Completed 4-17-90

TYPE OR PRINT
NOTICE: Fill out completely
and return to Cons. Div.
office within 30 days.

LEASE OPERATOR Buttonwood Petroleum, Inc.

ADDRESS 9 E. 4th St., Ste. 605 Tulsa, OK 74103

PHONE#(918) 587-7585 OPERATORS LICENSE NO. 8222

Character of Well Gas

(Oil, Gas, D&A, SWD, Input, Water Supply Well)

The plugging proposal was approved on 4/16/90 (date)

by Richard Lacey (KCC District Agent's Name).

Is ACO-1 filled? Yes If not, is well log attached? _____

Producing Formation Mississippian Depth to Top 4892 Bottom 4921 T.D. 5050

Show depth and thickness of all water, oil and gas formations.

OIL, GAS OR WATER RECORDS | CASING RECORD

Formation	Content	From	To	Size	Put In	Pulled out
				8 5/8	550'	-0-
Mississippi	Gas (Depleted)	4892	4921	4 1/2	5049'	3200

Describe in detail the manner in which the well was plugged, indicating where the mud fluid was placed and the method or methods used in introducing it into the hole. If cement or other plugs were used, state the character of same and depth placed, from feet to feet each set.

Pumped 25 SK plugs thru tubing - From 5,450' To 4,500'

Pumped 40 SK cement plugs - From 700' To 575'

Pumped 50 SK cement plugs - From 550' to 400' in 8 5/8"

Pumped 10 SK cement plugs - From 33' to 3' - cut off well head - capped well with I.D.

(If additional description is necessary, use BACK of this form.)

Name of Plugging Contractor G & N Inc. D/B/A Proctor's Casing Pullers License No. 30234
Expires 10/30/90

Address 6209 Aluma Valley Drive - Oklahoma City, OK 73121

NAME OF PARTY RESPONSIBLE FOR PLUGGING FEES: Buttonwood Petroleum Inc.

STATE OF Oklahoma COUNTY OF Tulsa, ss.

Stanley M. Scott, Vice President, Production (Employee of Operator) or (Operator) of above-described well, being first duly sworn on oath, says: That I have knowledge of the facts, statements, and matters herein contained and the log of the above-described well as filed that the same are true and correct, so help me God.

(Signature) Stanley M. Scott - VP.

(Address) Buttonwood Petroleum, Inc. 9 E. 4th St., Ste. 605

Tulsa, OK 74103
day of April, 19 90

APR 25 1990
4-25-90
SUBSCRIBED AND SWORN
CONSERVATION DIVISION
Wichita, Kansas

Marcia A. Magnuson

Notary Public
Marcia A. Magnuson

My Commission Expires: 11-09-92

15-033-2011-0000

KANSAS CORPORATION COMMISSION

WELL RECORD

(Mail to Kansas Geological Survey, 4150 Monroe Street, Wichita, Kansas 67209)

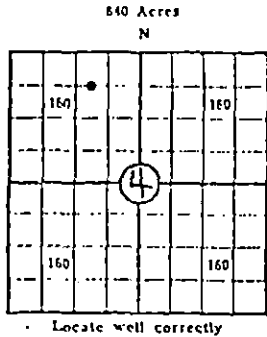

Lease Name: Merrill Well No. 1
 Well Located: 660' FNL & 1650' FWL
SEC 4 TWP 34S RGE 16W
 Operator: Cotton Petroleum Company
 Address: 2121 South Columbia, Suite 600, Tulsa, Okla. 74114
 Elevation: Ground 1669 D.F. K.B.
 Type Well: (Oil, gas, dry hole) Gas

Drilling Commenced: 1-9 1972 Drilling Completed: 1-20 1972
 Well Completed: 1-31 1972 Total Depth 5044'
 Initial Production: _____

Casing Record

Size: 8 5/8" Set at 485' Size: _____ Set at _____
 Size: 4 1/2" Set at 5049' Size: _____ Set at _____

Liner Record

Size: None Set from _____ To _____

Cementing

<u>Casing Size</u>	<u>Sacks</u>	<u>Type Cement and Additives</u>
<u>8 5/8"</u>	<u>350</u>	<u>200 sx. Reg., 6% gel, 3% CaCl, plug 150 sx. Reg. 3% CaCl.</u>
<u>4 1/2"</u>	<u>360</u>	<u>50/50 Pozmix</u>

15-033-2011-0000

Show Drill Stem Tests,
Well Stimulation and
Production Tests

Formation	Top	Bottom	
Mississippi	4892	4921	Spotted 500 gals. 15% spearhead acid
Mississippi	4892	4921	Ran 4 pt. test; CAOF - 5.8 MMCF/D