



KANSAS CORPORATION COMMISSION 1085765
 OIL & GAS CONSERVATION DIVISION

Form ACO-4
 Form must be typed
 March 2009

APPLICATION FOR COMMINGLING OF **Commingling ID # CO071206**
 PRODUCTION (K.A.R. 82-3-123) OR FLUIDS (K.A.R. 82-3-123a)

OPERATOR: License # 33343
 Name: PostRock Midcontinent Production LLC
 Address 1: Oklahoma Tower
 Address 2: 210 Park Ave, Ste 2750
 City: OKLAHOMA CITY State: OK Zip: 73102 + _____
 Contact Person: CLARK EDWARDS
 Phone: (620) 432-4200

API No. 15 - 15-133-26200-00-01
 Spot Description: _____
N2 S2 NE SE Sec. 15 Twp. 28 S. R. 20 East West
1830 Feet from North / South Line of Section
660 Feet from East / West Line of Section
 County: Neosho
 Lease Name: GROSDIDIER FRANCIS E Well #: 15-1

1. Name and upper and lower limit of each production interval to be commingled:
- | | |
|--------------------------------|-------------------------|
| Formation: <u>RIVERTON</u> | (Perfs): <u>710-712</u> |
| Formation: <u>BARTLESVILLE</u> | (Perfs): <u>476-480</u> |
| Formation: _____ | (Perfs): _____ |
| Formation: _____ | (Perfs): _____ |
| Formation: _____ | (Perfs): _____ |

2. Estimated amount of fluid production to be commingled from each interval:
- | | | | |
|--------------------------------|----------------|-----------------|-----------------|
| Formation: <u>RIVERTON</u> | BOPD: <u>0</u> | MCFPD: <u>0</u> | BWPD: <u>40</u> |
| Formation: <u>BARTLESVILLE</u> | BOPD: <u>3</u> | MCFPD: <u>0</u> | BWPD: <u>20</u> |
| Formation: _____ | BOPD: _____ | MCFPD: _____ | BWPD: _____ |
| Formation: _____ | BOPD: _____ | MCFPD: _____ | BWPD: _____ |
| Formation: _____ | BOPD: _____ | MCFPD: _____ | BWPD: _____ |

3. Plat map showing the location of the subject well, all other wells on the subject lease, and all wells on offsetting leases within a 1/2 mile radius of the subject well, and for each well the names and addresses of the lessee of record or operator.
4. Signed certificate showing service of the application and affidavit of publication as required in K.A.R. 82-3-135a.

For Commingling of PRODUCTION ONLY, include the following:

5. Wireline log of subject well. Previously Filed with ACO-1: Yes No
6. Complete Form ACO-1 (*Well Completion form*) for the subject well.

For Commingling of FLUIDS ONLY, include the following:

7. Well construction diagram of subject well.
8. Any available water chemistry data demonstrating the compatibility of the fluids to be commingled.

AFFIDAVIT: I am the affiant and hereby certify that to the best of my current information, knowledge and personal belief, this request for commingling is true and proper and I have no information or knowledge, which is inconsistent with the information supplied in this application.

Submitted Electronically

KCC Office Use Only	
<input type="checkbox"/> Denied	<input checked="" type="checkbox"/> Approved
15-Day Periods Ends: <u>7/14/2012</u>	
Approved By: <u>Rick Hestermann</u>	Date: <u>07/16/2012</u>

Protests may be filed by any party having a valid interest in the application. Protests must be in writing and comply with K.A.R. 82-3-135b and must be filed within 15 days of publication of the notice of application.

POSTROCK



Current Completion

WELL : Grosdidier, Francis E 15-1
FIELD : Cherokee Basin CBM
STATE : Kansas
COUNTY : Neosho

SPUD DATE : 10/25/2004
COMP. Date :
API: 15-133-26200-00-00

LOCATION: 15-28S-20E (NE, SE)
ELEVATION: GL - 924'

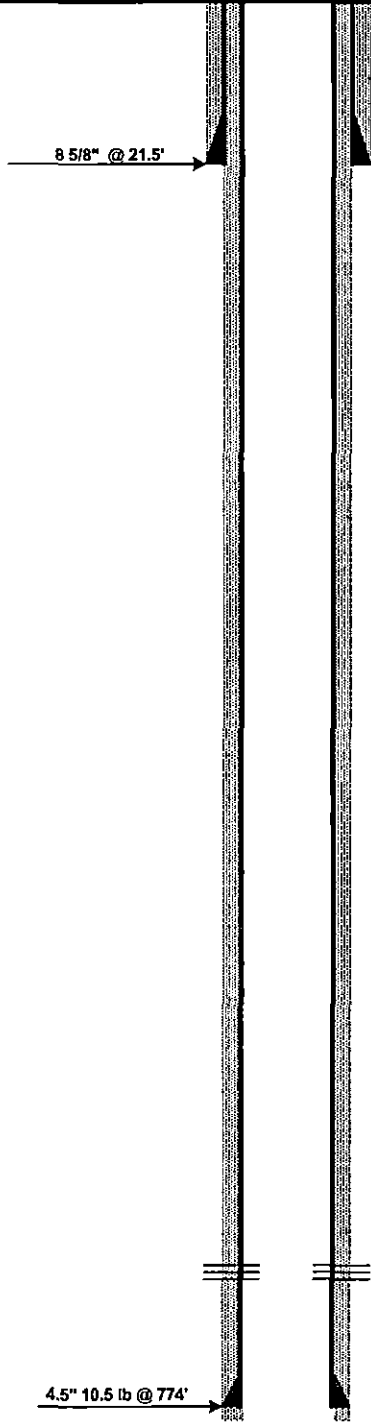

Wellhead/Surface Equipment

Tree Connection	
Tree	
Tubing Head	
Bradenhead	
Pumping Unit	
Compressor	

Tubular Detail

Size	Weight	Grade	Cap(bbl/ft)	Date	Depth
8 5/8"				2004	21.5'
4 1/2"	10.5 lb			2004	779'

Downhole Equipment Detail

Completion Data

Original as GAS Well

Perforations

<u>Original Completion</u>
- Riverton 710-712 (9) 12/1/2005 No stimulation reported
- Bartlesville 476-480 5/4/2012 Frac notes stated pumped way too much 20/40. - 10,900 lbs 20/40 sand - 276 bbls
Acid Treat 2/17/2012 - 250 gals 15%

PREPARED BY: POSTROCK

DATE: June, 2012

APPROVED BY: _____

DATE: _____

POSTROCK



LEGEND

PostRock®

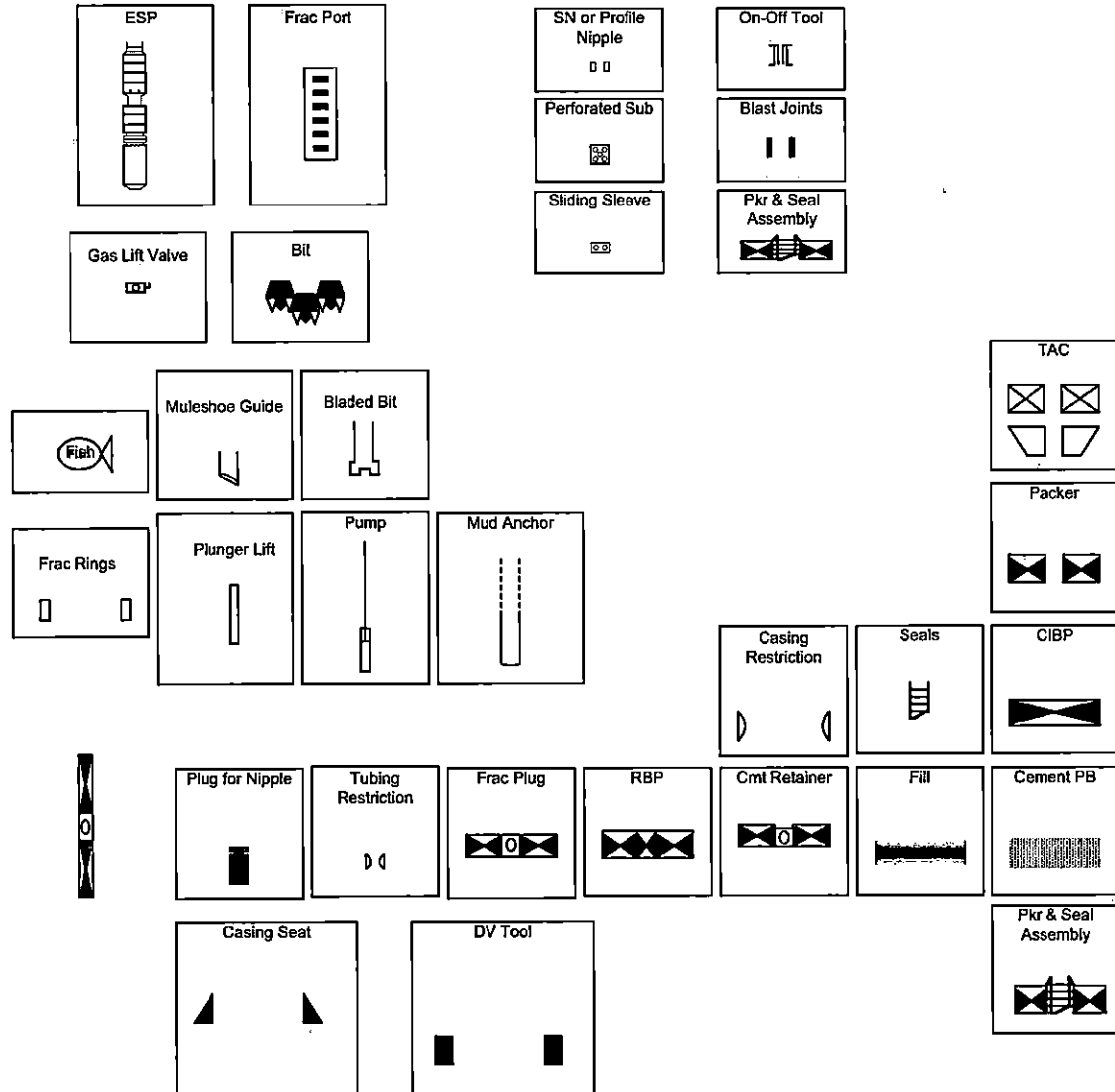

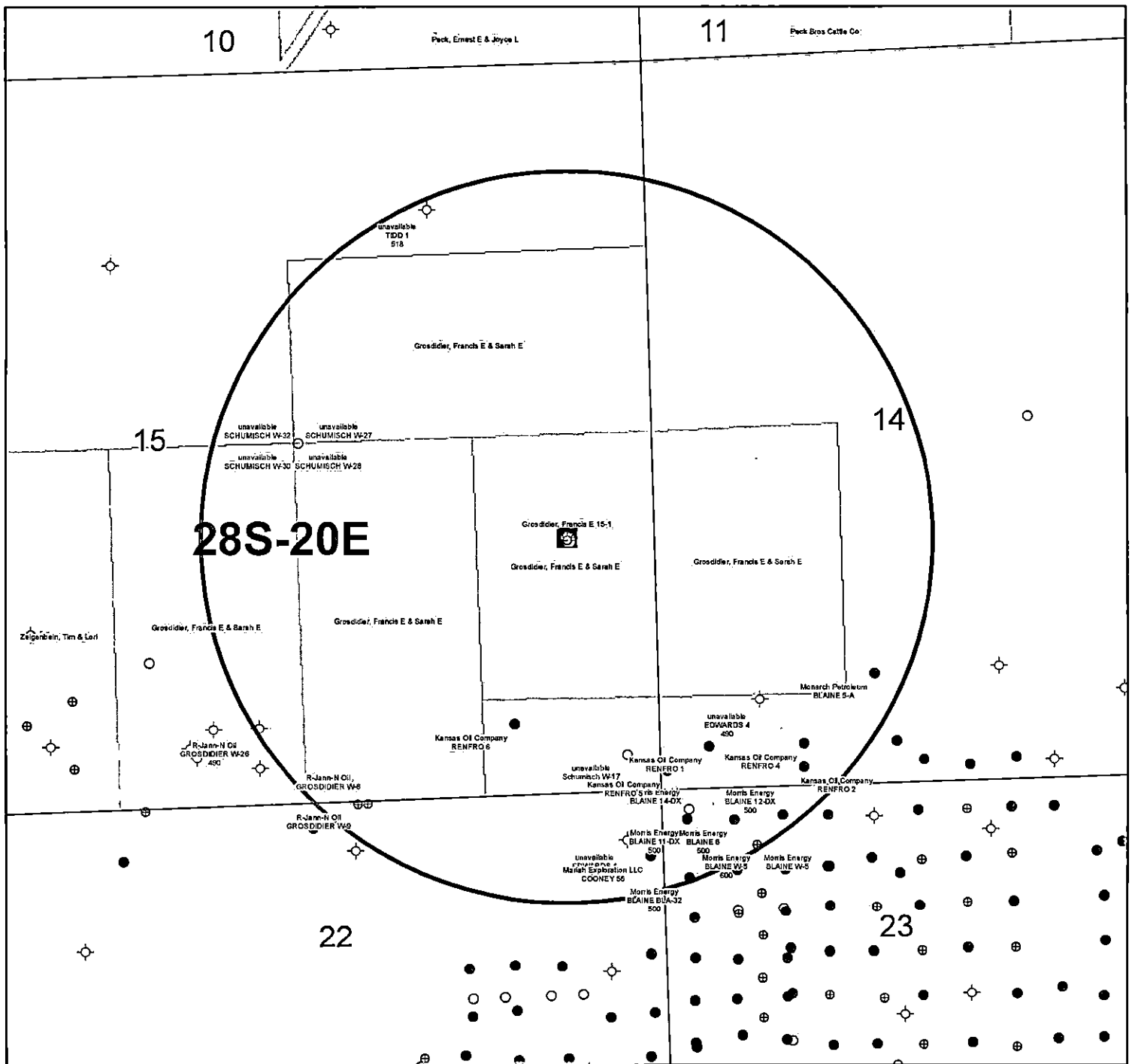

28S-20E

KGS STATUS	
◇	DA/PA
⊗	EOR
☆	GAS
△	INJ/SWD
●	OIL
★	OIL/GAS
○	OTHER

Grostdier, Francis E 15-1
 15-28S-20E
 1" = 1,000'

KANSAS CORPORATION COMMISSION
OIL & GAS CONSERVATION DIVISION

ORIGINAL Form ACO-1
September 1999
Form Must Be Typed

WELL COMPLETION FORM
WELL HISTORY - DESCRIPTION OF WELL & LEASE

Operator: License # 33344
Name: Quest Cherokee, LLC RECEIVED
Address: 211 W. 14th Street KANSAS CORPORATION COMMISSION
City/State/Zip: Chanute, KS 66720 APR 18 2006
Purchaser: Bluestem Pipeline, LLC CONSERVATION DIVISION
Operator Contact Person: Gary Laswell WICHITA, KS
Phone: (620) 431-9500
Contractor: Name: M.O.K.A.T.
License: 5831
Wellsite Geologist: Michael Ebers
Designate Type of Completion:
 New Well Re-Entry Workover
 Oil SWD SLOW Temp. Abd.
 Gas ENHR SIGW
 Dry Other (Core, WSW, Expl., Cathodic, etc)
If Workover/Re-entry: Old Well Info as follows:
Operator: _____
Well Name: _____
Original Comp. Date: _____ Original Total Depth: _____
 Deepening Re-perf. Conv. to Enhr./SWD
 Plug Back _____ Plug Back Total Depth _____
 Commingled _____ Docket No. _____
 Dual Completion _____ Docket No. _____
 Other (SWD or Enhr.?) _____ Docket No. _____
10/25/04 10/26/04 11/13/04
Spud Date or Date Reached TD Completion Date or
Recompletion Date Recompletion Date

API No. 15 - 133-26200-00-00
County: Neosho
N2 S2 - ne - se Sec. 15 Twp. 28 S. R. 20 East West
1830 feet from S / N (circle one) Line of Section
660 feet from E / W (circle one) Line of Section
Footages Calculated from Nearest Outside Section Corner:
(circle one) NE SE NW SW
Lease Name: Grosdidier, Francis E. Well #: 15-1
Field Name: Cherokee Basin CBM
Producing Formation: Riverton
Elevation: Ground: 924 Kelly Bushing: n/a
Total Depth: 779 Plug Back Total Depth: 773.85
Amount of Surface Pipe Set and Cemented at 21.4 Feet
Multiple Stage Cementing Collar Used? Yes No
If yes, show depth set _____ Feet
If Alternate II completion, cement circulated from 773.82
feet depth to Surface w/ 120 sx cmt.
ALT II WHM 8-25-06
Drilling Fluid Management Plan
(Data must be collected from the Reserve Pit)
Chloride content _____ ppm Fluid volume _____ bbls
Dewatering method used _____
Location of fluid disposal if hauled offsite: _____
Operator Name: _____
Lease Name: _____ License No.: _____
Quarter _____ Sec. _____ Twp. _____ S. R. _____ East West
County: _____ Docket No.: _____

INSTRUCTIONS: An original and two copies of this form shall be filed with the Kansas Corporation Commission, 130 S. Market - Room 2078, Wichita, Kansas 67202, within 120 days of the spud date, recompletion, workover or conversion of a well. Rule 82-3-130, 82-3-106 and 82-3-107 apply. Information of side two of this form will be held confidential for a period of 12 months if requested in writing and submitted with the form (see rule 82-3-107 for confidentiality in excess of 12 months). One copy of all wireline logs and geologist well report shall be attached with this form. ALL CEMENTING TICKETS MUST BE ATTACHED. Submit CP-4 form with all plugged wells. Submit CP-111 form with all temporarily abandoned wells.

All requirements of the statutes, rules and regulations promulgated to regulate the oil and gas industry have been fully complied with and the statements herein are complete and correct to the best of my knowledge.

Signature: [Signature]
Title: Head of Operations Date: 4/17/06
Subscribed and sworn to before me this 17th day of April,
20 06.
Notary Public: Jennifer R. Lamann
Date Commission Expires: July 30, 2009

KCC Office Use ONLY
 Letter of Confidentiality Received
If Denied, Yes Date: _____
 Wireline Log Received
 Geologist Report Received
 UIC Distribution

JENNIFER LAMANN
Notary Public - State of Kansas
My Appt. Expires July 30, 2009

Operator Name: Quest Cherokee, LLC Lease Name: Grosdidier, Francis E. Well #: 15-1
 Sec. 15 Twp. 28 S. R. 20 East West County: Neosho

INSTRUCTIONS: Show important tops and base of formations penetrated. Detail all cores. Report all final copies of drill stems tests giving interval tested, time tool open and closed, flowing and shut-in pressures, whether shut-in pressure reached static level, hydrostatic pressures, bottom hole temperature, fluid recovery, and flow rates if gas to surface test, along with final chart(s). Attach extra sheet if more space is needed. Attach copy of all Electric Wireline Logs surveyed. Attach final geological well site report.

Drill Stem Tests Taken <input type="checkbox"/> Yes <input checked="" type="checkbox"/> No <i>(Attach Additional Sheets)</i> Samples Sent to Geological Survey <input type="checkbox"/> Yes <input checked="" type="checkbox"/> No Cores Taken <input type="checkbox"/> Yes <input checked="" type="checkbox"/> No Electric Log Run <input checked="" type="checkbox"/> Yes <input type="checkbox"/> No <i>(Submit Copy)</i> List All E. Logs Run: Comp. Density/Neutron Log Dual Induction Log Gamma Ray/Neutron Log	<input checked="" type="checkbox"/> Log Formation (Top), Depth and Datum <input type="checkbox"/> Sample Name Top Datum See attached <div style="text-align: center;"> RECEIVED KANSAS CORPORATION COMMISSION APR 18 2006 CONSERVATION DIVISION WICHITA, KS </div>
--	---

CASING RECORD <input type="checkbox"/> New <input type="checkbox"/> Used							
Report all strings set-conductor, surface, intermediate, production, etc.							
Purpose of String	Size Hole Drilled	Size Casing Set (In O.D.)	Weight Lbs. / Ft.	Setting Depth	Type of Cement	# Sacks Used	Type and Percent Additives
Surface	12-1/4"	8-5/8"	20#	21.4'	"A"	4	
Production	6-3/4"	4-1/2"	10.5#	773.85'	"A"	120	

ADDITIONAL CEMENTING / SQUEEZE RECORD				
Purpose:	Depth Top Bottom	Type of Cement	#Sacks Used	Type and Percent Additives
<input type="checkbox"/> Perforate <input type="checkbox"/> Protect Casing <input type="checkbox"/> Plug Back TD <input type="checkbox"/> Plug Off Zone				

Shots Per Foot	PERFORATION RECORD - Bridge Plugs Set/Type Specify Footage of Each Interval Perforated	Acid, Fracture, Shot, Cement Squeeze Record <i>(Amount and Kind of Material Used)</i>	Depth
4	Waiting on pipeline		

TUBING RECORD		Size	Set At	Packer At	Liner Run	<input type="checkbox"/> Yes <input type="checkbox"/> No		
Date of First, Resumed Production, SWD or Enhr.			Producing Method					
			<input type="checkbox"/> Flowing <input type="checkbox"/> Pumping <input type="checkbox"/> Gas Lift <input type="checkbox"/> Other (Explain)					
Estimated Production Per 24 Hours	Oil	Bbls.	Gas	Mcf	Water	Bbls.	Gas-Oil Ratio	Gravity

Disposition of Gas Vented Sold Used on Lease *(If vented, Submit ACO-18.)*

METHOD OF COMPLETION

Open Hole Perf. Dually Comp. Commingled
 Other (Specify) _____

Production Interval

	A	B	C	D	E	F	G	H	I	J	K
1	Produced Fluids #										
2	Parameters	Units	Input	Input	Input	Input	Input		Click here to run SSP Goal Seek SSP		Click
3	Select the brines	Select fluid	<input type="checkbox"/>	<input type="checkbox"/>	<input type="checkbox"/>	<input type="checkbox"/>	<input type="checkbox"/>	Mixed brine:			Click
4	Sample ID	by checking						Cell H28 is			Click
5	Date	the box(es),	3/19/2012	3/4/2012	3/14/2012	1/20/2012	1/20/2012	STP calc. pH.			Click
6	Operator	Row 3	PostRock	PostRock	PostRock	PostRock	PostRock	Cells H35-38	Click		
7	Well Name		Ward Feed	Ward Feed	Clinesmith	Clinesmith	Clinesmith	are used in	Click		
8	Location		#34-1	#4-1	#5-4	#1	#2	mixed brines	Click		
9	Field		CBM	CBM	Bartles	Bartles	Bartles	calculations.	Click		
10	Na ⁺	(mg/l)*	19,433.00	27,381.00	26,534.00	25,689.00	24,220.00	24,654.20	Initial(BH)	Final(WH)	S/SR (Final-Initial)
11	K ⁺ (if not known =0)	(mg/l)						0.00	Saturation Index values		
12	Mg ²⁺	(mg/l)	1,096.00	872.00	1,200.00	953.00	858.00	995.91	Calcite		
13	Ca ²⁺	(mg/l)	1,836.00	2,452.00	2,044.00	1,920.00	1,948.00	2,040.23	-0.73	-0.60	0.13
14	Sr ²⁺	(mg/l)						0.00	Barite		
15	Ba ²⁺	(mg/l)						0.00	Halite		
16	Fe ²⁺	(mg/l)	40.00	21.00	18.00	82.00	90.00	50.21	Gypsum		
17	Zn ²⁺	(mg/l)						0.00	-1.77	-1.80	-0.03
18	Pb ²⁺	(mg/l)						0.00	Anhydrite		
19	Cl ⁻	(mg/l)	36,299.00	48,965.00	47,874.00	45,632.00	43,147.00	44,388.44	-3.19	-3.18	0.00
20	SO ₄ ²⁻	(mg/l)	1.00	1.00	8.00	1.00	1.00	2.40	Hemihydrate		
21	F ⁻	(mg/l)						0.00	-3.96	-3.90	0.06
22	Br ⁻	(mg/l)						0.00	Celestite		
23	SiO ₂	(mg/l) SiO ₂						0.00	-3.47	-3.36	0.12
24	HCO ₃ Alkalinity**	(mg/l as HCO ₃)	190.00	234.00	259.00	268.00	254.00	241.03	Iron Sulfide		
25	CO ₃ Alkalinity	(mg/l as CO ₃)							Zinc Sulfide		
26	Carboxylic acids**	(mg/l)						0.00	Calcium fluoride		
27	Ammonia	(mg/L) NH ₃						0.00	-0.16	-0.22	-0.06
28	Borate	(mg/L) H ₃ BO ₃						0.00	Iron Carbonate		
29	TDS (Measured)	(mg/l)						72781	Zinc Sulfide		
30	Calc. Density (STP)	(g/ml)	1.038	1.051	1.050	1.048	1.045	1.047	Calcium fluoride		
31	CO ₂ Gas Analysis	(%)	19.97	18.76	22.41	35.53	33.79	26.16	Iron Carbonate		
32	H ₂ S Gas Analysis***	(%)	0.0289	0.0292	0.0296	0.0306	0.0151	0.0269	Iron Carbonate		
33	Total H ₂ Saq	(mgH ₂ S/l)	1.00	1.00	1.00	1.00	0.50	0.90	-0.74	-0.51	0.23
34	pH, measured (STP)	pH	5.67	5.76	5.72	5.54	5.55	5.63	Inhibitor needed (mg/L)		
35	Choose one option to calculate SI?	0-CO ₂ %+Alk, 1-pH+Alk, 2-CO ₂ %+pH	0	0	0	0	0	0	Calcite	NTMP	
36	Gas/day(thousand cf/day)	(Mcf/D)						0	0.00	0.00	
37	Oil/Day	(B/D)	0	0	1	1	1	4	Barite	BHPMP	
38	Water/Day	(B/D)	100	100	100	100	100	500	0.00	0.00	
39	For mixed brines, enter values for temperatures and pressures in Cells (H40-H43)								(Enter H40-H43)		pH
40	Initial T	(F)	66.0	71.0	70.0	41.0	49.0	60.0	5.69	5.60	
41	Final T	(F)	66.0	71.0	70.0	41.0	49.0	89.0	Viscosity (CentiPoise)		
42	Initial P	(psia)	25.0	25.0	25.0	25.0	25.0	25.0	1.196	0.826	
43	Final P	(psia)	25.0	25.0	25.0	25.0	25.0	120.0	Heat Capacity (cal/ml/°C)		
44	Use TP on Calcite sheet?	1-Yes;0-No							0.955	0.959	
45	API Oil Grav.	API grav.						30.00	Inhibitor needed (mg/L)		
46	Gas Sp.Grav.	Sp.Grav.						0.60	Gypsum	HDTMP	
47	MeOH/Day	(B/D)	0					0	0.00	0.00	
48	MEG/Day	(B/D)	0					0	Anhydrite	HDTMP	
49	Conc. Multiplier								0.00	0.00	
50	H ⁺ (Strong acid) [†]	(N)									
51	OH ⁻ (Strong base) [†]	(N)									
52	Quality Control Checks at STP:										
53	H ₂ S Gas	(%)									
54	Total H ₂ Saq (STP)	(mgH ₂ S/l)									
55	pH Calculated	(pH)									
56	PCO ₂ Calculated	(%)									
57	Alkalinity Calculated	(mg/l) as HCO ₃									
58	ΣCations=	(equiv./l)									
59	ΣAnions=	(equiv./l)									
60	Calc TDS=	(mg/l)									
61	Inhibitor Selection	Input	Unit	#	Inhibitor	Unit Converter (From metric to English)					
62	Protection Time	120	min	1	NTMP	From Unit	Value	To Unit	Value		
63	Have ScaleSoft/Pitzer			2	BHPMP	°C	80	°F	176		
64	pick inhibitor for you?	1	1-Yes;0-No	3	PAA	m ³	100	ft ³	3,531		
65	If No, inhibitor # is:	4	#	4	DTPMP	m ³	100	bb(42 US gal)	629		
66	If you select Mixed,			5	PPCA	MPa	1,000	psia	145,074		
67	1 st inhibitor # is:	1	#	6	SPA	Bar	496	psia	7,194		
68	% of 1 st inhibitor is:	50	%	7	HEDP	Torr	10,000	psia	193		
69	2 nd inhibitor # is:	2	#	8	HDTMP	Gal	10,000	bb(42 US gal)	238		
70	Display act. coeffs?	0	1-Yes;0-No	9	Average	Liters	10,000	bb(42 US gal)	63		
71				10	Mixed						

Saturation Index Calculations

Champion Technologies, Inc.

(Based on the Tomson-Oddo Model)

Brine 1: Ward Feed Yard 34-1

Brine 2: Ward Feed Yard 4-1

Brine 3: Clinesmith 5-4

Brine 4: Clinesmith 1

Brine 5: Clinesmith 2

Component (mg/L)	Ratio					Mixed Brine
	20% Brine 1	20% Brine 2	20% Brine 3	20% Brine 4	20 Brine 5	
Calcium	1836	2452	2044	1920	1948	1952
Magnesium	1096	872	1200	953	858	865
Barium	0	0	0	0	0	0
Strontium	0	0	0	0	0	0
Bicarbonate	190	234	259	268	254	253
Sulfate	1	1	8	1	1	1
Chloride	36299	48965	47874	45632	43147	43206
CO ₂ in Brine	246	220	264	422	405	401
Ionic Strength	1.12	1.48	1.46	1.38	1.31	1.31
Temperature (°F)	89	89	89	89	89	89
Pressure (psia)	50	50	120	120	120	119

Saturation Index

Calcite	-1.71	-1.41	-1.48	-1.68	-1.69	-1.69
Gypsum	-3.71	-3.64	-2.82	-3.73	-3.72	-3.69
Hemihydrate	-3.70	-3.65	-2.83	-3.74	-3.71	-3.69
Anhydrite	-3.89	-3.79	-2.97	-3.89	-3.88	-3.85
Barite	N/A	N/A	N/A	N/A	N/A	N/A
Celestite	N/A	N/A	N/A	N/A	N/A	N/A

PTB

Calcite	N/A	N/A	N/A	N/A	N/A	N/A
Gypsum	N/A	N/A	N/A	N/A	N/A	N/A
Hemihydrate	N/A	N/A	N/A	N/A	N/A	N/A
Anhydrite	N/A	N/A	N/A	N/A	N/A	N/A
Barite	N/A	N/A	N/A	N/A	N/A	N/A
Celestite	N/A	N/A	N/A	N/A	N/A	N/A

Affidavit of Notice Served

Re: Application for: APPLICATION FOR COMMINGLING OF PRODUCTION OR FLUIDS - ACO-4

Well Name: GROSDIDIER, FRANCIS E 15-1 Legal Location: N2 S2 NE SE S15-T28S-R20E

The undersigned hereby certifies that he / she is a duly authorized agent for the applicant, and that on the day 29TH of JUNE, 2012, a true and correct copy of the application referenced above was delivered or mailed to the following parties:

Note: A copy of this affidavit must be served as a part of the application.

Name	Address (Attach additional sheets if necessary)
MONARCH PETROLEUM	RR4, BOX 184, CHANUTE, KS 66720
MORRIS ENERGY	3625 NE COAL VALLEY RD, PO BOX 305, WEIR, KS 66781
R-JANN-N OIL	RR1, ST PAUL, KS 66771
MARIAH EXPLORATION LLC	29611 W US HWY 60, PO BOX 1452, PAWHUSKA, OK 74056

See Attachment

I further attest that notice of the filing of this application was published in the CHANUTE TRIBUNE, the official county publication of NEOSHO county. A copy of the affidavit of this publication is attached.

Signed this 29TH day of JUNE, 2012

Justin R. Beal
Applicant or Duly Authorized Agent

Subscribed and sworn to before me this 29TH day of JUNE, 2012

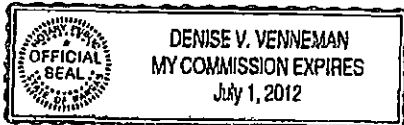

Denise V. Venneman
Notary Public
My Commission Expires: 7-1-12

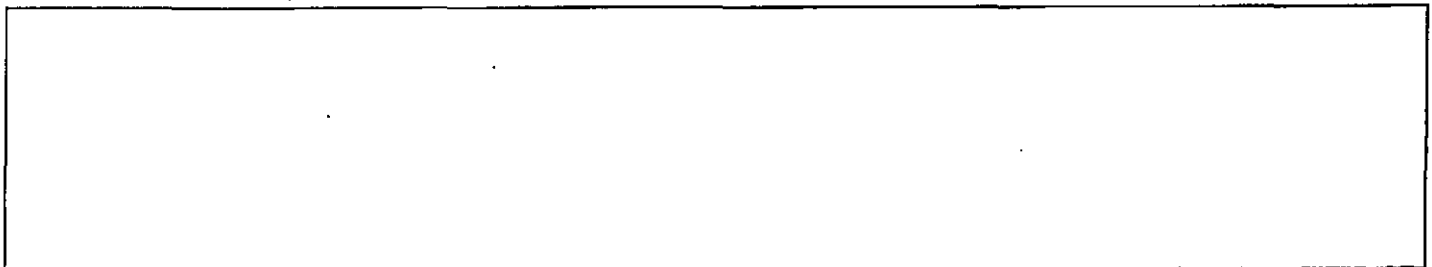

GROSDIDIER, FRANCIS E 15-1

NW4 of 15 surface & 1/2 minerals

HAMMANS, ARDEN A & PHYLLIS
18305 170TH RD
ERIE, KS 66733

UNION CENTRAL LIFE INSURANCE CO 1/2 minerals
C/O THOMAS DIANE
PO BOX 40888
CINCINNATI OH 45240

N2 NE OF 15

RUSSELL, DAVID M & SANDRA M
19755 HWY 59
ERIE, KS 66733

S2 SE SE OF 15

DAVIED, MARK A
3400 WOOD GREEN CT
MANHATTAN KS 66503

NW4 of 14

COOVER, CHARLES & ROSEMARY
17670 180TH RD
ERIE KS 66733

E2 SW4 of 14

BLAINE, PHILIP J
5307 WOODLAKE TRACE
GULF BREEZE FL 32563

S2 SW4 SW4 of 14

MATHEWS, CHARLES F & MARY S
611 S LINCOLN
ERIE KS 66733

Tract in NE4 22-28S-20E

HOAGLAND, C C & T S
18775 K-146 HWY
ERIE KS 66733

NE4 less tract of 22 & W2 NW4 of 23

BEACHNER BROS INC
PO BOX 128
ST PAUL KS 66771

GROSDIDIER, FRANCIS E 15-1

OFFSET OPERATORS, UNLEASED MINERAL OWNERS AND LAND OWNER ACREAGE

SPOT	LEGAL LOCATION	CURR_OPERA
SW SW SW	S14-T28S-R20E	Kansas Oil Company
SE SW SW	S14-T28S-R20E	Kansas Oil Company
SE SW SW	S14-T28S-R20E	Kansas Oil Company
SE SE SE	S15-T28S-R20E	Kansas Oil Company
SW SE SE	S15-T28S-R20E	Kansas Oil Company
SE NE NE NE	S22-T28S-R20E	Mariah Exploration LLC
NW SE SW	S14-T28S-R20E	Monarch Petroleum
NW NW NW NW	S23-T28S-R20E	Morris Energy
NE NW NW	S23-T28S-R20E	Morris Energy
NW NW NW	S23-T28S-R20E	Morris Energy
NE NW NW NW	S23-T28S-R20E	Morris Energy
SW NW NW NW	S23-T28S-R20E	Morris Energy
SE NW NW NW	S23-T28S-R20E	Morris Energy
SE NW NW NW	S23-T28S-R20E	Morris Energy
NE SE SE SW	S15-T28S-R20E	R-Jann-N Oil
NE SW SW SE	S15-T28S-R20E	R-Jann-N Oil
NE SW SW SE	S15-T28S-R20E	R-Jann-N Oil

GROSDIDIER, FRANCIS E 15-1

NW4 of 15 surface & 1/2 minerals

HAMMANS, ARDEN A & PHYLLIS
18305 170TH RD
ERIE, KS 66733

UNION CENTRAL LIFE INSURANCE CO 1/2 minerals
C/O THOMAS DIANE
PO BOX 40888
CINCINNATI OH 45240

N2 NE OF 15

RUSSELL, DAVID M & SANDRA M
19755 HWY 59
ERIE, KS 66733

S2 SE SE OF 15

DAVIED, MARK A
3400 WOOD GREEN CT
MANHATTAN KS 66503

NW4 of 14

COOVER, CHARLES & ROSEMARY
17670 180TH RD
ERIE KS 66733

E2 SW4 of 14

BLAINE, PHILIP J
5307 WOODLAKE TRACE
GULF BREEZE FL 32563

S2 SW4 SW4 of 14

MATHEWS, CHARLES F & MARY S
611 S LINCOLN
ERIE KS 66733

Tract in NE4 22-28S-20E

HOAGLAND, C C & T S
18775 K-146 HWY
ERIE KS 66733

NE4 less tract of 22 & W2 NW4 of 23

BEACHNER BROS INC
PO BOX 128
ST PAUL KS 66771

BEFORE THE STATE CORPORATION COMMISSION OF THE STATE OF KANSAS
NOTICE OF FILING APPLICATION

RE: In the Matter of Postrock Midcontinent Production, LLC Application for Commingling of Production in the Grosdidier, Francis E 15-1 located in Neosho County, Kansas.

TO: All Oil & Gas Producers, Unleased Mineral Interest Owners, Landowners, and all persons whomever concerned.

You, and each of you, are hereby notified that Postrock Midcontinent Production, LLC has filed an application to commingle the River-ton and Bartlesville producing formations of the Grosdidier, Francis E 15-1, located in the N2 S2 NE SE, S15-T28S-R20E, Approximately 1830 FSL & 660 FEL, Neosho County, Kansas.

Any persons who object to or protest this application shall be required to file their objections or protest with the Conservation Division of the State Corporation Commission of the State of Kansas within fifteen (15) days from the date of this publication. These protests shall be filed pursuant to Commission regulations and must state specific reasons why granting the application may cause waste, violate correlative rights or pollute the natural resources of the State of Kansas.

All persons interested or concerned shall take notice of the foregoing and shall govern themselves accordingly. All person and/or companies wishing to protest this application are required to file a written protest with the Conservation Division of the Kansas Oil and Gas Commission.

Upon the receipt of any protest, the Commission will convene a hearing and protestants will be expected to enter an appearance either through proper legal counsel or as individuals, appearing on their own behalf.

Postrock Midcontinent Production, LLC
210 Park Avenue, Suite 2750
Oklahoma City, Oklahoma 73102
(405) 660-7704

Affidavit of Publication

STATE OF KANSAS, NEOSHO COUNTY, ss:
Rhonda Howerter, being first duly sworn,
deposes and says: That *she* is *Classified Manager* of *THE CHANUTE TRIBUNE*, a daily newspaper printed in the State of Kansas, and published in and of general circulation in Neosho County, Kansas, with a general paid circulation on a daily basis in Neosho County, Kansas, and that said newspaper is not a trade, religious or fraternal publication.

Said newspaper is a daily published at least weekly 50 times a year: has been so published continuously and uninterruptedly in said county and state for a period of more than five years prior to the first publication of said notice; and has been admitted at the post office of Chanute, in said county as second class matter.

That the attached notice is a true copy thereof and was published in the regular and entire issue of said newspaper for 1 consecutive times, the first publication thereof being made as aforesaid on the 20 day of May 2012, with subsequent publications being made on the following dates:

_____, 2012 _____, 2012
_____, 2012 _____, 2012

Rhonda Howerter

Subscribed and sworn to and before me this 1 day of June, 2012

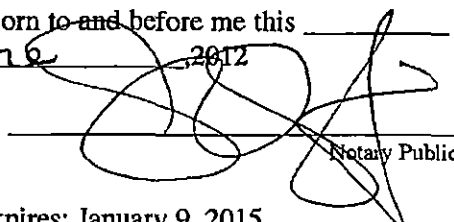

Notary Public

My commission expires: January 9, 2015
Printer's Fee \$ 62.34
Affidavit, Notary's Fee \$ 3.00
Additional Copies \$ _____
Total Publication Fees \$ 65.34

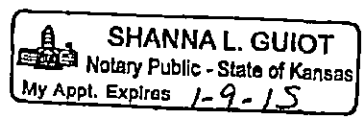
SHANNA L. GUIOT
Notary Public - State of Kansas
My Appl. Expires 1-9-15

AFFIDAVIT

STATE OF KANSAS \
- SS.
County of Sedgwick /

Mark Fletchall, of lawful age, being first duly sworn, deposeth and saith: That he is Record Clerk of The Wichita Eagle, a daily newspaper published in the City of Wichita, County of Sedgwick, State of Kansas, and having a general paid circulation on a daily basis in said County, which said newspaper has been continuously and uninterruptedly published in said County for more than one year prior to the first publication of the notice hereinafter mentioned, and which said newspaper has been entered as second class mail matter at the United States Post Office in Wichita, Kansas, and which said newspaper is not a trade, religious or fraternal publication and that a notice of a true copy is hereto attached was published in the regular and entire Morning issue of said The Wichita Eagle for 1 issues, that the first publication of said notice was

made as aforesaid on the 1st of

June A.D. 2012, with

subsequent publications being made on the following dates:

And affiant further says that he has personal knowledge of the statements above set forth and that they are true.

Mark Fletchall

Subscribed and sworn to before me this

1st day of June, 2012



Penny L. Case
Notary Public Sedgwick County, Kansas

Printer's Fee : \$132.40

LEGAL PUBLICATION
PUBLISHED IN THE WICHITA EAGLE
JUNE 1, 2012 (318791)
BEFORE THE STATE CORPORATION
COMMISSION OF THE
STATE OF KANSAS
NOTICE OF FILING APPLICATION
RE: In the Matter of Postrock Midcontinent
Production, LLC Application for
Commencing of Production in the
Grosdler, Francis E 15-1, located in
Neosho County, Kansas.
TO: All Oil & Gas Producers, Unleased Mineral
Interest Owners, Landowners, and all
persons whomsoever concerned.
You, and each of you, are hereby notified
that Postrock Midcontinent Production, LLC
has filed an application to commence the
Riverton and Bartlesville producing formations
of the Grosdler, Francis E 15-1, located in the
N2 S2 NE SE, S15-T285-R20E, Approximately
1830 ESE & 660 FEL, Neosho County, Kansas.
Any persons who object to or protest
this application shall be required to file their
objections or protest with the Conservation
Division of the State Corporation Commission
of the State of Kansas within fifteen (15)
days from the date of this publication. These
protests shall be filed pursuant to Commission
regulations and must state specific reasons
why granting the application may cause waste,
violate correlative rights or pollute the natural
resources of the State of Kansas.
All persons interested or concerned shall
take notice of the foregoing and shall govern
themselves accordingly. All persons and/or
companies wishing to protest this application
are required to file a written protest with the
Conservation Division of the Kansas Oil and
Gas Commission.
Upon the receipt of any protest, the
Commission will convene a hearing and
protestants will be expected to enter an
appearance either through proper legal
counsel or as individuals appearing on their
own behalf.
Postrock Midcontinent Production, LLC
210 Park Avenue, Suite 2750
Oklahoma City, Oklahoma 73102
(405) 660-7704

Conservation Division
Finney State Office Building
130 S. Market, Rm. 2078
Wichita, KS 67202-3802



Phone: 316-337-6200
Fax: 316-337-6211
<http://kcc.ks.gov/>

Mark Sievers, Chairman
Thomas E. Wright, Commissioner

Sam Brownback, Governor

July 16, 2012

Clark Edwards
PostRock Midcontinent Production LLC
Oklahoma Tower
210 Park Ave, Ste 2750
Oklahoma City, OK 73102

RE: Approved Commingling CO071206
Grosdidier Francis E 15-1, Sec.15-T28S-R20E, Neosho County
API No. 15-133-26200-00-01

Dear Mr. Edwards:

Your Application for Commingling (ACO-4) for the above described well, received by the KCC on July 2, 2012, has been reviewed and approved by the Kansas Corporation Commission (KCC) per K.A.R. 82-3-123. Notice was examined and found to be proper per K.A.R. 82-3-135a. No protest had been filed within the 15-day protest period.

Based upon the depth of the Riverton formation perforations, total oil production shall not exceed 100 BOPD and total gas production shall not exceed 50% of the absolute open flow (AOF).

Commingling ID number CO071206 has been assigned to this approved application. Use this number for well completion reports (ACO-1) and other correspondence that may concern this approved commingling.

Sincerely,

Rick Hestermann
Production Department