



KANSAS CORPORATION COMMISSION 1084672
OIL & GAS CONSERVATION DIVISION

Form ACO-4
Form must be typed
March 2009

APPLICATION FOR COMMINGLING OF **Commingling ID # CO061210**
PRODUCTION (K.A.R. 82-3-123) OR FLUIDS (K.A.R. 82-3-123a)

OPERATOR: License # 33343
Name: PostRock Midcontinent Production LLC
Address 1: Oklahoma Tower
Address 2: 210 Park Ave, Ste 2750
City: OKLAHOMA CITY State: OK Zip: 73102 +
Contact Person: CLARK EDWARDS
Phone: (620) 4324200

API No. 15 - 15-133-25926-00-01
Spot Description:
NW SW NE NE Sec. 1 Twp. 30 S. R. 18 East West
846 Feet from North / South Line of Section
1166 Feet from East / West Line of Section
County: Neosho
Lease Name: LOIS KRAMER 1 Well #: 1

1. Name and upper and lower limit of each production interval to be commingled:
Formation: RIVERTON (Perfs): 943-946
Formation: ROWE (Perfs): 890-892
Formation: UPPER ROWE (Perfs): 764-773
Formation: TEBO (Perfs): 731-734
Formation: FLEMING (Perfs): 662-666

2. Estimated amount of fluid production to be commingled from each interval:
Formation: RIVERTON BOPD: 0 MCFPD: .67 BWPD: 4.4
Formation: ROWE BOPD: 0 MCFPD: .67 BWPD: 4.4
Formation: UPPER ROWE BOPD: 0 MCFPD: .67 BWPD: 4.4
Formation: TEBO BOPD: 0 MCFPD: .67 BWPD: 4.4
Formation: FLEMING BOPD: 0 MCFPD: .67 BWPD: 4.4

3. Plat map showing the location of the subject well, all other wells on the subject lease, and all wells on offsetting leases within a 1/2 mile radius of the subject well, and for each well the names and addresses of the lessee of record or operator.
4. Signed certificate showing service of the application and affidavit of publication as required in K.A.R. 82-3-135a.

For Commingling of PRODUCTION ONLY, include the following:

5. Wireline log of subject well. Previously Filed with ACO-1: Yes No
6. Complete Form ACO-1 (Well Completion form) for the subject well.

For Commingling of FLUIDS ONLY, include the following:

7. Well construction diagram of subject well.
8. Any available water chemistry data demonstrating the compatibility of the fluids to be commingled.

AFFIDAVIT: I am the affiant and hereby certify that to the best of my current information, knowledge and personal belief, this request for commingling is true and proper and I have no information or knowledge, which is inconsistent with the information supplied in this application.

Submitted Electronically

KCC Office Use Only	
<input type="checkbox"/> Denied	<input checked="" type="checkbox"/> Approved
15-Day Periods Ends: <u>6/30/2012</u>	
Approved By: <u>Rick Hestermann</u>	Date: <u>07/02/2012</u>

Protests may be filed by any party having a valid interest in the application. Protests must be in writing and comply with K.A.R. 82-3-135b and must be filed within 15 days of publication of the notice of application.



CONFIDENTIAL WELL COMPLETION FORM

WELL HISTORY - DESCRIPTION OF WELL & LEASE

OPERATOR: License # 33343
Name: PostRock Midcontinent Production LLC
Address 1: Oklahoma Tower
Address 2: 210 Park Ave, Ste 2750
City: OKLAHOMA CITY State: OK Zip: 73102 +
Contact Person: CLARK EDWARDS
Phone: (620) 4324200
CONTRACTOR: License # 34453
Name: PostRock Energy Services Corporation
Wellsite Geologist: N/A
Purchaser: _____

Designate Type of Completion:

- New Well Re-Entry Workover
- Oil WSW SWD SIOW
 Gas D&A ENHR SIGW
 OG GSW Temp. Abd.
 CM (Coal Bed Methane)
 Cathodic Other (Core, Expl., etc.): _____

If Workover/Re-entry: Old Well Info as follows:

Operator: POSTROCK
Well Name: LOIS KRAMER 1-1
Original Comp. Date: 6/30/2003 Original Total Depth: 1148
 Deepening Re-perf. Conv. to ENHR Conv. to SWD
 Conv. to GSW
 Plug Back: _____ Plug Back Total Depth
 Commingled Permit #: _____
 Dual Completion Permit #: _____
 SWD Permit #: _____
 ENHR Permit #: _____
 GSW Permit #: _____

<u>4/3/2012</u>	<u>4/3/2012</u>
Spud Date or Recompletion Date	Date Reached TD Completion Date or Recompletion Date

API No. 15 - 15-133-25926-00-01

Spot Description: _____
NW SW NE NE Sec. 1 Twp. 30 S. R. 18 East West
846 Feet from North / South Line of Section
1166 Feet from East / West Line of Section

Footages Calculated from Nearest Outside Section Corner:

- NE NW SE SW

County: Neosho

Lease Name: LOIS KRAMER 1 Well #: 1

Field Name: _____

Producing Formation: RIVERTON, ROWE, UPPER ROWE, TEGO, FLEMING, CROWEBURG, BEVIER, MULKY, SUMMITT.

Elevation: Ground: 965 Kelly Bushing: 0

Total Depth: 1148 Plug Back Total Depth: 1132

Amount of Surface Pipe Set and Cemented at: 20 Feet

Multiple Stage Cementing Collar Used? Yes No

If yes, show depth set: _____ Feet

If Alternate II completion, cement circulated from: _____

feet depth to: _____ w/ _____ sx cmt.

Drilling Fluid Management Plan

(Data must be collected from the Reserve Pit)

Chloride content: _____ ppm Fluid volume: _____ bbls

Dewatering method used: _____

Location of fluid disposal if hauled offsite: _____

Operator Name: _____

Lease Name: _____ License #: _____

Quarter _____ Sec. _____ Twp. _____ S. R. _____ East West

County: _____ Permit #: _____

AFFIDAVIT

I am the affiant and I hereby certify that all requirements of the statutes, rules and regulations promulgated to regulate the oil and gas industry have been fully complied with and the statements herein are complete and correct to the best of my knowledge.

Submitted Electronically

KCC Office Use ONLY

- Letter of Confidentiality Received
Date: 06/05/2012
- Confidential Release Date: _____
- Wireline Log Received
- Geologist Report Received
- UIC Distribution
- ALT I II III Approved by: NAOMI JAMES Date: 06/06/2012



1083380

Operator Name: PostRock Midcontinent Production LLC Lease Name: LOIS KRAMER 1 Well #: 1
 Sec. 1 Twp. 30 S. R. 18 East West County: Neosho

INSTRUCTIONS: Show important tops and base of formations penetrated. Detail all cores. Report all final copies of drill stems tests giving interval tested, time tool open and closed, flowing and shut-in pressures, whether shut-in pressure reached static level, hydrostatic pressures, bottom hole temperature, fluid recovery, and flow rates if gas to surface test, along with final chart(s). Attach extra sheet if more space is needed. Attach complete copy of all Electric Wire-line Logs surveyed. Attach final geological well site report.

Drill Stem Tests Taken <input type="checkbox"/> Yes <input checked="" type="checkbox"/> No (Attach Additional Sheets) Samples Sent to Geological Survey <input type="checkbox"/> Yes <input checked="" type="checkbox"/> No Cores Taken <input type="checkbox"/> Yes <input checked="" type="checkbox"/> No Electric Log Run <input type="checkbox"/> Yes <input checked="" type="checkbox"/> No Electric Log Submitted Electronically <input type="checkbox"/> Yes <input type="checkbox"/> No (If no, Submit Copy) List All E. Logs Run:	<input type="checkbox"/> Log Formation (Top), Depth and Datum <input type="checkbox"/> Sample Name Top Datum N/A
---	--

CASING RECORD <input type="checkbox"/> New <input type="checkbox"/> Used							
Report all strings set-conductor, surface, intermediate, production, etc.							
Purpose of String	Size Hole Drilled	Size Casing Set (In O.D.)	Weight Lbs. / Ft.	Setting Depth	Type of Cement	# Sacks Used	Type and Percent Additives

ADDITIONAL CEMENTING / SQUEEZE RECORD				
Purpose:	Depth Top Bottom	Type of Cement	# Sacks Used	Type and Percent Additives
<input type="checkbox"/> Perforate <input type="checkbox"/> Protect Casing <input type="checkbox"/> Plug Back TD <input type="checkbox"/> Plug Off Zone	-			
	-			

Shots Per Foot	PERFORATION RECORD - Bridge Plugs Set/Type Specify Footage of Each Interval Perforated	Acid, Fracture, Shot, Cement Squeeze Record (Amount and Kind of Material Used)	Depth
	690-695	299 BBLS SLICK WATER/ 400# FRAC GEL/ 12600# 20/40 SAND/ 3000# 12/20 SAND	690-695

TUBING RECORD: Size: _____ Set At: _____ Packer At: _____ Liner Run: Yes No

Date of First, Resumed Production, SWD or ENHR. 4/9/2012
 Producing Method: Flowing Pumping Gas Lift Other (Explain) _____

Estimated Production Per 24 Hours	Oil Bbls.	Gas Mcf	Water Bbls.	Gas-Oil Ratio	Gravity
-----------------------------------	-----------	---------	-------------	---------------	---------

DISPOSITION OF GAS: <input type="checkbox"/> Vented <input checked="" type="checkbox"/> Sold <input type="checkbox"/> Used on Lease (If vented, Submit ACO-18.)	METHOD OF COMPLETION: <input type="checkbox"/> Open Hole <input checked="" type="checkbox"/> Perf. <input type="checkbox"/> Dually Comp. <input checked="" type="checkbox"/> Commingled (Submit ACO-5) (Submit ACO-4) <input type="checkbox"/> Other (Specify) _____	PRODUCTION INTERVAL: _____ _____
---	---	--

Conservation Division
Finney State Office Building
130 S. Market, Rm. 207B
Wichita, KS 67202-3802



Phone: 316-337-6200
Fax: 316-337-6211
<http://kcc.ks.gov/>

Mark Sievers, Chairman
Ward Loyd, Commissioner
Thomas E. Wright, Commissioner

Sam Brownback, Governor

June 05, 2012

CLARK EDWARDS
PostRock Midcontinent Production LLC
Oklahoma Tower
210 Park Ave, Ste 2750
OKLAHOMA CITY, OK 73102

Re: ACO1
API 15-133-25926-00-00
LOIS KRAMER 1 1
NE/4 Sec.01-30S-18E
Neosho County, Kansas

Dear Production Department:

We are herewith requesting that the Well Completion Form ACO-1 and attached information for the subject well be held confidential for a period of two years.

Should you have any questions or need additional information regarding subject well, please contact our office.

Respectfully,
CLARK EDWARDS

Affidavit of Notice Served

Re: Application for: APPLICATION FOR COMMINGLING OF PRODUCTION OR FLUIDS - ACO-4

Well Name: KRAMER, LOIS 1-1 Legal Location: NWSWNE S1-T30S-R18E

The undersigned hereby certifies that he / she is a duly authorized agent for the applicant, and that on the day 15TH of JUNE, 2012, a true and correct copy of the application referenced above was delivered or mailed to the following parties:

Note: A copy of this affidavit must be served as a part of the application.

Name	Address (Attach additional sheets if necessary)
POSTROCK MIDCONTINENT PRODUCTION, LLC	210 PARK AVENUE, SUITE 2750, OKLAHOMA CITY, OK 73102-5641
BRYAN W COOVER DEBRA J COOVER	6165 JACKSON RD, GALESBURG, KS 66740
Design Tech of KS, Inc.	15803 WINDHAM DRIVE, LITTLE ROCK, AR 72206
Neosho Natural LLC	4230 DOUGLAS RD, THAYER, KS 66776

I further attest that notice of the filing of this application was published in the CHANUTE TRIBUNE, the official county publication of NEOSHO county. A copy of the affidavit of this publication is attached.

Signed this 15th day of JUNE, 2012

Denise V Veneman
Applicant or Duly Authorized Agent

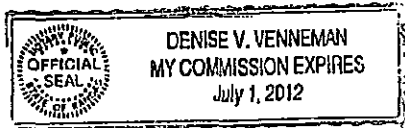

Subscribed and sworn to before me this 15th day of JUNE, 2012

Denise V Veneman
Notary Public

My Commission Expires: 7-1-12

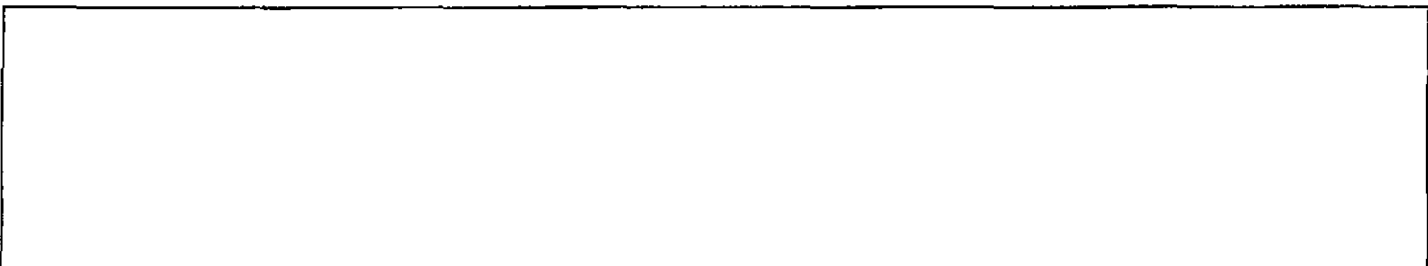

	A	B	C	D	E	F	G	H	I	J	K
1	Produced Fluids #		1	2	3	4	5		Click here to run SSP Goal Seek SSP Click		
2	Parameters	Units	Input	Input	Input	Input	Input				
3	Select the brines	Select fluid by checking the box(es), Row 3	<input type="checkbox"/>	<input type="checkbox"/>	<input type="checkbox"/>	<input type="checkbox"/>	<input type="checkbox"/>	Mixed brine: Cell H28 is STP calc. pH. Cells H35-38 are used in mixed brines calculations.			
4	Sample ID										
5	Date		3/19/2012	3/4/2012	3/14/2012	1/20/2012	1/20/2012				
6	Operator		PostRock	PostRock	PostRock	PostRock	PostRock				
7	Well Name		Ward Feed	Ward Feed	Clinesmith	Clinesmith	Clinesmith				
8	Location		#34-1	#4-1	#5-4	#1	#2				
9	Field		CBM	CBM	Bartles	Bartles	Bartles				
10	Na ⁺	(mg/l)*	19,433.00	27,381.00	26,534.00	25689.00	24220.00	24654.20	Initial(BE)	Final(WH)	SISR (Final-Initial)
11	K ⁺ (If not known =0)	(mg/l)						0.00	Saturation Index values		
12	Mg ²⁺	(mg/l)	1,096.00	872.00	1,200.00	953.00	858.00	995.91	Calcite		
13	Ca ²⁺	(mg/l)	1,836.00	2,452.00	2,044.00	1920.00	1948.00	2040.23	-0.73	-0.60	0.13
14	Sr ²⁺	(mg/l)						0.00	Barite		
15	Ba ²⁺	(mg/l)						0.00			
16	Fe ²⁺	(mg/l)	40.00	21.00	18.00	82.00	90.00	50.21	Halite		
17	Zn ²⁺	(mg/l)						0.00	-1.77	-1.80	-0.03
18	Pb ²⁺	(mg/l)						0.00	Gypsum		
19	Cl ⁻	(mg/l)	36,299.00	48,965.00	47,874.00	45632.00	43147.00	44388.44	-3.19	-3.18	0.00
20	SO ₄ ²⁻	(mg/l)	1.00	1.00	8.00	1.00	1.00	2.40	Hemihydrate		
21	F ⁻	(mg/l)						0.00	-3.96	-3.90	0.06
22	Br ⁻	(mg/l)						0.00	Anhydrite		
23	SiO ₂	(mg/l) SiO ₂						0.00	-3.47	-3.36	0.12
24	HCO ₃ Alkalinity**	(mg/l as HCO ₃)	190.00	234.00	259.00	268.00	254.00	241.03	Celestite		
25	CO ₃ Alkalinity	(mg/l as CO ₃)									
26	Carboxylic acids**	(mg/l)						0.00	Iron Sulfide		
27	Ammonia	(mg/L) NH ₃						0.00	-0.16	-0.22	-0.06
28	Borate	(mg/L) H ₃ BO ₃						0.00	Zinc Sulfide		
29	TDS (Measured)	(mg/l)						72781			
30	Calc. Density (STP)	(g/ml)	1.038	1.051	1.050	1.048	1.045	1.047	Calcium fluoride		
31	CO ₂ Gas Analysis	(%)	19.97	18.76	22.41	35.53	33.79	26.16			
32	H ₂ S Gas Analysis***	(%)	0.0289	0.0292	0.0296	0.0306	0.0151	0.0269	Iron Carbonate		
33	Total H ₂ Saq	(mgH ₂ S/l)	1.00	1.00	1.00	1.00	0.50	0.90	-0.74	-0.51	0.23
34	pH, measured (STP)	pH	5.67	5.76	5.72	5.54	5.55	5.63	Inhibitor needed (mg/L)		
									Calcite	NTMP	
35	Choose one option to calculate SI?	0-CO ₂ +Alk, 1-pH+Alk, 2-CO ₂ +pH	0	0	0	0	0	0			
36	Gas/day(thousand cf/day)	(Mcf/D)						0	0.00	0.00	
37	Oil/Day	(B/D)	0	0	1	1	1	4	Barite	BHPMP	
38	Water/Day	(B/D)	100	100	100	100	100	500	0.00	0.00	
39	For mixed brines, enter values for temperatures and pressures in Cells (H40-H43)								(Enter H40-H43) pH		
40	Initial T	(F)	66.0	71.0	70.0	41.0	49.0	60.0	5.69	5.60	
41	Final T	(F)	66.0	71.0	70.0	41.0	49.0	89.0	Viscosity (CentiPoise)		
42	Initial P	(psia)	25.0	25.0	25.0	25.0	25.0	25.0	1.196	0.826	
43	Final P	(psia)	25.0	25.0	25.0	25.0	25.0	120.0	Heat Capacity (cal/ml/C)		
44	Use TP on Calcite sheet?	1-Yes;0-No							0.955	0.959	
45	API Oil Grav.	API grav.						30.00	Inhibitor needed (mg/L)		
46	Gas Sp.Grav.	Sp.Grav.						0.60	Gypsum	HDTMP	
47	MeOH/Day	(B/D)	0					0	0.00	0.00	
48	MEG/Day	(B/D)	0					0	Anhydrite	HDTMP	
49	Conc. Multiplier								0.00	0.00	
50	H ⁺ (Strong acid) †	(N)									
51	OH ⁻ (Strong base) †	(N)									
52	Quality Control Checks at STP:										
53	H ₂ S Gas	(%)									
54	Total H ₂ Saq (STP)	(mgH ₂ S/l)									
55	pH Calculated	(pH)									
56	PCO ₂ Calculated	(%)									
57	Alkalinity Calculated	(mg/l) as HCO ₃									
58	ECations=	(equiv./l)									
59	EAnions=	(equiv./l)									
60	Calc TDS=	(mg/l)									
61	Inhibitor Selection	Input	Unit	#	Inhibitor	Unit Converter (From metric to English)			Value		
62	Protection Time	120	min	1	NTMP	From Unit	Value	To Unit	Value		
63	Have ScaleSoftPitzer			2	BHPMP	°C	80	°F	176		
64	pick inhibitor for you?	1	1-Yes;0-No	3	PAA	m ³	100	ft ³	3,531		
65	If No, inhibitor # is:	4	#	4	DTPMP	m ³	100	bb(42 US gal)	629		
66	If you select Mixed,			5	PPCA	MPa	1,000	psia	145,074		
67	1 st inhibitor # is:	1	#	6	SPA	Bar	496	psia	7,194		
68	% of 1 st inhibitor is:	50	%	7	HEDP	Torr	10,000	psia	193		
69	2 nd inhibitor # is:	2	#	8	HDTMP	Gal	10,000	bb(42 US gal)	238		
70	Display act. coeffs?	0	1-Yes;0-No	9	Average	Liters	10,000	bb(42 US gal)	63		
71				10	Mixed						

Saturation Index Calculations

Champion Technologies, Inc.
(Based on the Tomson-Oddo Model)

Brine 1: Ward Feed Yard 34-1

Brine 2: Ward Feed Yard 4-1

Brine 3: Clinesmith 5-4

Brine 4: Clinesmith 1

Brine 5: Clinesmith 2

Component (mg/L)	Ratio					Mixed Brine
	20% Brine 1	20% Brine 2	20% Brine 3	20% Brine 4	20 Brine 5	
Calcium	1836	2452	2044	1920	1948	1952
Magnesium	1096	872	1200	953	858	865
Barium	0	0	0	0	0	0
Strontium	0	0	0	0	0	0
Bicarbonate	190	234	259	268	254	253
Sulfate	1	1	8	1	1	1
Chloride	36299	48965	47874	45632	43147	43206
CO ₂ in Brine	246	220	264	422	405	401
Ionic Strength	1.12	1.48	1.46	1.38	1.31	1.31
Temperature (°F)	89	89	89	89	89	89
Pressure (psia)	50	50	120	120	120	119

Saturation Index

Calcite	-1.71	-1.41	-1.48	-1.68	-1.69	-1.69
Gypsum	-3.71	-3.64	-2.82	-3.73	-3.72	-3.69
Hemihydrate	-3.70	-3.65	-2.83	-3.74	-3.71	-3.69
Anhydrite	-3.89	-3.79	-2.97	-3.89	-3.88	-3.85
Barite	N/A	N/A	N/A	N/A	N/A	N/A
Celestite	N/A	N/A	N/A	N/A	N/A	N/A

PTB

Calcite	N/A	N/A	N/A	N/A	N/A	N/A
Gypsum	N/A	N/A	N/A	N/A	N/A	N/A
Hemihydrate	N/A	N/A	N/A	N/A	N/A	N/A
Anhydrite	N/A	N/A	N/A	N/A	N/A	N/A
Barite	N/A	N/A	N/A	N/A	N/A	N/A
Celestite	N/A	N/A	N/A	N/A	N/A	N/A

BEFORE THE STATE CORPORATION COMMISSION
OF THE STATE OF KANSAS
NOTICE OF FILING
APPLICATION

RE: In the Matter of Postrock Midcontinent Production, LLC Application for Commingling of Production in the Kramer, Lots 1-1 located in Neosho County, Kansas.

TO: All Oil & Gas Producers, Unleased Mineral Interest Owners, Landowners, and all persons whomsoever concerned.

You, and each of you, are hereby notified that Postrock Midcontinent Production, LLC has filed an application to commingle the River-ton, Rowe, Upper Rowe, Tebo, Cattlemen, Fleming, Crowburg, Bevier, Mulky and Summit producing formations at the Kramer, Lots 1-3, located in the NW SW NE NE, S1-T30S-R18E, Approximately B46 FNL & 1166 FEL, Neosho County, Kansas.

Any persons who object to or protest this application shall be required to file their objections of protest with the Conservation Division of the State Corporation Commission of the State of Kansas within fifteen (15) days from the date of this publication. These protests shall be filed pursuant to Commission regulations and must state specific reasons why granting the application may cause waste, violate correlative rights or pollute the natural resources of the State of Kansas.

All persons interested or concerned shall take notice of the foregoing and shall govern themselves accordingly. All person and/or companies wishing to protest this application are required to file a written protest with the Conservation Division of the Kansas Oil and Gas Commission.

Upon the receipt of any protest, the Commission will convene a hearing and protestants will be expected to enter an appearance either through proper legal counsel or as individuals, appearing on their own behalf.

Postrock Midcontinent
Production, LLC
210 Park Avenue, Suite 2750
Oklahoma City, Oklahoma 73102
(405) 650-7704

Affidavit of Publication

STATE OF KANSAS, NEOSHO COUNTY, ss:
Rhonda Howerter, being first duly sworn,
deposes and says: That she is *Classified Manager*
of *THE CHANUTE TRIBUNE*, a daily newspaper printed
in the State of Kansas, and published in and of general
circulation in Neosho County, Kansas, with a general paid
circulation on a daily basis in Neosho County, Kansas, and
that said newspaper is not a trade, religious or fraternal
publication.

Said newspaper is a daily published at least weekly 50
times a year; has been so published continuously and unin-
terruptedly in said county and state for a period of more
than five years prior to the first publication of said notice;
and has been admitted at the post office of Chanute, in said
county as second class matter.

That the attached notice is a true copy thereof and was
published in the regular and entire issue of said newspa-
per for 1 consecutive time, the first publication
thereof being made as aforesaid on the 20 day of
May
2012, with subsequent publications being made on the fol-
lowing dates:

_____, 2012 _____, 2012
_____, 2012 _____, 2012

Rhonda Howerter

Subscribed and sworn to and before me this
1 day of June, 2012

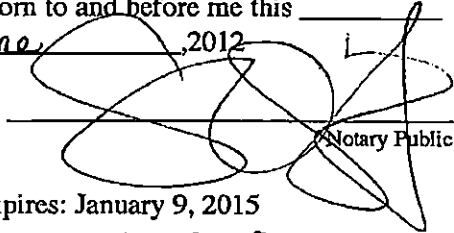

Notary Public

My commission expires: January 9, 2015

Printer's Fee \$ 63.30
Affidavit, Notary's Fee \$ 3.00
Additional Copies \$ _____
Total Publication Fees \$ 66.30

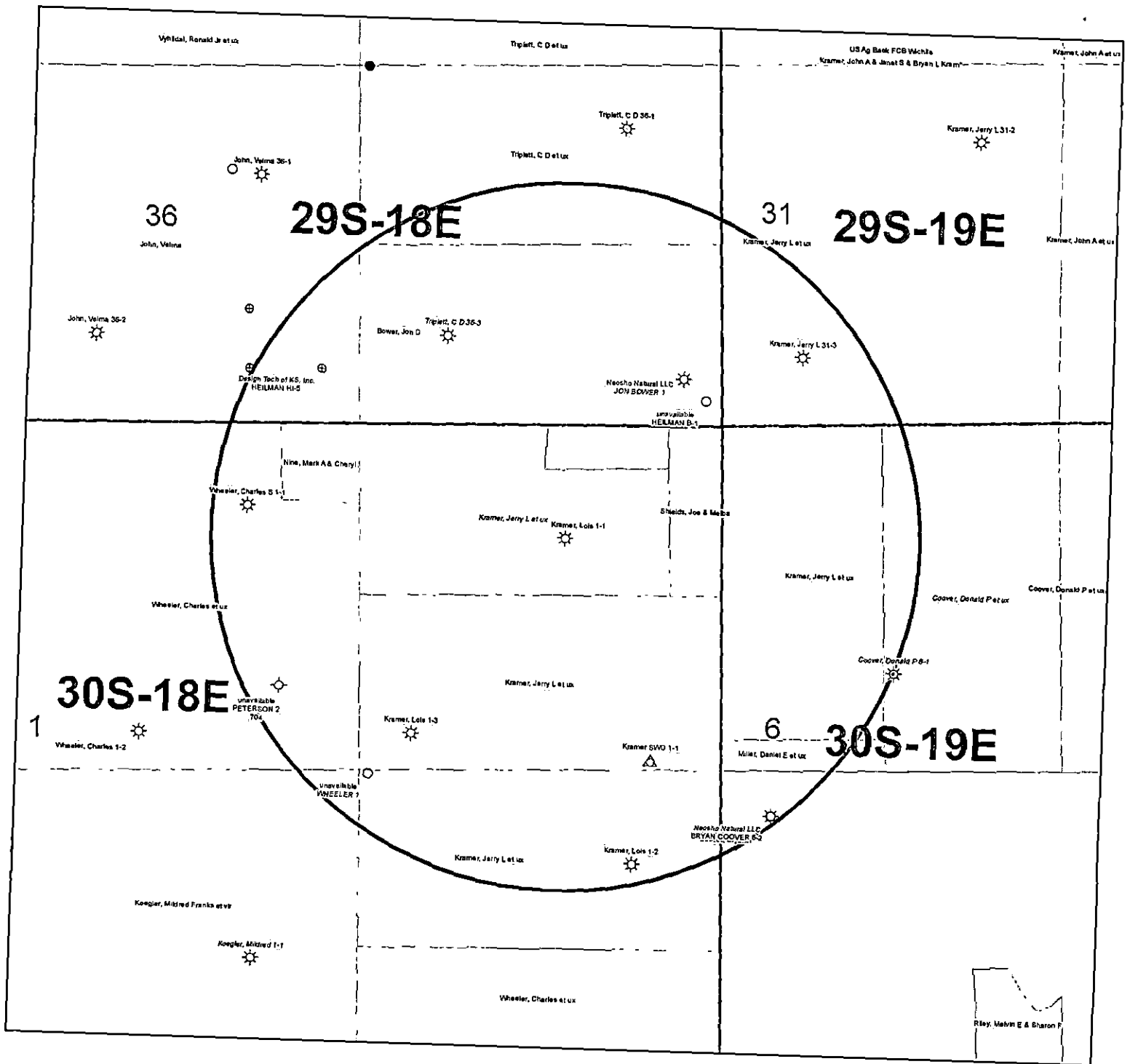

SHANNA L. GUIOT
Notary Public - State of Kansas
My Appt. Expires 1-9-15



KGS STATUS	
◇	DA/PA
⊕	EOR
☼	GAS
△	INJ/SWD
●	OIL
✱	OIL/GAS
○	OTHER

Kramer, Lois 1-1
 1-30S-18E
 1" = 1,000'

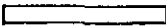
KRAMER, LOIS 1-1 - APPLICATION FOR COMMINGLING OF PRODUCTION OR FLUIDS



Offset Operators, Unleased Mineral Owners and Landowners acreage
(Attach additional sheets if necessary)

Name:

Legal Description of Leasehold:

BRYAN W & DEBRA J COOVER

Tract in SW/4 of 6-30S-19E

Design Tech of KS, Inc.

NE S36-T29S-R18E

Neosho Natural LLC

NW NW SW S6-T30S-R19E

Neosho Natural LLC

NW NW SW S6-T30S-R19E

Neosho Natural LLC

SE SE SE S36-T29S-R18E

I hereby certify that the statements made herein are true and correct to the best of my knowledge and belief.

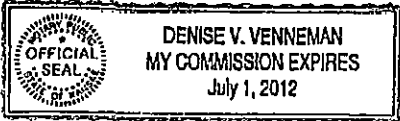

Amber R Beal
Applicant or Duly Authorized Agent

Subscribed and sworn before me this 15TH day of JUNE, 2012

Denise V Vennemman
Notary Public

My Commission Expires: 7-1-12

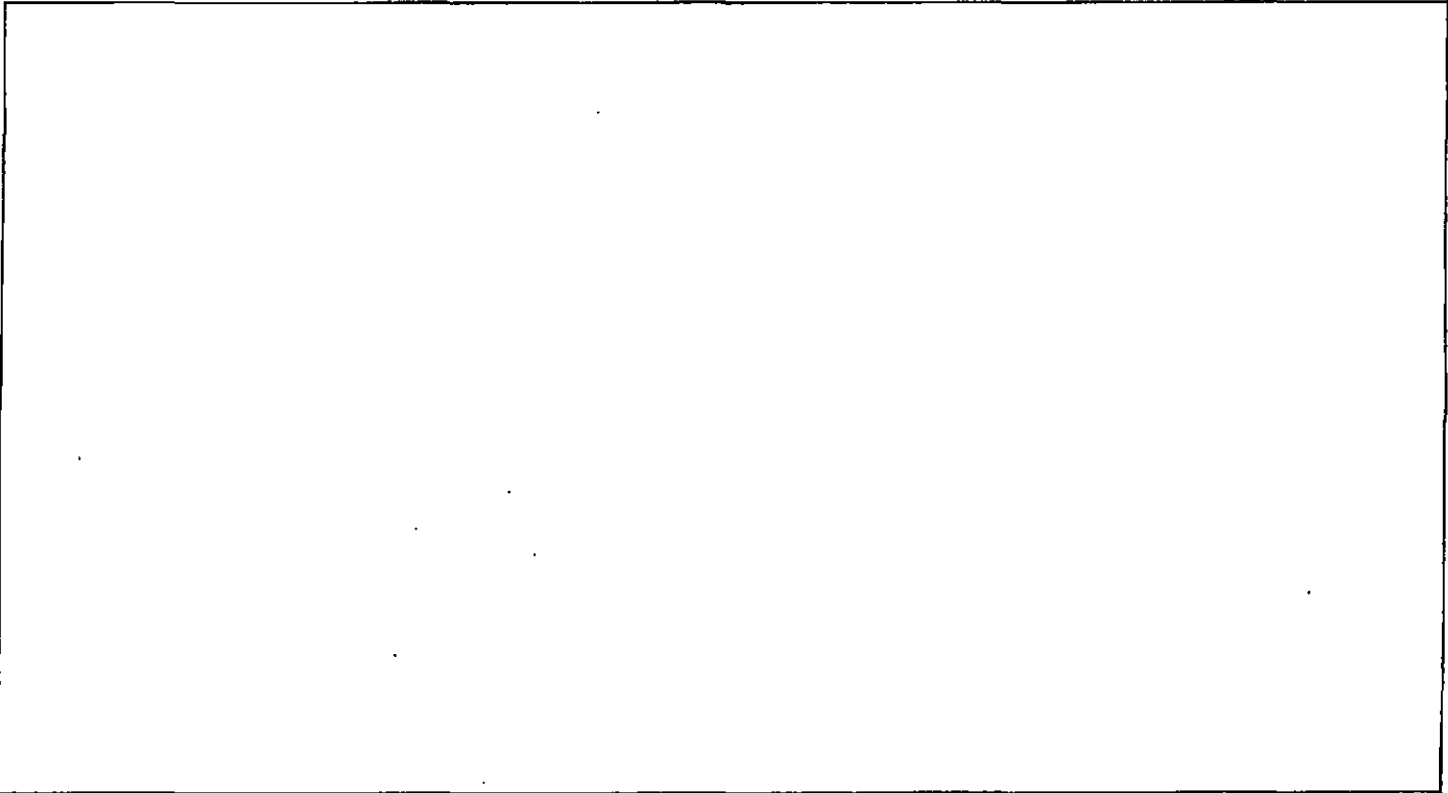

POSTROCK



LEGEND

PostRock®

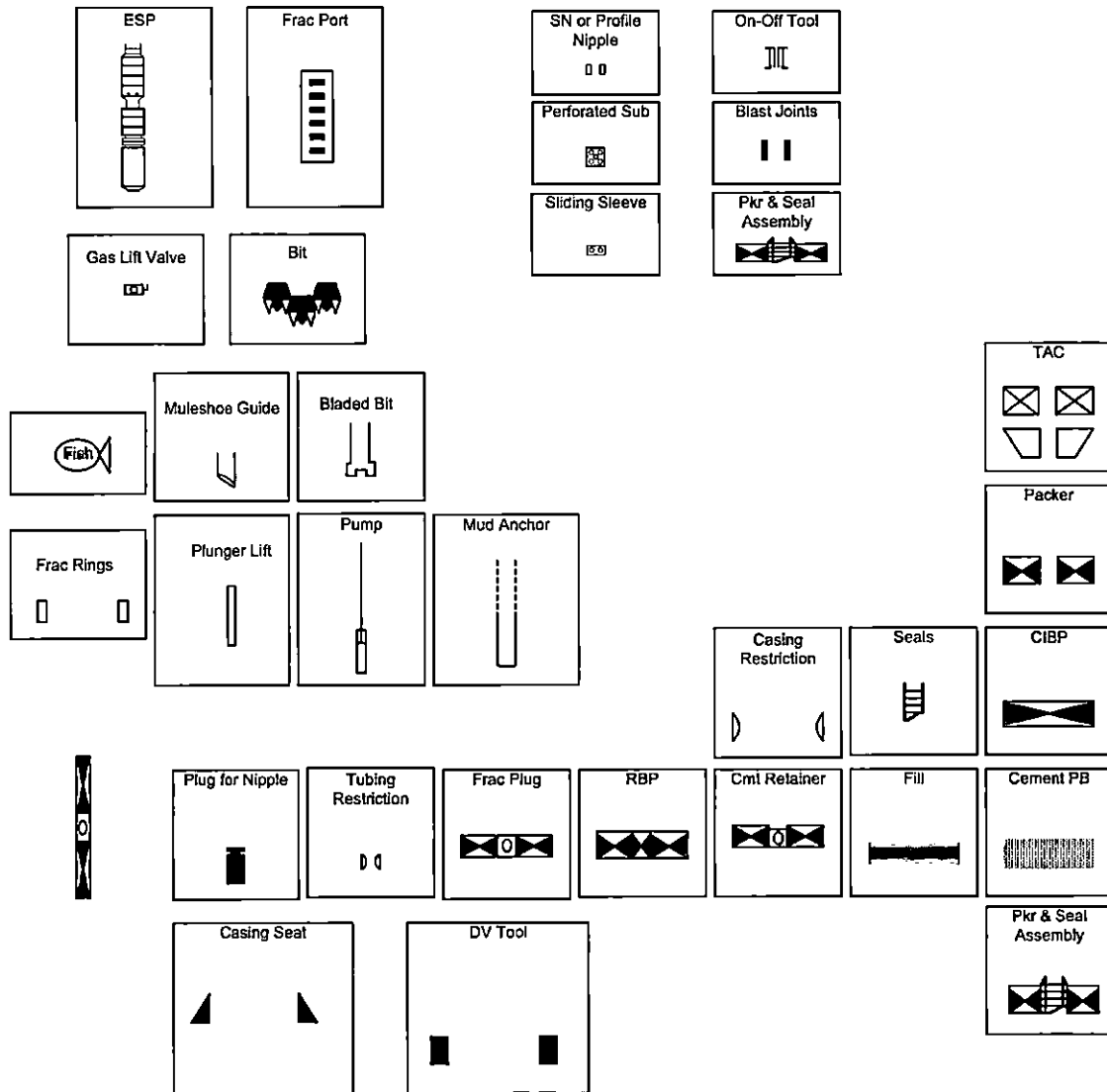

AFFIDAVIT

STATE OF KANSAS \
- SS.
County of Sedgwick /

Mark Fletchall, of lawful age, being first duly sworn, deposeth and saith: That he is Record Clerk of The Wichita Eagle, a daily newspaper published in the City of Wichita, County of Sedgwick, State of Kansas, and having a general paid circulation on a daily basis in said County, which said newspaper has been continuously and uninterruptedly published in said County for more than one year prior to the first publication of the notice hereinafter mentioned, and which said newspaper has been entered as second class mail matter at the United States Post Office in Wichita, Kansas, and which said newspaper is not a trade, religious or fraternal publication and that a notice of a true copy is hereto attached was published in the regular and entire Morning issue of said The Wichita Eagle for 1 issues, that the first publication of said notice was

made as aforesaid on the 1st of

June A.D. 2012, with

subsequent publications being made on the following dates:

And affiant further says that he has personal knowledge of the statements above set forth and that they are true.

Mark Fletchall

Subscribed and sworn to before me this

1st day of June, 2012

PENNY L. CASE
Notary Public - State of Kansas
My Appt. Expires 5/28/2014

Penny L. Case
Notary Public Sedgwick County, Kansas

Printer's Fee : \$132.40

LEGAL PUBLICATION

PUBLISHED IN THE WICHITA EAGLE
JUNE 1, 2012 (3187795)

BEFORE THE STATE CORPORATION
COMMISSION OF THE STATE OF KANSAS
NOTICE OF FILING APPLICATION

RE: In the Matter of: Postrock Midcontinent
Production, LLC Application for Commingling
of Production in the Kramer, Lots 1-1 located
in Neosho County, Kansas.

TO: All Oil & Gas Producers, Unleased Mineral
Interest Owners, Landowners, and all persons
whomsoever concerned.

You, and each of you, are hereby notified
that Postrock Midcontinent Production
LLC has filed an application for commingling
the Riverton, Rowe, Upper Rowe, Tebo,
Calliehan, Fleming, Croweboro, Beaver,
Mulky, and Summit producing formations
at the Kramer, Lots 1-3, located in the NW
SW 1/4 NE 1/4, S1 T30S-R18E, Approximately
846 ENL & 1166 FEL, Neosho County, Kansas.

Any persons who object to or protest
this application shall be required to file their
objections or protest with the Conservation
Division of the State Corporation Commission
of the State of Kansas within fifteen (15)
days from the date of this publication. These
protests shall be filed pursuant to Commission
regulations and must state specific reasons
why granting the application may cause waste,
violate correlative rights or pollute the natural
resources of the State of Kansas.

All persons interested or concerned shall
take notice of the foregoing and shall govern
themselves accordingly. All person and/or
companies wishing to protest this application
are required to file a written protest with the
Conservation Division of the Kansas Oil and
Gas Commission.

Upon the receipt of any protest, the
Commission will convene a hearing and
protestants will be expected to enter an
appearance either through proper legal
counsel or as individuals, appearing on their
own behalf.

Postrock Midcontinent Production, LLC
210 Park Avenue, Suite 2150
Oklahoma City, Oklahoma 73102
(405) 640-7704

Conservation Division
Finney State Office Building
130 S. Market, Rm. 2078
Wichita, KS 67202-3802



Phone: 316-337-6200
Fax: 316-337-6211
<http://kcc.ks.gov/>

Mark Sievers, Chairman
Ward Loyd, Commissioner
Thomas E. Wright, Commissioner

Sam Brownback, Governor

July 2, 2012

Clark Edwards
PostRock Midcontinent Production LLC
Oklahoma Tower
210 Park Ave, Ste 2750
Oklahoma City, OK 73102

RE: Approved Commingling CO061210
Lois Kramer 1 1, Sec.1-T30S-R18E, Neosho County
API No. 15-133-25926-00-01

Dear Mr. Edwards:

Your Application for Commingling (ACO-4) for the above described well has been reviewed and approved by the Kansas Corporation Commission (KCC) per K.A.R. 82-3-123. Notice was examined and found to be proper per K.A.R. 82-3-135a. No protest had been filed within the 15-day protest period. This application, which was received by the KCC on June 18, 2012, concerns approval to simultaneously produce from the following sources of supply through the same tubing string in the same wellbore:

Source of Supply	Estimated Current Production			Perf Depth
	BOPD	MCFPD	BWPD	
Riverton	0.00	0.67	4.40	943-946
Rowe	0.00	0.67	4.40	890-892
Upper Rowe	0.00	0.67	4.40	764-773
Tebo	0.00	0.67	4.40	731-734
Fleming	0.00	0.67	4.40	662-666
Croweburg	0.00	0.67	4.40	626-630
Bevier	0.00	0.67	4.40	602-606
Mulky	0.00	0.67	4.40	519-523
Summit	0.00	0.67	4.40	507-511
Cattleman	3.00	0.00	20.00	690-695
Total Estimated Current Production	3.00	6.03	59.60	

Based upon the depth of the Riverton formation perforations, total oil production shall not exceed 100 BOPD and total gas production shall not exceed 50% of the absolute open flow (AOF).

Commingling ID number CO061210 has been assigned to this approved application. Use this number for well completion reports (ACO-1) and other correspondence that may concern this approved commingling.

Sincerely,

Rick Hestermann
Production Department