

ORIGINAL

SIDE ONE

20662

STATE CORPORATION COMMISSION OF KANSAS  
OIL & GAS CONSERVATION DIVISION  
WELL COMPLETION FORM  
ACO-1 WELL HISTORY  
DESCRIPTION OF WELL AND LEASE

API NO. 15- 033-20,622 00-01  
County Comanche  
C -- SW SW Sec. 18 Twp. 33S Rge. 19 East West X

Operator: License # 30604  
Name: RAYDON EXPLORATION, INC.  
Address 9400 N. Broadway - Suite 400  
City/State/Zip Oklahoma City, Okla. 37114

660 Ft. North from Southeast Corner of Section  
4620 Ft. West from Southeast Corner of Section  
(NOTE: Locate well in section plat below.)

Purchaser:  
Operator Contact Person: Steve Raybourn  
Phone (405) 478-8585  
Contractor: Name: DUKE DRILLING CO., INC.  
License: 5929

Lease Name Baker Well # 1-18  
Field Name Wildcat  
Producing Formation Mississippi  
Elevation: Ground 1968' KB  
Total Depth 6490' PBDT 5393'

Wellsite Geologist: Lou Bird  
Designate Type of Completion  
 New Well  Re-Entry  Workover  
 Oil  SWD  Temp. Abd.  
 Gas  Inj  Delayed Comp.  
 Dry  Other (Core, Water Supply, etc.)

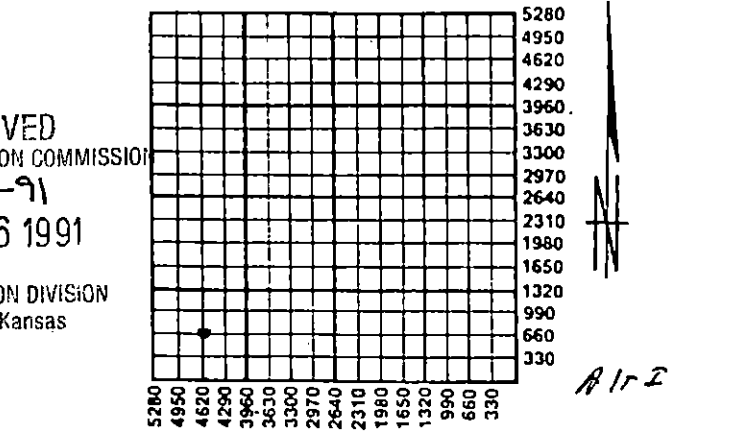

If OMO: old well info as follows:  
Operator: Gear Petroleum Co., Inc.  
Well Name: Baker #1-18  
Comp. Date 9-25-84 old Total Depth 5400'  
Drilling Method:  
 Mud Rotary  Air Rotary  Cable  
1/2/91 1/10/91 4-11-91  
Spud Date Date Reached TD Completion Date

Amount of Surface Pipe Set and Cemented at 607' Feet  
Multiple Stage Cementing Collar Used?  Yes  No  
If yes, show depth set \_\_\_\_\_ Feet  
If Alternate II completion, cement circulated from N/A  
feet depth to \_\_\_\_\_ w/ \_\_\_\_\_ sx cmt.

INSTRUCTIONS: This form shall be completed in triplicate and filed with the Kansas Corporation Commission, 200 Colorado Derby Building, Wichita, Kansas 67202, within 120 days of the spud date of any well. Rule 82-3-130, 82-3-107 and 82-3-106 apply. Information on side two of this form will be held confidential for a period of 12 months if requested in writing and submitted with the form. See rule 82-3-107 for confidentiality in excess of 12 months. One copy of all wireline logs and drillers time log shall be attached with this form. ALL CEMENTING TICKETS MUST BE ATTACHED. Submit CP-4 form with all plugged wells. Submit CP-111 form with all temporarily abandoned wells. Any recompletion, workover or conversion of a well requires filing of ACO-2 within 120 days from commencement date of such work.

All requirements of the statutes, rules and regulations promulgated to regulate the oil and gas industry have been fully complied with and the statements herein are complete and correct to the best of my knowledge.

Signature [Signature]  
Title Agent Date 5-2-91  
Subscribed and sworn to before me this 2nd day of May, 19 91.  
Notary Public [Signature]  
Date Commission Expires August 16, 1994

K.C.C. OFFICE USE ONLY  
F  Letter of Confidentiality Attached  
C  Wireline Log Received  
C  Drillers Timelog Received  
Distribution  
 KCC  SWD/Rep  NGPA  
 KGS  Plug  Other (Specify)

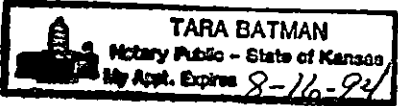

SIDE TWO

Operator Name RAYDON EXPLORATION, INC. Lease Name BAKER Well # 1-18  
 Sec. 18 Twp. 33S Rge. 19  East  West  
 County Comanche

INSTRUCTIONS: Show important tops and base of formations penetrated. Detail all cores. Report all drill stem tests giving interval tested, time tool open and closed, flowing and shut-in pressures, whether shut-in pressure reached static level, hydrostatic pressures, bottom hole temperature, fluid recovery, and flow rates if gas to surface during test. Attach extra sheet if more space is needed. Attach copy of log.

Drill Stem Tests Taken  Yes  No  
 (Attach Additional Sheets.)  
 Samples Sent to Geological Survey  Yes  No  
 Cores Taken  Yes  No  
 Electric Log Run  Yes  No  
 (Submit Copy.)  
 Submitted DIL dated 1-10-91

Formation Description		
Name	Top	Bottom
Heebner	4495	4303
Lansing K.C.	4853	4496
Stark Shale	5010	4854
Cherokee	5268	5011
Mississippian	5410	5269

Log  Sample

**CASING RECORD**  New  Used  
 Report all strings set-conductor, surface, intermediate, production, etc.

Purpose of String	Size Hole Drilled	Size Casing Set (In O.D.)	Weight Lbs./Ft.	Setting Depth	Type of Cement	# Sacks Used	Type and Percent Additives
Surface	12-1/4	8-5/8	24	607'	N/A	N/A	N/A
Production	7-7/8	4-1/2	10.5	5455.33'	Class H	150	5% A-10, 1% Bit gel, 10% A-5

PERFORATION RECORD		Acid, Fracture, Shot, Cement Squeeze Record	
Shots Per Foot	Specify Footage of Each Interval Perforated	(Amount and Kind of Material Used)	Depth
2 SPF	5236-40'	500 gal 15% acid plus 38 BS	5236-40'
2 SPF	5250-57'	2500 gal 15% acid plus 12 BS	5250-57'

**TUBING RECORD** Size 2-3/8" Set At 5200' Packer At 5200' Liner Run  Yes  No

Date of First Production Waiting on P/L Producing Method  Flowing  Pumping  Gas Lift  Other (Explain)

Estimated Production Per 24 Hours	Oil Bbls.	Gas Mcf	Water Bbls.	Gas-Oil Ratio	Gravity
	trace	400	trace		

Disposition of Gas:  Vented  Sold  Used on Lease (If vented, submit ACO-18.)  
 METHOD OF COMPLETION:  Open Hole  Perforation  Dually Completed  Commingled  
 Other (Specify) \_\_\_\_\_

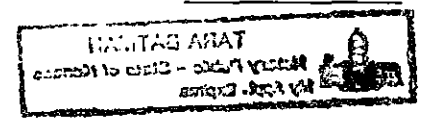



ORIGINAL

ORIGINAL

INVOICE DATE

01/11/91

DIRECT BILLING INQUIRIES TO:  713-895-5821	TERMS  NET AMOUNT DUE 30 DAYS FROM DATE OF INVOICE	REMIT TO:  D.J. SERVICES P.O. BOX 100306 HOUSTON, TX 77212
--	--	--

PAGE  1	INVOICE NO.  636452
---------------	---------------------------

RAYDON EXPLORATION INC  
9400 N BROADWAY  
SUITE 400  
OKLAHOMA CITY OK 73114



AUTHORIZED BY  636452
-----------------------------

PURCH. ORDER REF. NO.  N/A
----------------------------------

WELL NUMBER : 1-18      CUSTOMER NUMBER : 13284 - 1

LEASE NAME AND NUMBER  BAKER WD	STATE  14	COUNTY/PARISH  1407	CITY  Medicine Lodge	DISTRICT NAME  584	DISTR. NO.
JOB LOCATION/FIELD  WILDCAT	MTA DISTRICT	DATE OF JOB  01/11/91	TYPE OF SERVICE  LAND-PLUG AND ABANDON		

PRODUCT NUMBER	QUANTITY	DESCRIPTION	UNIT PRICE	U/M	EXTENDED PRICE
10100333	1.00	CEMENT CASING 5,001 TO 5,500 FEET	1325.00		1,325.00
			765.00		765.00
10103210	1.00	COMBINATION PLUG-BACK & CASING JOB	1155.00		1,155.00
10107891	1.00	Fuel Surcharge	136.36		136.36
10109005	55.00	MILEAGE CHRG. FROM NEAREST BASE OF	2.35		129.25
10409600	1.00	4-1/2" GUIDE SHOE -	109.00	GAL	109.00
10409600	1.00	THREAD LOCK - W	22.80	GAL	22.80
10409600	6.00	4-1/2" CENTRALIZERS -	43.55	GAL	261.30
10409600	1.00	4-1/2" STOP RING - B	16.65	GAL	16.65
10409600	1.00	4-1/2" FLOAT COLLAR - W	248.00	GAL	248.00
10419505	250.00	CLASS H CEMENT	5.95	QT	1,487.50
10415038	500.00	A-5 SALT	0.11	LB	55.00

RECEIVED  
STATE CORPORATION COMMISSION  
MAY 06 1991  
CONSERVATION DIVISION  
Wichita, Kansas

*Keith,  
Do we really  
have to pay these  
semp charges?*

ACCOUNT	NO.
	ADP
	BY
	DESCRIP

TAX EXEMPTION STATUS:



ORIGINAL

ORIGINAL

INVOICE DATE

01/11/91

DIRECT BILLING INQUIRIES TO:  713-895-5821	TERMS NET AMOUNT DUE 30 DAYS FROM DATE OF INVOICE	REMIT TO: B.J. SERVICES P.O. BOX 100806 HOUSTON, TX 77212
--	--	--

PAGE 2	INVOICE NO. 636452
-----------	-----------------------

RAYDON EXPLORATION INC  
9400 N BROADWAY  
SUITE 400  
OKLAHOMA CITY OK 73114

AUTHORIZED BY  636452
-----------------------------

PURCH. ORDER REF. NO.  N/A
----------------------------------

WELL NUMBER : 1-18      CUSTOMER NUMBER : 13284 - 1

LEASE NAME AND NUMBER BAKER WD	STATE 14	COUNTY/PARISH 1407	CITY Medicine Lodge	DISTRICT NAME 584	DISTR. NO.
JOB LOCATION/FIELD WILDCAT	MTA DISTRICT	DATE OF JOB 01/11/91	TYPE OF SERVICE LAND-PLUG AND ABANDON		

PRODUCT NUMBER	QUANTITY	DESCRIPTION	UNIT PRICE	U/M	EXTENDED PRICE
10420145	100.00	BJ-TITAN GEL, BENTONITE, BULK SALE	0.13	LB	13.00
10425005	500.00	MUD-CLEAN	0.48	GAL	240.00
10428020	600.00	A-10 GYPSEAL	0.22	LB	132.00
10428048	650.00	A-9 KCL	0.25	LB	162.50
10430608	1.00	4 1/2" TOP RESIN/PLASTIC CORE	44.00	EA	44.00
10880001	275.00	MIXING SERVICE CHR6 DRY MATERIALS,	1.10		302.50
10940101	699.00	DRAYAGE, PER TON MILE	0.75		524.25
			SUBTOTAL		7,129.11
			DISCOUNT		1,538.41

RECEIVED  
STATE CORPORATION COMMISSION

MAY 06 1991

CONSERVATION DIVISION  
Wichita, Kansas

ACCOUNT	1.0000% BARBER	2,177.56	21.77
	4.2500% KS-NEW WELL	2,177.56	92.55

TAX EXEMPTION STATUS:

PAY THIS AMOUNT

5,705.02



ORIGINAL

ORIGINAL

INVOICE DATE  
01/11/91

DIRECT BILLING INQUIRIES TO:  713-895-5821	TERMS  NET AMOUNT DUE 30 DAYS FROM DATE OF INVOICE	REMIT TO:  B.J. SERVICES P.O. BOX 100306 HOUSTON, TX 77212
--	--	--

PAGE 1	INVOICE NO. 636452
-----------	-----------------------

RAYDON EXPLORATION INC  
9400 N BROADWAY  
SUITE 400  
OKLAHOMA CITY OK 73114



AUTHORIZED BY  
636452

PURCH. ORDER REF. NO.  
N/A

WELL NUMBER : 1-18      CUSTOMER NUMBER : 13284 - 1

LEASE NAME AND NUMBER BAKER WD	STATE 14	COUNTY/PARISH 1407	CITY	DISTRICT NAME Medicine Lodge	DISTR. NO. 534
JOB LOCATION/FIELD WILDCAT	MTA DISTRICT	DATE OF JOB 01/11/91	TYPE OF SERVICE LAND-PLUG AND ABANDON		

PRODUCT NUMBER	QUANTITY	DESCRIPTION	UNIT PRICE	U/M	EXTENDED PRICE
10100335	1.00	CEMENT CASING 5,001 TO 5,500 FEET	1325.00		1,325.00
			765.00		765.00
10103210	1.00	COMBINATION PLUG-BACK & CASING JOB	1155.00		1,155.00
10107891	1.00	Fuel Surcharge	136.36		136.36
10109005	55.00	MILEAGE CHR6, FROM NEAREST BASE OF	2.35		129.25
10409600	1.00	4-1/2" GUIDE SHOE - W	109.00	GAL	109.00
10409600	1.00	THREAD LOCK - W	22.80	GAL	22.80
10409600	6.00	4-1/2" CENTRALIZERS - W	43.55	GAL	261.30
10409600	1.00	4-1/2" STOP RING - B	16.65	GAL	16.65
10409600	1.00	4-1/2" FLOAT COLLAR - W	248.00	GAL	248.00
10419505	250.00	CLASS H CEMENT	5.95	QT	1,487.50
10415038	500.00	A-5 SALT	0.11	LB	55.00

RECEIVED  
STATE CORPORATION COMMISSION  
MAY 06 1991  
CONSERVATION DIVISION  
Wichita, Kansas

*Keith,  
Do we really  
have to pay these  
comp charges?*

BY \_\_\_\_\_  
DESCRIP1 \_\_\_\_\_

1-29-91

TAX EXEMPTION STATUS:



ORIGINAL

ORIGINAL

INVOICE DATE
01/11/91

DIRECT BILLING INQUIRIES TO: 713-895-5821	TERMS NET AMOUNT DUE 30 DAYS FROM DATE OF INVOICE	REMIT TO: B.J. SERVICES P.O. BOX 100806 HOUSTON, TX 77212
--	--	--

PAGE 2	INVOICE NO. 636452
-----------	-----------------------

AUTHORIZED BY 636452
-------------------------

PURCH. ORDER REF. NO. N/A
------------------------------

RAYDON EXPLORATION INC  
9400 N BROADWAY  
SUITE 400  
OKLAHOMA CITY OK 73114

WELL NUMBER : 1-18      CUSTOMER NUMBER : 13284 - 1

LEASE NAME AND NUMBER BAKER WD	STATE 14	COUNTY/PARISH 1407	CITY Medicine Lodge	DISTRICT NAME 584	DISTR. NO.
JOB LOCATION/FIELD HILDCAT	MTA DISTRICT	DATE OF JOB 01/11/91	TYPE OF SERVICE LAND-PLUG AND ABANDON		

PRODUCT NUMBER	QUANTITY	DESCRIPTION	UNIT PRICE	U/M	EXTENDED PRICE
10420145	100.00	BJ-TITAN GEL, BENTONITE, BULK SALE	0.13	LB	13.00
10425005	500.00	MUD-CLEAN	0.48	GAL	240.00
10423028	600.00	A-10 GYPSEAL	0.22	LB	132.00
10423048	650.00	A-9 KCL	0.25	LB	162.50
10430608	1.00	4 1/2" TOP RESIN/PLASTIC CORE	44.00	EA	44.00
10880001	275.00	MIXING SERVICE CHRG DRY MATERIALS,	1.10		302.50
10940101	699.00	DRAYAGE, PER TON MILE	0.75		524.25
SUBTOTAL					7,129.11
DISCOUNT					1,538.41

RECEIVED  
STATE CORPORATION COMMISSION

MAY 06 1991

CONSERVATION DIVISION  
Wichita, Kansas

ACCOUNT	1.0000% BARBER	2,177.56	21.77
	4.2500% KS-NEW WELL	2,177.56	92.55

TAX EXEMPTION STATUS:

PAY THIS AMOUNT

5,705.02



ORIGINAL

ORIGINAL

INVOICE DATE

01/11/91

DIRECT BILLING INQUIRIES TO:  713-895-5821	TERMS  NET AMOUNT DUE 30 DAYS FROM DATE OF INVOICE	REMIT TO:  D.J. SERVICES P.O. BOX 100306 HOUSTON, TX 77212
--	--	--

PAGE  1	INVOICE NO.  636452
---------------	---------------------------

RAYDON EXPLORATION INC

9400 N BROADWAY  
SUITE 400  
OKLAHOMA CITY OK 73114



AUTHORIZED BY
636452

PURCH. ORDER REF. NO.  N/A
----------------------------------

WELL NUMBER : 1-18 CUSTOMER NUMBER : 13284 - 1

LEASE NAME AND NUMBER  BAKER WD	STATE  14	COUNTY/PARISH  1407	CITY  Medicine Lodge	DISTRICT NAME  534	DISTR. NO.
JOB LOCATION/FIELD  WILDCAT	MTA DISTRICT	DATE OF JOB  01/11/91	TYPE OF SERVICE  LAND-PLUG AND ABANDON		

PRODUCT NUMBER	QUANTITY	DESCRIPTION	UNIT PRICE	U/M	EXTENDED PRICE
10109333	1.00	CEMENT CASING 5,001 TO 5,500 FEET	1325.00		1,325.00
			765.00		765.00
10103210	1.00	COMBINATION PLUG-BACK & CASING JOB	1155.00		1,155.00
10107891	1.00	Fuel Surcharge	136.36		136.36
10109095	55.00	MILEAGE CHRGE FROM NEAREST BASE OF	2.35		129.25
10409600	1.00	4-1/2" GUIDE SHOE - W	109.00	GAL	109.00
10409600	1.00	THREAD LOCK - W	22.80	GAL	22.80
10409600	6.00	4-1/2" CENTRALIZERS - W	43.55	GAL	261.30
10409600	1.00	4-1/2" STOP RING - B	16.65	GAL	16.65
10409600	1.00	4-1/2" FLOAT COLLAR - W	248.00	GAL	248.00
10419505	250.00	CLASS H CEMENT	5.95	QT	1,487.50
10415038	500.00	A-5 SALT	0.11	LB	55.00

RECEIVED  
STATE COMMISSION  
MAY 06 1991  
CONSERVATION DIVISION  
Wichita, Kansas

*Kath,  
Do we really  
have to pay these  
any charges?*

ACCOUNT	ADP	BY	DESCRIP
---------	-----	----	---------

TAX EXEMPTION STATUS:

