

For KCC Use: 8-19-01
 Effective Date: 8-19-01
 District #: 1
 SGA? Yes No

KANSAS CORPORATION COMMISSION
 OIL & GAS CONSERVATION DIVISION

RECEIVED

Form C-1
 September 1999

NOTICE OF INTENT TO DRILL

AUG - 8 2001

Form must be Typed
 Form must be Signed
 All blanks must be Filled

Must be approved by KCC five (5) days prior to commencing well

Expected Spud Date 8 - 21 - 01
month day year

OPERATOR: License# 5123
 Name: Pickrell Drilling Co. Inc.
 Address: 100 S. Main, Suite 505
 City/State/Zip: Wichita, Kansas 67202-3738
 Contact Person: Larry J. Richardson
 Phone: 316-262-8427

CONTRACTOR: License# 5123
 Name: Company Tools

Well Drilled For:	Well Class:	Type Equipment:
<input checked="" type="checkbox"/> Oil <input checked="" type="checkbox"/> Gas <input type="checkbox"/> OWWO <input type="checkbox"/> Seismic; # of Holes <input type="checkbox"/> Other	<input type="checkbox"/> Enh Rec <input type="checkbox"/> Storage <input type="checkbox"/> Disposal <input type="checkbox"/> Other	<input checked="" type="checkbox"/> Mud Rotary <input type="checkbox"/> Air Rotary <input type="checkbox"/> Cable
<input type="checkbox"/> Infield <input type="checkbox"/> Pool Ext. <input checked="" type="checkbox"/> Wildcat		

If OWWO: old well information as follows:
 Operator: _____
 Well Name: _____
 Original Completion Date: _____ Original Total Depth: _____

Directional, Deviated or Horizontal wellbore? Yes No
 If Yes, true vertical depth: _____
 Bottom Hole Location: _____
 KCC DKT #: _____

* WATCH FOR LOST CIRCULATION ZONE ± 400'

AFFIDAVIT

The undersigned hereby affirms that the drilling, completion and eventual plugging of this well will comply with K.S.A. 55-101, et. seq.
 It is agreed that the following minimum requirements will be met:

1. Notify the appropriate district office **prior** to spudding of well;
2. A copy of the approved notice of intent to drill **shall be** posted on each drilling rig;
3. The minimum amount of surface pipe as specified below **shall be set** by circulating cement to the top; in all cases surface pipe **shall be set** through all unconsolidated materials plus a minimum of 20 feet into the underlying formation.
4. If the well is dry hole, an agreement between the operator and the district office on plug length and placement is necessary **prior to plugging**;
5. The appropriate district office will be notified before well is either plugged or production casing is cemented in;
6. If an ALTERNATE II COMPLETION, production pipe shall be cemented from below any usable water to surface within **120 days** of spud date. **In all cases, NOTIFY district office** prior to any cementing.

I hereby certify that the statements made herein are true and to the best of my knowledge and belief.

Date: 8-08-01 Signature of Operator or Agent: [Signature] Title: Geologist

For KCC Use ONLY
 API # 15 - 033-21260-00-00
 Conductor pipe required NONE feet
 Minimum surface pipe required 200' feet per Alt. 1
 Approved by: DPW 8-14-01
 This authorization expires: 2-14-02
 (This authorization void if drilling not started within 6 months of effective date.)
 Spud date: _____ Agent: _____

KCC WICHITA
 Spot 40' North & 35' E. of _____ East
SW - SE - SW Sec. 2 Twp. 33 S. R. 20 West
370' feet from (S) / N (circle one) Line of Section
1685' feet from E / (W) (circle one) Line of Section
 Is SECTION Regular Irregular?
 (Note: Locate well on the Section Plat on reverse side)
 County: Comanche
 Lease Name: Sangster-Webb "A" Well #: 1
 Field Name: _____
 Is this a Prorated / Spaced Field? Yes No
 Target Information(s): Mississippi, Viola
 Nearest Lease or unit boundary: 330' (?)370' ✓
 Ground Surface Elevation: 1828' feet MSL
 Water well within one-quarter mile: Yes No
 Public water supply well within one mile: Yes No
 Depth to bottom of fresh water: 85' ✓
 Depth to bottom of usable water: 180' ✓
 Surface Pipe by Alternate: 1 2
 Length of Surface Pipe Planned to be set: 200'+ ✓
 Length of Conductor Pipe required: N/A
 Projected Total Depth: 6600'
 Producing Formation Target: Mississippian, Viola
 Water Source for Drilling Operations:
 Well _____ Farm Pond _____ Other X
 DWR Permit #: _____
 (Note: Apply for Permit with DWR)
 Will Cores be taken? Yes No
 If Yes, proposed zone: _____

- Remember to:**
- File Drill Pit Application (form CDP-1) with Intent to Drill;
 - File Completion Form ACO-1 within 120 days of spud date;
 - File acreage attribution plat according to field proration orders;
 - Notify appropriate district office 48 hours prior to workover or re-entry;
 - Submit plugging report (CP-4) after plugging is completed;
 - Obtain written approval before disposing or injecting salt water.

2
33
200

IN ALL CASES PLOT THE INTENDED WELL ON THE PLAT BELOW

Plat of acreage attributable to a well in a prorated or spaced field

If the intended well is in a prorated or spaced field, please fully complete this side of the form. If the intended well is in a prorated or spaced field complete the plat below showing that the well will be properly located in relationship to other wells producing from the common source of supply. Please show all the wells and within 1 mile of the boundaries of the proposed acreage attribution unit for gas wells and within 1/2 mile of the boundaries of the proposed acreage attribution unit for oil wells.

API No. 15 - _____
 Operator: Pickrell Drilling Company, Inc.
 Lease: Sangster-Webb "A"
 Well Number: #1
 Field: Wildcat

Location of Well: County: Comanche
 _____ 370' feet from (S) / N (circle one) Line of Section
 _____ 1685' feet from E (W) (circle one) Line of Section
 Sec. 2 Twp. 33 S. R. 20 East West

Number of Acres attributable to well: _____
 QTR / QTR / QTR of acreage: SW - SE - SW

Is Section X Regular or _____ Irregular

If Section is Irregular, locate well from nearest corner boundary.
 Section corner used: SE X SW

PLAT

*(Show location of the well and shade attributable acreage for prorated or spaced wells.)
 (Show footage to the nearest lease or unit boundary line.)*

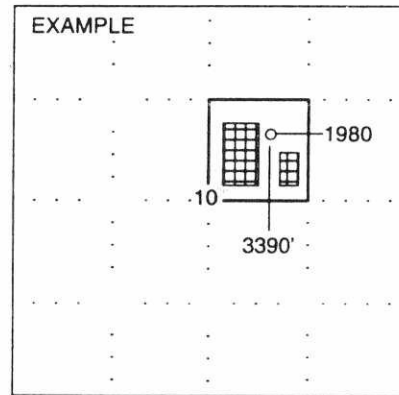
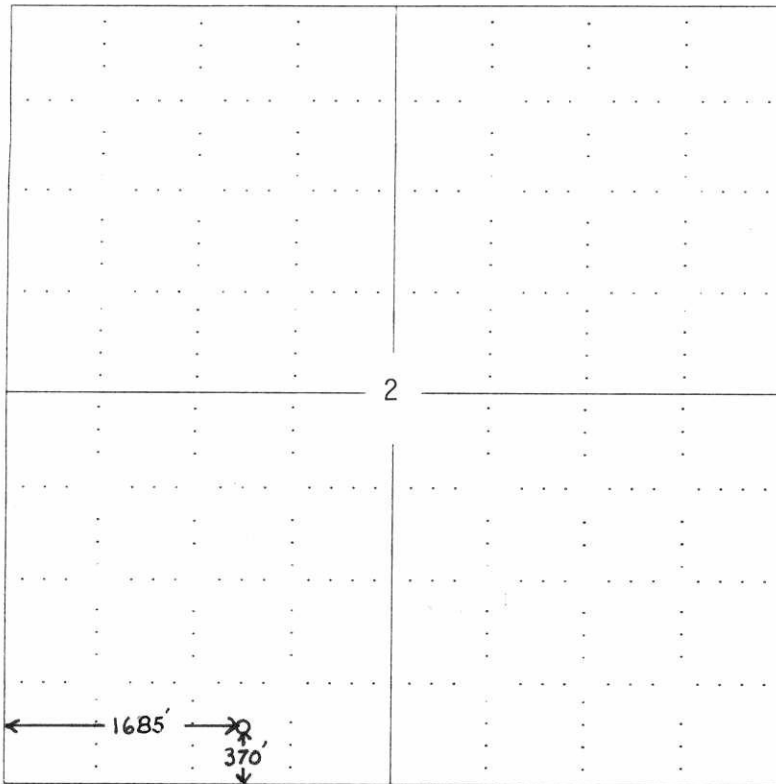

NOTE: In all cases locate the spot of the proposed drilling locaton.

In plotting the proposed location of the well, you must show:

1. The manner in which you are using the depicted plat by identifying section lines, i.e. 1 section, 1 section with 8 surrounding sections, 4 sections, etc.
2. The distance of the proposed drilling location from the section's south / north and east / west.
3. The distance to the nearest lease or unit boundary line.
4. If proposed location is located within a prorated or spaced field a certificate of acreage attribution plat must be attached: (CO-7 for oil wells; CG-8 for gas wells).



Kansas Corporation Commission

Bill Graves, Governor John Wine, Chair Cynthia L. Claus, Commissioner Brian J. Moline, Commissioner

August 14, 2001

Larry J Richardson
Pickrell Drilling Co., Inc.
100 S Main, Ste 505
Wichita KS 67202-3738

Re: Drilling Pit Application
 Sangster-Webb A Lease Well No. 1
 SW/4 2-33S-20W
 Comanche County, Kansas

Dear Mr. Richardson:

District staff has inspected the location and has determined that an unsealed condition will present a pollution threat to water resources.

District staff has instructed that no earthen pits are to be used at this location. Steel pits are to be used. Please inform the Commission in writing as to which disposal well you utilized to dispose of the contents in the steel pits and the amount of fluid that was disposed. The enclosed Surface Pond Waste Transfer, form CDP-5, must be filed within 30 days of fluid transfer.

District staff indicated that a haul-off pit would be utilized, please complete the enclosed CDP-1. This location has been inspected and staff has determined that the pit shall be constructed **without slots**, the bottom shall be flat and reasonably level and the free fluids must be removed. The fluids are to be removed from the pit as soon as the Hutchinson Salt section has been drilled through and displacement of the fluids into the pit has occurred. The fluids should be removed again as soon as practical after drilling operations have ceased

Sincerely,

A handwritten signature in cursive script that reads "Jonelle Rains".

Jonelle Rains, Supervisor
Environmental Protection and Remediation Department

Cc: Steve Durrant