

FOR KCC USE:

EFFECTIVE DATE: 5-26-93

DISTRICT #

SGA7... Yes No

State of Kansas **X Correction**
NOTICE OF INTENTION TO DRILL

Must be approved by the K.C.C. five (5) days prior to commencing well

FORM C-1 7/91

FORM MUST BE TYPED

FORM MUST BE SIGNED

ALL BLANKS MUST BE FILLED

Expected Spud Date May 26 1993
month day year

Spot C-NW SE Sec 10 Twp 33 S, Rg 17 X East West

OPERATOR: License # 5278
Name: Enron Oil & Gas Company
Address: 20 North Broadway, Suite 830
City/State/Zip: Oklahoma City, OK 73102
Contact Person: Craig Northcutt
Phone: (405) 239-7800

1980 feet from South XXXX line of Section
1980 feet from East XXXX line of Section
IS SECTION X REGULAR IRREGULAR?

(NOTE: Locate well on the Section Plat on Reverse Side)
County: Comanche
Lease Name: Victor 10 Well #: 1 Re-entry
Field Name: Wildcat

CONTRACTOR: License #: 5840
Name: Brandt Drilling Co. Inc.

Is this a Prorated/Spaced Field? ... yes X no
Target Formation(s): Ft. Scott

Well Drilled For: Well Class: Type Equipment:
... Oil ... Enh Rec ... Infield X Mud Rotary
... Gas ... Storage ... Pool Ext. ... Air Rotary
X OWWO ... Disposal X Wildcat ... Cable
... Seismic; ... # of Holes ... Other

Nearest lease or unit boundary: 660
Ground Surface Elevation: 1907 feet MSL
Water well within one-quarter mile: ... yes X no

If OWWO: old well information as follows:
Operator: Huymon Corporation
Well Name: Victor #1
Comp. Date: 7-25-81 Old Total Depth: 5172'

Public water supply well within one mile: ... yes X no
Depth to bottom of fresh water: 70
Depth to bottom of usable water: 185

Directional, Deviated or Horizontal wellbore? ... yes X no
If yes, true vertical depth:
Bottom Hole Location:

Surface Pipe by Alternate: X 1 2
Length of Surface Pipe Planned to be set: 494
Length of Conductor pipe required:

X Was # 15-033-20851-0001

AFFIDAVIT

X 15-033-20459-0001

The undersigned hereby affirms that the drilling, completion and eventual plugging of this well will comply with K.S.A. 55-101, et. seq.
It is agreed that the following minimum requirements will be met:

RECEIVED
MAY 20 1993
05-20-1993
CONSERVATION DIVISION
WICHITA, KS

1. Notify the appropriate district office prior to spudding of well;
2. A copy of the approved notice of intent to drill shall be posted on each drilling rig;
3. The minimum amount of surface pipe as specified below shall be set by circulating cement to the top; in all cases surface pipe shall be set through all unconsolidated materials plus a minimum of 20 feet into the underlying formation;
4. If the well is dry hole, an agreement between the operator and the district office on plug length and placement is necessary prior to plugging;
5. The appropriate district office will be notified before well is either plugged or production casing is cemented in;
6. IF AN ALTERNATE II COMPLETION, PRODUCTION PIPE SHALL BE CEMENTED FROM BELOW ANY USABLE WATER TO SURFACE WITHIN 120 DAYS OF SPUD DATE. IN ALL CASES, NOTIFY DISTRICT OFFICE PRIOR TO ANY CEMENTING.

I hereby certify that the statements made herein are true and to the best of my knowledge and belief.
Date: 5-20-93 Signature of Operator or Agent: Craig Northcutt Title: Proj. Drlg. Engr.

FOR KCC USE: 15-033-20459-0001
API # 15-
Conductor pipe required Ann 18 feet
Minimum surface pipe required 200 feet per Alt. (1)
Approved by: DR 5-21-93
This authorization expires: 11-21-93
(This authorization void if drilling not started within 6 months of effective date.)
Spud date: Agent:

REMEMBER TO:

- File Drill Pit Application (form CDP-1) with Intent to Drill;
- File Completion Form ACO-1 within 120 days of spud date;
- File acreage attribution plat according to field proration orders;
- Notify appropriate district office 48 hours prior to workover or re-entry;
- Submit plugging report (CP-4) after plugging is completed;
- Obtain written approval before disposing or injecting salt water.

Mail to: Conservation Division, 200 Colorado Derby Building, 202 W. First St., Wichita, Kansas 67202-1286.

10
33
17 W

IN ALL CASES - PLOT THE INTENDED WELL ON THE PLAT BELOW

PLAT OF ACREAGE ATTRIBUTABLE TO A WELL IN A PRORATED OR SPACED FIELD

If the intended well is in a prorated or spaced field, please fully complete this side of the form. If the intended well is in a prorated or spaced field complete the plat below showing that the well will be properly located in relationship to other wells producing from the common source of supply. Please show all the wells within 1 mile of the boundaries of the proposed acreage attribution unit for gas wells and within 1/2 mile of the boundaries of the proposed acreage attribution unit for oil wells.

API NO. 15- _____
 OPERATOR Enron Oil & Gas Company
 LEASE Victor 10
 WELL NUMBER 1 Re-entry
 FIELD Wildcat

LOCATION OF WELL: COUNTY Comanche
 _____ feet from south/~~north~~ line of section
1980
 _____ feet from east/~~west~~ line of section
1980
 SECTION 10 TWP 33S RG 17W

NUMBER OF ACRES ATTRIBUTABLE TO WELL 320
 QTR/QTR/QTR OF ACREAGE E/2

IS SECTION X REGULAR or _____ IRREGULAR
IF SECTION IS IRREGULAR, LOCATE WELL FROM NEAREST CORNER BOUNDARY.

Section corner used: _____ NE _____ NW _____ SE _____ SW

PLAT

(Show location of the well and shade attributable acreage for prorated or spaced wells.)
 (Show footage to the nearest lease or unit boundary line.)

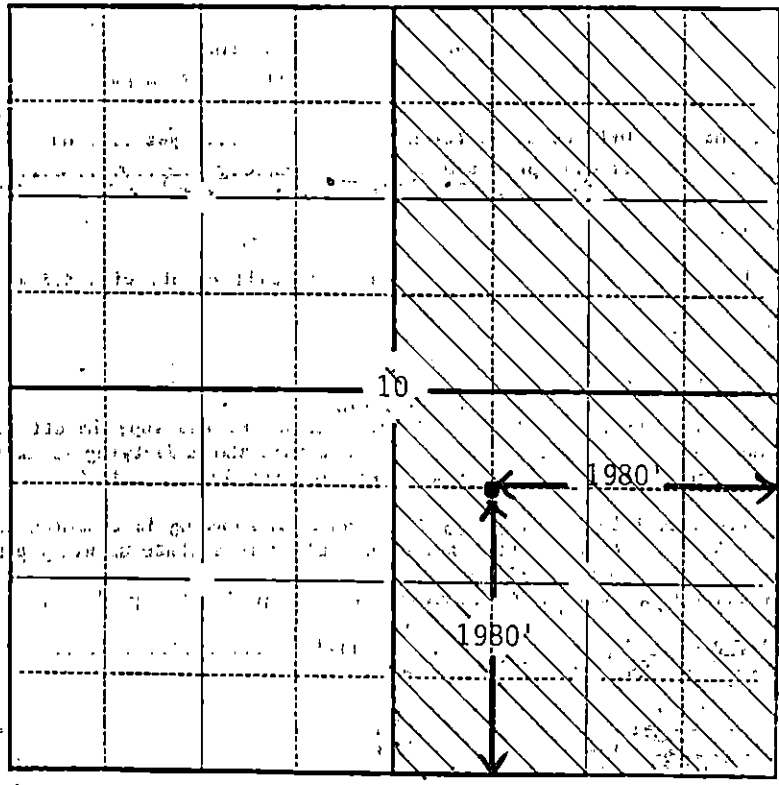

320 Acres

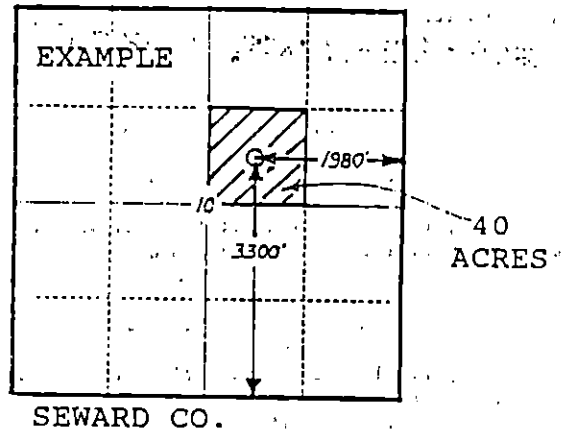

In plotting the proposed location of the well, you must show:

- 1) The manner in which you are using the depicted plat by identifying section lines, i.e. 1 section, 1 section with 8 surrounding sections, 4 sections, etc.;
- 2) the distance of the proposed drilling location from the section's south/north and east/west lines; and
- 3) the distance to the nearest lease or unit boundary line.