

For KCC Use:
Effective Date: 12-23-01
District # 1
SGA? Yes No

KANSAS CORPORATION COMMISSION
OIL & GAS CONSERVATION DIVISION
NOTICE OF INTENT TO DRILL

Form C-1
September 1999
Form must be Typed
Form must be Signed
All blanks must be Filled

Must be approved by KCC five (5) days prior to commencing well

Expected Spud Date January 15, 2002
month day year

Spot AP-150' E of East
SW SE Sec. 30 Twp. 33 S. R. 19 West
660 feet from S (circle one) Line of Section
1830 feet from E (circle one) Line of Section

OPERATOR: License# 5214
Name: Lario Oil & Gas Company
Address: 301 South Market
City/State/Zip: Wichita, KS 67202
Contact Person: Jay G. Schweikert
Phone: 316-265-5611

Is SECTION Regular Irregular?
(Note: Locate well on the Section Plat on reverse side)
County: Comanche
Lease Name: Baker Well #: 1-30
Field Name: Wildcat

CONTRACTOR: License# 5123
Name: Pickrell Drilling Co., Inc.

Is this a Prorated / Spaced Field? Yes No
Target Formation(s): Marmaton, Pawnee, Ft. Scott, Mississippi & Viola

Well Drilled For: Well Class: Type Equipment:
 Oil Enh Rec Infield Mud Rotary
 Gas Storage Pool Ext. Air Rotary
 OWO Disposal Wildcat Cable
 Seismic; # of Holes Other
 Other

Nearest Formation or unit boundary: 660 ft
Ground Surface Elevation: 1890 feet MSL
Water well within one-quarter mile: Yes No
Public water supply well within one mile: Yes No
Depth to bottom of fresh water: 60 ft
Depth to bottom of usable water: 180 ft
Surface Pipe by Alternate: X 1 2
Length of Surface Pipe Planned to be set: 680 ft
Length of Conductor Pipe required: 50 ft
Projected Total Depth: 6300 ft
Formation at Total Depth: Viola

If OWWO: old well information as follows:
Operator: _____
Well Name: _____
Original Completion Date: _____ Original Total Depth: _____

Water Source for Drilling Operations: Well Farm Pond Other
DWR Permit #: _____
(Note: Apply for Permit with DWR)
Will Cores be taken? Yes No
If Yes, proposed zone: _____

Directional, Deviated or Horizontal wellbore? Yes No
If Yes, true vertical depth: _____
Bottom Hole Location: _____
KCC DKT #: _____

RECEIVED
12-17-01
DEC 17 2001

AFFIDAVIT

The undersigned hereby affirms that the drilling completion and eventual plugging of this well will comply with K.S.A. 55-101, et. seq.
It is agreed that the following minimum requirements will be met:
1. Notify the appropriate district office **prior** to spudding of well;
2. A copy of the approved notice of intent to drill **shall be** posted on each drilling rig;
3. The minimum amount of surface pipe as specified below **shall be set** by circulating cement to the top; in all cases surface pipe **shall be set** through all unconsolidated materials plus a minimum of 20 feet into the underlying formation.
4. If the well is dry hole, an agreement between the operator and the district office on plug length and placement is necessary **prior to plugging**;
5. The appropriate district office will be notified before well is either plugged or production casing is cemented in;
6. If an ALTERNATE II COMPLETION, production pipe shall be cemented from below any usable water to surface within **120 days** of spud date. **In all cases, NOTIFY district office** prior to any cementing.

I hereby certify that the statements made herein are true and to the best of my knowledge and belief.
Date: 12-14-01 Signature of Operator or Agent: Jay G. Schweikert Title: Operations Engineer
Jay G. Schweikert

For KCC Use ONLY
API # 15 - 033-21291-0000
Conductor pipe required NONE feet
Minimum surface pipe required 200 feet per Alt. (1)
Approved by: RJP 12-18-01
This authorization expires: 6-18-02
(This authorization void if drilling not started within 6 months of effective date.)
Spud date: _____ Agent: _____

Remember to:
- File Drill Pit Application (form CDP-1) with Intent to Drill;
- File Completion Form ACO-1 within 120 days of spud date;
- File acreage attribution plat according to field proration orders;
- Notify appropriate district office 48 hours prior to workover or re-entry;
- Submit plugging report (CP-4) after plugging is completed;
- Obtain written approval before disposing or injecting salt water.

30
33
19W

IN ALL CASES PLOT THE INTENDED WELL ON THE PLAT BELOW

Plat of acreage attributable to a well in a prorated or spaced field

If the intended well is in a prorated or spaced field, please fully complete this side of the form. If the intended well is in a prorated or spaced field complete the plat below showing that the well will be properly located in relationship to other wells producing from the common source of supply. Please show all the wells and within 1 mile of the boundaries of the proposed acreage attribution unit for gas wells and within 1/2 mile of the boundaries of the proposed acreage attribution unit for oil wells.

API No. 15 - _____
 Operator: Lario Oil & Gas Company
 Lease: Baker
 Well Number: 1-30
 Field: Wildcat
 Number of Acres attributable to well: 160
 QTR / QTR / QTR of acreage: _____ - SW - SE

Location of Well: County: Comanche
 _____ 660 _____ feet from (S) N (circle one) Line of Section
 _____ 1830 _____ feet from (E) / W (circle one) Line of Section
 Sec. 30 Twp. 33 S. R. 19 East West

Is Section Regular or _____ Irregular

If Section is Irregular, locate well from nearest corner boundary.
 Section corner used: _____ NE _____ NW _____ SE _____ SW.

PLAT

*(Show location of the well and shade attributable acreage for prorated or spaced wells.)
 (Show footage to the nearest lease or unit boundary line.)*

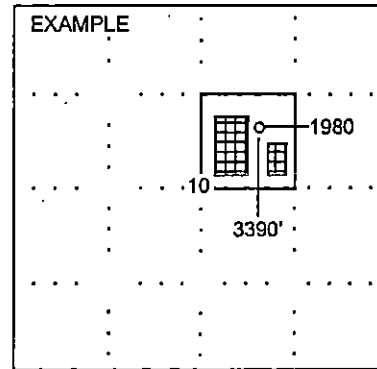
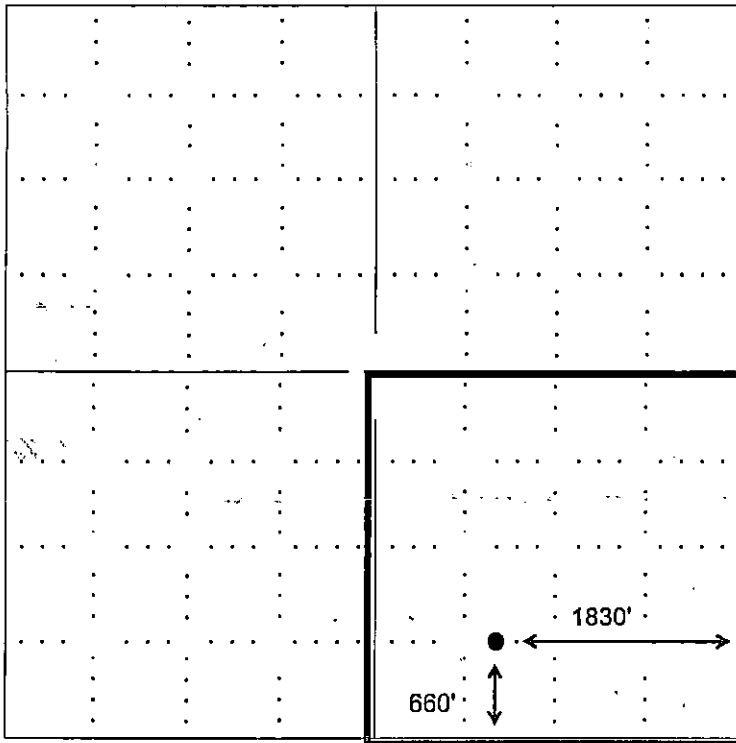

NOTE: In all cases locate the spot of the proposed drilling locaton.

In plotting the proposed location of the well, you must show:

1. The manner in which you are using the depicted plat by identifying section lines, i.e. 1 section, 1 section with 8 surrounding sections, 4 sections, etc.
2. The distance of the proposed drilling location from the section's south / north and east / west.
3. The distance to the nearest lease or unit boundary line.
4. If proposed location is located within a prorated or spaced field a certificate of acreage attribution plat must be attached: (C0-7 for oil wells; CG-8 for gas wells).