



15-223-2087-0000

CP2

ROBERT B. DOCKING Governor  
WILLIAM L. MITCHELL Chairman  
JAMES O. GREENLEAF Commissioner  
DALE E. SAFFELS Commissioner  
RAYMOND B. HARVEY Secretary  
E. EDWARD JOHNSON Gen. Counsel

State Corporation Commission

CONSERVATION DIVISION

(Oil, Gas and Water)  
500 Insurance Bldg. 212 N. Market  
WICHITA, KANSAS 67202

VERBAL PERMIT FORM  
(To Be Filed By Plugging Agent)

RECEIVED  
STATE CORPORATION COMMISSION  
AUG 21 1968  
CONSERVATION DIVISION  
Wichita, Kansas

J. P. Roberts  
Administrator  
500 Insurance Building  
Wichita, Kansas 67202

Dear Sir:

Mr. Bank of Shenandoah Oil Corp. has this date requested permission to plug the following described well:

Mr. Bank guarantees payment of the plugging fee.

Operator's full Name: Harold Bank

Complete Address: 1018 Commerce Bldg Ft Worth, Tex

Lease Name: Merrill Ranch D Well No. -1-

Location: NW-SE Sec. 13 Twp. 34S Rge. 16 (E) (W) X

County: Comanche Total Depth 5150 Oil Well     

Gas Well      Input Well      SWD Well      D & A X Lost Hole     

Mr. Bank was instructed to plug the well as follows:

1027 ft 8 5/8 in surface pipe circulated with cement  
mud to 300 ft 1/2 sack bulls a plug and 25 sacks  
cement, mud to 40, 1/2 sack bulls a plug and  
10 sacks cement to surface  
Bridge set hole and 2 sacks cement

Very truly yours,

      
Conservation Division Agent

15-633-20031-0000  
 LAUGHLIN-SIMMONS & CO. OF KANSAS, INC.  
 OILWELL ELEVATIONS AND LOCATIONS  
 204 MULU STREET (316) AM 4-655  
 WICHITA, KANSAS 67211

5-29-68  
 DATE

Comanche 13 34s 16w C NW SE  
 COUNTY S T R LOCATION  
 OPERATOR NO. FARM

ELEVATION: 1633 ft @ 5th

Shenandoah Oil Corporation  
 406 Mutual Savings Building  
 Fort Worth, Texas 76102

SCALE: 2" = 1 Mile

loc. falls in very rough pasture, on a fence line & is marked with a sheet of a tall pole with pink-white flagging.  
 Best access is from east across river through Wells Ranch.

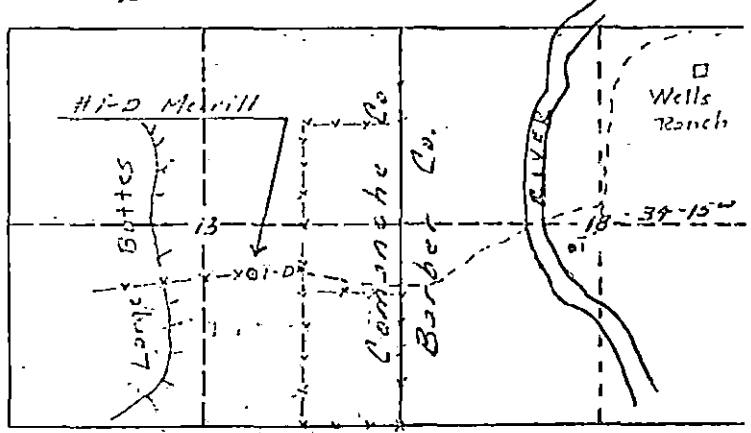

MINIMUM STAKING CHARGE: \$ 30.00  
 EXTRA TIME & MILEAGE: 15.00  
 ELEVATION CHARGE: 15.00  
 TOTAL: \$ 60.00

Thanks  
 R.R. Tammahill  
 L-S ENGINEER

15-633-20031-0000  
 LAUGHLIN-SIMMONS & CO. OF KANSAS, INC.  
 OILWELL ELEVATIONS AND LOCATIONS  
 204 S ZULU STREET (316) AM 4-655  
 WICHITA, KANSAS 67211

5-29-68  
 DATE

Comanche 13 34s 16w C NW SE  
 COUNTY S T R LOCATION  
 Shenandoah Oil Corp 1 Merrill Ranch "D"  
 OPERATOR NO. FARM

ELEVATION: 1633 ft  
 @ 574'

Shenandoah Oil Corporation  
 406 Mutual Savings Building  
 Fort Worth, Texas 76102

SCALE: 2" = 1 Mile

loc. falls in very rough pasture, in a fence line & is m'kd with a sheet & a tall stake with pink-white flagging.

Best access is from out across river through Wells Ranch.

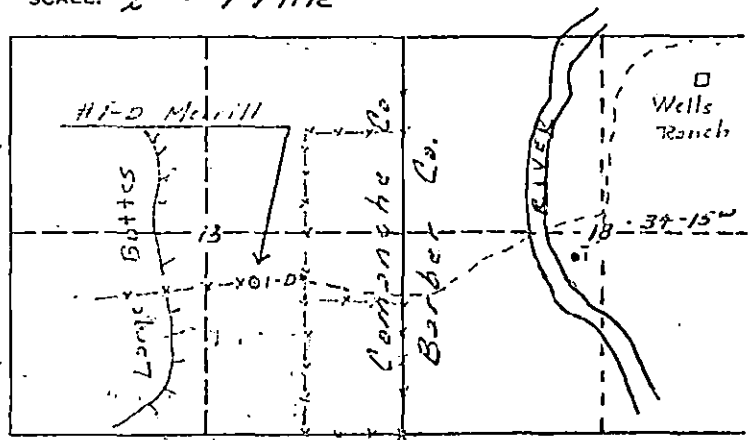

MINIMUM STAKING CHARGE: \$ 30.00  
 EXTRA TIME & MILEAGE: 15.00  
 ELEVATION CHARGE: 15.00  
 TOTAL: \$ 60.00

Thanks  
 R.R. Tamshill  
 L-S ENGINEER