

STATE OF KANSAS
STATE CORPORATION COMMISSION

WELL PLUGGING RECORD

Give All Information Completely
Make Required Affidavit
Mail or Deliver Report to
Conservation Division
State Corporation Comm.
245 North Water
Wichita, KS 67202

Comanche County. Sec. 18 Twp. 33 Rge. 17 E/W
Location as "NE/CNW $\frac{1}{2}$ SW $\frac{1}{2}$ " or footage from lines _____
C of NE NE
Lease Owner Raymond Oil Co., Inc.
Lease Name Lewis #1 Well No. _____
Office Address Wichita, Kansas 67202
Character of Well (Completed as Oil, Gas or Dry Hole) _____

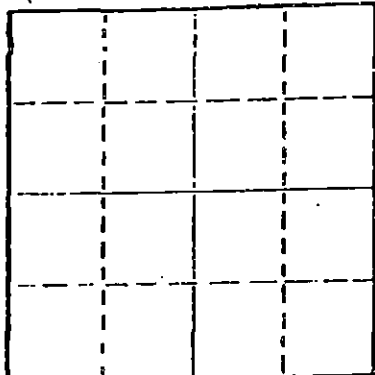

Locate well correctly on above
Section Plot

Date Well completed _____ 19____
Application for plugging filed _____ 19____
Application for plugging approved _____ 19____
Plugging commenced 6/1/77 _____ 19____
Plugging completed 6/6/77 _____ 19____
Reason for abandonment of well or producing formation
depleted. _____
If a producing well is abandoned, date of last production
_____ 19____

Was permission obtained from the Conservation Division or
its agents before plugging was commenced? yes

Name of Conservation Agent who supervised plugging of this well Metz
Producing formation _____ Depth to top _____ Bottom _____ Total Depth of Well 5740
Show depth and thickness of all water, oil and gas formations.

OIL, GAS OR WATER RECORDS

CASING RECORD

FORMATION	CONTENT	FROM	TO	SIZE	PUT IN	PULLED OUT
				13-3/8	93	none
				8-5/8	534	none
				4-1/2"	5310	4224'

Describe in detail the manner in which the well was plugged, indicating where the mud fluid
was placed and the method or methods used in introducing it into the hold. If cement or other
plugs were used, state the character of same and depth placed, from _____ feet to
_____ feet for each plug set.

Sanded to 4950' and ran 4 sacks cement thru dump bailer. Shot pipe at 4615', 4550',
4340', 4215', pulled 128 joints. Mudded hole to 315', set 25' rockbridge to 350' and filled
hole with 5 yards ready mix from 350' to base of cellar.

PLUGGING COMPLETE.

RECEIVED
STATE CORPORATION COMMISSION
6-15-77
JUN 15 1977
CONSERVATION DIVISION
WICHITA, KANSAS

(If additional description is necessary, use BACK of this sheet)

Name of Plugging Contractor KELSO CASING PULLING
CHASE, KANSAS

STATE OF KANSAS COUNTY OF RICE, ss.
R. DARRELL KELSO (employee of owner) or (owner or operator) of the above-described

well, being first duly sworn on oath, says: That I have knowledge of the facts, statements, and matters herein contained and the log of the
above-described well as filed and that the same are true and correct. So help me God.

(Signature) R. Darrell Kelso
CHASE, KANSAS
(Address)

Subscribed and Sworn to before me this 13th day of June 19 77

My commission expires _____

NOTARY PUBLIC
MARGARET MELCHER
Rice County, Ks
My Comm. Exp. Feb. 15, 1979

Margaret Melcher
Notary Public.

KANSAS DRILLERS LOG

API No. 15 033 County Comanche Number 20223-0000

Operator Raymond Oil Company, Inc.
 Address 200 West Douglas, Suite 800
 Well No. 1 Lease Name Lewis
 Footage Location _____ feet from (N) (S) line _____ feet from (E) (W) line
 Principal Contractor DaMac Drilling Inc. Geologist Peter J. Stubbs
 Spud Date 4-3-77 Total Depth 5740 P.B.T.D. _____
 Date Completed 4-22-77 Oil Purchaser _____

S. 18 T. 33S R. 17W ^E/_W
 Loc. C NE NE
 County Comanche

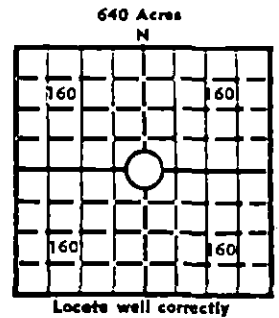

Elev.: Gr. _____
 DF _____ KB _____

CASING RECORD

Report of all strings set— surface, intermediate, production, etc.

Purpose of string	Size hole drilled	Size casing set (in O.D.)	Weight lbs/ft.	Setting depth	Type cement	Sacks	Type and percent additives
Conductor	20	13 3/8		93	Class H	175	3%CC
Surface	12 1/2	8 5/8		534	Com. & 2%Gel	125	3%CC
		1"		150	Com & 2%Gel	25	3%CC
				50	Com & 2%Gel	50	3%CC
					Com & 2%Gel	50	3%CC
					Com & 2%Gel	50	3%CC
Production	7 7/8	4 1/2		5310	50-50Poz	225	18% Salt. 1/2 FloSeal

LINER RECORD

PERFORATION RECORD

Top, ft.	Bottom, ft.	Sacks cement	Shots per ft.	Size & type	Depth interval

TUBING RECORD

Size	Setting depth	Packer set at

ACID, FRACTURE, SHOT, CEMENT SQUEEZE RECORD

Amount and kind of material used	Depth interval treated

MAY 13 1977
 5-13-77
 CONSERVATION DIVISION
 WICHITA, KANSAS

INITIAL PRODUCTION

Date of first production _____ Producing method (flowing, pumping, gas lift, etc.) _____

RATE OF PRODUCTION PER 24 HOURS	Oil	Gas	Water	Gas-oil ratio
	bbls.	MCF	bbls.	CFPB

Disposition of gas (vented, used on lease or sold) _____ Producing interval(s) _____

INSTRUCTIONS: As provided in KCC Rule 82-2-125, within 90 days after completion of a well, one completed copy of this Drillers Log shall be transmitted to the State Geological Survey of Kansas, 4150 Monroe Street, Wichita, Kansas 67209. Copies of this form are available from the Conservation Division, State Corporation Commission, 3830 So. Maridian (P.O. Box 17027), Wichita, Kansas 66217. Phone AC 316-522-2206. If confidential custody is desired, please note Rule 82-2-125. Drillers Logs will be on open file in the Oil and Gas Division, State Geological Survey of Kansas, Lawrence, Kansas 66044.

Copy - [unclear]
 cc: MKS
 cc: ONG

DESIGNATE TYPE OF COMP.: OIL, GAS, DRY HOLE, SWDW, ETC.:

Operator Raymond Oil Company, Inc.

Well No. 1 Lease Name Lewis

S 18 T 33SR 17W^E_W

WELL LOG

Show all important zones of porosity and contents thereof; cored intervals, and all drill-stem tests, including depth interval tested, cushion used, time tool open, flowing and shut-in pressures, and recoveries.

SHOW GEOLOGICAL MARKERS, LOGS RUN, OR OTHER DESCRIPTIVE INFORMATION.

FORMATION DESCRIPTION, CONTENTS, ETC.	TOP	BOTTOM	NAME	DEPTH
Sand & Clay	0	85		
RedBed	85	92		
RedBed & Shells	92	315		
RedBed	315	535		
Shale & Rock	535	1595		
RedBed & Shale	1595	2205		
Shale & Lime	2205	4440		
Lime	4440	5740RTD		

USE ADDITIONAL SHEETS, IF NECESSARY, TO COMPLETE WELL RECORD.

Date Received

Martha J. McKown

 Signature
 Vice President

 Title
 April 26, 1977

 Date