

STATE OF KANSAS  
STATE CORPORATION COMMISSION  
200 Colorado Derby Building  
Wichita, Kansas 67202

WELL PLUGGING RECORD  
K.A.R.-82-3-117

API NUMBER 15-007-20,748-0000

LEASE NAME Tregellas #4

WELL NUMBER \_\_\_\_\_

SPOT LOCATION 855' S of NL, 125' W  
of E1 NE/4

SEC. 3 TWP. 30 SRGE. 13 W (E) or (W)

COUNTY Barber

Date Well Completed \_\_\_\_\_

Plugging Commenced 6/26/85

Plugging Completed 7/12/85

TYPE OR PRINT

NOTICE: Fill out completely  
and return to Cons. Div.  
office within 30 days.

LEASE OPERATOR Aladdin Petroleum Corp.

ADDRESS 809 Petroleum Bldg. Wichita, Ks. 67202

PHONE # (316) 265-9602 OPERATORS LICENSE NO. 5035

Character of Well \_\_\_\_\_  
(Oil, Gas, D&A, SWD, Input, Water Supply Well)

Did you notify the KCC/KDHE Joint District Office prior to plugging this well? Yes

Which KCC/KDHE Joint Office did you notify? Dodge City

Is ACO-1 filed? \_\_\_\_\_ If not, is well log attached? \_\_\_\_\_

Producing formation \_\_\_\_\_ Depth to top \_\_\_\_\_ bottom \_\_\_\_\_ T.D. 4885'

Show depth and thickness of all water, oil and gas formations.

OIL, GAS OR WATER RECORDS

CASING RECORD

Formation	Content	From	To	Size	Put In	Pulled out
				13 3/8	243'	none
				8 5/8	955'	200
				5 1/2"	4638'	3086'

Describe in detail the manner in which the well was plugged, indicating where the mud fluid was placed and the method or methods used in introducing it into the hole. If cement or other plugs were used state, the character of same and depth placed, from \_\_\_\_\_ feet to \_\_\_\_\_ feet each set.

Sanded bottom to 4320' & 5 sacks cement. Shot pipe at 3811', 3316', & 3086'.

Pulled 75 joints of pipe. Plugged well with 3 hulls, 15 gel, 50 cement, 10 gel, 1 hull, plug, & 150 sacks 60/40 poz 6% gel.

Plugging complete.

(If additional description is necessary, use BACK of this form.)

Name of Plugging Contractor Kelso Casing Pulling License No. 6050

Address Box 347, Chase, Ks. 67524

STATE OF Kansas COUNTY OF Rice, ss.

R. Darrell Kelso (employee of operator) or (operator) of above-described well, being first duly sworn on oath, says: That I have knowledge of the facts, statements, and matters herein contained and the log of the above-described well as filed that the same are true and correct, so helped God.

STATE CORPORATION COMMISSION

(Signature) R. Darrell Kelso

(Address) Box 347, Chase, Ks. 67524

FILED 17  
7-17-85  
CONSERVATION DIVISION  
Wichita, Kansas

SUBSCRIBED AND SWORN TO before me this 15th day of July, 1985

My Commission expires: \_\_\_\_\_



Irene Hoover  
Notary Public

**KANSAS DRILLERS LOG**

S. 3 T. 30 R. 13<sup>XX</sup><sub>E</sub>  
 W  
 Loc. 855' SNL & 125' WEL  
 County Barber

API No. 15 — 007 — 20,748-0000  
 County Number

Operator  
Aladdin Petroleum Corporation

Address  
809 Petroleum Bldg., Wichita, KS

Well No. #4 Lease Name Tregellas

Footage Location  
855 feet from (N)  line 125 feet from (E)  line of NE/4

Principal Contractor DaMac Drilling, Inc. Geologist Harlan Dixon

Spud Date 5/29/79 Total Depth 4885 P.B.T.D.

Date Completed Oil Purchaser

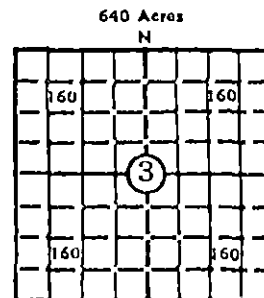

Locate well correctly  
 Elev.: Gr. 1798  
 DW 1804 KB 1806

**CASING RECORD**

Report of all strings set— surface, intermediate, production, etc.

Purpose of string	Size hole drilled	Size casing set (in O.D.)	Weight lbs/ft.	Setting depth	Type cement	Sacks	Type and percent additives
Surface		13-3/8"	36	243	Regular	275	3% CaCl
Intermediate		8-5/8"	24	955	Posmix	200	3% CaCl
Production		5-1/2"	14	4638	Posmix	175	3% CaCl

**LINER RECORD**

**PERFORATION RECORD**

Top, ft.	Bottom, ft.	Sacks cement	Shots per ft.	Size & type	Depth interval
			2	SDJ	4502-10

**TUBING RECORD**

Size	Setting depth	Packer set at
		4626'

**ACID, FRACTURE, SHOT, CEMENT SQUEEZE RECORD**

Amount and kind of material used	Depth interval treated
STATE GEOLOGICAL SURVEY MAY 29 1985 5-29-85 CONSERVATION DIVISION Wichita, Kansas	

**INITIAL PRODUCTION**

Date of first production <u>6/25/79</u>	Producing method (flowing, pumping, gas lift, etc.) <u>Pumping</u>
RATE OF PRODUCTION PER 24 HOURS	Oil <u>80</u> bbls. Gas <u>Show</u> MCF Water <u>None</u> bbls. Gas-oil ratio <u>CFPB</u>
Disposition of gas (vented, used on lease or sold) <u>Used on lease</u>	Producing interval (s) <u>4502-10</u>

INSTRUCTIONS: As provided in KCC Rule 82-2-125, within 90 days after completion of a well, one completed copy of this Drillers Log shall be transmitted to the State Geological Survey of Kansas, 4150 Monroe Street, Wichita, Kansas 67209. Copies of this form are available from the Conservation Division, State Corporation Commission, 3830 So. Meridian (P.O. Box 17027), Wichita, Kansas 66217. Phone AC 316-522-2206. If confidential custody is desired, please note Rule 82-2-125. Drillers Logs will be on an open file in the Oil and Gas Division, State Geological Survey of Kansas, Lawrence, Kansas 66044.