

CORRECTED

CORRECTED

For KCC Use:
Effective Date: 4-29-2001
District #: 1
SGA? [X] Yes [] No

KANSAS CORPORATION COMMISSION
OIL & GAS CONSERVATION DIVISION

Form C-1
September 1999
Form must be Typed
Form must be Signed
All blanks must be Filled

NOTICE OF INTENT TO DRILL

Must be approved by KCC five (5) days prior to commencing well

Expected Spud Date: May 23, 2001
month day year

Spot: 200' S., E2, NE Sec. 21 Twp. 34 S. R. 20
[] East [X] West

OPERATOR: License# 5663
Name: Hess Oil Company
Address: P.O. Box 1009
City/State/Zip: McPherson, KS 67460
Contact Person: Bryan Hess/James C. Hess
Phone: 620-241-4640

* 1520 feet from S (N) (circle one) Line of Section
660 feet from (E) / W (circle one) Line of Section
Is SECTION [X] Regular [] Irregular?

(Note: Locate well on the Section Plat on reverse side)

County: Comanche
Lease Name: Woolfolk Well #: 1
Field Name:

Is this a Prorated / Spaced Field? [] Yes [X] No

Target Formation(s): Mississippi, Arbuckle

Nearest Lease or unit boundary: 660

Ground Surface Elevation: 1743 feet MSL

Water well within one-quarter mile: [] Yes [X] No

Public water supply well within one mile: [] Yes [X] No

Depth to bottom of fresh water: 100

Depth to bottom of usable water: 180

Surface Pipe by Alternate: X 1 / 2

Length of Surface Pipe Planned to be set: 650

Length of Conductor Pipe required: NA

Projected Total Depth: 6400

Formation at Total Depth: Arbuckle

Water Source for Drilling Operations:

Well [] Farm Pond [X] Other []

DWR Permit #: (Note: Apply for Permit with DWR [])

Will Cores be taken? [] Yes [X] No

If Yes, proposed zone:

Well Drilled For: [X] Oil [] Gas [] OWWO [] Seismic; # of Holes [] Other
Well Class: [] Enh Rec [] Storage [] Disposal [] Other
Type Equipment: [X] Mud Rotary [] Air Rotary [] Cable

If OWWO: old well information as follows:
Operator:
Well Name:
Original Completion Date: Original Total Depth:

Directional, Deviated or Horizontal wellbore? [] Yes [X] No

If Yes, true vertical depth:

Bottom Hole Location:

KCC DKT #:

AFFIDAVIT

* SPOT WAS: C E/2 NE
SPOT IS: 200's of E/2 NE
FOOTAGE WAS: 1320' FNL MAY 24 2001
FOOTAGE IS: 1520' FNL 5-24-01
KANSAS CORPORATION COMMISSION CONSERVATION DIVISION

The undersigned hereby affirms that the drilling, completion and eventual plugging of this well will comply with K.S.A. 55-101, et. seq.
It is agreed that the following minimum requirements will be met:
1. Notify the appropriate district office prior to spudding of well;
2. A copy of the approved notice of intent to drill shall be posted on each drilling rig;
3. The minimum amount of surface pipe as specified below shall be set by circulating cement to the top; in all cases surface pipe shall be set through all unconsolidated materials plus a minimum of 20 feet into the underlying formation.
4. If the well is dry hole, an agreement between the operator and the district office on plug length and placement is necessary prior to plugging;
5. The appropriate district office will be notified before well is either plugged or production casing is cemented in;
6. If an ALTERNATE II COMPLETION, production pipe shall be cemented from below any usable water to surface within 120 days of spud date. In all cases, NOTIFY district office prior to any cementing.

I hereby certify that the statements made herein are true and to the best of my knowledge and belief.

Date: May 23, 2001 Signature of Operator or Agent: [Signature] Title: Bryan Hess, Mgr.

For KCC Use ONLY
API # 15 - 033-21220-0000
Conductor pipe required NONE feet
Minimum surface pipe required 200 feet per Alt. (1) X
Approved by: [Signature] / ORIG 4-24-2001
This authorization expires: 10-24-2001
Spud date: Agent:

- Remember to:
- File Drill Pit Application (form CDP-1) with Intent to Drill;
- File Completion Form ACO-1 within 120 days of spud date;
- File acreage attribution plat according to field proration orders;
- Notify appropriate district office 48 hours prior to workover or re-entry;
- Submit plugging report (CP-4) after plugging is completed;
- Obtain written approval before disposing or injecting salt water.

21
34
2001

12774500

IN ALL CASES PLOT THE INTENDED WELL ON THE PLAT BELOW

Plat of acreage attributable to a well in a prorated or spaced field

If the intended well is in a prorated or spaced field, please fully complete this side of the form. If the intended well is in a prorated or spaced field complete the plat below showing that the well will be properly located in relationship to other wells producing from the common source of supply. Please show all the wells and within 1 mile of the boundaries of the proposed acreage attribution unit for gas wells and within 1/2 mile of the boundaries of the proposed acreage attribution unit for oil wells.

API No. 15 - _____
Operator: Hess Oil Company
Lease: Woolfolk
Well Number: 1
Field: _____

Number of Acres attributable to well: 160
QTR / QTR / QTR of acreage: 200' S₂ - E2 - NE

Location of Well: County: Comanche
1520 feet from S (N) (circle one) Line of Section
660 feet from (E) W (circle one) Line of Section
Sec. 21 Twp. 34 S. R. 20 East West

Is Section Regular or Irregular

If Section is Irregular, locate well from nearest corner boundary.
Section corner used: NE NW SE SW

PLAT

(Show location of the well and shade attributable acreage for prorated or spaced wells.)

(Show footage to the nearest lease or unit boundary line.)

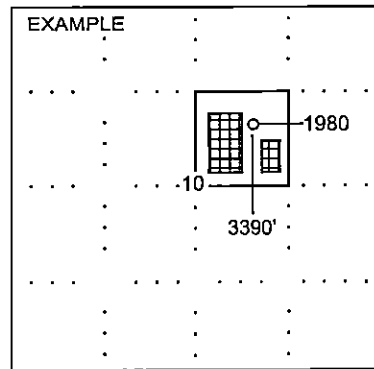
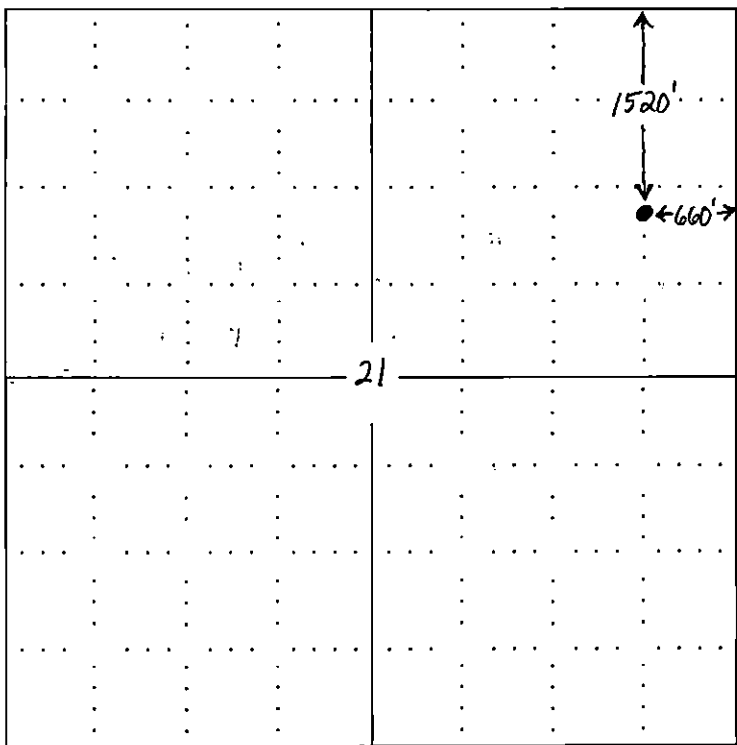

NOTE: In all cases locate the spot of the proposed drilling locaton.

In plotting the proposed location of the well, you must show:

1. The manner in which you are using the depicted plat by identifying section lines, i.e. 1 section, 1 section with 8 surrounding sections, 4 sections, etc.
2. The distance of the proposed drilling location from the section's south / north and east / west.
3. The distance to the nearest lease or unit boundary line.
4. If proposed location is located within a prorated or spaced field a certificate of acreage attribution plat must be attached: (CO-7 for oil wells; CG-8 for gas wells).