

FOR KCC USE:

EFFECTIVE DATE: 6-20-98

DISTRICT # 1
SEAT: Yes

State of Kansas

NOTICE OF INTENTION TO DRILL

Must be approved by the K.C.C. five (5) days prior to commencing well

DWVO

FORM MUST BE TYPED

FORM MUST BE SIGNED

ALL BLANKS MUST BE FILLED

Expected Spud Date: June 22 1998
month day year

150 W NE NE Sec 2 34 20 East
Spot
Sec Typ S, Rg. X West

OPERATOR: License # 31691
Name: Coral Coast Petroleum, L.C.
Address: 200 E 1st #001
City/State/Zip: Wichita, Kansas 67202
Contact Person: Dan Reynolds
Phone: 316-269-1233

660' feet from South North line of Section
810' feet from East West line of Section
IS SECTION X REGULAR INREGULAR?

(NOTE: Locate well on the Section Plat on Reverse Side)

County: Comanche
Lease Name: Ora Baker Well #: 4
Field Name: Collier Flats SOUTH
Is this a Prorated/Spaced Field? yes X no
Target Formation(s): Arbuckle
Nearest lease or unit boundary: 660
Ground Surface Elevation: 1806 feet MSL
Water well within one-quarter mile: yes X no
Public water supply well within one mile: yes X no
Depth to bottom of fresh water: 100
Depth to bottom of usable water: 180
Surface Pipe by Alternate: X 1 2
Length of Surface Pipe Planned to be set: was 642
Length of Conductor pipe required: none
Projected Total Depth: 6400
Formation at Total Depth: Arbuckle
Water Source for Drilling Operations:
... well ... farm pond X other
DWR Permit #:
Will Cores Be Taken? yes X no
If yes, proposed zone:
Directional, Deviated or Horizontal wellbore? yes X no
If yes, true vertical depth:
Bottom Hole Location:
AFFIDAVIT

CONTRACTOR: License #: 5929
Name: Duke Drilling, Inc.

Well Drilled For: Well Class: Type Equipment:
X Oil ... Enh Rec X Infield X Mud Rotary
X Gas ... Storage X Pool Ext. Air Rotary
X DWVO ... Disposal ... Wildcat ... Cable
X Seismic; ... # of Holes ... Other
Other

If DWVO: old well information as follows:
Operator: RJ Patrick
Well Name: #4 Ora Baker
Comp. Date: 3-9-82 Old Total Depth 4830

Directional, Deviated or Horizontal wellbore? yes X no
If yes, true vertical depth:
Bottom Hole Location:

The undersigned hereby affirms that the drilling, completion and eventual plugging of this well will comply with K.S.A. 55-101, et. seq.
It is agreed that the following minimum requirements will be met:

- 1. Notify the appropriate district office prior to spudding of well;
- 2. A copy of the approved notice of intent to drill shall be posted on each drilling rig;
- 3. The minimum amount of surface pipe as specified below shall be set by circulating cement to the top; in all cases surface pipe shall be set through all unconsolidated materials plus a minimum of 20 feet into the underlying formation;
- 4. If the well is dry hole, an agreement between the operator and the district office on plug length and placement is necessary prior to plugging;
- 5. The appropriate district office will be notified before well is either plugged or production casing is cemented in;
- 6. IF AN ALTERNATE IS COMPLETION, PRODUCTION PIPE SHALL BE CEMENTED FROM BELOW ANY USABLE WATER TO SURFACE WITHIN 120 DAYS OF SPUD DATE. IN ALL CASES, NOTIFY DISTRICT OFFICE PRIOR TO ANY CEMENTING.

I hereby certify that the statements made herein are true and to the best of my knowledge and belief.
Date: 6-8-98 Signature of Operator or Agent: Dan Reynolds Title: Managing Member

RECEIVED
KANSAS CORP. CO.
6-9-98
1998 JUN -9 12:35

FOR KCC USE:
API # 15- 033-205500001
Conductor pipe required NONE feet
Minimum surface pipe required 642 feet per Alt. 1 X
Approved by: JK 6-15-98
This authorization expires: 12-15-98
(This authorization void if drilling not started within 6 months of effective date.)
Spud date: Agent:

REMEMBER TO:

- File Drill Pit Application (form CPP-1) with Intent to Drill;
 - File Completion Form ACO-1 within 120 days of spud date;
 - File acreage attribution plat according to field proration orders;
 - Notify appropriate district office 48 hours prior to workover or re-entry;
 - Submit plugging report (CP-4) after plugging is completed;
 - Obtain written approval before disposing or injecting salt water.
- Mail to: Conservation Division, 200 Colorado Derby Building, 202 W. First St., Wichita, Kansas 67202-1286.

2
34
20W

**IN ALL CASES INTENDED WELL ON THE PLAT BELOW
PLAT OF ACREAGE TO A WELL IN A PRORATED OR SPACED FIELD**

If the intended well is in a prorated or spaced field, please fully complete this side of the form. If the intended well is in a prorated or spaced field complete the plat below showing that the well will be located in relationship to other wells producing from the common source of supply. Show all the wells within 1 mile of the boundaries of the proposed acreage attributable for gas wells and within 1/2 mile of the boundaries of the proposed acreage attributable for oil wells.

API NO. 15- _____
 OPERATOR _____ LOCATION OF WELL: COUNTY _____
 LEASE _____ feet from south/north line of section _____
 WELL NUMBER _____ feet from east/west line of section _____
 FIELD _____ SECTION _____ TWP _____ RG _____

NUMBER OF ACRES ATTRIBUTABLE _____ IS SECTION _____ REGULAR or _____ IRREGULAR
 QTR/QTR/QTR OF ACREAGE _____ IF SECTION IS IRREGULAR, LOCATE WELL FROM NEAREST
CORNER BOUNDARY.

Section corner used: _____ NE _____ NW _____ SE _____ SW
PLAT

(Show location of the well attributable acreage for prorated or spaced wells.)
 (Show the nearest lease or unit boundary line.)

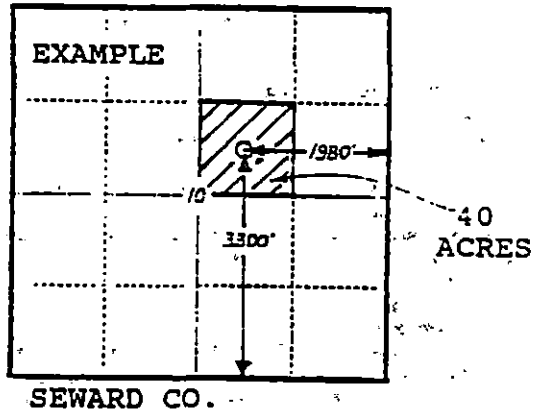
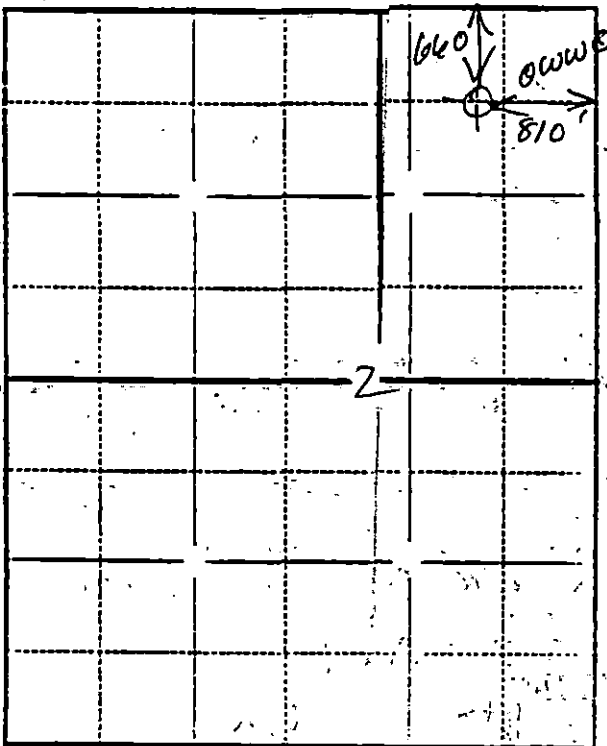

In plotting the proposed location of the well, you must show:

- 1) The manner in which the depicted plat by identifying section lines, i.e. 1 section, 1 section surrounding sections, 4 sections, etc.;
- 2) the distance of the drilling location from the section's south/north and east/west lines; and
- 3) the distance to the lease or unit boundary line.