

FOR KCC USE:

FORM C-1 7/91

EFFECTIVE DATE: 7-6-94

FORM MUST BE TYPE

DISTRICT 1

State of Kansas  
NOTICE OF INTENTION TO DRILL

FORM MUST BE SIGNED

SGA? Yes No

Must be approved by the K.C.C. five (5) days prior to commencing well

ALL BLANKS MUST BE FILLED

Expected Spud Date July 6, 1994  
month day year

Spot 5/2 NW - SW - SW Sec 10 Twp 34 S. Rg 20W East

OPERATOR: License # 31232  
Name: Cody Energy, Inc.  
Address: 7555 E. Hampden Ave., Suite 600  
City/State/Zip: Denver, Colorado 80231  
Contact Person: Rock Petty  
Phone: (915) 686 0181

.....770..... feet from South North line of Section  
.....330..... feet from East/West line of Section  
IS SECTION X REGULAR IRREGULAR

(NOTE: Locate well on the Section Plat on Reverse Side)  
County: Comanche  
Lease Name: Bobwhite Well #: 10-4  
Field Name: Wildcat  
Is this a Prorated/Spaced Field? yes X no  
Target Formation(s): Viola and Arbuckle  
Nearest lease or unit boundary: .330  
Ground Surface Elevation: 1759 feet MSL  
Water well within one-quarter mile: X yes no  
Public water supply well within one mile: X yes no  
Depth to bottom of fresh water: 100  
Depth to bottom of usable water: 180  
Surface Pipe by Alternate: X 1 2  
Length of Surface Pipe Planned to be set: 600  
Length of Conductor pipe required: None  
Projected Total Depth: 6700  
Formation at Total Depth: Arbuckle  
Water Source for Drilling Operations: X  
... well ... farm pond ... other:  
DWR Permit #: NA  
Will Cores Be Taken?: yes X no  
If yes, proposed zone:

CONTRACTOR: License #: 5840  
Name: Brandt Drilling Co.

Well Drilled For: Well Class: Type Equipment:  
X Oil ... Enh Rec ... Infield XX Mud Rotary  
... Gas ... Storage ... Pool Ext. ... Air Rotary  
... OWWO ... Disposal ... Wildcat ... Cable  
... Seismic; ... # of Holes ... Other  
... Other  
If OWWO: old well information as follows:  
Operator:  
Well Name:  
Comp. Date: Old Total Depth

Directional, Deviated or Horizontal wellbore? yes X no  
If yes, true vertical depth:  
Bottom Hole Location:

AFFIRMATION

The undersigned hereby affirms that the drilling, completion and eventual plugging of this well will comply with the provisions of K.S.A. 58-101, et. seq.

It is agreed that the following minimum requirements will be met:

- 1. Notify the appropriate district office prior to spudding of well;
- 2. A copy of the approved notice of intent to drill shall be posted on each drilling rig;
- 3. The minimum amount of surface pipe as specified below shall be set by circulating cement to the top of the casing surface pipe shall be set through all unconsolidated materials plus a minimum of 20 feet into the underlying formation;
- 4. If the well is dry hole, an agreement between the operator and the district office on plug length and placement is necessary prior to plugging;
- 5. The appropriate district office will be notified before well is either plugged or production casing is cemented in;
- 6. IF AN ALTERNATE IS COMPLETED, PRODUCTION PIPE SHALL BE CEMENTED FROM BELOW ANY USABLE WATER TO SURFACE WITHIN 120 DAYS OF SPUD DATE. IN ALL CASES, NOTIFY DISTRICT OFFICE PRIOR TO ANY CEMENTING.

I hereby certify that the statements made herein are true and to the best of my knowledge and belief.

Date: 6/17/94 Signature of Operator or Agent: Nicki Addeep Title: Operations Tech.

FOR KCC USE:  
API # 15- 033-20891-00-00  
Conductor pipe required NONE feet  
Minimum surface pipe required 200 feet per Alt. (1) X  
Approved by: OPW 7-1-94  
This authorization expires: 1-1-95  
(This authorization void if drilling not started within 6 months of effective date.)  
Spud date: Agent:

REMEMBER TO:

- File Drill Pit Application (form CDP-1) with Intent to Drill;
- File Completion Form ACO-1 within 120 days of spud date;
- File acreage attribution plat according to field prorotation orders;
- Notify appropriate district office 48 hours prior to workover or re-entry;
- Submit plugging report (CP-4) after plugging is completed;
- Obtain written approval before disposing or injecting salt water.

Mail to: Conservation Division, 208 Colorado Bldg

King, 208 W. Flwa.

Wichita

Kansas 67202

RECEIVED  
OPERATION COMM  
STATE OF K.S.A. 58  
JUN 22 1994  
6-22-94  
CONSERVATION DIVISION  
Wichita, Kansas

10  
34  
20W

IN ALL CASES PLOT THE INTENDED WELL ON THE PLAT BELOW

PLAT OF ACREAGE ATTRIBUTABLE TO A WELL IN A PRORATED OR SPACED FIELD

If the intended well is in a prorated or spaced field, please fully complete this side of the form. If the intended well is in a prorated or spaced field complete the plat showing that the well will be properly located in relationship to other wells producing the common source of supply. Please show all the wells within 1 mile of the boundaries of the proposed acreage attribution unit for gas wells and within 1/2 mile of the boundaries of the proposed acreage attribution unit for oil wells.

API NO. 15- \_\_\_\_\_  
 OPERATOR Cody Energy, Inc.  
 LEASE Bobwhite  
 WELL NUMBER 10-1  
 FIELD Wildcat

LOCATION OF WELL: COUNTY Comanche  
770 feet from south/north line of sec  
330 feet from east/west line of sec  
 SECTION 10 TWP 34S RG 20W

NUMBER OF ACRES ATTRIBUTABLE TO WELL 10  
 QTR/QTR/QTR OF ACREAGE NW - SW - SW

IS SECTION X REGULAR or IRREGULAR  
 IF SECTION IS IRREGULAR, LOCATE WELL FROM NEAREST CORNER BOUNDARY.

Section corner used: NE NW SE

PLAT

(Show location of the well and shade attributable acreage for prorated or spaced wells (Show footage to the nearest lease or unit boundary line.)

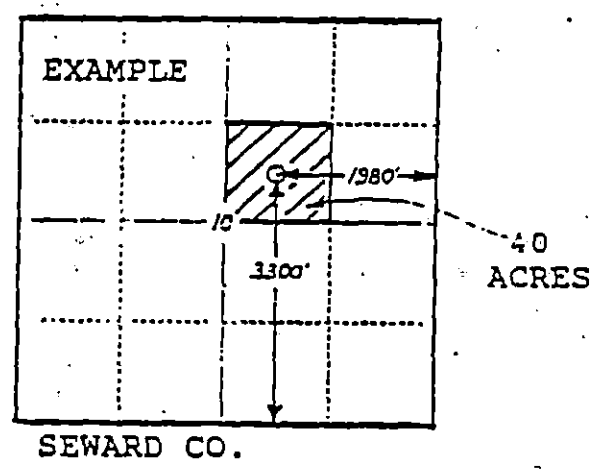
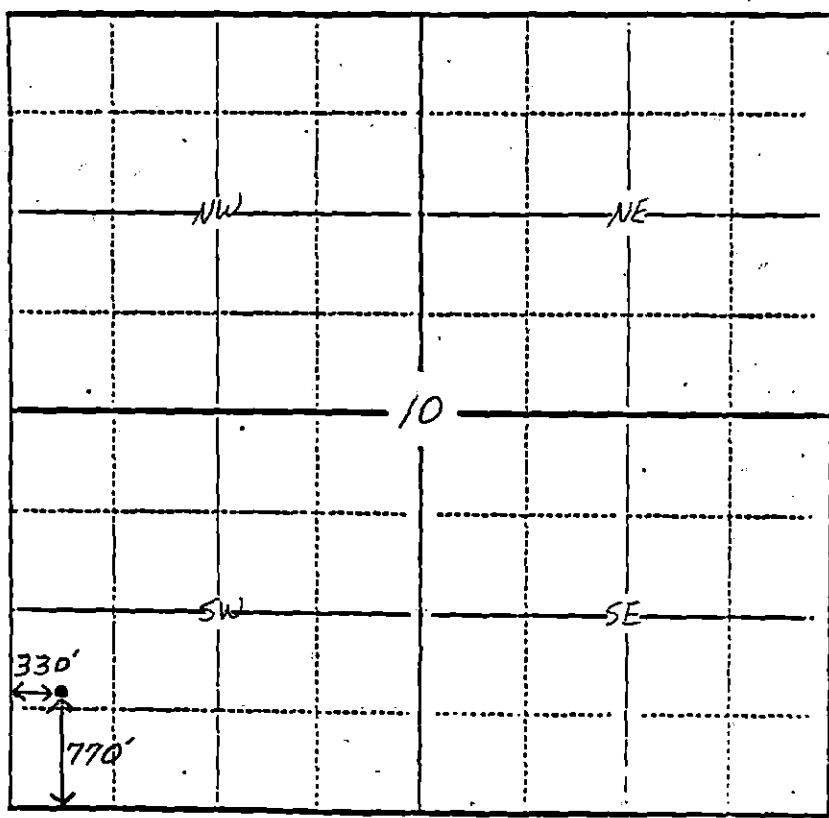

In plotting the proposed location of the well, you must show:

- 1) The manner in which you are using the depicted plat by identifying section lines, i.e. 1 section, 1 section with 8 surrounding sections, 4 sections, etc.;
- 2) the distance of the proposed drilling location from the section's south/north and east/west lines; and
- 3) the distance to the nearest lease or unit boundary line.