

EFFECTIVE DATE: 12-14-91

State of Kansas

DISTRICT # 1

NOTICE OF INTENTION TO DRILL

SEAL: Yes No

Must be approved by the K.C.C. five (5) days prior to commencing well

Expected Spud Date: 12 month 14 day 91 year

Spot: NW SW Sec 5 Twp 34 S, Rg 20 East West

OPERATOR: License # 3882
Name: Samuel Gary Jr. & Associates, Inc.
Address: 1775 Sherman St., Suite 1925
City/State/Zip: Denver, CO 80203
Contact Person: Dan Hall
Phone: (303) 831-4673 (303) 297-9046

2000 feet from South / ~~WESTERN~~ line of Section
660 feet from ~~WESTERN~~ / West line of Section
IS SECTION REGULAR IRREGULAR?

(NOTE: Locate well on the Section Plat on Reverse Side)

County: Comanche
Lease Name: Butts Well #: 5-12
Field Name: Wildcat
Is this a Prorated/Spaced Field? yes no

CONTRACTOR: License #:
Name: To be determined

Target Formation(s): Viola
Nearest lease or unit boundary: 660'

Well Drilled For: Well Class: Type Equipment:
 Oil ... Enh Rec ... Infield Mud Rotary
... Gas ... Storage ... Pool Ext. ... Air Rotary
... OWWO ... Disposal Wildcat ... Cable
... Seismic; ... # of Holes ... Other
... Other

Ground Surface Elevation: 1772 est. feet MSL
Water well within one-quarter mile: yes no

Public water supply well within one mile: yes no
Depth to bottom of fresh water: 100 ft.

Depth to bottom of usable water: 220 ft. 180

Surface Pipe by Alternate: 1 2
Length of Surface Pipe Planned to be set: 650 ft.

Length of Conductor pipe required: 60 ft.
Projected Total Depth: 6700 ft.

Formation at Total Depth: Arbuckle
Water Source for Drilling Operations:

... well ... farm pond other

DWR Permit #:
Will Cores Be Taken?: yes no

If yes, proposed zone:

If OWWO: old well information as follows:

Operator:
Well Name:
Comp. Date: Old Total Depth

Directional, Deviated or Horizontal wellbore? yes no
If yes, true vertical depth:

Bottom Hole Location:

AFFIDAVIT

The undersigned hereby affirms that the drilling, completion and eventual plugging of this well will comply with K.S.A. 55-101, et. seq.

It is agreed that the following minimum requirements will be met:

1. Notify the appropriate district office prior to spudding of well;
2. A copy of the approved notice of intent to drill shall be posted on each drilling rig;
3. The minimum amount of surface pipe as specified below shall be set by circulating cement to the top; in all cases surface pipe shall be set through all unconsolidated materials plus a minimum of 20 feet into the underlying formation;
4. If the well is dry hole, an agreement between the operator and the district office on plug length and placement is necessary prior to plugging;
5. The appropriate district office will be notified before well is either plugged or production casing is cemented in;
6. IF AN ALTERNATE II COMPLETION, PRODUCTION PIPE SHALL BE CEMENTED FROM BELOW ANY USABLE WATER TO SURFACE WITHIN 120 DAYS OF SPUD DATE. IN ALL CASES, NOTIFY DISTRICT OFFICE PRIOR TO ANY CEMENTING.

I hereby certify that the statements made herein are true and to the best of my knowledge and belief.

Date: 12-3-91 Signature: Samuel Gary Jr. Title: President

FOR KCC USE:
 API # 15- 033-20,840-0000
 Conductor pipe required NONE feet
 Minimum surface pipe required 300 feet per Alt (1)
 Approved by: [Signature] 12-4-91
 This authorization expires: 6-9-92
 (This authorization void if drilling not started within 6 months of effective date.)
 Spud date: Agent:

RECEIVED
STATE CORPORATION COMMISSION

DEC 05 1991

12-5-91
CONSERVATION DIVISION
Wichita, Kansas

REMEMBER TO:

- File Drill Pit Application (form CDP-1) with Intent to Drill;
- File Completion Form ACO-1 within 120 days of spud date;
- File acreage attribution plat according to field proration orders;
- Notify appropriate district office 48 hours prior to workover or re-entry;
- Submit plugging report (CP-4) after plugging is completed;
- Obtain written approval before disposing or injecting salt water.

Mail to: Conservation Division, 208 Colorado Derby Building, 202 W. First St., Wichita, Kansas 67202-1286.

5
37
2090

IN ALL CASES PLOT THE INTENDED WELL ON THE PLAT BELOW

PLAT OF ACREAGE ATTRIBUTABLE TO A WELL IN A PRORATED OR SPACED FIELD

If the intended well is in a prorated or spaced field, please fully complete this side of the form. If the intended well is in a prorated or spaced field complete the plat below showing that the well will be properly located in relationship to other wells producing from the common source of supply. Please show all the wells within 1 mile of the boundaries of the proposed acreage attribution unit for gas wells and within 1/2 mile of the boundaries of the proposed acreage attribution unit for oil wells.

API NO. 15- _____
OPERATOR Samuel Gary Jr. & Associates, Inc.
LEASE Butts
WELL NUMBER 5-12
FIELD Wildcat

LOCATION OF WELL: COUNTY Comanche
1900 feet from south/north line of section
660 feet from east/west line of section
SECTION 5 TWP 34S RG 20W

NUMBER OF ACRES ATTRIBUTABLE TO WELL _____
QTR/QTR/QTR OF ACREAGE _____ - NW - SW

IS SECTION X REGULAR or _____ IRREGULAR
IF SECTION IS IRREGULAR, LOCATE WELL FROM NEAREST CORNER BOUNDARY.

Section corner used: _____ NE _____ NW _____ SE _____ SW

PLAT

(Show location of the well and shade attributable acreage for prorated or spaced wells.)
(Show footage to the nearest lease or unit boundary line.)

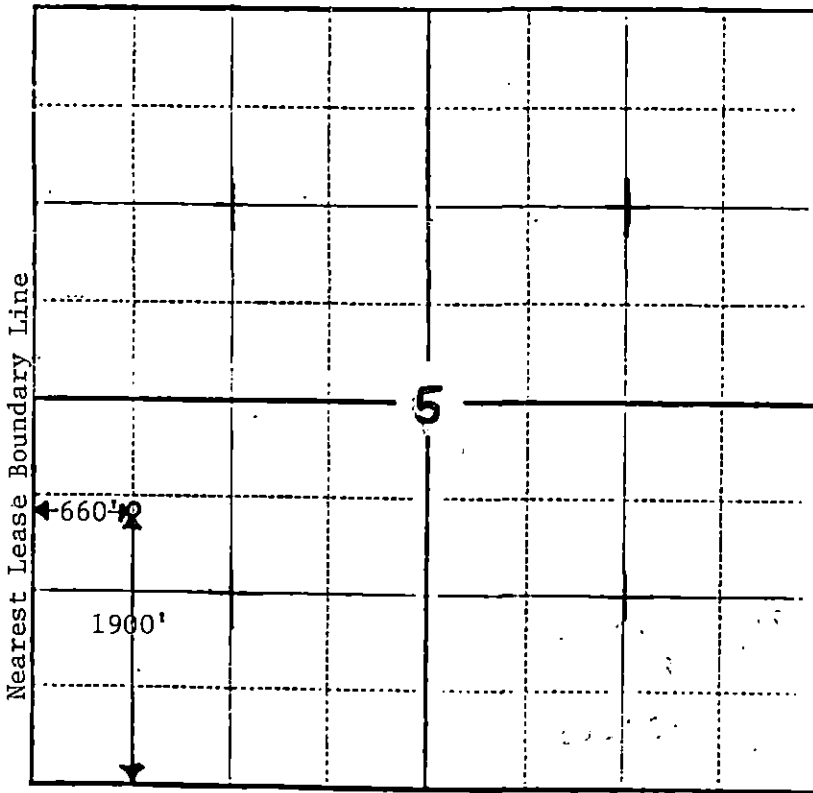

Comanche Co.

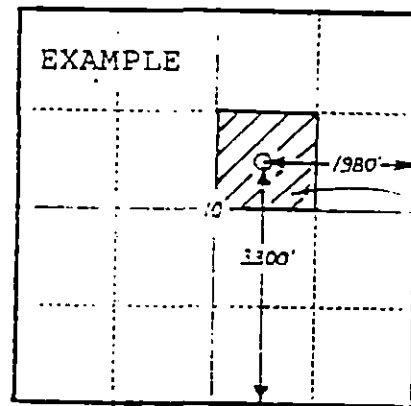

SEWARD CO.

40
ACRES

In plotting the proposed location of the well, you must show:

- 1) The manner in which you are using the depicted plat by identifying section lines, i.e. 1 section, 1 section with 8 surrounding sections, 4 sections, etc.;
- 2) the distance of the proposed drilling location from the section's south/north and east/west lines; and
- 3) the distance to the nearest lease or unit boundary line.