

P. 4

FOR KCC USE:

FORM C-1 7/91

FORM MUST BE TYPED

FORM MUST BE SIGNED

ALL BLANKS MUST BE FILLED

EFFECTIVE DATE: 10-18-92

State of Kansas

NOTICE OF INTENTION TO DRILL

DISTRICT # 1
SGA7 Yes No

Must be approved by the K.C.C. five (5) days prior to commencing well

Expected Spud Date 10 month 12 day 92 year

Spot SE SE NW Sec 5 Twp 34S S. Rg 20W East West

OPERATOR: License # 3882
Name: Samuel Gary, Jr. & Associates
Address: 1775 Sherman Street, Suite 1925
City/State/Zip: Denver, Colorado 80203
Contact Person: Steve Fredrickson
Phone: (303) 623-0070

2310' feet from South / North line of Section
2310' feet from East / West line of Section
IS SECTION REGULAR IRREGULAR?

CONTRACTOR: License #: 5840
Name: Brandt Drilling Co., Inc.

(NOTE: Locate well on the Section Plat on Reverse Side)
County: Comanche
Lesse Name: Bluff Creek Well #: 5-6
Field Name:

Well Drilled For: Well Class: Type Equipment:
Oil Enh Roc Infield X Mud Rotary
X Gas Storage Pool Ext Air Rotary
OHW Disposal X Wildcat Cable
Seismic: # of Holes Other

Is this a Prorated/Spaced Field? yes X no
Target Formation(s): Morrow
Nearest lease or unit boundary: 2310'
Ground Surface Elevation: 1770' (est.) foot MSL
Water well within one-quarter mile: yes X no
Public water supply well within one mile: yes X no
Depth to bottom of fresh water: 100 180
Depth to bottom of usable water:
Surface Pipe by Alternate: X 1 2
Length of Surface Pipe Planned to be set: 675'
Length of Conductor pipe required: 40'
Projected Total Depth: 5400
Formation at Total Depth: Mississippian
Water Source for Drilling Operations:
X well farm pond other

If OHS: old well information as follows:
Operator:
Well Name:
Comp. Date: Old Total Depth

Directional, Deviated or Horizontal wellbore? yes X no
If yes, true vertical depth:
Bottom Hole Location:

DNR Permit #:
Will Cores Be Taken?: yes X no
If yes, proposed zone:

AFFIDAVIT

The undersigned hereby affirms that the drilling, completion and eventual plugging of this well will comply with K.S.A. 55-101, et. seq.
It is agreed that the following minimum requirements will be met:

- 1. Notify the appropriate district office prior to spudding of well;
- 2. A copy of the approved notice of intent to drill shall be posted on each drilling rig;
- 3. The minimum amount of surface pipe as specified below shall be set by circulating cement to the top; in all cases surface pipe shall be set through all unconsolidated materials plus a minimum of 20 feet into the underlying formation;
- 4. If the well is dry hole, an agreement between the operator and the district office on plug length and placement is necessary prior to plugging;
- 5. The appropriate district office will be notified before well is either plugged or production casing is cemented in;
- 6. IF AN ALTERNATE II COMPLETION, PRODUCTION PIPE SHALL BE CEMENTED FROM BELOW ANY USABLE WATER TO SURFACE WITHIN 120 DAYS OF SPUD DATE. IN ALL CASES, NOTIFY DISTRICT OFFICE PRIOR TO ANY CEMENTING.

I hereby certify that the statements made herein are true and to the best of my knowledge and belief.
Date: 10-9-92 Signature of Operator or Agent: Timothy E. Brandt Title: Agent

FOR KCC USE:
API # 15- 033-20862-0000
Conductor pipe required 1200 feet
Minimum surface pipe required 200 feet per Alt. X
Approved by: CB 10-13-92
This authorization expires: 4-13-93
(This authorization void if drilling not started within 6 months of effective date.)
Spud date: Agent:

REMEMBER TO:

- File Drill Pit Application (form CDP-1) with Intent to Drill;
- File Completion Form ACO-1 within 120 days of spud date;
- File acreage attribution plat according to field proration orders;
- Notify appropriate district office 48 hours prior to workover or re-entry;
- Submit plugging report (CP-4) after plugging is completed;
- Obtain written approval before disposing or injecting salt water.

Mail to: Conservation Division, 200 Colorado Derby Building, 202 W. First St., Wichita, Kansas 67202-1286.

RECEIVED
KANSAS CORPORATION COMMISSION
OCT 9 1992
10-9-92
CONSERVATION DIVISION
WICHITA, KS
5
34
25

IN ALL CASES PLOT THE INTENDED WELL ON THE PLAT BELOW

PLAT OF ACREAGE ATTRIBUTABLE TO A WELL IN A PRORATED OR SPACED FIELD

If the intended well is in a prorated or spaced field, please fully complete this side of the form. If the intended well is in a prorated or spaced field complete the plat below showing that the well will be properly located in relationship to other wells producing from the common source of supply. Please show all the wells within 1 mile of the boundaries of the proposed acreage attribution unit for gas wells and within 1/2 mile of the boundaries of the proposed acreage attribution unit for oil wells.

API NO. 15- _____
 OPERATOR Samuel Gary Jr. & Associates
 LEASE Bluff Creek
 WELL NUMBER 5-6
 FIELD _____

LOCATION OF WELL: COUNTY Comanche
 _____ feet from south/north line of section
2310 feet from east/west line of section
 SECTION 5 TWP 34S RG 20W

NUMBER OF ACRES ATTRIBUTABLE TO WELL _____
 QTR/QTR/QTR OF ACREAGE _____

IS SECTION x REGULAR or _____ IRREGULAR
IF SECTION IS IRREGULAR, LOCATE WELL FROM NEAREST
CORNER BOUNDARY.

Section corner used: _____ NE x _____ NW _____ SE _____ SW

PLAT

(Show location of the well and shade attributable acreage for prorated or spaced wells.)
 (Show footage to the nearest lease or unit boundary line.)

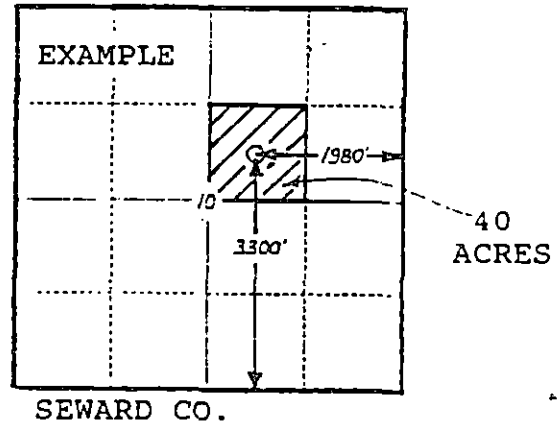
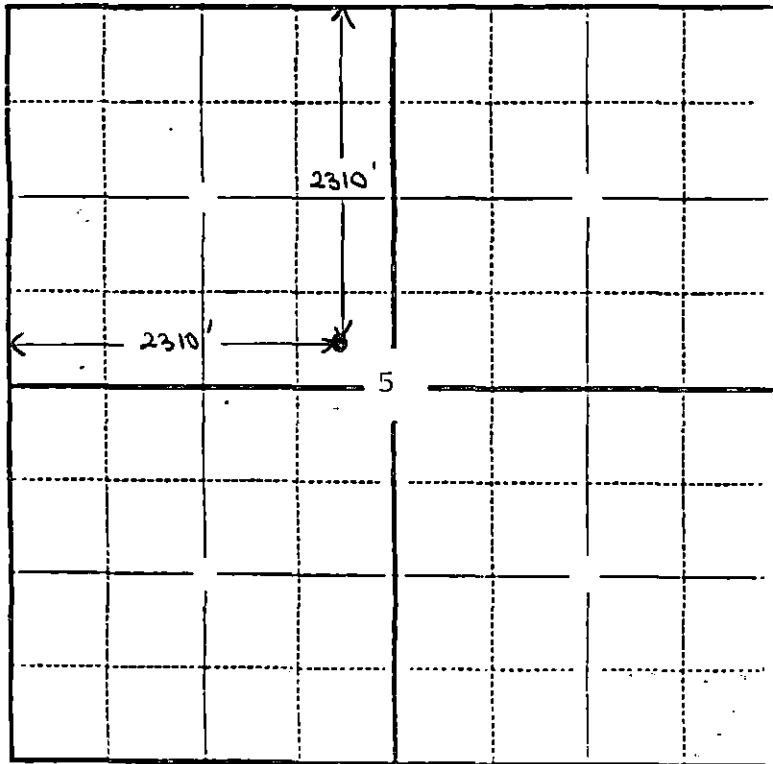

Comanche County, Kansas

In plotting the proposed location of the well, you must show:

- 1) The manner in which you are using the depicted plat by identifying section lines, i.e. 1 section, 1 section with 8 surrounding sections, 4 sections, etc.;
- 2) the distance of the proposed drilling location from the section's south/north and east/west lines; and
- 3) the distance to the nearest lease or unit boundary line.