



KANSAS CORPORATION COMMISSION 1084861
 OIL & GAS CONSERVATION DIVISION

Form ACO-4
 Form must be typed
 March 2009

APPLICATION FOR COMMINGLING OF **Commingling ID # CO071214**
 PRODUCTION (K.A.R. 82-3-123) OR FLUIDS (K.A.R. 82-3-123a)

OPERATOR: License # 33343
 Name: PostRock Midcontinent Production LLC
 Address 1: Oklahoma Tower
 Address 2: 210 Park Ave, Ste 2750
 City: OKLAHOMA CITY State: OK Zip: 73102 + _____
 Contact Person: CLARK EDWARDS
 Phone: (620) 432-4200

API No. 15 - 15-133-27219-00-00
 Spot Description: _____
 _____ SW NE Sec. 20 Twp. 28 S. R. 19 East West
 _____ 1980 _____ Feet from North / South Line of Section
 _____ 1980 _____ Feet from East / West Line of Section
 County: Neosho
 Lease Name: STICH, WILLIAM A. Well #: 20-5

1. Name and upper and lower limit of each production interval to be commingled:
 Formation: RIVERTON (Perfs): 867-867
 Formation: NEUTRAL (Perfs): 812-814
 Formation: ROWE (Perfs): 806-808
 Formation: WEIR (Perfs): 705-707
 Formation: TEBO (Perfs): 658-660

2. Estimated amount of fluid production to be commingled from each interval:
 Formation: RIVERTON BOPD: 0 MCFPD: 1.45 BWPD: 3.64
 Formation: NEUTRAL BOPD: 0 MCFPD: 1.45 BWPD: 3.64
 Formation: ROWE BOPD: 0 MCFPD: 1.45 BWPD: 3.64
 Formation: WEIR BOPD: 0 MCFPD: 1.45 BWPD: 3.64
 Formation: TEBO BOPD: 0 MCFPD: 1.45 BWPD: 3.64

3. Plat map showing the location of the subject well, all other wells on the subject lease, and all wells on offsetting leases within a 1/2 mile radius of the subject well, and for each well the names and addresses of the lessee of record or operator.

4. Signed certificate showing service of the application and affidavit of publication as required in K.A.R. 82-3-135a.

For Commingling of PRODUCTION ONLY, include the following:

5. Wireline log of subject well. Previously Filed with ACO-1: Yes No
 6. Complete Form ACO-1 (*Well Completion form*) for the subject well.

For Commingling of FLUIDS ONLY, include the following:

7. Well construction diagram of subject well.
 8. Any available water chemistry data demonstrating the compatibility of the fluids to be commingled.

Submitted Electronically

AFFIDAVIT: I am the affiant and hereby certify that to the best of my current information, knowledge and personal belief, this request for commingling is true and proper and I have no information or knowledge, which is inconsistent with the information supplied in this application.

KCC Office Use Only	
<input type="checkbox"/> Denied	<input checked="" type="checkbox"/> Approved
15-Day Periods Ends: <u>7/14/2012</u>	
Approved By: <u>Rick Hestermann</u>	Date: <u>07/16/2012</u>

Protests may be filed by any party having a valid interest in the application. Protests must be in writing and comply with K.A.R. 82-3-135b and must be filed within 15 days of publication of the notice of application.



PostRock

WELL: Stich, William A 20-5
 SSI: 624610
 API: 15-133-27219-00-00
 LOCATION: SW NE Sec. 20- 28S-19E
 COUNTY: Neosho
 STATE: Kansas

Wellbore Schematic

Casing	8.625" @ 20" 4.5" 10.5# J-55, 4.05" ID w/ 0.0159 bbl/ft capacity @ 983'
Perforations	Original Perfs: 3/3/2008 - Riverton 864-867 (13) - Neutral 812-814 (9) - Rowe 806-808 (9) - Weir 705-707 (9) - Tebo 658-660 (9) - Fleming 618-620 (9) - Fleming 601-603 (9) - Croweburg 560-563 (13) - Bevier 537-539 (9) - Mulky 454-458 (17)
Completions	Spud Date: 12/15/2007 Completion Date: 3/3/2008 River/Neu/Rowe: - 5600# 20/40 - 500 gal 15% - 607 bbls - 12 bpm Weir/Tebo/Fleming: - 2700# 20/40 - 400 gal 15% - 321 bbls - 12 bpm Fleming/Crowe/Bevier: - 2400# 20/40 - 400 gal 15% - 408 bbls - 18 bpm Mulky/Summit: - 6000# 20/40 - 400 gal 15% - 626 bbls - 14 bpm

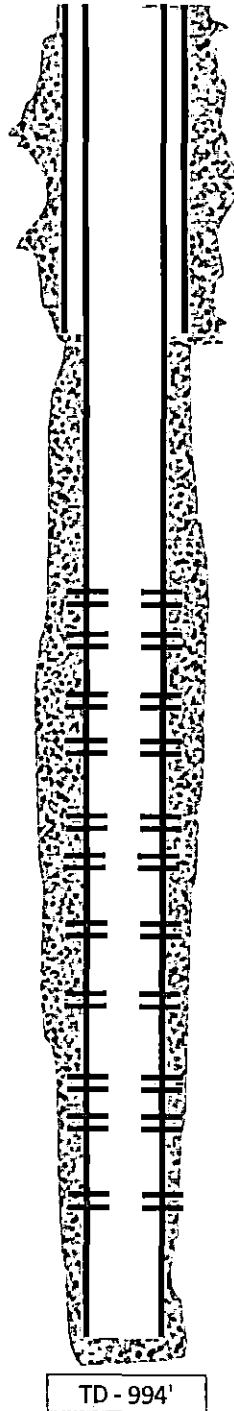

TOC - Surface

8.625" @ 20'

4.5" 10.5# @ 983'
125 sks cement

TD - 994'

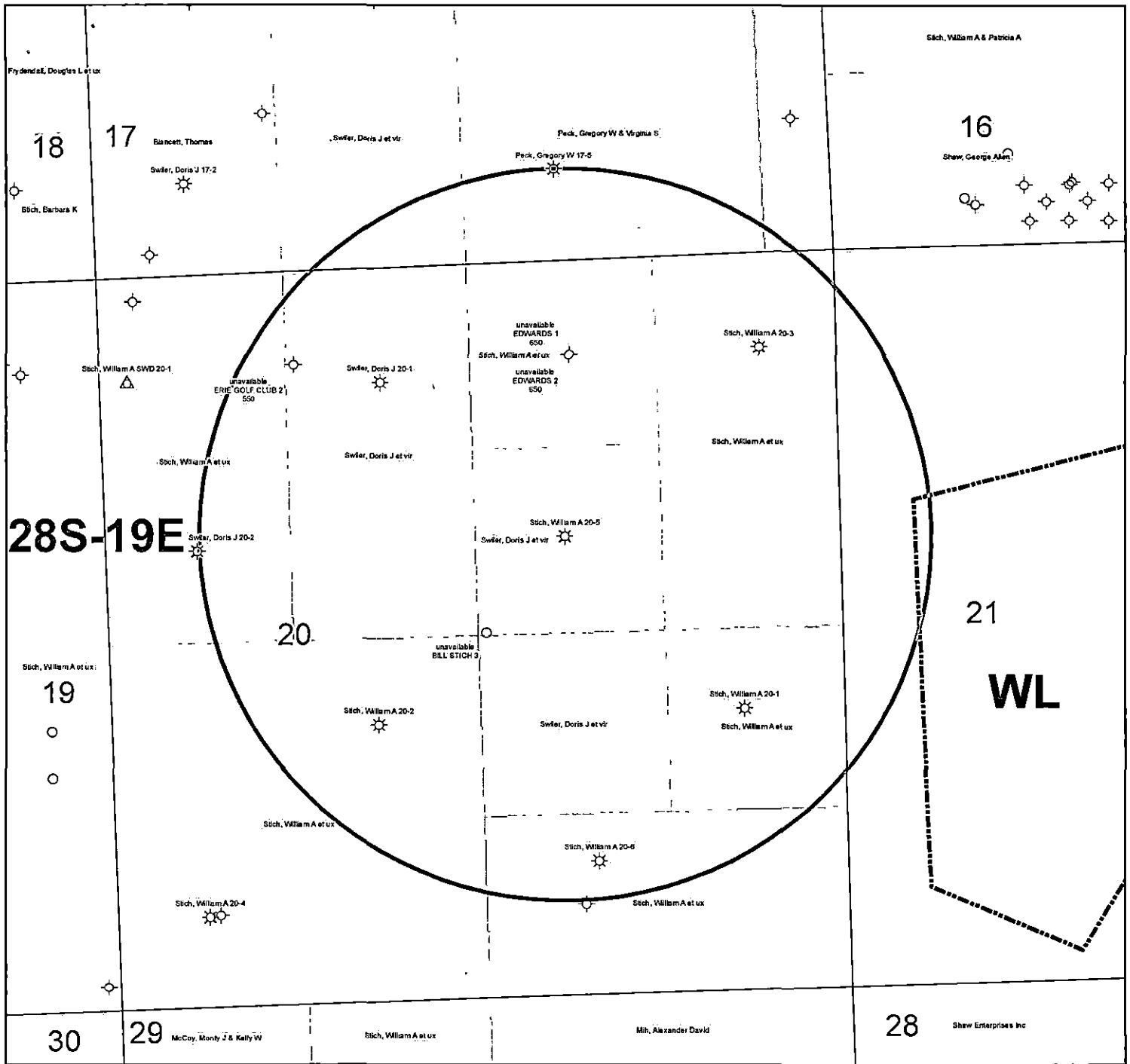

KGS STATUS	
◊	DA/PA
⊕	EOR
☀	GAS
△	INJ/SWD
●	OIL
★	OIL/GAS
○	OTHER

Stich, William A 20-5
 20-28S-19E
 1" = 1,000'

	A	B	C	D	E	F	G	H	I	J	K
1	Produced Fluids #		1	2	3	4	5		Click here to run SSP Goal Seek SSP Click		
2	Parameters	Units	Input	Input	Input	Input	Input				
3	Select the brines	Select fluid by checking the box(es),	<input type="checkbox"/>	<input type="checkbox"/>	<input type="checkbox"/>	<input type="checkbox"/>	<input type="checkbox"/>	Mixed brine:			
4	Sample ID	Row 3						Cell H28 is			
5	Date	3/19/2012	3/4/2012	3/14/2012	1/20/2012	1/20/2012		STP calc. pH.			
6	Operator	PostRock	PostRock	PostRock	PostRock	PostRock		Cells H35-38			
7	Well Name	Ward Feed	Ward Feed	Clinesmith	Clinesmith	Clinesmith		are used in			
8	Location	#34-1	#4-1	#5-4	#1	#2		mixed brines			
9	Field	CBM	CBM	Bartles	Bartles	Bartles		calculations.			
10	Na ⁺	(mg/l)*	19,433.00	27,381.00	26,534.00	25689.00	24220.00	24654.20	Initial(BH)	Final(WH)	SISR (Final-Initial)
11	K ⁺ (if not known =0)	(mg/l)						0.00	Saturation Index values		
12	Mg ²⁺	(mg/l)	1,096.00	872.00	1,200.00	953.00	858.00	995.91	Calcite		
13	Ca ²⁺	(mg/l)	1,836.00	2,452.00	2,044.00	1920.00	1948.00	2040.23	-0.73	-0.60	0.13
14	Str ²⁺	(mg/l)						0.00	Barite		
15	Ba ²⁺	(mg/l)						0.00			
16	Fe ²⁺	(mg/l)	40.00	21.00	18.00	82.00	90.00	50.21	Halite		
17	Zn ²⁺	(mg/l)						0.00	-1.77	-1.80	-0.03
18	Pb ²⁺	(mg/l)						0.00	Gypsum		
19	Cl ⁻	(mg/l)	36,299.00	48,965.00	47,874.00	45632.00	43147.00	44388.44	-3.19	-3.18	0.00
20	SO ₄ ²⁻	(mg/l)	1.00	1.00	8.00	1.00	1.00	2.40	Hemihydrate		
21	F ⁻	(mg/l)						0.00	-3.96	-3.90	0.06
22	Br ⁻	(mg/l)						0.00	Anhydrite		
23	SiO ₂	(mg/l) SiO ₂						0.00	-3.47	-3.36	0.12
24	HCO ₃ Alkalinity**	(mg/l as HCO ₃)	190.00	234.00	259.00	268.00	254.00	241.03	Celestite		
25	CO ₃ Alkalinity	(mg/l as CO ₃)									
26	Carboxylic acids**	(mg/l)						0.00	Iron Sulfide		
27	Ammonia	(mg/L) NH ₃						0.00	-0.16	-0.22	-0.06
28	Borate	(mg/L) H ₃ BO ₃						0.00	Zinc Sulfide		
29	TDS (Measured)	(mg/l)						72781			
30	Calc. Density (STP)	(g/ml)	1.038	1.051	1.050	1.048	1.045	1.047	Calcium fluoride		
31	CO ₂ Gas Analysis	(%)	19.97	18.76	22.41	35.53	33.79	26.16			
32	H ₂ S Gas Analysis***	(%)	0.0289	0.0292	0.0296	0.0306	0.0151	0.0269	Iron Carbonate		
33	Total H ₂ Saq	(mgH ₂ S/l)	1.00	1.00	1.00	1.00	0.50	0.90	-0.74	-0.51	0.23
34	pH, measured (STP)	pH	5.67	5.76	5.72	5.54	5.55	5.63	Inhibitor needed (mg/L)		
	Choose one option to calculate SI?	0-CO ₂ +Alk, 1-pH+Alk, 2-CO ₂ +pH	0	0	0	0	0		Calcite	NTMP	
35	Gas/day(thousand cf/day)	(Mcf/D)						0	0.00	0.00	
36	Oil/Day	(B/D)	0	0	1	1	1	4	Barite	BHPMP	
37	Water/Day	(B/D)	100	100	100	100	100	500	0.00	0.00	
38	For mixed brines, enter values for temperatures and pressures in Cells (H40-H43)							(Enter H40-H43)	pH		
39	Initial T	(F)	66.0	71.0	70.0	41.0	49.0	60.0	5.69	5.60	
40	Final T	(F)	66.0	71.0	70.0	41.0	49.0	89.0	Viscosity (CentiPoise)		
41	Initial P	(psia)	25.0	25.0	25.0	25.0	25.0	25.0	1.196	0.826	
42	Final P	(psia)	25.0	25.0	25.0	25.0	25.0	120.0	Heat Capacity (cal/ml ^o C)		
43	Use TP on Calcite sheet?	1-Yes;0-No							0.955	0.959	
44	API Oil Grav.	API grav.						30.00	Inhibitor needed (mg/L)		
45	Gas Sp.Grav.	Sp.Grav.						0.60	Gypsum	HDTMP	
46	MeOH/Day	(B/D)	0					0	0.00	0.00	
47	MEG/Day	(B/D)	0					0	Anhydrite	HDTMP	
48	Conc. Multiplier								0.00	0.00	
49	H ⁺ (Strong acid) [†]	(N)									
50	OH ⁻ (Strong base) [†]	(N)									
51	Quality Control Checks at STP:										
52	H ₂ S Gas	(%)									
53	Total H ₂ Saq (STP)	(mgH ₂ S/l)									
54	pH Calculated	(pH)									
55	PCO ₂ Calculated	(%)									
56	Alkalinity Calculated	(mg/l) as HCO ₃									
57	ECations=	(equiv./l)									
58	EAnions=	(equiv./l)									
59	Calc TDS=	(mg/l)									
60	Inhibitor Selection	Input	Unit	#	Inhibitor	Unit Converter (From metric to English)					
61	Protection Time	120	min	1	NTMP	From Unit	Value	To Unit	Value		
62	Have ScaleSoftPitzer			2	BHPMP	°C	80	°F	176		
63	pick inhibitor for you?	1	1-Yes;0-No	3	PAA	m ³	100	ft ³	3,531		
64	If No, inhibitor # is:	4	#	4	DTPMP	m ³	100	bb(42 US gal)	629		
65	If you select Mixed,			5	PPCA	MPa	1,000	psia	145,074		
66	1 st inhibitor # is:	1	#	6	SPA	Bar	496	psia	7,194		
67	% of 1 st inhibitor is:	50	%	7	HEDP	Torr	10,000	psia	193		
68	2 nd inhibitor # is:	2	#	8	HDTMP	Gal	10,000	bb(42 US gal)	238		
69	Display act. coeffs?	0	1-Yes;0-No	9	Average	Liters	10,000	bb(42 US gal)	63		
70				10	Mixed						

Saturation Index Calculations

Champion Technologies, Inc.
(Based on the Tomson-Oddo Model)

Brine 1: Ward Feed Yard 34-1

Brine 2: Ward Feed Yard 4-1

Brine 3: Clinesmith 5-4

Brine 4: Clinesmith 1

Brine 5: Clinesmith 2

Component (mg/L)	Ratio					Mixed Brine
	20% Brine 1	20% Brine 2	20% Brine 3	20% Brine 4	20 Brine 5	
Calcium	1836	2452	2044	1920	1948	1952
Magnesium	1096	872	1200	953	858	865
Barium	0	0	0	0	0	0
Strontium	0	0	0	0	0	0
Bicarbonate	190	234	259	268	254	253
Sulfate	1	1	8	1	1	1
Chloride	36299	48965	47874	45632	43147	43206
CO ₂ in Brine	246	220	264	422	405	401
Ionic Strength	1.12	1.48	1.46	1.38	1.31	1.31
Temperature (°F)	89	89	89	89	89	89
Pressure (psia)	50	50	120	120	120	119

Saturation Index

Calcite	-1.71	-1.41	-1.48	-1.68	-1.69	-1.69
Gypsum	-3.71	-3.64	-2.82	-3.73	-3.72	-3.69
Hemihydrate	-3.70	-3.65	-2.83	-3.74	-3.71	-3.69
Anhydrite	-3.89	-3.79	-2.97	-3.89	-3.88	-3.85
Barite	N/A	N/A	N/A	N/A	N/A	N/A
Celestite	N/A	N/A	N/A	N/A	N/A	N/A

PTB

Calcite	N/A	N/A	N/A	N/A	N/A	N/A
Gypsum	N/A	N/A	N/A	N/A	N/A	N/A
Hemihydrate	N/A	N/A	N/A	N/A	N/A	N/A
Anhydrite	N/A	N/A	N/A	N/A	N/A	N/A
Barite	N/A	N/A	N/A	N/A	N/A	N/A
Celestite	N/A	N/A	N/A	N/A	N/A	N/A

KANSAS CORPORATION COMMISSION
OIL & GAS CONSERVATION DIVISION

Form ACO-1
September 1999
Form Must Be Typed

WELL COMPLETION FORM
WELL HISTORY - DESCRIPTION OF WELL & LEASE

Operator: License # 33344
Name: Quest Cherokee, LLC
Address: 211 W. 14th Street
City/State/Zip: Chanute, KS 66720
Purchaser: Bluestem Pipeline, LLC
Operator Contact Person: Jennifer R. Ammann
Phone: (620) 431-9500
Contractor: Name: TXD
License: 33837

Wellsite Geologist: Ken Recoy
Designate Type of Completion:
 New Well Re-Entry Workover
 Oil SWD SLOW Temp. Abd.
 Gas ENHR SIGW
 Dry Other (Core, WSW, Expl., Cathodic, etc)

If Workover/Re-entry: Old Well Info as follows:

Operator: _____
Well Name: _____
Original Comp. Date: _____ Original Total Depth: _____
 Deepening Re-perf. Conv. to Enhr./SWD
 Plug Back _____ Plug Back Total Depth _____
 Commingled Docket No. _____
 Dual Completion Docket No. _____
 Other (SWD or Enhr.?) Docket No. _____

<u>12-15-07</u>	<u>1-2-08</u>	<u>1-3-08</u>
Spud Date or Recompletion Date	Date Reached TD	Completion Date or Recompletion Date

API No. 15 - 15-133-27219-0000
County: Neosho
SW NE Sec. 20 Twp. 28 S. R. 19 East West
1980 feet from S N (circle one) Line of Section
1980 feet from E W (circle one) Line of Section

Footages Calculated from Nearest Outside Section Corner:
(circle one) NE SE NW SW
Lease Name: Stich, William A. Well #: 20-5

Field Name: Cherokee Basin CBM
Producing Formation: Multiple
Elevation: Ground: 910 Kelly Bushing: n/a
Total Depth: 994 Plug Back Total Depth: 983
Amount of Surface Pipe Set and Cemented at 20 Feet
Multiple Stage Cementing Collar Used? Yes No
If yes, show depth set _____ Feet
If Alternate II completion, cement circulated from 983
feet depth to surface w/ 125 sx cmt.

Drilling Fluid Management Plan
(Data must be collected from the Reserve Pit)
Chloride content _____ ppm Fluid volume _____ bbls
Dewatering method used _____
Location of fluid disposal if hauled offsite: _____
Operator Name: _____
Lease Name: _____ License No.: _____
Quarter _____ Sec. _____ Twp. _____ S. R. _____ East West
County: _____ Docket No.: _____

INSTRUCTIONS: An original and two copies of this form shall be filed with the Kansas Corporation Commission, 130 S. Market - Room 2078, Wichita, Kansas 67202, within 120 days of the spud date, recompletion, workover or conversion of a well. Rule 82-3-130, 82-3-106 and 82-3-107 apply. Information of side two of this form will be held confidential for a period of 12 months if requested in writing and submitted with the form (see rule 82-3-107 for confidentiality in excess of 12 months). One copy of all wireline logs and geologist well report shall be attached with this form. ALL CEMENTING TICKETS MUST BE ATTACHED. Submit CP-4 form with all plugged wells. Submit CP-111 form with all temporarily abandoned wells.

All requirements of the statutes, rules and regulations promulgated to regulate the oil and gas industry have been fully complied with and the statements herein are complete and correct to the best of my knowledge.

Signature: Jennifer R. Ammann
Title: New Well Development Coordinator Date: 4/11/08
Subscribed and sworn to before me this 11th day of April,
2008.
Notary Public: Derra Klauman
Date Commission Expires: 8-4-2010

KCC Office Use ONLY
 Letter of Confidentiality Received
If Denied, Yes Date: _____
 Wireline Log Received
 Geologist Report Received
 UIC Distribution

TERRA KLAUMAN
Notary Public - State of Kansas
My Appl. Expires 8-4-2010

Operator Name: Quest Cherokee, LLC Lease Name: Stich, William A. Well #: 20-5
 Sec. 20 Twp. 28 S. R. 19 East West County: Neosho

INSTRUCTIONS: Show important tops and base of formations penetrated. Detail all cores. Report all final copies of drill stems tests giving interval tested, time tool open and closed, flowing and shut-in pressures, whether shut-in pressure reached static level, hydrostatic pressures, bottom hole temperature, fluid recovery, and flow rates if gas to surface test, along with final chart(s). Attach extra sheet if more space is needed. Attach copy of all Electric Wireline Logs surveyed. Attach final geological well site report.

Drill Stem Tests Taken <input type="checkbox"/> Yes <input type="checkbox"/> No (Attach Additional Sheets) Samples Sent to Geological Survey <input type="checkbox"/> Yes <input type="checkbox"/> No Cores Taken <input type="checkbox"/> Yes <input type="checkbox"/> No Electric Log Run <input type="checkbox"/> Yes <input type="checkbox"/> No (Submit Copy) List All E. Logs Run: Compensated Density Neutron Log Dual Induction Log	<input checked="" type="checkbox"/> Log Formation (Top), Depth and Datum <input type="checkbox"/> Sample Name Top Datum See attached
---	--

CASING RECORD <input type="checkbox"/> New <input type="checkbox"/> Used							
Report all strings set-conductor, surface, intermediate, production, etc.							
Purpose of String	Size Hole Drilled	Size Casing Set (In O.D.)	Weight Lbs./FL	Setting Depth	Type of Cement	# Sacks Used	Type and Percent Additives
Surface	12-1/4	8-5/8"	22	20	"A"	5	
Production	6-3/4	4-1/2	10.5	983	"A"	125	

ADDITIONAL CEMENTING / SQUEEZE RECORD				
Purpose:	Depth Top Bottom	Type of Cement	#Sacks Used	Type and Percent Additives
<input type="checkbox"/> Perforate				
<input type="checkbox"/> Protect Casing				
<input type="checkbox"/> Plug Back TD				
<input type="checkbox"/> Plug Off Zone				

Shots Per Foot	PERFORATION RECORD - Bridge Plugs Set/Type Specify Footage of Each Interval Perforated	Acid, Fracture, Shot, Cement Squeeze Record (Amount and Kind of Material Used)	
			Depth
4	864-867/812-814/806-808	600gal 15% HCl w/ 50bbls 2% acid water, 607bbls water w/ 2% HCl, Biocide, 66000 20/40 sand	864-867/812-814
			806-808
4	705-707/658-660/618-620	400gal 15% HCl w/ 62bbls 2% acid water, 321bbls water w/ 2% HCl, Biocide, 27000 20/40 sand	705-707/658-660
			618-620
4	454-458/442-446	400gal 15% HCl w/ 46bbls 2% acid water, 625bbls water w/ 2% HCl, Biocide, 60000 20/40 sand	454-458/442-446

TUBING RECORD		Size	Set At	Packer At	Liner Run	<input type="checkbox"/> Yes <input checked="" type="checkbox"/> No
		2-3/8"	907	n/a		
Date of First, Resumerd Production, SWD or Enhc.			Producing Method			
3-10-08			<input type="checkbox"/> Flowing <input checked="" type="checkbox"/> Pumping <input type="checkbox"/> Gas Lift <input type="checkbox"/> Other (Explain)			
Estimated Production Per 24 Hours	Oil Bbls.	Gas Mcf	Water Bbls.	Gas-Oil Ratio	Gravity	
	n/a	14.6 mcf	34.2 bbls			

Disposition of Gas Vented Sold Used on Lease (If vented, Submit ACO-18.)

METHOD OF COMPLETION Open Hole Perf. Dually Comp. Commingled Other (Specify) _____

Production Interval _____

BEFORE THE STATE CORPORATION COMMISSION OF THE STATE OF KANSAS
NOTICE OF FILING APPLICATION

RE: In the Matter of **Postrock Midcontinent Production, LLC** Application for Commingling of Production in the **Stich, William A 20-5** located in **Neosho County, Kansas.**

TO: All Oil & Gas Producers, Unleased Mineral Interest Owners, Landowners, and all persons whomsoever concerned.

You, and each of you, are hereby notified that **Postrock Midcontinent Production, LLC** has filed an application to commingle the **Riverton, Neutral, Rowe, Weir, Tebo, Fleming, Croweburg, Bevier, Mulky, Summit, Lower Cattleman and Upper Cattleman** producing formations at the **Stich, William A 20-5**, located in the SW NE, S20-T28S-R19E, Approximately 1980 FNL & 1980 FEL, Neosho County, Kansas.

Any persons who object to or protest this application shall be required to file their objections or protest with the Conservation Division of the State Corporation Commission of the State of Kansas within fifteen (15) days from the date of this publication. These protests shall be filed pursuant to Commission regulations and must state specific reasons why granting the application may cause waste, violate correlative rights or pollute the natural resources of the State of Kansas.

All persons interested or concerned shall take notice of the foregoing and shall govern themselves accordingly. All person and/or companies wishing to protest this application are required to file a written protest with the Conservation Division of the Kansas Oil and Gas Commission.

Upon the receipt of any protest, the Commission will convene a hearing and protestants will be expected to enter an appearance either through proper legal counsel or as individuals, appearing on their own behalf.

Postrock Midcontinent Production, LLC
210 Park Avenue, Suite 2750
Oklahoma City, Oklahoma 73102
(405) 660-7704

A COPY OF THE AFFIDAVIT OF PUBLICATION MUST ACCOMPANY ALL APPLICATIONS

Affidavit of Publication

STATE OF KANSAS, NEOSHO COUNTY, ss:
Rhonda Howerter, being first duly sworn, deposes and says: That *she* is *Classified Manager* of *THE CHANUTE TRIBUNE*, a daily newspaper printed in the State of Kansas, and published in and of general circulation in Neosho County, Kansas, with a general paid circulation on a daily basis in Neosho County, Kansas, and that said newspaper is not a trade, religious or fraternal publication.

Said newspaper is a daily published at least weekly 50 times a year: has been so published continuously and uninterruptedly in said county and state for a period of more than five years prior to the first publication of said notice; and has been admitted at the post office of Chanute, in said county as second class matter.

That the attached notice is a true copy thereof and was published in the regular and entire issue of said newspaper for 1 consecutive time, the first publication thereof being made as aforesaid on the 16 day of June 2012, with subsequent publications being made on the following dates:

_____, 2012 _____, 2012

_____, 2012 _____, 2012

Rhonda Howerter

Subscribed and sworn to and before me this 19 day of June, 2012

[Signature]
Notary Public

My commission expires: January 9, 2015

Printer's Fee \$ 71.17

Affidavit, Notary's Fee \$ 3.00

Additional Copies \$ _____

Total Publication Fees \$ 74.17

SHANNA L. GUIOT
Notary Public - State of Kansas
My Appt. Expires 1-9-15

AFFIDAVIT

STATE OF KANSAS \
- SS.
County of Sedgwick /

Mark Fletchall, of lawful age, being first duly sworn, deposeth and saith: That he is Record Clerk of The Wichita Eagle, a daily newspaper published in the City of Wichita, County of Sedgwick, State of Kansas, and having a general paid circulation on a daily basis in said County, which said newspaper has been continuously and uninterruptedly published in said County for more than one year prior to the first publication of the notice hereinafter mentioned, and which said newspaper has been entered as second class mail matter at the United States Post Office in Wichita, Kansas, and which said newspaper is not a trade, religious or fraternal publication and that a notice of a true copy is hereto attached was published in the regular and entire Morning issue of said The Wichita Eagle for 1 issues, that the first publication of said notice was

made as aforesaid on the 18th of

June A.D. 2012, with

subsequent publications being made on the following dates:

And affiant further says that he has personal knowledge of the statements above set forth and that they are true.

Mark Fletchall

Subscribed and sworn to before me this

18th day of June, 2012

PENNY L. CASE
Notary Public - State of Kansas
My Appt. Expires 5/28/2014

Penny L. Case
Notary Public Sedgwick County, Kansas

Printer's Fee : \$134.80

LEGAL PUBLICATION
PUBLISHED IN THE WICHITA EAGLE
JUNE 18, 2012 (3191267)
BEFORE THE STATE CORPORATION
COMMISSION OF THE
STATE OF KANSAS
NOTICE OF FILING APPLICATION
RE: In the Matter of Postrock Midcontinent
Production, LLC Application for
Commencing of Production in the
Sitch: William A 20-5 located in
Neosho County, Kansas
TO: All Oil & Gas Producers, Unleased
Mineral Interest Owners,
Landowners, and all persons
whomever concerned.
You, and each of you, are hereby notified
that Postrock Midcontinent Production,
LLC has filed an application to commence
the Riverton, Neutral, Rowe, Well, Tebo,
Fleming, Crawe, Bower, Bulky,
Summit, Lower, Cattleman and Upper
Cattleman production formations in the
Sitch: William A 20-5 located in the SW NE
S20-T28S-R19E, Approximately 1980 ENL &
1980 FEL, Neosho County, Kansas.
Any persons who object to or protest
this application shall be required to file their
objections or protest with the Conservation
Division of the State Corporation Commission
of the State of Kansas within fifteen (15)
days from the date of this publication. These
protests shall be filed pursuant to Commission
regulations and must state specific reasons
why granting the application may cause
waste, violate correlative rights or pollute the
natural resources of the State of Kansas.
All persons interested or concerned shall
take notice of the foregoing and shall govern
themselves accordingly. All person and/or
companies wishing to protest this application
are required to file a written protest with the
Conservation Division of the Kansas Oil and
Gas Commission.
Upon the receipt of any protest, the
Commission will convene a hearing and
protestants will be expected to enter an
appearance, either through proper legal
counsel or as individuals, appearing on their
own behalf.
Postrock Midcontinent Production, LLC
210 Park Avenue, Suite 2750
Oklahoma City, Oklahoma 73102
(405) 660-7704

1 NAME & UPPER & LOWER LIMIT OF EACH PRODUCTION INTERVAL TO BE COMMINGLED

FORMATION:	<u>FLEMING</u>	(PERFS):	<u>618 - 620</u>
FORMATION:	<u>FLEMING</u>	(PERFS):	<u>601 - 603</u>
FORMATION:	<u>CROWEBURG</u>	(PERFS):	<u>560 - 563</u>
FORMATION:	<u>BEVIER</u>	(PERFS):	<u>537 - 539</u>
FORMATION:	<u>MULKY</u>	(PERFS):	<u>454 - 458</u>
FORMATION:	<u>SUMMITT</u>	(PERFS):	<u>442 - 446</u>
FORMATION:	<u>CATTLEMAN</u>	(PERFS):	<u>636 - 640</u>
FORMATION:	<u>CATTLEMAN</u>	(PERFS):	<u>690 - 694</u>
FORMATION:	<u> </u>	(PERFS):	<u> </u>
FORMATION:	<u> </u>	(PERFS):	<u> </u>
FORMATION:	<u> </u>	(PERFS):	<u> </u>
FORMATION:	<u> </u>	(PERFS):	<u> </u>

2 ESTIMATED AMOUNT OF FLUID PRODUCTION TO BE COMMINGLED FROM EACH INTERVAL

FORMATION:	<u>FLEMING</u>	BOPD:	<u>0</u>	MCFPD:	<u>1.45</u>	BWPD:	<u>3.64</u>
FORMATION:	<u>FLEMING</u>	BOPD:	<u>0</u>	MCFPD:	<u>1.45</u>	BWPD:	<u>3.64</u>
FORMATION:	<u>CROWEBURG</u>	BOPD:	<u>0</u>	MCFPD:	<u>1.45</u>	BWPD:	<u>3.64</u>
FORMATION:	<u>BEVIER</u>	BOPD:	<u>0</u>	MCFPD:	<u>1.45</u>	BWPD:	<u>3.64</u>
FORMATION:	<u>MULKY</u>	BOPD:	<u>0</u>	MCFPD:	<u>1.45</u>	BWPD:	<u>3.64</u>
FORMATION:	<u>SUMMITT</u>	BOPD:	<u>0</u>	MCFPD:	<u>1.45</u>	BWPD:	<u>3.64</u>
FORMATION:	<u>CATTLEMAN</u>	BOPD:	<u>1.5</u>	MCFPD:	<u>0</u>	BWPD:	<u>10</u>
FORMATION:	<u>CATTLEMAN</u>	BOPD:	<u>1.5</u>	MCFPD:	<u>0</u>	BWPD:	<u>10</u>
FORMATION:	<u> </u>	BOPD:	<u> </u>	MCFPD:	<u> </u>	BWPD:	<u> </u>
FORMATION:	<u> </u>	BOPD:	<u> </u>	MCFPD:	<u> </u>	BWPD:	<u> </u>
FORMATION:	<u> </u>	BOPD:	<u> </u>	MCFPD:	<u> </u>	BWPD:	<u> </u>
FORMATION:	<u> </u>	BOPD:	<u> </u>	MCFPD:	<u> </u>	BWPD:	<u> </u>

Affidavit of Notice Served

Re: Application for: APPLICATION FOR COMMINGLING OF PRODUCTION OR FLUIDS - ACO-4

Well Name: STICH, WILLIAM A 20-5 Legal Location: SWNE S20-T28S-R19E

The undersigned hereby certifies that he / she is a duly authorized agent for the applicant, and that on the day 29th of JUNE, 2012, a true and correct copy of the application referenced above was delivered or mailed to the following parties:

Note: A copy of this affidavit must be served as a part of the application.

Name	Address (Attach additional sheets if necessary)
JOSEPH & REBECCA STICH	8740 150TH RD, CHANUTE, KS 66720
ALEXANDER DAVID MIH	1927 BREWSTER ROAD, INDIANAPOLIS, IN 46260
SHAW ENTERPRISES, INC	11600 160TH ROAD, CHANUTE, KS 66720
ELK CREEK AGRICULTURAL LP	1400 WOODSBOROUGH, HOUSTON, TX 77055

I further attest that notice of the filing of this application was published in the CHANUTE TRIBUNE, the official county publication of NEOSHO county. A copy of the affidavit of this publication is attached.

Signed this 29th day of JUNE, 2012

Denise V. Venneman
Applicant or Duly Authorized Agent

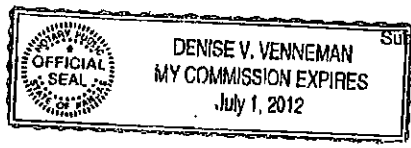

Subscribed and sworn to before me this 29th day of JUNE, 2012

Denise V. Venneman
Notary Public

My Commission Expires: 7-1-12

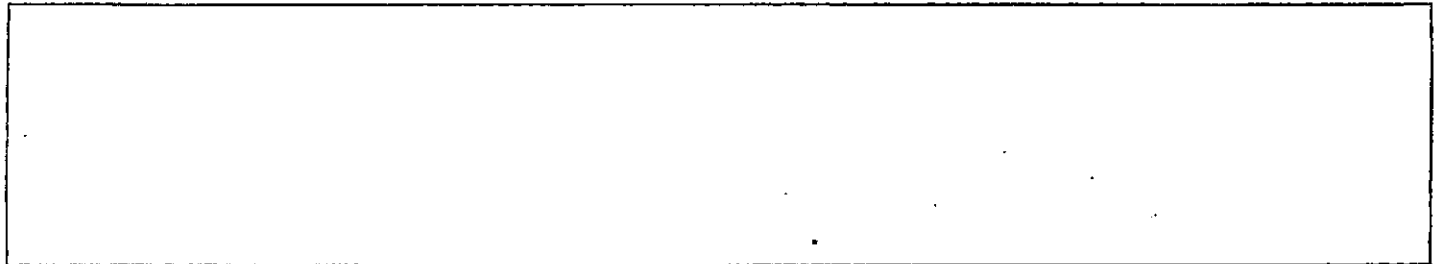

Conservation Division
Finney State Office Building
130 S. Market, Rm. 2078
Wichita, KS 67202-3802



Phone: 316-337-6200
Fax: 316-337-6211
<http://kcc.ks.gov/>

Mark Sievers, Chairman
Thomas E. Wright, Commissioner

Sam Brownback, Governor

July 16, 2012

Clark Edwards
PostRock Midcontinent Production LLC
Oklahoma Tower
210 Park Ave, Ste 2750
Oklahoma City, OK 73102

RE: Approved Commingling CO071214
Stich, William A. 20-5, Sec.20-T28S-R19E, Neosho County
API No. 15-133-27219-00-00

Dear Mr. Edwards:

Your Application for Commingling (ACO-4) for the above described well, received by the KCC on July 2, 2012, has been reviewed and approved by the Kansas Corporation Commission (KCC) per K.A.R. 82-3-123. Notice was examined and found to be proper per K.A.R. 82-3-135a. No protest had been filed within the 15-day protest period.

Based upon the depth of the Riverton formation perforations, total oil production shall not exceed 100 BOPD and total gas production shall not exceed 50% of the absolute open flow (AOF).

File form ACO-1 upon re-completion of the well to commingle.

Commingling ID number CO71214 has been assigned to this approved application. Use this number for well completion reports (ACO-1) and other correspondence that may concern this approved commingling.

Sincerely,

Rick Hestermann
Production Department