



KANSAS CORPORATION COMMISSION 1084870
OIL & GAS CONSERVATION DIVISION

Form ACO-4
Form must be typed
March 2009

APPLICATION FOR COMMINGLING OF PRODUCTION (K.A.R. 82-3-123) OR FLUIDS (K.A.R. 82-3-123a)

Commingling ID # CO071216

OPERATOR: License # 33343
Name: PostRock Midcontinent Production LLC
Address 1: Oklahoma Tower
Address 2: 210 Park Ave, Ste 2750
City: OKLAHOMA CITY State: OK Zip: 73102 + _____
Contact Person: CLARK EDWARDS
Phone: (620) 432-4200

API No. 15 - 15-133-26371-00-00
Spot Description: _____
NE SW NW SW Sec. 9 Twp. 28 S. R. 19 East West
1927 Feet from North / South Line of Section
386 Feet from East / West Line of Section
County: Neosho
Lease Name: KING FARMS Well #: 9-1

1. Name and upper and lower limit of each production interval to be commingled:
- | | |
|------------------------------|-------------------------|
| Formation: <u>RIVERTON</u> | (Perfs): <u>863-867</u> |
| Formation: <u>ROWE</u> | (Perfs): <u>813-815</u> |
| Formation: <u>BLUEJACKET</u> | (Perfs): <u>715-717</u> |
| Formation: <u>FLEMING</u> | (Perfs): <u>611-613</u> |
| Formation: <u>CROWEBURG</u> | (Perfs): <u>576-578</u> |

2. Estimated amount of fluid production to be commingled from each interval:
- | | | | |
|------------------------------|----------------|--------------------|-------------------|
| Formation: <u>RIVERTON</u> | BOPD: <u>0</u> | MCFPD: <u>4.44</u> | BWPD: <u>4.44</u> |
| Formation: <u>ROWE</u> | BOPD: <u>0</u> | MCFPD: <u>4.44</u> | BWPD: <u>4.44</u> |
| Formation: <u>BLUEJACKET</u> | BOPD: <u>0</u> | MCFPD: <u>4.44</u> | BWPD: <u>4.44</u> |
| Formation: <u>FLEMING</u> | BOPD: <u>0</u> | MCFPD: <u>4.44</u> | BWPD: <u>4.44</u> |
| Formation: <u>CROWEBURG</u> | BOPD: <u>0</u> | MCFPD: <u>4.44</u> | BWPD: <u>4.44</u> |

3. Plat map showing the location of the subject well, all other wells on the subject lease, and all wells on offsetting leases within a 1/2 mile radius of the subject well, and for each well the names and addresses of the lessee of record or operator.
4. Signed certificate showing service of the application and affidavit of publication as required in K.A.R. 82-3-135a.

For Commingling of PRODUCTION ONLY, include the following:

5. Wireline log of subject well. Previously Filed with ACO-1: Yes No
6. Complete Form ACO-1 (*Well Completion form*) for the subject well.

For Commingling of FLUIDS ONLY, include the following:

7. Well construction diagram of subject well.
8. Any available water chemistry data demonstrating the compatibility of the fluids to be commingled.

AFFIDAVIT: I am the affiant and hereby certify that to the best of my current information, knowledge and personal belief, this request for commingling is true and proper and I have no information or knowledge, which is inconsistent with the information supplied in this application.

Submitted Electronically

KCC Office Use Only	
<input type="checkbox"/> Denied	<input checked="" type="checkbox"/> Approved
15-Day Periods Ends: <u>7/14/2012</u>	
Approved By: <u>Rick Hestermann</u>	Date: <u>07/16/2012</u>

Protests may be filed by any party having a valid interest in the application. Protests must be in writing and comply with K.A.R. 82-3-135b and must be filed within 15 days of publication of the notice of application.



PostRock

Wellbore Schematic

WELL: King Farms 9-1
 SSI: 609010
 API: 15-133-26371
 LOCATION: NW SW Sec. 9 28S-19E
 COUNTY: Neosho
 STATE: Kansas

Casing	8.625" 20# @ 22' 4.5" 10.5# J-55, 4.05" ID w/ 0.0159 bbl/ft capacity @ 976'
Perforations	Original Perfs: 1/16/06 - Riverton 863-867' (17) - Rowe 813-815' (9) - Bluejacket 715-717' (9) - Fleming 611-613' (9) - Croweburg 576-578' (9) - Croweburg 572-575' (13) - Bevier 548.5-550.5' (9) - Mulky 477-481' (17)
Completions	Spud Date: 1/4/06 RV Completion: 1/16/06 - 400 gals 15% HCl - 16.5 BPM - 400# 20/40 - 371 bbls BCFJ Completion: 1/16/06 - 500 gals 15% HCl - 14.5 BPM - 5,500# 20/40 - 660 bbls SM Completion: 1/16/06 - 400 gals 15% HCl - 15.5 BPM - 2,150# 20/40 - 526 bbls

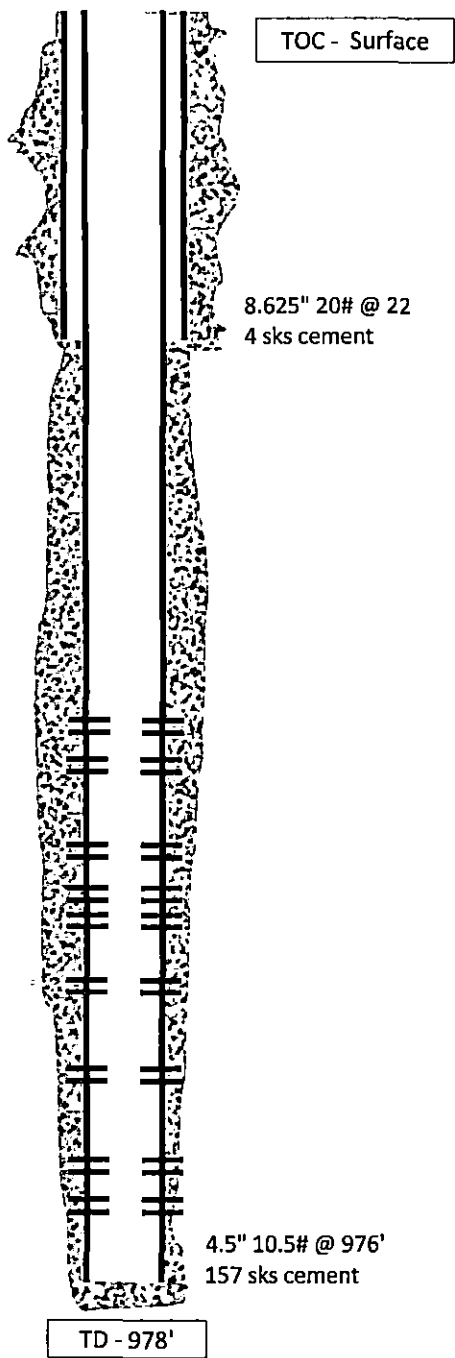

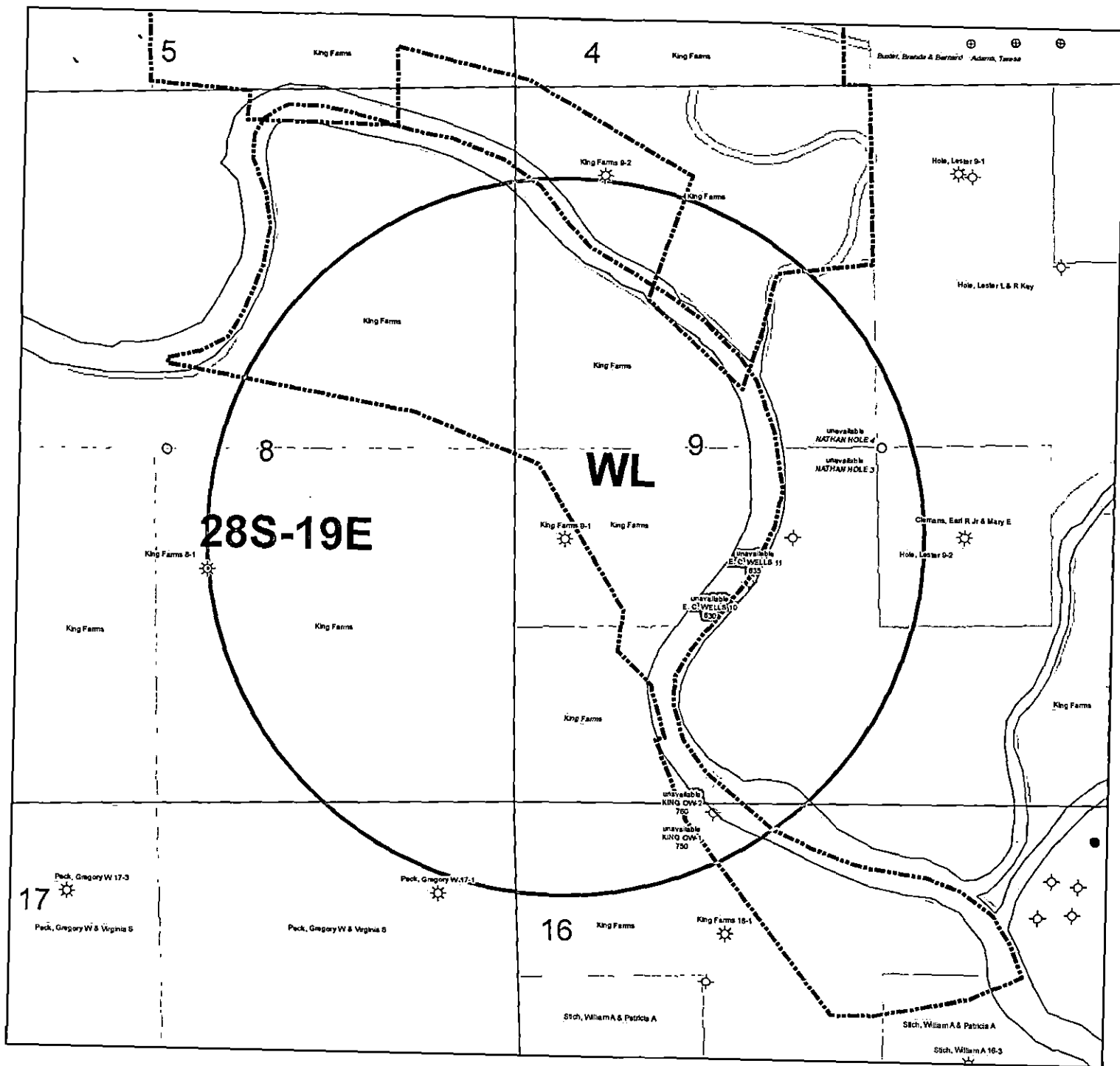

KGS STATUS	
◇	DA/PA
⊙	EOR
☆	GAS
△	INJ/SWD
●	OIL
⊛	OIL/GAS
○	OTHER

King Farms 9-1
 9-28S-19E
 1" = 1,000'

	A	B	C	D	E	F	G	H	I	J	K
1	Produced Fluids #		1	2	3	4	5		Click here to run SSP Goal Seek SSP Click		
2	Parameters	Units	Input	Input	Input	Input	Input				
3	Select the brines	Select fluid by checking the box(es),	<input type="checkbox"/>	<input type="checkbox"/>	<input type="checkbox"/>	<input type="checkbox"/>	<input type="checkbox"/>	Mixed brine:			
4	Sample ID	Row 3	PostRock	PostRock	PostRock	PostRock	PostRock	Cell H28 is			
5	Date	3/19/2012	3/4/2012	3/14/2012	1/20/2012	1/20/2012	1/20/2012	STP calc. pH.			
6	Operator	Ward Feed	Ward Feed	Clinesmith	Clinesmith	Clinesmith	Clinesmith	Cells H35-38			
7	Well Name	#34-1	#4-1	#5-4	#1	#2		are used in			
8	Location	CBM	CBM	Bartles	Bartles	Bartles		mixed brines			
9	Field							calculations.			
10	Na ⁺	(mg/l)*	19,433.00	27,381.00	26,534.00	25689.00	24220.00	24654.20	Initial(BH)	Final(WH)	S/RSR
11	K ⁺ (If not known =0)	(mg/l)						0.00	Saturation Index values		(Final-Initial)
12	Mg ²⁺	(mg/l)	1,096.00	872.00	1,200.00	953.00	858.00	995.91	Calcite		
13	Ca ²⁺	(mg/l)	1,836.00	2,452.00	2,044.00	1920.00	1948.00	2040.23	-0.73	-0.60	0.13
14	Sr ²⁺	(mg/l)						0.00	Barite		
15	Ba ²⁺	(mg/l)						0.00			
16	Fe ²⁺	(mg/l)	40.00	21.00	18.00	82.00	90.00	50.21	Halite		
17	Zn ²⁺	(mg/l)						0.00	-1.77	-1.80	-0.03
18	Pb ²⁺	(mg/l)						0.00	Gypsum		
19	Cl ⁻	(mg/l)	36,299.00	48,965.00	47,874.00	45632.00	43147.00	44388.44	-3.19	-3.18	0.00
20	SO ₄ ²⁻	(mg/l)	1.00	1.00	8.00	1.00	1.00	2.40	Hemihydrate		
21	F ⁻	(mg/l)						0.00	-3.96	-3.90	0.06
22	Br ⁻	(mg/l)						0.00	Anhydrite		
23	SiO ₂	(mg/l) SiO ₂						0.00	-3.47	-3.36	0.12
24	HCO ₃ Alkalinity**	(mg/l as HCO ₃)	190.00	234.00	259.00	268.00	254.00	241.03	Celestite		
25	CO ₃ Alkalinity	(mg/l as CO ₃)									
26	Carboxylic acids**	(mg/l)						0.00	Iron Sulfide		
27	Ammonia	(mg/L) NH ₃						0.00	-0.16	-0.22	-0.06
28	Borate	(mg/L) H ₃ BO ₃						0.00	Zinc Sulfide		
29	TDS (Measured)	(mg/l)						72781			
30	Calc. Density (STP)	(g/ml)	1.038	1.051	1.050	1.048	1.045	1.047	Calcium Fluoride		
31	CO ₂ Gas Analysis	(%)	19.97	18.76	22.41	35.53	33.79	26.16			
32	H ₂ S Gas Analysis***	(%)	0.0289	0.0292	0.0296	0.0306	0.0151	0.0269	Iron Carbonate		
33	Total H ₂ Saq	(mgH ₂ S/l)	1.00	1.00	1.00	1.00	0.50	0.90	-0.74	-0.51	0.23
34	pH, measured (STP)	pH	5.67	5.76	5.72	5.54	5.55	5.63	Inhibitor needed (mg/L)		
35	Choose one option to calculate SI?	0-CO ₂ %+Alk, 1-pH+Alk, 2-CO ₂ %+pH	0	0	0	0	0		Calcite	NTMP	
36	Gas/day(thousand cf/day)	(Mcf/D)						0	0.00	0.00	
37	Oil/Day	(B/D)	0	0	1	1	1	4	Barite	BHPMP	
38	Water/Day	(B/D)	100	100	100	100	100	500	0.00	0.00	
39	For mixed brines, enter values for temperatures and pressures - in Cells (H40-H43)								(Enter H40-H43)		pH
40	Initial T	(F)	66.0	71.0	70.0	41.0	49.0	60.0	5.69	5.60	
41	Final T	(F)	66.0	71.0	70.0	41.0	49.0	89.0	Viscosity (CentiPoise)		
42	Initial P	(psia)	25.0	25.0	25.0	25.0	25.0	25.0	1.196	0.826	
43	Final P	(psia)	25.0	25.0	25.0	25.0	25.0	120.0	Heat Capacity (cal/ml°C)		
44	Use TP on Calcite sheet?	1-Yes;0-No							0.955	0.959	
45	API Oil Grav.	API grav.						30.00	Inhibitor needed (mg/L)		
46	Gas Sp.Grav.	Sp.Grav.						0.60	Gypsum	HDTMP	
47	MeOH/Day	(B/D)	0					0	0.00	0.00	
48	MEG/Day	(B/D)	0					0	Anhydrite	HDTMP	
49	Conc. Multiplier								0.00	0.00	
50	H ⁺ (Strong acid) †	(N)									
51	OH ⁻ (Strong base) †	(N)									
52	Quality Control Checks at STP:										
53	H ₂ S Gas	(%)									
54	Total H ₂ Saq (STP)	(mgH ₂ S/l)									
55	pH Calculated	(pH)									
56	PCO ₂ Calculated	(%)									
57	Alkalinity Calculated	(mg/l) as HCO ₃									
58	ECations=	(equiv./l)									
59	EAnions=	(equiv./l)									
60	Calc TDS=	(mg/l)									
61	Inhibitor Selection	Input	Unit	#	Inhibitor	Unit Converter (From metric to English)					
62	Protection Time	120	min	1	NTMP	From Unit	Value	To Unit	Value		
63	Have SealSoftPitzer			2	BHPMP	°C	80	°F	176		
64	pick inhibitor for you?	1	1-Yes;0-No	3	PAA	m ³	100	ft ³	3,531		
65	If No, inhibitor # is:	4	#	4	DTPMP	m ³	100	bb(42 US gal)	629		
66	If you select Mixed,			5	PPCA	MPa	1,000	psia	145,074		
67	1 st inhibitor # is:	1	#	6	SPA	Bar	496	psia	7,194		
68	% of 1 st inhibitor is:	50	%	7	HEDP	Torr	10,000	psia	193		
69	2 nd inhibitor # is:	2	#	8	HDTMP	Gal	10,000	bb(42 US gal)	238		
70	Display act. coeffs?	0	1-Yes;0-No	9	Average	Liters	10,000	bb(42 US gal)	63		
71				10	Mixed						

Saturation Index Calculations

Champion Technologies, Inc.

(Based on the Tomson-Oddo Model)

Brine 1: Ward Feed Yard 34-1

Brine 2: Ward Feed Yard 4-1

Brine 3: Clinesmith 5-4

Brine 4: Clinesmith 1

Brine 5: Clinesmith 2

Component (mg/L)	Ratio					Mixed Brine
	20% Brine 1	20% Brine 2	20% Brine 3	20% Brine 4	20 Brine 5	
Calcium	1836	2452	2044	1920	1948	1952
Magnesium	1096	872	1200	953	858	865
Barium	0	0	0	0	0	0
Strontium	0	0	0	0	0	0
Bicarbonate	190	234	259	268	254	253
Sulfate	1	1	8	1	1	1
Chloride	36299	48965	47874	45632	43147	43206
CO ₂ in Brine	246	220	264	422	405	401
Ionic Strength	1.12	1.48	1.46	1.38	1.31	1.31
Temperature (°F)	89	89	89	89	89	89
Pressure (psia)	50	50	120	120	120	119

Saturation Index

Calcite	-1.71	-1.41	-1.48	-1.68	-1.69	-1.69
Gypsum	-3.71	-3.64	-2.82	-3.73	-3.72	-3.69
Hemihydrate	-3.70	-3.65	-2.83	-3.74	-3.71	-3.69
Anhydrite	-3.89	-3.79	-2.97	-3.89	-3.88	-3.85
Barite	N/A	N/A	N/A	N/A	N/A	N/A
Celestite	N/A	N/A	N/A	N/A	N/A	N/A

PTB

Calcite	N/A	N/A	N/A	N/A	N/A	N/A
Gypsum	N/A	N/A	N/A	N/A	N/A	N/A
Hemihydrate	N/A	N/A	N/A	N/A	N/A	N/A
Anhydrite	N/A	N/A	N/A	N/A	N/A	N/A
Barite	N/A	N/A	N/A	N/A	N/A	N/A
Celestite	N/A	N/A	N/A	N/A	N/A	N/A

KANSAS CORPORATION COMMISSION
OIL & GAS CONSERVATION DIVISION

ORIGINAL

Form ACO-1
September 1999
Form Must Be Typed

WELL COMPLETION FORM
WELL HISTORY - DESCRIPTION OF WELL & LEASE

Operator: License # 33344
 Name: Quest Cherokee, LLC
 Address: 211 W. 14th Street
 City/State/Zip: Chanute, KS 66720
 Purchaser: Bluestem Pipeline, LLC
 Operator Contact Person: Gary Laswell
 Phone: (620) 431-9500
 Contractor: Name: Well Refined Drilling Company
 License: 33072
 Wellsite Geologist: Ken Recoy
 Designate Type of Completion:
 New Well Re-Entry Workover
 Oil SWD SLOW Temp. Abd.
 Gas ENHR SIGW
 Dry Other (Core, WSW, Expl., Cathodic, etc)
 If Workover/Re-entry: Old Well Info as follows:
 Operator: _____
 Well Name: _____
 Original Comp. Date: _____ Original Total Depth: _____
 Deepening Re-perf. Conv. to Enhr./SWD
 Plug Back _____ Plug Back Total Depth _____
 Commingled _____ Docket No. _____
 Dual Completion _____ Docket No. _____
 Other (SWD or Enhr.?) _____ Docket No. _____

1/4/06	1/6/06	1/11/06
Spud Date or Recompletion Date	Date Reached TD	Completion Date or Recompletion Date

API No. 15 - 133-26371 - 0020
 County: Neosho
 _____ w/2 _____ nw _____ sw _____ Sec. 9 Twp. 28 S. R. 19 East West
1980 feet from (S) N (circle one) Line of Section
360 feet from (SE) W (circle one) Line of Section
 Footages Calculated from Nearest Outside Section Corner:
 (circle one) NE (SE) NW SW
 Lease Name: King Farms Well #: 9-1
 Field Name: Cherokee Basin CBM
 Producing Formation: Multiple
 Elevation: Ground: 902 Kelly Bushing: n/a
 Total Depth: 978 Plug Back Total Depth: 975.37
 Amount of Surface Pipe Set and Cemented at 21' 8" Feet
 Multiple Stage Cementing Collar Used? Yes No
 If yes, show depth set _____ Feet
 If Alternate II completion, cement circulated from 975.37
 feet depth to Surface w/ 146 _____ sx cmt.
Drilling Fluid Management Plan
 (Data must be collected from the Reserve Pit)
 Chloride content _____ ppm Fluid volume _____ bbls
 Dewatering method used _____
 Location of fluid disposal if hauled offsite: _____
 Operator Name: _____
 Lease Name: _____ License No.: _____
 Quarter _____ Sec. _____ Twp. _____ S. R. _____ East West
 County: _____ Docket No.: _____

INSTRUCTIONS: An original and two copies of this form shall be filed with the Kansas Corporation Commission, 130 S. Market - Room 2078, Wichita, Kansas 67202, within 120 days of the spud date, recompletion, workover or conversion of a well. Rule 82-3-130, 82-3-106 and 82-3-107 apply. Information of side two of this form will be held confidential for a period of 12 months if requested in writing and submitted with the form (see rule 82-3-107 for confidentiality in excess of 12 months). One copy of all wireline logs and geologist well report shall be attached with this form. ALL CEMENTING TICKETS MUST BE ATTACHED. Submit CP-4 form with all plugged wells. Submit CP-111 form with all temporarily abandoned wells.

All requirements of the statutes, rules and regulations promulgated to regulate the oil and gas industry have been fully complied with and the statements herein are complete and correct to the best of my knowledge.

Signature: [Signature]
 Title: Head of Operations Date: 5/2/06
 Subscribed and sworn to before me this 2nd day of May
 20 06.
 Notary Public: [Signature]
 Date Commission Expires: July 30, 2009

KCC Office Use ONLY

NO Letter of Confidentiality Received
 If Denied, Yes Date: _____
YES Wireline Log Received
YES Geologist Report Received
 _____ UIC Distribution

JENNIFER R. AMMANN
 Notary Public - State of Kansas
 My Appt. Expires 7-30-09

Operator Name: Quest Cherokee, LLC Lease Name: King Farms Well #: 9-1
 Sec. 9 Twp. 28 S. R. 19 East West County: Neosho

INSTRUCTIONS: Show important tops and base of formations penetrated. Detail all cores. Report all final copies of drill stems tests giving interval tested, time tool open and closed, flowing and shut-in pressures, whether shut-in pressure reached static level, hydrostatic pressures, bottom hole temperature, fluid recovery, and flow rates if gas to surface test, along with final chart(s). Attach extra sheet if more space is needed. Attach copy of all Electric Wireline Logs surveyed. Attach final geological well site report.

Drill Stem Tests Taken Yes No
 (Attach Additional Sheets)
 Samples Sent to Geological Survey Yes No
 Cores Taken Yes No
 Electric Log Run Yes No
 (Submit Copy)

Log Formation (Top), Depth and Datum Sample
 Name Top Datum
 See Attached

RECEIVED
KANSAS CORPORATION COMMISSION
MAY 03 2006
CONSERVATION DIVISION
WICHITA, KS

List All E. Logs Run:
 Comp. Density/Neutron Log
 Dual Induction Log
 Gamma Ray/Neutron Log

CASING RECORD <input type="checkbox"/> New <input type="checkbox"/> Used							
Report all strings set-conductor, surface, intermediate, production, etc.							
Purpose of String	Size Hole Drilled	Size Casing Set (In O.D.)	Weight Lbs. / Ft.	Setting Depth	Type of Cement	# Sacks Used	Type and Percent Additives
Surface	12-1/4"	8-5/8"	20#	21' 8"	"A"	4	
Production	6-3/4"	4-1/2"	10.5#	975.37	"A"	146	

ADDITIONAL CEMENTING / SQUEEZE RECORD				
Purpose:	Depth Top Bottom	Type of Cement	#Sacks Used	Type and Percent Additives
<input type="checkbox"/> Perforate				
<input type="checkbox"/> Protect Casing				
<input type="checkbox"/> Plug Back TD				
<input type="checkbox"/> Plug Off Zone				

Shots Per Foot	PERFORATION RECORD - Bridge Plugs Set/Type Specify Footage of Each Interval Perforated	Acid, Fracture, Shot, Cement Squeeze Record (Amount and Kind of Material Used)	Depth
4	863-867/813-815/715-717/611-613/576-578/572-575	400gal 15% HCl w/ 34 bbls 2% iod water, 37 bbls water w/ 2% KCl, Blocks 4008 2040 sand	863-867/813-815
4	548.5-550.5/477-481/464-468	500gal 15% HCl w/ 50 bbls 2% iod water, 600bbls water w/ 2% KCl, Blocks 6508 2040 sand	715-717/611-613
			576-578/572-575
			548.5-550.5
		400gal 15% HCl w/ 50 bbls 2% iod water, 628bbls water w/ 2% KCl, Blocks 21508 2040 sand	477-481/464-468

TUBING RECORD		Size	Set At	Packer At	Liner Run
		2-3/8"	904	n/a	<input type="checkbox"/> Yes <input checked="" type="checkbox"/> No
Date of First, Resumed Production, SWD or Enhr.		Producing Method			
2/27/06		<input type="checkbox"/> Flowing <input checked="" type="checkbox"/> Pumping <input type="checkbox"/> Gas Lift <input type="checkbox"/> Other (Explain)			
Estimated Production Per 24 Hours	Oil Bbls.	Gas Mcf	Water Bbls.	Gas-Oil Ratio	Gravity
	n/a	16.5mcf	89.9bbls		

Disposition of Gas Vented Sold Used on Lease (If vented, Submit ACO-18.)

METHOD OF COMPLETION Open Hole Perf. Dually Comp. Commingled Other (Specify) _____

Production Interval _____

BEFORE THE STATE CORPORATION COMMISSION OF THE STATE OF KANSAS
NOTICE OF FILING APPLICATION

RE: In the Matter of Postrock Midcontinent Production, LLC Application for Commingling of Production in the King Farms B-1 located in Neosho County, Kansas.

TO: All Oil & Gas Producers, Unleased Mineral Interest Owners, Landowners, and all persons whomsoever concerned.

You, and each of you, are hereby notified that Postrock Midcontinent Production, LLC has filed an application to commingle the Riverton, Rowe, Bluejacket, Fleming, Croweburg, Bevier, Mulky, Summit and Cattleman producing formations at the King Farms B-1, located in the NE SW NW SW, S8-T28S-R10E, Approximately 1027 FSL & 388 FEL, Neosho County, Kansas.

Any persons who object to or protest this application shall be required to file their objections or protest with the Conservation Division of the State Corporation Commission of the State of Kansas within fifteen (15) days from the date of this publication. These protests shall be filed pursuant to Commission regulations and must state specific reasons why granting the application may cause waste, violate correlative rights or pollute the natural resources of the State of Kansas.

All persons interested or concerned shall take notice of the foregoing and shall govern themselves accordingly. All person and/or companies wishing to protest this application are required to file a written protest with the Conservation Division of the Kansas Oil and Gas Commission.

Upon the receipt of any protest, the Commission will convene a hearing and protestants will be expected to enter an appearance either through proper legal counsel or as individuals, appearing on their own behalf.

Postrock Midcontinent Production, LLC
210 Park Avenue, Suite 2750
Oklahoma City, Oklahoma 73102
(405) 660-7704

A COPY OF THE AFFIDAVIT OF PUBLICATION MUST ACCOMPANY ALL APPLICATIONS

Affidavit of Publication

STATE OF KANSAS, NEOSHO COUNTY, ss:
Rhonda Howerter, being first duly sworn, deposes and says: That *she* is *Classified Manager* of *THE CHANUTE TRIBUNE*, a daily newspaper printed in the State of Kansas, and published in and of general circulation in Neosho County, Kansas, with a general paid circulation on a daily basis in Neosho County, Kansas, and that said newspaper is not a trade, religious or fraternal publication.

Said newspaper is a daily published at least weekly 50 times a year: has been so published continuously and uninterruptedly in said county and state for a period of more than five years prior to the first publication of said notice; and has been admitted at the post office of Chanute, in said county as second class matter.

That the attached notice is a true copy thereof and was published in the regular and entire issue of said newspaper for 1 consecutive time, the first publication thereof being made as aforesaid on the 16 day of June 2012, with subsequent publications being made on the following dates:

_____, 2012 _____, 2012
_____, 2012 _____, 2012

Rhonda Howerter

Subscribed and sworn to and before me this 19 day of June, 2012

[Signature]

Notary Public

My commission expires: January 9, 2015
Printer's Fee \$ 70.14
Affidavit, Notary's Fee \$ 3.00
Additional Copies \$ _____
Total Publication Fees \$ 73.14

 SHANNA L. GUIOT
Notary Public - State of Kansas
My Appt. Expires 1-9-15

AFFIDAVIT

STATE OF KANSAS \
- SS.
County of Sedgwick /

Mark Fitchall, of lawful age, being first duly sworn, deposeth and saith: That he is Record Clerk of The Wichita Eagle, a daily newspaper published in the City of Wichita, County of Sedgwick, State of Kansas, and having a general paid circulation on a daily basis in said County, which said newspaper has been continuously and uninterruptedly published in said County for more than one year prior to the first publication of the notice hereinafter mentioned, and which said newspaper has been entered as second class mail matter at the United States Post Office in Wichita, Kansas, and which said newspaper is not a trade, religious or fraternal publication and that a notice of a true copy is hereto attached was published in the regular and entire Morning issue of said The Wichita Eagle for 1 issues, that the first publication of said notice was

made as aforesaid on the 18th of

June A.D. 2012, with

subsequent publications being made on the following dates:

And affiant further says that he has personal knowledge of the statements above set forth and that they are true.

Mark Fitchall

Subscribed and sworn to before me this

18th day of June, 2012

PENNY L. CASE
Notary Public - State of Kansas
My Appt. Expires *5/20/2015*

Penny L Case

Notary Public Sedgwick County, Kansas

Printer's Fee : \$132.40

LEGAL PUBLICATION
PUBLISHED IN THE WICHITA EAGLE
JUNE 18, 2012 (3197262)
BEFORE THE STATE CORPORATION
COMMISSION OF THE STATE
OF KANSAS
NOTICE OF FILING APPLICATION
RE: In the Matter of Postrock Midcontinent
Production, LLC Application for
Commencing of Production in the King
Farms 9-1 located in Neosho County,
Kansas.
TO: All Oil & Gas Producers, Unleased
Mineral Interest Owners, Landowners,
and all persons whomsoever concerned.
You, and each of you, are hereby notified
that Postrock Midcontinent Production
LLC has filed an application for commingle
the Riverton, Rowe, Bluejacket, Fleming,
Croweburg, Beaver, Mulky, Summit and
Cattleman producing formations of the King
Farms 9-1, located in the NE SW NW SW
S9-T28S-R19E, Approximately 1927 FSL &
386.FEL, Neosho County, Kansas.
Any persons who object to or protest
this application shall be required to file their
objections or protest with the Conservation
Division of the State Corporation
Commission of the State of Kansas within
fifteen (15) days from the date of this
publication. These protests shall be filed
pursuant to Commission regulations and
must state specific reasons why granting
the application may cause waste, violate
correlative rights or pollute the natural
resources of the State of Kansas.
All persons interested or concerned
shall take notice of the foregoing and shall
govern themselves accordingly. All person
and/or companies wishing to protest this
application are required to file a written
protest with the Conservation Division of the
Kansas Oil and Gas Commission.
Upon the receipt of any protest, the
Commission will convene a hearing and
protestants will be expected to enter an
appearance, either through proper legal
counsel or as individuals, appearing on their
own behalf.
Postrock Midcontinent Production, LLC
210 Park Avenue, Suite 2750
Oklahoma City, Oklahoma 73102
(405) 660-7709

Affidavit of Notice Served

Re: Application for: APPLICATION FOR COMMINGLING OF PRODUCTION OR FLUIDS - ACO-4

Well Name: KING FARMS 9-1 Legal Location: NESWNWSW S9-T28S-R19E

The undersigned hereby certifies that he / she is a duly authorized agent for the applicant, and that on the day 29th of JUNE, 2012, a true and correct copy of the application referenced above was delivered or mailed to the following parties:

Note: A copy of this affidavit must be served as a part of the application.

Name

Address (Attach additional sheets if necessary)

JOHN & DOROTHY LARUE

11400 190TH RD, CHANUTE, KS 66720

I further attest that notice of the filing of this application was published in the CHANUTE TRIBUNE, the official county publication of NEOSHO county. A copy of the affidavit of this publication is attached.

Signed this 29th day of JUNE, 2012

Quincy R. Beal
Applicant for Duly Authorized Agent

Subscribed and sworn to before me this 29th day of JUNE, 2012

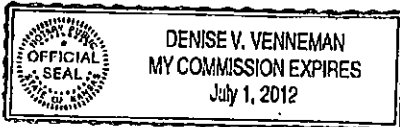

Denise V. Venneman
Notary Public

My Commission Expires: 7-1-12

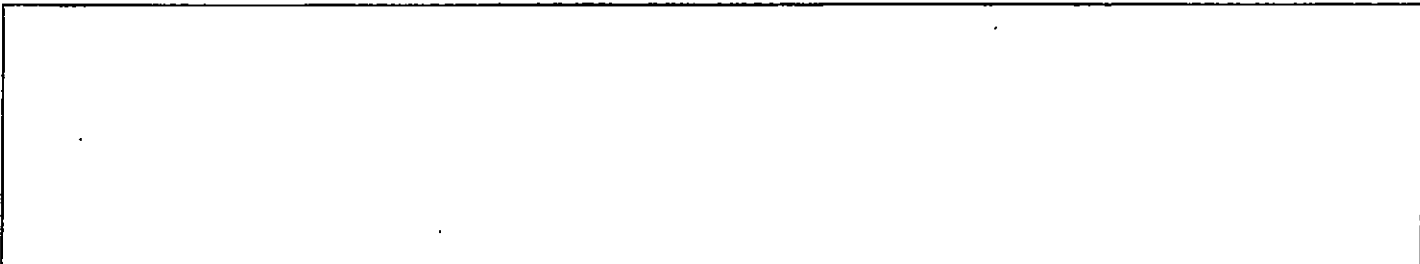

KING FARMS 9-1 - APPLICATION FOR COMMINGLING OF PRODUCTION OR FLUIDS

Offset Operators, Unleased Mineral Owners and Landowners acreage
(Attach additional sheets if necessary)

Name:

Legal Description of Leasehold:

JOHN & DOROTHY LARUE

LOT 10, AKA SWSE W OF RIVER S9-T28S-R19E

JOHN & DOROTHY LARUE

N OF RIVER IN C OF N2 S16-T28S-R19E

I hereby certify that the statements made herein are true and correct to the best of my knowledge and belief.

Justin R. Beal
Applicant or Duly Authorized Agent

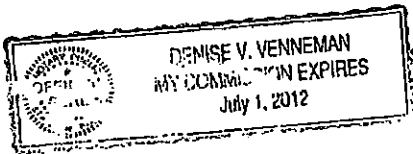

Subscribed and sworn before me this 29th day of JUNE, 2012

Denise V. Venneman
Notary Public

My Commission Expires: 7-1-12

Conservation Division
Finney State Office Building
130 S. Market, Rm. 2078
Wichita, KS 67202-3802



Phone: 316-337-6200
Fax: 316-337-6211
<http://kcc.ks.gov/>

Mark Sievers, Chairman
Thomas E. Wright, Commissioner

Sam Brownback, Governor

July 16, 2012

Clark Edwards
PostRock-Midcontinent Production LLC
Oklahoma Tower
210 Park Ave, Ste 2750
Oklahoma City, OK 73102

RE: Approved Commingling CO071216
King Farms 9-1, Sec.9-T28S-R19E, Neosho County
API No. 15-133-26371-00-00

Dear Mr. Edwards:

Your Application for Commingling (ACO-4) for the above described well, received by the KCC on July 2, 2012, has been reviewed and approved by the Kansas Corporation Commission (KCC) per K.A.R. 82-3-123. Notice was examined and found to be proper per K.A.R. 82-3-135a. No protest had been filed within the 15-day protest period.

Based upon the depth of the Riverton formation perforations, total oil production shall not exceed 100 BOPD and total gas production shall not exceed 50% of the absolute open flow (AOF).

File form ACO-1 upon re-completion of the well to commingle.

Commingling ID number CO071216 has been assigned to this approved application. Use this number for well completion reports (ACO-1) and other correspondence that may concern this approved commingling.

Sincerely,

Rick Hestermann
Production Department