



KANSAS CORPORATION COMMISSION 1084892
OIL & GAS CONSERVATION DIVISION

Form ACO-4
Form must be typed
March 2009

APPLICATION FOR COMMINGLING OF **Commingling ID # CO071223**
PRODUCTION (K.A.R. 82-3-123) OR FLUIDS (K.A.R. 82-3-123a)

OPERATOR: License # 33343
Name: PostRock Midcontinent Production LLC
Address 1: Oklahoma Tower
Address 2: 210 Park Ave, Ste 2750
City: OKLAHOMA CITY State: OK Zip: 73102 +
Contact Person: CLARK EDWARDS
Phone: (620) 432-4200

API No. 15 - 15-099-24254-00-00
Spot Description: _____
SW NE NE NW Sec. 22 Twp. 32 S. R. 18 East West
598 Feet from North / South Line of Section
2291 Feet from East / West Line of Section
County: Labette
Lease Name: ALLMON, MICHAEL JOE Well #: 22-1

1. Name and upper and lower limit of each production interval to be commingled:
- | | |
|-----------------------------|-------------------------|
| Formation: <u>RIVERTON</u> | (Perfs): <u>945-947</u> |
| Formation: <u>TEBO</u> | (Perfs): <u>731-733</u> |
| Formation: <u>FLEMING</u> | (Perfs): <u>641-643</u> |
| Formation: <u>CROWEBURG</u> | (Perfs): <u>609-612</u> |
| Formation: <u>BEVIER</u> | (Perfs): <u>576-578</u> |

2. Estimated amount of fluid production to be commingled from each interval:
- | | | | |
|-----------------------------|----------------|--------------------|-------------------|
| Formation: <u>RIVERTON</u> | BOPD: <u>0</u> | MCFPD: <u>2.14</u> | BWPD: <u>5.71</u> |
| Formation: <u>TEBO</u> | BOPD: <u>0</u> | MCFPD: <u>2.14</u> | BWPD: <u>5.71</u> |
| Formation: <u>FLEMING</u> | BOPD: <u>0</u> | MCFPD: <u>2.14</u> | BWPD: <u>5.71</u> |
| Formation: <u>CROWEBURG</u> | BOPD: <u>0</u> | MCFPD: <u>2.14</u> | BWPD: <u>5.71</u> |
| Formation: <u>BEVIER</u> | BOPD: <u>0</u> | MCFPD: <u>2.14</u> | BWPD: <u>5.71</u> |

3. Plat map showing the location of the subject well, all other wells on the subject lease, and all wells on offsetting leases within a 1/2 mile radius of the subject well, and for each well the names and addresses of the lessee of record or operator.
4. Signed certificate showing service of the application and affidavit of publication as required in K.A.R. 82-3-135a.

For Commingling of PRODUCTION ONLY, include the following:

5. Wireline log of subject well. Previously Filed with ACO-1: Yes No
6. Complete Form ACO-1 (*Well Completion form*) for the subject well.

For Commingling of FLUIDS ONLY, include the following:

7. Well construction diagram of subject well.
8. Any available water chemistry data demonstrating the compatibility of the fluids to be commingled.

AFFIDAVIT: I am the affiant and hereby certify that to the best of my current information, knowledge and personal belief, this request for commingling is true and proper and I have no information or knowledge, which is inconsistent with the information supplied in this application.

Submitted Electronically

KCC Office Use Only	
<input type="checkbox"/> Denied	<input checked="" type="checkbox"/> Approved
15-Day Periods Ends: <u>7/14/2012</u>	
Approved By: <u>Rick Hestermann</u>	Date: <u>07/16/2012</u>

Protests may be filed by any party having a valid interest in the application. Protests must be in writing and comply with K.A.R. 82-3-135b and must be filed within 15 days of publication of the notice of application.



PostRock

Wellbore Schematic

WELL: Allmon, Michael Joe 22-1
 SSI: 618130
 API: 15-099-24254-00-00
 LOCATION: NE NW Sec. 22-32S-18E
 COUNTY: Labette
 STATE: Kansas

Casing	8.625" @ 20' 5.5" 15.5# J-55, 4.95" ID w/ 0.0238 bbl/ft capacity @ 1054'
Perforations	No Data found on perms of original comp rec. Revised perms: 5/25/2011 - Riverton 945-947 - Tebo 731-733 - Fleming 641-643 - Croweburg 609-612 - Bevier 576-578 - Mulky 533-538
Completions	Spud Date: 1/25/2008 Completion Date: 5/26/2011 Riverton: - 2400# 20/40 - 400 gal 15% - 677 bbls - 12 bpm Tebo/Flem/Crowe/Bevier: - 13800# 20/40 - 400 gal 15% - 1769 bbls - 14 bpm Mulky: - 17600# 20/40 - 300 gal 15% - 883 bbls - 19 bpm Summit: - 11100# 20/40 - 400 gal 15% - 740 bbls - 19 bpm

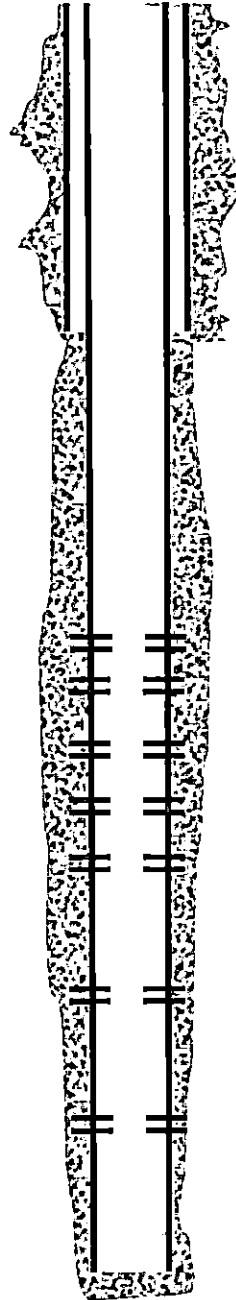

TOC - Surface

8.625" @ 20'
5 sks cement

5.5" 16# @ 1054'
145 sks cement

TD - 1077'

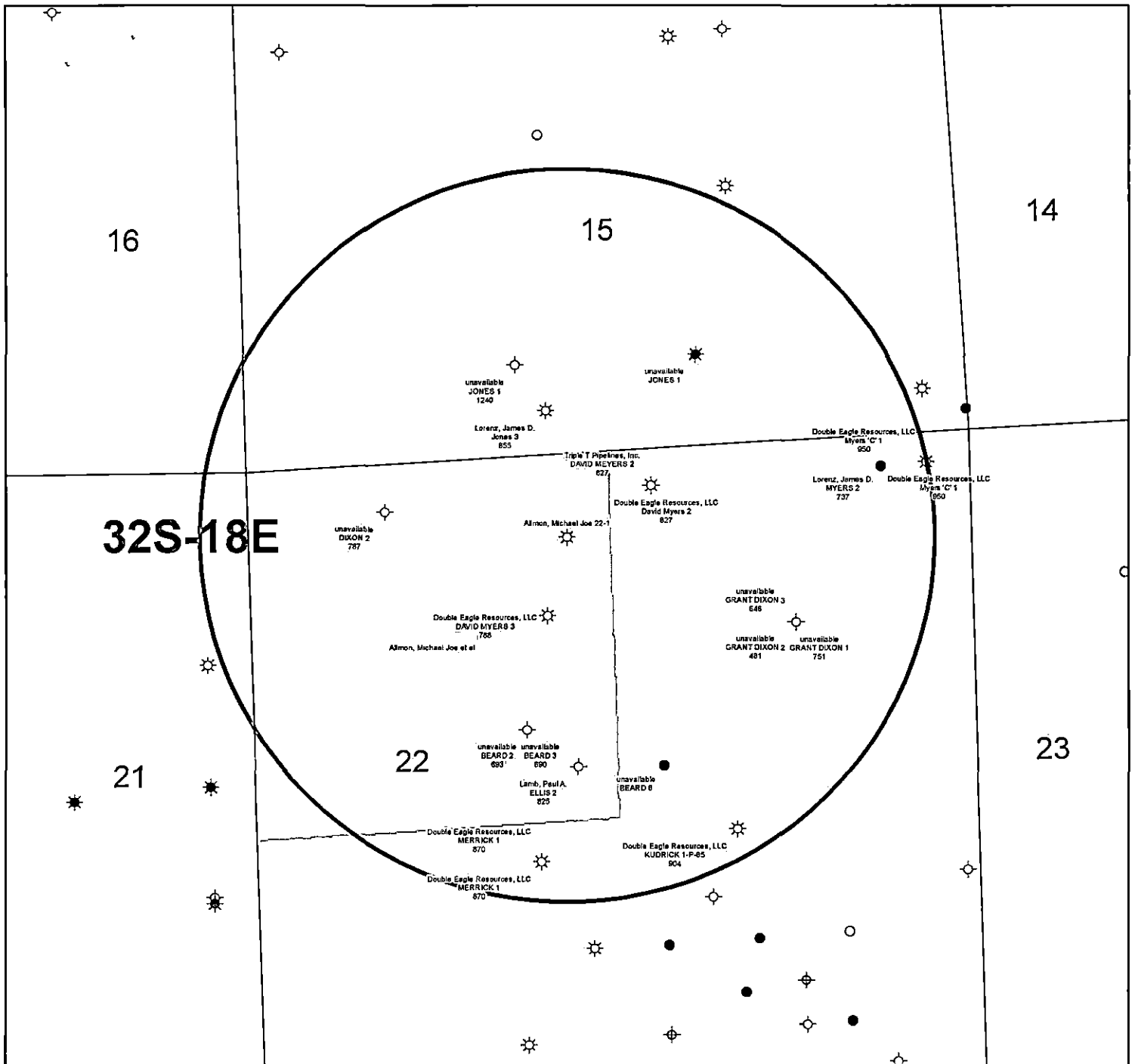

32S-18E

KGS STATUS	
◇	DAPA
⊙	EOR
☀	GAS
△	INJ/SWD
●	OIL
★	OIL/GAS
○	OTHER

Allmon, Michael Joe 22-1
22-32S-18E
1" = 1,000'

Affidavit of Publication

STATE OF KANSAS, LABETTE COUNTY, ss:
Kim Root, being first duly sworn,
 deposes and says: That *she* is *Classified Manager*
 of *PARSONS SUN*, a daily newspaper printed in the State
 of Kansas, and published in and of general circulation in
 Labette County, Kansas, with a general paid circulation
 on a daily basis in Labette County, Kansas, and that said
 newspaper is not a trade, religious or fraternal publication

Said newspaper is a daily published at least weekly 50
 times a year: has been so published continuously and unin-
 terruptedly in said county and state for a period of more
 than five years prior to the first publication of said notice;
 and has been admitted at the post office of Parsons, in said
 county as second class matter.

That the attached notice is a true copy thereof and was
 published in the regular and entire issue of said newspa-
 per for 1 consecutive day, the first publication
 thereof being made as aforesaid on the 19 day of
June 2012, with subsequent publications being made
 on the following dates:

_____, 2012 _____, 2012

_____, 2012 _____, 2012

Kim Root

Subscribed and sworn to and before me this 19
 day of June, 2012

[Signature]

 Notary Public

My commission expires: January 9, 2015
 Printer's Fee \$ 68.07
 Affidavit, Notary's Fee \$ 3.00
 Additional Copies \$ _____
 Total Publication Fees \$ 71.07

SHANNA L. GUIOT
 Notary Public - State of Kansas
 My Appl. Expires 1-9-15

LEGAL

(Published in the Parsons Sun
 June 19, 2012)
 BEFORE THE STATE CORPORATION
 COMMISSION
 OF THE STATE OF KANSAS
 NOTICE OF FILING APPLICATION
 RE: In the Matter of Postrock Midconti-
 nent Production, LLC Application for
 Commingling of Production in the Al-
 mon, Michael Joe 22-1 located in La-
 bette County, Kansas.
 TO: All Oil & Gas Producers, Unleased
 Mineral Interest Owners, Landowners,
 and all persons whomsoever concerned.
 You, and each of you, are hereby noti-
 fied that Postrock Midcontinent Pro-
 duction, LLC has filed an application to com-
 mingle the Riverton, Tebo, Fleming,
 Croweburg, Beaver, Mulky, Summit and
 Cattleman producing formations at the
 Almon, Michael Joe 22-1, located in the
 SW NE NE NW S22-T32S-R18E, Ap-
 proximately 698 FNL & 2291 FWL, La-
 bette County, Kansas.
 Any persons who object to or protest this
 application shall be required to file their
 objections or protest with the Conserva-
 tion Division of the State Corporation
 Commission of the State of Kansas
 within fifteen (15) days from the date of
 this publication. These protests shall be
 filed pursuant to Commission regulations
 and must state specific reasons why
 granting the application may cause
 waste, violate correlative rights or pollute
 the natural resources of the State of
 Kansas.
 All persons interested or concerned shall
 take notice of the foregoing and shall
 govern themselves accordingly. All per-
 son and/or companies wishing to protest
 this application are required to file a writ-
 ten protest with the Conservation Divi-
 sion of the Kansas Oil and Gas Commis-
 sion.
 Upon the receipt of any protest, the
 Commission will convene a hearing and
 protestants will be expected to enter an
 appearance either through proper legal
 counsel or as individuals, appearing on
 their own behalf.
 Postrock Midcontinent Production, LLC
 210 Park Avenue, Suite 2750
 Oklahoma City, Oklahoma 73102
 (405) 860-7704

**KANSAS CORPORATION COMMISSION
OIL & GAS CONSERVATION DIVISION
WELL COMPLETION FORM
WELL HISTORY - DESCRIPTION OF WELL & LEASE**

Form ACO-1
September 1999
Form Must Be Typed

Operator: License # 33344
 Name: Quest Cherokee, LLC
 Address: 211 W. 14th Street
 City/State/Zip: Chanute, KS 66720
 Purchaser: Bluestem Pipeline, LLC
 Operator Contact Person: Jennifer R. Smith
 Phone: (620) 431-9500
 Contractor: Name: TXD
 License: 33837
 Wellsite Geologist: Ken Recoy

Designate Type of Completion:
 New Well Re-Entry Workover
 Oil SWD SLOW Temp. Abd.
 Gas ENHR SIGW
 Dry Other (Core, WSW, Expl., Cathodic, etc)

If Workover/Re-entry: Old Well Info as follows:

Operator: _____
 Well Name: _____
 Original Comp. Date: _____ Original Total Depth: _____
 Deepening Re-perf. Conv. to Enhr./SWD
 Plug Back Plug Back Total Depth
 Commingled Docket No. _____
 Dual Completion Docket No. _____
 Other (SWD or Enhr.?) Docket No. _____

<u>1-25-08</u>	<u>2-02-08</u>	<u>2-04-08</u>
Spud Date or Recompletion Date	Date Reached TD	Completion Date or Recompletion Date

API No. 15 - 15-099-24254-0000
 County: Labette
NE NE NW Sec. 22 Twp. 32 S. R. 18 East West
600 feet from S / (N) (circle one) Line of Section
2290 feet from E / (W) (circle one) Line of Section

Footages Calculated from Nearest Outside Section Corner:
 (circle one) NE SE (NW) SW
 Lease Name: Allmon, Michael Joe Well #: 22-1
 Field Name: Cherokee Basin CBM

Producing Formation: Not Yet Complete
 Elevation: Ground: 932 Kelly Bushing: n/a
 Total Depth: 1077 Plug Back Total Depth: 1054
 Amount of Surface Pipe Set and Cemented at 20 Feet
 Multiple Stage Cementing Collar Used? Yes No
 If yes, show depth set _____ Feet
 If Alternate II completion, cement circulated from 1054
 feet depth to surface w/ 145 sx cmt.

Drilling Fluid Management Plan
 (Data must be collected from the Reserve Pit)
 Chloride content _____ ppm Fluid volume _____ bbls
 Dewatering method used _____
 Location of fluid disposal if hauled offsite: _____
 Operator Name: _____
 Lease Name: _____ License No.: _____
 Quarter _____ Sec. _____ Twp. _____ S. R. _____ East West
 County: _____ Docket No.: _____

INSTRUCTIONS: An original and two copies of this form shall be filed with the Kansas Corporation Commission, 130 S. Market - Room 2078, Wichita, Kansas 67202, within 120 days of the spud date, recompletion, workover or conversion of a well. Rule 82-3-130, 82-3-106 and 82-3-107 apply. Information of slide two of this form will be held confidential for a period of 12 months if requested in writing and submitted with the form (see rule 82-3-107 for confidentiality in excess of 12 months). One copy of all wireline logs and geologist well report shall be attached with this form. ALL CEMENTING TICKETS MUST BE ATTACHED. Submit CP-4 form with all plugged wells. Submit CP-111 form with all temporarily abandoned wells.

All requirements of the statutes, rules and regulations promulgated to regulate the oil and gas industry have been fully complied with and the statements herein are complete and correct to the best of my knowledge.

Signature: Jennifer R. Smith
 Title: New Well Development Coordinator Date: 5/22/08
 Subscribed and sworn to before me this 22nd day of May,
 20 08.
 Notary Public: Terra Klauman
 Date Commission Expires: 8-4-2010

KCC Office Use ONLY

Letter of Confidentiality Received
 If Denied, Yes Date: _____
 Wireline Log Received
 Geologist Report Received
 UIC Distribution

TERRA KLAUMAN
 Notary Public - State of Kansas
 My Appt. Expires 8-4-2010

Operator Name: Quest Cherokee, LLC Lease Name: Allmon, Michael Joe Well #: 22-1
 Sec. 22 Twp. 32 S. R. 18 East West County: Labette

INSTRUCTIONS: Show important tops and base of formations penetrated. Detail all cores. Report all final copies of drill stems tests giving interval tested, time tool open and closed, flowing and shut-in pressures, whether shut-in pressure reached static level, hydrostatic pressures, bottom hole temperature, fluid recovery, and flow rates if gas to surface test, along with final chart(s). Attach extra sheet if more space is needed. Attach copy of all Electric Wireline Logs surveyed. Attach final geological well site report.

Drill Stem Tests Taken Yes No
 (Attach Additional Sheets)

Samples Sent to Geological Survey Yes No

Cores Taken Yes No

Electric Log Run Yes No
 (Submit Copy)

List All E. Logs Run:

Log Formation (Top), Depth and Datum Sample

Name Top Datum

See attached

Compensated Density Neutron Log
 Dual Induction Log

CASING RECORD <input type="checkbox"/> New <input type="checkbox"/> Used							
Report all strings set-conductor, surface, intermediate, production, etc.							
Purpose of String	Size Hole Drilled	Size Casing Set (In O.D.)	Weight Lbs. / FL	Setting Depth	Type of Cement	# Sacks Used	Type and Percent Additives
Surface	12-1/4	8-5/8"	22	20	"A"	5	
Production	7-7/8	5-1/2	14.5	1054	"A"	145	

ADDITIONAL CEMENTING / SQUEEZE RECORD				
Purpose:	Depth Top Bottom	Type of Cement	#Sacks Used	Type and Percent Additives
<input type="checkbox"/> Perforate				
<input type="checkbox"/> Protect Casing				
<input type="checkbox"/> Plug Back TD				
<input type="checkbox"/> Plug Off Zone				

Shots Per Foot	PERFORATION RECORD - Bridge Plugs Set/Type Specify Footage of Each Interval Perforated	Acid, Fracture, Shot, Cement Squeeze Record (Amount and Kind of Material Used)	Depth

TUBING RECORD		Size	Set At	Packer At	Liner Run
		2-3/8"	Waiting on Pipeline	n/a	<input type="checkbox"/> Yes <input type="checkbox"/> No
Date of First, Resumerd Production, SWD or Enhr.			Producing Method		
			<input type="checkbox"/> Flowing <input type="checkbox"/> Pumping <input type="checkbox"/> Gas Lift <input type="checkbox"/> Other (Explain)		
Estimated Production Per 24 Hours	Oil Bbls.	Gas Mcf	Water Bbls.	Gas-Oil Ratio	Gravity
	n/a				

Disposition of Gas Vented Sold Used on Lease
 (If vented, Submit ACO-18.)

METHOD OF COMPLETION Open Hole Perf. Dually Comp. Commingled

Production Interval Other (Specify) _____

	A	B	C	D	E	F	G	H	I	J	K
1	Produced Fluids #		1	2	3	4	5		Click here to run SSP Click Click Goal Seek SSP Click		
2	Parameters	Units	Input	Input	Input	Input	Input				
3	Select the brines	Select fluid	<input type="checkbox"/>	<input type="checkbox"/>	<input type="checkbox"/>	<input type="checkbox"/>	<input type="checkbox"/>	Mixed brine:			
4	Sample ID	by checking						Cell H28 is			
5	Date	the box(es),	3/19/2012	3/4/2012	3/14/2012	1/20/2012	1/20/2012	STP calc. pH.			
6	Operator	Row 3	PostRock	PostRock	PostRock	PostRock	PostRock	Cells H35-38			
7	Well Name		Ward Feed	Ward Feed	Clinesmith	Clinesmith	Clinesmith	are used in			
8	Location		#34-1	#4-1	#5-4	#1	#2	mixed brines			
9	Field		CBM	CBM	Bartles	Bartles	Bartles	calculations.			
10	Na ⁺	(mg/l)*	19,433.00	27,381.00	26,534.00	25689.00	24220.00	24654.20	Initial(BH)	Final(WH)	SI/SR (Final-Initial)
11	K ⁺ (if not known =0)	(mg/l)						0.00	Saturation Index values		
12	Mg ²⁺	(mg/l)	1,096.00	872.00	1,200.00	953.00	858.00	995.91	Calcite		
13	Ca ²⁺	(mg/l)	1,836.00	2,452.00	2,044.00	1920.00	1948.00	2040.23	-0.73	-0.60	0.13
14	Sr ²⁺	(mg/l)						0.00	Barite		
15	Ba ²⁺	(mg/l)						0.00			
16	Fe ²⁺	(mg/l)	40.00	21.00	18.00	82.00	90.00	50.21	Halite		
17	Zn ²⁺	(mg/l)						0.00	-1.77	-1.80	-0.03
18	Pb ²⁺	(mg/l)						0.00	Gypsum		
19	Cl ⁻	(mg/l)	36,299.00	48,965.00	47,874.00	45632.00	43147.00	44388.44	-3.19	-3.18	0.00
20	SO ₄ ²⁻	(mg/l)	1.00	1.00	8.00	1.00	1.00	2.40	Hemihydrate		
21	F ⁻	(mg/l)						0.00	-3.96	-3.90	0.06
22	Br ⁻	(mg/l)						0.00	Anhydrite		
23	SiO ₂	(mg/l) SiO ₂						0.00	-3.47	-3.36	0.12
24	HCO ₃ Alkalinity**	(mg/l as HCO ₃)	190.00	234.00	259.00	268.00	254.00	241.03	Celestite		
25	CO ₃ Alkalinity	(mg/l as CO ₃)									
26	Carboxylic acids**	(mg/l)						0.00	Iron Sulfide		
27	Ammonia	(mg/L) NH ₃						0.00	-0.16	-0.22	-0.06
28	Borate	(mg/L) H ₃ BO ₃						0.00	Zinc Sulfide		
29	TDS (Measured)	(mg/l)						72781			
30	Calc. Density (STP)	(g/ml)	1.038	1.051	1.050	1.048	1.045	1.047	Calcium fluoride		
31	CO ₂ Gas Analysis	(%)	19.97	18.76	22.41	35.53	33.79	26.16			
32	H ₂ S Gas Analysis***	(%)	0.0289	0.0292	0.0296	0.0306	0.0151	0.0269	Iron Carbonate		
33	Total H ₂ Saq	(mgH ₂ S/l)	1.00	1.00	1.00	1.00	0.50	0.90	-0.74	-0.51	0.23
34	pH, measured (STP)	pH	5.67	5.76	5.72	5.54	5.55	5.63	Inhibitor needed (mg/L)		
35	Choose one option to calculate SI?	0-CO ₂ %+Alk, 1-pH+Alk, 2-CO ₂ %+pH	0	0	0	0	0	0	Calcite	NTMP	
36	Gas/day(thousand cf/day)	(Mc/D)						0	0.00	0.00	
37	Oil/Day	(B/D)	0	0	1	1	1	4	Barite	BHPMP	
38	Water/Day	(B/D)	100	100	100	100	100	500	0.00	0.00	
39	For mixed brines, enter values for temperatures and pressures in Cells (H40-H43)								(Enter H40-H43)		pH
40	Initial T	(F)	66.0	71.0	70.0	41.0	49.0	60.0	5.69	5.60	
41	Final T	(F)	66.0	71.0	70.0	41.0	49.0	89.0	Viscosity (CentiPoise)		
42	Initial P	(psia)	25.0	25.0	25.0	25.0	25.0	25.0	1.196	0.826	
43	Final P	(psia)	25.0	25.0	25.0	25.0	25.0	120.0	Heat Capacity (cal/ml ² C)		
44	Use TP on Calcite sheet?	1-Yes;0-No							0.955	0.959	
45	API Oil Grav.	API grav.						30.00	Inhibitor needed (mg/L)		
46	Gas Sp.Grav.	Sp.Grav.						0.60	Gypsum	HD TMP	
47	MeOH/Day	(B/D)	0	0	0	0	0	0	0.00	0.00	
48	MEG/Day	(B/D)	0	0	0	0	0	0	Anhydrite	HD TMP	
49	Conc. Multiplier								0.00	0.00	
50	H ⁺ (Strong acid) [†]	(N)									
51	OH ⁻ (Strong base) [†]	(N)									
52	Quality Control Checks at STP:										
53	H ₂ S Gas	(%)									
54	Total H ₂ Saq (STP)	(mgH ₂ S/l)									
55	pH Calculated	(pH)									
56	PCO ₂ Calculated	(%)									
57	Alkalinity Calculated	(mg/l) as HCO ₃									
58	ΣCations=	(equiv./l)									
59	ΣAnions=	(equiv./l)									
60	Calc TDS=	(mg/l)									
61	Inhibitor Selection	Input	Unit	#	Inhibitor	Unit Converter (From metric to English)			Value		
62	Protection Time	120	min	1	NTMP	From Unit	Value	To Unit	Value		
63	Have ScaleSoftPitzer			2	BHPMP	°C	80	°F	176		
64	pick inhibitor for you?	1	1-Yes;0-No	3	PAA	m ³	100	ft ³	3,531		
65	If No, inhibitor # is:	4	#	4	DTPMP	m ³	100	bbl(42 US gal)	629		
66	If you select Mixed,			5	PPCA	MPa	1,000	psia	145,074		
67	1 st inhibitor # is:	1	#	6	SPA	Bar	496	psia	7,194		
68	% of 1 st inhibitor is:	50	%	7	HEDP	Torr	10,000	psia	193		
69	2 nd inhibitor # is:	2	#	8	HDTMP	Gal	10,000	bbl(42 US gal)	238		
70	Display act. coeffs?	0	1-Yes;0-No	9	Average	Liters	10,000	bbl(42 US gal)	63		
71				10	Mixed						

Saturation Index Calculations

Champion Technologies, Inc.

(Based on the Tomson-Oddo Model)

Brine 1: Ward Feed Yard 34-1

Brine 2: Ward Feed Yard 4-1

Brine 3: Clinesmith 5-4

Brine 4: Clinesmith 1

Brine 5: Clinesmith 2

Component (mg/L)	Ratio					Mixed Brine
	20% Brine 1	20% Brine 2	20% Brine 3	20% Brine 4	20 Brine 5	
Calcium	1836	2452	2044	1920	1948	1952
Magnesium	1096	872	1200	953	858	865
Barium	0	0	0	0	0	0
Strontium	0	0	0	0	0	0
Bicarbonate	190	234	259	268	254	253
Sulfate	1	1	8	1	1	1
Chloride	36299	48965	47874	45632	43147	43206
CO ₂ in Brine	246	220	264	422	405	401
Ionic Strength	1.12	1.48	1.46	1.38	1.31	1.31
Temperature (°F)	89	89	89	89	89	89
Pressure (psia)	50	50	120	120	120	119

Saturation Index

Calcite	-1.71	-1.41	-1.48	-1.68	-1.69	-1.69
Gypsum	-3.71	-3.64	-2.82	-3.73	-3.72	-3.69
Hemihydrate	-3.70	-3.65	-2.83	-3.74	-3.71	-3.69
Anhydrite	-3.89	-3.79	-2.97	-3.89	-3.88	-3.85
Barite	N/A	N/A	N/A	N/A	N/A	N/A
Celestite	N/A	N/A	N/A	N/A	N/A	N/A

PTB

Calcite	N/A	N/A	N/A	N/A	N/A	N/A
Gypsum	N/A	N/A	N/A	N/A	N/A	N/A
Hemihydrate	N/A	N/A	N/A	N/A	N/A	N/A
Anhydrite	N/A	N/A	N/A	N/A	N/A	N/A
Barite	N/A	N/A	N/A	N/A	N/A	N/A
Celestite	N/A	N/A	N/A	N/A	N/A	N/A

AFFIDAVIT

STATE OF KANSAS \
- SS.
County of Sedgwick /

Mark Fletchall, of lawful age, being first duly sworn, deposeth and saith: That he is Record Clerk of The Wichita Eagle, a daily newspaper published in the City of Wichita, County of Sedgwick, State of Kansas, and having a general paid circulation on a daily basis in said County, which said newspaper has been continuously and uninterruptedly published in said County for more than one year prior to the first publication of the notice hereinafter mentioned, and which said newspaper has been entered as second class mail matter at the United States Post Office in Wichita, Kansas, and which said newspaper is not a trade, religious or fraternal publication and that a notice of a true copy is hereto attached was published in the regular and entire Morning issue of said The Wichita Eagle for 1 issues, that the first publication of said notice was

made as aforesaid on the 21st of

June A.D. 2012, with

subsequent publications being made on the following dates:

And affiant further says that he has personal knowledge of the statements above set forth and that they are true.

Mark Fletchall

Subscribed and sworn to before me this

21st day of June, 2012

PENNY L. CASE
Notary Public - State of Kansas
My Appt. Expires 6/28/2014

Penny L. Case
Notary Public Sedgwick County, Kansas

Printer's Fee : \$132.40

LEGAL PUBLICATION
PUBLISHED IN THE WICHITA EAGLE
JUNE 21, 2012 (3191662)
BEFORE THE STATE CORPORATION
COMMISSION OF THE
STATE OF KANSAS
NOTICE OF FILING APPLICATION
RE: In the Matter of Postrock Midcontinent
Production, LLC Application for
Commining of Production in the
Abmon, Michael Joe 22-1 located in
Labette County, Kansas
TO: All Oil & Gas Producers, Unleased
Mineral Interest Owners, Landowners,
and all persons who ever concerned.
You and each of you are hereby notified
that Postrock Midcontinent Production,
LLC has filed an application to commingle
the Rhenton, Tebo, Fleming, Crawburg,
Bevier, Mulky, Summit and Callikman
producing formations at the Abmon,
Michael Joe 22-1 located in the SW NE NE
NW 1/4 22-1 R18E, Approximately 398
FNE & 2281 FWL, Labette County, Kansas.
Any persons who object to or protest
this application shall be required to file their
objections or protest with the Conservation
Division of the State Corporation Commission
of the State of Kansas within fifteen (15)
days from the date of this publication.
These protests shall be filed pursuant to
Commission regulations and must state
specific reasons why granting the application
may cause waste, violate correlative rights
or pollute the natural resources of the State
of Kansas.
All persons interested or concerned shall
take notice of the foregoing and shall govern
themselves accordingly. All person and/or
companies wishing to protest this application
are required to file a written protest with the
Conservation Division of the Kansas Oil and
Gas Commission.
Upon the receipt of any protest, the
Commission will convene a hearing and
protestants will be expected to enter an
appearance, either through proper legal
counsel or as individuals, appearing on their
own behalf.
Postrock Midcontinent Production, LLC
210 Park Avenue, Suite 2750
Oklahoma City, Oklahoma 73102
(405) 660-7704

Affidavit of Notice Served

Re: Application for: APPLICATION FOR COMMINGLING OF PRODUCTION OR FLUIDS - ACO-4

Well Name: ALLMON, MICHAEL JOE 22-1 Legal Location: SWNENENW S22-T32S-R18E

The undersigned hereby certifies that he / she is a duly authorized agent for the applicant, and that on the day 29th of JUNE, 2012, a true and correct copy of the application referenced above was delivered or mailed to the following parties:

Note: A copy of this affidavit must be served as a part of the application.

Name	Address (Attach additional sheets if necessary)
JAMES D BUTTS & REBECCA A BUTTS	598 17500 ROAD, CHERRYVALE, KS 67335
ALAN A JONES REV LIVING TRUST & DEANNA J JONES REV LIVING TRUST	722 18000 RD, MOUND VALLEY, KS 67354
STATE OF KANSAS % FORESTRY, FISH & GAME COMMISSION	512 SE 25TH AVE, PRATT, KS 67124
JANET MYERS	15078 ELK RD, MOUND VALLEY, KS 67354
LARRY DEAN MERRICK & KAREN MERRICK	P O BOX 32 MOUND VALLEY, KS 67354
UNION CENTRAL LIFE INSURANCE CO, C/O THOMAS DIANE	PO BOX 40888, CINCINNATI, OH 45240
RUSSELL W HEDRICK & KIM M HEDRICK	655 17500 RD, MOUND VALLEY, KS 67354
KUDRICK FAMILY TRUST, VIRGINIA KUDRICK TRUSTEE	702 17000 RD, MOUND VALLEY, KS 67354
DOUBLE EAGLE RESOURCES, LLS	1400 S D, FT SMITH, AR 72901
LAMB, PAUL A	206 W 8TH ST, COFFEYVILLE, KS 67337

I further attest that notice of the filing of this application was published in the PARSONS SUN, the official county publication of LABETTE county. A copy of the affidavit of this publication is attached.

Signed this 29th day of JUNE, 2012

Amber R Bial
Applicant or Duly Authorized Agent

Subscribed and sworn to before me this 29th day of JUNE, 2012

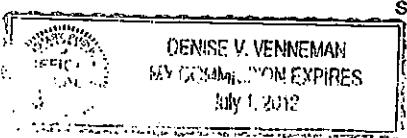

Denise V Venneman
Notary Public
My Commission Expires: 7-1-12

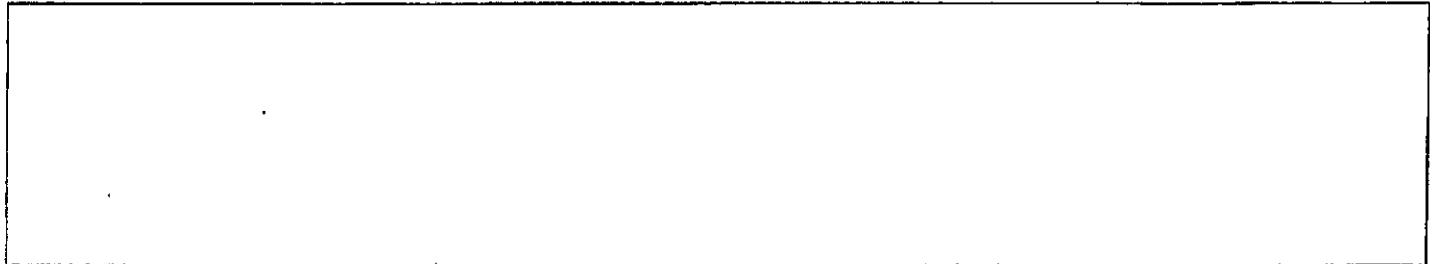

Affidavit of Notice Served

Re: Application for: APPLICATION FOR COMMINGLING OF PRODUCTION OR FLUIDS - ACO-4

Well Name: ALLMON, MICHAEL JOE 22-1 Legal Location: SWNENENW S22-T32S-R18E

The undersigned hereby certifies that he / she is a duly authorized agent for the applicant, and that on the day 29th of JUNE, 2012, a true and correct copy of the application referenced above was delivered or mailed to the following parties:

Note: A copy of this affidavit must be served as a part of the application.

Name	Address (Attach additional sheets if necessary)
LORENZ, JAMES D	543A 22000 RD, CHERRYVALE, KS 67335
TRIPLE T PIPELINES, INC	PO BOX 1027, FRONTENAC, KS 66763

I further attest that notice of the filing of this application was published in the PARSONS SUN, the official county publication of LABETTE county. A copy of the affidavit of this publication is attached.

Signed this 29th day of JUNE, 2012

[Signature]
Applicant or Duly Authorized Agent

Subscribed and sworn to before me this 29th day of JUNE, 2012



[Signature]
Notary Public

My Commission Expires: 7-1-12

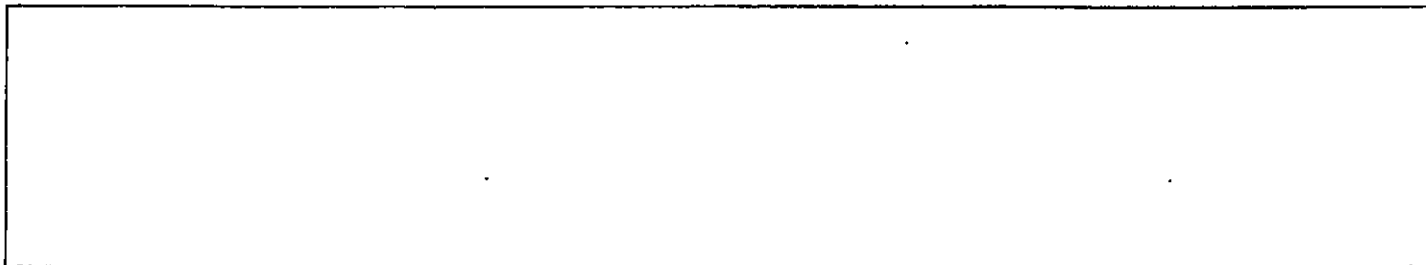

ALLMON, MICHAEL JOE 22-1 - APPLICATION FOR COMINGLING OF PRODUCTION OR FLUIDS

Offset Operators, Unleased Mineral Owners and Landowners acreage
(Attach additional sheets if necessary)

Name:

JAMES D BUTTS & REBECCA A BUTTS

ALAN A JONES REV LIVING TRUST & DEANNA L JONES

STATE OF KANSAS % FORESTRY, FISH & GAME COMM

JANET MYERS

LARRY DEAN MERRICK & KAREN MERRICK

UNION CENTRAL LIFE INSURANCE CO, C/O THOMAS

RUSSELL W HEDRICK & KIM M HEDRICK

KUDRICK FAMILY TRUST, VIRGINIA L KUDRICK TRUST

SEE ATTACHED

Legal Description of Leasehold:

NE/4 S21-T32S-R18E

S/2 S15-T32S-R18E

SE4 SE4 S16-T32S-R18E

NE/4 S22-T32S-R18E

SW/4 S22-T32S-R18E (SURFACE & 1/2 MINERALS)

SW//4 S22-T32S-R18E (1/2 MINERALS)

SE4 W OF RD S22-T32S-R18E

SE4 E OF RD S22-T32S-R18E

I hereby certify that the statements made herein are true and correct to the best of my knowledge and belief.

Amber AS Bial
Applicant or duly Authorized Agent

Subscribed and sworn before me this 29th day of JUNE, 2012

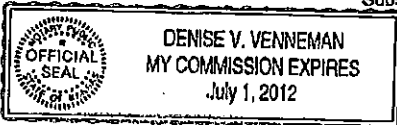

Denise Venneman
Notary Public

My Commission Expires: 7-1-12

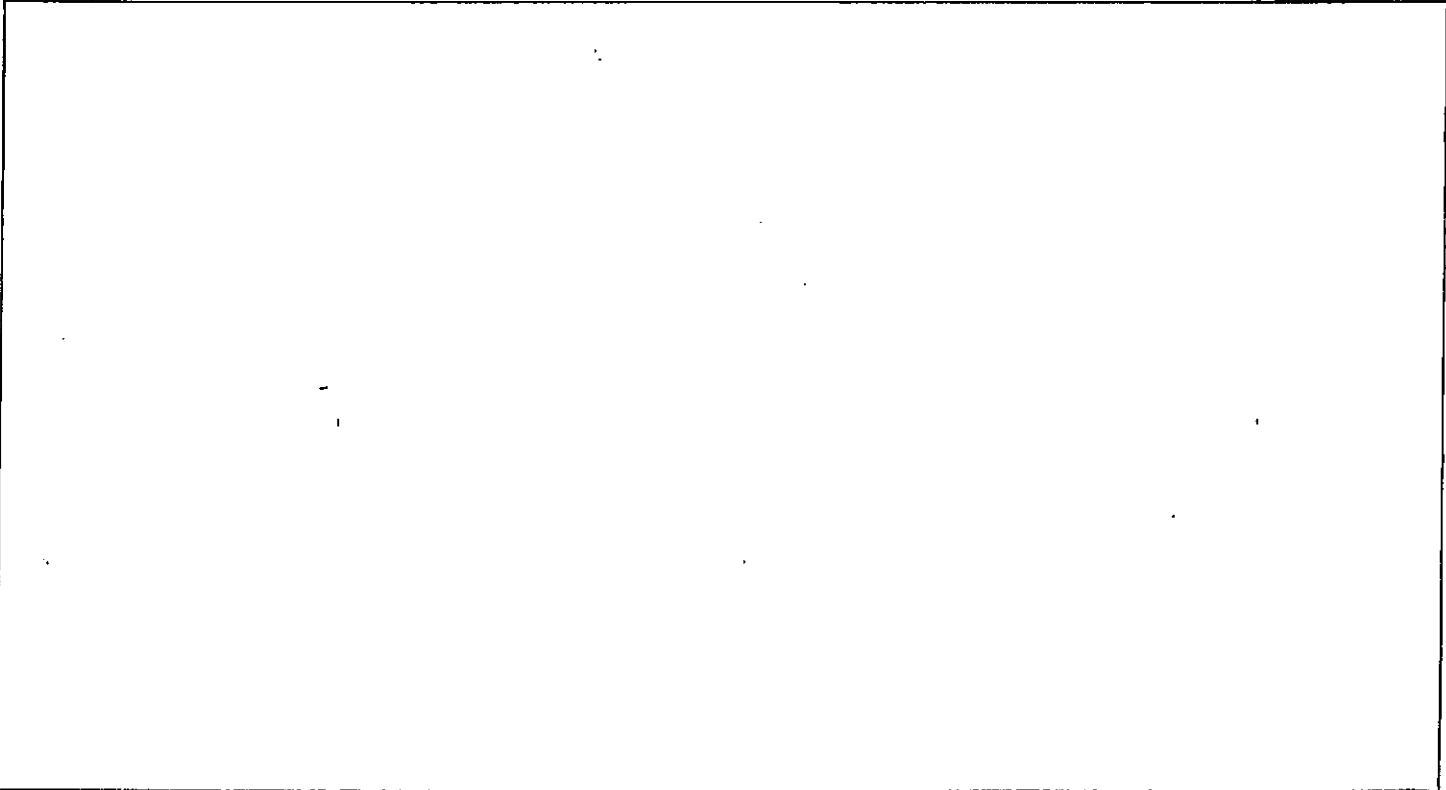

ALLMON, MICHAEL JOE 22-1

OFFSET OPERATORS, UNLEASED MINERAL OWNERS AND LANDOWNERS ACREAGE

SPOT	LEGAL LOCATION	CURR_OPERA
NW NE NW SE	S22-T32S-R18E	Double Eagle Resources, LLC
NE NE SW	S22-T32S-R18E	Double Eagle Resources, LLC
NW NW NE	S22-T32S-R18E	Double Eagle Resources, LLC
NE NE NE	S22-T32S-R18E	Double Eagle Resources, LLC
SE NE NW	S22-T32S-R18E	Double Eagle Resources, LLC
NE NE SW	S22-T32S-R18E	Double Eagle Resources, LLC
C NE NE NE	S22-T32S-R18E	Double Eagle Resources, LLC
C SE SE NW	S22-T32S-R18E	Lamb, Paul A.
N2 NE NE	S22-T32S-R18E	Lorenz, James D.
SE SE SW	S15-T32S-R18E	Lorenz, James D.
NW NW NE	S22-T32S-R18E	Triple T Pipelines, Inc.

QTR	S	T	R	Title	Unleased Mineral Owners
NE/4	21	32S	18E		James D. Butts & Rebecca A. Butts, h&w, Joint Tenants 593 17500 Road Cherryvale, Kansas 67335
S/2	15	32S	18E		Alan A. Jones Rev. Living Trust & Deanna L. Jones Rev. Living Trust 722 18000 RD MOUND VALLEY, KS 67354
SE4 SE4	16	32S	18E		STATE OF KANSAS % FORESTRY, FISH & GAME COMMISSION 512 SE 25TH AVE PRATT KS 67124
NE/4	22	32S	18E		Janet Myers 1507R Elk Rd. Mound Valley, KS 67354
SW/4 Surface & 1/2 Minerals	22	32S	18E		LARRY DEAN MERRICK & KAREN MERRICK PO BOX 32 Mound Valley, KS 67354
SW/4 1/2 Minerals	22	32S	18E		UNION CENTRAL LIFE INSURANCE CO C/O THOMAS DIANE PO BOX 40888 CINCINNATI OH 45240
SE4 W of Rd	22	32S	18E		Russell W. Hedrick & Kim M. Hedrick H/W, J's 655 17500 Rd. Mound Valley, KS 67354
SE4 E of Rd	22	32S	18E		Kudrick Family Trust, Virginia L. Kudrick Trustee 702 17000 Rd. Mound Valley, KS 67354

Conservation Division
Finney State Office Building
130 S. Market, Rm. 2078
Wichita, KS 67202-3802



Phone: 316-337-6200
Fax: 316-337-6211
<http://kcc.ks.gov/>

Mark Sievers, Chairman
Thomas E. Wright, Commissioner

Sam Brownback, Governor

July 16, 2012

Clark Edwards
PostRock Midcontinent Production LLC
Oklahoma Tower
210 Park Ave, Ste 2750
Oklahoma City, OK 73102

RE: Approved Commingling CO071223
Allmon, Michael Joe 22-1 Sec.22-T32S-R18E, Labette County
API No. 15-099-24254-00-00

Dear Mr. Edwards:

Your Application for Commingling (ACO-4) for the above described well, received by the KCC on July 2, 2012, has been reviewed and approved by the Kansas Corporation Commission (KCC) per K.A.R. 82-3-123. Notice was examined and found to be proper per K.A.R. 82-3-135a. No protest had been filed within the 15-day protest period.

Based upon the depth of the Riverton formation perforations, total oil production shall not exceed 100 BOPD and total gas production shall not exceed 50% of the absolute open flow (AOF).

File form ACO-1 upon re-completion of the well to commingle.

Commingling ID number CO071223 has been assigned to this approved application. Use this number for well completion reports (ACO-1) and other correspondence that may concern this approved commingling.

Sincerely,

Rick Hestermann
Production Department