



KANSAS CORPORATION COMMISSION 1084886
OIL & GAS CONSERVATION DIVISION

Form ACO-4
Form must be typed
March 2009

APPLICATION FOR COMMINGLING OF *Commingling ID #* **CO071230**
PRODUCTION (K.A.R. 82-3-123) OR FLUIDS (K.A.R. 82-3-123a)

OPERATOR: License # 33343
Name: PostRock Midcontinent Production LLC
Address 1: Oklahoma Tower
Address 2: 210 Park Ave, Ste 2750
City: OKLAHOMA CITY State: OK Zip: 73102 + _____
Contact Person: CLARK EDWARDS
Phone: (602) 432-4200

API No. 15 - 15-133-26332-00-00
Spot Description: _____
NE SW NE NE Sec. 7 Twp. 30 S. R. 19 East West
678 Feet from North / South Line of Section
709 Feet from East / West Line of Section
County: Neosho
Lease Name: VAN CLEAVE REV TRUST Well #: 7-2

1. Name and upper and lower limit of each production interval to be commingled:
Formation: Summit (Perfs): 489-493
Formation: Mulky (Perfs): 502-506
Formation: Bevier (Perfs): 587-589
Formation: Croweburg (Perfs): 608-611
Formation: Fleming (Perfs): 646-648

2. Estimated amount of fluid production to be commingled from each interval:
Formation: Summit BOPD: 0 MCFPD: 1.43 BWPD: 4
Formation: Mulky BOPD: 0 MCFPD: 1.43 BWPD: 4
Formation: Bevier BOPD: 3 MCFPD: 1.43 BWPD: 4
Formation: Croweburg BOPD: 0 MCFPD: 1.43 BWPD: 4
Formation: Fleming BOPD: 0 MCFPD: 1.43 BWPD: 4

3. Plat map showing the location of the subject well, all other wells on the subject lease, and all wells on offsetting leases within a 1/2 mile radius of the subject well, and for each well the names and addresses of the lessee of record or operator.

4. Signed certificate showing service of the application and affidavit of publication as required in K.A.R. 82-3-135a.

For Commingling of PRODUCTION ONLY, include the following:

5. Wireline log of subject well. Previously Filed with ACO-1: Yes No
 6. Complete Form ACO-1 (*Well Completion form*) for the subject well.

For Commingling of FLUIDS ONLY, include the following:

7. Well construction diagram of subject well.
 8. Any available water chemistry data demonstrating the compatibility of the fluids to be commingled.

AFFIDAVIT: I am the affiant and hereby certify that to the best of my current information, knowledge and personal belief, this request for commingling is true and proper and I have no information or knowledge, which is inconsistent with the information supplied in this application.

Submitted Electronically

KCC Office Use Only	
<input type="checkbox"/> Denied	<input checked="" type="checkbox"/> Approved
15-Day Periods Ends: <u>7/18/2012</u>	
Approved By: <u>Rick Hestermann</u>	Date: <u>07/18/2012</u>

Protests may be filed by any party having a valid interest in the application. Protests must be in writing and comply with K.A.R. 82-3-135b and must be filed within 15 days of publication of the notice of application.

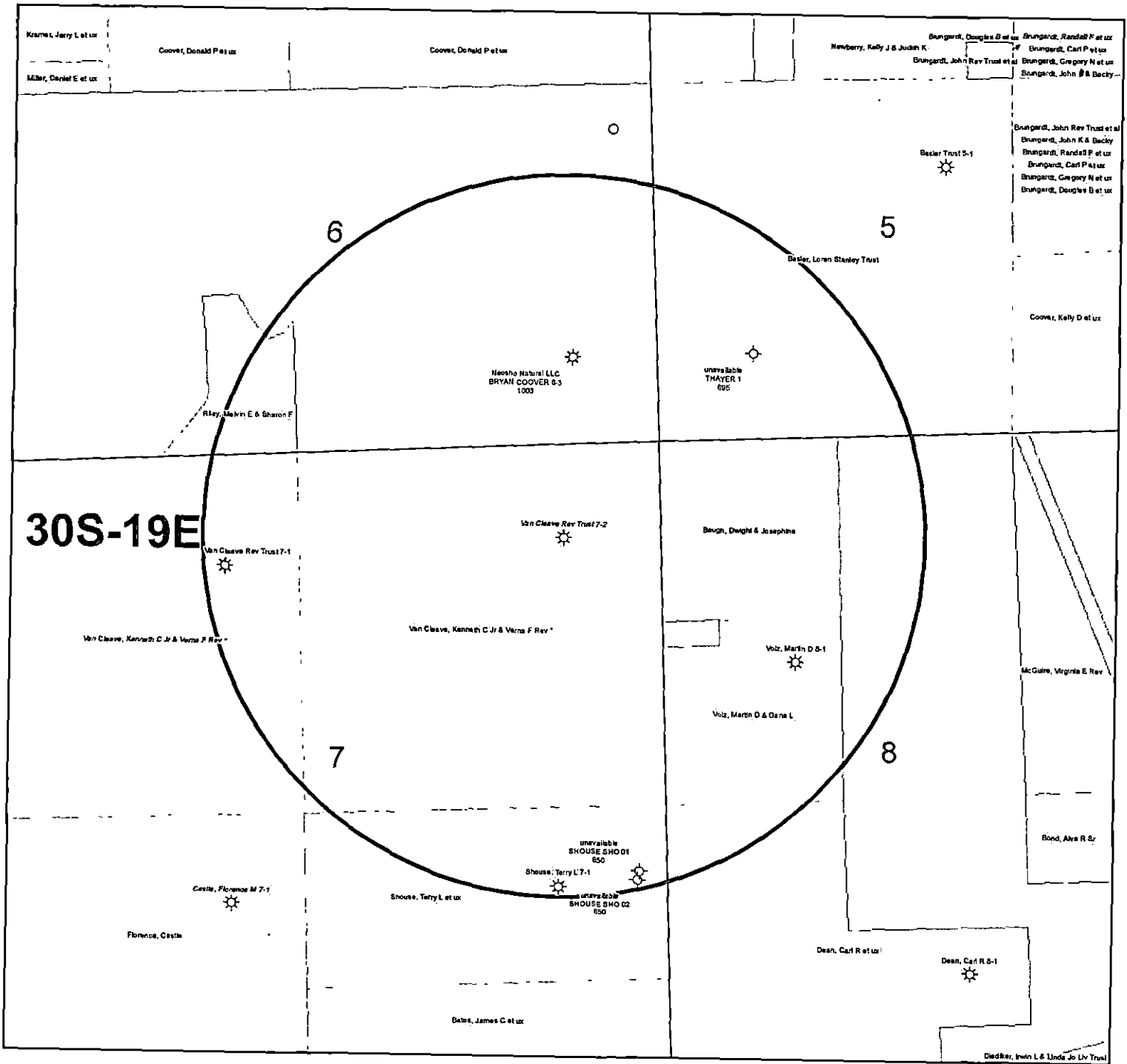

KGS STATUS

⊕	DA/PA
⊗	EOR
☼	GAS
△	INJ/SWD
●	OIL
⊛	OIL/GAS
○	OTHER

Van Cleave Rev Trust 7-2
 7-30S-19E
 1" = 1,000'

	A	B	C	D	E	F	G	H	I	J	K
1	Produced Fluids #		1	2	3	4	5		Click here to run SSP Goal Seek SSP Click Click Click Click		
2	Parameters	Units	Input	Input	Input	Input	Input				
3	Select the brines	Select fluid	<input type="checkbox"/>	<input type="checkbox"/>	<input type="checkbox"/>	<input type="checkbox"/>	<input type="checkbox"/>	Mixed brine:			
4	Sample ID	by checking						Cell H28 is			
5	Date	the box(es),	3/19/2012	3/4/2012	3/14/2012	1/20/2012	1/20/2012	STP calc. pH.			
6	Operator	Row 3	PostRock	PostRock	PostRock	PostRock	PostRock	Cells H35-38			
7	Well Name		Ward Feed	Ward Feed	Clinesmith	Clinesmith	Clinesmith	are used in			
8	Location		#34-1	#4-1	#5-4	#1	#2	mixed brines			
9	Field		CBM	CBM	Bartles	Bartles	Bartles	calculations.			
10	Na ⁺	(mg/l)*	19,433.00	27,381.00	26,534.00	25,689.00	24,220.00	24,654.20	Initial(BH)	Final(WH)	SI/SR (Final-Initial)
11	K ⁺ (if not known =0)	(mg/l)						0.00	Saturation Index values		
12	Mg ²⁺	(mg/l)	1,096.00	872.00	1,200.00	953.00	858.00	995.91	Calcite		
13	Ca ²⁺	(mg/l)	1,836.00	2,452.00	2,044.00	1,920.00	1,948.00	2,040.23	-0.73	-0.60	0.13
14	Sr ²⁺	(mg/l)						0.00	Barite		
15	Ba ²⁺	(mg/l)						0.00			
16	Fe ²⁺	(mg/l)	40.00	21.00	18.00	82.00	90.00	50.21	Halite		
17	Zn ²⁺	(mg/l)						0.00	-1.77	-1.80	-0.03
18	Pb ²⁺	(mg/l)						0.00	Gypsum		
19	Cl ⁻	(mg/l)	36,299.00	48,965.00	47,874.00	45,632.00	43,147.00	44,388.44	-3.19	-3.18	0.00
20	SO ₄ ²⁻	(mg/l)	1.00	1.00	8.00	1.00	1.00	2.40	Hemihydrate		
21	F ⁻	(mg/l)						0.00	-3.96	-3.90	0.06
22	Br ⁻	(mg/l)						0.00	Anhydrite		
23	SiO ₂	(mg/l) SiO ₂						0.00	-3.47	-3.36	0.12
24	HCO ₃ Alkalinity**	(mg/l as HCO ₃)	190.00	234.00	259.00	268.00	254.00	241.03	Celestite		
25	CO ₃ Alkalinity	(mg/l as CO ₃)									
26	Carboxylic acids**	(mg/l)						0.00	Iron Sulfide		
27	Ammonia	(mg/L) NH ₃						0.00	-0.16	-0.22	-0.06
28	Borate	(mg/L) H ₃ BO ₃						0.00	Zinc Sulfide		
29	TDS (Measured)	(mg/l)						72781			
30	Calc. Density (STP)	(g/ml)	1.038	1.051	1.050	1.048	1.045	1.047	Calcium fluoride		
31	CO ₂ Gas Analysis	(%)	19.97	18.76	22.41	35.53	33.79	26.16			
32	H ₂ S Gas Analysis***	(%)	0.0289	0.0292	0.0296	0.0306	0.0151	0.0269	Iron Carbonate		
33	Total H ₂ Saq	(mgH ₂ S/l)	1.00	1.00	1.00	1.00	0.50	0.90	-0.74	-0.51	0.23
34	pH, measured (STP)	pH	5.67	5.76	5.72	5.54	5.55	5.63	Inhibitor needed (mg/L)		
		0-CO ₂ +Alk.							Calcite	NTMP	
35	Choose one option to calculate SI?	1-pH+Alk. 2-CO ₂ +pH	0	0	0	0	0	0			
36	Gas/day (thousand cf/day)	(McF/D)						0	0.00	0.00	
37	Oil/Day	(B/D)	0	0	1	1	1	4	Barite	BHPMP	
38	Water/Day	(B/D)	100	100	100	100	100	500	0.00	0.00	
39	For mixed brines, enter values for temperatures and pressures in Cells (H40-H43)								(Enter H40-H43) pH		
40	Initial T	(F)	66.0	71.0	70.0	41.0	49.0	60.0	5.69	5.60	
41	Final T	(F)	66.0	71.0	70.0	41.0	49.0	89.0	Viscosity (CentPoise)		
42	Initial P	(psia)	25.0	25.0	25.0	25.0	25.0	25.0	1.196	0.826	
43	Final P	(psia)	25.0	25.0	25.0	25.0	25.0	120.0	Heat Capacity (cal/ml/°C)		
44	Use TP on Calcite sheet?	1-Yes;0-No							0.955	0.959	
45	API Oil Grav.	API grav.						30.00	Inhibitor needed (mg/L)		
46	Gas Sp.Grav.	Sp.Grav.						0.60	Gypsum	HDTMP	
47	MeOH/Day	(B/D)	0					0	0.00	0.00	
48	MEG/Day	(B/D)	0					0	Anhydrite	HDTMP	
49	Conc. Multiplier								0.00	0.00	
50	H ⁺ (Strong acid) †	(N)									
51	OH ⁻ (Strong base) †	(N)									
52	Quality Control Checks at STP:										
53	H ₂ S Gas	(%)									
54	Total H ₂ Saq (STP)	(mgH ₂ S/l)									
55	pH Calculated	(pH)									
56	PCO ₂ Calculated	(%)									
57	Alkalinity Calculated	(mg/l) as HCO ₃									
58	ΣCations=	(equiv./l)									
59	ΣAnions=	(equiv./l)									
60	Calc TDS=	(mg/l)									
61	Inhibitor Selection	Input	Unit	#	Inhibitor	Unit Converter (From metric to English)			Value		
62	Protection Time	120	min	1	NTMP	From Unit	Value	To Unit	176		
63	Have ScaleSoftPitzer			2	BHPMP	°C	80	°F	176		
64	pick inhibitor for you?	1	1-Yes;0-No	3	PAA	m ³	100	ft ³	3,531		
65	If No, inhibitor # is:	4	#	4	DTPMP	m ³	100	bbl(42 US gal)	629		
66	If you select Mixed,			5	PPCA	MPa	1,000	psia	145,074		
67	1 st inhibitor # is:	1	#	6	SPA	Bar	496	psia	7,194		
68	% of 1 st inhibitor is:	50	%	7	HEDP	Torr	10,000	psia	193		
69	2 nd inhibitor # is:	2	#	8	HDTMP	Gal	10,000	bbl(42 US gal)	238		
70	Display act. coeffs?	0	1-Yes;0-No	9	Average	Liters	10,000	bbl(42 US gal)	63		
71				10	Mixed						

Saturation Index Calculations

Champion Technologies, Inc.
(Based on the Tomson-Oddo Model)

Brine 1: Ward Feed Yard 34-1

Brine 2: Ward Feed Yard 4-1

Brine 3: Clinesmith 5-4

Brine 4: Clinesmith 1

Brine 5: Clinesmith 2

Component (mg/L)	Ratio					Mixed Brine
	20% Brine 1	20% Brine 2	20% Brine 3	20% Brine 4	20 Brine 5	
Calcium	1836	2452	2044	1920	1948	1952
Magnesium	1096	872	1200	953	858	865
Barium	0	0	0	0	0	0
Strontium	0	0	0	0	0	0
Bicarbonate	190	234	259	268	254	253
Sulfate	1	1	8	1	1	1
Chloride	36299	48965	47874	45632	43147	43206
CO ₂ in Brine	246	220	264	422	405	401
Ionic Strength	1.12	1.48	1.46	1.38	1.31	1.31
Temperature (°F)	89	89	89	89	89	89
Pressure (psia)	50	50	120	120	120	119

Saturation Index

Calcite	-1.71	-1.41	-1.48	-1.68	-1.69	-1.69
Gypsum	-3.71	-3.64	-2.82	-3.73	-3.72	-3.69
Hemihydrate	-3.70	-3.65	-2.83	-3.74	-3.71	-3.69
Anhydrite	-3.89	-3.79	-2.97	-3.89	-3.88	-3.85
Barite	N/A	N/A	N/A	N/A	N/A	N/A
Celestite	N/A	N/A	N/A	N/A	N/A	N/A

PTB

Calcite	N/A	N/A	N/A	N/A	N/A	N/A
Gypsum	N/A	N/A	N/A	N/A	N/A	N/A
Hemihydrate	N/A	N/A	N/A	N/A	N/A	N/A
Anhydrite	N/A	N/A	N/A	N/A	N/A	N/A
Barite	N/A	N/A	N/A	N/A	N/A	N/A
Celestite	N/A	N/A	N/A	N/A	N/A	N/A

AFFIDAVIT

STATE OF KANSAS \
- SS.
County of Sedgwick /

Mark Fletchall, of lawful age, being first duly sworn, deposeth and saith: That he is Record Clerk of The Wichita Eagle, a daily newspaper published in the City of Wichita, County of Sedgwick, State of Kansas, and having a general paid circulation on a daily basis in said County, which said newspaper has been continuously and uninterruptedly published in said County for more than one year prior to the first publication of the notice hereinafter mentioned, and which said newspaper has been entered as second class mail matter at the United States Post Office in Wichita, Kansas, and which said newspaper is not a trade, religious or fraternal publication and that a notice of a true copy is hereto attached was published in the regular and entire Morning issue of said The Wichita Eagle for 1 issues, that the first publication of said notice was

made as aforesaid on the 18th of

June A.D. 2012, with

subsequent publications being made on the following dates:

And affiant further says that he has personal knowledge of the statements above set forth and that they are true.

Mark Fletchall

Subscribed and sworn to before me this

18th day of June, 2012

PENNY L. CASE
Notary Public - State of Kansas
My Appt. Expires 5/28/2014

Penny L Case
Notary Public Sedgwick County, Kansas

Printer's Fee : \$134.80

LEGAL PUBLICATIONS
PUBLISHED IN THE WICHITA EAGLE
JUNE 18, 2012 (3191269)
BEFORE THE STATE CORPORATION
COMMISSION OF THE
STATE OF KANSAS
NOTICE OF FILING APPLICATION
RE: In the Matter of Postrock Midcontinent
Production, LLC Application for
Commencing of Production in the Van
Cleave Rev. Trust 7-2, located in
Neosho County, Kansas.
TO: All Oil & Gas Producers, Unleased
Mineral Interest Owners, Landowners,
and all persons whomsoever concerned.
You, and each of you, are hereby
notified that Postrock Midcontinent
Production, LLC has filed an application to
commence the Riverton, Rowe, Fleming,
Croweburg, Beaver, Mulky, Summit and
Cattlemen producing formations at the
Van Cleave Rev. Trust 7-2, located in the
NE 1/4, S7, T30S-R19E, Approximately
678 PNL & 709 FEL, Neosho County,
Kansas.
Any persons who object to or protest
this application shall be required to file their
objections or protest with the Conservation
Division of the State Corporation
Commission of the State of Kansas within
fifteen (15) days from the date of this
publication. These protests shall be filed
pursuant to Commission regulations and
must state specific reasons why granting
the application may cause waste, violate
correlative rights or pollute the natural
resources of the State of Kansas.
All persons interested or concerned
shall take notice of the foregoing and shall
govern themselves accordingly. All person
and/or companies wishing to protest this
application are required to file a written
protest with the Conservation Division of
the Kansas Oil and Gas Commission.
Upon the receipt of any protest, the
Commission will convene a hearing and
protestants will be expected to enter an
appearance either through proper legal
counsel or as individuals, appearing on
their own behalf.
Postrock Midcontinent Production, LLC
210 Park Avenue, Suite 2750
Oklahoma City, Oklahoma 73102
(405) 660-7704

BEFORE THE STATE CORPORATION COMMISSION OF THE STATE OF KANSAS
NOTICE OF FILING APPLICATION

RE: In the Matter of Postrock Midcontinent Production, LLC Application for Commingling of Production in the Van Cleave Rev Trust 7-2 located in Neosho County, Kansas.

TO: All Oil & Gas Producers, Un-leased Mineral Interest Owners, Landowners, and all persons whomsoever concerned.

You, and each of you, are hereby notified that Postrock Midcontinent Production, LLC has filed an application to commingle the Riverton, Rowe, Fleming, Croweburg, Bevier, Mulky, Summit and Cattleman producing formations at the Van Cleave Rev Trust 7-2, located in the NE NE, S7-T30S-R19E, Approximately 678 FNL & 709 FEL, Neosho County, Kansas.

Any persons who object to or protest this application shall be required to file their objections or protest with the Conservation Division of the State Corporation Commission of the State of Kansas within fifteen (15) days from the date of this publication. These protests shall be filed pursuant to Commission regulations and must state specific reasons why granting the application may cause waste, violate correlative rights or pollute the natural resources of the State of Kansas.

All persons interested or concerned shall take notice of the foregoing and shall govern themselves accordingly. All person and/or companies wishing to protest this application are required to file a written protest with the Conservation Division of the Kansas Oil and Gas Commission.

Upon the receipt of any protest, the Commission will convene a hearing and protestants will be expected to enter an appearance either through proper legal counsel or as individuals, appearing on their own behalf.

Postrock Midcontinent Production, LLC
210 Park Avenue, Suite 2750
Oklahoma City, Oklahoma 73102
(405) 660-7704

A COPY OF THE AFFIDAVIT OF PUBLICATION MUST ACCOMPANY ALL APPLICATIONS

Affidavit of Publication

STATE OF KANSAS, NEOSHO COUNTY, ss:
Rhonda Howerter, being first duly sworn, deposes and says: That *she* is *Classified Manager* of *THE CHANUTE TRIBUNE*, a daily newspaper printed in the State of Kansas, and published in and of general circulation in Neosho County, Kansas, with a general paid circulation on a daily basis in Neosho County, Kansas, and that said newspaper is not a trade, religious or fraternal publication.

Said newspaper is a daily published at least weekly 50 times a year: has been so published continuously and uninterruptedly in said county and state for a period of more than five years prior to the first publication of said notice; and has been admitted at the post office of Chanute, in said county as second class matter.

That the attached notice is a true copy thereof and was published in the regular and entire issue of said newspaper for 1 ~~consecutive~~ time, the first publication thereof being made as aforesaid on the 16 day of June 2012, with subsequent publications being made on the following dates:

_____, 2012 _____, 2012
_____, 2012 _____, 2012

Rhonda Howerter

Subscribed and sworn to and before me this 19 day of June, 2012

[Signature]
Notary Public

My commission expires: January 9, 2015
Printer's Fee \$ 70.14
Affidavit, Notary's Fee \$ 3.00
Additional Copies \$ _____
Total Publication Fees \$ 73.14

SHANNA L. GUIOT
Notary Public - State of Kansas
My Appl. Expires 1-9-15

KANSAS CORPORATION COMMISSION
OIL & GAS CONSERVATION DIVISION

ORIGINAL

Form ACO-1
September 1999
Form Must Be Typed

WELL COMPLETION FORM
WELL HISTORY - DESCRIPTION OF WELL & LEASE

Operator: License # 33344
Name: Quest Cherokee, LLC
Address: 211 W. 14th Street
City/State/Zip: Chanute, KS 66720
Purchaser: Bluestem Pipeline, LLC
Operator Contact Person: Gary Laswell
Phone: (620) 431-9500
Contractor: Name: LS Well Service, LLC
License: 33374
Wellsite Geologist: Julie Shaffer

Designate Type of Completion:
 New Well Re-Entry Workover
 Oil SWD SLOW Temp. Abd.
 Gas ENHR SIGW
 Dry Other (Core, WSW, Expl., Cathodic, etc)

If Workover/Re-entry: Old Well Info as follows:

Operator: _____
Well Name: _____
Original Comp. Date: _____ Original Total Depth: _____
 Deepening Re-perf. Conv. to Enhr./SWD
 Plug Back _____ Plug Back Total Depth _____
 Commingled _____ Docket No. _____
 Dual Completion _____ Docket No. _____
 Other (SWD or Enhr.?) _____ Docket No. _____

<u>11/10/05</u>	<u>11/11/05</u>	<u>11/17/05</u>
Spud Date or Recompletion Date	Date Reached TD	Completion Date or Recompletion Date

API No. 15 - 133-26332-0000
County: Neosho
E2 W2 NE NE Sec. 7 Twp. 30 S. R. 19 East West
660 feet from S / N (circle one) Line of Section
700 feet from E / W (circle one) Line of Section

Footages Calculated from Nearest Outside Section Corner:
(circle one) NE SE NW SW
Lease Name: Van Cleave Rev. Trust Well #: 7-2
Field Name: Cherokee Basin CBM

Producing Formation: Multiple zones
Elevation: Ground: 972 Kelly Bushing: n/a
Total Depth: 1046 Plug Back Total Depth: 1006
Amount of Surface Pipe Set and Cemented at 21.5 Feet
Multiple Stage Cementing Collar Used? Yes No
If yes, show depth set _____ Feet
If Alternate II completion, cement circulated from 1006
feet depth to surface w/ 127 _____ sx cml.
ALT II UHM 8-25-06

Drilling Fluid Management Plan
(Data must be collected from the Reserve Pit)
Chloride content _____ ppm Fluid volume _____ bbls
Dewatering method used _____
Location of fluid disposal if hauled offsite: _____
Operator Name: _____
Lease Name: _____ License No.: _____
Quarter _____ Sec. _____ Twp. _____ S. R. _____ East West
County: _____ Docket No.: _____

INSTRUCTIONS: An original and two copies of this form shall be filed with the Kansas Corporation Commission, 130 S. Market - Room 2078, Wichita, Kansas 67202, within 120 days of the spud date, recompletion, workover or conversion of a well. Rule 82-3-130, 82-3-106 and 82-3-107 apply. Information of side two of this form will be held confidential for a period of 12 months if requested in writing and submitted with the form (see rule 82-3-107 for confidentiality in excess of 12 months). One copy of all wireline logs and geologist well report shall be attached with this form. ALL CEMENTING TICKETS MUST BE ATTACHED. Submit CP-4 form with all plugged wells. Submit CP-111 form with all temporarily abandoned wells.

All requirements of the statutes, rules and regulations promulgated to regulate the oil and gas industry have been fully complied with and the statements herein are complete and correct to the best of my knowledge.

Signature: [Signature]
Title: Head of Operations Date: 4/8/06
Subscribed and sworn to before me this 8th day of April
2006.
Notary Public: [Signature]
Date Commission Expires: July 30, 2009

KCC Office Use ONLY

Letter of Confidentiality Received
If Denied, Yes Date: _____
 Wireline Log Received
 Geologist Report Received
 UIC Distribution

RECEIVED
KANSAS CORPORATION COMMISSION
APR 13 2006
CONSERVATION DIVISION
WICHITA, KS

JENNIFER AMMANN
Notary Public - State of Kansas
My Appt. Expires July 30, 2009

Operator Name: Quest Cherokee, LLC Lease Name: Van Cleave Rev. Trust Well #: 7-2
 Sec. 7 Twp. 30 S. R. 19 East West County: Neosho

INSTRUCTIONS: Show important tops and base of formations penetrated. Detail all cores. Report all final copies of drill stems tests giving interval tested, time tool open and closed, flowing and shut-in pressures, whether shut-in pressure reached static level, hydrostatic pressures, bottom hole temperature, fluid recovery, and flow rates if gas to surface test, along with final chart(s). Attach extra sheet if more space is needed. Attach copy of all Electric Wireline Logs surveyed. Attach final geological well site report.

Drill Stem Tests Taken <input type="checkbox"/> Yes <input checked="" type="checkbox"/> No <i>(Attach Additional Sheets)</i> Samples Sent to Geological Survey <input type="checkbox"/> Yes <input checked="" type="checkbox"/> No Cores Taken <input type="checkbox"/> Yes <input checked="" type="checkbox"/> No Electric Log Run <input checked="" type="checkbox"/> Yes <input type="checkbox"/> No <i>(Submit Copy)</i> List All E. Logs Run: Comp. Density/Neutron Log Dual Induction Log Gamma Ray/Neutron Log	<input checked="" type="checkbox"/> Log Formation (Top), Depth and Datum <input type="checkbox"/> Sample Name Top Datum See attached
--	--

CASING RECORD <input type="checkbox"/> New <input type="checkbox"/> Used							
Report all strings set-conductor, surface, intermediate, production, etc.							
Purpose of String	Size Hole Drilled	Size Casing Set (In O.D.)	Weight Lbs. / Ft.	Setting Depth	Type of Cement	# Sacks Used	Type and Percent Additives
Surface	11"	8-5/8"	20#	21.5	"A"	5	
Production	6-3/4"	4-1/2"	10.5#	1006	"A"	127	

ADDITIONAL CEMENTING / SQUEEZE RECORD				
Purpose:	Depth Top Bottom	Type of Cement	#Sacks Used	Type and Percent Additives
<input type="checkbox"/> Perforate <input type="checkbox"/> Protect Casing <input type="checkbox"/> Plug Back TD <input type="checkbox"/> Plug Off Zone				

Shots Per Foot	PERFORATION RECORD - Bridge Plugs Set/Type Specify Footage of Each Interval Perforated	Acid, Fracture, Shot, Cement Squeeze Record (Amount and Kind of Material Used)	Depth
4	488.5-492.5/501.5-505.5/586.5-588.5/607.5-610.5	400gal 15% HCL w/ 42 bbls 2% KCl water, 547bbls water w/ 2% KCl, Blocks, 76ccs 20/40 sand	478.5-478.5/503.5-503.5
4	646.5-647.5/876.5-878.5/933.5-936.5	400gal 15% HCL w/ 41bbls 2% KCl water, blocks, 542bbls 2% KCl, blocks, 133ccs 20/40 sand	601.5-601.5/878.5-878.5
		400gal 15% HCL w/ 25bbls 2% KCl water, blocks, 637bbls 2% KCl, blocks, 65ccs 20/40 sand	646-648/608-811
			587-589

TUBING RECORD		Size	Set At	Packer At	Liner Run	<input type="checkbox"/> Yes <input checked="" type="checkbox"/> No
		2-3/8"	928	n/a		
Date of First, Resumed Production, SWD or Enhr.			Producing Method			
12/31/05			<input type="checkbox"/> Flowing <input checked="" type="checkbox"/> Pumping <input type="checkbox"/> Gas Lift <input type="checkbox"/> Other (Explain)			
Estimated Production Per 24 Hours	Oil	Bbls.	Gas	Mcf	Water	Bbls.
			27.8mcf		10bbls	
Disposition of Gas		METHOD OF COMPLETION		Production Interval		

Vented Sold Used on Lease Open Hole Perf. Dually Comp. Commingled
(If vented, Submit ACO-18.) Other (Specify) _____

RECEIVED
KANSAS CORPORATION COMMISSION
APR 13 2006
CONSERVATION DIVISION
WICHITA, KS

Affidavit of Notice Served

Re: Application for: APPLICATION FOR COMMINGLING OF PRODUCTION OR FLUIDS - ACO-4

Well Name: VAN CLEAVE REV TRUST 7-2 Legal Location: NENE S7-T30S-R19E

The undersigned hereby certifies that he / she is a duly authorized agent for the applicant, and that on the day 3RD of JULY, 2012, a true and correct copy of the application referenced above was delivered or mailed to the following parties:

Note: A copy of this affidavit must be served as a part of the application.

Name	Address (Attach additional sheets if necessary)
NEOSHO NATURAL LLC	4230 DOUGLAS RD, THAYER, KS 66776
THE CITY OF PARSONS, KANSAS, A MUNICIPAL CORPORATION	112 S 17TH ST, PARSONS, KS 67357
JAMES MERRILL	1301 N 20TH RD, PARSONS, KS 67357
BRYAN W & DEBRA J COOVER	6165 JACKSON RD, GALESBURG, KS 66740

I further attest that notice of the filing of this application was published in the CHANUTE TRIBUNE, the official county publication of NEOSHO county. A copy of the affidavit of this publication is attached.

Signed this 3 day of JULY, 2012

[Signature]
Applicant or Duly Authorized Agent

Subscribed and sworn to before me this 3 day of JULY, 2012

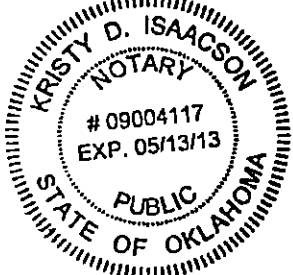

[Signature]
Notary Public
My Commission Expires: 5/13/13

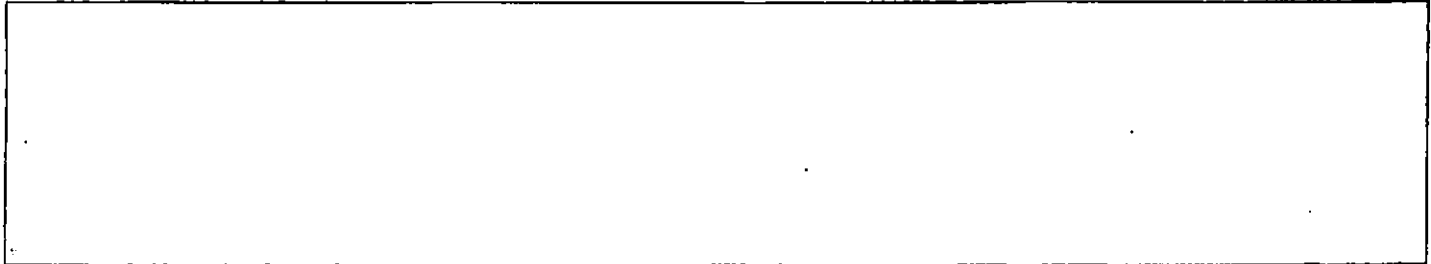

VAN CLEAVE REV TRUST 7-2 - APPLICATION FOR COMMINGLING OF PRODUCTION OR FLUIDS

[Redacted]

[Redacted]

Offset Operators, Unleased Mineral Owners and Landowners acreage
(Attach additional sheets if necessary)

Name:

Legal Description of Leasehold:

SEE ATTACHED

I hereby certify that the statements made herein are true and correct to the best of my knowledge and belief.

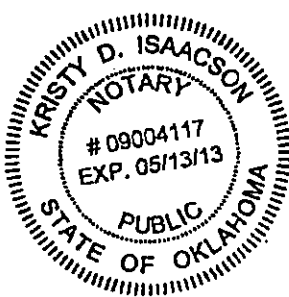

[Signature]
 Applicant or Duly Authorized Agent

Subscribed and sworn before me this 3 day of JULY, 2012

[Signature]
 Notary Public

My Commission Expires: 5/13/13

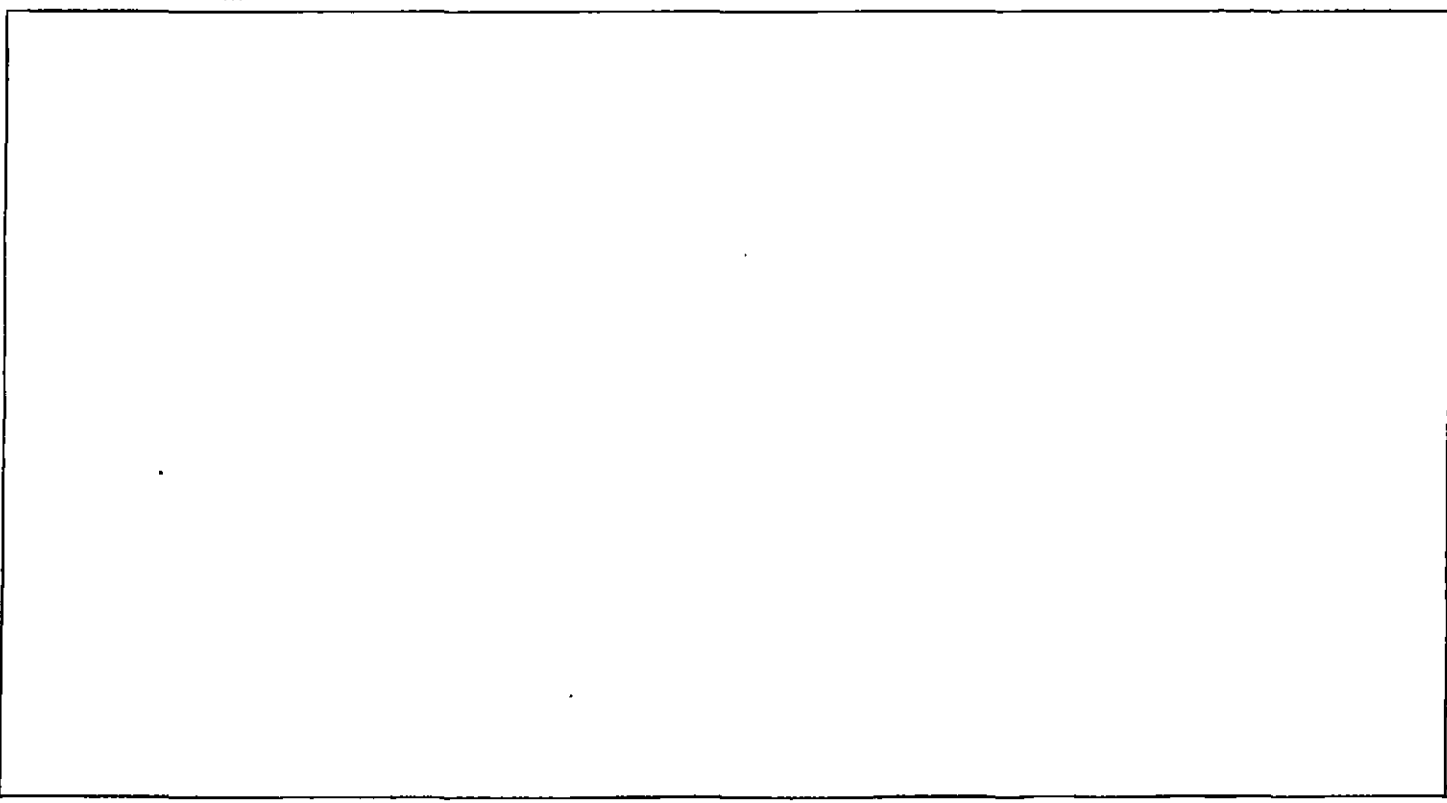

VAN CLEAVE REV 7-2

NW4 of 8-30S-19E

per TO dtd 3-4-07

E2NW4

The City Of Parsons, Kansas, a municipal corporation
112 S 17TH ST
Parsons, KS 67357

1.78 acre tract in SW4NW4

James Merrill
1301 N 20th
Parsons, KS 67357

SE4 & Tract in SW/4 of 6-30S-19E

Bryan W and Debra J Coover
6165 Jackson Road
Galesburg, KS 66740

POSTROCK



Current Completion

WELL Van Cleave Rev Trust 7-2
FIELD : Cherokee Basin
STATE : Kansas
COUNTY : Neosho

SPUD DATE : 11/10/2005
COMP. Date : 12/2/2005
API: 15-133-26332-00-00

LOCATION: 7-30S-19E (NE, NE)
ELEVATION: GL - 972'

8 5/8" @ 21.5' Cement w/5 sks

2 3/8" tubing @ 928'

4.5" 10.5 lb @ 1007' Cement w/135 sks

Drilled Depth @ 1046'

Wellhead/Surface Equipment

Tree Connection	
Tree	
Tubing Head	
Bradenhead	
Pumping Unit	
Compressor	

Tubular Detail

Size	Weight	Grade	Cap(bbl/ft)	Date	Depth
8 5/8"				2005	21.5'
4 1/2"	10.5 lb		.0159	2005	1007'

Downhole Equipment Detail

Empty box for Downhole Equipment Detail.

Completion Data

Original as GAS Well per ACO-1	
1,200 gals 15% HCL	
1,726 bbbls	
30,400 lbs 20/40 sand	

Perforations

Original Completion: 4 spf
489-493 (Summit)
502-506 (Mulky)
587-589 (Bevier)
608-611 (Croweburg)
646-648 (Fleming)
877-879 (Rowe)
934-937 (Riverton)

PREPARED BY: POSTROCK
APPROVED BY: _____

DATE: July, 2012
DATE: _____

POSTROCK



LEGEND

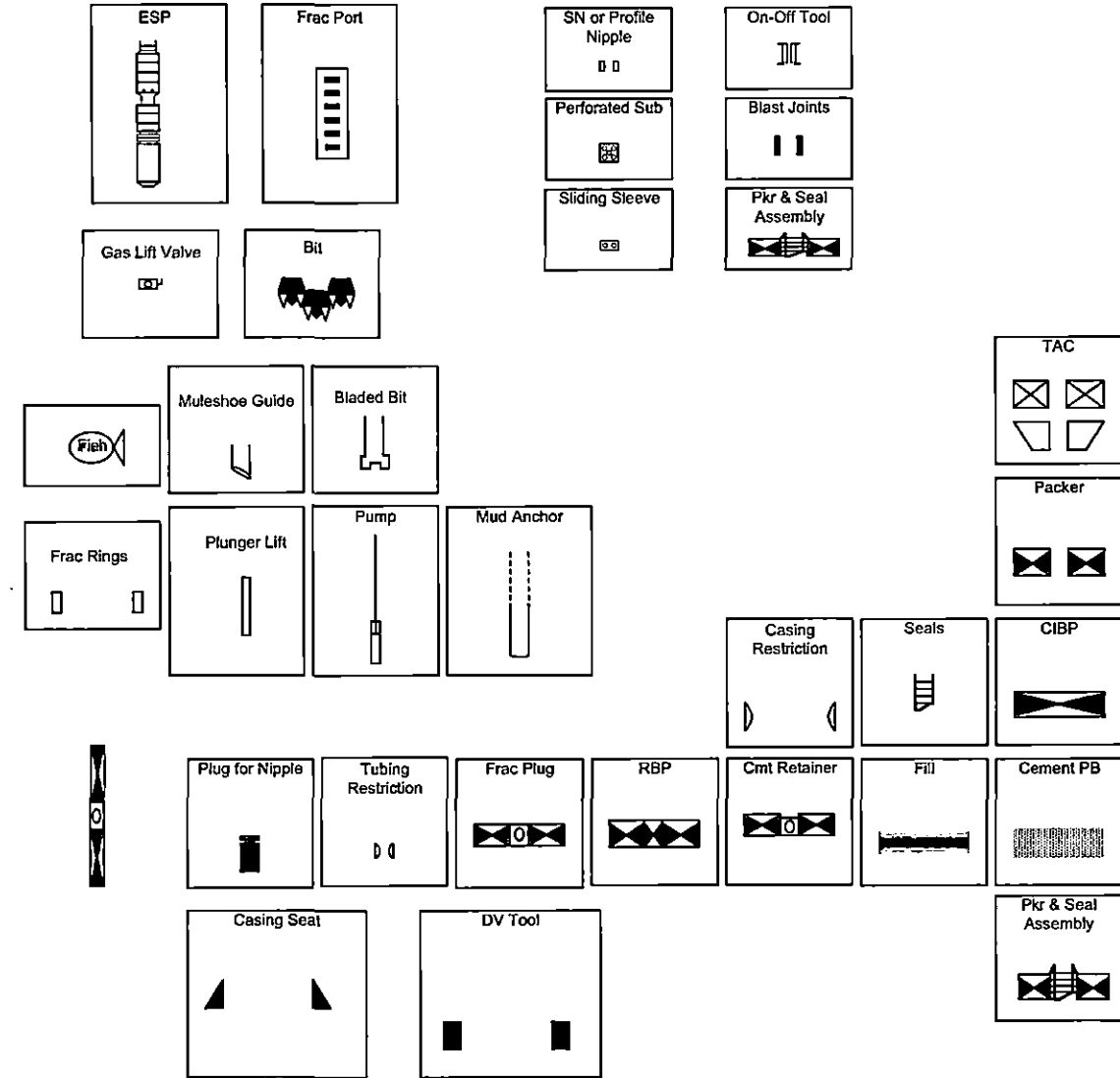

Conservation Division
Finney State Office Building
130 S. Market, Rm. 2078
Wichita, KS 67202-3802



Phone: 316-337-6200
Fax: 316-337-6211
<http://kcc.ks.gov/>

Mark Sievers, Chairman
Thomas E. Wright, Commissioner

Sam Brownback, Governor

July 18, 2012

Clark Edwards
PostRock Midcontinent Production LLC
Oklahoma Tower
210 Park Ave, Ste 2750
Oklahoma City, OK 73102

RE: Approved Commingling CO071230
Van Cleave Rev Trust 7-2 Sec.7-T30S-R19E, Neosho County
API No. 15-133-26332-00-00

Dear Mr. Edwards:

Your Application for Commingling (ACO-4) for the above described well, received by the KCC on July 16, 2012, has been reviewed and approved by the Kansas Corporation Commission (KCC) per K.A.R. 82-3-123. Notice was examined and found to be proper per K.A.R. 82-3-135a. No protest had been filed within the 15-day protest period.

Based upon the depth of the Riverton formation perforations, total oil production shall not exceed 100 BOPD and total gas production shall not exceed 50% of the absolute open flow (AOF).

File form ACO-1 upon re-completion of the well to commingle.

Commingling ID number CO071230 has been assigned to this approved application. Use this number for well completion reports (ACO-1) and other correspondence that may concern this approved commingling.

Sincerely,

Rick Hestermann
Production Department