

15-033-20363-0000

STATE OF KANSAS
STATE CORPORATION COMMISSION
CONSERVATION DIVISION
P. O. BOX 17027
WICHITA, KANSAS 67217

WELL PLUGGING RECORD

Comanche County, Sec 11 Twp. 34S Rge. 20 (NW) (W)
Location as "NE/CNW/SW" or footage from lines Gen. SW/4 SW/4

Lease Owner InterNorth, Inc.
Lease Name Girk 11 Well No. 2
Office Address P.O. Box 35288 Tulsa, Okla. 74135
Character of Well (completed as Oil, Gas or Dry Hole) Dry Hole
Date well completed Sept. 15 19 80
Application for plugging filed Sept. 15 19 80
Application for plugging approved _____ 19 _____
Plugging commenced Sept. 15 19 80
Plugging completed Sept. 15 19 80
Reason for abandonment of well or producing formation Dry hole

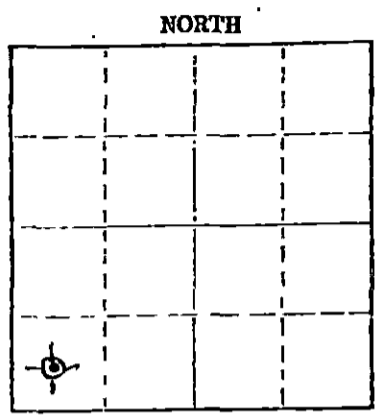

Locate well correctly on above Section Plot

If a producing well is abandoned, date of last production _____ 19 _____
Was permission obtained from the Conservation Division or its agents before plugging was commenced? Yes

Name of Conservation Agent who supervised plugging of this well Bill Owens, Pratt, Ks.
Producing formation _____ Depth to top _____ Bottom _____ Total Depth of Well 5300 Feet
Show depth and thickness of all water, oil and gas formations.

OIL, GAS OR WATER RECORDS

CASING RECORD

| FORMATION | CONTENT | FROM | TO | SIZE | PUT IN | PULLED OUT |
|-----------|---------|------|----|--------|--------|------------|
| | | | | 20" | 60' | None |
| | | | | 8 5/8" | 608' | None |
| | | | | | | |
| | | | | | | |
| | | | | | | |
| | | | | | | |
| | | | | | | |

Describe in detail the manner in which the well was plugged, indicating where the mud fluid was placed and the method or methods used in introducing it into the hole. If cement or other plugs were used, state the character of same and depth placed, from _____ feet to _____ feet for each plug set.
70 vis. mud from td to surface
60 sacks cement (600'-420')
40 sacks cement (300'-120')
10 sacks cement (40'-31')
10 sacks rathole
10 sacks mousehole
Heavy mud between plugs
Weld on plate and date.

RECEIVED
STATE CORPORATION COMMISSION
SEP 25 1980
CONSERVATION DIVISION
Wichita, Kansas

(If additional description is necessary, use BACK of this sheet)
Name of Plugging Contractor Rine Drilling Co.
Address Wichita, Kansas

STATE OF _____ COUNTY OF _____ ss. _____

(employee of owner) or (owner or operator) of the above-described well, being first duly sworn on oath, says: That I have knowledge of the facts, statements, and matters herein contained and the log of the above-described well as filed and that the same are true and correct. So help me God.

(Signature) Robert W. Ward
P.O. Box 249, Woodward, Okla. 73801
(Address)

Subscribed and sworn to before me this 17th day of September, 19 80

My commission expires 4-8-84
Notary Public.

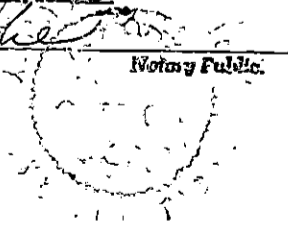

GIRK #2-11:

SW SW
11 34S 20W
Comanche County, Kansas

Contractor: RINE DRILLING COMPANY

Started: September 1, 1980

Completed: September 16, 1980

LOG

| | | |
|---------------------|---------|-------|
| Surface | 0 - | 75' |
| Red Bed & Gypsum | 75 - | 275' |
| Red Bed | 613 - | 1500' |
| | | |
| Red Bed & Anhydrite | 1500 - | 2270' |
| Dolomite | 2270 - | 2425' |
| Dolomite & Lime | 2425 - | 2577' |
| Lime | 2577 - | 2785' |
| Lime & Shale | 2785' - | 5300' |

Ran 15 jts., 8 5/8" csg., set @ 608', cmt w/ 250 sx lt., 3% c.c. 1/4# flo, + 150 sx A, 2% gel, 3% c.c. 1/4# flo.
 TOTCO 1/2° @ 560'
 TOTCO 1° @ 2270'

TOTCO 3/4° @ 4770', 1° @ 5300'.
 Plugged and abandoned as follows:
 Through open end D.P.
 50 sx cmt @ 600'
 40 sx cmt @ 300'
 10 sx cmt. from 40' to -3'
 10 sx in RH
 10 sx in MH
 Job complete @ 8:00 PM 9/15/80
 Kansas State Plugger:
 Bill Owens
 Pratt, Kansas

STATE OF KANSAS:)
) ss:
 SEDGWICK COUNTY :)

RECEIVED
 STATE CORPORATION COMMISSION
 SEP 25 1980
 9-25-80
 CONSERVATION DIVISION
 Wichita, Kansas

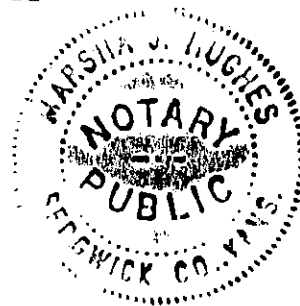

I, E.J. Rine, do hereby certify that the above is a true and accurate log of the GIRK #2-11, located SW SW 11 34S 20W, Comanche County, Kansas.

E.J. Rine
 E.J. Rine, President

Subscribed and sworn to before me this 17th day of September, 1980.

Marsha J. Hughes
 Marsha J. Hughes, Notary Public

My appointment expires: 6-20-84

WELL COMPLETION REPORT AND DRILLER'S LOG

S. 11 T. 34 R. 20 E
W

Loc. C SW SW

County Comanche

API No. 15 — 033 — 20,363-0000
County Number

Operator
Inter North Inc.

Address
P. O. Box 35288 Tulsa, Okla 74135

Well No. #2 Lease Name Girk II

Footage Location
660 feet from ~~XX~~ (S) line 660 feet from (X) (W) line

Principal Contractor Rine Drilling Geologist

Spud Date 9/1/80 Date Completed 9/15/80 Total Depth 5300' P.B.T.D.

Directional Deviation Oil and/or Gas Purchaser
Dry Hole

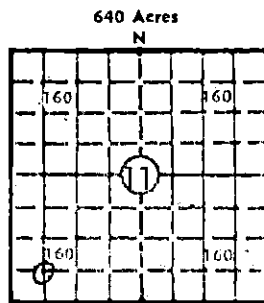

Locate well correctly

Elev.: Gr. 1772'

DF. 1782' KB 1784'

CASING RECORD

Report of all strings set — surface, intermediate, production, etc.

| Purpose of string | Size hole drilled | Size casing set (in O.D.) | Weight lbs/ft. | Setting depth | Type cement | Sacks | Type and percent additives |
|-------------------|-------------------|---------------------------|----------------|---------------|-------------------------|------------|----------------------------|
| Surface | 12 1/4" | 8-5/8" | 24.00# | 608' | Haliburton lite Class A | 250 150 | |
| | | | | | | | |
| | | | | | | | |
| | | | | | | | |

LINER RECORD

PERFORATION RECORD

| Top, ft. | Bottom, ft. | Sacks cement | Shots per ft. | Size & type | Depth interval |
|----------|-------------|--------------|---------------|-------------|----------------|
| | | | | | |
| | | | | | |
| | | | | | |

TUBING RECORD

| Size | Setting depth | Packer set at |
|------|---------------|---------------|
| | | |
| | | |

ACID, FRACTURE, SHOT, CEMENT SQUEEZE RECORD

Amount and kind of material used

RECEIVED
STATE CORPORATION COMMISSION
SEP 25 1980
7-25-80
CONSERVATION DIVISION
Wichita, Kansas

INITIAL PRODUCTION

| | | | | | |
|--|---|------------|-----------------------|---------------|------|
| Date of first production <u>None</u> | Producing method (flowing, pumping, gas lift, etc.) | | | | |
| RATE OF PRODUCTION PER 24 HOURS | Oil bbls. | Gas MCF | Water bbls. | Gas-oil ratio | CFPB |
| Disposition of gas (vented, used on lease or sold) | | | Producing interval(s) | | |

INSTRUCTIONS: As provided in KCC Rule 82-2-125, within 90 days after completion of a well, one completed copy of this Drillers Log shall be transmitted to the State Geological Survey of Kansas, 4150 Monroe Street, Wichita, Kansas 67209. Copies of this form are available from the Conservation Division, State Corporation Commission, 245 No. Water, Wichita, Kansas 67202. Phone AC 316-522-2206. If confidential custody is desired, please note Rule 82-2-125. Drillers Logs will be on open file in the Oil and Gas Division, State Geological Survey of Kansas, Lawrence, Kansas 66044.

15-033-20363-0000

| | | |
|--|-----------------------|--|
| Operator | | DESIGNATE TYPE OF COMP.: OIL, GAS, DRY HOLE, SWDW, ETC.: |
| Well No. 2 | Lease Name Girk 11 | Dry |
| S 11 T 34S R 20 ^{XX} _W | | |

WELL LOG

Show all important zones of porosity and contents thereof; cored intervals, and all drill-stem tests, including depth interval tested, cushion used, time tool open, flowing and shut-in pressures, and recoveries.

SHOW GEOLOGICAL MARKERS, LOGS RUN, OR OTHER DESCRIPTIVE INFORMATION.

| FORMATION DESCRIPTION, CONTENTS, ETC. | TOP | BOTTOM | NAME | DEPTH |
|--|-----|--------|------|-------|
| <p>Ran Compensated Neutron-Formation Density & Dual Induction-Laterolog</p> <p><u>DST #1, 4744-70' (Misrun)</u> Open 30 mins, wk b/w & died, SI 60 mins Open 15 mins plugged.</p> <p><u>DST #2, 4744-70'</u> Open 30 mins IF 239-239 psi Closed 60 mins ISI 445 psi Open 60 mins FF 239-239 psi Closed 120 mins FSI 496 psi Weak blow thru out tst. Rec 390' very sli O&GCM.</p> <p><u>DST #3, 4752-84'</u> Open 60 mins IF 116-155 psi Closed 120 mins ISI 406 psi Open 120 mins FF 155-174 psi Closed 4 hrs FSI 406 psi Rec 120' very sli O&GCM.</p> | | | | |

RECEIVED
STATE CORPORATION COMMISSION
SEP 25 1980
9-25-80
CONSERVATION DIVISION
Wichita, Kansas

USE ADDITIONAL SHEETS, IF NECESSARY, TO COMPLETE WELL RECORD.

| | |
|---------------|---------------------|
| Date Received | <i>Bob Hammerly</i> |
| | Signature |
| | Production Manager |
| | Title |
| | 9/19/80 |
| | Date |