



KANSAS CORPORATION COMMISSION 1084903
OIL & GAS CONSERVATION DIVISION

Form ACO-4
Form must be typed
March 2009

APPLICATION FOR COMMINGLING OF **Commingling ID # CO081203**
PRODUCTION (K.A.R. 82-3-123) OR FLUIDS (K.A.R. 82-3-123a)

OPERATOR: License # 33343
Name: PostRock Midcontinent Production LLC
Address 1: Oklahoma Tower
Address 2: 210 Park Ave, Ste 2750
City: OKLAHOMA CITY State: OK Zip: 73102 + _____
Contact Person: CLARK EDWARDS
Phone: (620) 432-4200

API No. 15 - 15-205-25902-00-00
Spot Description: _____
SE NW NE NE Sec. 16 Twp. 29 S. R. 16 East West
653 Feet from North / South Line of Section
753 Feet from East / West Line of Section
County: Wilson
Lease Name: WASSON FLOYD Well #: 16-1

1. Name and upper and lower limit of each production interval to be commingled:
Formation: SUMMIT (Perfs): 611-614
Formation: MULKY (Perfs): 625-629
Formation: CATTLEMAN (Perfs): 772-776
Formation: CATTLEMAN (Perfs): 799-812
Formation: _____ (Perfs): _____

2. Estimated amount of fluid production to be commingled from each interval:
Formation: SUMMIT BOPD: 0 MCFPD: 0 BWPD: 20
Formation: MULKY BOPD: 0 MCFPD: 0 BWPD: 20
Formation: CATTLEMAN BOPD: 1.5 MCFPD: 0 BWPD: 10
Formation: CATTLEMAN BOPD: 1.5 MCFPD: 0 BWPD: 10
Formation: _____ BOPD: _____ MCFPD: _____ BWPD: _____

3. Plat map showing the location of the subject well, all other wells on the subject lease, and all wells on offsetting leases within a 1/2 mile radius of the subject well, and for each well the names and addresses of the lessee of record or operator.

4. Signed certificate showing service of the application and affidavit of publication as required in K.A.R. 82-3-135a.

For Commingling of PRODUCTION ONLY, include the following:

5. Wireline log of subject well. Previously Filed with ACO-1: Yes No
 6. Complete Form ACO-1 (Well Completion form) for the subject well.

For Commingling of FLUIDS ONLY, include the following:

7. Well construction diagram of subject well.
 8. Any available water chemistry data demonstrating the compatibility of the fluids to be commingled.

AFFIDAVIT: I am the affiant and hereby certify that to the best of my current information, knowledge and personal belief, this request for commingling is true and proper and I have no information or knowledge, which is inconsistent with the information supplied in this application.

Submitted Electronically

KCC Office Use Only	
<input type="checkbox"/> Denied	<input checked="" type="checkbox"/> Approved
15-Day Periods Ends: <u>8/16/2012</u>	
Approved By: <u>Rick Hestermann</u>	Date: <u>08/16/2012</u>

Protests may be filed by any party having a valid interest in the application. Protests must be in writing and comply with K.A.R. 82-3-135b and must be filed within 15 days of publication of the notice of application.



PostRock

Wellbore Schematic

WELL: Wasson, Floyd 16-1
 SSI: 606900
 API: 15-205-25902-00-00
 LOCATION: NE NE Sec. 16-29S-16E
 COUNTY: Wilson
 STATE: Kansas

Casing	8.625" @ 20' 4.5" 10.5# J-55, 4.05" ID w/ 0.0159 bbl/ft capacity @ 895'
Perforations	Original Perfs: 12/7/2004 - Summit 611-614.5 (15) - Mulky 625-629 (17)
Completions	Completion Date: 12/27/2004 Summit/Mulky: - 15309# 20/40 - 500 gal 15% - 366 bbls - 12 bpm

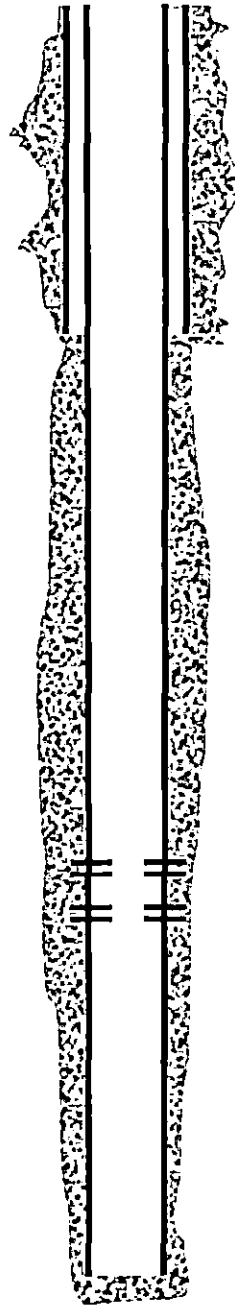

TOC - Surface

8.625" @ 20'

4.5" 10.5# @ 895'
95 sks cement

TD - 897'

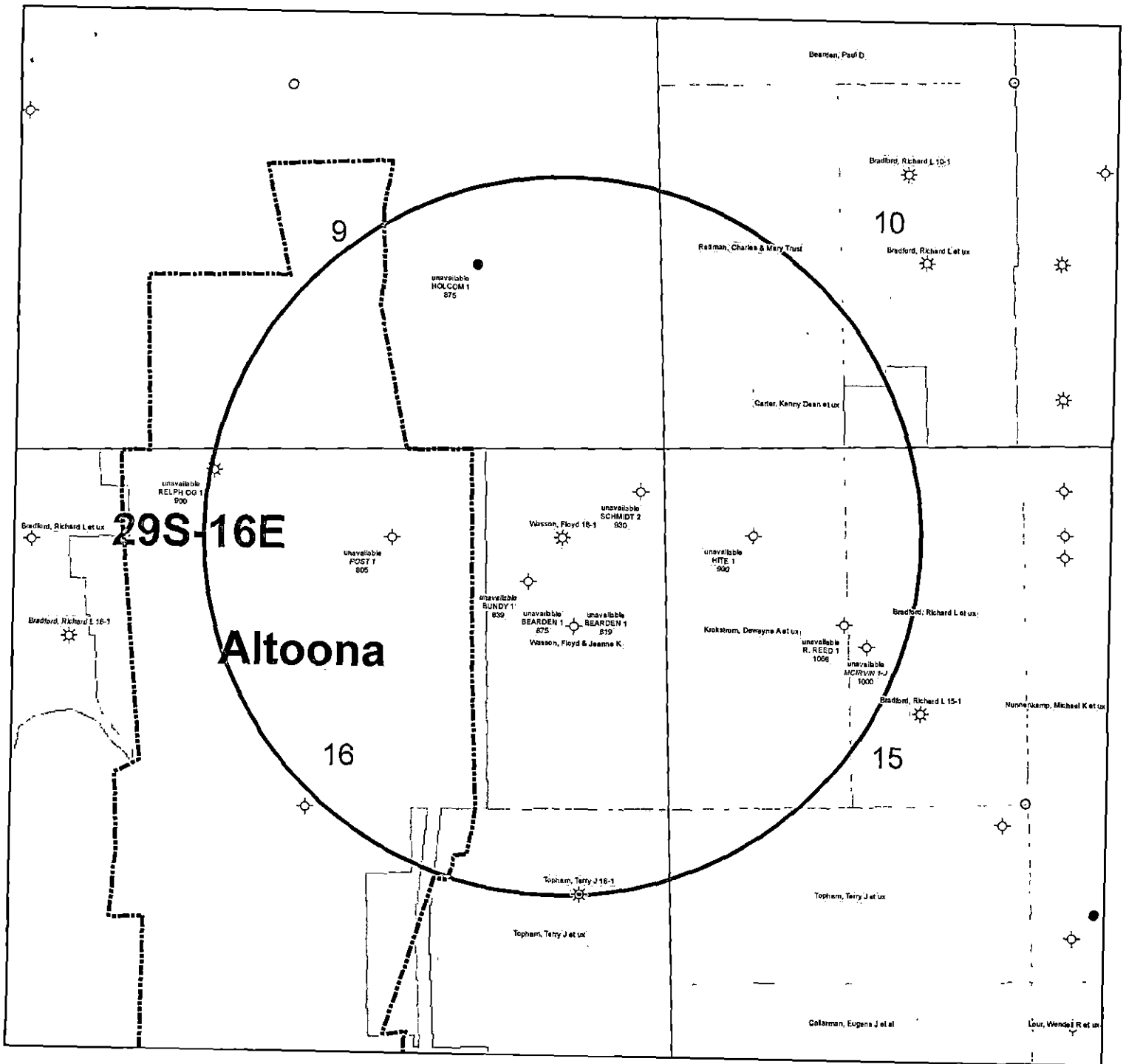

KGS STATUS	
◇	DA/PA
⊕	EOR
⊛	GAS
△	INJ/SWD
●	OIL
✱	OIL/GAS
○	OTHER

Wasson, Floyd 16-1
 16-29S-16E
 1" = 1,000'

	A	B	C	D	E	F	G	H	I	J	K
1	Produced Fluids #		1	2	3	4	5		Click here to run SSP Click Click Goal Seek SSP Click		
2	Parameters	Units	Input	Input	Input	Input	Input				
3	Select the brines	Select fluid by checking the box(es),	<input type="checkbox"/>	<input type="checkbox"/>	<input type="checkbox"/>	<input type="checkbox"/>	<input type="checkbox"/>	Mixed brine: Cell H28 is STP calc. pH.			
4	Sample ID							Cells H35-38 are used in mixed brines calculations.			
5	Date		3/19/2012	3/4/2012	3/14/2012	1/20/2012	1/20/2012				
6	Operator	Row 3	PostRock	PostRock	PostRock	PostRock	PostRock				
7	Well Name		Ward Feed	Ward Feed	Clinesmith	Clinesmith	Clinesmith				
8	Location		#34-1	#4-1	#5-4	#1	#2				
9	Field		CBM	CBM	Bartles	Bartles	Bartles				
10	Na ⁺	(mg/l)*	19,433.00	27,381.00	26,534.00	25689.00	24220.00	24654.20	Initial(BH)	Final(WH)	SLSR (Final-Initial)
11	K ⁺ (if not known =0)	(mg/l)						0.00	Saturation Index values		
12	Mg ²⁺	(mg/l)	1,096.00	872.00	1,200.00	953.00	858.00	995.91	Calcite		
13	Ca ²⁺	(mg/l)	1,836.00	2,452.00	2,044.00	1920.00	1948.00	2040.23	-0.73	-0.60	0.13
14	Str ²⁺	(mg/l)						0.00	Barite		
15	Ba ²⁺	(mg/l)						0.00	Halite		
16	Fe ²⁺	(mg/l)	40.00	21.00	18.00	82.00	90.00	50.21	Halite		
17	Zn ²⁺	(mg/l)						0.00	-1.77	-1.80	-0.03
18	Pb ²⁺	(mg/l)						0.00	Gypsum		
19	Cl ⁻	(mg/l)	36,299.00	48,965.00	47,874.00	45632.00	43147.00	44388.44	-3.19	-3.18	0.00
20	SO ₄ ²⁻	(mg/l)	1.00	1.00	8.00	1.00	1.00	2.40	Hemihydrate		
21	F ⁻	(mg/l)						0.00	-3.96	-3.90	0.06
22	Br ⁻	(mg/l)						0.00	Anhydrite		
23	SiO ₂	(mg/l) SiO ₂						0.00	-3.47	-3.36	0.12
24	HCO ₃ Alkalinity**	(mg/l as HCO ₃)	190.00	234.00	259.00	268.00	254.00	241.03	Celestite		
25	CO ₃ Alkalinity	(mg/l as CO ₃)							Iron Sulfide		
26	Carboxylic acids**	(mg/l)						0.00	Iron Sulfide		
27	Ammonia	(mg/L) NH ₃						0.00	-0.16	-0.22	-0.06
28	Borate	(mg/L) H ₃ BO ₃						0.00	Zinc Sulfide		
29	TDS (Measured)	(mg/l)						72781			
30	Calc. Density (STP)	(g/ml)	1.038	1.051	1.050	1.048	1.045	1.047	Calcium fluoride		
31	CO ₂ Gas Analysis	(%)	19.97	18.76	22.41	35.53	33.79	26.16			
32	H ₂ S Gas Analysis***	(%)	0.0289	0.0292	0.0296	0.0306	0.0151	0.0269	Iron Carbonate		
33	Total H ₂ Saq	(mgH ₂ S/l)	1.00	1.00	1.00	1.00	0.50	0.90	-0.74	-0.51	0.23
34	pH, measured (STP)	pH	5.67	5.76	5.72	5.54	5.55	5.63	Inhibitor needed (mg/L)		
	Choose one option to calculate SI?	0-CO ₂ +Alk, 1-pH+Alk, 2-CO ₂ +pH							Calcite	NTMP	
35	Gas/day(thousand cf/day)	(Mcf/D)	0	0	0	0	0	0	0.00	0.00	
36	Oil/Day	(B/D)	0	0	1	1	1	4	Barite	BHPMP	
37	Water/Day	(B/D)	100	100	100	100	100	500	0.00	0.00	
38	For mixed brines, enter values for temperatures and pressures in Cells (H40-H43)								(Enter H40-H43)		
40	Initial T	(F)	66.0	71.0	70.0	41.0	49.0	60.0	5.69	5.60	
41	Final T	(F)	66.0	71.0	70.0	41.0	49.0	89.0	Viscosity (CentiPoise)		
42	Initial P	(psia)	25.0	25.0	25.0	25.0	25.0	25.0	1.196	0.826	
43	Final P	(psia)	25.0	25.0	25.0	25.0	25.0	120.0	Heat Capacity (cal/ml/C)		
44	Use TP on Calcite sheet?	1-Yes;0-No							0.955	0.959	
45	API Oil Grav.	API grav.						30.00	Inhibitor needed (mg/L)		
46	Gas Sp.Grav.	Sp.Grav.						0.60	Gypsum	HDTMP	
47	MeOH/Day	(B/D)	0					0	0.00	0.00	
48	MEG/Day	(B/D)	0					0	Anhydrite	HDTMP	
49	Conc. Multiplier								0.00	0.00	
50	H ⁺ (Strong acid) ¹	(N)									
51	OH ⁻ (Strong base) ¹	(N)									
52	Quality Control Checks at STP:										
53	H ₂ S Gas	(%)									
54	Total H ₂ Saq (STP)	(mgH ₂ S/l)									
55	pH Calculated	(pH)									
56	PCO ₂ Calculated	(%)									
57	Alkalinity Calculated	(mg/l) as HCO ₃									
58	ΣCations=	(equiv./l)									
59	ΣAnions=	(equiv./l)									
60	Calc TDS=	(mg/l)									
61	Inhibitor Selection	Input	Unit	#	Inhibitor	Unit Converter (From metric to English)			Value		
62	Protection Time	120	min	1	NTMP	From Unit	Value	To Unit	Value		
63	Have ScaleSoftPitizer			2	BHPMP	°C	80	°F	176		
64	pick inhibitor for you?	1	1-Yes;0-No	3	PAA	m ³	100	ft ³	3,531		
65	If No, inhibitor # is:	4	#	4	DTPMP	m ³	100	bb(42 US gal)	629		
66	If you select Mixed,			5	PPCA	MPa	1,000	psia	145,074		
67	1 st inhibitor # is:	1	#	6	SPA	Bar	496	psia	7,194		
68	% of 1 st inhibitor is:	50	%	7	HEDP	Torr	10,000	psia	193		
69	2 nd inhibitor # is:	2	#	8	HDTMP	Gal	10,000	bb(42 US gal)	238		
70	Display act. coeffs?	0	1-Yes;0-No	9	Average	Liters	10,000	bb(42 US gal)	63		
71				10	Mixed						

Saturation Index Calculations

Champion Technologies, Inc.

(Based on the Tomson-Oddo Model)

Brine 1: Ward Feed Yard 34-1

Brine 2: Ward Feed Yard 4-1

Brine 3: Clinesmith 5-4

Brine 4: Clinesmith 1

Brine 5: Clinesmith 2

Component (mg/L)	Ratio					Mixed Brine
	20% Brine 1	20% Brine 2	20% Brine 3	20% Brine 4	20 Brine 5	
Calcium	1836	2452	2044	1920	1948	1952
Magnesium	1096	872	1200	953	858	865
Barium	0	0	0	0	0	0
Strontium	0	0	0	0	0	0
Bicarbonate	190	234	259	268	254	253
Sulfate	1	1	8	1	1	1
Chloride	36299	48965	47874	45632	43147	43206
CO ₂ in Brine	246	220	264	422	405	401
Ionic Strength	1.12	1.48	1.46	1.38	1.31	1.31
Temperature (°F)	89	89	89	89	89	89
Pressure (psia)	50	50	120	120	120	119

Saturation Index

Calcite	-1.71	-1.41	-1.48	-1.68	-1.69	-1.69
Gypsum	-3.71	-3.64	-2.82	-3.73	-3.72	-3.69
Hemihydrate	-3.70	-3.65	-2.83	-3.74	-3.71	-3.69
Anhydrite	-3.89	-3.79	-2.97	-3.89	-3.88	-3.85
Barite	N/A	N/A	N/A	N/A	N/A	N/A
Celestite	N/A	N/A	N/A	N/A	N/A	N/A

PTB

Calcite	N/A	N/A	N/A	N/A	N/A	N/A
Gypsum	N/A	N/A	N/A	N/A	N/A	N/A
Hemihydrate	N/A	N/A	N/A	N/A	N/A	N/A
Anhydrite	N/A	N/A	N/A	N/A	N/A	N/A
Barite	N/A	N/A	N/A	N/A	N/A	N/A
Celestite	N/A	N/A	N/A	N/A	N/A	N/A

**KANSAS CORPORATION COMMISSION
OIL & GAS CONSERVATION DIVISION
WELL COMPLETION FORM
WELL HISTORY - DESCRIPTION OF WELL & LEASE**

Form ACO-1
September 1999
Form Must Be Typed

ORIGINAL

Operator: License # 33344
 Name: Quest Cherokee Oilfield Service, LLC
 Address: 211 W. 14th Street
 City/State/Zip: Chanute, KS 66720
 Purchaser: Bluestem Pipeline, LLC
 Operator Contact Person: Richard Marlin
 Phone: (620) 431-9500
 Contractor: Name: MOKAT Drilling
 License: SB31
 Wellsite Geologist: Michael L. Ebers
 Designate Type of Completion:
 New Well Re-Entry Workover
 Oil SWD SLOW Temp. Abd.
 Gas ENHR SIGW
 Dry Other (Core, WSW, Expl., etc., show depth set _____ Feet)
 If Workover/Re-entry: Old Well Info as follows:
 Operator: _____
 Well Name: _____
 Original Comp. Date: _____ Original Total Depth: _____
 Deepening Re-perf. Conv. to Enhr./SWD
 Plug Back Plug Back Total Depth
 Commingled Docket No. _____
 Dual Completion Docket No. _____
 Other (SWD or Enhr.?) Docket No. _____
 11/3/04 11/4/04 11/12/04
 Spud Date or Date Reached TD Completion Date or
 Recompletion Date Recompletion Date

API No. 15 - 205-25902-0000
 County: Wilson
 _____ ne ne Sec. 16 Twp. 29 S. R. 16 East West
660 feet from S / N (circle one) Line of Section
800 feet from E W (circle one) Line of Section
 Footages Calculated from Nearest Outside Section Corner:
 (circle one) NE SE NW SW
 Lease Name: Wasson, Floyd Well #: 16-1
 Field Name: Cherokee Basin CBM
 Producing Formation: Summit/Mulky
 Elevation: Ground: 816 Kelly Bushing: _____
 Total Depth: 897 Plug Back Total Depth: 895.07'
 Amount of Surface Pipe Set and Cemented at 20.4' Feet
 Multiple Stage Cementing Collar Used? Yes No
 If Alternate II completion, cement circulated from 895.07
 feet depth to surface w/ 95 _____ sx cmt.
ALT II within 2-22-07
 Drilling Fluid Management Plan
 (Date must be collected from the Reserve Pit)
 Chloride content _____ ppm Fluid volume _____ bbls
 Dewatering method used _____
 Location of fluid disposal-if hauled offsite:
 Operator Name: _____
 Lease Name: _____ License No.: _____
 Quarter _____ Sec. _____ Twp. _____ S. R. _____ East West
 County: _____ Docket No.: _____

RECEIVED
 KANSAS CORPORATION COMMISSION
 APR 12 2005
 CONSERVATION DIVISION
 WICHITA, KS

INSTRUCTIONS: An original and two copies of this form shall be filed with the Kansas Corporation Commission, 130 S. Market - Room 2078, Wichita, Kansas 67202, within 120 days of the spud date, recompletion, workover or conversion of a well. Rule 82-3-130, 82-3-106 and 82-3-107 apply. Information of side two of this form will be held confidential for a period of 12 months if requested in writing and submitted with the form (see rule 82-3-107 for confidentiality in excess of 12 months). One copy of all wireline logs and geologist well report shall be attached with this form. ALL CEMENTING TICKETS MUST BE ATTACHED. Submit CP-4 form with all plugged wells. Submit CP-111 form with all temporarily abandoned wells.

All requirements of the statutes, rules and regulations promulgated to regulate the oil and gas industry have been fully complied with and the statements herein are complete and correct to the best of my knowledge.

Signature: Richard Marlin
 Title: Chief Operating Officer Date: 4/8/05
 Subscribed and sworn to before me this 8th day of April
 20 05.
 Notary Public: Jennifer R. Houston
 Date Commission Expires: 7/30/05
 JENNIFER R. HOUSTON
 Notary Public - State of Kansas
 My Appt. Expires 7/30/05

KCC Office Use ONLY

_____ Letter of Confidentiality Received
 If Denied, Yes Date: _____
 _____ Wireline Log Received
 _____ Geologist Report Received
 _____ UIC Distribution

✓

Operator Name: Quest Cherokee Oilfield Service, LLC Lease Name: Wasson, Floyd Well #: 16-1
 Sec. 16 Twp. 29 S. R. 16 East West County: Wilson

INSTRUCTIONS: Show important tops and base of formations penetrated. Detail all cores. Report all final copies of drill stems tests giving interval tested, time tool open and closed, flowing and shut-in pressures, whether shut-in pressure reached static level, hydrostatic pressures, bottom hole temperature, fluid recovery, and flow rates if gas to surface test, along with final chart(s). Attach extra sheet if more space is needed. Attach copy of all Electric Wireline Logs surveyed. Attach final geological well site report.

Drill Stem Tests Taken <i>(Attach Additional Sheets)</i>	<input type="checkbox"/> Yes <input checked="" type="checkbox"/> No	<input checked="" type="checkbox"/> Log Formation (Top), Depth and Datum	<input type="checkbox"/> Sample
Samples Sent to Geological Survey	<input type="checkbox"/> Yes <input checked="" type="checkbox"/> No	Name	Top Datum
Cores Taken	<input type="checkbox"/> Yes <input checked="" type="checkbox"/> No	Lenapah Lime	376 +442
Electric Log Run <i>(Submit Copy)</i>	<input checked="" type="checkbox"/> Yes <input type="checkbox"/> No	Altamont Lime	415 +403
List All E. Logs Run:		Pawnee Lime	519 +299
Comp Density/Neutron Dual Induction Gamma Ray/Neutron Log		Oswego Lime	588 +230
		Verdigris Lime	704-1/2 +113-1/2

CASING RECORD <input type="checkbox"/> New <input type="checkbox"/> Used							
Report all strings set-conductor, surface, intermediate, production, etc.							
Purpose of String	Size Hole Drilled	Size Casing Set (In O.D.)	Weight Lbs./ Ft.	Setting Depth	Type of Cement	# Sacks Used	Type and Percent Additives
Surface	11"	8-5/8"	24.75#	20.4'	"A"	4sx	
Production	6 3/4"	4 1/2"	10.5#	895.07'	"A"	95sx	

ADDITIONAL CEMENTING / SQUEEZE RECORD			
Purpose:	Depth Top Bottom	Type of Cement	#Sacks Used Type and Percent Additives
<input type="checkbox"/> Perforate <input type="checkbox"/> Protect Casing <input type="checkbox"/> Plug Back TD <input type="checkbox"/> Plug Off Zone			RECEIVED KANSAS CORPORATION COMMISSION APR 12 2005

PERFORATION RECORD - Bridge Plugs Set/Type		Acid, Fracture, Shot, Cement Squeeze Record	
Shots Per Foot	Specify Footage of Each Interval Perforated	(Amount and Kind of Material Used)	Depth
4	611-614.5 & 625-629	366 bbls gelled water & 15309# 20/40 sand frac	611-614.5 & 625-629

TUBING RECORD		Size	Set At	Packer At	Liner Run
		2-3/8"		n/a	<input type="checkbox"/> Yes <input checked="" type="checkbox"/> No
Date of First, Resumerd Production, SWD or Enhr.		Producing Method			
3/16/05		<input type="checkbox"/> Flowing <input checked="" type="checkbox"/> Pumping <input type="checkbox"/> Gas Lift <input type="checkbox"/> Other (Explain)			
Estimated Production Per 24 Hours	Oil Bbls.	Gas Mcf	Water Bbls.	Gas-Oil Ratio	Gravity
	n/a	0	0		

Disposition of Gas Vented Sold Used on Lease (If vented, Submit ACO-18.)

METHOD OF COMPLETION Open Hole Perf. Dually Comp. Commingled Other (Specify) _____

Production Interval _____

CHANUTE, KS 66720
620-331-9500

LOCATION Chanute, ks
FARMIAN John Michals

TREATMENT REPORT & FIELD TICKET
CEMENT

DATE	CUSTOMER #	WELL NAME & NUMBER	SECTION	TOWNSHIP	RANGE	COUNTY
11-12-2004		Wasson, Floyd #16-1	16	295	165	W6

FOREMAN OPERATOR	TIME IN	TIME OUT	LESS LUNCH	TRUCK #	TRUCK HOURS	EMPLOYEE SIGNATURE
John M	6:34	11:30	No	348	4.5	[Signature]
Wes T	6:58	11:30	No	197	4	Wesley Smith
Simmy H	6:50	11:30	No	103	4	[Signature]
Tim A	6:51	11:30	No	140	4	[Signature]
Rodney A	6:50	11:30	No	286	4	Rodney

3. TYPE Long string HOLE SIZE 6 3/4 HOLE DEPTH 897 CASING SIZE & WEIGHT 4 1/2 / 10.5
 CASING DEPTH 895 DRILL PIPE _____ TUBING _____ OTHER _____
 SLURRY WEIGHT 13.8 SLURRY VOL _____ WATER gal/sk _____ CEMENT LEFT in CASING 0
 DISPLACEMENT 14.2 DISPLACEMENT PSI 800 MIX PSI 100 RATE _____

REMARKS: Circulate with fresh H₂O. Ran 2 Gel ahead. Ran 9 BB18 Dye with 15 Gallons sodium silicate. Cement until dye return. Flush pump. pump plug with K.C.L. Water set float shoe.
Boat on location to move crews in, around, and out of location. Muddy & soft pasture.

ACCOUNT CODE	QUANTITY or UNITS	DESCRIPTION of SERVICES or PRODUCT	UNIT PRICE	TOTAL
	# 348	Foreman Pickup		
	# 197	Cement Pump Truck		
	# 103	Bulk Truck		
1110	10 sks	Gilsonite		
1107	1 sks	Flo-Seal		
1118	2 sks	Premium Gel		
1215A	1 gal	KCL		
1111B	15 gal's	Sodium Silicate		
1123	5,880 gal's	City Water <u>140 BBL</u>		
	# 140	Transport		
	# 286	80 Vac		
	85 sks	Cement. <u>95 sks w/additives</u>		
		<u>w/out additives</u>		
				SALES TAX
				ESTIMATED
				TOTAL

HORIZION _____

TITLE _____

DATE _____

Quest Cherokee LLC Cementing Report

Date: 11-12-2004

Well: Wassen, Floyd # 16-1 Legals 16-295-16E Wilson Co.

RE: Run & Cement Longstring-Notified Becke at KCC Office- 11/12/04 @ 8:10 (AM) PM

Time:

- 1 7:30 AM Team- G + 5 oil -on location and rig up
- 2 7:48 AM Buckeye on location and spot casing trailer
- 3 8:25 AM Team- G + 3 oil -TIH w/ 895.07 ft of casing
- 3 7:55 AM QCOS on location and rig up
- 5 9:10 AM Team- G + 3 oil -Hit fill approx. 55 ft from T.D.
- 6 9:35 AM QCOS wash casing to T.D. and circulate 2 sks gel to surface
Wash time 9:10 A.M - 10:00 A.M (50 min) w/ 60' cyclo. clean hole
- 7 9:40 AM Team- G + 3 oil -Land casing
- 8 10:15 AM Team- G + 3 oil -Rig down and off location
- 9 10:30 AM QCOS- pump- Circulate W/ fresh H2O, run 9 bbl dye with 15 gal sodium silicate, cement until dye return, flush pump, pump plug W/ KCL water, set float shoe

10 11:30 AM QCOS Rig down and off location

CEMENT SLURRY:

Total Cement: 95 sks
 Cement blend: OWC, 5# Gilsonite, 1/4# Flo-Seal
 Cement slurry weight: 13.8
 Average Surface Pressure:
 Running cement circulation pressure: 100
 Pumping plug circulation pressure: 800
 Circulation during job: Good

RECEIVED
KANSAS CORPORATION COMMISSION

APR 12 2005

CONSERVATION DIVISION
WICHITA, KS

HOLE/CASING/FLOAT EQUIPMENT SUMMARY:

Hole Size & Depth: 6 3/4" - 897'
 Casing Size & Depth: New 4 1/2" 10.5# per/ft. Range 3-plus shoe- 895.07

- 852 Centralizer
- 714 Basket
- 554 Centralizer
- 383 Basket
- 170 Centralizer

1 ea 4 1/2" Latch-Down Float Shoe w/ Notch Collar on bottom & 4 1/2" Latch-Down Plug

Dozer on location to move crews in, around, and out of muddy - soft pasture location.

AFFIDAVIT

STATE OF KANSAS \
- SS.
County of Sedgwick /

Mark Fletchall, of lawful age, being first duly sworn, deposeth and saith: That he is Record Clerk of The Wichita Eagle, a daily newspaper published in the City of Wichita, County of Sedgwick, State of Kansas, and having a general paid circulation on a daily basis in said County, which said newspaper has been continuously and uninterruptedly published in said County for more than one year prior to the first publication of the notice hereinafter mentioned, and which said newspaper has been entered as second class mail matter at the United States Post Office in Wichita, Kansas, and which said newspaper is not a trade, religious or fraternal publication and that a notice of a true copy is hereto attached was published in the regular and entire Morning issue of said The Wichita Eagle for 1 issues, that the first publication of said notice was

made as aforesaid on the 21st of

June A.D. 2012, with

subsequent publications being made on the following dates:

And affiant further says that he has personal knowledge of the statements above set forth and that they are true.

Mark Fletchall

Subscribed and sworn to before me this

21st day of June, 2012

PENNY L. CASE
Notary Public - State of Kansas
My Appt. Expires 5/30/2014

Penny L. Case
Notary Public Sedgwick County, Kansas

Printer's Fee : \$130.00

LEGAL PUBLICATION
PUBLISHED IN THE WICHITA EAGLE
JUNE 21, 2012 (319)455
BEFORE THE STATE CORPORATION
COMMISSION OF THE STATE OF KANSAS
NOTICE OF FILING APPLICATION
RE: In the Matter of Postrock Midcontinent
Production, LLC Application for
Commencement of Production in the
Wasson, Floyd 16-1 located in Wilson
County, Kansas.
TO: All Oil & Gas Producers, Unleased
Mineral Interest Owners, Landowners,
and all persons whom ever concerned.
You, and each of you, are hereby notified
that Postrock Midcontinent Production, LLC
has filed an application to commence the
Mufky Summit and Catterman producing
formations of the Wasson, Floyd 16-1 located
in the SE 1/4 NW 1/4 NE 1/4 S16-T29S-R16E,
Approximately 653 FNL & 753 FEL, Wilson
County, Kansas.
Any persons who object to or protest
this application shall be required to file their
objections or protest with the Conservation
Division of the State Corporation Commission
of the State of Kansas within fifteen (15)
days from the date of this publication. Those
protests shall be filed pursuant to Commission
regulations and must state specific reasons
why granting the application may cause waste,
violate correlative rights or pollute the natural
resources of the State of Kansas.
All persons interested or concerned shall
take notice of the foregoing and shall govern
themselves accordingly. All person and/or
companies wishing to protest this application
are required to file a written protest with the
Conservation Division of the Kansas Oil and
Gas Commission.
Upon the receipt of any protest, the
Commission will convene a hearing and
protestants will be expected to enter an
appearance either through proper legal
counsel or as individuals, appearing on their
own behalf.
Postrock Midcontinent Production, LLC
210 Park Avenue, Suite 2750
Oklahoma City, Oklahoma 73102
(405) 660-7704

PROOF OF PUBLICATION

STATE OF KANSAS
Wilson County - SS

JOSEPH S. and RITA M. RELPH, of lawful age, being duly sworn upon oath that they are the Owners and Publishers of the WILSON COUNTY CITIZEN:

THAT said newspaper has been published at least weekly fifty (50) times a year and has been so published for at least five years prior to the first publication of the attached notice:

THAT said newspaper is a general circulation on a daily, or weekly, or monthly, or yearly basis in;

WILSON COUNTY, KANSAS and is NOT a trade, religious or fraternal publication and has been PRINTED and PUBLISHED in Wilson County, Kansas.

THE ATTACHED was published on the following dates in a regular issue of said newspaper:

- 1st publication was made on the 18th day of June, 2012
2nd publication was made on the ___ day of ___ .20___
3rd publication was made on the ___ day of ___ .20___
4th publication was made on the ___ day of ___ .20___
5th publication was made on the ___ day of ___ .20___
6th publication was made on the ___ day of ___ .20___

TOTAL PUBLICATION FEE: \$ 38.50

(Signed) Joseph S. Relph

Subscribed and sworn to before me, this 19th day of June, 2012

Rita M. Relph (Notary Public)

My commission expires Aug. 30, 2014

LEGAL NOTICE
(Published in the Wilson County Citizen on Monday, June 18, 2012)
BEFORE THE STATE CORPORATION COMMISSION OF THE STATE OF KANSAS
NOTICE OF FILING APPLICATION
RE: In the Matter of Postrock Midcontinent Production, LLC Application for Commencing of Production in the Wascon, Floyd 16-1 located in Wilson County, Kansas.
TO: All Oil & Gas Producers, Unleased Mineral Interest Owners, Landowners, and all persons whomsoever concerned.
You, and each of you, are hereby notified that Postrock Midcontinent Production, LLC has filed an application to commence the Mulky Summit and Cattleman producing formations at the Wascon, Floyd, 16-1, located in the SE NW NE NE, S16-T29S-R16E, Approximately 659 PNL & 753 FEL, Wilson County, Kansas.
Any persons who object to or protest this application shall be required to file their objections or protest with the Conservation Division of the State Corporation Commission of the State of Kansas within fifteen (15) days from the date of this publication. These protests shall be filed pursuant to Commission regulations and must state specific reasons why granting the application may cause waste, violate correlative rights or pollute the natural resources of the State of Kansas.
All persons interested or concerned shall take notice of the foregoing and shall govern themselves accordingly. All person and/or companies wishing to protest this application are required to file a written protest with the Conservation Division of the Kansas Oil and Gas Commission.
Upon the receipt of any protest, the Commission will convene a hearing and protestants will be expected to enter an appearance either through proper legal counsel or as individuals, appearing on their own behalf.
Postrock Midcontinent Production, LLC
210 Park Avenue, Suite 2760
Oklahoma City, Oklahoma 73104
(405) 660-7704
35 1 copy



Affidavit of Notice Served

Re: Application for: APPLICATION FOR COMMINGLING OF PRODUCTION OR FLUIDS ACO-4

Well Name: WASSON, FLOYD 16-1 Legal Location: SENWNE S16-T29S-R16E

The undersigned hereby certifies that he / she is a duly authorized agent for the applicant, and that on the day 1ST of AUGUST, 2012, a true and correct copy of the application referenced above was delivered or mailed to the following parties:

Note: A copy of this affidavit must be served as a part of the application.

Name

Address (Attach additional sheets if necessary)

SEE ATTACHED

I further attest that notice of the filing of this application was published in the WILSON COUNTY CITIZEN, the official county publication of WILSON county. A copy of the affidavit of this publication is attached.

Signed this 1ST day of AUGUST, 2012

Jeff L Morris
Applicant or Duly Authorized Agent

Subscribed and sworn to before me this 1ST day of AUGUST, 2012



Jennifer R Beal
Notary Public
My Commission Expires: July 20, 2016

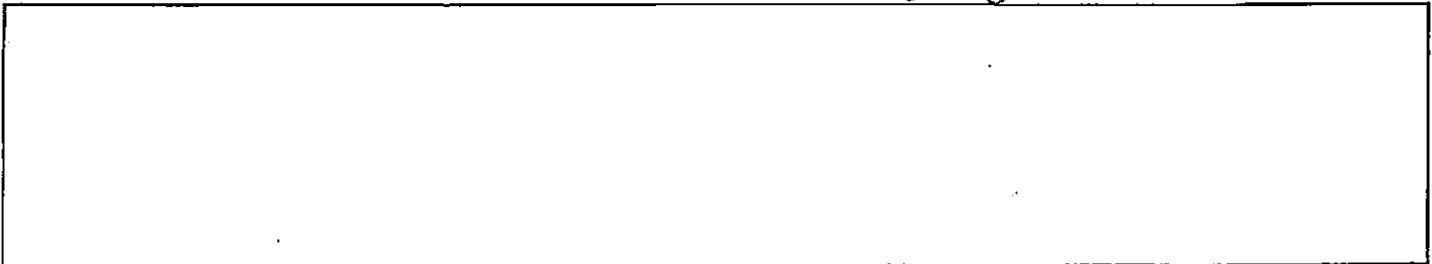

WASSON, FLOYD 16-1

9-29S-16E

ALLEN, RICHARD & JEANETTE	1430 N COMMERICAL ALTOONA, KS 66710
BEEMAN, GINGER	PO BOX 8 ALTOONA, KS 66710
BLEVENS, TINA	unknown
BONGIORNI, GARY	23586 K47 HWY THAYER, KS 66776
BUSSE, TIM & LINDA	P O BOX 156 ALTOONA, KS 66710
CITY OF ALTOONA	P O BOX 147 ALTOONA, KS 66710
COLLINS, JAMES J	1312 MAIN ALTOONA, KS 66710
DICKENS, LEWIS & BELLE	P O BOX 15 ALTOONA, KS 66710
DUDAS, BETTY	506 N 8TH NEODESHA, KS 66757
FARMER, KENNETH	1401 STATE ALTOONA, KS 66710
FARMER, KENNETH	P O BOX 102 ALTOONA, KS 66710
GING, LYNN D	Attn: GREEN, HAROLD 7722 OAKLAND AVE KANSAS CITY, KS 66112
GOOD, RICHARD & STELLA M	17248 K47 HWY ALTOONA, KS 66710
GREATER NEW LIFE MINISTERIES INC	P O BOX 126 ALTOONA, KS 66710
HOLLINGSWORTH, MYRA JANE	17750 HWY 47 ALTOONA, KS 66710
KDOT	700 SW HARRISON 14TH FL TOPEKA, KS 66603
MUSTAIN, DONALD & WANDA	P O BOX 23 ALTOONA, KS 66710
MYERS, DAVID L & DINAH L	P O BOX 172 ALTOONA, KS 66710
NUNNENKAMP, GARY & JEANETTE	1404 MAIN ALTOONA, KS 66710
RAYMOND, JAMES & STACY	P O BOX 236 ALTOONA, KS 66710
RELPH, DAVID L & TONI S	11740 QUINTER RD ALTOONA, KS 66710
ROHR, ROBERT L; MYERS, RHONDA D	1306 QUINCY ALTOONA, KS 66710
SHAY, EVA L & SMITH, ELLEN	1302 STATE ALTOONA, KS 66710
STANLEY, GARY L & PAMELA S	P O BOX 977 NEWTOWN, PA 18940
STATE HIGHWAY COMMISSION	411 W 14TH CHANUTE, KS 66720
THROCKMORTON, GEORGE & CAROL	P O BOX 22 ALTOONA, KS 66710
WHITSON, DANNY W	24692 900 RD THAYER, KS 66776

WASSON, FLOYD /6-1

16-29S-16E

ALLEN, CHRISTOPHER M & JUDY K
BABCOCK, BOB AND TONY
BANK OF NEW YORK MELLON TRUST COMPANY
BARNETT, CHARLES
BARNETT, TRAVIS L & PAMELA C
BARNHART, BERNADINE
BEISLY, RICHARD L & FERN
BELL, SALLY & DARGATZ, BONI
BENTLEY, DONNA L
BOLLIG, BARBARA MAY F/K/A;
BONER, JAY & CHRISTINA
BUCK, TAMARA
BUSSE, TIMOTHY, Sr
CARTER, WILLARD
CHEEVER, MARY L
CHURCH FIRST BAPTIST OF ALTOONA
CHURCH OF CHRIST TRUSTEES
CITY OF ALTOONA
CLAIBOURN, WARREN O & TERRY JD
CLIFFORD, WAYNE E
COFFEY, DEBORAH V
COLLINS, LUKE & CHEYENNE
CUTLER, CLOYD S
DANNELS, DAMON D
DANNELS, RICHARD E & LOIS E
DAVISSON, LYLE R. & PATRICIA O.
DORSEY, BRAD L & FAITH K
EASLEY, PATRICIA
FAY, SARAH J & SUMNER, SHIRLEY W
FORD, PATSY RUTH
FORSYTHE, MORRIS L
GARNER, JEFF
GEESEKA, GUY & ELISA
GLIDDEN, MATTHEW & SARINA
GOOD, COURTNEY; MAYHEW, MICHAEL
GOODSELL, DENNIS EUGENE & GOODSELL, NICOLE EVE
GREATER NEW LIFE MINISTERIES INC

PO BOX 252 NEODESHA, KS 66757
928 QUINCY ST ALTOONA, KS 66710
C/O GREEN TREE SERVICING LLC 330 RIDER TRAIL SOUTH STE 150 EARTH CITY, MO 63045
P O BOX 11 ALTOONA, KS 66710
P O BOX 67 ALTOONA, KS 66710
PO BOX 74 ALTOONA, KS 66710
702 QUINCY ALTOONA, KS 66710
P O BOX 1291 EL DORADO, KS 67042
P O BOX 127 ALTOONA, KS 66710
4805 140TH RD CHANUTE, KS 66720-5161
121 E 8TH ALTOONA, KS 66710
P O BOX 46 ALTOONA, KS 66710
1017 MAIN ST ALTOONA, KS 66710
11819 UDALL RD ALTOONA, KS 66710
P O BOX 271 ALTOONA, KS 66710
P O BOX 178 ALTOONA, KS 66710
11819 UDALL RD ALTOONA, KS 66710
P O BOX 147 ALTOONA, KS 66710
P O BOX 316 ALTOONA, KS 66710
731 QUINCY ALTOONA, KS 66710
P O BOX 43 ALTOONA, KS 66710
1214 MAIN ALTOONA, KS 66710
1304 N 8TH NEODESHA, KS 66757
208 8TH ALTOONA, KS 66710
P O BOX 81 ALTOONA, KS 66710
3146 N PENN INDEPENDENCE, KS 67301
105 E 10TH ALTOONA, KS 66710
211 E 8TH ST ALTOONA, KS 66710
P.O. BOX 5 ALTOONA, KS 66710
1100 S 13TH APT 128 PARSONS, KS 67357-3553
P O BOX 88 ALTOONA, KS 66710
914 JEFFERSON FREDONIA, KS 66736
P O BOX 100 ALTOONA, KS 66710
906 MAIN ALTOONA, KS 66710
126 E 13TH ALTOONA, KS 66710
P O BOX 129 ALTOONA, KS 66710
P O BOX 126 ALTOONA, KS 66710

WASSON, FLOYD 16 -1

16-29S-16E

GREEN, RONALD D
HARE, ROBERT A & MARTIN, CONNIE
HARPER, SCOTT & JUDY
HOLLOWAY, STEVEN T & HOLLOWAY, ADELINA B
HOLTZMAN, DALE & VERONICA
HOUGHTON, ARTHUR DALE & DONITA M
HUGHES, DAVID & MAVIS
JONES, RAYMOND & LORRIE
JONES, RAYMOND J
KNOBLE, MAYNARD
KNOBLE, MAYNARD & LINDA
LEE, ROGER
LETCHER, JAMES V
LOUIA, ROBERT E & ROBERTA
MARTIN, CONNIE J
MAYHEW, MICHAEL & GOOD, COURTNEY S
MCGAUGH, LAWRENCE W
MCGAUGH, WAYNE
MENTZER, RALPH
MILLER WAYNAKA D; PARKER SAMANTHA
MONTROYA, MICHAEL N
MOORE, RALPH & VELMA
MORGAN, JESSE WILL JR & KATIE
MUSTAIN, DONALD & WANDA
MUSTAIN, JOHNNY R
MYERS, DAVID L & DINAH L
MYERS, ROBERT A & BRANDY L
MYRES, NICCI R
NALLEY, JEFFERY
NALLEY, RANDALL L
NEESE, DALE
P.F.C. RENTALS, LLC
PERKINS, JOLANDA S
PFC RENTALS LLC
PHILLIPS, LEE
PORTER, LEE J & CARRIE E
POSTON, KEVIN D
P O BOX 97 ALTOONA, KS 66710
1208 N 5TH NEODESHA, KS 66757
226 E 13TH ALTOONA, KS 66710
P.O BOX 219 GAS, KS 66742
PO BOX 66 ALTOONA, KS 66710
P O BOX 119 ALTOONA, KS 66710
P O BOX 94 ALTOONA, KS 66710
1129 QUINCY ALTOONA, KS 66710
P O BOX 34 ALTOONA, KS 66710
1020 ADAMS ALTOONA, KS 66710
24510 JACKSON RD CHANUTE, KS 66720
P O BOX 86 ALTOONA, KS 66710
701 CARVER RD WALDEN APT GRIFFIN, GA 30224
1215 MAIN ALTOONA, KS 66710
P O BOX 54 ALTOONA, KS 66710
126 E 13TH ALTOONA, KS 66710
504 S KANSAS CHANUTE, KS 66720
504 S KANSAS CHANUTE, KS 66720
BOX 64 YATES CENTER, KS 66783
PO BOX 18 ALTOONA, KS 66710
PO BOX 113 ALTOONA, KS 66710
917 QUINCY ST ALTOONA, KS 66710
820 QUINCY ALTOONA, KS 66710
P.O BOX 23 ALTOONA, KS 66710
P.O BOX 171 ALTOONA, KS 66710
P.O BOX 172 ALTOONA, KS 66710
120.1150TH ST HUMBOLDT, KS 66748
P.O BOX 66805 ST LOUIS, MO 63166
905 QUINCY ALTOONA, KS 66710
906 QUINCY ALTOONA, KS 66710
P O BOX 282 FREDONIA, KS 66736
ATTN: PAUL F. COLLINS P.O. BOX 14 ALTOONA, KS 66710
P O BOX 164 ALTOONA, KS 66710
306 N STATE YATES CENTER, KS 66783
P O BOX 159 ALTOONA, KS 66710
1118 COMMERCIAL ALTOONA, KS 66710
111 E 7TH ALTOONA, KS 66710

WASSON, FLOYD 14-1

16-295-16E

REEVE, EVERETT
REEVE, GAYLORD
REYNOLDS, RAMONA G.
ROBERDS, WILLIAM WESLEY & GLORIA A
ROBY, ROGER & MARY
ROBY, WILLIAM & JANE
ROETS, VEDA M
ROUTH, JACKIE & JEAN A
RUBY, LORRIE M
RUCKER, DOUGLAS B
SEWELL, TERRY M; LINDLEY, CONNIE & SEWELL, RANDALL L,
SINCLAIR, CAROLYN
SMITH, CRYSTAL D
SPRADLING, BELINDA H
STANLEY, GARY L
STEVICKS, MONTE & SUSAN
STUSSY, JOSEPH C & GLENISE
TAYLOR, MARIE ALLIS
THOMPSON, MARILYN M & JOHN R
THURMAN, JERROLD L & SHERRI M
TOLLE, STEVIE M; COOK KYLE E
TOPHAM, TERRY J & JANET K
TROUTMAN, JOHN A
TROUTMAN, JOHN ALLEN
VAUGHN, MILTON & DAISY M
WALKER, JEFFREY L & PAMELA K
WALKER, MARY SUSAN & RUSSELL L TR
WALL, EDWARD WAYNE & NORMA
WASSON, CLINTIN F & JEANNE K
WASSON, FLOYD & JEANNE K; BEARDEN, JEANNE K F/K/A
WHITSON, DANNY W
WILLIAMS, CINDY
WORTHEY, HARLEY W & WORTHEY, EVONNA R
YORK, DALLAS L

119 S ELM ST STOCKTON, KS 67669
P O BOX 62 ALTOONA, KS 66710
830 QUINCY ALTOONA, KS 66710
4081 N 156TH DR GOODYEAR, AZ 85338
P O BOX 142 ALTOONA, KS 66710
P O BOX 76 ALTOONA, KS 66710
P O BOX 146 ALTOONA, KS 66710
109 MAIN ALTOONA, KS 66710
30438 E 143 ST S COWETA, OK 74429
1211 S E SADDLE LN BARTLESVILLE, OK 74006
P O BOX 42 ALTOONA, KS 66710
P O BOX 153 ALTOONA, KS 66710
P O BOX 152 ALTOONA, KS 66710
1425 N 2ND ST ASKANSAS CITY, KS 67005
P O BOX 977 NEWTOWN, PA 18940
1231 MAIN ALTOONA, KS 66710
1031 MAIN - P.O BOX 122 ALTOONA, KS 66710
P O BOX 21 NEODESHA, KS 66757
P O BOX 87 ALTOONA, KS 66710
1104 STATE ST ALTOONA, KS 66710
1309 N 11TH NEODESHA, KS 66757
15181 EBSON RD FULTON, IL 61252
517 S EVERGREEN CHANUTE, KS 66720
P O BOX 21 ALTOONA, KS 66710
P O BOX 83 ALTOONA, KS 66710
18328 K47 HWY ALTOONA, KS 66710
201 EAST 1ST ALTOONA, KS 66710
P O BOX 64 ALTOONA, KS 66710
10398 RENO RD ALTOONA, KS 66710
10398 RENO RD ALTOONA, KS 66710
24692 900 RD THAYER, KS 66776
1017 MAIN ALTOONA, KS 66710
1130 MAIN ALTOONA, KS 66710
18190-1000 RD ALTOONA, KS 66710

WASSON, FLOYD /6-1

10-29S-16E

per TO dtd 5.29.06

M&B desc in SE4 SW4
(6.57 acres)

Jeffrey L Walker and Pamela K Walker
18328 K47 HWY
Altoona, KS 66710

WASSON, FLOYD 16-1 - APPLICATION FOR COMMINGLING OF PRODUCTION OR FLUIDS

Offset Operators, Unleased Mineral Owners and Landowners acreage
(Attach additional sheets if necessary)

Name:
SEE ATTACHED

Legal Description of Leasehold:

Multiple horizontal lines for providing details under 'Name' and 'Legal Description of Leasehold'.

I hereby certify that the statements made herein are true and correct to the best of my knowledge and belief.

Jay L Morris
Applicant or Duty Authorized Agent

Subscribed and sworn before me this 1ST day of AUGUST, 2012



Jennifer R Beal
Notary Public
My Commission Expires: July 20, 2016

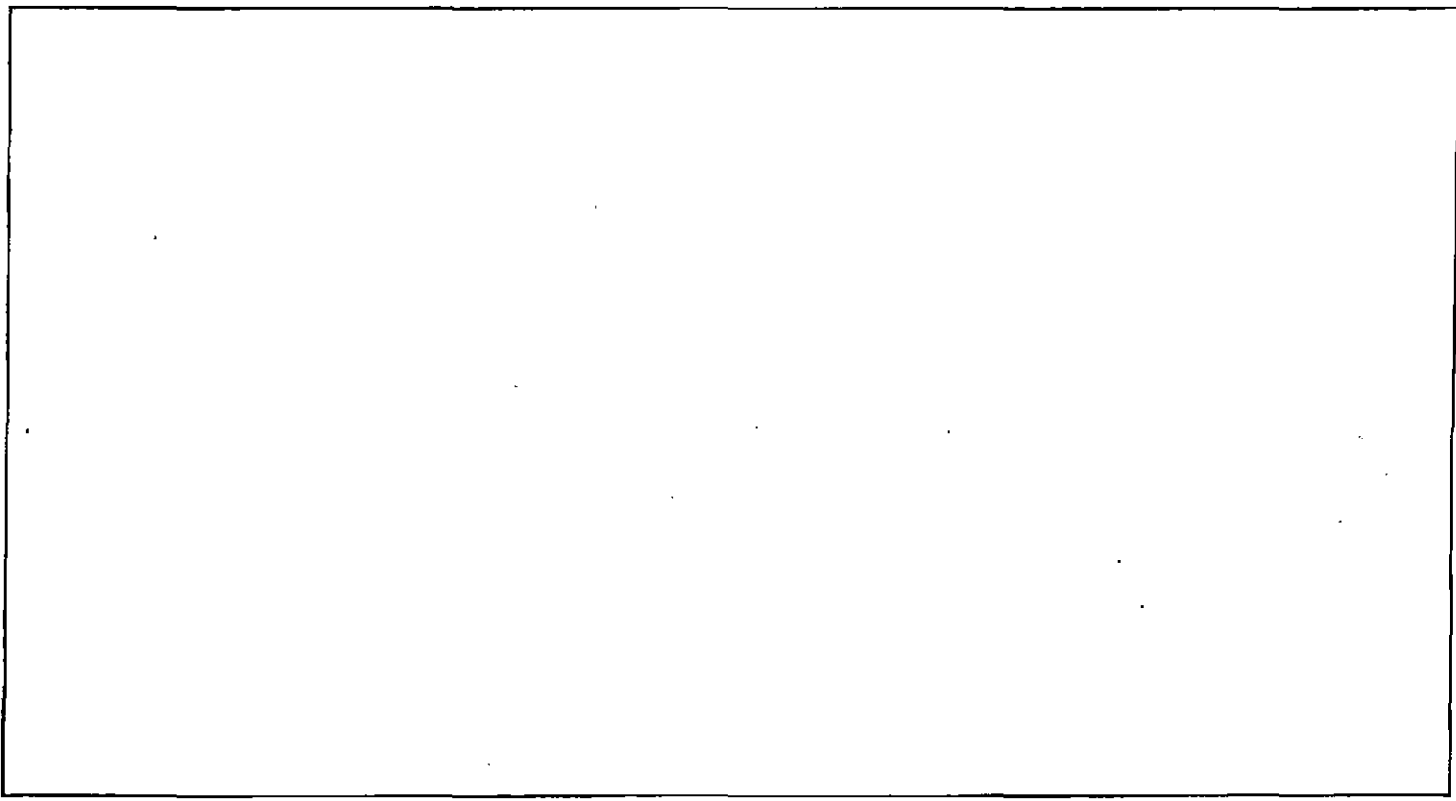

WASSON, FLOYD 16-f

9-295-16E

ALLEN, RICHARD & JEANETTE	1430 N COMMERICAL ALTOONA, KS 66710
BEEMAN, GINGER	PO BOX 8 ALTOONA, KS 66710
BLEVENS, TINA	unknown
BONGIORNI, GARY	23586 K47 HWY THAYER, KS 66776
BUSSE, TIM & LINDA	P O BOX 156 ALTOONA, KS 66710
CITY OF ALTOONA	P O BOX 147 ALTOONA, KS 66710
COLLINS, JAMES J	1312 MAIN ALTOONA, KS 66710
DICKENS, LEWIS & BELLE	P O BOX 15 ALTOONA, KS 66710
DUDAS, BETTY	506 N 8TH NEODESHA, KS 66757
FARMER, KENNETH	1401 STATE ALTOONA, KS 66710
FARMER, KENNETH	P O BOX 102 ALTOONA, KS 66710
GING, LYNN D	Attn: GREEN, HAROLD 7722 OAKLAND AVE KANSAS CITY, KS 66112
GOOD, RICHARD & STELLA M	17248 K47 HWY ALTOONA, KS 66710
GREATER NEW LIFE MINISTERIES INC	P O BOX 126 ALTOONA, KS 66710
HOLLINGSWORTH, MYRA JANE	17750 HWY 47 ALTOONA, KS 66710
KDOT	700 SW HARRISON 14TH FL TOPEKA, KS 66603
MUSTAIN, DONALD & WANDA	P O BOX 23 ALTOONA, KS 66710
MYERS, DAVID L & DINAH L	P O BOX 172 ALTOONA, KS 66710
NUNNENKAMP, GARY & JEANETTE	1404 MAIN ALTOONA, KS 66710
RAYMOND, JAMES & STACY	P O BOX 236 ALTOONA, KS 66710
RELPH, DAVID L & TONI S	11740 QUINTER RD ALTOONA, KS 66710
ROHR, ROBERT L; MYERS, RHONDA D	1306 QUINCY ALTOONA, KS 66710
SHAY, EVA L & SMITH, ELLEN	1302 STATE ALTOONA, KS 66710
STANLEY, GARY L & PAMELA S	P O BOX 977 NEWTOWN, PA 18940
STATE HIGHWAY COMMISSION	411 W 14TH CHANUTE, KS 66720
THROCKMORTON, GEORGE & CAROL	P O BOX 22 ALTOONA, KS 66710
WHITSON, DANNY W	24692 900 RD THAYER, KS 66776

WASSON, FLOYD 16-1

16-29S-16E

ALLEN, CHRISTOPHER M & JUDY K
BABCOCK, BOB AND TONY
BANK OF NEW YORK MELLON TRUST COMPANY
BARNETT, CHARLES
BARNETT, TRAVIS L & PAMELA C
BARNHART, BERNADINE
BEISLY, RICHARD L & FERN
BELL, SALLY & DARGATZ, BONI
BENTLEY, DONNA L
BOLLIG, BARBARA MAY F/K/A;
BONER, JAY & CHRISTINA
BUCK, TAMARA
BUSSE, TIMOTHY, Sr
CARTER, WILLARD
CHEEVER, MARY L
CHURCH FIRST BAPTIST OF ALTOONA
CHURCH OF CHRIST TRUSTEES
CITY OF ALTOONA
CLAIBOURN, WARREN O & TERRY JO
CLIFFORD, WAYNE E
COFFEY, DEBORAH V
COLLINS, LUKE & CHEYENNE
CUTLER, CLOYD S
DANNELS, DAMON D
DANNELS, RICHARD E & LOIS E
DAVISSON, LYLE R. & PATRICIA O.
DORSEY, BRAD L & FAITH K
EASLEY, PATRICIA
FAY, SARAH J & SUMNER, SHIRLEY W
FORD, PATSY RUTH
FORSYTHE, MORRIS L
GARNER, JEFF
GEESEKA, GUY & ELISA
GLIDDEN, MATTHEW & SARINA
GOOD, COURTNEY; MAYHEW, MICHAEL
GOODSELL, DENNIS EUGENE & GOODSELL, NICOLE EVE
GREATER NEW LIFE MINISTERIES INC

PO BOX 252 NEODESHA, KS 66757
928 QUINCY ST ALTOONA, KS 66710
C/o GREEN TREE SERVICING LLC 330 RIDER TRAIL SOUTH STE 150 EARTH CITY, MO 63045
P O BOX 11 ALTOONA, KS 66710
P O BOX 67 ALTOONA, KS 66710
PO BOX 74 ALTOONA, KS 66710
702 QUINCY ALTOONA, KS 66710
P O BOX 1291 EL DORADO, KS 67042
P O BOX 127 ALTOONA, KS 66710
4805 140TH RD CHANUTE, KS 66720-5161
121 E 8TH ALTOONA, KS 66710
P O BOX 46 ALTOONA, KS 66710
1017 MAIN ST ALTOONA, KS 66710
11819 UDALL RD ALTOONA, KS 66710
P O BOX 271 ALTOONA, KS 66710
P.O. BOX 178 ALTOONA, KS 66710
11819 UDALL RD ALTOONA, KS 66710
P O BOX 147 ALTOONA, KS 66710
P O BOX 316 ALTOONA, KS 66710
731 QUINCY ALTOONA, KS 66710
P O BOX 43 ALTOONA, KS 66710
1214 MAIN ALTOONA, KS 66710
1304 N 8TH NEODESHA, KS 66757
208 8TH ALTOONA, KS 66710
P O BOX 81 ALTOONA, KS 66710
3146 N PENN INDEPENDENCE, KS 67301
105 E 10TH ALTOONA, KS 66710
211 E 8TH ST ALTOONA, KS 66710
P.O. BOX 5 ALTOONA, KS 66710
1100 S 13TH APT 128 PARSONS, KS 67357-3553
P O BOX 88 ALTOONA, KS 66710
914 JEFFERSON FREDONIA, KS 66736
P O BOX 100 ALTOONA, KS 66710
906 MAIN ALTOONA, KS 66710
126 E 13TH ALTOONA, KS 66710
P O BOX 129 ALTOONA, KS 66710
P O BOX 126 ALTOONA, KS 66710

WASSON, FLOYD 16 -i

16-295-16E

GREEN, RONALD D	P O BOX 97 ALTOONA, KS 66710
HARE, ROBERT A & MARTIN, CONNIE	1208 N 5TH NEODESHA, KS 66757
HARPER, SCOTT & JUDY	226 E 13TH ALTOONA, KS 66710
HOLLOWAY, STEVEN T & HOLLOWAY, ADELINA B	P O BOX 219 GAS, KS 66742
HOLTZMAN, DALE & VERONICA	PO BOX 66 ALTOONA, KS 66710
HOUGHTON, ARTHUR DALE & DONITA M	P O BOX 119 ALTOONA, KS 66710
HUGHES, DAVID & MAVIS	P O BOX 94 ALTOONA, KS 66710
JONES, RAYMOND & LORRIE	1129 QUINCY ALTOONA, KS 66710
JONES, RAYMOND J	P O BOX 34 ALTOONA, KS 66710
KNOBLE, MAYNARD	1020 ADAMS ALTOONA, KS 66710
KNOBLE, MAYNARD & LINDA	24510 JACKSON RD CHANUTE, KS 66720
LEE, ROGER	P O BOX 86 ALTOONA, KS 66710
LETCHER, JAMES V	701 CARVER RD WALDEN APT GRIFFIN, GA 30224
LOUIS, ROBERT E & ROBERTA	1215 MAIN ALTOONA, KS 66710
MARTIN, CONNIE J	P O BOX 54 ALTOONA, KS 66710
MAYHEW, MICHAEL & GOOD, COURTNEY S	126 E 13TH ALTOONA, KS 66710
MCGAUGH, LAWRENCE W	504 S KANSAS CHANUTE, KS 66720
MCGAUGH, WAYNE	504 S KANSAS CHANUTE, KS 66720
MENTZER, RALPH	BOX 64 YATES CENTER, KS 66783
MILLER WAYNAKA D; PARKER SAMANTHA	PO BOX 18 ALTOONA, KS 66710
MONTOYA, MICHAEL N	PO BOX 113 ALTOONA, KS 66710
MOORE, RALPH & VELMA	917 QUINCY ST ALTOONA, KS 66710
MORGAN, JESSE WILL JR & KATIE	820 QUINCY ALTOONA, KS 66710
MUSTAIN, DONALD & WANDA	P O BOX 23 ALTOONA, KS 66710
MUSTAIN, JOHNNY R	P O BOX 171 ALTOONA, KS 66710
MYERS, DAVID L & DINAH L	P O BOX 172 ALTOONA, KS 66710
MYERS, ROBERT A & BRANDY L	120 1150TH ST HUMBOLDT, KS 66748
MYRES, NICCI R	P O BOX 66805 ST LOUIS, MO 63166
NALLEY, JEFFERY	905 QUINCY ALTOONA, KS 66710
NALLEY, RANDALL L	906 QUINCY ALTOONA, KS 66710
NEESE, DALE	P O BOX 282 FREDONIA, KS 66736
P.F.C. RENTALS, LLC	ATTN; PAUL F. COLLINS P.O. BOX 14 ALTOONA, KS 66710
PERKINS, JOLANDA S	P O BOX 164 ALTOONA, KS 66710
PFC RENTALS LLC	306 N STATE YATES CENTER, KS 66783
PHILLIPS, LEE	P O BOX 159 ALTOONA, KS 66710
PORTER, LEE J & CARRIE E	1118 COMMERCIAL ALTOONA, KS 66710
POSTON, KEVIN D	111 E 7TH ALTOONA, KS 66710

WASSON, FLOYD 16-1

16-29S-16E

REEVE, EVERETT	119 S ELM ST STOCKTON, KS 67669
REEVE, GAYLORD	P O BOX 62 ALTOONA, KS 66710
REYNOLDS, RAMONA G.	830 QUINCY ALTOONA, KS 66710
ROBERDS, WILLIAM WESLEY & GLORIA A	4081 N 156TH DR GOODYEAR, AZ 85338
ROBY, ROGER & MARY	P O BOX 142 ALTOONA, KS 66710
ROBY, WILLIAM & JANE	P O BOX 76 ALTOONA, KS 66710
ROETS, VEDA M	P O BOX 146 ALTOONA, KS 66710
ROUTH, JACKIE & JEAN A	109 MAIN ALTOONA, KS 66710
RUBY, LORRIE M	30438 E 143 ST S COWETA, OK 74429
RUCKER, DOUGLAS B	1211 S E SADDLE LN BARTLESVILLE, OK 74006
SEWELL, TERRY M; LINDLEY, CONNIE & SEWELL, RANDALL L,	P O BOX 42 ALTOONA, KS 66710
SINCLAIR, CAROLYN	P O BOX 153 ALTOONA, KS 66710
SMITH, CRYSTAL D	P O BOX 152 ALTOONA, KS 66710
SPRADLING, BELINDA H	1425 N 2ND ST ASKANSAS CITY, KS 67005
STANLEY, GARY L	P O BOX 977 NEWTOWN, PA 18940
STEVICKS, MONTE & SUSAN	1231 MAIN ALTOONA, KS 66710
STUSSY, JOSEPH C & GLENISE	1031 MAIN - P O BOX 122 ALTOONA, KS 66710
TAYLOR, MARIE ALLIS	P O BOX 21 NEODESHA, KS 66757
THOMPSON, MARILYN M & JOHN R	P O BOX 87 ALTOONA, KS 66710
THURMAN, JERROLD L & SHERRI M	1104 STATE ST ALTOONA, KS 66710
TOLLE, STEVIE M; COOK KYLE E	1309 N 11TH NEODESHA, KS 66757
TOPHAM, TERRY J & JANET K	15181 EBSON RD FULTON, IL 61252
TROUTMAN, JOHN A	517 S EVERGREEN CHANUTE, KS 66720
TROUTMAN, JOHN ALLEN	P O BOX 21 ALTOONA, KS 66710
VAUGHN, MILTON & DAISY M	P O BOX 83 ALTOONA, KS 66710
WALKER, JEFFREY L & PAMELA K	18328 K47 HWY ALTOONA, KS 66710
WALKER, MARY SUSAN & RUSSELL L TR	201 EAST 1ST ALTOONA, KS 66710
WALL, EDWARD WAYNE & NORMA	P O BOX 64 ALTOONA, KS 66710
WASSON, CLINTIN F & JEANNE K	10398 RENO RD ALTOONA, KS 66710
WASSON, FLOYD & JEANNE K; BEARDEN, JEANNE K F/K/A	10398 RENO RD ALTOONA, KS 66710
WHITSON, DANNY W	24692 900 RD THAYER, KS 66776
WILLIAMS, CINDY	1017 MAIN ALTOONA, KS 66710
WORTHEY, HARLEY W & WORTHEY, EVONNA R	1130 MAIN ALTOONA, KS 66710
YORK, DALEAS L	18190 1000 RD ALTOONA, KS 66710

WASSON, FLOYD /Co-1

10-29S-16E

per TO dtd 5.29.06

M&B desc in SE4 SW4
(6.57 acres)

Jeffrey L Walker and Pamela K Walker
18328 K47 HWY
Altoona, KS 66710

Conservation Division
Finney State Office Building
130 S. Market, Rm. 2078
Wichita, KS 67202-3802



Phone: 316-337-6200
Fax: 316-337-6211
<http://kcc.ks.gov/>

Mark Sievers, Chairman
Thomas E. Wright, Commissioner

Sam Brownback, Governor

August 16 , 2012

Clark Edwards
PostRock Midcontinent Production LLC
Oklahoma Tower
210 Park Ave, Ste 2750
Oklahoma City, OK 73102

RE: Approved Commingling CO081203
Wasson, Floyd 16-1 Sec.16-T29S-R16E, Wilson County
API No. 15-205-25902-00-00

Dear Mr. Edwards:

Your Application for Commingling (ACO-4) for the above described well, received by the KCC on August 1, 2012, has been reviewed and approved by the Kansas Corporation Commission (KCC) per K.A.R. 82-3-123. Notice was examined and found to be proper per K.A.R. 82-3-135a. No protest had been filed within the 15-day protest period.

Based upon the depth of the Cattleman formation perforations, total oil production shall not exceed 100 BOPD and total gas production shall not exceed 50% of the absolute open flow (AOF).

File form ACO-1 upon re-completion of the well to commingle.

Commingling ID number CO081203 has been assigned to this approved application. Use this number for well completion reports (ACO-1) and other correspondence that may concern this approved commingling.

Sincerely,

Rick Hestermann
Production Department