



KANSAS CORPORATION COMMISSION 1084934
OIL & GAS CONSERVATION DIVISION

Form ACO-4
Form must be typed
March 2009

APPLICATION FOR COMMINGLING OF Commingling ID # CO071231
PRODUCTION (K.A.R. 82-3-123) OR FLUIDS (K.A.R. 82-3-123a)

OPERATOR: License # 33343
Name: PostRock Midcontinent Production LLC
Address 1: Oklahoma Tower
Address 2: 210 Park Ave, Ste 2750
City: OKLAHOMA CITY State: OK Zip: 73102 +
Contact Person: CLARK EDWARDS
Phone: (620) 432-4200

API No. 15 - 15-133-26178-00-00
Spot Description: _____
SW NE NW NE Sec. 30 Twp. 29 S. R. 18 East West
645 Feet from North / South Line of Section
1890 Feet from East / West Line of Section
County: Neosho
Lease Name: ERBE REVOCABLE TRUST Well #: 30-1

- 1. Name and upper and lower limit of each production interval to be commingled:

Formation: <u>MULKY</u>	(Perfs): <u>676-679</u>
Formation: <u>SUMMIT</u>	(Perfs): <u>664-667</u>
Formation: <u>WEIR</u>	(Perfs): <u>941-943</u>
Formation: <u>WEIR</u>	(Perfs): <u>921-923</u>
Formation: <u>TEBO</u>	(Perfs): <u>887-890</u>

- 2. Estimated amount of fluid production to be commingled from each interval:

Formation: <u>MULKY</u>	BOPD: <u>0</u>	MCFPD: <u>3</u>	BWPD: <u>5</u>
Formation: <u>SUMMIT</u>	BOPD: <u>0</u>	MCFPD: <u>3</u>	BWPD: <u>5</u>
Formation: <u>WEIR</u>	BOPD: <u>0</u>	MCFPD: <u>3</u>	BWPD: <u>5</u>
Formation: <u>WEIR</u>	BOPD: <u>0</u>	MCFPD: <u>3</u>	BWPD: <u>5</u>
Formation: <u>TEBO</u>	BOPD: <u>0</u>	MCFPD: <u>3</u>	BWPD: <u>5</u>

- 3. Plat map showing the location of the subject well, all other wells on the subject lease, and all wells on offsetting leases within a 1/2 mile radius of the subject well, and for each well the names and addresses of the lessee of record or operator.
- 4. Signed certificate showing service of the application and affidavit of publication as required in K.A.R. 82-3-135a.

For Commingling of PRODUCTION ONLY, include the following:

- 5. Wireline log of subject well. Previously Filed with ACO-1: Yes No
- 6. Complete Form ACO-1 (Well Completion form) for the subject well.

For Commingling of FLUIDS ONLY, include the following:

- 7. Well construction diagram of subject well.
- 8. Any available water chemistry data demonstrating the compatibility of the fluids to be commingled.

AFFIDAVIT: I am the affiant and hereby certify that to the best of my current information, knowledge and personal belief, this request for commingling is true and proper and I have no information or knowledge, which is inconsistent with the information supplied in this application.

Submitted Electronically

KCC Office Use Only	
<input type="checkbox"/> Denied	<input checked="" type="checkbox"/> Approved
15-Day Periods Ends: <u>8/7/2012</u>	
Approved By: <u>Rick Hestermann</u>	Date: <u>08/08/2012</u>

Protests may be filed by any party having a valid interest in the application. Protests must be in writing and comply with K.A.R. 82-3-135b and must be filed within 15 days of publication of the notice of application.



Wellbore Schematic

WELL: Erbe Rev Trust 30-1
SSI: 606260
API: 15-133-26178
LOCATION: NW NE Sec. 30 29S-18E
COUNTY: Neosho
STATE: Kansas

Casing	8.625" @ 22' 4.5" 10.5# J-55, 4.05" ID w/ 0.0159 bbl/ft capacity @ 1137'
Perforations	Original Perfs: 11/16/04 - Mulky 676-679' (13) - Summit 664-667.5 (15) Recomp Perfs: 2/20/06 - Weir 941-943' (9) - Weir 921-923' (9) - Tebo 887-890' (9) - Fleming 816-819' (13) - Croweburg 780-783' (13) - Bevier 757-759' (9)
Completions	Spud Date: 10/6/04 SM Completion: 12/23/04 - 500 gals 15% HCl - 12 BPM - 12,000# 20/40 - 421 bbls fluid SM Flush: 2/17/06 - 500 gals 15% HCl TWW Completion: 2/21/06 - 500 gals 15% HCl - 10 BPM - 5,100# 20/40 - 392 bbls fluid BCF Completion: 2/21/06 - 600 gals 15% HCl - 13.6 BPM - 2,200# 20/40 - 206 bbls fluid - Communication up back-side BCF Re-Stim: 2/22/06 - 16 BPM - 13,700# 20/40 - 552 bbls fluid

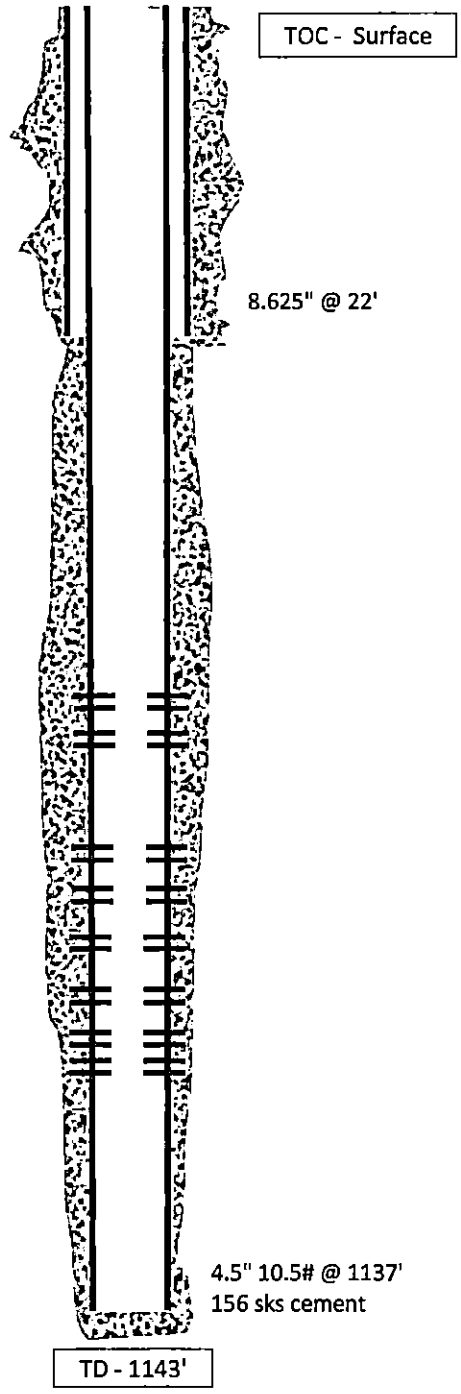

	A	B	C	D	E	F	G	H	I	J	K
1	Produced Fluids #		1	2	3	4	5		Click here to run SSP Goal Seek SSP Click Click Click Click		
2	Parameters	Units	Input	Input	Input	Input	Input				
3	Select the brines	Select fluid by checking the box(es),	<input type="checkbox"/>	<input type="checkbox"/>	<input type="checkbox"/>	<input type="checkbox"/>	<input type="checkbox"/>	Mixed brine: Cell H28 is			
4	Sample ID	Row 3						STP calc. pH.			
5	Date	3/19/2012	3/4/2012	3/14/2012	1/20/2012	1/20/2012		Cells H35-38 are used in mixed brines calculations.			
6	Operator	PostRock	PostRock	PostRock	PostRock	PostRock					
7	Well Name	Ward Feed	Ward Feed	Clinesmith	Clinesmith	Clinesmith					
8	Location	#34-1	#4-1	#5-4	#1	#2					
9	Field	CBM	CBM	Bartles	Bartles	Bartles					
10	Na ⁺	(mg/l)*	19,433.00	27,381.00	26,534.00	25,689.00	24,220.00	24,654.20	Initial(BH)	Final(WH)	S/SR (Final-Initial)
11	K ⁺ (if not known =0)	(mg/l)						0.00	Saturation Index values		
12	Mg ²⁺	(mg/l)	1,096.00	872.00	1,200.00	953.00	858.00	995.91	Calcite		
13	Ca ²⁺	(mg/l)	1,836.00	2,452.00	2,044.00	1,920.00	1,948.00	2,040.23	-0.73	-0.60	0.13
14	Sr ²⁺	(mg/l)						0.00	Barite		
15	Ba ²⁺	(mg/l)						0.00			
16	Fe ²⁺	(mg/l)	40.00	21.00	18.00	82.00	90.00	50.21	Halite		
17	Zn ²⁺	(mg/l)						0.00	-1.77	-1.80	-0.03
18	Pb ²⁺	(mg/l)						0.00	Gypsum		
19	Cl ⁻	(mg/l)	36,299.00	48,965.00	47,874.00	45,632.00	43,147.00	44,388.44	-3.19	-3.18	0.00
20	SO ₄ ²⁻	(mg/l)	1.00	1.00	8.00	1.00	1.00	2.40	Hemihydrate		
21	F ⁻	(mg/l)						0.00	-3.96	-3.90	0.06
22	Br ⁻	(mg/l)						0.00	Anhydrite		
23	SiO ₂	(mg/l) SiO ₂						0.00	-3.47	-3.36	0.12
24	HCO ₃ Alkalinity**	(mg/l as HCO ₃)	190.00	234.00	259.00	268.00	254.00	241.03	Celestite		
25	CO ₃ Alkalinity	(mg/l as CO ₃)									
26	Carboxylic acids**	(mg/l)						0.00	Iron Sulfide		
27	Ammonia	(mg/L) NH ₃						0.00	-0.16	-0.22	-0.06
28	Borate	(mg/L) H ₃ BO ₃						0.00	Zinc Sulfide		
29	TDS (Measured)	(mg/l)						72781			
30	Calc. Density (STP)	(g/ml)	1.038	1.051	1.050	1.048	1.045	1.047	Calcium fluoride		
31	CO ₂ Gas Analysis	(%)	19.97	18.76	22.41	35.53	33.79	26.16			
32	H ₂ S Gas Analysis***	(%)	0.0289	0.0292	0.0296	0.0306	0.0151	0.0269	Iron Carbonate		
33	Total H ₂ Saq	(mgH ₂ S/l)	1.00	1.00	1.00	1.00	0.50	0.90	-0.74	-0.51	0.23
34	pH, measured (STP)	pH	5.67	5.76	5.72	5.54	5.55	5.63	Inhibitor needed (mg/L)		
	Choose one option to calculate SI?	0-CO ₂ +Alk, 1-pH+Alk, 2-CO ₂ +pH	0	0	0	0	0	0	Calcite	NTMP	
35	Gas/day(thousand cf/day)	(Mcf/D)						0	0.00	0.00	
36	Oil/Day	(B/D)	0	0	1	1	1	4	Barite	BHPMP	
37	Water/Day	(B/D)	100	100	100	100	100	500	0.00	0.00	
38	For mixed brines, enter values for temperatures and pressures in Cells (H40-H43)							(Enter H40-H43)	pH		
39	Initial T	(F)	66.0	71.0	70.0	41.0	49.0	60.0	5.69	5.60	
40	Final T	(F)	66.0	71.0	70.0	41.0	49.0	89.0	Viscosity (CentiPoise)		
41	Initial P	(psia)	25.0	25.0	25.0	25.0	25.0	25.0	1.196	0.826	
42	Final P	(psia)	25.0	25.0	25.0	25.0	25.0	120.0	Heat Capacity (cal/ml ^o C)		
43	Use TP on Calcite sheet?	1-Yes;0-No							0.955	0.959	
44	API Oil Grav.	API grav.						30.00	Inhibitor needed (mg/L)		
45	Gas Sp.Grav.	Sp.Grav.						0.60	Gypsum	HDTMP	
46	%eOH/Day	(B/D)	0					0	0.00	0.00	
47	MEG/Day	(B/D)	0					0	Anhydrite	HDTMP	
48	Conc. Multiplier								0.00	0.00	
49	H ⁺ (Strong acid) [†]	(N)									
50	OH ⁻ (Strong base) [†]	(N)									
51	Quality Control Checks at STP:										
52	H ₂ S Gas	(%)									
53	Total H ₂ Saq (STP)	(mgH ₂ S/l)									
54	pH Calculated	(pH)									
55	PCO ₂ Calculated	(%)									
56	Alkalinity Calculated	(mg/l) as HCO ₃									
57	ECatons=	(equiv./l)									
58	EAnfons=	(equiv./l)									
59	Calc TDS=	(mg/l)									
60	Inhibitor Selection	Input	Unit	#	Inhibitor	Unit Converter (From metric to English)	Value	To Unit	Value		
61	Protection Time	120	min	1	NTMP	From Unit	80	°F	176		
62	Have ScaleSoft/Ptizer			2	BHPMP	°C	100	ft ³	3,531		
63	pick Inhibitor for you?	1	1-Yes;0-No	3	PAA	m ³	100	bb(42 US gal)	629		
64	If No, inhibitor # is:	4	#	4	DTPMP	m ³	1,000	psia	145,074		
65	If you select Mixed,			5	PPCA	MPa	496	psia	7,194		
66	1 st inhibitor # is:	1	#	6	SPA	Bar	10,000	psia	193		
67	% of 1 st inhibitor is:	50	%	7	HEDP	Torr	10,000	psia	238		
68	2 nd inhibitor # is:	2	#	8	HDTMP	Gal	10,000	bb(42 US gal)	63		
69	Display net. coeffs?	0	1-Yes;0-No	9	Average	Liters	10,000	bb(42 US gal)			
70				10	Mixed						

Saturation Index Calculations

Champion Technologies, Inc.

(Based on the Tomson-Oddo Model)

Brine 1: Ward Feed Yard 34-1

Brine 2: Ward Feed Yard 4-1

Brine 3: Clinesmith 5-4

Brine 4: Clinesmith 1

Brine 5: Clinesmith 2

Component (mg/L)	Ratio					
	20% Brine 1	20% Brine 2	20% Brine 3	20% Brine 4	20 Brine 5	Mixed Brine
Calcium	1836	2452	2044	1920	1948	1952
Magnesium	1096	872	1200	953	858	865
Barium	0	0	0	0	0	0
Strontium	0	0	0	0	0	0
Bicarbonate	190	234	259	268	254	253
Sulfate	1	1	8	1	1	1
Chloride	36299	48965	47874	45632	43147	43206
CO ₂ in Brine	246	220	264	422	405	401
Ionic Strength	1.12	1.48	1.46	1.38	1.31	1.31
Temperature (°F)	89	89	89	89	89	89
Pressure (psia)	50	50	120	120	120	119

Saturation Index

Calcite	-1.71	-1.41	-1.48	-1.68	-1.69	-1.69
Gypsum	-3.71	-3.64	-2.82	-3.73	-3.72	-3.69
Hemihydrate	-3.70	-3.65	-2.83	-3.74	-3.71	-3.69
Anhydrite	-3.89	-3.79	-2.97	-3.89	-3.88	-3.85
Barite	N/A	N/A	N/A	N/A	N/A	N/A
Celestite	N/A	N/A	N/A	N/A	N/A	N/A

PTB

Calcite	N/A	N/A	N/A	N/A	N/A	N/A
Gypsum	N/A	N/A	N/A	N/A	N/A	N/A
Hemihydrate	N/A	N/A	N/A	N/A	N/A	N/A
Anhydrite	N/A	N/A	N/A	N/A	N/A	N/A
Barite	N/A	N/A	N/A	N/A	N/A	N/A
Celestite	N/A	N/A	N/A	N/A	N/A	N/A

**KANSAS CORPORATION COMMISSION
OIL & GAS CONSERVATION DIVISION
WELL COMPLETION FORM
WELL HISTORY - DESCRIPTION OF WELL & LEASE**

Form ACO-1
September 1999
Form Must Be Typed

ORIGINAL

Operator: License # 33344
 Name: Quest Cherokee, LLC
 Address: 211 W. 14th Street
 City/State/Zip: Chanute, KS 66720
 Purchaser: Bluestem Pipeline, LLC
 Operator Contact Person: Gary Laswell
 Phone: (620) 431-9500
 Contractor: Name: Well Refined
 License: 33072
 Wellsite Geologist: Julie Talkington
 Designate Type of Completion:
 New Well Re-Entry Workover
 Oil SWD SLOW Temp. Abd.
 Gas ENHR SIGW
 Dry Other (Core, WSW, Expl., Cathodic, etc)
 If Workover/Re-entry: Old Well Info as follows:
 Operator: _____
 Well Name: _____
 Original Comp. Date: _____ Original Total Depth: _____
 Deepening Re-perf. Conv. to Enhr./SWD
 Plug Back _____ Plug Back Total Depth _____
 Commingled Docket No. _____
 Dual Completion Docket No. _____
 Other (SWD or Enhr.?) Docket No. _____

<u>10/06/04</u>	<u>10/07/04</u>	<u>10/27/04</u>
Spud Date or Recompletion Date	Date Reached TD	Completion Date or Recompletion Date

API No. 15 - 133-26178-00-00
 County: Neosho
W2 E2 NW NE Sec. 30 Twp. 29 S. R. 18 East West
660 feet from S (circle one) Line of Section
1830 feet from E W (circle one) Line of Section
 Footages Calculated from Nearest Outside Section Corner:
 (circle one) NE SE NW SW
 Lease Name: Erbe Rev Trust Well #: 30-1
 Field Name: Cherokee Basin CBM
 Producing Formation: _____
 Elevation: Ground: 1013 Kelly Bushing: n/a
 Total Depth: 1143 Plug Back Total Depth: 1137.02
 Amount of Surface Pipe Set and Cemented at 21.3 Feet
 Multiple Stage Cementing Collar Used? Yes No
 If yes, show depth set _____ Feet
 If Alternate II completion, cement circulated from 1137.02
 feet depth to surface w/ 156 _____ sx cmt.
ALT II WTM 8-25-06
Drilling Fluid Management Plan
 (Data must be collected from the Reserve Pit)
 Chloride content _____ ppm Fluid volume _____ bbls
 Dewatering method used _____
 Location of fluid disposal if hauled offsite: _____
 Operator Name: _____
 Lease Name: _____ License No.: _____
 Quarter _____ Sec. _____ Twp. _____ S. R. _____ East West
 County: _____ Docket No.: _____

INSTRUCTIONS: An original and two copies of this form shall be filed with the Kansas Corporation Commission, 130 S. Market - Room 2078, Wichita, Kansas 67202, within 120 days of the spud date, recompletion, workover or conversion of a well. Rule 82-3-130, 82-3-106 and 82-3-107 apply. Information of side two of this form will be held confidential for a period of 12 months if requested in writing and submitted with the form (see rule 82-3-107 for confidentiality in excess of 12 months). One copy of all wireline logs and geologist well report shall be attached with this form. ALL CEMENTING TICKETS MUST BE ATTACHED. Submit CP-4 form with all plugged wells. Submit CP-111 form with all temporarily abandoned wells.

All requirements of the statutes, rules and regulations promulgated to regulate the oil and gas industry have been fully complied with and the statements herein are complete and correct to the best of my knowledge.

Signature: [Signature]
 Title: Head of Operations Date: 4/8/06
 Subscribed and sworn to before me this 8th day of April
20 06
 Notary Public: [Signature]
 Date Commission Expires: 7-30-09

KCC Office Use ONLY

Letter of Confidentiality Received
 If Denied, Yes Date: _____
 Wireline Log Received
 Geologist Report Received
 UIC Distribution

JENNIFER AMMANN
 Notary Public - State of Kansas
 My Appt. Expires 7-30-09

✓

Operator Name: Quest Cherokee, LLC Lease Name: Erbe Rev Trust Well #: 30-1
 Sec. 30 Twp. 29 S. R. 18 East West County: Neosho

INSTRUCTIONS: Show important tops and base of formations penetrated. Detail all cores. Report all final copies of drill stems tests giving interval tested, time tool open and closed, flowing and shut-in pressures, whether shut-in pressure reached static level, hydrostatic pressures, bottom hole temperature, fluid recovery, and flow rates if gas to surface test, along with final chart(s). Attach extra sheet if more space is needed. Attach copy of all Electric Wireline Logs surveyed. Attach final geological well site report.

Drill Stem Tests Taken Yes No
 (Attach Additional Sheets)

Samples Sent to Geological Survey Yes No

Cores Taken Yes No

Electric Log Run Yes No
 (Submit Copy)

List All E. Logs Run:

Log Formation (Top), Depth and Datum Sample
 Name Top Datum
 See attached

RECEIVED
 KANSAS CORPORATION COMMISSION
APR 19 2006
 CONSERVATION DIVISION
 WICHITA, KS

Comp. Density/Neutron Log
 Dual Induction Log
 Gamma Ray/Neutron Log

CASING RECORD <input type="checkbox"/> New <input type="checkbox"/> Used							
Report all strings set-conductor, surface, intermediate, production, etc.							
Purpose of String	Size Hole Drilled	Size Casing Set (In O.D.)	Weight Lbs. / Ft.	Setting Depth	Type of Cement	# Sacks Used	Type and Percent Additives
Surface	12-1/4"	8-5/8"	20#	21.3	"A"	4	
Production	6-3/4"	4-1/2"	10.5#	1137.02	"A"	156	

ADDITIONAL CEMENTING / SQUEEZE RECORD				
Purpose:	Depth Top Bottom	Type of Cement	#Sacks Used	Type and Percent Additives
<input type="checkbox"/> Perforate <input type="checkbox"/> Protect Casing <input type="checkbox"/> Plug Back TD <input type="checkbox"/> Plug Off Zone				

Shots Per Foot	PERFORATION RECORD - Bridge Plugs Set/Type Specify Footage of Each Interval Perforated	Acid, Fracture, Shot, Cement Squeeze Record (Amount and Kind of Material Used)	Depth
4	664-667.5/676-679	500 gal 15% HCL w/40 bbls 2% KCL water, 421 bbls water w/2% KCL, Blocks, 1200 20/40 sand	
	941-943/921-923/887-890	500 gal 15% HCL w/42 bbls 2% KCL water, 382 bbls water w/2% KCL, Blocks, 5100 20/40 sand	
	816-819/780-783/757-759	500 gal 15% HCL w/47 bbls 2% KCL water, 200 bbls water w/2% KCL, Blocks, 2200 20/40 sand	

TUBING RECORD		Size	Set At	Packer At	Liner Run
		2-3/8"	955	n/a	<input type="checkbox"/> Yes <input checked="" type="checkbox"/> No
Date of First, Resumerd Production, SWD or Enhr.			Producing Method		
3/31/05			<input type="checkbox"/> Flowing <input checked="" type="checkbox"/> Pumping <input type="checkbox"/> Gas Lift <input type="checkbox"/> Other (Explain)		
Estimated Production Per 24 Hours	Oil Bbls.	Gas Mcf	Water Bbls.	Gas-Oil Ratio	Gravity
	n/a	18.9 mcf	50 bbls		

Disposition of Gas Vented Sold Used on Lease (If vented, Submit ACO-18.)

METHOD OF COMPLETION

Open Hole Perf. Dually Comp. Commingled

Other (Specify) _____

Production Interval

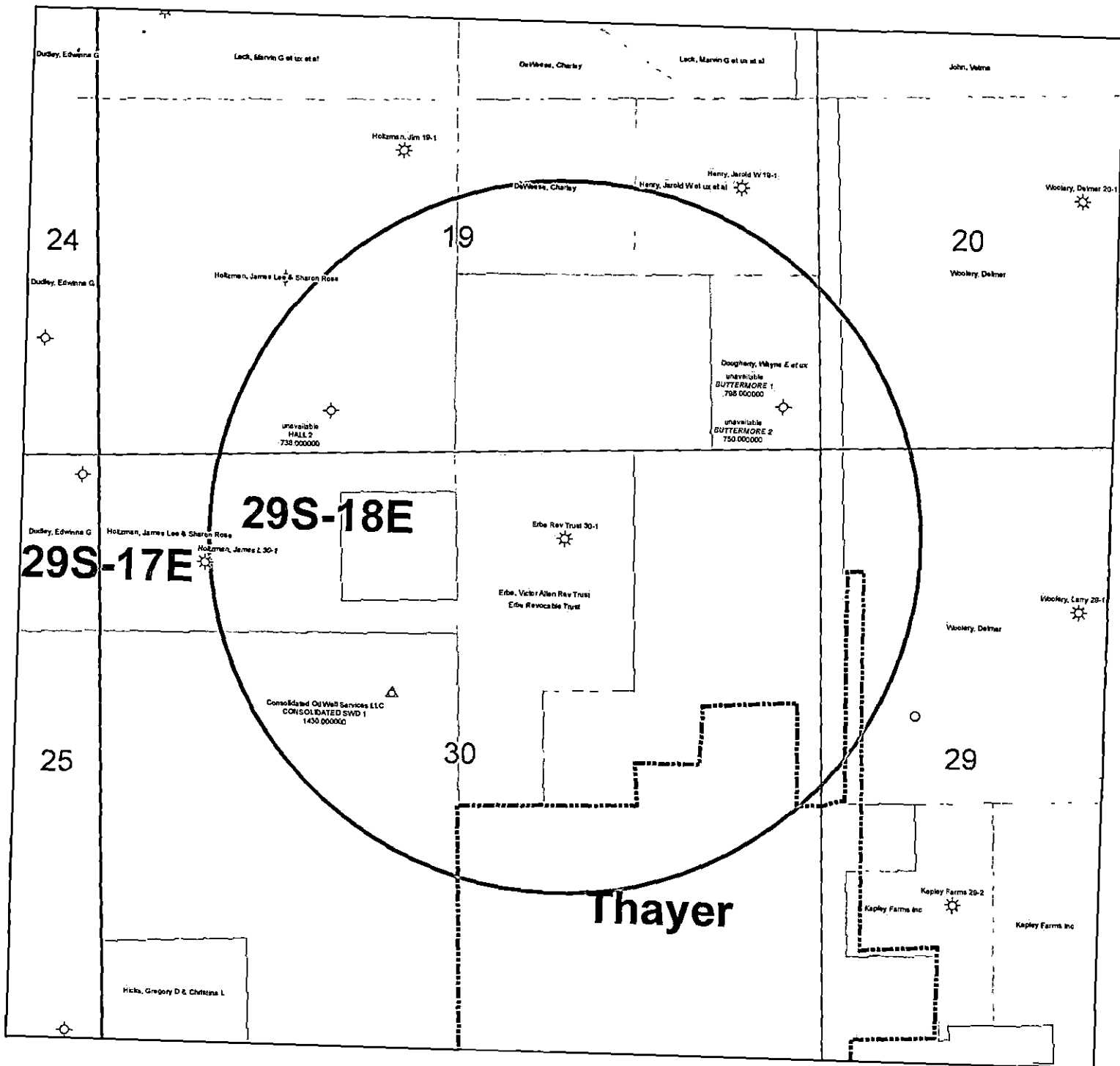

KGS STATUS	
◇	DA/PA
⊕	EOR
☼	GAS
△	INJ/SWD
●	OIL
✱	OIL/GAS
○	OTHER

Erbe Rev Trust 30-1
 30-29S-18E
 1" = 1,000'

BEFORE THE STATE CORPORATION COMMISSION OF THE STATE OF KANSAS
NOTICE OF FILING APPLICATION

RE: In the Matter of Postrock Midcontinent Production, LLC Application for Commingling of Production in the Erbe Revocable Trust 30-1 located in Neosho County, Kansas.

TO: All Oil & Gas Producers, Unleased Mineral Interest Owners, Landowners, and all persons whomsoever concerned.

You, and each of you, are hereby notified that Postrock Midcontinent Production, LLC has filed an application to commingle the Summit, Mulky, Welr, Tebo, Fleming, Croweburg, Bevler, Barlowville producing formations at the Erbe Revocable Trust 30-1 located in the W2 E2 NW NE, S30-T29S-R18E, Approximately 645 FNL & 1800 FEL, Neosho County, Kansas.

Any persons who object to or protest this application shall be required to file their objections or protest with the Conservation Division of the State Corporation Commission of the State of Kansas within fifteen (15) days from the date of this publication. These protests shall be filed pursuant to Commission regulations and must state specific reasons why granting the application may cause waste, violate correlative rights or pollute the natural resources of the State of Kansas.

All persons interested or concerned shall take notice of the foregoing and shall govern themselves accordingly. All person and/or companies wishing to protest this application are required to file a written protest with the Conservation Division of the Kansas Oil and Gas Commission.

Upon the receipt of any protest, the Commission will convene a hearing and protestants will be expected to enter an appearance either through proper legal counsel or as individuals, appearing on their own behalf.

Postrock Midcontinent Production, LLC
210 Park Avenue, Suite 2750
Oklahoma City, Oklahoma 73102
(405) 660-7704

A COPY OF THE AFFIDAVIT OF PUBLICATION MUST ACCOMPANY ALL APPLICATIONS

Affidavit of Publication

STATE OF KANSAS, NEOSHO COUNTY, ss:

Rhonda Howerter, being first duly sworn, deposes and says: That she is *Classified Manager* of *THE CHANUTE TRIBUNE*, a daily newspaper printed in the State of Kansas, and published in and of general circulation in Neosho County, Kansas, with a general paid circulation on a daily basis in Neosho County, Kansas, and that said newspaper is not a trade, religious or fraternal publication.

Said newspaper is a daily published at least weekly 50 times a year: has been so published continuously and uninterruptedly in said county and state for a period of more than five years prior to the first publication of said notice; and has been admitted at the post office of Chanute, in said county as second class matter.

That the attached notice is a true copy thereof and was published in the regular and entire issue of said newspaper for 1 consecutive time, the first publication thereof being made as aforesaid on the 3 day of July 2012, with subsequent publications being made on the following dates:

_____, 2012 _____, 2012

_____, 2012 _____, 2012

Rhonda Howerter

Subscribed and sworn to and before me this 3 day of July 2012

[Signature]
Notary Public

My commission expires: January 9, 2015

Printer's Fee \$ 70.14

Affidavit, Notary's Fee \$ 3.00

Additional Copies \$ _____

Total Publication Fees \$ 73.14

SHANNA L. GUIOT
Notary Public - State of Kansas
My Appl. Expires 1-9-15

AFFIDAVIT

STATE OF KANSAS \
- SS.
County of Sedgwick /

Mark Fletchall, of lawful age, being first duly sworn, deposes and saith: That he is Record Clerk of The Wichita Eagle, a daily newspaper published in the City of Wichita, County of Sedgwick, State of Kansas, and having a general paid circulation on a daily basis in said County, which said newspaper has been continuously and uninterruptedly published in said County for more than one year prior to the first publication of the notice hereinafter mentioned, and which said newspaper has been entered as second class mail matter at the United States Post Office in Wichita, Kansas, and which said newspaper is not a trade, religious or fraternal publication and that a notice of a true copy is hereto attached was published in the regular and entire Morning issue of said The Wichita Eagle for 1 issues, that the first publication of said notice was

made as aforesaid on the 2nd of

July A.D. 2012, with

subsequent publications being made on the following dates:

And affiant further says that he has personal knowledge of the statements above set forth and that they are true.

Mark Fletchall

Subscribed and sworn to before me this

2nd day of July, 2012



Penny L. Case
Notary Public Sedgwick County, Kansas

Printer's Fee : \$134.80

LEGAL PUBLICATION
PUBLISHED IN THE WICHITA EAGLE
JULY 2, 2012 (3194133)
BEFORE THE STATE CORPORATION
COMMISSION OF THE STATE OF KANSAS
NOTICE OF FILING APPLICATION
RE: In the Matter of: Postrock Midcontinent
Production, LLC Application for Commission
of Production in the Erbe Revocable Trust 30-1
located in Neosho County, Kansas.
TO: All Oil & Gas Producers, Unleased Mineral
Interest Owners, Landowners, and all persons
whom ever concerned.
You, and each of you, are hereby notified
that Postrock Midcontinent Production,
LLC has filed an application to commingle
the Summit, Milky, Wolf, Tebo, Fleming,
Crowburn, Beaver, Barleville, producing
formations at the Erbe Revocable Trust 30-1
located in the W2 E2 NW NE, S30-T29S-R18E,
Approximately 645 PNL & 1870 FEL, Neosho
County, Kansas.
Any persons who object to or protest
this application shall be required to file their
objections or protest with the Conservation
Division of the State Corporation Commission
of the State of Kansas within fifteen (15)
days from the date of this publication. These
protests shall be filed pursuant to Commission
regulations and must state specific reasons
why granting the application may cause waste,
violate correlative rights or pollute the natural
resources of the State of Kansas.
All persons interested or concerned shall
take notice of the foregoing and shall govern
themselves accordingly. All person and/or
companies wishing to protest this application
are required to file a written protest with the
Conservation Division of the Kansas Oil and
Gas Commission.
Upon the receipt of any protest, the
Commission will convene a hearing and
protestants will be expected to enter an
appearance either through proper legal
counsel or as individuals, appearing on their
own behalf.
Postrock Midcontinent Production, LLC
210 Park Avenue, Suite 2750
Oklahoma City, Oklahoma 73102
(405) 660-2704

Affidavit of Notice Served

Re: Application for: APPLICATION FOR COMMINGLING OF PRODUCTION OR FLUIDS ACO-4

Well Name: ERBE REVOCABLE TRUST 30-1 Legal Location: W2 E2 NW NE S30-T29S-R18E

The undersigned hereby certifies that he / she is a duly authorized agent for the applicant, and that on the day 23RD of JULY, 2012, a true and correct copy of the application referenced above was delivered or mailed to the following parties:

Note: A copy of this affidavit must be served as a part of the application.

Name

Address (Attach additional sheets if necessary)

CONSOLIDATED OIL WELL SERVICE, LLC

1322 S GRANT, PO BOX 884, CHANUTE, KS 66720

SEE ATTACHED

I further attest that notice of the filing of this application was published in the CHANUTE TRIBUNE, the official county publication of NEOSHO county. A copy of the affidavit of this publication is attached.

Signed this 24th day of JULY, 2012



[Signature]
Applicant or Duly Authorized Agent

Subscribed and sworn to before me this 24 day of JULY, 2012

[Signature]
Notary Public

My Commission Expires: 5/13/13

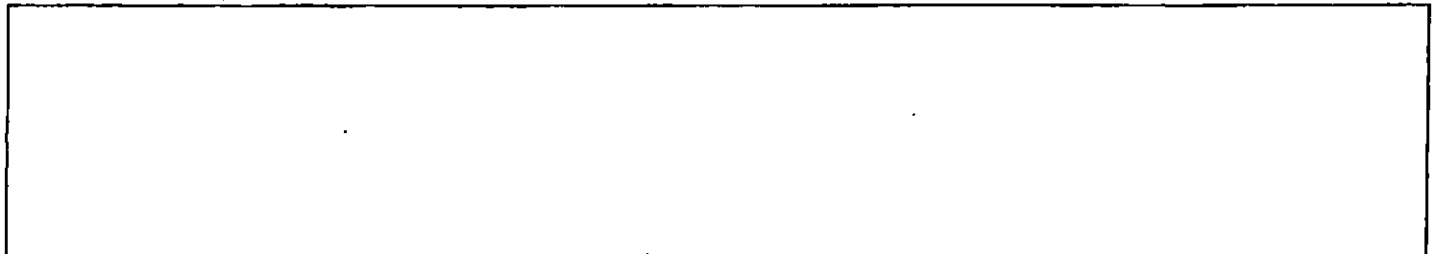

3BE REV TRUST 30-1

NW/4 30-295-18E
IMMY LEE & JIM PETERSON
340 85TH RD
THAYER, KS 66776

LOYD E MCKIBBEN
380 85TH RD
THAYER, KS 66776

TEVEN W & VICKIE J SNEED
PO BOX 187
THAYER, KS 66776

CONSOLIDATED OIL
PO BOX 684 211 W
CHANUTE, KS 66720

MARY L & CATHY E ADAMS
PO BOX 96
THAYER, KS 66776

Don A & Kristin M Carrico
150 85TH Rd
Thayer, KS 66776

City Of Thayer
PO Box 157
Thayer, KS 66776

Opene W & D Carter
280 85th Rd
Thayer, KS 66776

NE/4 30-295-18E
CONSOLIDATED UNIFIED SCHOOL DIST #101
PO BOX 137
ERIE, KS 66733

BOARD CHETOPA TOWNSHIP
320 WATERMELON RD
THAYER, KS 66776

ROLLEN WAYNE BERG
1610 E CARPENTER
OLA, KS 66749

LAWRENCE MARSHALL
6825 90TH RD
THAYER, KS 66776

EDDIE D CARRICO
424 MONTGOMERY RD
THAYER, KS 66776

SMITHYS EXPRESS LLC
PO BOX 156
THAYER, KS 66776

AJ ROWAN
717 N GALVESTON
THAYER, KS 66776

MAYNARD C & LINDA J KNOBLE
%POEVERLEIN WILLIAM HENRY & ROSEANNA
310 WATERMELON RD
Thayer, KS 66776

CARL'S SALES & SERVICE INC
PO BOX 38
Thayer, KS 66776

RALPH E & PATRICIA STUDEBAKER LIV TRUST
PO BOX 38
Thayer, KS 66776

SE/4 30-295-18E
THORNTON FAMILY TRUST
7450 BETHANY RD THAYER, KS 66776

STANLEY & KATHERINE STITT
8830 BROWN RD THAYER, KS 66776

JAMES L & SHARON HOLTZMAN
24723 850 RD THAYER, KS 66776

GEORGE STEVENIN
600 MEADOW LN THAYER, KS 66776

DUANE G & BRENDA MCFARLAND
417 N JULIA THAYER, KS 66776

RYAN & KIMBERLY SCHULZ TRUST
7630 80TH RD THAYER, KS 66776

LARRY D & MARGARET R BROWN
122 GREENWOOD THAYER, KS 66776

CITY OF THAYER
PO BOX 157 THAYER, KS 66776

STEVE L ERBE
207 WATERMELON RD THAYER, KS 66776

RALPH E & PATRICIA STUDEBAKER LIV TRUST
PO BOX 38 THAYER, KS 66776

MARGARET LAVERTY
410 N OKMULGEE THAYER, KS 66776

JEFFREY & TONJA WINKLEMAN
410 N OKMULGEE THAYER, KS 66776

THEODORE H & ANITA OHMART
421 N OKMULGEE THAYER, KS 66776

LILLIE & CHARLES KEEN
SHARRIS FRANCES
323 W WATERMELON RD THAYER, KS 66776
MASONIC LODGE #149 AF&AM
PO BOX 38 THAYER, KS 66776

WILLIAM R PHILLIPS
406 E WORK THAYER, KS 66776

KYANNE SCHULZ
406 E WORK THAYER, KS 66776

KALENE S NEWTON
432 WORK THAYER, KS 66776

JIMMIE APARTMENTS
%WILBUR VANWINKLE
4120 S SANTA FE CHANUTE, KS 66720

SW/4 30-295-18E
THAYER CHRISTIAN CHURCH
8485 Dorn RD
THAYER, KS 66776

Elis & Betty R Holtzman
8385 Dorn Rd
Thayer, KS 66776

tract in NE4 & sec 18
SW/4 SE4 & W2 SE4 3E4
Rockin R Farm LLC
PO Box 118
Thayer, KS 66776

ERBE REV TRUST 30-1 - APPLICATION FOR COMMINGLING OF PRODUCTION OR FLUIDS

[Empty box]

[Empty box]

Offset Operators, Unleased Mineral Owners and Landowners acreage
(Attach additional sheets if necessary)

Name:

Legal Description of Leasehold:

SEE ATTACHED

I hereby certify that the statements made herein are true and correct to the best of my knowledge and belief.

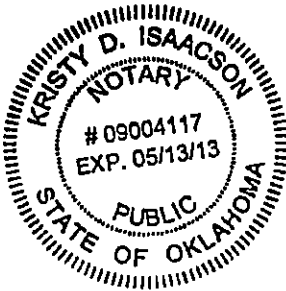

[Signature]
 Applicant or Duly Authorized Agent

Subscribed and sworn before me this 24 day of JULY, 2012

[Signature]
 Notary Public

My Commission Expires: 5/13/13

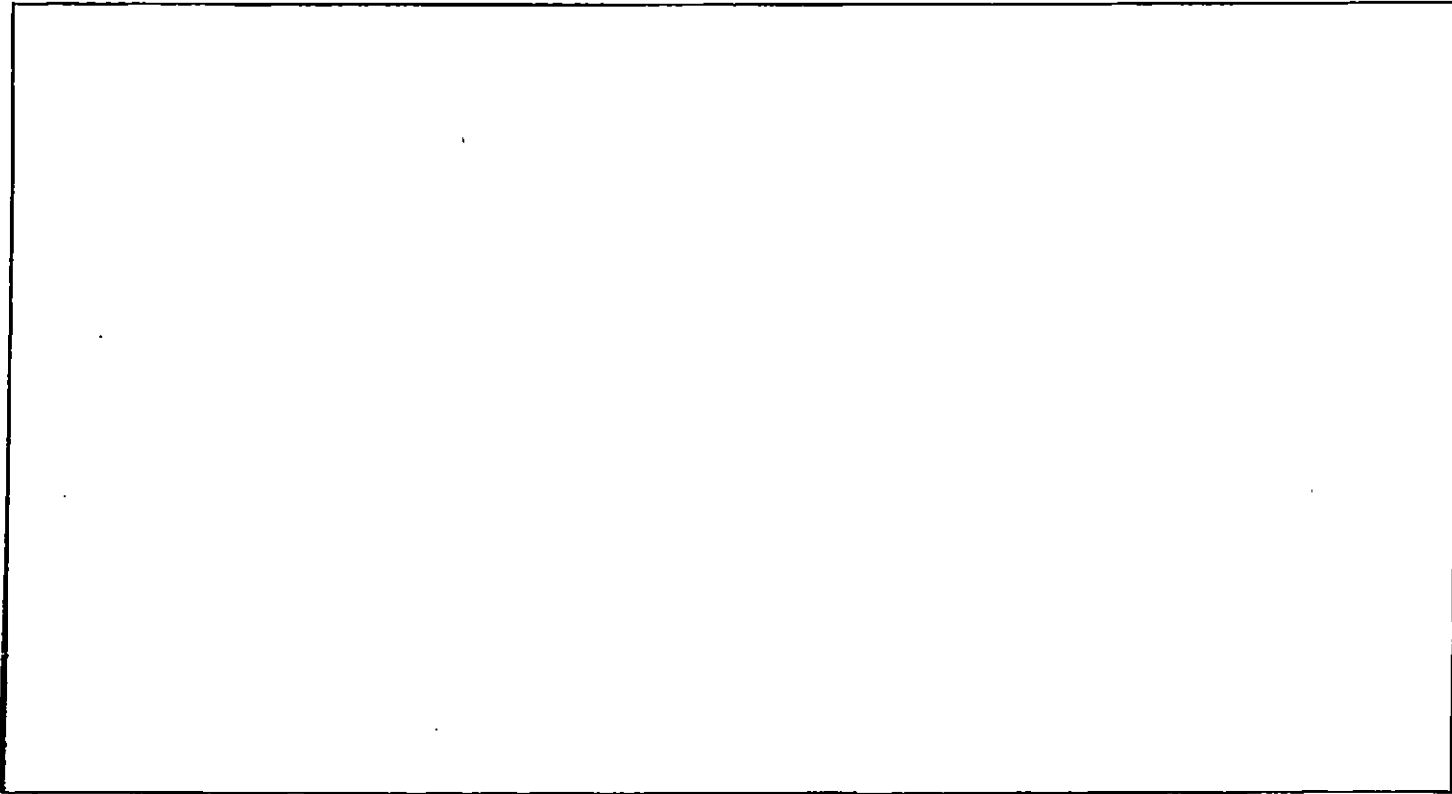

ERBE REV TRUST 30-1

LEGAL LOCATION
S30-T29S-R18E

SPOT **CURR_OPERA**
NE SE NW Consolidated Oil Well Services LLC

ERBE REV TRUST 30-1

NW/4 30-295-18E
JIMMY LEE & J M PETERSON
3940 85TH RD
THAYER, KS 66776

LLOYD E MCKIBBEN
3980 85TH RD
THAYER, KS 66776

STEVEN W & VICKIE J SNEED
P O BOX 187
THAYER, KS 66776

CONSOLIDATED OIL
PO BOX 824 211 W
CHANUTE, KS 66720

GARY L & CATHY E ADAMS
PO BOX 96
THAYER, KS 66776

Ben A & Kristin M Carrico
3150 85Th Rd
Thayer, KS 66776

City Of Thayer
PO Box 157
Thayer, KS 66776

Eugene W & D Carter
2280 85th Rd
Thayer, KS 66776

NE/4 30-295-18E
CONSOLIDATED UNIFIED SCHOOL DIST #101
PO BOX 137
ERIE, KS 66733

BOARD CHETOPA TOWNSHIP
320 WATERMELON RD
THAYER, KS 66776

ROLLEN WAYNE BERG
1610 E CARPENTER
IOLA, KS 65749

LAWRENCE MARSHALL
6825 90TH RD
THAYER, KS 66776

EDDIE D CARRICO
424 MONTGOMERY RD
THAYER, KS 66776

SMITHYS EXPRESS LLC
PO BOX 156
THAYER, KS 66776

AJ ROWAN
717 N GALVESTON
THAYER, KS 66776

MAYNARD C & LINDA J KNOBLE
%POEVERLEIN WILLIAM HENRY & ROSEANNA
310 WATERMELON RD
Thayer, KS 66776

CARL'S SALES & SERVICE INC
PO BOX 38
Thayer, KS 66776

RALPH E & PATRICIA STUDEBAKER LIV TRUST
PO BOX 38
Thayer, KS 66776

SE/4 30-295-18E
THORNTON FAMILY TRUST
7450 BETHANY RD THAYER, KS 66776

STANLEY & KATHERINE STITT
8330 BROWN RD THAYER, KS 66776
JAMES L & SHARON HOLTZMAN
24723 850 RD THAYER, KS 66776

GEORGE STEVENIN
600 MEADOW LN THAYER, KS 66776

DUANE G & BRENDA MCFARLAND
417 N JULIA THAYER, KS 66776

BRYAN & KIMBERLY SCHULZ TRUST
7630 80TH RD THAYER, KS 66776

LARRY D & MARGARET R BROWN
122 GREENWOOD THAYER, KS 66776

CITY OF THAYER
PO BOX 157 THAYER, KS 66776

STEVE L ERBE
207 WATERMELON RD THAYER, KS 66776

RALPH E & PATRICIA STUDEBAKER LIV TRUST
PO BOX 38 THAYER, KS 66776

MARGARET LAVERTY
410 N OKMULGEE THAYER, KS 66776

JEFFREY & TONJA WINKLEMAN
410 N OKMULGEE THAYER, KS 66776

THEODORE H & ANITA OHMART
421 N OKMULGEE THAYER, KS 66776

LILLIE & CHARLES KEEN
%HARRIS FRANCES
323 W WATERMELON RD THAYER, KS 66776
MASONIC LODGE #149 AF&AM
PO BOX 38 THAYER, KS 66776

WILLIAM R PHILLIPS
406 E WORK THAYER, KS 66776

KYANNE SCHULZ
406 E WORK THAYER, KS 66776

KALENE S NEWTON
432 WORK THAYER, KS 66776

JIMINI APARTMENTS
%WILBUR VANWINKLE
4120 S SANTA FE CHANUTE, KS 66720

SW/4 30-295-18E
THAYER CHRISTIAN CHURCH
8495 Dorn RD
THAYER, KS 66776

Elfa & Betty R Holtzman
8385 Dorn Rd
Thayer, KS 66776

tract in NE4 & sec 19
SW/4 SE4 & W2 SE4 SE4
Rockin R Farm LLC
PO Box 118
Thayer, KS 66776

Conservation Division
Finney State Office Building
130 S. Market, Rm. 2078
Wichita, KS 67202-3802



Phone: 316-337-6200
Fax: 316-337-6211
<http://kcc.ks.gov/>

Mark Sievers, Chairman
Thomas E. Wright, Commissioner

Sam Brownback, Governor

August 7, 2012

Clark Edwards
PostRock Midcontinent Production LLC
Oklahoma Tower
210 Park Ave, Ste 2750
Oklahoma City, OK 73102

RE: Approved Commingling CO071231
Erbe Revocable Trust 30-1, Sec.30-T29S-R18E, Neosho County
API No. 15-133-26178-00-00

Dear Mr. Edwards:

Your Application for Commingling (ACO-4) for the above described well, received by the KCC on July 24, 2012, has been reviewed and approved by the Kansas Corporation Commission (KCC) per K.A.R. 82-3-123. Notice was examined and found to be proper per K.A.R. 82-3-135a. No protest had been filed within the 15-day protest period.

Based upon the depth of the Bartlesville formation perforations, total oil production shall not exceed 100 BOPD and total gas production shall not exceed 50% of the absolute open flow (AOF).

File form ACO-1 upon re-completion of the well to commingle.

Commingling ID number CO071231 has been assigned to this approved application. Use this number for well completion reports (ACO-1) and other correspondence that may concern this approved commingling.

Sincerely,

Rick Hestermann
Production Department