



KANSAS CORPORATION COMMISSION 1084876
OIL & GAS CONSERVATION DIVISION

Form ACO-4
Form must be typed
March 2009

APPLICATION FOR COMMINGLING OF **Commingling ID # CO081204**
PRODUCTION (K.A.R. 82-3-123) OR FLUIDS (K.A.R. 82-3-123a)

OPERATOR: License # 33343
Name: PostRock Midcontinent Production LLC
Address 1: Oklahoma Tower
Address 2: 210 Park Ave, Ste 2750
City: OKLAHOMA CITY State: OK Zip: 73102 + _____
Contact Person: CLARK EDWARDS
Phone: (620) 432-4200

API No. 15 - 15-205-26581-00-00
Spot Description: _____
SW NE NE SE Sec. 19 Twp. 28 S. R. 17 East West
1986 Feet from North / South Line of Section
644 Feet from East / West Line of Section
County: Wilson
Lease Name: MCMILLEN BILLY D Well #: 19-1

1. Name and upper and lower limit of each production interval to be commingled:
Formation: RIVERTON (Perfs): 1031-1033
Formation: WEIR (Perfs): 878-879
Formation: TEBO (Perfs): 854-856
Formation: FLEMING (Perfs): 822-823
Formation: FLEMING (Perfs): 809-811

2. Estimated amount of fluid production to be commingled from each interval:
Formation: RIVERTON BOPD: 0 MCFPD: 7.3 BWPD: 4
Formation: WEIR BOPD: 0 MCFPD: 7.3 BWPD: 4
Formation: TEBO BOPD: 0 MCFPD: 7.3 BWPD: 4
Formation: FLEMING BOPD: 0 MCFPD: 7.3 BWPD: 4
Formation: FLEMING BOPD: 0 MCFPD: 7.3 BWPD: 4

3. Plat map showing the location of the subject well, all other wells on the subject lease, and all wells on offsetting leases within a 1/2 mile radius of the subject well, and for each well the names and addresses of the lessee of record or operator.

4. Signed certificate showing service of the application and affidavit of publication as required in K.A.R. 82-3-135a.

For Commingling of PRODUCTION ONLY, include the following:

5. Wireline log of subject well. Previously Filed with ACO-1: Yes No
 6. Complete Form ACO-1 (Well Completion form) for the subject well.

For Commingling of FLUIDS ONLY, include the following:

7. Well construction diagram of subject well.
 8. Any available water chemistry data demonstrating the compatibility of the fluids to be commingled.

AFFIDAVIT: I am the affiant and hereby certify that to the best of my current information, knowledge and personal belief, this request for commingling is true and proper and I have no information or knowledge, which is inconsistent with the information supplied in this application.

Submitted Electronically

KCC Office Use Only	
<input type="checkbox"/> Denied	<input checked="" type="checkbox"/> Approved
15-Day Periods Ends: <u>8/3/2012</u>	
Approved By: <u>Rick Hestermann</u>	Date: <u>08/07/2012</u>

Protests may be filed by any party having a valid interest in the application. Protests must be in writing and comply with K.A.R. 82-3-135b and must be filed within 15 days of publication of the notice of application.

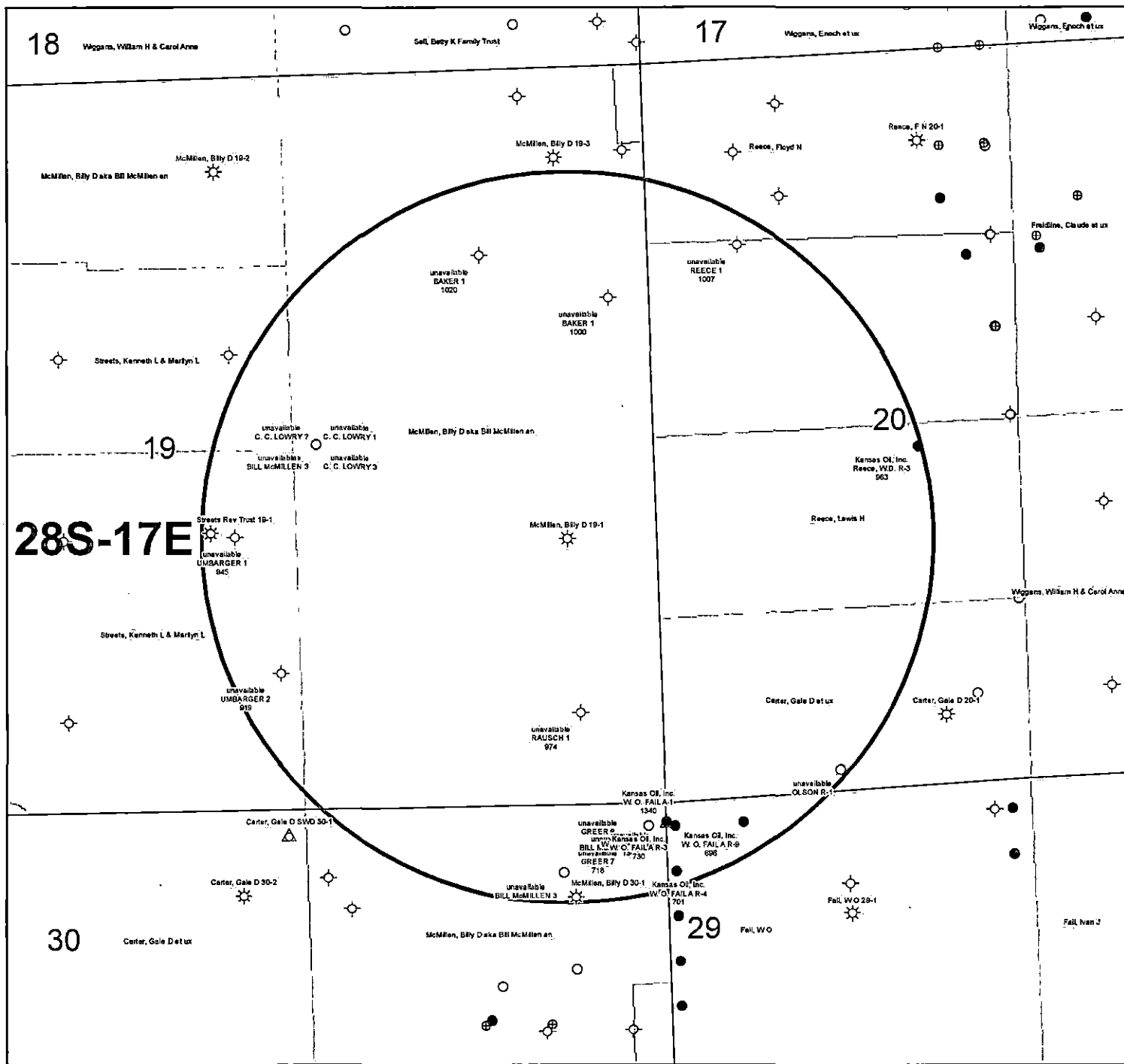

28S-17E

KGS STATUS	
⊕	DA/PA
⊗	EOR
☼	GAS
△	INJ/SWD
●	OIL
⊛	OIL/GAS
○	OTHER

McMillen, Billy D 19-1
 19-28S-17E
 1" = 1,000'

	A	B	C	D	E	F	G	H	I	J	K
1	Produced Fluids #										
2	Parameters	Units	Input	Input	Input	Input	Input		Click here to run SSP Goal Seek SSP		Click
3	Select the brines	Select fluid by checking the box(es),	<input type="checkbox"/>	<input type="checkbox"/>	<input type="checkbox"/>	<input type="checkbox"/>	<input type="checkbox"/>	Mixed brine: Cell H28 is			Click
4	Sample ID							STP calc. pH.			Click
5	Date		3/19/2012	3/4/2012	3/14/2012	1/20/2012	1/20/2012	Cells H35-38 are used in mixed brines calculations.			Click
6	Operator	Row 3	PostRock	PostRock	PostRock	PostRock	PostRock				Click
7	Well Name		Ward Feed	Ward Feed	Clinesmith	Clinesmith	Clinesmith				Click
8	Location		#34-1	#4-1	#5-4	#1	#2				Click
9	Field		CBM	CBM	Bartles	Bartles	Bartles				Click
10	Na ⁺	(mg/l)*	19,433.00	27,381.00	26,534.00	25,689.00	24,220.00	24,654.20			Initial(BH)
11	K ⁺ (if not known =0)	(mg/l)						0.00	Saturation Index values		
12	Mg ²⁺	(mg/l)	1,096.00	872.00	1,200.00	953.00	858.00	995.91	Calcite		
13	Ca ²⁺	(mg/l)	1,836.00	2,452.00	2,044.00	1,920.00	1,948.00	2,040.23	-0.73	-0.60	0.13
14	Sr ²⁺	(mg/l)						0.00	Barite		
15	Ba ²⁺	(mg/l)						0.00			
16	Fe ²⁺	(mg/l)	40.00	21.00	18.00	82.00	90.00	50.21	Halite		
17	Zn ²⁺	(mg/l)						0.00	-1.77	-1.80	-0.03
18	Pb ²⁺	(mg/l)						0.00	Gypsum		
19	Cl ⁻	(mg/l)	36,299.00	48,965.00	47,874.00	45,632.00	43,147.00	44,388.44	-3.19	-3.18	0.00
20	SO ₄ ²⁻	(mg/l)	1.00	1.00	8.00	1.00	1.00	2.40	Hemihydrate		
21	F ⁻	(mg/l)						0.00	-3.96	-3.90	0.06
22	Br ⁻	(mg/l)						0.00	Anhydrite		
23	SiO ₂	(mg/l) SiO ₂						0.00	-3.47	-3.36	0.12
24	HCO ₃ Alkalinity**	(mg/l as HCO ₃)	190.00	234.00	259.00	268.00	254.00	241.03	Celestite		
25	CO ₃ Alkalinity	(mg/l as CO ₃)									
26	Carboxylic acids**	(mg/l)						0.00	Iron Sulfide		
27	Ammonia	(mg/L) NH ₃						0.00	-0.16	-0.22	-0.06
28	Borate	(mg/L) H ₃ BO ₃						0.00	Zinc Sulfide		
29	TDS (Measured)	(mg/l)						72781			
30	Calc. Density (STP)	(g/ml)	1.038	1.051	1.050	1.048	1.045	1.047	Calcium fluoride		
31	CO ₂ Gas Analysis	(%)	19.97	18.76	22.41	35.53	33.79	26.16			
32	H ₂ S Gas Analysis***	(%)	0.0289	0.0292	0.0296	0.0306	0.0151	0.0269	Iron Carbonate		
33	Total H ₂ Saq	(mgH ₂ S/l)	1.00	1.00	1.00	1.00	0.50	0.90	-0.74	-0.51	0.23
34	pH, measured (STP)	pH	5.67	5.76	5.72	5.54	5.55	5.63	Inhibitor needed (mg/L)		
35	Choose one option to calculate SI?	0-CO ₂ +Alk, 1-pH+Alk, 2-CO ₂ +pH	0	0	0	0	0		Calcite	NTMP	
36	Gas/day(thousand cf/day)	(Mcf/D)						0	0.00	0.00	
37	Oil/Day	(B/D)	0	0	1	1	1	4	Barite	BHPMP	
38	Water/Day	(B/D)	100	100	100	100	100	500	0.00	0.00	
39	For mixed brines, enter values for temperatures and pressures in Cells (H40-H43)								(Enter H40-H43)		pH
40	Initial T	(F)	66.0	71.0	70.0	41.0	49.0	60.0	5.69	5.60	
41	Final T	(F)	66.0	71.0	70.0	41.0	49.0	89.0	Viscosity (CentiPoise)		
42	Initial P	(psia)	25.0	25.0	25.0	25.0	25.0	25.0	1.196	0.826	
43	Final P	(psia)	25.0	25.0	25.0	25.0	25.0	120.0	Heat Capacity (cal/ml ² C)		
44	Use TP on Calcite sheet?	1-Yes;0-No							0.955	0.959	
45	API Oil Grav.	API grav.						30.00	Inhibitor needed (mg/L)		
46	Gas Sp.Grav.	Sp.Grav.						0.60	Gypsum	HDTMP	
47	MeOH/Day	(B/D)	0					0	0.00	0.00	
48	MEG/Day	(B/D)	0					0	Anhydrite	HDTMP	
49	Conc. Multiplier								0.00	0.00	
50	H ⁺ (Strong acid) ¹	(N)									
51	OH ⁻ (Strong base) ¹	(N)									
52	Quality Control Checks at STP:										
53	H ₂ S Gas	(%)									
54	Total H ₂ Saq (STP)	(mgH ₂ S/l)									
55	pH Calculated	(pH)									
56	PCO ₂ Calculated	(%)									
57	Alkalinity Calculated	(mg/l) as HCO ₃									
58	ΣCations=	(equiv./l)									
59	ΣAnions=	(equiv./l)									
60	Calc TDS=	(mg/l)									
61	Inhibitor Selection	Input	Unit	#	Inhibitor	Unit Converter (From metric to English)					
62	Protection Time	120	min	1	NTMP	From Unit	Value	To Unit	Value		
63	Have ScaleSoft/Pfizer			2	BHPMP	°C	80	°F	176		
64	pick inhibitor for you?	1	1-Yes;0-No	3	PAA	m ³	100	ft ³	3,531		
65	If No, inhibitor # is:	4	#	4	DTPMP	m ³	100	bbt(42 US gal)	629		
66	If you select Mixed,			5	PPCA	MPa	1,000	psia	145,074		
67	1 st inhibitor # is:	1	#	6	SPA	Bar	496	psia	7,194		
68	% of 1 st inhibitor is:	50	%	7	HEDP	Torr	10,000	psia	193		
69	2 nd inhibitor # is:	2	#	8	HDTMP	Gal	10,000	bbt(42 US gal)	238		
70	Display act. cocfs?	0	1-Yes;0-No	9	Average	Liters	10,000	bbt(42 US gal)	63		
71				10	Mixed						

Saturation Index Calculations

Champion Technologies, Inc.

(Based on the Tomson-Oddo Model)

Brine 1: Ward Feed Yard 34-1

Brine 2: Ward Feed Yard 4-1

Brine 3: Clinesmith 5-4

Brine 4: Clinesmith 1

Brine 5: Clinesmith 2

Component (mg/L)	Ratio					
	20% Brine 1	20% Brine 2	20% Brine 3	20% Brine 4	20 Brine 5	Mixed Brine
Calcium	1836	2452	2044	1920	1948	1952
Magnesium	1096	872	1200	953	858	865
Barium	0	0	0	0	0	0
Strontium	0	0	0	0	0	0
Bicarbonate	190	234	259	268	254	253
Sulfate	1	1	8	1	1	1
Chloride	36299	48965	47874	45632	43147	43206
CO ₂ in Brine	246	220	264	422	405	401
Ionic Strength	1.12	1.48	1.46	1.38	1.31	1.31
Temperature (°F)	89	89	89	89	89	89
Pressure (psia)	50	50	120	120	120	119

Saturation Index

Calcite	-1.71	-1.41	-1.48	-1.68	-1.69	-1.69
Gypsum	-3.71	-3.64	-2.82	-3.73	-3.72	-3.69
Hemihydrate	-3.70	-3.65	-2.83	-3.74	-3.71	-3.69
Anhydrite	-3.89	-3.79	-2.97	-3.89	-3.88	-3.85
Barite	N/A	N/A	N/A	N/A	N/A	N/A
Celestite	N/A	N/A	N/A	N/A	N/A	N/A

PTB

Calcite	N/A	N/A	N/A	N/A	N/A	N/A
Gypsum	N/A	N/A	N/A	N/A	N/A	N/A
Hemihydrate	N/A	N/A	N/A	N/A	N/A	N/A
Anhydrite	N/A	N/A	N/A	N/A	N/A	N/A
Barite	N/A	N/A	N/A	N/A	N/A	N/A
Celestite	N/A	N/A	N/A	N/A	N/A	N/A

KANSAS CORPORATION COMMISSION
OIL & GAS CONSERVATION DIVISION

ORIGINAL

Form ACO-1
September 1999
Form Must Be Typed

WELL COMPLETION FORM
WELL HISTORY - DESCRIPTION OF WELL & LEASE

Operator: License # 33344
Name: Quest Cherokee, LLC
Address: 211 W. 14th Street
City/State/Zip: Chanute, KS 66720
Purchaser: Bluestem Pipeline, LLC
Operator Contact Person: Jennifer R. Ammann
Phone: (620) 431-9500
Contractor: Name: L S Well Service, LLC
License: 33374

Wellsite Geologist: Ken Recco
Designate Type of Completion:
 New Well Re-Entry Workover
 Oil SWD SIOW Temp. Abd.
 Gas ENHR SIGW
 Dry Other (Core, WSW, Expl., Cathodic, etc)

If Workover/Re-entry: Old Well Info as follows:

Operator: _____
Well Name: _____
Original Comp. Date: _____ Original Total Depth: _____
 Deepening Re-perf. Conv. to Enhr./SWD
 Plug Back _____ Plug Back Total Depth _____
 Commingled _____ Docket No. _____
 Dual Completion _____ Docket No. _____
 Other (SWD or Enhr.?) _____ Docket No. _____

<u>5/12/06</u>	<u>5/16/06</u>	<u>5/22/06</u>
Spud Date or Recompletion Date	Date Reached TD	Completion Date or Recompletion Date

API No. 15 - 205-26581-00-06
County: Wilson
_____ ne _____ se Sec. 19 Twp. 26 S. R. 17 East West
1980 feet from (S) N (circle one) Line of Section
660 feet from (E) W (circle one) Line of Section

Footages Calculated from Nearest Outside Section Corner:
(circle one) NE SE NW SW
Lease Name: McMillen, Billy D. Well #: 19-1
Field Name: Cherokee Basin CBM

Producing Formation: Multiple
Elevation: Ground: 896 Kelly Bushing: n/a
Total Depth: 1149 Plug Back Total Depth: 1141.38
Amount of Surface Pipe Set and Cemented at 21.6 Feet
Multiple Stage Cementing Collar Used? Yes No
If yes, show depth set _____ Feet
If Alternate II completion, cement circulated from 1141.38
feet depth to surface w/ 160 ^{sq cmt}

Drilling Fluid Management Plan
(Data must be collected from the Reserve Pit)
Chloride content _____ ppm Fluid volume _____ bbls
Dewatering method used _____
Location of fluid disposal if hauled offsite: _____
Operator Name: _____
Lease Name: _____ License No.: _____
Quarter _____ Sec. _____ Twp. _____ S. R. _____ East West
County: _____ Docket No.: _____

RECEIVED
KANSAS CORPORATION COMMISSION
OIL & GAS CONSERVATION DIVISION
WICHITA, KS
SEP 11 2006

AIT-2-DG-12/4/08

INSTRUCTIONS: An original and two copies of this form shall be filed with the Kansas Corporation Commission, 130 S. Market - Room 2078, Wichita, Kansas 67202, within 120 days of the spud date, recompletion, workover or conversion of a well. Rule 82-3-130, 82-3-106 and 82-3-107 apply. Information of side two of this form will be held confidential for a period of 12 months if requested in writing and submitted with the form (see rule 82-3-107 for confidentiality in excess of 12 months). One copy of all wireline logs and geologist well report shall be attached with this form. ALL CEMENTING TICKETS MUST BE ATTACHED. Submit CP-4 form with all plugged wells. Submit CP-111 form with all temporarily abandoned wells.

All requirements of the statutes, rules and regulations promulgated to regulate the oil and gas industry have been fully complied with and the statements herein are complete and correct to the best of my knowledge.

Signature: Jennifer R. Ammann
Title: New Well Development Coordinator Date: 9/8/06

Subscribed and sworn to before me this 8th day of September,
2006.

Notary Public: Debra Klauman

Date Commission Expires: 8-4-2010

TERRA KLAUMAN
Notary Public - State of Kansas
My Appt. Expires 8-4-2010

KCC Office Use ONLY
 Letter of Confidentiality Received
If Denied, Yes Date: _____
 Wireline Log Received
 Geologist Report Received
LIC Distribution

Operator Name: Quest Cherokee, LLC Lease Name: McMillen, Billy D. Well #: 19-1
 Sec. 19 Twp. 28 S. R. 17 East West County: Wilson

INSTRUCTIONS: Show important tops and base of formations penetrated. Detail all cores. Report all final copies of drill stems tests giving interval tested, time tool open and closed, flowing and shut-in pressures, whether shut-in pressure reached static level, hydrostatic pressures, bottom hole temperature, fluid recovery, and flow rates if gas to surface test, along with final chart(s). Attach extra sheet if more space is needed. Attach copy of all Electric Wireline Logs surveyed. Attach final geological well site report.

Drill Stem Tests Taken <i>(Attach Additional Sheets)</i>	<input type="checkbox"/> Yes <input checked="" type="checkbox"/> No	<input checked="" type="checkbox"/> Log Formation (Top), Depth and Datum	<input type="checkbox"/> Sample
Samples Sent to Geological Survey	<input type="checkbox"/> Yes <input checked="" type="checkbox"/> No	Name	Top Datum
Cores Taken	<input type="checkbox"/> Yes <input checked="" type="checkbox"/> No	See attached	
Electric Log Run <i>(Submit Copy)</i>	<input checked="" type="checkbox"/> Yes <input type="checkbox"/> No		
List All E. Logs Run:			
Dual Induction Log			
Compensated Density Neutron Log			
Gamma Ray CCL			

CASING RECORD <input type="checkbox"/> New <input type="checkbox"/> Used							
Report all strings set-conductor, surface, intermediate, production, etc.							
Purpose of String	Size Hole Drilled	Size Casing Set (In O.D.)	Weight Lbs./ Ft.	Setting Depth	Type of Cement	# Sacks Used	Type and Percent Additives
Surface	11	8-5/8"	20#	21.6	"A"	5	
Production	6-3/4	4-1/2	10.5#	1141.38	"A"	160	

ADDITIONAL CEMENTING / SQUEEZE RECORD				
Purpose:	Depth Top Bottom	Type of Cement	#Sacks Used	Type and Percent Additives
<input type="checkbox"/> Perforate <input type="checkbox"/> Protect Casing <input type="checkbox"/> Plug Back TD <input type="checkbox"/> Plug Off Zone				

Shots Per Foot	PERFORATION RECORD - Bridge Plugs Set/Type Specify Footage of Each Interval Perforated	Acid, Fracture, Shot, Cement Squeeze Record <i>(Amount and Kind of Material Used)</i>		Depth
4	1031-1033	200gal 15% HCL w/ 41 lbs 2% acid water, 500lbs water w/ 2% KCL, Blocks, 3000# 20/40 sand		1031-1033
4	878-879/854-856/822-823/809-811/791-793/751-753/736-738	400gal 15% HCL w/ 40 lbs 2% acid water, 821lbs water w/ 2% KCL, Blocks, 18100# 20/40 sand		878-879/854-856 822-823/809-811/791-793 751-753/736-738
4	665-669/653-657	400gal 15% HCL w/ 50 lbs 2% acid water, 525lbs water w/ 2% KCL, Blocks, 12100# 20/40 sand		665-669/653-657

TUBING RECORD	Size 2-3/8"	Set At 1033	Packer At n/a	Liner Run <input type="checkbox"/> Yes <input checked="" type="checkbox"/> No
Date of First, Resumed Production, SWD or Enhr. 7/21/06	Producing Method <input type="checkbox"/> Flowing <input checked="" type="checkbox"/> Pumping <input type="checkbox"/> Gas Lift <input type="checkbox"/> Other (Explain)			
Estimated Production Per 24 Hours	Oil Bbls. n/a	Gas Mcf 0mcf	Water Bbls. 76bbls	Gas-Oil Ratio

Disposition of Gas **METHOD OF COMPLETION** Production Interval

Vented Sold Used on Lease Open Hole Perf. Dually Comp. Commingled
(If vented, Submit ACO-18.) Other (Specify) _____

Affidavit of Notice Served

Re: Application for: APPLICATION FOR COMMINGLING OF PRODUCTION OR FLUIDS - ACO-4
Well Name: MCMILLEN, BILLY D 19-1 Legal Location: SWNESE S19-T28S-R17E

The undersigned hereby certifies that he / she is a duly authorized agent for the applicant, and that on the day 29TH of JUNE, 2012, a true and correct copy of the application referenced above was delivered or mailed to the following parties:

Note: A copy of this affidavit must be served as a part of the application.

Name	Address (Attach additional sheets if necessary)
KANSAS OIL, INC	16716 WICHITA RD, CHANUTE, KS 66720
CK REECE	315 LAMBETH RD, WATERLOO, IA 50701
LYLE MARTIN GREER	1019 N STUEBEN, CHANUTE, KS 66720

I further attest that notice of the filing of this application was published in the WILSON COUNTY CITIZEN, the official county publication of WILSON county. A copy of the affidavit of this publication is attached.

Signed this 29TH day of JUNE, 2012

[Signature]
Applicant or Duly Authorized Agent

Subscribed and sworn to before me this 29TH day of JUNE, 2012

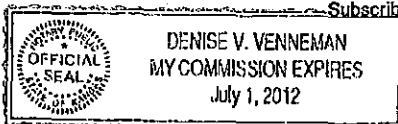

[Signature]
Notary Public
My Commission Expires: 7-1-12

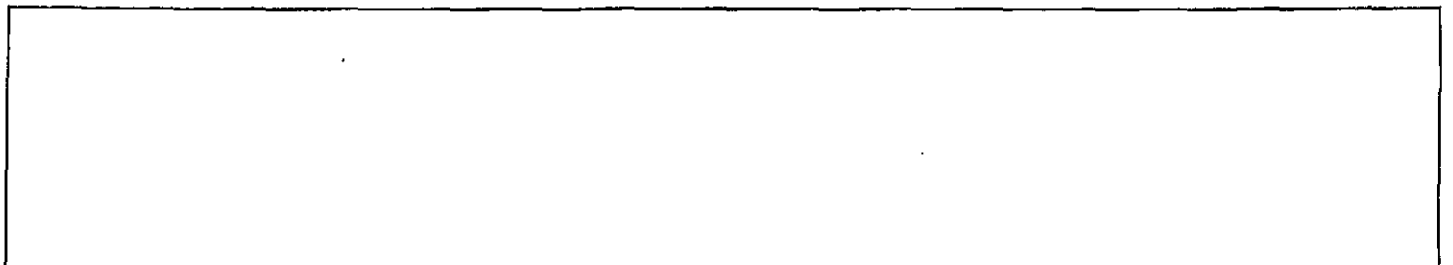

MCMILLEN, BILLY D 19-1 - APPLICATION FOR COMMINGLING OF PRODUCTION OR FLUIDS



Offset Operators, Unleased Mineral Owners and Landowners acreage
(Attach additional sheets if necessary)

Name:

Legal Description of Leasehold:

SEE ATTACHED

Horizontal lines for Name

Horizontal lines for Legal Description of Leasehold

I hereby certify that the statements made herein are true and correct to the best of my knowledge and belief.

Jimmy R D Beal
Applicant or Duly Authorized Agent

Subscribed and sworn before me this 29TH day of JUNE, 2012

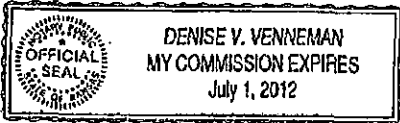

Denise V. Vennemman
Notary Public

My Commission Expires: 7-1-12

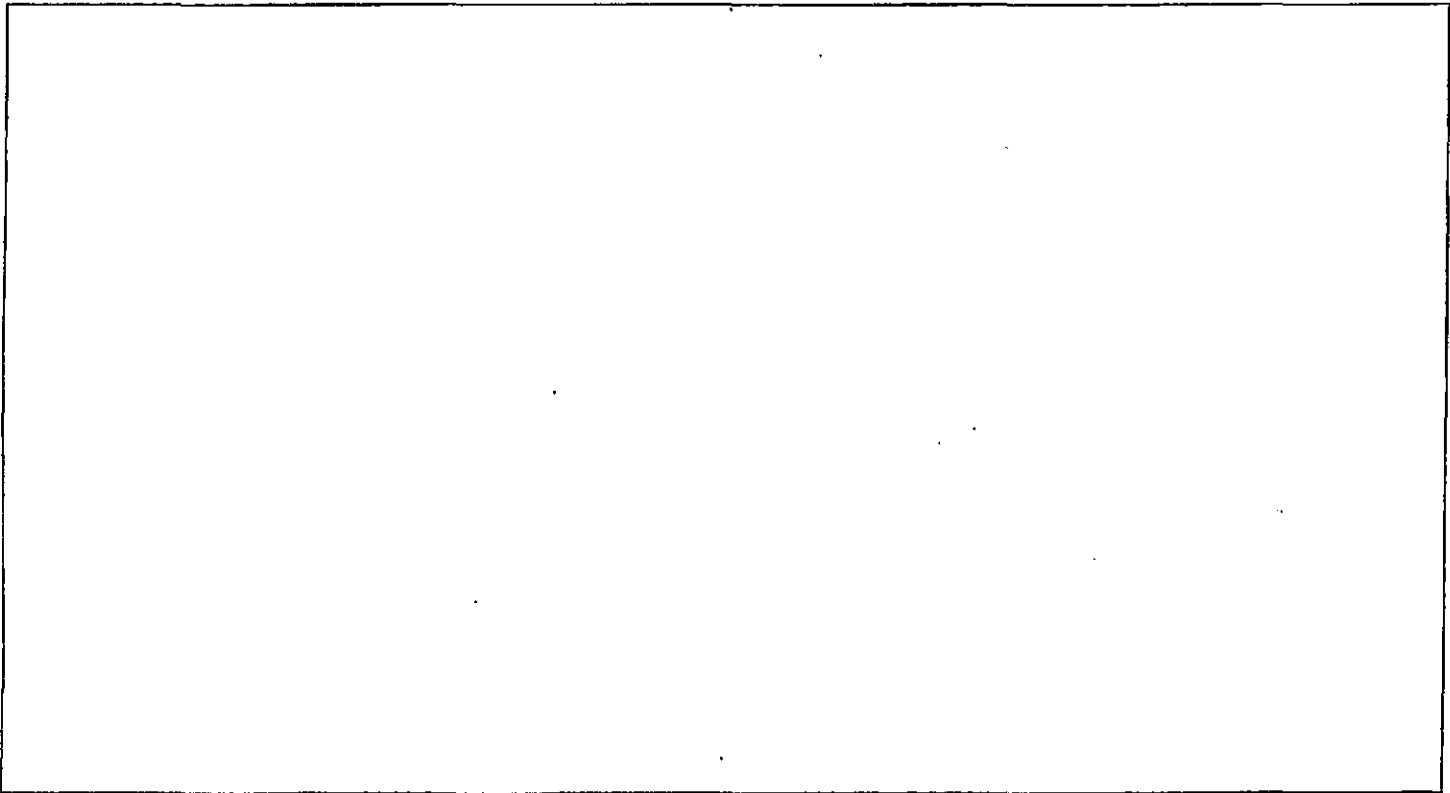

MCMILLEN, BILLY D 19-1

OFFSET OPERATORS, UNLEASED MINERAL OWNERS AND LANDOWNERS ACREAGE

SPOT	LEGAL LOCATION	CURR_OPERA
NW NW NW NW	S29-T28S-R17E	Kansas Oil, Inc.
N2 NW NW	S29-T28S-R17E	Kansas Oil, Inc.
N2 NW NW	S29-T28S-R17E	Kansas Oil, Inc.
NW NE NE SW	S20-T28S-R17E	Kansas Oil, Inc.
NW NW NW	S29-T28S-R17E	Kansas Oil, Inc.



PostRock

Wellbore Schematic

WELL: McMillen, Billy D 19-1
 SSI: 612470
 API: 15-205-26581
 LOCATION: NE SE Sec. 19 28S-17E
 COUNTY: Wilson
 STATE: Kansas

Casing	8.625" @ 22' 4.5" 10.5# J-55, 4.05" ID w/ 0.0159 bbl/ft capacity @ 1142'
Perforations	Original Perfs: 6/1/06 - Riverton 1031-1033' (9) - Weir 878-879' (5) - Tebo 854-856' (9) - Fleming 822-823' (5) - Fleming 809-811' (9) - Fleming 791-793' (9) - Croweburg 751-753' (9) - Bevier 736-738' (9) - Mulky 665-669' (17) - Summit 653-657' (17)
Completions	Spud Date: 5/12/06 V Completion: 6/1/06 - 200 gal 15% HCl - 10 BPM - 3,000# 20/40 - 300 bbls BCFTW Completion: 6/2/06 - 400 gal 15% HCl - 14.3 BPM - 18,100# 20/40 - 821 bbls SM Completion: 6/2/06 - 400 gal 15% HCl - 14.3 BPM - 12,100# 20/40 - 525 bbls

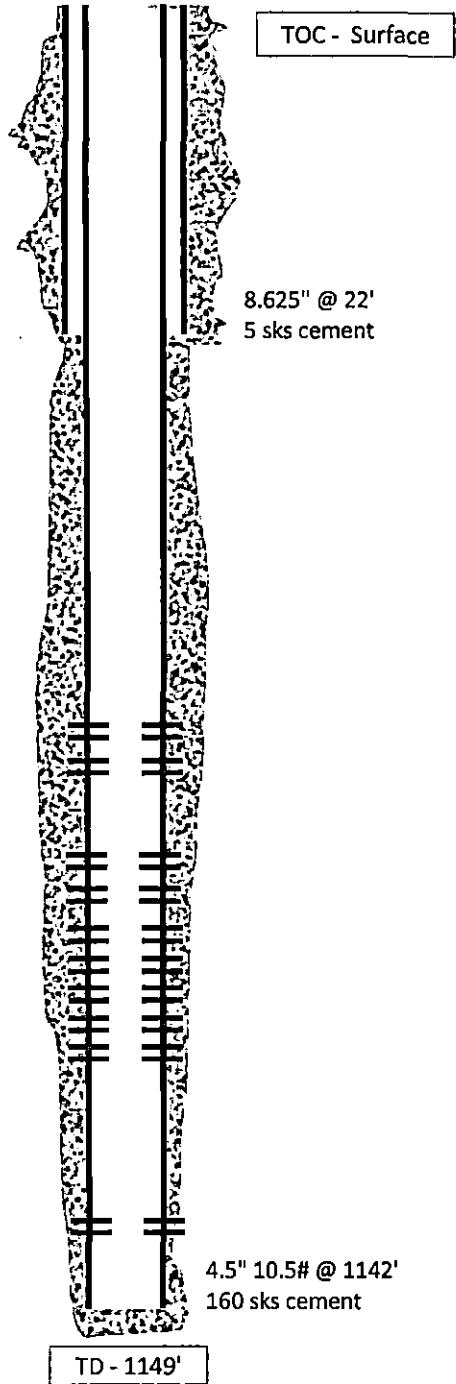

AFFIDAVIT

STATE OF KANSAS \
- SS.
County of Sedgwick /

Mark Fletchall, of lawful age, being first duly sworn, deposes and saith: That he is Record Clerk of The Wichita Eagle, a daily newspaper published in the City of Wichita, County of Sedgwick, State of Kansas, and having a general paid circulation on a daily basis in said County, which said newspaper has been continuously and uninterruptedly published in said County for more than one year prior to the first publication of the notice hereinafter mentioned, and which said newspaper has been entered as second class mail matter at the United States Post Office in Wichita, Kansas, and which said newspaper is not a trade, religious or fraternal publication and that a notice of a true copy is hereto attached was published in the regular and entire Morning issue of said The Wichita Eagle for _1_ issues, that the first publication of said notice was

made as aforesaid on the 6th of

July A.D. 2012, with

subsequent publications being made on the following dates:

And affiant further says that he has personal knowledge of the statements above set forth and that they are true.

Mark Fletchall

Subscribed and sworn to before me this

6th day of July, 2012

PENNY L. CASE
Notary Public - State of Kansas
My Appt. Expires 5/28/17

Penny L Case
Notary Public Sedgwick County, Kansas

Printer's Fee : \$132.40

LEGAL PUBLICATION
PUBLISHED IN THE WICHITA EAGLE
JULY 6, 2012 (3194614)
BEFORE THE STATE CORPORATION COMMISSION OF THE STATE OF KANSAS
NOTICE OF FILING APPLICATION
RE: In the Matter of Postrock Midcontinent Production, LLC Application for Commencing of Production in the McMillen, Billy D 19-1 located in Wilson County, Kansas. TO: All Oil & Gas Producers, Unleased Mineral Interest Owners, Landowners, and all persons whom ever concerned.
You, and each of you, are hereby notified that Postrock Midcontinent Production, LLC has filed an application to commence the Riveron, Weir, Tebo, Fleming, Croweburg, Bevier, Mulky, Summitt and Stray Sand production formations at the McMillen, Billy D 19-1, located in the SW 1/4 NE 1/4 SE 1/4 T28S-R17E, Approximately 1986 FSL & 644 FEET, Wilson County, Kansas.
Any persons who object to or protest this application shall be required to file their objections or protest with the Conservation Division of the State Corporation Commission of the State of Kansas within fifteen (15) days from the date of this publication. These protests shall be filed pursuant to Commission regulations and must state specific reasons why granting the application may cause waste, violate correlative rights or pollute the natural resources of the State of Kansas.
All persons interested or concerned shall take notice of the foregoing and shall govern themselves accordingly. All person and/or companies wishing to protest this application are required to file a written protest with the Conservation Division of the Kansas Oil and Gas Commission.
Upon the receipt of any protest, the Commission will convene a hearing and protestants will be expected to enter an appearance, either through proper legal counsel or as individuals, appearing on their own behalf.
Postrock Midcontinent Production, LLC
210 Park Avenue, Suite 2750
Oklahoma City, Oklahoma 73102
(405) 660-7700

PROOF OF PUBLICATION

STATE OF KANSAS
Wilson County - SS

JOSEPH S. and RITA M. RELPH, of lawful age, being
duly sworn upon oath that they are the Owners and
Publishers of the WILSON COUNTY CITIZEN:

THAT said newspaper has been published at least
weekly fifty (50) times a year and has been so published
for at least five years prior to the first publication of the
attached notice:

THAT said newspaper is a general circulation on a dai-
ly, or weekly, or monthly, or yearly basis in;

WILSON COUNTY, KANSAS and is NOT a trade, reli-
gious or fraternal publication and has been PRINTED
and PUBLISHED in Wilson County, Kansas.

THE ATTACHED was published on the following dates
in a regular issue of said newspaper:

1st publication was made on the 19th day of
July, 2012
2nd publication was made on the _____ day of
_____, 20_____
3rd publication was made on the _____ day of
_____, 20_____
4th publication was made on the _____ day of
_____, 20_____
5th publication was made on the _____ day of
_____, 20_____
6th publication was made on the _____ day of
_____, 20_____

TOTAL PUBLICATION FEE: \$ 38⁵⁰

(Signed) Joseph S. Relph

Subscribed and sworn to before me, this 20th day of
July, 2012

Rita M. Relph (Notary Public)

My commission expires Aug. 30, 2014

(Published in the Wilson County Citizen on
Thursday, July 19, 2012.)

BEFORE THE STATE CORPORATION
COMMISSION OF THE STATE OF KANSAS

NOTICE OF FILING APPLICATION

RE: In the Matter of Postrock Midcontinent
Production, LLC Application for Commingling of
Production in the McMillen, Billy D 19-1 located
in Wilson County, Kansas.

TO: All Oil & Gas Producers, Unleased Miner-
al Interest Owners, Landowners, and all persons
whomever concerned.

You, and each of you, are hereby notified that
Postrock Midcontinent Production, LLC has filed
an application to commingle the Riverton, Web,
Teho, Fleming, Croweburg, Beaver, Mulky, Sum-
mitt and Stray Sand producing formations at the
McMillen, Billy D 19-1, located in the SW NE NE
SE, S19-T28S-R17E, Approximately 1986 FSL &
644 FEL, Wilson County, Kansas.

Any persons who object to or protest this ap-
plication shall be required to file their objections
or protest with the Conservation Division of the
State Corporation Commission of the State of
Kansas within fifteen (15) days from the date of
this publication. These protests shall be filed pur-
suant to Commission regulations and must state
specific reasons why granting the application
may cause waste, violate correlative rights or pol-
lute the natural resources of the State of Kansas.

All persons interested or concerned shall take
notice of the foregoing and shall govern them-
selves accordingly. All person and/or companies
wishing to protest this application are required to
file a written protest with the Conservation Divi-
sion of the Kansas Oil and Gas Commission.

Upon the receipt of any protest, the Com-
mission will convene a hearing and protestants
will be expected to enter an appearance either
through proper legal counsel or as individuals,
appearing on their own behalf.

Postrock Midcontinent Production, LLC
210 Park Avenue, Suite 2750
Oklahoma City, Oklahoma 73102
(405) 660-7704
44 1 cpy.



Rita M. Relph
NOTARY PUBLIC
State of Kansas
My Commission Expires

Conservation Division
Finney State Office Building
130 S. Market, Rm. 2078
Wichita, KS 67202-3802



Phone: 316-337-6200
Fax: 316-337-6211
<http://kcc.ks.gov/>

Mark Sievers, Chairman
Thomas E. Wright, Commissioner

Sam Brownback, Governor

August 7 , 2012

Clark Edwards
PostRock Midcontinent Production LLC
Oklahoma Tower
210 Park Ave, Ste 2750
Oklahoma City, OK 73102

RE: Approved Commingling CO081204
McMillen, Billy D. 19-1 Sec.19-T28S-R17E, Wilson County
API No. 15-205-26581-00-00

Dear Mr. Edwards:

Your Application for Commingling (ACO-4) for the above described well, received by the KCC on August 1, 2012, has been reviewed and approved by the Kansas Corporation Commission (KCC) per K.A.R. 82-3-123. Notice was examined and found to be proper per K.A.R. 82-3-135a. No protest had been filed within the 15-day protest period.

Based upon the depth of the Riverton formation perforations, total oil production shall not exceed 100 BOPD and total gas production shall not exceed 50% of the absolute open flow (AOF).

File form ACO-1 upon re-completion of the well to commingle.

Commingling ID number CO081204 has been assigned to this approved application. Use this number for well completion reports (ACO-1) and other correspondence that may concern this approved commingling.

Sincerely,

Rick Hestermann
Production Department