



APPLICATION FOR COMMINGLING OF PRODUCTION (K.A.R. 82-3-123) OR FLUIDS (K.A.R. 82-3-123a)

Commingling ID # **CO081213**

OPERATOR: License # 33343
Name: PostRock Midcontinent Production LLC
Address 1: Oklahoma Tower
Address 2: 210 Park Ave, Ste 2750
City: OKLAHOMA CITY State: OK Zip: 73102 +
Contact Person: CLARK EDWARDS
Phone: (620) 432-4200

API No. 15 - 15-205-26631-00-00
Spot Description: _____
SE NW NE NE Sec. 27 Twp. 28 S. R. 16 East West
625 Feet from North / South Line of Section
678 Feet from East / West Line of Section
County: Wilson
Lease Name: BROWN DOYLE C Well #: 27-1

1. Name and upper and lower limit of each production interval to be commingled:
Formation: SUMMIT (Perfs): 715-719
Formation: MULKY (Perfs): 730-734
Formation: BEVIER (Perfs): 801-803
Formation: CROWEBURG (Perfs): 815-817
Formation: FLEMING (Perfs): 851-854

2. Estimated amount of fluid production to be commingled from each interval:
Formation: SUMMIT BOPD: 0 MCFPD: 2 BWPD: .29
Formation: MULKY BOPD: 0 MCFPD: 2 BWPD: .29
Formation: BEVIER BOPD: 0 MCFPD: 2 BWPD: .29
Formation: CROWEBURG BOPD: 0 MCFPD: 2 BWPD: .29
Formation: FLEMING BOPD: 0 MCFPD: 2 BWPD: .29

3. Plat map showing the location of the subject well, all other wells on the subject lease, and all wells on offsetting leases within a 1/2 mile radius of the subject well, and for each well the names and addresses of the lessee of record or operator.

4. Signed certificate showing service of the application and affidavit of publication as required in K.A.R. 82-3-135a.

For Commingling of PRODUCTION ONLY, include the following:

- 5. Wireline log of subject well. Previously Filed with ACO-1: Yes No
- 6. Complete Form ACO-1 (Well Completion form) for the subject well.

For Commingling of FLUIDS ONLY, include the following:

- 7. Well construction diagram of subject well.
- 8. Any available water chemistry data demonstrating the compatibility of the fluids to be commingled.

AFFIDAVIT: I am the affiant and hereby certify that to the best of my current information, knowledge and personal belief, this request for commingling is true and proper and I have no information or knowledge, which is inconsistent with the information supplied in this application.

Submitted Electronically

KCC Office Use Only
 Denied Approved
15-Day Periods Ends: 8/29/2012
Approved By: Rick Hestermann Date: 08/29/2012

Protests may be filed by any party having a valid interest in the application. Protests must be in writing and comply with K.A.R. 82-3-135b and must be filed within 15 days of publication of the notice of application.

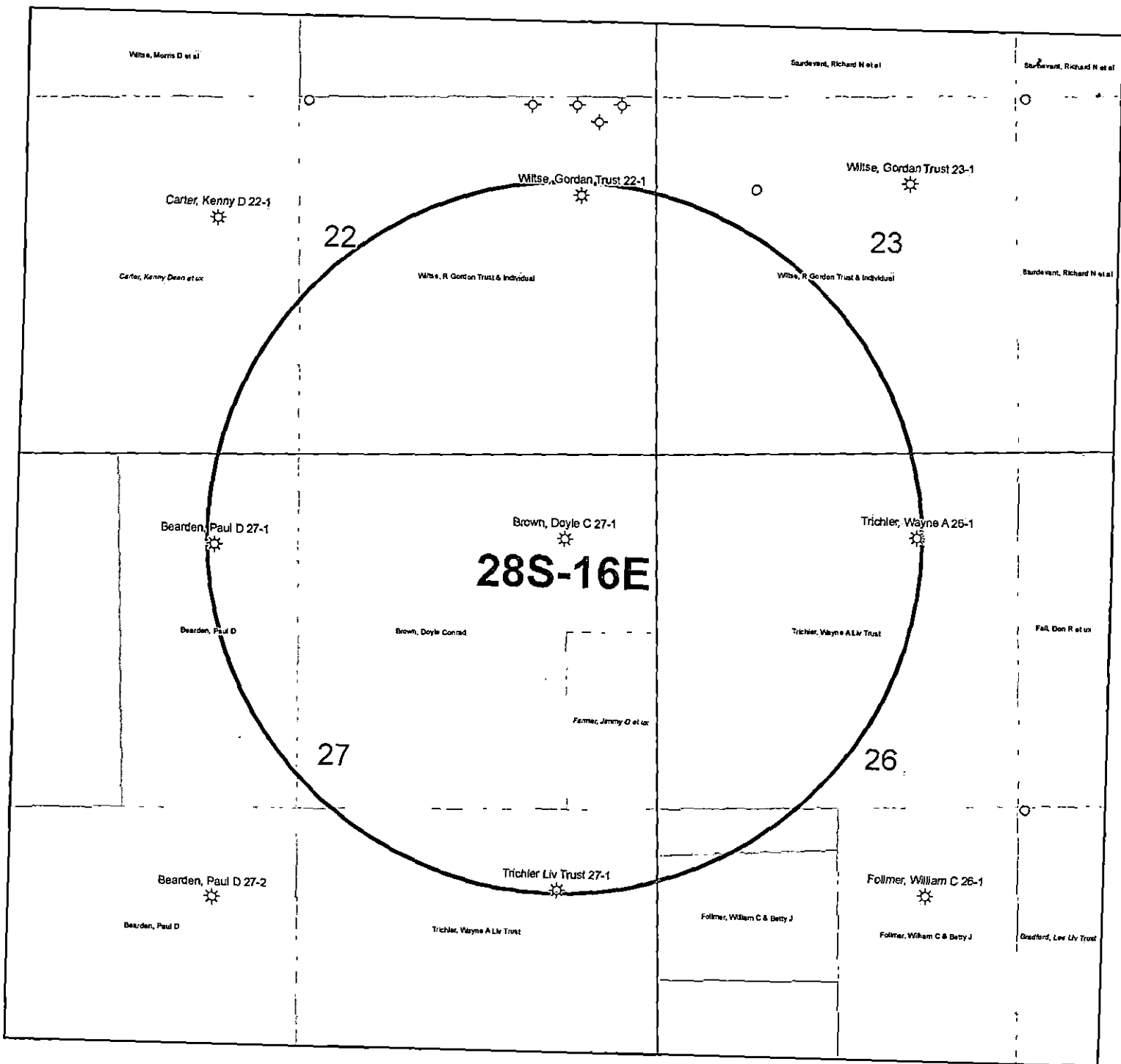

KGS STATUS	
◇	DA/PA
⊙	EOR
☼	GAS
△	INJ/SWD
●	OIL
⊛	OIL/GAS
○	OTHER

Brown, Doyle C 27-1
 27-28S-16E
 1" = 1,000'

KANSAS CORPORATION COMMISSION **ORIGINAL**
OIL & GAS CONSERVATION DIVISION

Form ACO-1
September 1999
Form Must Be Typed

WELL COMPLETION FORM
WELL HISTORY - DESCRIPTION OF WELL & LEASE

Operator: License # 33344
Name: Quest Cherokee, LLC
Address: 211 W. 14th Street
City/State/Zip: Chanute, KS 66720
Purchaser: Bluestem Pipeline, LLC
Operator Contact Person: Jennifer R. Ammann
Phone: (620) 431-9500
Contractor: Name: Michaels Drilling
License: 33783

Wellsite Geologist: Ken Recoy

Designate Type of Completion:
 New Well Re-Entry Workover
 Oil SWD SIOW Temp. Abd.
 Gas ENHR SIGW
 Dry Other (Core, WSW, Expl., Cathodic, etc)

If Workover/Re-entry: Old Well Info as follows:

Operator: _____
Well Name: _____

Original Comp. Date: _____ Original Total Depth: _____

Deepening Re-perf. Conv. to Enhr./SWD
 Plug Back Plug Back Total Depth

Commingled Docket No. _____

Dual Completion Docket No. _____

Other (SWD or Enhr.?) Docket No. _____

5/23/06	5/24/06	5/31/06
Spud Date or Recompletion Date	Date Reached TD	Completion Date or Recompletion Date

API No. 15 - 205-26631-00-00

County: Wilson

Sec. 27 Twp. 28 S. R. 16 East West

660 feet from S / N (circle one) Line of Section

660 feet from E / W (circle one) Line of Section

Footages Calculated from Nearest Outside Section Corner:

(circle one) NE SE NW SW

Lease Name: Brown, Doyle C. Well #: 27-1

Field Name: Cherokee Basin CBM

Producing Formation: Multiple

Elevation: Ground: 940 Kelly Bushing: n/a

Total Depth: 1185 Plug Back Total Depth: 1179.76

Amount of Surface Pipe Set and Cemented at 23 Feet

Multiple Stage Cementing Collar Used? Yes No

If yes, show depth set _____ Feet

If Alternate II completion, cement circulated from 1179.76

feet depth to surface w/ 150 sx cmt.

Drilling Fluid Management Plan Alt II NRK
(Data must be collected from the Reserve Pit) 11-24-08

Chloride content _____ ppm Fluid volume _____ bbls

Dewatering method used _____

Location of fluid disposal if hauled offsite: _____

Operator Name: _____

Lease Name: _____ License No. _____

Quarter _____ Sec. _____ Twp. _____ S. R. _____ East West

County: _____ Docket No.: _____

RECEIVED
KANSAS CORPORATION COMMISSION
SEP 20 2006
CONSERVATION DIVISION
WICHITA, KS

INSTRUCTIONS: An original and two copies of this form shall be filed with the Kansas Corporation Commission, 130 S. Market - Room 2078, Wichita, Kansas 67202, within 120 days of the spud date, recompletion, workover or conversion of a well. Rule 82-3-130, 82-3-106 and 82-3-107 apply. Information of side two of this form will be held confidential for a period of 12 months if requested in writing and submitted with the form (see rule 82-3-107 for confidentiality in excess of 12 months). One copy of all wireline logs and geologist well report shall be attached with this form. ALL CEMENTING TICKETS MUST BE ATTACHED. Submit CP-4 form with all plugged wells. Submit CP-111 form with all temporarily abandoned wells.

All requirements of the statutes, rules and regulations promulgated to regulate the oil and gas industry have been fully complied with and the statements herein are complete and correct to the best of my knowledge.

Signature: Jennifer R. Ammann

Title: New Well Development Coordinator Date: 9/19/06

Subscribed and sworn to before me this 19th day of September

20 06.

Notary Public: Debra Klauerman

Date Commission Expires: 8-4-2010

TERRA KLAUMAN
Notary Public - State of Kansas
My Appt. Expires 8-4-2010

KCC Office Use ONLY

Letter of Confidentiality Received
If Denied, Yes Date: _____

Wireline Log Received

Geologist Report Received

UIC Distribution

Operator Name: Quest Cherokee, LLC Lease Name: Brown, Doyle C. Well #: 27-1
 Sec. 27 Twp. 28 S. R. 16 East West County: Wilson

INSTRUCTIONS: Show important tops and base of formations penetrated. Detail all cores. Report all final copies of drill stems tests giving interval tested, time tool open and closed, flowing and shut-in pressures, whether shut-in pressure reached static level, hydrostatic pressures, bottom hole temperature, fluid recovery, and flow rates if gas to surface test, along with final chart(s). Attach extra sheet if more space is needed. Attach copy of all Electric Wireline Logs surveyed. Attach final geological well site report.

Drill Stem Tests Taken <input type="checkbox"/> Yes <input checked="" type="checkbox"/> No <i>(Attach Additional Sheets)</i> Samples Sent to Geological Survey <input type="checkbox"/> Yes <input checked="" type="checkbox"/> No Cores Taken <input type="checkbox"/> Yes <input checked="" type="checkbox"/> No Electric Log Run <input checked="" type="checkbox"/> Yes <input type="checkbox"/> No <i>(Submit Copy)</i> List All E. Logs Run: Dual Induction Log Compensated Density/Neutron Log Gamma Ray Neutron Log	<input checked="" type="checkbox"/> Log Formation (Top), Depth and Datum <input type="checkbox"/> Sample Name Top Datum See attached
---	--

CASING RECORD <input type="checkbox"/> New <input type="checkbox"/> Used							
Report all strings set-conductor, surface, intermediate, production, etc.							
Purpose of String	Size Hole Drilled	Size Casing Set (In O.D.)	Weight Lbs. / Ft.	Setting Depth	Type of Cement	# Sacks Used	Type and Percent Additives
Surface	12-1/4	8-5/8"	20	23	"A"	4	
Production	6-3/4	4-1/2	10.5#	1179.76	"A"	150	

ADDITIONAL CEMENTING / SQUEEZE RECORD				
Purpose:	Depth Top Bottom	Type of Cement	#Sacks Used	Type and Percent Additives
<input type="checkbox"/> Perforate <input type="checkbox"/> Protect Casing <input type="checkbox"/> Plug Back TD <input type="checkbox"/> Plug Off Zone				

Shots Per Foot	PERFORATION RECORD - Bridge Plugs Set/Type Specify Footage of Each Interval Perforated	Acid, Fracture, Shot, Cement Squeeze Record (Amount and Kind of Material Used)	Depth
4	801-803/815-817/851-854/913-915/968-970	300gal 15% HCL w/ 30 lbs 2% acid water, 650bbl water w/ 2% KCL, 800lbs, 11000# 20/40 sand	801-803/815-817 851-854 913-915/968-970
4	715-719/730-734	300gal 15% HCL w/ 54 lbs 2% acid water, 650bbl water w/ 2% KCL, 800lbs, 12000# 20/40 sand	715-719/730-734

TUBING RECORD		Size	Set At	Packer At	Liner Run
		2-3/8"	936.4	n/a	<input type="checkbox"/> Yes <input checked="" type="checkbox"/> No
Date of First, Resumed Production, SWD or Enhr.			Producing Method		
7/25/06			<input type="checkbox"/> Flowing <input checked="" type="checkbox"/> Pumping <input type="checkbox"/> Gas Lift <input type="checkbox"/> Other (Explain)		
Estimated Production Per 24 Hours	Oil Bbls.	Gas Mcf	Water Bbls.	Gas-Oil Ratio	Gravity
	n/a	7.8mcf	56.9bbls		

Disposition of Gas Vented Sold Used on Lease *(If vented, Submit ACO-18.)*

METHOD OF COMPLETION Open Hole Perf. Dually Comp. Commingled Other (Specify) _____

Production Interval _____

	A	B	C	D	E	F	G	H	I	J	K
1	Produced Fluids #		1	2	3	4	5		Click here to run SSP Goal Seek SSP		Click
2	Parameters	Units	Input	Input	Input	Input	Input				Click
3	Select the brines	Select fluid by checking the box(es),	<input type="checkbox"/>	<input type="checkbox"/>	<input type="checkbox"/>	<input type="checkbox"/>	<input type="checkbox"/>	Mixed brine:			Click
4	Sample ID							Cell H28 is			
5	Date		3/19/2012	3/4/2012	3/14/2012	1/20/2012	1/20/2012	STP calc. pH.			Click
6	Operator	Row 3	PostRock	PostRock	PostRock	PostRock	PostRock	Cells H35-38			
7	Well Name		Ward Feed	Ward Feed	Clinesmith	Clinesmith	Clinesmith	are used in			Click
8	Location		#34-1	#4-1	#5-4	#1	#2	mixed brines			
9	Field		CBM	CBM	Bartles	Bartles	Bartles	calculations.			Click
10	Na ⁺	(mg/l)*	19,433.00	27,381.00	26,534.00	25689.00	24220.00	24654.20	Initial(BH)	Final(WH)	SUSR (Final-Initial)
11	K ⁺ (if not known =0)	(mg/l)						0.00	Saturation Index values		
12	Mg ²⁺	(mg/l)	1,096.00	872.00	1,200.00	953.00	858.00	995.91	Calcite		
13	Ca ²⁺	(mg/l)	1,836.00	2,452.00	2,044.00	1920.00	1948.00	2040.23	-0.73	-0.60	0.13
14	Sr ²⁺	(mg/l)						0.00	Barite		
15	Ba ²⁺	(mg/l)						0.00			
16	Fe ²⁺	(mg/l)	40.00	21.00	18.00	82.00	90.00	50.21	Halite		
17	Zn ²⁺	(mg/l)						0.00	-1.77	-1.80	-0.03
18	Pb ²⁺	(mg/l)						0.00	Gypsum		
19	Cl ⁻	(mg/l)	36,299.00	48,965.00	47,874.00	45632.00	43147.00	44388.44	-3.19	-3.18	0.00
20	SO ₄ ²⁻	(mg/l)	1.00	1.00	8.00	1.00	1.00	2.40	Hemihydrate		
21	F ⁻	(mg/l)						0.00	-3.96	-3.90	0.06
22	Br ⁻	(mg/l)						0.00	Anhydrite		
23	SiO ₂	(mg/l) SiO ₂						0.00	-3.47	-3.36	0.12
24	HCO ₃ Alkalinity**	(mg/l as HCO ₃)	190.00	234.00	259.00	268.00	254.00	241.03	Celestite		
25	CO ₃ Alkalinity	(mg/l as CO ₃)									
26	Carboxylic acids**	(mg/l)						0.00	Iron Sulfide		
27	Ammonia	(mg/L) NH ₃						0.00	-0.16	-0.22	-0.06
28	Borate	(mg/L) H ₃ BO ₃						0.00	Zinc Sulfide		
29	TDS (Measured)	(mg/l)						72781			
30	Calc. Density (STP)	(g/ml)	1.038	1.051	1.050	1.048	1.045	1.047	Calcium fluoride		
31	CO ₂ Gas Analysis	(%)	19.97	18.76	22.41	35.53	33.79	26.16			
32	H ₂ S Gas Analysis***	(%)	0.0289	0.0292	0.0296	0.0306	0.0151	0.0269	Iron Carbonate		
33	Total H ₂ Saq	(mgH ₂ S/l)	1.00	1.00	1.00	1.00	0.50	0.90	-0.74	-0.51	0.23
34	pH, measured (STP)	pH	5.67	5.76	5.72	5.54	5.55	5.63	Inhibitor needed (mg/L)		
		0-CO ₂ %+Alk.							Calcite	NTMP	
35	Choose one option to calculate SI?	1-pH+Alk. 2-CO ₂ %+pH	0	0	0	0	0				
36	Gas/day(thousand cf/day)	(Mc/D)						0	0.00	0.00	
37	Oil/Day	(B/D)	0	0	1	1	1	4	Barite	BHPMP	
38	Water/Day	(B/D)	100	100	100	100	100	500	0.00	0.00	
39	For mixed brines, enter values for temperatures and pressures in Cells (H40-H43)								(Enter H40-H43)		pH
40	Initial T	(F)	66.0	71.0	70.0	41.0	49.0	60.0	5.69	5.60	
41	Final T	(F)	66.0	71.0	70.0	41.0	49.0	60.0	Viscosity (CentiPoise)		
42	Initial P	(psia)	25.0	25.0	25.0	25.0	25.0	25.0	1.196	0.826	
43	Final P	(psia)	25.0	25.0	25.0	25.0	25.0	120.0	Heat Capacity (cal/ml ² C)		
44	Use TP on Calcite sheet?	1-Yes;0-No							0.955	0.959	
45	API Oil Grav.	API grav.						30.00	Inhibitor needed (mg/L)		
46	Gas Sp. Grav.	Sp.Grav.						0.60	Gypsum	HDTMP	
47	MeOH/Day	(B/D)	0					0	0.00	0.00	
48	MEG/Day	(B/D)	0					0	Anhydrite	HDTMP	
49	Conc. Multiplier								0.00	0.00	
50	H ⁺ (Strong acid) †	(N)									
51	OH ⁻ (Strong base) †	(N)									
52	Quality Control Checks at STP:										
53	H ₂ S Gas	(%)									
54	Total H ₂ Saq (STP)	(mgH ₂ S/l)									
55	pH Calculated	(pH)									
56	PCO ₂ Calculated	(%)									
57	Alkalinity Calculated	(mg/l) as HCO ₃									
58	ECations=	(equiv./l)									
59	EAnions=	(equiv./l)									
60	Calc TDS=	(mg/l)									
61	Inhibitor Selection	Input	Unit	#	Inhibitor	Unit Converter (From metric to English)		Value			
62	Protection Time	120	min	1	NTMP	From Unit	To Unit	Value			
63	Have ScaleSoftPitzer			2	BHPMP	°C	°F	80			176
64	pick inhibitor for you?	1	1-Yes;0-No	3	PAA	m ³	ft ³	100			3,531
65	If No, inhibitor # is:	4	#	4	DTPMP	m ³	bb(42 US gal)	100			629
66	If you select Mixed,			5	PPCA	MPa	psia	1,000			145,074
67	1 st inhibitor # is:	1	#	6	SPA	Bar	psia	496			7,194
68	% of 1 st inhibitor is:	50	%	7	HEDP	Torr	psia	10,000			193
69	2 nd inhibitor # is:	2	#	8	HDTMP	Gal	bb(42 US gal)	10,000			238
70	Display act. coeffs?	0	1-Yes;0-No	9	Average	Liters	bb(42 US gal)	10,000			63
71				10	Mixed						

Saturation Index Calculations

Champion Technologies, Inc.

(Based on the Tomson-Oddo Model)

Brine 1: Ward Feed Yard 34-1

Brine 2: Ward Feed Yard 4-1

Brine 3: Clinesmith 5-4

Brine 4: Clinesmith 1

Brine 5: Clinesmith 2

Component (mg/L)	Ratio					Mixed Brine
	20% Brine 1	20% Brine 2	20% Brine 3	20% Brine 4	20 Brine 5	
Calcium	1836	2452	2044	1920	1948	1952
Magnesium	1096	872	1200	953	858	865
Barium	0	0	0	0	0	0
Strontium	0	0	0	0	0	0
Bicarbonate	190	234	259	268	254	253
Sulfate	1	1	8	1	1	1
Chloride	36299	48965	47874	45632	43147	43206
CO ₂ in Brine	246	220	264	422	405	401
Ionic Strength	1.12	1.48	1.46	1.38	1.31	1.31
Temperature (°F)	89	89	89	89	89	89
Pressure (psia)	50	50	120	120	120	119

Saturation Index

Calcite	-1.71	-1.41	-1.48	-1.68	-1.69	-1.69
Gypsum	-3.71	-3.64	-2.82	-3.73	-3.72	-3.69
Hemihydrate	-3.70	-3.65	-2.83	-3.74	-3.71	-3.69
Anhydrite	-3.89	-3.79	-2.97	-3.89	-3.88	-3.85
Barite	N/A	N/A	N/A	N/A	N/A	N/A
Celestite	N/A	N/A	N/A	N/A	N/A	N/A

PTB

Calcite	N/A	N/A	N/A	N/A	N/A	N/A
Gypsum	N/A	N/A	N/A	N/A	N/A	N/A
Hemihydrate	N/A	N/A	N/A	N/A	N/A	N/A
Anhydrite	N/A	N/A	N/A	N/A	N/A	N/A
Barite	N/A	N/A	N/A	N/A	N/A	N/A
Celestite	N/A	N/A	N/A	N/A	N/A	N/A

POSTROCK



Current Completion

WELL : Brown, Doyle C 27-1
 FIELD : Cherokee Basin
 STATE : Kansas
 COUNTY : Wilson

SPUD DATE : 5/23/2006
 COMP. Date : 5/31/2006
 API: 15-205-26631-00-00

LOCATION: 27-28S-16E (NE NE)
 ELEVATION: GL - 940'

8 5/8" 20 lb @ 23' Cement w/ 4 sks

2 3/8" tubing @ 936'

4.5" 10.5 lb @ 1180' Cement w/150 sks

Drilled Depth @ 1185'

Wellhead/Surface Equipment

Tree Connection	
Tree	
Tubing Head	
Bradenhead	
Pumping Unit	
Compressor	

Tubular Detail

Size	Weight	Grade	Cap(bbl/ft)	Date	Depth
8 5/8"	20 lb			2006	23'
4 1/2"	10.5 lb		.0159	2006	1180'

Downhole Equipment Detail

Completion Data

Original as GAS Well per ACO-1	
600 gals 15% HCL	
865 bbbs	
23,900 lbs 20/40 sand	

Perforations

Original Completion:
715-719 (Summit) (17)
730-734 (Mulky) (17)
801-803 (Bevier) (9)
815-817 (Croweburg) (9)
851-854 (Fleming) (13)
913-915 (Tebo) (9)
968-970 (Weir) (9)

PREPARED BY: POSTROCK _____

DATE: July, 2012 _____

APPROVED BY: _____

DATE: _____

POSTROCK



LEGEND

PostRock

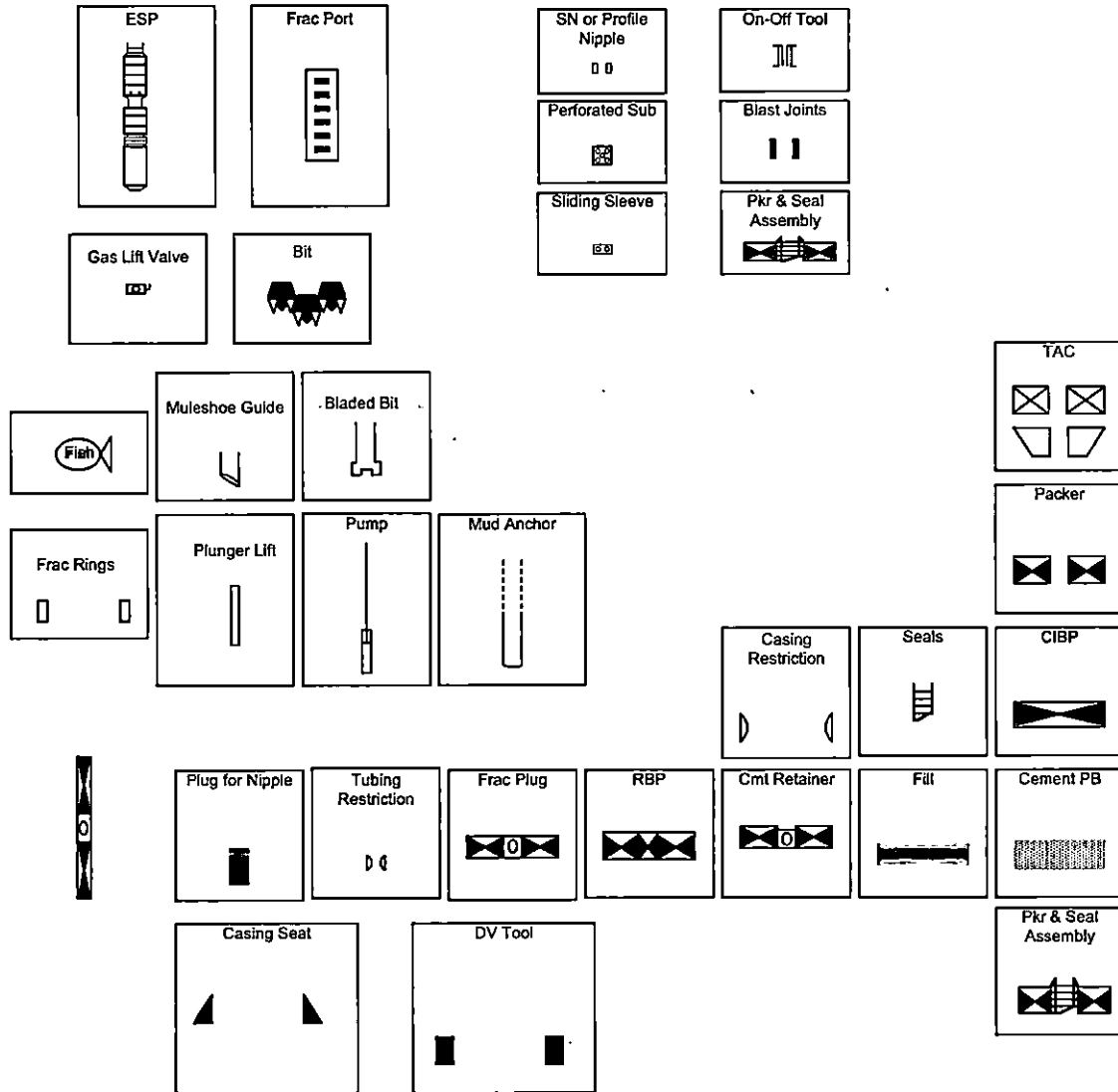

AFFIDAVIT

STATE OF KANSAS \
- SS.
County of Sedgwick /

Mark Fletchall, of lawful age, being first duly sworn, deposes and saith: That he is Record Clerk of The Wichita Eagle, a daily newspaper published in the City of Wichita, County of Sedgwick, State of Kansas, and having a general paid circulation on a daily basis in said County, which said newspaper has been continuously and uninterruptedly published in said County for more than one year prior to the first publication of the notice hereinafter mentioned, and which said newspaper has been entered as second class mail matter at the United States Post Office in Wichita, Kansas, and which said newspaper is not a trade, religious or fraternal publication and that a notice of a true copy is hereto attached was published in the regular and entire Morning issue of said The Wichita Eagle for 1 issues, that the first publication of said notice was

made as aforesaid on the 19th of

July A.D. 2012, with

subsequent publications being made on the following dates:

And affiant further says that he has personal knowledge of the statements above set forth and that they are true.

Mark Fletchall

Subscribed and sworn to before me this

19th day of July, 2012

 PENNY L. CASE
Notary Public, State of Kansas
My Appt. Expires 5/28/2014

Penny L. Case
Notary Public Sedgwick County, Kansas

Printer's Fee : \$132.40

LEGAL PUBLICATION

PUBLISHED IN THE WICHITA EAGLE
JULY 19, 2012 (3196740)
BEFORE THE STATE CORPORATION
COMMISSION OF THE STATE OF KANSAS.
NOTICE OF FILING APPLICATION

RE: In the Matter of Postrock Midcontinent
Production, LLC. Application for
Commencing of Production in the
Brown, Doyle C. 27-1, located in Wilson
County, Kansas.

TO: All Oil & Gas Producers, Unleased Mineral
Interest Owners, Landowners, and all
persons whomsoever concerned.

You, and each of you, are hereby notified
that Postrock Midcontinent Production, LLC
has filed an application to commence the Weir,
Tebbs, Fleming, Croweburg, Bevier, Moberg,
Summit and Bartlesville producing formations
of the Brown, Doyle C. 27-1, located in the SE
NW 1/4 NE 1/4, S27-T28S-R16E, approximately
625 ENL & 678 FEL, Wilson County, Kansas.

Any persons who object to or protest
this application shall be required to file their
objections or protest with the Conservation
Division of the State Corporation Commission
of the State of Kansas within fifteen (15)
days from the date of this publication. These
protests shall be filed pursuant to Commission
regulations and must state specific reasons
why granting the application may cause waste,
violate correlative rights or pollute the natural
resources of the State of Kansas.

All persons interested or concerned shall
take notice of the foregoing and shall govern
themselves accordingly. All person and/or
companies wishing to protest this application
are required to file a written protest with the
Conservation Division of the Kansas Oil and
Gas Commission.

Upon the receipt of any protest, the
Commission will convene a hearing and
protestants will be expected to enter an
appearance either through proper legal
counsel or as individuals appearing on their
own behalf.

Postrock Midcontinent Production, LLC
210 Park Avenue, Suite 2750
Oklahoma City, Oklahoma 73102
(405) 660-7784

A COPY OF THE AFFIDAVIT OF PUBLICATION
MUST ACCOMPANY ALL APPLICATIONS

PROOF OF PUBLICATION

STATE OF KANSAS
Wilson County - SS

JOSEPH S. and RITA M. RELPH, of lawful age, being duly sworn upon oath that they are the Owners and Publishers of the WILSON COUNTY CITIZEN:

THAT said newspaper has been published at least weekly fifty (50) times a year and has been so published for at least five years prior to the first publication of the attached notice:

THAT said newspaper is a general circulation on a daily, or weekly, or monthly, or yearly basis in;

WILSON COUNTY, KANSAS and is NOT a trade, religious or fraternal publication and has been PRINTED and PUBLISHED in Wilson County, Kansas.

THE ATTACHED was published on the following dates in a regular issue of said newspaper:

1st publication was made on the 19th day of July, 2012
2nd publication was made on the _____ day of _____, 20_____
3rd publication was made on the _____ day of _____, 20_____
4th publication was made on the _____ day of _____, 20_____
5th publication was made on the _____ day of _____, 20_____
6th publication was made on the _____ day of _____, 20_____

TOTAL PUBLICATION FEE, \$ 38.50

(Signed) Joseph S. Relph

Subscribed and sworn to before me, this 20th day of July, 2012

Rita M. Relph (Notary Public)

My commission expires Aug. 30, 2014

(Published in the Wilson County Citizen on Thursday, July 19, 2012.)
BEFORE THE STATE CORPORATION COMMISSION OF THE STATE OF KANSAS
NOTICE OF FILING APPLICATION
RE: In the Matter of Postrock Midcontinent Production, LLC Application for Commingling of Production in the Brown, Doyle C27-1 located in Wilson County, Kansas.
TO: All Oil & Gas Producers, Unleased Mineral Interest Owners, Landowners, and all persons whomsoever concerned.
You, and each of you, are hereby notified that Postrock Midcontinent Production, LLC has filed an application to commingle the Weir, Tebo, Fleming, Croweburg, Boyer, Mulky, Summit and Bartlesville producing formations at the Brown, Doyle C27-1, located in the SE NW NE NE, E27-128S-R16E, Approximately 625 FNL & 678 FEL, Wilson County, Kansas.
Any persons who object to or protest this application shall be required to file their objections or protest with the Conservation Division of the State Corporation Commission of the State of Kansas within fifteen (15) days from the date of this publication. These protests shall be filed pursuant to Commission regulations and must state specific reasons why granting the application may cause waste, violate correlative rights or pollute the natural resources of the State of Kansas.
All persons interested or concerned shall take notice of the foregoing and shall govern themselves accordingly. All persons and/or companies wishing to protest this application are required to file a written protest with the Conservation Division of the Kansas Oil and Gas Commission.
Upon the receipt of any protest, the Commission will convene a hearing and protestants will be expected to enter an appearance either through proper legal counsel or as individuals appearing on their own behalf.
Postrock Midcontinent Production, LLC
210 Park Avenue, Suite 2750
Oklahoma City, Oklahoma 73102
(405) 660-7704
441 cpy/



Affidavit of Notice Served

Re: Application for: APPLICATION FOR COMMINGLING OF PRODUCTION OR FLUIDS ACO-4

Well Name: BROWN, DOYLE C 27-1 Legal Location: SEWNENE S27-T28S-R16E

The undersigned hereby certifies that he / she is a duly authorized agent for the applicant, and that on the day 14th of AUGUST, 2012, a true and correct copy of the application referenced above was delivered or mailed to the following parties:

Note: A copy of this affidavit must be served as a part of the application.

Name	Address (Attach additional sheets if necessary)
FLOYD ARTHUR RUSSELL & MARGARET JEANNE RUSSELL	14465 SCOTT RD, ALTOONA, KS 66710

I further attest that notice of the filing of this application was published in the WILSON COUNTY CITIZEN, the official county publication of WILSON county. A copy of the affidavit of this publication is attached.

Signed this 14th day of AUGUST, 2012

Jess L Morris
Applicant or Duty Authorized Agent

Subscribed and sworn to before me this 14th day of AUGUST, 2012



Jennifer R Beal
Notary Public
My Commission Expires: July 20, 2016

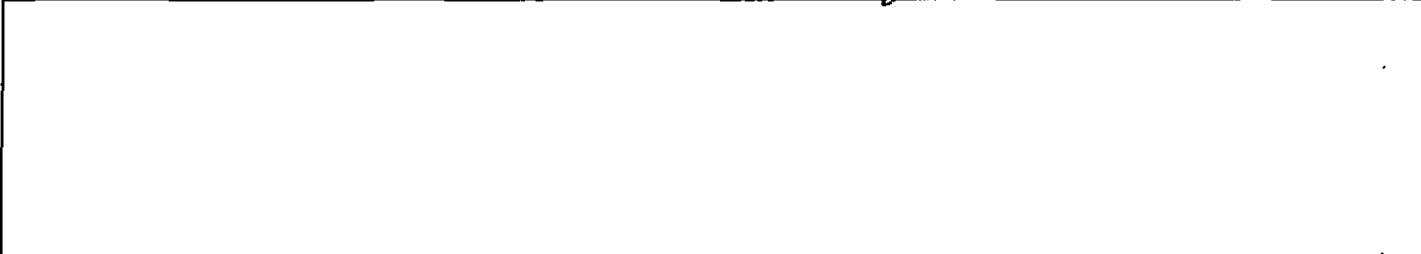

BROWN, DOYLE C 27-1 - APPLICATION FOR COMMINGLING OF PRODUCTION OR FLUIDS

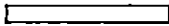

Offset Operators, Unleased Mineral Owners and Landowners acreage
(Attach additional sheets if necessary)

Name:

Legal Description of Leasehold:

SEE ATTACHED

I hereby certify that the statements made herein are true and correct to the best of my knowledge and belief.

Jess L Morris
 Applicant or Duty Authorized Agent

Subscribed and sworn before me this 14th day of AUGUST, 2012



Jennifer R Beal
 Notary Public
 My Commission Expires: July 20, 2016

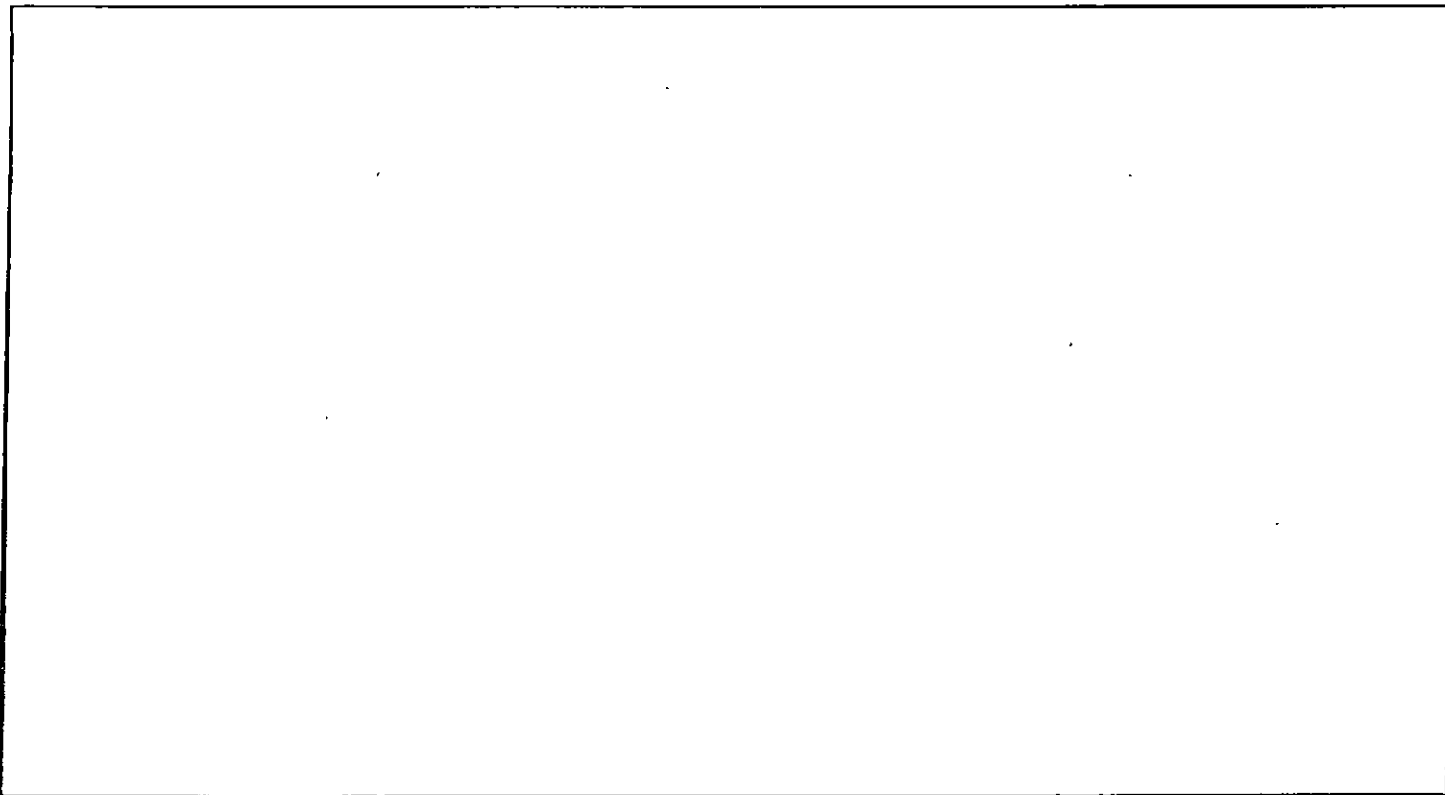

BROWN, DOYLE C 27-1

26-28S-16E

per TO dtd 10.6.10

**Tract in NW4 SW4
(9.35 Acres)**

**Floyd Arthur Russell and Margaret Jeanne Russell
14465 Scott Rd
Altoona, KS 66710**

Conservation Division
Finney State Office Building
130 S. Market, Rm. 2078
Wichita, KS 67202-3802



Phone: 316-337-6200
Fax: 316-337-6211
<http://kcc.ks.gov/>

Mark Sievers, Chairman
Thomas E. Wright, Commissioner

Sam Brownback, Governor

August 29 , 2012

Clark Edwards
PostRock Midcontinent Production LLC
Oklahoma Tower
210 Park Ave, Ste 2750
Oklahoma City, OK 73102

RE: Approved Commingling CO081213
Brown, Doyle C. 27-1, Sec.27-T28S-R16E, Wilson County
API No. 15-205-26631-00-00

Dear Mr. Edwards:

Your Application for Commingling (ACO-4) for the above described well, received by the KCC on August 14, 2012, has been reviewed and approved by the Kansas Corporation Commission (KCC) per K.A.R. 82-3-123. Notice was examined and found to be proper per K.A.R. 82-3-135a. No protest had been filed within the 15-day protest period.

Based upon the depth of the Bartlesville formation perforations, total oil production shall not exceed 100 BOPD and total gas production shall not exceed 50% of the absolute open flow (AOF).

File form ACO-1 upon re-completion of the well to commingle.

Commingling ID number CO081213 has been assigned to this approved application. Use this number for well completion reports (ACO-1) and other correspondence that may concern this approved commingling.

Sincerely,

Rick Hestermann
Production Department