



KANSAS CORPORATION COMMISSION 1086596
OIL & GAS CONSERVATION DIVISION

Form ACO-4
Form must be typed
March 2009

APPLICATION FOR COMMINGLING OF *Commingling ID #* **CO081230**
PRODUCTION (K.A.R. 82-3-123) OR FLUIDS (K.A.R. 82-3-123a)

OPERATOR: License # 33343
Name: PostRock Midcontinent Production LLC
Address 1: Oklahoma Tower
Address 2: 210 Park Ave, Ste 2750
City: OKLAHOMA CITY State: OK Zip: 73102 + _____
Contact Person: CLARK EDWARDS
Phone: (620) 432-4200

API No. 15 - 15-133-26920-00-00
Spot Description: _____
NW SE NE NE Sec. 13 Twp. 27 S. R. 19 East West
718 Feet from North / South Line of Section
649 Feet from East / West Line of Section
County: Neosho
Lease Name: CARSON, CLEO M. Well #: 13-1

1. Name and upper and lower limit of each production interval to be commingled:
- | | |
|-----------------------------|-------------------------|
| Formation: <u>SUMMIT</u> | (Perfs): <u>508-512</u> |
| Formation: <u>MULKY</u> | (Perfs): <u>519-523</u> |
| Formation: <u>BEVIER</u> | (Perfs): <u>597-599</u> |
| Formation: <u>CROWEBURG</u> | (Perfs): <u>620-623</u> |
| Formation: <u>FLEMING</u> | (Perfs): <u>654-656</u> |

2. Estimated amount of fluid production to be commingled from each interval:
- | | | | |
|-----------------------------|----------------|-----------------|----------------|
| Formation: <u>SUMMIT</u> | BOPD: <u>0</u> | MCFPD: <u>0</u> | BWPD: <u>0</u> |
| Formation: <u>MULKY</u> | BOPD: <u>0</u> | MCFPD: <u>0</u> | BWPD: <u>0</u> |
| Formation: <u>BEVIER</u> | BOPD: <u>0</u> | MCFPD: <u>0</u> | BWPD: <u>0</u> |
| Formation: <u>CROWEBURG</u> | BOPD: <u>0</u> | MCFPD: <u>0</u> | BWPD: <u>0</u> |
| Formation: <u>FLEMING</u> | BOPD: <u>0</u> | MCFPD: <u>0</u> | BWPD: <u>0</u> |

3. Plat map showing the location of the subject well, all other wells on the subject lease, and all wells on offsetting leases within a 1/2 mile radius of the subject well, and for each well the names and addresses of the lessee of record or operator.
4. Signed certificate showing service of the application and affidavit of publication as required in K.A.R. 82-3-135a.

For Commingling of PRODUCTION ONLY, include the following:

5. Wireline log of subject well. Previously Filed with ACO-1: Yes No
6. Complete Form ACO-1 (*Well Completion form*) for the subject well.

For Commingling of FLUIDS ONLY, include the following:

7. Well construction diagram of subject well.
8. Any available water chemistry data demonstrating the compatibility of the fluids to be commingled.

AFFIDAVIT: I am the affiant and hereby certify that to the best of my current information, knowledge and personal belief, this request for commingling is true and proper and I have no information or knowledge, which is inconsistent with the information supplied in this application.

Submitted Electronically

KCC Office Use Only	
<input type="checkbox"/> Denied	<input checked="" type="checkbox"/> Approved
15-Day Periods Ends: <u>9/8/2012</u>	
Approved By: <u>Rick Hestermann</u>	Date: <u>09/11/2012</u>

Protests may be filed by any party having a valid interest in the application. Protests must be in writing and comply with K.A.R. 82-3-135b and must be filed within 15 days of publication of the notice of application.

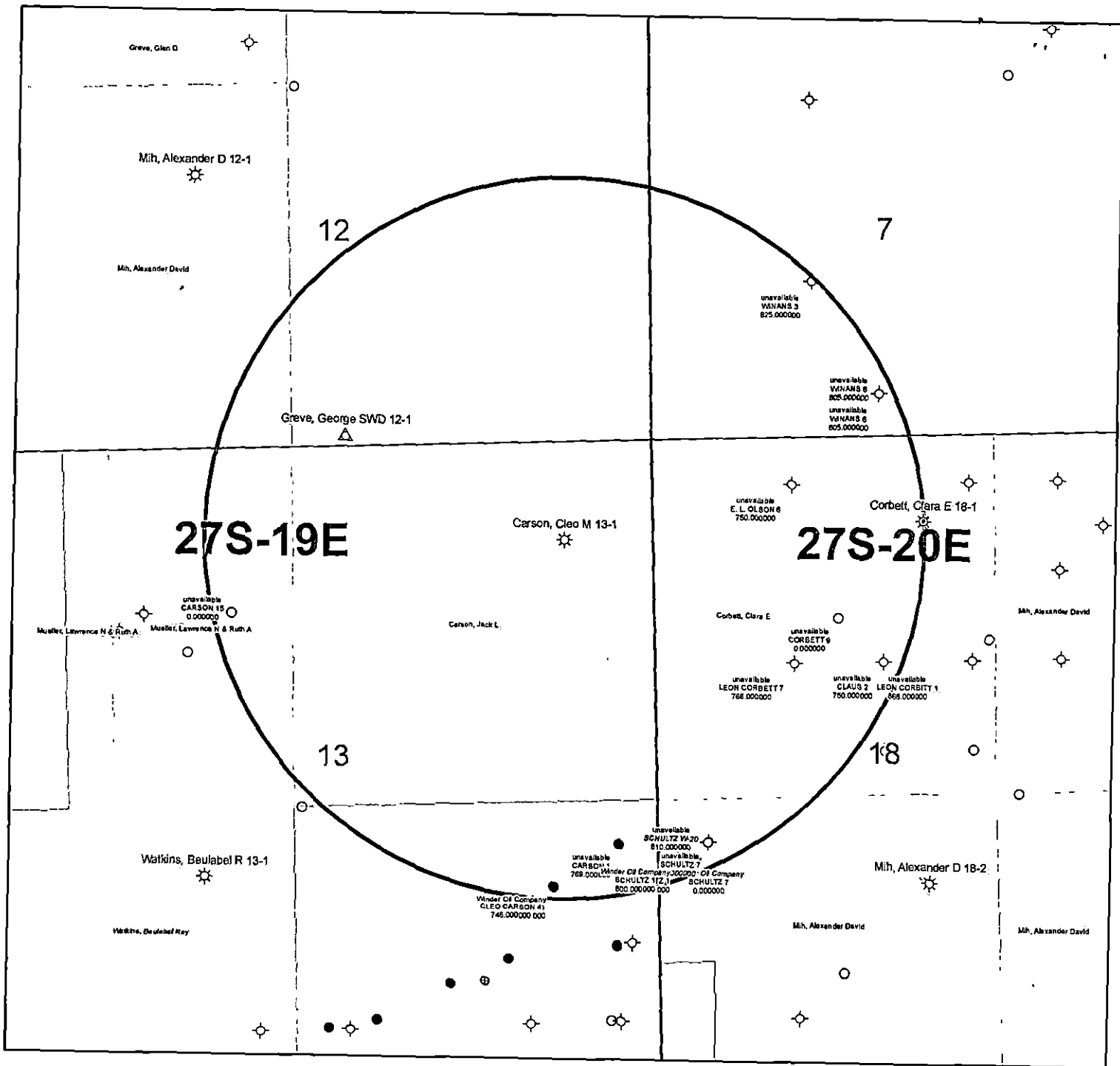

KGS STATUS

- ◇ DA/PA
- ⊕ EOR
- ☆ GAS
- △ INJ/SWD
- OIL
- ✱ OIL/GAS
- OTHER

Carson, Cleo M 13-1
 13-27S-19E
 1" = 1,000'

**KANSAS CORPORATION COMMISSION
OIL & GAS CONSERVATION DIVISION
WELL COMPLETION FORM
WELL HISTORY - DESCRIPTION OF WELL & LEASE**

ORIGINAL

Form ACC-1
September 1999
Form Must Be Typed

Operator: License # 33344
Name: Quest Cherokee, LLC
Address: 211 W. 14th Street
City/State/Zip: Chanute, KS 66720
Purchaser: Bluestem Pipeline, LLC
Operator Contact Person: Jennifer R. Ammann
Phone: (620) 431-9500
Contractor: Name: Michael Drilling
License: 33783
Wellsite Geologist: Ken Recoy

Designate Type of Completion:

New Well Re-Entry Workover
 Oil SWD SLOW Temp. Abd.
 Gas ENHR SIGW
 Dry Other (Core, WSW, Expl., Cathodic, etc)

If Workover/Re-entry: Old Well Info as follows:

Operator: _____
Well Name: _____
Original Comp. Date: _____ Original Total Depth: _____
 Deepening Re-perf. Conv. to Enhr./SWD
 Plug Back _____ Plug Back Total Depth
 Commingled Docket No. _____
 Dual Completion Docket No. _____
 Other (SWD or Enhr.?) Docket No. _____

<u>6/28/07</u>	<u>7/5/07</u>	<u>7/27/07</u>
Spud Date or Recompletion Date	Date Reached TD	Completion Date or Recompletion Date

API No. 15 - 133-26920-0000
County: Neosho
_____ ne _____ ne Sec. 13 Twp. 27 S. R. 19 East West
810 feet from S / (circle one) Line of Section
660 feet from (circle one) E / W (circle one) Line of Section

Footages Calculated from Nearest Outside Section Corner:

(circle one) NE SE NW SW
Lease Name: Carson, Cleo M. Well #: 13-1
Field Name: Cherokee Basin CBM

Producing Formation: Multiple
Elevation: Ground: 1001 Kelly Bushing: n/a
Total Depth: 1034 Plug Back Total Depth: 1024.23
Amount of Surface Pipe Set and Cemented at 23 Feet
Multiple Stage Cementing Collar Used? Yes No
If yes, show depth set _____ Feet
If Alternate II completion, cement circulated from 1024.23
feet depth to surface w/ 154 sx cmt.

Drilling Fluid Management Plan Att. II SB
(Data must be collected from the Reserve Pit) 3-21-08
Chloride content _____ ppm Fluid volume _____ bbls
Dewatering method used _____
Location of fluid disposal if hauled offsite: _____
Operator Name: _____
Lease Name: _____ License No.: _____
Quarter _____ Sec. _____ Twp. _____ S. R. _____ East West
County: _____ Docket No.: _____

INSTRUCTIONS: An original and two copies of this form shall be filed with the Kansas Corporation Commission, 130 S. Market - Room 2078, Wichita, Kansas 67202, within 120 days of the spud date, recompletion, workover or conversion of a well. Rule 82-3-130, 82-3-106 and 82-3-107 apply. Information of side two of this form will be held confidential for a period of 12 months if requested in writing and submitted with the form (see rule 82-3-107 for confidentiality in excess of 12 months). One copy of all wireline logs and geologist well report shall be attached with this form. ALL CEMENTING TICKETS MUST BE ATTACHED. Submit CP-4 form with all plugged wells. Submit CP-111 form with all temporarily abandoned wells.

All requirements of the statutes, rules and regulations promulgated to regulate the oil and gas industry have been fully complied with and the statements herein are complete and correct to the best of my knowledge.

Signature: Jennifer R. Ammann
Title: New Well Development Coordinator Date: 10/26/07
Subscribed and sworn to before me this 26th day of October
20 07
Notary Public: Sorra Klauman
Date Commission Expires: 8-4-2010

TERRA KLAUMAN
Notary Public - State of Kansas
My Appt. Expires 8-4-2010

KCC Office Use ONLY

Letter of Confidentiality Received
 If Denied, Yes Date: _____ **RECEIVED**
 Wireline Log Received **KANSAS CORPORATION COMMISSION**
 Geologist Report Received
 UIC Distribution

OCT 29 2007
CONSERVATION DIVISION
WICHITA, KS

ORIGINAL

Side Two

Operator Name: Quest Cherokee, LLC Lease Name: Carson, Cleo M. Well #: 13-1
Sec. 13 Twp. 27 S. R. 19 [X] East [] West County: Neosho

INSTRUCTIONS: Show important tops and base of formations penetrated. Detail all cores. Report all final copies of drill stems tests giving interval tested, time tool open and closed, flowing and shut-in pressures, whether shut-in pressure reached static level, hydrostatic pressures, bottom hole temperature, fluid recovery, and flow rates if gas to surface test, along with final chart(s). Attach extra sheet if more space is needed. Attach copy of all Electric Wireline Logs surveyed. Attach final geological well site report.

Drill Stem Tests Taken [] Yes [X] No (Attach Additional Sheets)
Samples Sent to Geological Survey [] Yes [X] No
Cores Taken [] Yes [X] No
Electric Log Run [] Yes [] No (Submit Copy)

[X] Log Formation (Top), Depth and Datum [] Sample
Name Top Datum
See attached

List All E. Logs Run:

Compensated Density Neutron Log
Dual Induction Log
Gamma Ray Neutron Log

CASING RECORD table with columns: Purpose of String, Size Hole Drilled, Size Casing Set (In O.D.), Weight Lbs. / Ft., Setting Depth, Type of Cement, # Sacks Used, Type and Percent Additives. Includes rows for Surface and Production.

ADDITIONAL CEMENTING / SQUEEZE RECORD table with columns: Purpose, Depth Top Bottom, Type of Cement, #Sacks Used, Type and Percent Additives.

PERFORATION RECORD - Bridge Plugs Set/Type table with columns: Shots Per Foot, Specify Footage of Each Interval Perforated, Acid, Fracture, Shot, Cement Squeeze Record (Amount and Kind of Material Used), Depth.

TUBING RECORD table with columns: Size, Set At, Packer At, Liner Run, Date of First, Resumerd Production, SWD or Enhr., Producing Method, Estimated Production Per 24 Hours, Oil Bbls., Gas Mcf, Water Bbls., Gas-Oil Ratio, Gravity.

Disposition of Gas . METHOD OF COMPLETION . Production Interval
[] Vented [X] Sold [] Used on Lease (If vented, Submit ACO-18.)
[] Open Hole [X] Perf. [] Dually Comp. [] Commingled
[] Other (Specify)

	A	B	C	D	E	F	G	H	I	J	K
1	Produced Fluids #		1	2	3	4	5		Click here to run SSP Goal Seek SSP Click Click Click Click		
2	Parameters	Units	Input	Input	Input	Input	Input				
3	Select the brines	Select fluid by checking	<input type="checkbox"/>	<input type="checkbox"/>	<input type="checkbox"/>	<input type="checkbox"/>	<input type="checkbox"/>	Mixed brine:			
4	Sample ID	the box(es),						Cell H28 is			
5	Date	Row 3	3/19/2012	3/4/2012	3/14/2012	1/20/2012	1/20/2012	STP calc. pH.			
6	Operator		PostRock	PostRock	PostRock	PostRock	PostRock	Cells H35-38			
7	Well Name		Ward Feed	Ward Feed	Clinesmith	Clinesmith	Clinesmith	are used in			
8	Location		#34-1	#4-1	#5-4	#1	#2	mixed brines			
9	Field		CBM	CBM	Bartles	Bartles	Bartles	calculations.			
10	Na ⁺	(mg/l)*	19,433.00	27,381.00	26,534.00	25689.00	24220.00	24654.20	Initial(BH)	Final(WH)	SISR (Final-Initial)
11	K ⁺ (if not known =0)	(mg/l)						0.00	Saturation Index values		
12	Mg ²⁺	(mg/l)	1,096.00	872.00	1,200.00	953.00	858.00	995.91	Calcite		
13	Ca ²⁺	(mg/l)	1,836.00	2,452.00	2,044.00	1920.00	1948.00	2040.23	-0.73	-0.60	0.13
14	Sr ²⁺	(mg/l)						0.00	Barite		
15	Ba ²⁺	(mg/l)						0.00			
16	Fe ²⁺	(mg/l)	40.00	21.00	18.00	82.00	90.00	50.21	Halite		
17	Zn ²⁺	(mg/l)						0.00	-1.77	-1.80	-0.03
18	Pb ²⁺	(mg/l)						0.00	Gypsum		
19	Cl ⁻	(mg/l)	36,299.00	48,965.00	47,874.00	45632.00	43147.00	44388.44	-3.19	-3.18	0.00
20	SO ₄ ²⁻	(mg/l)	1.00	1.00	8.00	1.00	1.00	2.40	Hemihydrate		
21	F ⁻	(mg/l)						0.00	-3.96	-3.90	0.06
22	Br ⁻	(mg/l)						0.00	Anhydrite		
23	SiO ₂	(mg/l) SiO ₂						0.00	-3.47	-3.36	0.12
24	HCO ₃ Alkalinity**	(mg/l as HCO ₃)	190.00	234.00	259.00	268.00	254.00	241.03	Celestite		
25	CO ₃ Alkalinity	(mg/l as CO ₃)									
26	Carboxylic acids**	(mg/l)						0.00	Iron Sulfide		
27	Ammonia	(mg/L) NH ₃						0.00	-0.16	-0.22	-0.06
28	Borate	(mg/L) H ₃ BO ₃						0.00	Zinc Sulfide		
29	TDS (Measured)	(mg/l)						72781			
30	Calc. Density (STP)	(g/ml)	1.038	1.051	1.050	1.048	1.045	1.047	Calcium fluoride		
31	CO ₂ Gas Analysis	(%)	19.97	18.76	22.41	35.53	33.79	26.16			
32	H ₂ S Gas Analysis***	(%)	0.0289	0.0292	0.0296	0.0306	0.0151	0.0269	Iron Carbonate		
33	Total H ₂ Saq	(mgH ₂ S/l)	1.00	1.00	1.00	1.00	0.50	0.90	-0.74	-0.51	0.23
34	pH, measured (STP)	pH	5.67	5.76	5.72	5.54	5.55	5.63	Inhibitor needed (mg/L)		
35	Choose one option to calculate SI?	0-CO ₂ +Alk, 1-pH+Alk, 2-CO ₂ +pH	0	0	0	0	0		Calcite	NTMP	
36	Gas/day(thousand cf/day)	(Mcf/D)						0	0.00	0.00	
37	Oil/Day	(B/D)	0	0	1	1	1	4	Barite	BHPMP	
38	Water/Day	(B/D)	100	100	100	100	100	500	0.00	0.00	
39	For mixed brines, enter values for temperatures and pressures in Cells (H40-H43)								(Enter H40-H43) pH		
40	Initial T	(F)	66.0	71.0	70.0	41.0	49.0	60.0	5.69	5.60	
41	Final T	(F)	66.0	71.0	70.0	41.0	49.0	89.0	Viscosity (CentiPoise)		
42	Initial P	(psia)	25.0	25.0	25.0	25.0	25.0	25.0	1.196	0.826	
43	Final P	(psia)	25.0	25.0	25.0	25.0	25.0	120.0	Heat Capacity (cal/ml ^o C)		
44	Use TP on Calcite sheet?	1-Yes;0-No							0.955	0.959	
45	API Oil Grav.	API grav.						30.00	Inhibitor needed (mg/L)		
46	Gas Sp.Grav.	Sp.Grav.						0.60	Gypsum	HDTMP	
47	MeOH/Day	(B/D)	0					0	0.00	0.00	
48	MEG/Day	(B/D)	0					0	Anhydrite	HDTMP	
49	Conc. Multiplier								0.00	0.00	
50	H ⁺ (Strong acid) †	(N)									
51	OH ⁻ (Strong base) †	(N)									
52	Quality Control Checks at STP:										
53	H ₂ S Gas	(%)									
54	Total H ₂ Saq (STP)	(mgH ₂ S/l)									
55	pH Calculated	(pH)									
56	PCO ₂ Calculated	(%)									
57	Alkalinity Calculated	(mg/l) as HCO ₃									
58	ΣCations=	(equiv./l)									
59	ΣAnions=	(equiv./l)									
60	Calc TDS=	(mg/l)									
61	Inhibitor Selection	Input	Unit	#	Inhibitor	Unit Converter (From metric to English)					
62	Protection Time	120	min	1	NTMP	From Unit	Value	To Unit	Value		
63	Have ScaleSoft/Pitzer			2	BHPMP	°C	80	°F	176		
64	pick inhibitor for you?	1	1-Yes;0-No	3	PAA	m ³	100	ft ³	3,531		
65	If No, inhibitor # is:	4	#	4	DTPMP	m ³	100	bbl(42 US gal)	629		
66	If you select Mixed,			5	PPCA	MPa	1,000	psia	145,074		
67	1 st inhibitor # is:	1	#	6	SPA	Bar	496	psia	7,194		
68	% of 1 st inhibitor is:	50	%	7	HEDP	Torr	10,000	psia	193		
69	2 nd inhibitor # is:	2	#	8	HDTMP	Gal	10,000	bbl(42 US gal)	238		
70	Display act. coeffs?	0	1-Yes;0-No	9	Average	Liters	10,000	bbl(42 US gal)	63		
71				10	Mixed						

Saturation Index Calculations

Champion Technologies, Inc.

(Based on the Tomson-Oddo Model)

Brine 1: Ward Feed Yard 34-1

Brine 2: Ward Feed Yard 4-1

Brine 3: Clinesmith 5-4

Brine 4: Clinesmith 1

Brine 5: Clinesmith 2

Component (mg/L)	Ratio					Mixed Brine
	20% Brine 1	20% Brine 2	20% Brine 3	20% Brine 4	20 Brine 5	
Calcium	1836	2452	2044	1920	1948	1952
Magnesium	1096	872	1200	953	858	865
Barium	0	0	0	0	0	0
Strontium	0	0	0	0	0	0
Bicarbonate	190	234	259	268	254	253
Sulfate	1	1	8	1	1	1
Chloride	36299	48965	47874	45632	43147	43206
CO ₂ in Brine	246	220	264	422	405	401
Ionic Strength	1.12	1.48	1.46	1.38	1.31	1.31
Temperature (°F)	89	89	89	89	89	89
Pressure (psia)	50	50	120	120	120	119

Saturation Index

Calcite	-1.71	-1.41	-1.48	-1.68	-1.69	-1.69
Gypsum	-3.71	-3.64	-2.82	-3.73	-3.72	-3.69
Hemihydrate	-3.70	-3.65	-2.83	-3.74	-3.71	-3.69
Anhydrite	-3.89	-3.79	-2.97	-3.89	-3.88	-3.85
Barite	N/A	N/A	N/A	N/A	N/A	N/A
Celestite	N/A	N/A	N/A	N/A	N/A	N/A

PTB

Calcite	N/A	N/A	N/A	N/A	N/A	N/A
Gypsum	N/A	N/A	N/A	N/A	N/A	N/A
Hemihydrate	N/A	N/A	N/A	N/A	N/A	N/A
Anhydrite	N/A	N/A	N/A	N/A	N/A	N/A
Barite	N/A	N/A	N/A	N/A	N/A	N/A
Celestite	N/A	N/A	N/A	N/A	N/A	N/A

POSTROCK



Current Completion

WELL : Carson, Cleo M 13-1
 FIELD : Cherokee Basin
 STATE : Kansas
 COUNTY : Neosho

SPUD DATE : 6/28/2007
 COMP. Date : 7/27/2007
 API: 15-133-26920-00-00

LOCATION: 13-27S-19E (NE, NE)
 ELEVATION: GL - 1001'

8 5/8" 22 lb @ 22' Cement w/5 sks

2 3/8" tubing @ 791'

4.5" 10.5 lb @ 1024' Cement w/154 sks

PBTD @ 1024'

Drilled Depth @ 1034'

Wellhead/Surface Equipment

Tree Connection	
Tree	
Tubing Head	
Bradenhead	
Pumping Unit	
Compressor	

Tubular Detail

Size	Weight	Grade	Cap(bbl/ft)	Date	Depth
8 5/8"	22 lb			2007	22'
4 1/2"	10.5 lb		.0159	2007	1061'
2 3/8"				2007	791'

Downhole Equipment Detail

Completion Data

Original as GAS Well per ACO-1
700 gals 15% HCL
1,282 bbis total fluid
8,100 lbs 20/40 sand

Perforations

Original Completion: 4 spf
508-512 (Summit) (17)
519-523 (Mulky) (17)
597-599 (Bevier) (9)
620-623 (Croweburg) (13)
654-656 (Fleming) (9)
707-709 (Tebo) (9)
762-764 (Weir) (9)

PREPARED BY: POSTROCK _____
 APPROVED BY: _____

DATE: July, 2012 _____
 DATE: _____

POSTROCK



LEGEND

PostRock™

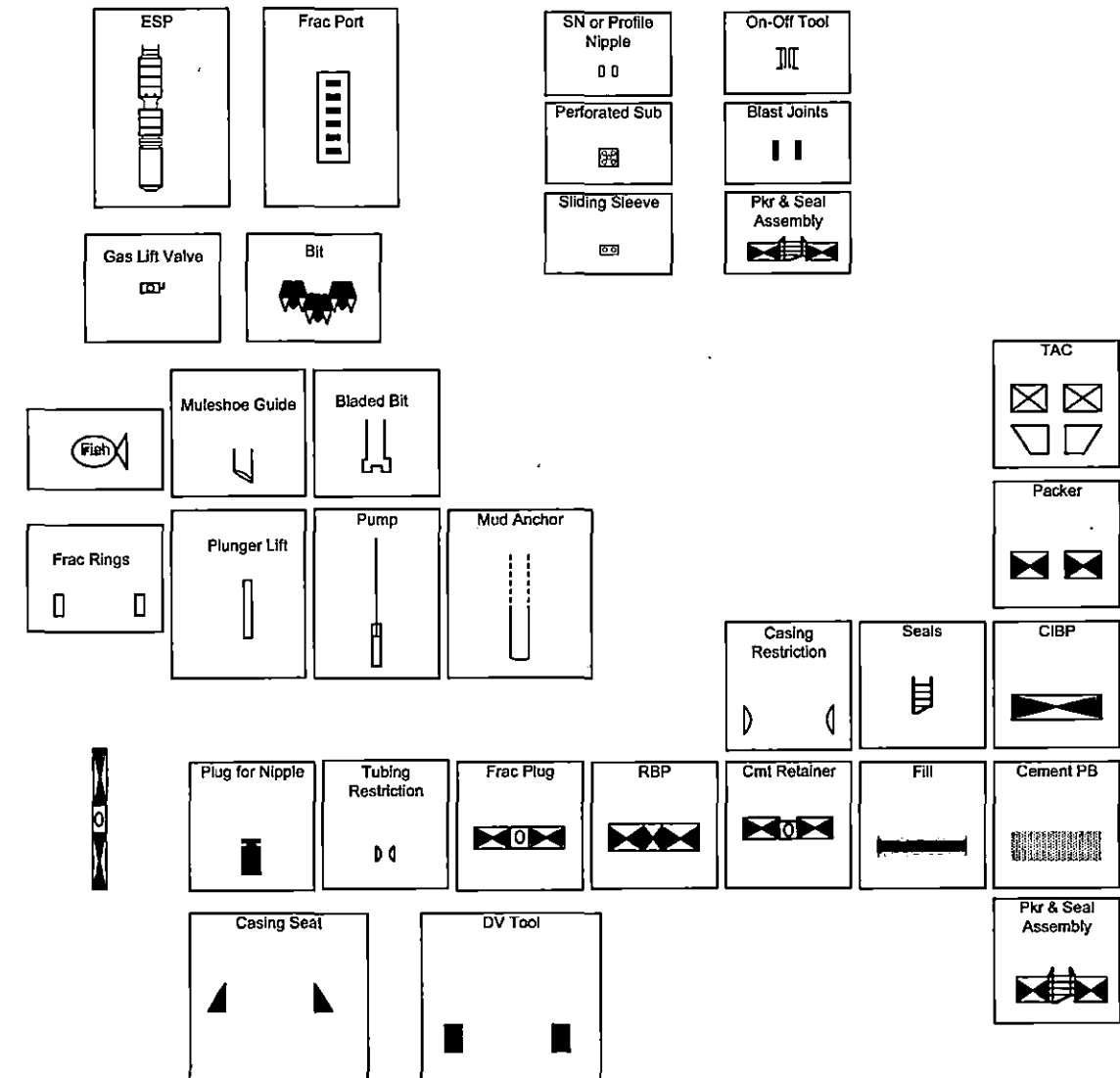

BEFORE THE STATE CORPORATION COMMISSION OF THE STATE OF KANSAS
NOTICE OF FILING APPLICATION

RE: In the Matter of **Postrock Midcontinent Production, LLC Application for Commingling of Production in the Carson, Cleo M 13-1** located in Neosho County, Kansas.

TO: All Oil & Gas Producers, Unleased Mineral Interest Owners, Landowners, and all persons whomsoever concerned.

You, and each of you, are hereby notified that **Postrock Midcontinent Production, LLC** has filed an application to commingle the **Weir, Tebo, Fleming, Crowe-burg, Bevier, Mulky, Summit and Stray Sand** producing formations at the **Carson, Cleo M 13-1**, located in the **NW SE NE NE, S13-T27S-R19E, Approximately 718 FNL & 649 FEL**, Neosho County, Kansas.

Any persons who object to or protest this application shall be required to file their objections or protest with the Conservation Division of the State Corporation Commission of the State of Kansas within fifteen (15) days from the date of this publication. These protests shall be filed pursuant to Commission regulations and must state specific reasons why granting the application may cause waste, violate correlative rights or pollute the natural resources of the State of Kansas.

All persons interested or concerned shall take notice of the foregoing and shall govern themselves accordingly. All person and/or companies wishing to protest this application are required to file a written protest with the Conservation Division of the Kansas Oil and Gas Commission.

Upon the receipt of any protest, the Commission will convene a hearing and protestants will be expected to enter an appearance either through proper legal counsel or as individuals, appearing on their own behalf.

Postrock Midcontinent Production, LLC
210 Park Avenue, Suite 2750
Oklahoma City, Oklahoma 73102
(405) 660-7704

A COPY OF THE AFFIDAVIT OF PUBLICATION MUST ACCOMPANY ALL APPLICATIONS

Affidavit of Publication

STATE OF KANSAS, NEOSHO COUNTY, ss:
Rhonda Howerter, being first duly sworn, deposes and says: That *she* is *Classified Manager of THE CHANUTE TRIBUNE*, a daily newspaper printed in the State of Kansas, and published in and of general circulation in Neosho County, Kansas, with a general paid circulation on a daily basis in Neosho County, Kansas, and that said newspaper is not a trade, religious or fraternal publication.

Said newspaper is a daily published at least weekly 50 times a year: has been so published continuously and uninterruptedly in said county and state for a period of more than five years prior to the first publication of said notice; and has been admitted at the post office of Chanute, in said county as second class matter.

That the attached notice is a true copy thereof and was published in the regular and entire issue of said newspaper for 1 ~~consecutive~~ time, the first publication thereof being made as aforesaid on the 24 day of July 2012, with subsequent publications being made on the following dates:

_____, 2012 _____, 2012
_____, 2012 _____, 2012

Rhonda Howerter

Subscribed and sworn to and before me this 24 day of July, 2012

[Signature]

Notary Public

My commission expires: January 9, 2015
Printer's Fee \$ 70.14
Affidavit, Notary's Fee \$ 3.00
Additional Copies \$ _____
Total Publication Fees \$ 73.14

SHANNA L. GUIOT
Notary Public - State of Kansas
My Appl. Expires 1-9-15

AFFIDAVIT

STATE OF KANSAS \
- SS.
County of Sedgwick /

Mark Fletchall, of lawful age, being first duly sworn, deposeth and saith: That he is Record Clerk of The Wichita Eagle, a daily newspaper published in the City of Wichita, County of Sedgwick, State of Kansas, and having a general paid circulation on a daily basis in said County, which said newspaper has been continuously and uninterruptedly published in said County for more than one year prior to the first publication of the notice hereinafter mentioned, and which said newspaper has been entered as second class mail matter at the United States Post Office in Wichita, Kansas, and which said newspaper is not a trade, religious or fraternal publication and that a notice of a true copy is hereto attached was published in the regular and entire Morning issue of said The Wichita Eagle for 1 issues, that the first publication of said notice was

made as aforesaid on the 25th of

July A.D. 2012, with

subsequent publications being made on the following dates:

And affiant further says that he has personal knowledge of the statements above set forth and that they are true.

Mark Fletchall

Subscribed and sworn to before me this

25th day of July, 2012

Deborah C. Sanders
Notary Public Sedgwick County, Kansas

Printer's Fee : \$139.60

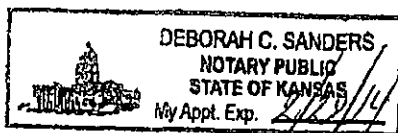

LEGAL PUBLICATION
PUBLISHED IN THE WICHITA EAGLE
JULY 25, 2012 (3197992)
BEFORE THE STATE CORPORATION COMMISSION
OF THE STATE OF KANSAS
NOTICE OF FILING APPLICATION
RE: In the Matter of: Pastrock Midcontinent
Production, LLC Application for
Commencing of Production in the Carson,
Cleo M. 13-1 located in Neosho County,
Kansas.
TO: All Oil & Gas Producers; Unleased Mineral
Interest Owners; Landowners; and all
persons whomsoever concerned.
You, and each of you, are hereby notified
that Pastrock Midcontinent Production, LLC
has filed an application to commence the Wolf,
Tobo, Fleming, Croweburg, Dewler, Mulky,
Summit and Stray Sand producing formations
at the Carson, Cleo M. 13-1 located in the NW
SE NE NE; S13; T23; R19E, Approximately
719 FNL & 649 FEL, Neosho County, Kansas.
Any persons who object to or protest
this application shall be required to file their
objections or protest with the Conservation
Division of the State Corporation Commission
of the State of Kansas within fifteen (15)
days from the date of this publication. These
protests shall be filed pursuant to Commission
regulations and must state specific reasons
why granting the application may cause waste,
violate correlative rights or pollute the natural
resources of the State of Kansas.
All persons interested or concerned shall
take notice of the foregoing and shall govern
themselves accordingly. All person and/or
companies wishing to protest this application
are required to file a written protest with the
Conservation Division of the Kansas Oil and
Gas Commission.
Upon the receipt of any protest, the
Commission will convene a hearing and
protestants will be expected to enter an
appearance, either through probat legal
counsel or as individuals, appearing in their
own behalf.
Pastrock Midcontinent Production, LLC
210 Park Avenue, Suite 2750
Oklahoma City, Oklahoma 73102
(405) 660-7700
A COPY OF THE AFFIDAVIT OF PUBLICATION
MUST ACCOMPANY ALL APPLICATIONS

Affidavit of Notice Served

Re: Application for: APPLICATION FOR COMMINGLING OF PRODUCTION OR FLUIDS ACO-4

Well Name: CARSON, CLEO M 13-1 Legal Location: NWSENE S13-T27S-R19E

The undersigned hereby certifies that he / she is a duly authorized agent for the applicant, and that on the day 24th of AUGUST, 2012, a true and correct copy of the application referenced above was delivered or mailed to the following parties:

Note: A copy of this affidavit must be served as a part of the application.

Name	Address (Attach additional sheets if necessary)
WINDER OIL COMPANY	21955 OTTAWA RD, ERIE, KS 66733
RICHARD L WINDER	21955 OTTAWA RD, ERIE, KS 66733
GEORGE & BETTY GREVE	13010 230TH RD, ERIE, KS 66733
PATRICK CARSON	14800 220TH RD, ERIE, KS 66733
ODENSE BAPTIST CEMETERY	ODENSE BAPTIST CHURCH, ERIE, KS 66733

I further attest that notice of the filing of this application was published in the THE CHANUTE TRIBUNE, the official county publication of NEOSHO county. A copy of the affidavit of this publication is attached.

Signed this 24th day of AUGUST, 2012

[Signature]
Applicant or Duly Authorized Agent

Subscribed and sworn to before me this 24th day of AUGUST, 2012



[Signature]
Notary Public
My Commission Expires: July 20, 2014

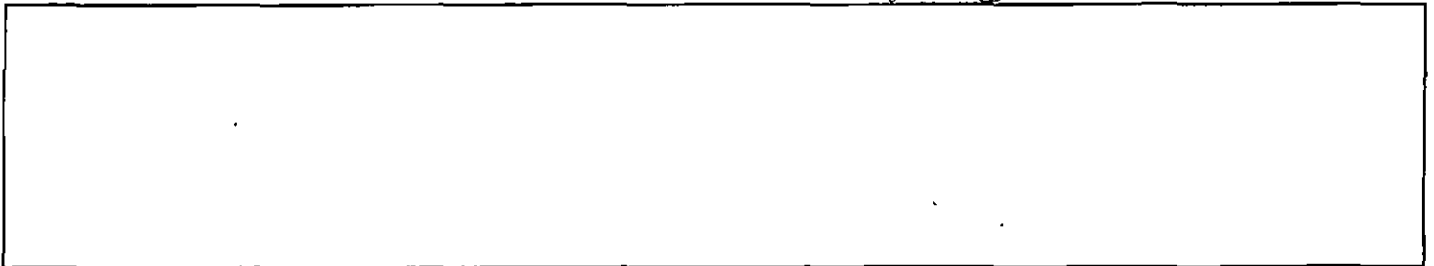

CARSON, CLEO M 13-1

LEGAL LOCATION	SPOT	CURR_OPERA
S13-T27S-R19E	NW NE SE	Winder Oil Company
S18-T27S-R20E	SW	Winder Oil Company
S18-T27S-R20E	NW NW SW	Winder Oil Company

CARSON, CLEO M 13-1

12-27S-19E

SE4 RICHARD L WINDER
21955 OTTAWA RD ERIE, KS 66733

GREVE GEORGE & BETTY V
13010 230TH RD ERIE, KS 66733

13-27S-19E

SE4 Patrick Carson
14800 220TH RD ERIE, KS 66733

7-27S-20E

tract in SW4 ODNSE BAPTIST CEMETERY
ODENSE BAPTIST CHURCH
ERIE, KS 66733

SW4 less trct RICHARD L WINDER
21955 OTTAWA RD ERIE, KS 66733

Conservation Division
Finney State Office Building
130 S. Market, Rm. 2078
Wichita, KS 67202-3802



Phone: 316-337-6200
Fax: 316-337-6211
<http://kcc.ks.gov/>

Mark Sievers, Chairman
Thomas E. Wright, Commissioner

Sam Brownback, Governor

September 11, 2012

Clark Edwards
PostRock Midcontinent Production LLC
Oklahoma Tower
210 Park Ave, Ste 2750
Oklahoma City, OK 73102

RE: Approved Commingling CO081230
Carson, Cleo M. 13-1, Sec. 13-T27S-R19E, Neosho County
API No. 15-133-26920-00-00

Dear Mr. Edwards:

Your Application for Commingling (ACO-4) for the above described well, received by the KCC on August 27, 2012, has been reviewed and approved by the Kansas Corporation Commission (KCC) per K.A.R. 82-3-123. Notice was examined and found to be proper per K.A.R. 82-3-135a. No protest had been filed within the 15-day protest period.

Based upon the depth of the Weir formation perforations, total oil production shall not exceed 100 BOPD and total gas production shall not exceed 50% of the absolute open flow (AOF).

File form ACO-1 upon re-completion of the well to commingle.

Commingling ID number CO081230 has been assigned to this approved application. Use this number for well completion reports (ACO-1) and other correspondence that may concern this approved commingling.

Sincerely,

Rick Hestermann
Production Department