



KANSAS CORPORATION COMMISSION 1089872
OIL & GAS CONSERVATION DIVISION

Form ACO-4
Form must be typed
March 2009

APPLICATION FOR COMMINGLING OF *Commingling ID #* **CO081232**
PRODUCTION (K.A.R. 82-3-123) OR FLUIDS (K.A.R. 82-3-123a)

OPERATOR: License # 33343
Name: PostRock Midcontinent Production LLC
Address 1: Oklahoma Tower
Address 2: 210 Park Ave, Ste 2750
City: OKLAHOMA CITY State: OK Zip: 73102 +
Contact Person: CLARK EDWARDS
Phone: (620) 432-4200

API No. 15 - 15-205-26580-00-00
Spot Description: _____
NW SE SE SW Sec. 20 Twp. 28 S. R. 17 East West
507 Feet from North / South Line of Section
2042 Feet from East / West Line of Section
County: Wilson
Lease Name: CARTER GALE D Well #: 20-1

- 1. Name and upper and lower limit of each production interval to be commingled:

Formation: <u>SUMMIT</u>	(Perfs): <u>632-636</u>
Formation: <u>MULKY</u>	(Perfs): <u>644-648</u>
Formation: <u>BEVIER</u>	(Perfs): <u>714-716</u>
Formation: <u>CROWEBURG</u>	(Perfs): <u>733-736</u>
Formation: <u>FLEMING</u>	(Perfs): <u>772-774</u>

- 2. Estimated amount of fluid production to be commingled from each interval:

Formation: <u>SUMMIT</u>	BOPD: <u>0</u>	MCFPD: <u>1.62</u>	BWPD: <u>2.5</u>
Formation: <u>MULKY</u>	BOPD: <u>0</u>	MCFPD: <u>1.62</u>	BWPD: <u>2.5</u>
Formation: <u>BEVIER</u>	BOPD: <u>0</u>	MCFPD: <u>1.62</u>	BWPD: <u>2.5</u>
Formation: <u>CROWEBURG</u>	BOPD: <u>0</u>	MCFPD: <u>1.62</u>	BWPD: <u>2.5</u>
Formation: <u>FLEMING</u>	BOPD: <u>0</u>	MCFPD: <u>1.62</u>	BWPD: <u>2.5</u>

- 3. Plat map showing the location of the subject well, all other wells on the subject lease, and all wells on offsetting leases within a 1/2 mile radius of the subject well, and for each well the names and addresses of the lessee of record or operator.
- 4. Signed certificate showing service of the application and affidavit of publication as required in K.A.R. 82-3-135a.

For Commingling of PRODUCTION ONLY, include the following:

- 5. Wireline log of subject well. Previously Filed with ACO-1: Yes No
- 6. Complete Form ACO-1 (*Well Completion form*) for the subject well.

For Commingling of FLUIDS ONLY, include the following:

- 7. Well construction diagram of subject well.
- 8. Any available water chemistry data demonstrating the compatibility of the fluids to be commingled.

AFFIDAVIT: I am the affiant and hereby certify that to the best of my current information, knowledge and personal belief, this request for commingling is true and proper and I have no information or knowledge, which is inconsistent with the information supplied in this application.

Submitted Electronically

KCC Office Use Only	
<input type="checkbox"/> Denied	<input checked="" type="checkbox"/> Approved
15-Day Periods Ends: <u>9/8/2012</u>	
Approved By: <u>Rick Hestermann</u>	Date: <u>09/11/2012</u>

Protests may be filed by any party having a valid interest in the application. Protests must be in writing and comply with K.A.R. 82-3-135b and must be filed within 15 days of publication of the notice of application.

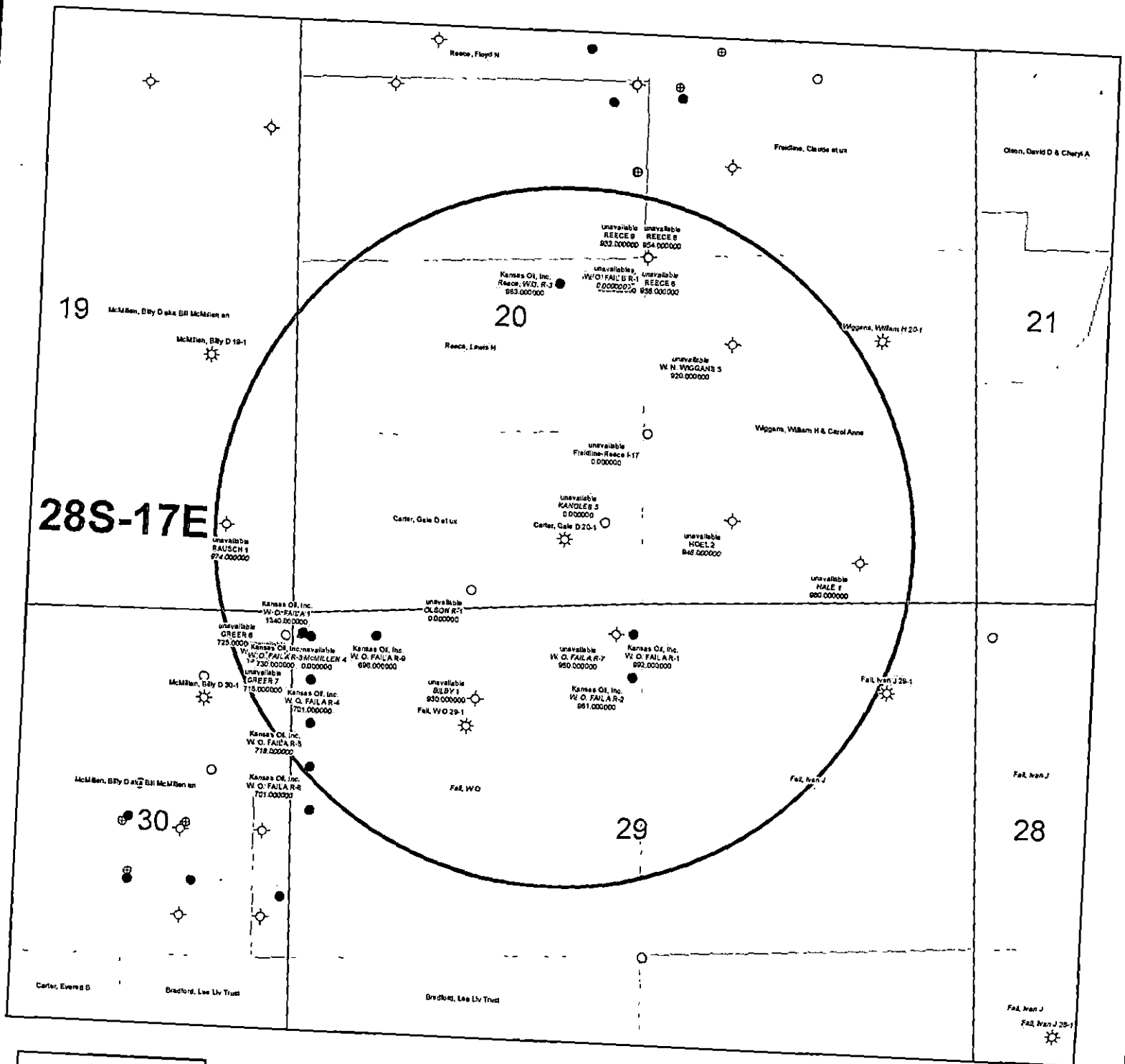

KGS STATUS

- ◇ DA/PA
- ⊕ EOR
- ☼ GAS
- △ INJ/SWD
- OIL
- ✱ OIL/GAS
- OTHER

Carter, Gale D 20-1
 20-28S-17E
 1" = 1,000'

	A	B	C	D	E	F	G	H	I	J	K			
1	Produced Fluids #		1	2	3	4	5		Click here to run SSP Click Click Click Click Goal Seek SSP Click					
2	Parameters	Units	Input	Input	Input	Input	Input							
3	Select the brines	Select fluid by checking	<input type="checkbox"/>	<input type="checkbox"/>	<input type="checkbox"/>	<input type="checkbox"/>	<input type="checkbox"/>	Mixed brine:						
4	Sample ID	the box(es),	3/19/2012	3/4/2012	3/14/2012	1/20/2012	1/20/2012	Cell H28 is						
5	Date	PostRock	PostRock	PostRock	PostRock	PostRock	PostRock	STP calc, pH,						
6	Operator	Row 3	Ward Feed	Ward Feed	Clinesmith	Clinesmith	Clinesmith	Cells H35-38						
7	Well Name		#34-1	#4-1	#5-4	#1	#2	are used in						
8	Location		CBM	CBM	Bartles	Bartles	Bartles	mixed brines						
9	Field							calculations.						
10	Na ⁺	(mg/l)*	19,433.00	27,381.00	26,534.00	25689.00	24220.00	24654.20	Initial(BH)	Final(WH)	SI/SR (Final-Initial)			
11	K ⁺ (if not known =0)	(mg/l)						0.00	Saturation Index values					
12	Mg ²⁺	(mg/l)	1,096.00	872.00	1,200.00	953.00	858.00	995.91	Calcite					
13	Ca ²⁺	(mg/l)	1,836.00	2,452.00	2,044.00	1920.00	1948.00	2040.23	-0.73	-0.60	0.13			
14	Sr ²⁺	(mg/l)						0.00	Barite					
15	Ba ²⁺	(mg/l)						0.00						
16	Fe ²⁺	(mg/l)	40.00	21.00	18.00	82.00	90.00	50.21	Halite					
17	Zn ²⁺	(mg/l)						0.00	-1.77	-1.80	-0.03			
18	Pb ²⁺	(mg/l)						0.00	Gypsum					
19	Cl ⁻	(mg/l)	36,299.00	48,965.00	47,874.00	45632.00	43147.00	44388.44	-3.19	-3.18	0.00			
20	SO ₄ ²⁻	(mg/l)	1.00	1.00	8.00	1.00	1.00	2.40	Hemihydrate					
21	F ⁻	(mg/l)						0.00	-3.96	-3.90	0.06			
22	Br ⁻	(mg/l)						0.00	Anhydrite					
23	SiO ₂	(mg/l) SiO ₂						0.00	-3.47	-3.36	0.12			
24	HCO ₃ Alkalinity**	(mg/l as HCO ₃)	190.00	234.00	259.00	268.00	254.00	241.03	Celestite					
25	CO ₃ Alkalinity	(mg/l as CO ₃)												
26	Carboxylic acids**	(mg/l)						0.00	Iron Sulfide					
27	Ammonia	(mg/L) NH ₃						0.00	-0.16	-0.22	-0.06			
28	Borate	(mg/L) H ₃ BO ₃						0.00	Zinc Sulfide					
29	TDS (Measured)	(mg/l)						72781						
30	Calc. Density (STP)	(g/ml)	1.038	1.051	1.050	1.048	1.045	1.047	Calcium fluoride					
31	CO ₂ Gas Analysis	(%)	19.97	18.76	22.41	35.53	33.79	26.16						
32	H ₂ S Gas Analysis***	(%)	0.0289	0.0292	0.0296	0.0306	0.0151	0.0269	Iron Carbonate					
33	Total H ₂ Saq	(mgH ₂ S/l)	1.00	1.00	1.00	1.00	0.50	0.90	-0.74	-0.51	0.23			
34	pH, measured (STP)	pH	5.67	5.76	5.72	5.54	5.55	5.63	Inhibitor needed (mg/L)					
35	Choose one option to calculate SI?	0-CO ₂ %+Alk, 1-pH+Alk, 2-CO ₂ %+pH	0	0	0	0	0	0	Calcite	NTMP				
36	Gas/day(thousand cf/day)	(Mcf/D)						0	0.00	0.00				
37	Oil/Day	(B/D)	0	0	1	1	1	4	Barite	BHPMP				
38	Water/Day	(B/D)	100	100	100	100	100	500	0.00	0.00				
39	For mixed brines, enter values for temperatures and pressures in Cells (H40-H43)								(Enter H40-H43)		pH			
40	Initial T	(F)	66.0	71.0	70.0	41.0	49.0	60.0	5.69	5.60				
41	Final T	(F)	66.0	71.0	70.0	41.0	49.0	89.0	Viscosity (CentiPoise)					
42	Initial P	(psia)	25.0	25.0	25.0	25.0	25.0	25.0	1.196	0.826				
43	Final P	(psia)	25.0	25.0	25.0	25.0	25.0	120.0	Heat Capacity (cal/ml ^o C)					
44	Use TP on Calcite sheet?	1-Yes;0-No							0.955	0.959				
45	API Oil Grav.	API grav.						30.00	Inhibitor needed (mg/L)					
46	Gas Sp.Grav.	Sp.Grav.						0.60	Gypsum	HDTMP				
47	MeOH/Day	(B/D)	0	0	0	0	0	0	0.00	0.00				
48	MEG/Day	(B/D)	0	0	0	0	0	0	Anhydrite	HDTMP				
49	Conc. Multiplier								0.00	0.00				
50	H ⁺ (Strong acid) [†]	(N)												
51	OH ⁻ (Strong base) [†]	(N)												
52	Quality Control Checks at STP:													
53	H ₂ S Gas	(%)												
54	Total H ₂ Saq (STP)	(mgH ₂ S/l)												
55	pH Calculated	(pH)												
56	PCO ₂ Calculated	(%)												
57	Alkalinity Calculated	(mg/l) as HCO ₃												
58	ECations=	(equiv./l)												
59	EAnions=	(equiv./l)												
60	Calc TDS=	(mg/l)												
61	Inhibitor Selection	Input	Unit	#	Inhibitor	Unit Converter (From metric to English)								
62	Protection Time	120	min	1	NTMP.	From Unit	Value	To Unit	Value					
63	Have ScaleSoft/Fitzer			2	BHPMP	°C	80	°F	176					
64	plek inhibitor for you?	1	1-Yes;0-No	3	PAA	m ³	100	ft ³	3,531					
65	If No, Inhibitor # is:	4	#	4	DTPMP	m ³	100	bbl(42 US gal)	629					
66	If you select Mixed,			5	PPCA	MPa	1,000	psia	145,074					
67	1 st inhibitor # is:	1	#	6	SPA	Bar	496	psia	7,194					
68	% of 1 st inhibitor is:	50	%	7	HEDP	Torr	10,000	psia	193					
69	2 nd inhibitor # is:	2	#	8	HDTMP	Gal	10,000	bbl(42 US gal)	238					
70	Display act. coeffs?	0	1-Yes;0-No	9	Average	Liters	10,000	bbl(42 US gal)	63					
71				10	Mixed									

Saturation Index Calculations

Champion Technologies, Inc.

(Based on the Tomson-Oddo Model)

Brine 1: Ward Feed Yard 34-1

Brine 2: Ward Feed Yard 4-1

Brine 3: Clinesmith 5-4

Brine 4: Clinesmith 1

Brine 5: Clinesmith 2

Component (mg/L)	Ratio					Mixed Brine
	20% Brine 1	20% Brine 2	20% Brine 3	20% Brine 4	20 Brine 5	
Calcium	1836	2452	2044	1920	1948	1952
Magnesium	1096	872	1200	953	858	865
Barium	0	0	0	0	0	0
Strontium	0	0	0	0	0	0
Bicarbonate	190	234	259	268	254	253
Sulfate	1	1	8	1	1	1
Chloride	36299	48965	47874	45632	43147	43206
CO ₂ in Brine	246	220	264	422	405	401
Ionic Strength	1.12	1.48	1.46	1.38	1.31	1.31
Temperature (°F)	89	89	89	89	89	89
Pressure (psia)	50	50	120	120	120	119

Saturation Index

Calcite	-1.71	-1.41	-1.48	-1.68	-1.69	-1.69
Gypsum	-3.71	-3.64	-2.82	-3.73	-3.72	-3.69
Hemihydrate	-3.70	-3.65	-2.83	-3.74	-3.71	-3.69
Anhydrite	-3.89	-3.79	-2.97	-3.89	-3.88	-3.85
Barite	N/A	N/A	N/A	N/A	N/A	N/A
Celestite	N/A	N/A	N/A	N/A	N/A	N/A

PTB

Calcite	N/A	N/A	N/A	N/A	N/A	N/A
Gypsum	N/A	N/A	N/A	N/A	N/A	N/A
Hemihydrate	N/A	N/A	N/A	N/A	N/A	N/A
Anhydrite	N/A	N/A	N/A	N/A	N/A	N/A
Barite	N/A	N/A	N/A	N/A	N/A	N/A
Celestite	N/A	N/A	N/A	N/A	N/A	N/A

Operator Name: Quest Cherokee, LLC Lease Name: Carter, Gale D. Well #: 20-1
 Sec. 20 Twp. 28 S. R. 17 East West County: Wilson

INSTRUCTIONS: Show important tops and base of formations penetrated. Detail all cores. Report all final copies of drill stems tests giving interval tested, time tool open and closed, flowing and shut-in pressures, whether shut-in pressure reached static level, hydrostatic pressures, bottom hole temperature, fluid recovery, and flow rates if gas to surface test, along with final chart(s). Attach extra sheet if more space is needed. Attach copy of all Electric Wireline Logs surveyed. Attach final geological well site report.

Drill Stem Tests Taken <input type="checkbox"/> Yes <input checked="" type="checkbox"/> No <i>(Attach Additional Sheets)</i> Samples Sent to Geological Survey <input type="checkbox"/> Yes <input checked="" type="checkbox"/> No Cores Taken <input type="checkbox"/> Yes <input checked="" type="checkbox"/> No Electric Log Run <input checked="" type="checkbox"/> Yes <input type="checkbox"/> No <i>(Submit Copy)</i> List All E. Logs Run: Compensated Density Neutron Log Gamma Ray CCL Dual Induction Log	<input checked="" type="checkbox"/> Log Formation (Top), Depth and Datum <input type="checkbox"/> Sample Name Top Datum See attached
--	--

CASING RECORD <input type="checkbox"/> New <input type="checkbox"/> Used							
Report all strings set-conductor, surface, intermediate, production, etc.							
Purpose of String	Size Hole Drilled	Size Casing Set (In O.D.)	Weight Lbs. / Ft.	Setting Depth	Type of Cement	# Sacks Used	Type and Percent Additives
Surface	12-1/4	8-5/8"	20#	23	"A"	4	
Production	6-3/4	4-1/2	10.5#	1101.88	"A"	160	

ADDITIONAL CEMENTING / SQUEEZE RECORD				
Purpose:	Depth Top Bottom	Type of Cement	#Sacks Used	Type and Percent Additives
<input type="checkbox"/> Perforate <input type="checkbox"/> Protect Casing <input type="checkbox"/> Plug Back TD <input type="checkbox"/> Plug Off Zone				

Shots Per Foot	PERFORATION RECORD - Bridge Plugs Set/Type Specify Footage of Each Interval Perforated	Acid, Fracture, Shot, Cement Squeeze Record (Amount and Kind of Material Used)	Depth
4	1023-1025/976-978/970-972	300gal 15% HCl w/ 45 bbls 2% acid water, 450 bbls water w/ 2% KCl, Blocks, 8000# 20/40 sand	1023-1025/976-978 970-972
4	772-774/733-736/714-716	400gal 15% HCl w/ 45 bbls 2% acid water, 800 bbls water w/ 2% KCl, Blocks, 12100# 20/40 sand	772-774/733-736 714-716
4	644-648/632-636	400gal 15% HCl w/ 45 bbls 2% acid water, 500 bbls water w/ 2% KCl, Blocks, 12000# 20/40 sand	644-648/632-636

TUBING RECORD	Size	Set At	Packer At	Liner Run
	2-3/8	1031.46	n/a	<input type="checkbox"/> Yes <input checked="" type="checkbox"/> No

Date of First, Resumed Production, SWD or Enhr. 7/28/06	Producing Method <input type="checkbox"/> Flowing <input checked="" type="checkbox"/> Pumping <input type="checkbox"/> Gas Lift <input type="checkbox"/> Other (Explain)
---	---

Estimated Production Per 24 Hours	Oil Bbls.	Gas Mcf	Water Bbls.	Gas-Oil Ratio	Gravity
	n/a	8.1mcf	25bbls		

Disposition of Gas Vented Sold Used on Lease *(If vented, Submit ACO-18.)*

METHOD OF COMPLETION Open Hole Perf. Dually Comp. Commingled Other (Specify) _____

Production Interval _____

QUEST

Resource Corporation



211 W. 14TH STREET,
CHANUTE, KS 66720
620-431-9500

TICKET NUMBER 1518

FIELD TICKET REF #

FOREMAN Craig Rindne
(overseeing)

TREATMENT REPORT & FIELD TICKET CEMENT

DATE	WELL NAME & NUMBER	SECTION	TOWNSHIP	RANGE	COUNTY		
May 22, 06	Porter, Belt D. 20-1	20	28	17	Wichita		
FOREMAN / OPERATOR	TIME IN	TIME OUT	LESS LUNCH	TRUCK #	TRAILER #	TRUCK HOURS	EMPLOYEE SIGNATURE
Craig Rindne	1:15	5:30		901746		4.25	<i>[Signature]</i>

JOB TYPE logging HOLE SIZE 6 3/4 HOLE DEPTH 1108 CASING SIZE & WEIGHT 4 1/2" x 10.5
 CASING DEPTH 1101.88 DRILL PIPE _____ TUBING _____ OTHER _____
 SLURRY WEIGHT 14.5 SLURRY VOL _____ WATER gal/sk _____ CEMENT LEFT in CASING 0
 DISPLACEMENT 17.57 DISPLACEMENT PSI _____ MIX PSI _____ RATE 4.5

REMARKS:

Ran 2 sacks of prem gel and swept to surface. Installed cement head. Pumped 2 sacks of gel, 10 barrels of water and 160 sacks of cement. Flushed pump. Pump wiper plug to bottom. set flood shoe.

1011.88	5	4	4	2	1	1
		kr	kr			

Ft 4 1/2 casing
 centralizers
 Casing tractor
 Casing trailer
 Baffles 3 1/2" x 3"
 4 1/2 wiper plug
 Flood shoe 4 1/2

Supplied by Quest

RECEIVED
KANSAS CORPORATION COMMISSION
SEP 11 2006
CONSERVATION DIVISION
WICHITA, KS

ACCOUNT CODE	QUANTITY or UNITS	DESCRIPTION OF SERVICES OR PRODUCT	TOTAL AMOUNT
		Foreman Pickup	
		Cement Pump Truck	
		Bulk Truck	
1104		Portland Cement	
1124		OWC Blend Cement	
1126		OWC Blend Cement	
1110		Gilsonite	
1107		Flo-Seal	
1118		Premium Gel	
1215A		KGL	
1111B		(Sodium Silicate)	
1123		City Water	
		Transport Truck	
		Transport Trailer	
		80 Vac	

Supplied by Consolidated

Michael Drilling, LLC
P.O. Box 402
Iola, KS 66749
620-365-2755

Company: Quest Cherokee LLC
Address: 9520 North May Ave, Suite 300
Oklahoma City, Oklahoma 73120
Ordered By: Donnie Meyers

Date: 05/13/06
Lease: Carter, Gale D.
County: Wilson
Well#: 20-1
API#: 15-205-26580-00-00

Drilling Log

FEET	DESCRIPTION	FEET	DESCRIPTION
0-5	Overburden	615	Gas Test 22" at 1/4" Choke
5-23	Lime	627-629	Shale
23-130	Sandy Shale	629-634	Black Shale
130-180	Lime	634-642	Lime
180-191	Sandy Shale	636	Gas Test 20" at 1/4" Choke
191-212	Lime	642-644	Black Shale
212-250	Shale	644-646	Coal
250-264	Lime	646-660	Shale
264-322	Shale	657	Gas Test 46" at 1/4" Choke
322-340	Lime	660-680	Sand
340-400	Shale	680-711	Shale
400-402	Black Shale	711-713	Coal
402-412	Lime	713-730	Shale
412-417	Shale	730-731	Lime
417-457	Lime and Shale	731-733	Coal
457-520	Sand	733-738	Shale
520-535	Shale	738-740	Coal
535-542	Lime	740-745	Shale
542-544	Coal	745-748	Coal
544-570	Lime	748-783	Sand
570-573	Black Shale	783-800	Sandy Shale
573-607	Sandy Shale	800-802	Coal
607-608	Coal	802-832	Shale
608-627	Lime	832-834	Coal

RECEIVED
KANSAS CORPORATION COMMISSION
SEP 11 2006
CONSERVATION DIVISION
WICHITA, KS

Michael Drilling, LLC
P.O. Box 402
Iola, KS 66749
620-365-2755

Company: Quest Cherokee LLC
Address: 9520 North May Ave, Suite 300
Oklahoma City, Oklahoma 73120
Ordered By: Donnie Meyers

Date: 05/13/06
Lease: Carter, Gale D.
County: Wilson
Well#: 20-1
API#: 15-205-26580-00-00

Drilling Log

FEET	DESCRIPTION	FEET	DESCRIPTION
834-860	Shale		
860-861	Coal		
861-885	Shale		
885-935	Sand		
935-960	Shale		
960-968	Sand		
968-971	Coal		
971-976	Shale		
976-978	Coal		
978-1019	Shale		
983	Gas Test 43" at 1/4" Choke		
1019-1021	Coal		
1021-1033	Shale		
1033	Gas Test 43" at 1/4" Choke		
1033-1108	Mississippi Lime		
1083	Gas Test 43" at 1/4" Choke		
1108	Gas Test 43" at 1/4" Choke		
1108	TD		
	Surface 23'		

POSTROCK



LEGEND

PostRock®

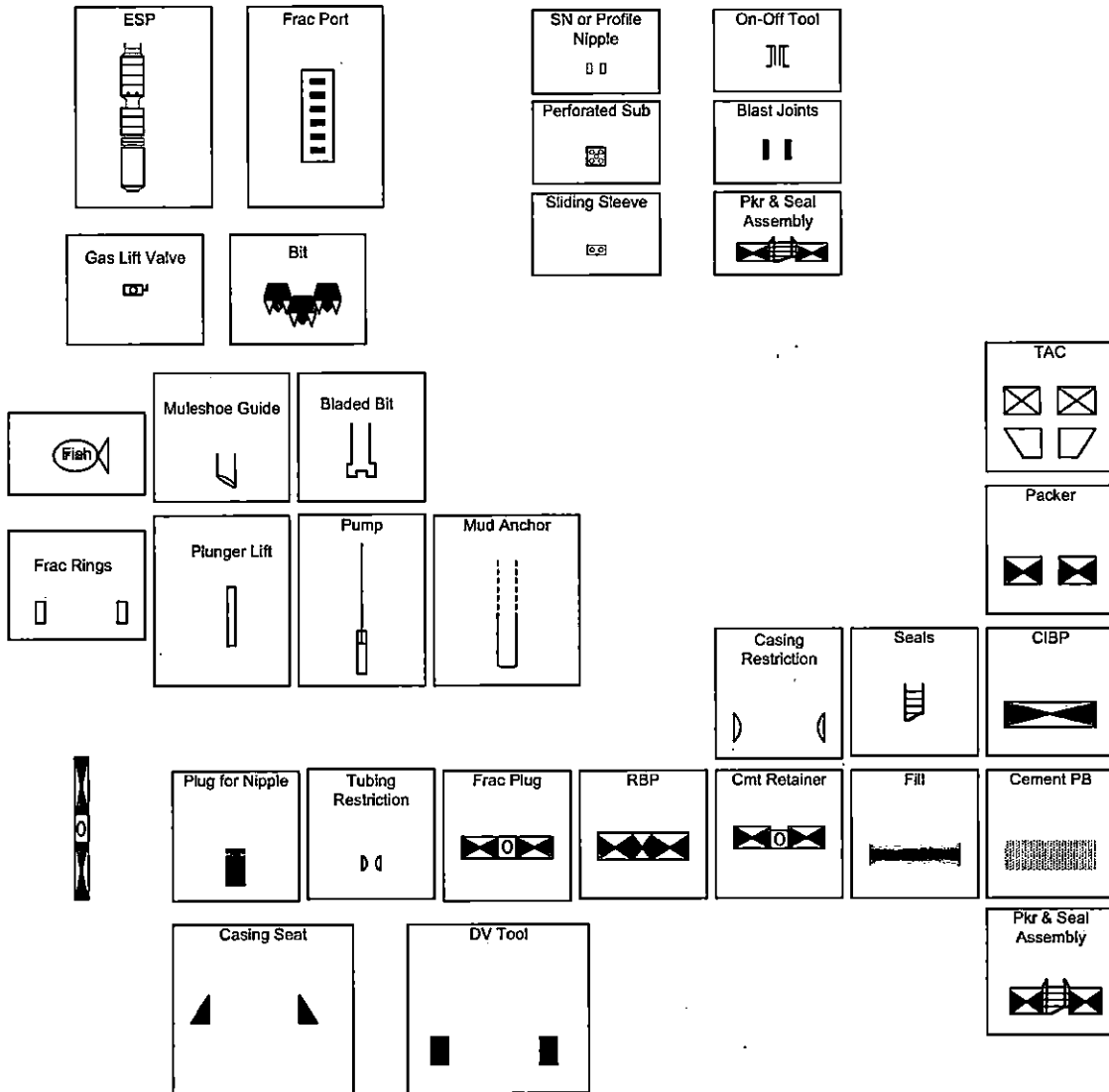

AFFIDAVIT

STATE OF KANSAS \
- SS.
County of Sedgwick /

Mark Fletchall, of lawful age, being first duly sworn, deposeth and saith: That he is Record Clerk of The Wichita Eagle, a daily newspaper published in the City of Wichita, County of Sedgwick, State of Kansas, and having a general paid circulation on a daily basis in said County, which said newspaper has been continuously and uninterruptedly published in said County for more than one year prior to the first publication of the notice hereinafter mentioned, and which said newspaper has been entered as second class mail matter at the United States Post Office in Wichita, Kansas, and which said newspaper is not a trade, religious or fraternal publication and that a notice of a true copy is hereto attached was published in the regular and entire Morning issue of said The Wichita Eagle for 1 issues, that the first publication of said notice was

made as aforesaid on the 11th of

August A.D. 2012, with

subsequent publications being made on the following dates:

And affiant further says that he has personal knowledge of the statements above set forth and that they are true.

Mark Fletchall

Subscribed and sworn to before me this

13th day of August, 2012



Penny L. Case
Notary Public Sedgwick County, Kansas

Printer's Fee : \$139.60

LEGAL PUBLICATION
PUBLISHED IN THE WICHITA EAGLE
AUGUST 11, 2012 (3208866)
BEFORE THE STATE CORPORATION COMMISSION
OF THE STATE OF KANSAS
NOTICE OF FILING APPLICATION
RE: In The Matter of Postrock Midcontinent
Production, LLC Application for
Commencing Production in the Carter,
Gate D 20-1 located in Wilson County,
Kansas.
TO: All Oil & Gas Producers, Unleased
Mineral Interest Owners, Landowners,
and all persons whomsoever concerned.
You, and each of you, are hereby
notified that Postrock Midcontinent
Production, LLC has filed an application
to commence the Summit, Muly,
Beyer, Crewsburg, Fleming, Howe,
Neutral, Riverton and Squirrel producing
formations of the Carter Gate D 20-1
located in the NW 1/4 SE 1/4 SW 1/4 T28S
R17E, Approximately S07° E51° & 2042
FWL, Wilson County, Kansas.
Any persons who object to or protest
this application shall be required to file their
objections or protest with the Conservation
Division of the State Corporation
Commission of the State of Kansas within
fifteen (15) days from the date of this
publication. These protests shall be filed
pursuant to Commission regulations and
must state specific reasons why granting
the application may cause waste, violate
correlative rights or pollute the natural
resources of the State of Kansas.
All persons interested or concerned
shall take notice of the foregoing and shall
govern themselves accordingly. All person
and/or companies wishing to protest this
application are required to file a written
protest with the Conservation Division of
the Kansas Oil and Gas Commission.
Upon the receipt of any protest, the
Commission will convene a hearing and
protestants will be expected to enter an
appearance either through proper legal
counsel or as individuals appearing on
their own behalf.
Postrock Midcontinent Production, LLC
210 Park Avenue, Suite 2750
Oklahoma City, Oklahoma 73102
(405) 660-7704
**A COPY OF THE AFFIDAVIT OF
PUBLICATION MUST ACCOMPANY
ALL APPLICATIONS**

PROOF OF PUBLICATION

STATE OF KANSAS
Wilson County - SS

JOSEPH S. and RITA M. RELPH, of lawful age, being duly sworn upon oath that they are the Owners and Publishers of the WILSON COUNTY CITIZEN:

THAT said newspaper has been published at least weekly fifty (50) times a year and has been so published for at least five years prior to the first publication of the attached notice:

THAT said newspaper is a general circulation on a daily, or weekly, or monthly, or yearly basis in;

WILSON COUNTY, KANSAS and is NOT a trade, religious or fraternal publication and has been PRINTED and PUBLISHED in Wilson County, Kansas.

THE ATTACHED was published on the following dates in a regular issue of said newspaper:

1st publication was made on the 13th day of August, 2012

2nd publication was made on the _____ day of _____, 20_____

3rd publication was made on the _____ day of _____, 20_____

4th publication was made on the _____ day of _____, 20_____

5th publication was made on the _____ day of _____, 20_____

6th publication was made on the _____ day of _____, 20_____

TOTAL PUBLICATION FEE: \$ 37²⁹³

(Signed) Joseph S. Relph

Subscribed and sworn to before me, this 14th day of August, 2012

Rita M. Relph (Notary Public)

My commission expires Aug-30, 2014

(Published in the Wilson County Citizen on Monday, August 13, 2012)

BEFORE THE STATE CORPORATION COMMISSION OF THE STATE OF KANSAS

NOTICE OF FILING APPLICATION

RE: In the Matter of Postrock Midcontinent Production, LLC Application for Commingling of Production in the Carter, Gale D 20-1 located in Wilson County, Kansas.

TO: All Oil & Gas Producers, Unleased Mineral Interest Owners, Landowners, and all persons whomsoever concerned.

You, and each of you, are hereby notified that Postrock Midcontinent Production, LLC has filed an application to commingle the Summit, Mully, Beaver, Croweburg, Fleming, Rowe, Neutral, Riverston and Squirrel producing formations at the Carter, Gale D 20-1, located in the NW SE SE SW, S20-T28S-R17E, Approximately 607 E SL & 2042 FWL, Wilson County, Kansas.

Any persons who object to or protest this application shall be required to file their objections or protest with the Conservation Division of the State Corporation Commission of the State of Kansas within fifteen (15) days from the date of this publication. These protests shall be filed pursuant to Commission regulations and must state specific reasons why granting the application may cause waste, violate correlative rights or pollute the natural resources of the State of Kansas.

All persons interested or concerned shall take notice of the foregoing and shall govern themselves accordingly. All person and/or companies wishing to protest this application are required to file a written protest with the Conservation Division of the Kansas Oil and Gas Commission.

Upon the receipt of any protest, the Commission will convene a hearing and protestants will be expected to enter an appearance either through proper legal counsel or as individuals, appearing on their own behalf.

Postrock Midcontinent Production, LLC
210 Park Avenue, Suite 2750
Oklahoma City, Oklahoma 73102
(405) 660-7704
511 copy

pd.
8/23/12
mr



Rita M. Relph
NOTARY PUBLIC
State of Kansas
My Commission Expires

Affidavit of Notice Served

Re: Application for: APPLICATION FOR COMMINGLING OF PRODUCTION OR FLUIDS ACO-4

Well Name: CARTER, GALE D 20-1 Legal Location: NWSESESW S20-T28S-R17E

The undersigned hereby certifies that he / she is a duly authorized agent for the applicant, and that on the day 24th of AUGUST, 2012, a true and correct copy of the application referenced above was delivered or mailed to the following parties:

Note: A copy of this affidavit must be served as a part of the application.

Name	Address (Attach additional sheets if necessary)
KANSAS OIL, INC	16716 WICHITA RD, CHANUTE, KS 66720
C K REECE	315 LAMBETH RD, WATERLOO, IA 50701
LYLE M GREER	1019 N STEUBEN, CHANUTE, KS 66720

I further attest that notice of the filing of this application was published in the THE WILSON COUNTY CITIZEN, the official county publication of WILSON county. A copy of the affidavit of this publication is attached.

Signed this 24th day of AUGUST, 2012

[Signature]
Applicant or Duly Authorized Agent

Subscribed and sworn to before me this 24th day of AUGUST, 2012



[Signature]
Notary Public
My Commission Expires: July 20, 2014

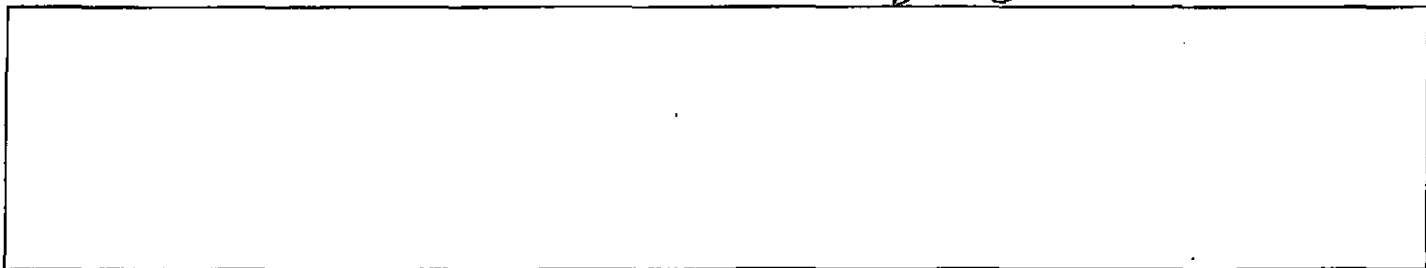

CARTER, GALE D 20-1

20-28S-17E

per TO dtd 11.19.06

S2NW4 less 4 acre tract C.K. Reece
315 LAMBETH RD
Waterloo, IA 50701

per TO dtd 11.19.06

4 acre tract in S2NW4 Lyle M. Greer
1019 N Steuben
Chanute, KS 66720

CARTER, GALE D 20-1

LEGAL LOCATION	SPOT	CURR_OPERA
S20-T28S-R17E	NW NE NE SW	Kansas Oil, Inc.
S29-T28S-R17E	NW NW NW	Kansas Oil, Inc.
S29-T28S-R17E	NE NE NE NW	Kansas Oil, Inc.
S29-T28S-R17E	SE NE NE NW	Kansas Oil, Inc.
S29-T28S-R17E	NW NW NW NW	Kansas Oil, Inc.
S29-T28S-R17E	N2 NW NW	Kansas Oil, Inc.
S29-T28S-R17E	SW NW NW	Kansas Oil, Inc.
S29-T28S-R17E	SW SW NW NW	Kansas Oil, Inc.
S29-T28S-R17E	N2 NW NW	Kansas Oil, Inc.

Conservation Division
Finney State Office Building
130 S. Market, Rm. 2078
Wichita, KS 67202-3802



Phone: 316-337-6200
Fax: 316-337-6211
<http://kcc.ks.gov/>

Mark Sievers, Chairman
Thomas E. Wright, Commissioner

Sam Brownback, Governor

September 11, 2012

Clark Edwards
PostRock Midcontinent Production LLC
Oklahoma Tower
210 Park Ave, Ste 2750
Oklahoma City, OK 73102

RE: Approved Commingling CO081232
Carter, Gale D. 20-1, Sec. 20-T28S-R17E, Wilson County
API No. 15-205-26580-00-00

Dear Mr. Edwards:

Your Application for Commingling (ACO-4) for the above described well, received by the KCC on August 27, 2012, has been reviewed and approved by the Kansas Corporation Commission (KCC) per K.A.R. 82-3-123. Notice was examined and found to be proper per K.A.R. 82-3-135a. No protest had been filed within the 15-day protest period.

Based upon the depth of the Riverton formation perforations, total oil production shall not exceed 100 BOPD and total gas production shall not exceed 50% of the absolute open flow (AOF).

File form ACO-1 upon re-completion of the well to commingle.

Commingling ID number CO081232 has been assigned to this approved application. Use this number for well completion reports (ACO-1) and other correspondence that may concern this approved commingling.

Sincerely,

Rick Hestermann
Production Department