

ORIGINAL

RELEASED

CONFIDENTIAL

SIDE ONE

FEB 28 1991

STATE CORPORATION COMMISSION OF KANSAS  
OIL & GAS CONSERVATION DIVISION  
WELL COMPLETION FORM  
ACO-1 WELL HISTORY  
DESCRIPTION OF WELL AND LEASE

API NO. 15- 151-21955-0000 FROM CONFIDENTIAL

County PRATT

SE SE SW Sec. 35 Twp. 26S Rge. 12 X East West

330 Ft. North from Southeast Corner of Section

2978 Ft. West from Southeast Corner of Section  
(NOTE: Locate well in section plat below.)

Lease Name STUDER Well # 12

Field Name STEAD SOUTH

Producing Formation MISSISSIPPI

Elevation: Ground 1864' KB 1871'

Total Depth 4405' PBDT 4220'

Operator: License # 5916

Name: CONOCO, INC.

Address 3817 N. W. EXPRESSWAY

City/State/Zip OKLAHOMA CITY, OK 73112

Purchaser: \_\_\_\_\_

Operator Contact Person: GLEN HUGHES

Phone ( 316 ) 793-7871

Contractor: Name: DUKE DRILLING, INC.

License: \_\_\_\_\_

Wellsite Geologist: David Weichman

Designate Type of Completion

New Well  Re-Entry  Workover

Oil  SWD  Temp. Abd.

Gas  Inj  Delayed Comp.

Dry  Other (Core, Water Supply, etc.)

If **DWO**: old well info as follows:

Operator: \_\_\_\_\_

Well Name: \_\_\_\_\_

Comp. Date \_\_\_\_\_ Old Total Depth \_\_\_\_\_

Drilling Method:

Mud Rotary  Air Rotary  Cable

11-27-89 12-03-89 12-09-89

Spud Date Date Reached TD Completion Date

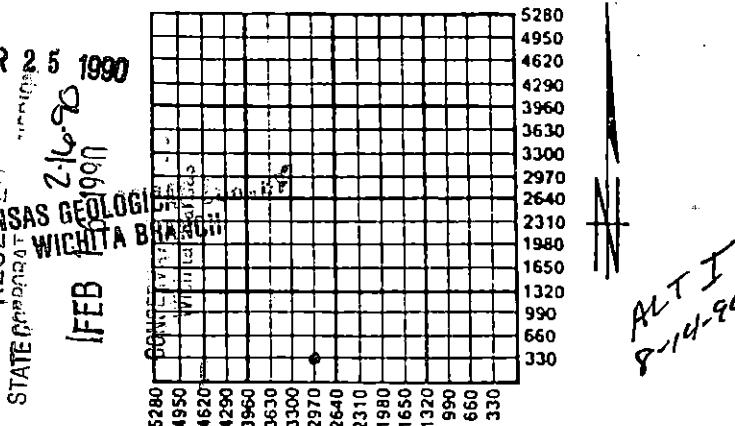

Amount of Surface Pipe Set and Cemented at 280 Feet

Multiple Stage Cementing Collar Used?  Yes  No

If yes, show depth set \_\_\_\_\_ Feet

If Alternate II completion, cement circulated from \_\_\_\_\_

feet depth to \_\_\_\_\_ w/ \_\_\_\_\_ sx cmt.

**INSTRUCTIONS:** This form shall be completed in triplicate and filed with the Kansas Corporation Commission, 200 Colorado Derby Building, Wichita, Kansas 67202, within 120 days of the spud date of any well. Rule 82-3-130, 82-3-107 and 82-3-106 apply. Information on side two of this form will be held confidential for a period of 12 months if requested in writing and submitted with the form. See rule 82-3-107 for confidentiality in excess of 12 months. One copy of all wireline logs and drillers time log shall be attached with this form. ALL CEMENTING TICKETS MUST BE ATTACHED. Submit CP-4 form with all plugged wells. Submit CP-111 form with all temporarily abandoned wells. Any recompletion, workover or conversion of a well requires filing of ACO-2 within 120 days from commencement date of such work.

All requirements of the statutes, rules and regulations promulgated to regulate the oil and gas industry have been fully complied with and the statements herein are complete and correct to the best of my knowledge.

Signature Chris J. Dodson CHRIS J. DODSON

Title SUPERVISOR-REGULATORY AFFAIRS Date 2-14-90

Subscribed and sworn to before me this 4 day of February, 19 90.

Notary Public Candy M. Driscoll

Date Commission Expires 7/22/92

**K.C.C. OFFICE USE ONLY**

Letter of Confidentiality Attached

Wireline Log Received

Drillers Timelog Received

**Distribution**

KCC  SWD/Rep  NGPA

KGS  Plug  Other (Specify)

ORIGINAL

91

CONFIDENTIAL

ORIGINAL

SIDE TWO

Operator Name CONOCO, INC. Lease Name STUDER Well # 12
County PRATT
Sec. 35 Twp. 26S Rge. 12
East West

INSTRUCTIONS: Show important tops and base of formations penetrated. Detail all cores. Report all drill stem tests giving interval tested, time tool open and closed, flowing and shut-in pressures, whether shut-in pressure reached static level, hydrostatic pressures, bottom hole temperature, fluid recovery, and flow rates if gas to surface during test. Attach extra sheet if more space is needed. Attach copy of log.

Drill Stem Tests Taken (Attach Additional Sheets.)
Samples Sent to Geological Survey
Cores Taken
Electric Log Run (Submit Copy.)
Formation Description
Name Top Bottom
MISSISSIPPI CHAT 4134' 4189'

RELEASED

FEB 28 1991

FROM CONFIDENTIAL

DIL/SP/GR, GR/FDC/CNL/CAL

CASING RECORD
Report all strings set-conductor, surface, intermediate, production, etc.
Purpose of String, Size Hole Drilled, Size Casing Set (In O.D.), Weight Lbs./Ft., Setting Depth, Type of Cement, # Sacks Used, Type and Percent Additives
PERFORATION RECORD
Shots Per Foot, Specify Footage of Each Interval Perforated, Acid, Fracture, Shot, Cement Squeeze Record (Amount and Kind of Material Used), Depth
TUBING RECORD
Size, Set At, Packer At, Liner Run
Date of First Production, Producing Method
Estimated Production Per 24 Hours, Oil Bbls., Gas Mcf, Water Bbls., Gas-Oil Ratio

Disposition of Gas:
METHOD OF COMPLETION
Production Interval 4134'-4189'

