

STATE CORPORATION COMMISSION OF KANSAS
OIL & GAS CONSERVATION DIVISION
WELL COMPLETION OR RECOMPLETION FORM
ACO-1 WELL HISTORY
DESCRIPTION OF WELL AND LEASE

API NO. 15-151-21,906-0000
County...Pratt
Approx. NE SE NE Sec. 32 Twp. 26 Rge. 12 East
X West

Operator: License # 3292
Name Timberline Oil & Gas Corp.
Address 105 E. 8th Street
City/State/Zip Pratt, KS 67124

3690 Ft North from Southeast Corner of Section
540 Ft West from Southeast Corner of Section
(Note: Locate well in section plat below)

Purchaser None - salt water disposal

Lease Name Dietz Well # W-4
Field Name Iuka Carmi
Disposal
Producing Formation Arbuckle

Operator Contact Person Brant C. Grote
Phone 316-672-9476

Elevation: Ground 1895 KB 1903

Contractor: License # 5929
Name Duke Drilling Co., Inc.

Wellsite Geologist Brant C. Grote
Phone 316-672-9476

Designate Type of Completion
X New Well Re-Entry Workover

Oil X SWD Temp Abd
Gas Inj Delayed Comp.
Dry Other (Core, Water Supply etc.)

If OWO: old well info as follows:
Operator
Well Name
Comp. Date Old Total Depth

WELL HISTORY

Drilling Method:
X Mud Rotary Air Rotary Cable
10-17-88 10-24-88 11-2-88
Spud Date Date Reached TD Completion Date
5054' 5054'
Total Depth PBD

Amount of Surface Pipe Set and Cemented at 285 feet
Multiple Stage Cementing Collar Used? Yes X No
If yes, show depth set feet
If alternate 2 completion, cement circulated from feet depth to w/SX cmt
Cement Company Name
Invoice #

RECEIVED
NOV 7 1988
11-7-88
CONSERVATION DIVISION
Wichita, Kansas

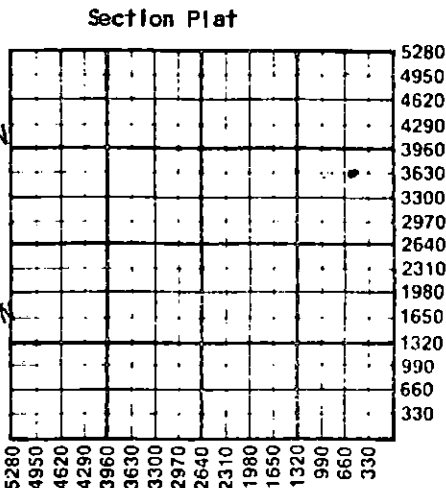

WATER SUPPLY INFORMATION

Disposition of Produced Water: Disposal
Docket # Repressuring

Questions on this portion of the ACO-1 call:

Water Resources Board (913) 296-3717
Source of Water: Farmers Domestic well
Division of Water Resources Permit #
X Groundwater 4950 Ft North from Southeast Corner
(Well) 330 Ft West from Southeast Corner of
Sec 32 Twp 26 Rge 12 East X West
Surface Water Ft North from Southeast Corner
(Stream, pond etc) Ft West from Southeast Corner
Sec Twp Rge East West
Other (explain)
(purchased from city, R.W.D. #)

INSTRUCTIONS: This form shall be completed in triplicate and filed with the Kansas Corporation Commission, 200 Colorado Derby Building, Wichita, Kansas 67202, within 120 days of the spud date of any well. Rule 82-3-130, 82-3-107 and 82-3-106 apply. Information on side two of this form will be held confidential for a period of 12 months if requested in writing and submitted with the form. See rule 82-3-107 for confidentiality in excess of 12 months. One copy of all wireline logs and drillers time log shall be attached with this form. Submit CP-4 form with all plugged wells. Submit CP-111 form with all temporarily abandoned wells.

All requirements of the statutes, rules and regulations promulgated to regulate the oil and gas industry have been fully complied with and the statements herein are complete and correct to the best of my knowledge.

Signature Brant C. Grote
Title President Date 11/4/88

Subscribed and sworn to before me this 4th day of November 1988
Notary Public Sharon K. Smith

Date Commission Expires 11/20/90



K.C.C. OFFICE USE ONLY
F Letter of Confidentiality Attached
C Wireline Log Received
C Drillers Timelog Received
Distribution
X KCC SWD/Rep NGPA
X KGS Plug Other
(Specify)
11-7-88 X

Operator Name Timberline Oil & Gas Corporation Lease Name Dietz Well # W-4

Sec. 32 Twp. 26 Rge. 12 East West County Pratt

WELL LOG

INSTRUCTIONS: Show important tops and base of formations penetrated. Detail all cores. Report all drill stem tests giving interval tested, time tool open and closed, flowing and shut-in pressures, whether shut-in pressure reached static level, hydrostatic pressures, bottom hole temperature, fluid recovery, and flow rates if gas to surface during test. Attach extra sheet if more space is needed. Attach copy of log.

Drill Stem Tests Taken Yes No
 Samples Sent to Geological Survey Yes No
 Cores Taken Yes No

Formation Description
 Log Sample

Name	Top	Bottom
Viola	4090' KB	
Arbuckle	4261' KB	

Samples from 4250' to TD

CASING RECORD <input checked="" type="checkbox"/> New <input type="checkbox"/> Used							
Report all strings set-conductor, surface, intermediate, production, etc.							
Purpose of String	Size Hole Drilled	Size Casing Set (In O.D.)	Weight Lbs/Ft.	Setting Depth	Type of Cement	#Sacks Used	Type and Percent Additives
Surface	12 1/2"	8-5/8"	24#	285'	60/40 POZ	200	
Production	7-7/8"	5 1/2"	14.5#	4345'	ATL	250	2% Gilsonite
				Packer shoe at 4348'	ASC	50	5% Gilsonite

PERFORATION RECORD		Acid, Fracture, Shot, Cement Squeeze Record	
Shots Per Foot	Specify Footage of Each Interval Perforated	(Amount and Kind of Material Used)	Depth
Open Hole	4348' - 5054'	10,000 gal. 15% HCl	4348' - 5054'

TUBING RECORD	Size <u>3 1/2"</u>	Set At <u>fiberglass</u>	Packer at <u>4463 KB</u>	Liner Run <input type="checkbox"/> Yes <input checked="" type="checkbox"/> No
Date of First Production	Producing Method <input type="checkbox"/> Flowing <input type="checkbox"/> Pumping <input type="checkbox"/> Gas Lift <input type="checkbox"/> Other (explain).....			
<u>NA</u>				

Estimated Production Per 24 Hours	Oil	Gas	Water	Gas-Oil Ratio	Gravity
	<u>NA</u>	<u>NA</u>	<u>NA</u>		
	Bbls	MCF	Bbls	CFPB	

METHOD OF COMPLETION Open Hole Perforation Other (Specify)

Disposition of gas: Vented Sold Used on Lease

Production Interval Disposal 4348-5054'

Dually Completed Commingled

