

STATE OF KANSAS  
STATE CORPORATION COMMISSION  
CONSERVATION DIVISION  
500 INSURANCE BUILDING  
212 NORTH MARKET  
WICHITA, KANSAS 67202

FORM CP-1

WELL PLUGGING APPLICATION FORM  
File One Copy

Lease Owner E. K. Edmiston Drilling Co., Inc.

Address 425 First National Bank Bldg., Wichita, Kansas

Lease (Farm Name) SHRIVER Well No. 1

Well Location C W 1/2 NW NE Sec. 18 Twp 26S Rge. (E) 11 (W)

County Pratt Field Name (If Any) \_\_\_\_\_

Total Depth 4218' Oil Well \_\_\_\_\_ Gas Well \_\_\_\_\_ Input Well \_\_\_\_\_ SWD Well \_\_\_\_\_ D & A X

Well Log filed with application Yes or Well Log filed with Plugging Supervisor \_\_\_\_\_

Date and hour plugging is desired to begin January 11, 1969, 4:15 PM

Plugging of the well will be done in accordance with the Rules and Regulations of the State Corporation Commission.

contractor's  
Name of ~~company~~ representative in charge of plugging operations W. A. Walker

Box 1061 Address Great Bend, Kansas

Plugging Contractor Rains & Williamson Oil Co., Inc. License No. \_\_\_\_\_

Address 1425 Wichita Plaza - Wichita, Kansas

Invoice covering assessment for plugging this well should be sent to E. K. Edmiston Drilling

Co., Inc. Address 425 First National Bank Bldg.  
Wichita, Kansas

and payment will be guaranteed by applicant.

RECEIVED  
STATE CORPORATION COMMISSION  
Signed: Wilson Rains  
Applicant or Acting Agent

JAN 17 1969 Date: January 15, 1969

CONSERVATION DIVISION  
Wichita, Kansas

State of Kansas



ROBERT B. DOCKING Governor  
DALE E. SAFFELS Chairman  
JULES V. DOTY Commissioner  
JAMES O. GREENLEAF Commissioner  
RAYMOND B. HARVEY Secretary  
JACK GLAVES Gen. Counsel

State Corporation Commission

CONSERVATION DIVISION

(Oil, Gas and Water)

500 Insurance Bldg. 212 N. Market  
WICHITA, KANSAS 67202

January 14, 1969

WELL PLUGGING AUTHORITY

Well No.	1
Lease	Shriver
Description	C W/2 NW NE 18-26-11W
County	Pratt
Total Depth	4218
Plugging Contractor	Rains & Williamson Drilling

E. K. Edmiston  
425 1st Nat'l Bk. Bldg.,  
Wichita, Kansas 67202

Gentlemen:

This is your authority to plug the above subject well in accordance with the Rules and Regulations of the State Corporation Commission.

This authority is void after 90 days from the above date.

Very truly yours,

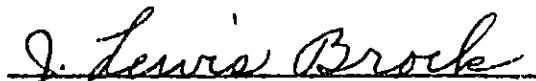
  
J. Lewis Brock, Administrator

Mr. R. J. Warren Box 322 Pratt, Kansas  
is hereby assigned to supervise the plugging of the above  
named well.

STATE OF KANSAS  
DEPARTMENT OF HEALTH AND ENVIRONMENT

M E M O R A N D U M

December 10, 1985

TO: Mike Cochran

FROM: Don C. Ubel

SUBJECT: Results of additional observation wells at W. K. Black  
"Lost Hole" site  
NWNE 28-26-13W  
Pratt County

On October 8, 1985, Clarke Well & Equipment drilled the first of two new observation wells near the half section line west of the Black "Lost Hole". The hole was drilled to bedrock at around 187' but restrictions in the bore hole prevented casing from going to the bottom. Pipe was eventually set at 143', just above a clay layer that separates the unconsolidated sediments into an upper water bearing zone and a lower water bearing zone. Due to muddy conditions the second OB well was not completed until November 22, 1985. The second well has pipe set at 187', at the top of the Permian Redbeds. A bentonite seal was installed back of the casing across the clay layer @ 140'.

Water samples collected from the new OB wells and also the existing OB wells since September 1985 show chloride concentrations as follows:

OB #1 - Oil field supply well (Depth 110')	12-6-85	30 mg/l
OB #2 - Observation well at "Lost Hole" (Depth 198')	9-6-85 12-6-85	475 mg/l 445 mg/l <i>COO</i>
OB #3 - New well west of "Lost Hole" (Depth 143')	10-8-85 12-6-85	220 mg/l 240 mg/l
OB #4 - New well west of "Lost Hole" (Depth 187')	11-22-85 12-6-85	740 mg/l 805 mg/l

The information gained from the two new OB wells appears to answer most of the questions raised by GWMD #5. Observation well #3 shows that the water in the "upper zone" (above 142') contains enough natural mineralization to account for the seemingly

512-144

DEC 20 1985

high chloride concentration (124 mg/l) showing up in the Jarboe irrigation well. The deeper OB well (OB#4) shows that the mineralization along the bedrock contact is not significantly greater than at OB #2, thus, the occurrence of downward drainage of freshwater in the "Lost Hole", at least at a significant rate, does not appear likely.

I have discussed the data gained from these new OB wells with Ralph Davis and we are in agreement that additional drilling, beyond what has been done to this point, is not necessary. The existing OB wells will be placed on a regular sampling schedule by GWMD #5 to track water quality changes that might indicate "change in conditions at the "Lost Hole".

W. K. Black, Inc. has agreed to pay for the construction of the two new observation wells.

DCU:wg

cc: Ralph Davis  
Duane Rankin, KCC ✓

WELL RECORD

And Construction Sheet

South Well (Deep)

Well No. 2 (of 2)

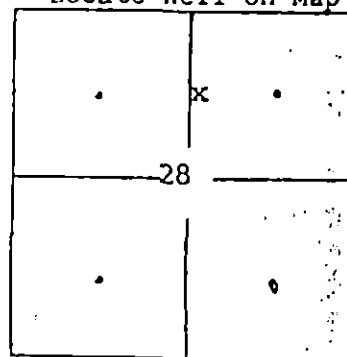

Well Owner KDHE - Black Oil

Well Use Monitor Appropriation No. \_\_\_\_\_

Location (Fraction) SW 1/4 NW 1/4 NE 1/4 Section No. 28

Township T 26 S Range R 13 W/K, Pratt SECTION 28 County, Kansas

Size Hole 9 Inches in Diameter

Size Casing 5 in. Dia. .214 Wall; Wt. 2.277 lbs/ft, Plastic Material

Size Screen 5 in. Dia. .214 Wall Plastic Material 1/8" Slot/HOLE

\*\*\*\*\* FORMATION LOG; From Test No. \_\_\_\_\_ Formation Thickness CASING & SCREEN, Record & Mfgr. \*\*\*\*\*

From	To	Formation	Thickness	CASING & SCREEN	From	To	Ftg.
0	20	Topsoil & sand & sandy clay		Plain	0	182	182
20	23	Sand & gravel, med.		Screen	182	187	5
23	41	Sandy tan clay					
41	68	Sand & gravel, fine to med.					
68	79	Tan sandy clay w/caliche		Left casing 2' above ground			
79	85	Sand & gravel, fine to med.					
85	95	Tan clay					
95	112.5	Brown clay					
112.5	113	Brown clay					
113	127	Sand & gravel, fine to med. to coarse w/streak of brown clay @ 127'					
127	142	Sand & gravel, med. to fine to coarse					
142	148	Tan clay					
148	151	Sand & gravel fine to med.					
151	153	Tan clay					
153	187	Sand & gravel, fine					
	187	Red Shale		Total Casing & Screen			187

Static Water Level 30' Chlorinate: \_\_\_\_\_ Quantity Used \_\_\_\_\_

GRAVEL PACK CEMENT (2 sacks) CHLORIDES = 805 ppm

10 to 166 0 to 10 - mixed w/gravel

170 to 187 166 to 170 - Expanding bentonite pellets

What is the nearest source of possible contamination old unplugged oil wells

Direction From Well east How Many Feet 600'

Designed by Darrell W. Clarke Drilled by Rodney Schenkel Date: 11/22/85

1762, 1985

W.L. RECORD  
And Construction Sheet

OK #3

North Well  
(Shallow)

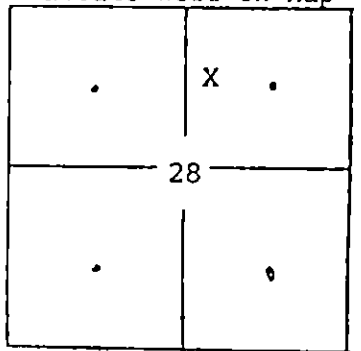

Well Owner KDHE-Black Oil Co. Well No. 1 (of 2)

Well Use Monitor Appropriation No. \_\_\_\_\_

Location (Fraction) SW 1/4 NW 1/4 NE 1/4 Section No. 28

Township T 26 S Range R 13 W/E, Pratt SECTION 28 County, Kansas

Size Hole 9 Inches in Diameter

Size Casing 5 in. Dia. .214 Wall; Wt. 2.277 lbs/ft; Plastic Material

Size Screen 5 in. Dia. .214 Wall Plastic Material 1/8" Slot

\*\*\*\*\*  
FORMATION LOG; From Test No. \_\_\_\_\_ Formation Thickness CASING & SCREEN, Record & Mfgr.

From	To	Formation	Thickness	CASING & SCREEN, Record & Mfgr.	From	To	Ftg.
0	5	Fine sand topsoil		Plain	0	138	138
5	22	Tan sandy clay & fine sand		Screen	138	143	5
22	25	Sand & gravel, fine					
25	40	Sand & sandy tan clay					
40	52	Sand & gravel, very fine to fine					
52	56	Sand & gravel, med, some coarse		Left casing 2' above ground			
56	68	Sand & gravel, fine & fine sand					
68	79	Sandy tan clay & streaks of lime-					
		stone 72-75'					
79	85	Fine sand & sand & gravel					
85	95	Brown clay & streak of limestone	93'-94'				
95	105	Sand & gravel, fine & fine sand					
105	112	Sand & gravel, med. to fine					
112	112.5	Brown clay					
112.5	142	Sand & gravel, med. to fine to coarse					
142	161	Sandy tan clay w/thin streak of limestone		Total Casing & Screen			
161	187	Sand & gravel, fine some med. strk of limestone	175'				

Static Water Level 187 Red Shale 30' Chlorinate: \_\_\_\_\_ Quantity Used

GRAVEL PACK \_\_\_\_\_ CEMENT \_\_\_\_\_ Chlorides = 240 ppm  
10 to 143 \_\_\_\_\_ 0 to 10

What is the nearest source of possible contamination unplugged oil field hole  
Direction From Well East How Many Feet 600

Designed by Darrell W. Clarke Drilled by Rodney Schenkel Date: 10/8/85

DEC 2 1985

WILLIAM K. BLACK, INC.  
 "LOST HOLE"

C. NONE 28-26-13W

PIRATT COUNTY

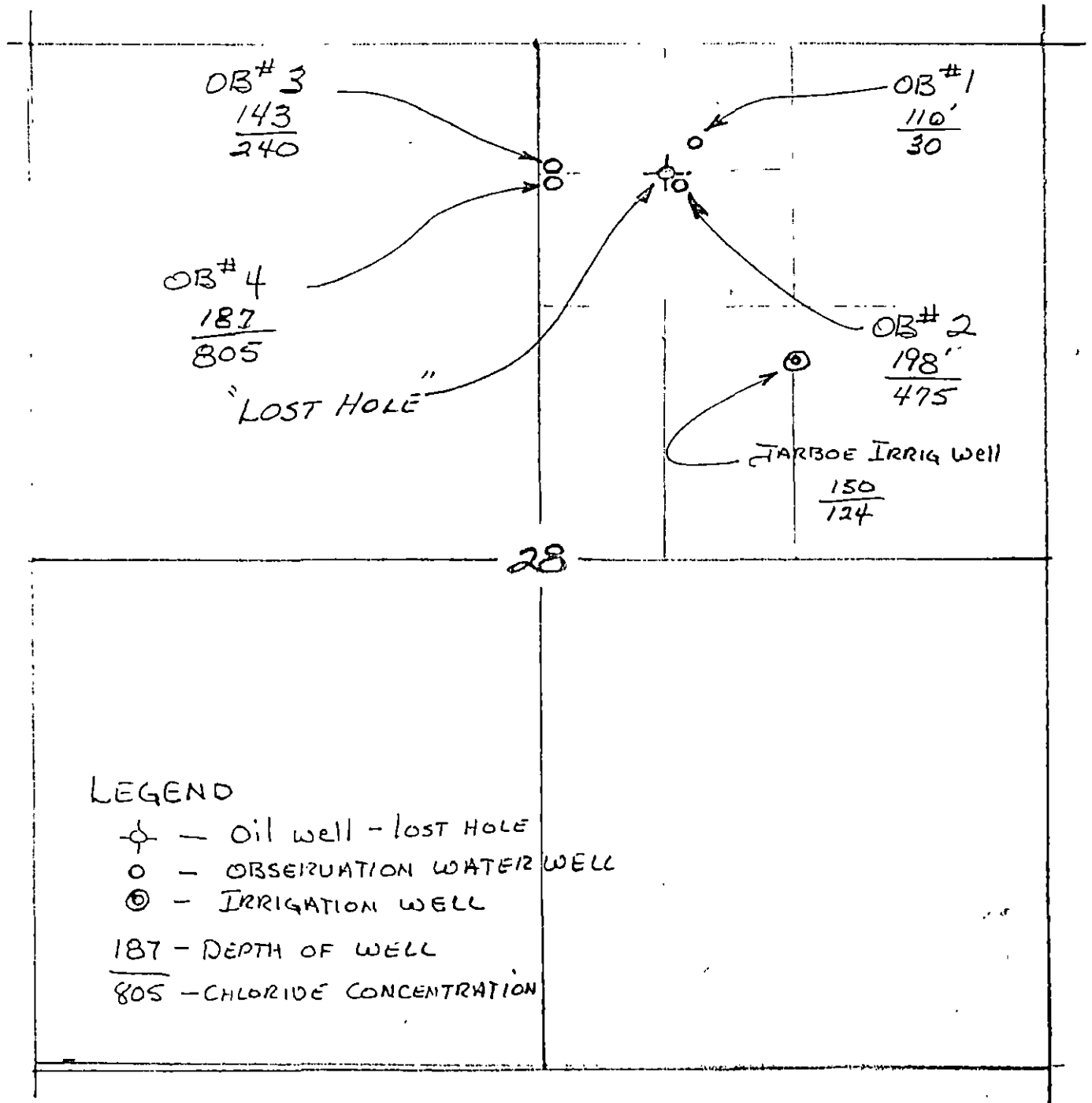

DEC 27 1985

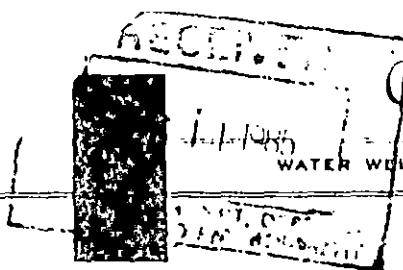

# Clarke Well and Equipment, Inc.

WATER WELLS & ROTARY DRILLING - PUMPS - IRRIGATION EQUIPMENT - TRENCHING

ROUTE 1 - AIRPORT - GREAT BEND, KANSAS 67530  
TELEPHONE AC 316-793-8340

CUSTOMER NO	JOB NO.	IRR DEV	INVOICE NO	INVOICE DATE
498995	6277	no	3984	December 10, 1985

W. K. Black Inc.  
Box 801  
Pratt, KS 67124

TERMS: This invoice due and payable on or before the 10th of the month following date of invoice. A monthly finance charge of 1 1/2% will be rendered on past due accounts. This is an annual rate of 18% on unpaid balance.

QUANTITY	DESCRIPTION	UNIT PRICE	EXTENSION
	NE 1/4 28-26-13, Pratt Co., KS MONITOR WELLS		
	10/8/85 Monitor Well #1 (North - Shallow) 145' (CWE log & KDHE report attached)	6.50/ft	942.50
	11/22/85 Monitor Well #2 (South - Deep) 187' (CWE log and KDHE Report attached)	6.50/ft	<u>1,215.50</u>

copies invoice & logs - ~~Don Abel KDHE Dodge City~~  
Big Bend GMD #5

TOTAL MATERIAL AND SERVICE	\$ 2,158.00
STATE SALES TAX	<u>86.32</u>
TOTAL INVOICE	<u>\$ 2,244.32</u>

THANK YOU

BFG 2 1985



PATTINSON LOST HOLE

NWNE 28-26-13W

PRATT COUNTY

15'  
200'

WATER TABLE  
50'

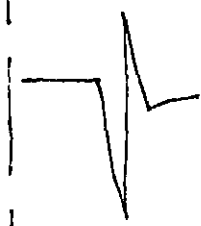
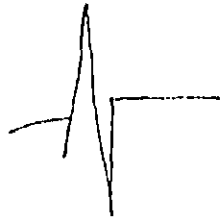

SAND & GRAVEL  
(FRESH WATER)

200' 195' ← BEDROCK CONTACT

461' (TOP OF SHOT OFF  
drill string)

65'

526' (BOTTOM OF BIT)

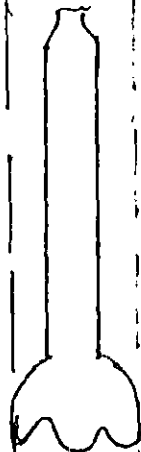

PERMIAN  
REDBEDS  
SALT PLAINS  
&  
HAIRPETZ

750+ STONE CORRAL ANHY. 11

XXXX XXXX  
SALT XXX  
XXX

TO 820'

XXXXXXXXXX  
XXXXXXXXXX  
XXXXXXXXXX  
XXXXXXXXXX

NINNESCA  
SHALE

530 sq ft 12 yd<sup>3</sup>

20' E skid

Don't know measurement

0 24' 0

61'

0

- Don U.

- Bill Black

? the 11.6 units

640

- Ralph

- Jerry

- Harold Van Bore

Ralph O'Leary  
+ Kyle Parker

Pathinson

object - 100 one contacted owners

only cement drilled in ho. well was ~ 25'

est. 4 coagul @ 1/ft = 4,000  
+ of well

5' of perf. with 3' in bedrock leave 2' perf in sand

3-4 hr @ 20 gpm

~ 40' to w.c. in ho. well  
37'

Black doesn't consider himself liable.

Ralph said ECC has found to do work, asked what we will do