

EFFECTIVE DATE: 9-20-93

FORM MUST BE TYPED

DISTRICT #

State of Kansas
NOTICE OF INTENTION TO DRILL

FORM MUST BE SIGNED

SCA? Yes No

Must be approved by the K.C.C. five (5) days prior to commencing well

ALL BLANKS MUST BE FILLED

Expected Spud Date 09 15 93
month day year

Spot East
C-N/2-SE-NW Sec 35 Twp 26s Rg 12X West

OPERATOR: License # 30060
Name: Veteran Exploration, Inc.
Address: 7535 E Hampden Ave #506
City/State/Zip: Denver, CO 80231
Contact Person: Robert Hall Gordon
Phone: (316) 265-9311 262-5439

3630 feet from South / 2310 feet from East / West line of Section
IS SECTION X REGULAR IRREGULAR?

(NOTE: Locate well on the Section Plat on Reverse Side)
County: Pratt
Lease Name: Mardis Well #: I-135

CONTRACTOR: License #: Unknown - will notify
Name: Unknown prior to spud

Field Name: SteadSouth
Is this a Prorated/Spaced Field? yes X no

Well Drilled For: Well Class: Type Equipment:
X Oil Enh Rec Infield X Mud Rotary
Gas Storage Pool Ext Air Rotary
OWWO Disposal X Wildcat Cable
Seismic # of Holes Other

Target Formation(s): Mississippi
Nearest lease or unit boundary: 330'
Ground Surface Elevation: 1860' Est feet HSL

If OWWO: old well information as follows:
Operator:
Well Name:
Comp. Date: Old Total Depth

Water well within one-quarter mile: yes X no
Public water supply well within one mile: yes X no
Depth to bottom of fresh water: 210

Directional, Deviated or Horizontal wellbore? yes X no
If yes, true vertical depth:
Bottom Hole Location:

Depth to bottom of usable water: 220
Surface Pipe by Alternate: X 1 2
Length of Surface Pipe Planned to be set: 240'

AFFIDAVIT

The undersigned hereby affirms that the drilling, completion and eventual plugging of this well will comply with K.S.A. 55-101, et. seq.
It is agreed that the following minimum requirements will be met:

Length of Conductor pipe required: None
Projected Total Depth: 4130 TVD
Formation at Total Depth: Mississippi

Water Source for Drilling Operations:
... well ... farm pond X ... other
DWR Permit #:

Will Cores Be Taken?: yes X no
If yes, proposed zone:

1. Notify the appropriate district office prior to spudding of well;
2. A copy of the approved notice of intent to drill shall be posted on each drilling rig;
3. The minimum amount of surface pipe as specified below shall be set by circulating cement to the top; in all cases surface pipe shall be set through all unconsolidated materials plus a minimum of 20 feet into the underlying formation;
4. If the well is dry hole, an agreement between the operator and the district office on plug length and placement is necessary prior to plugging;
5. The appropriate district office will be notified before well is either plugged or production casing is cemented in;
6. IF AN ALTERNATE II COMPLETION, PRODUCTION PIPE SHALL BE CEMENTED FROM BELOW ANY USABLE WATER TO SURFACE WITHIN 120 DAYS OF SPUD DATE. IN ALL CASES, NOTIFY DISTRICT OFFICE PRIOR TO ANY CEMENTING.

I hereby certify that the statements made herein are true and to the best of my knowledge and belief.

Date: 09/03/93. Signature of Operator or Agent: Robert P. Jacobsen Title: President

FOR KCC USE:
 API # 15- 151-22106-0000
 Conductor pipe required 1100 feet
 Minimum surface pipe required 240' foot per Alt.
 Approved by: CB 9-15-93
 This authorization expires: 3-15-94
 (This authorization void if drilling not started within 6 months of effective date.)
 Spud date: Agent:

REMEMBER TO:

- File Drill Pit Application (form CDP-1) with Intent to Drill;
- File Completion Form ACO-1 within 120 days of spud date;
- File acreage attribution plat according to field proration orders;
- Notify appropriate district office 48 hours prior to workover or re-entry;
- Submit plugging report (CP-4) after plugging is completed;
- Obtain written approval before disposing or injecting salt water.

Mail to: Conservation Division, 200 Colorado Derby Building, 202 W. First St., Wichita, Kansas 67202-1286.

RECEIVED
STATE CORPORATION COMMISSION
SEP 09 1993
9-9-93
CONSERVATION DIVISION
Wichita, Kansas

IN ALL CASES PLOT THE INTENDED WELL ON THE PLAT BELOW

PLAT OF ACREAGE ATTRIBUTABLE TO A WELL IN A PRORATED OR SPACED FIELD

If the intended well is in a prorated or spaced field, please fully complete this side of the form. If the intended well is in a prorated or spaced field complete the plat below showing that the well will be properly located in relationship to other wells producing from the common source of supply. Please show all the wells within 1 mile of the boundaries of the proposed acreage attribution unit for gas wells and within 1/2 mile of the boundaries of the proposed acreage attribution unit for oil wells.

API NO. 15- _____
 OPERATOR Veteran Exploration, Inc. LOCATION OF WELL: COUNTY Pratt
 LEASE Mardis 3630 feet from south/north line of section
 WELL NUMBER T-135 2310 feet from east/west line of section
 FIELD SteadSouth SECTION 35 TWP 26S RG 12W

NUMBER OF ACRES ATTRIBUTABLE TO WELL 10 IS SECTION X REGULAR or _____ IRREGULAR
 QTR/QTR/QTR OF ACREAGE NE - SE - NW IF SECTION IS IRREGULAR, LOCATE WELL FROM NEAREST
CORNER BOUNDARY.

Section corner used: _____ NE _____ NW _____ SE _____ SW

PLAT

(Show location of the well and shade attributable acreage for prorated or spaced wells.)
 (Show footage to the nearest lease or unit boundary line.)

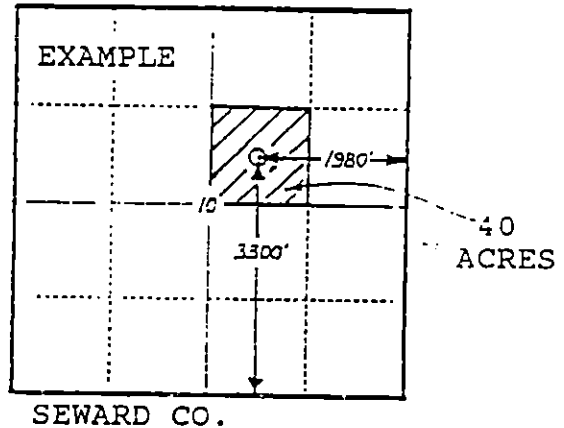
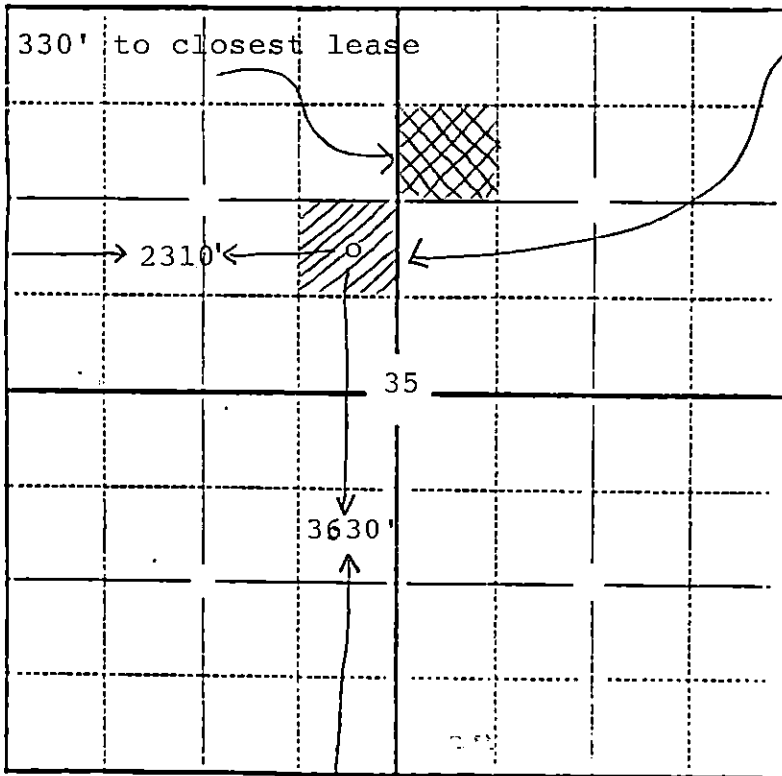

Veteran Exploration, Inc. Pratt CO.

In plotting the proposed location of the well, you must show:

- 1) The manner in which you are using the depicted plat by identifying section lines, i.e. 1 section, 1 section with 8 surrounding sections, 4 sections, etc.;
- 2) the distance of the proposed drilling location from the section's south/north and east/west lines; and
- 3) the distance to the nearest lease or unit boundary line.